

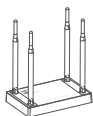

netis Wireless Dual Band Fiber Router
Quick Installation Guide



1.Package Contents



Wireless Dual Band Router



Power Adapter

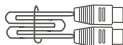

Ethernet Cable



QIG

* This QIG is for all netis wireless dual band fiber routers.

* The product model shown in this QIG is WF2780F, as an example.

2.Hardware Connection

Application 1: Use WAN Port

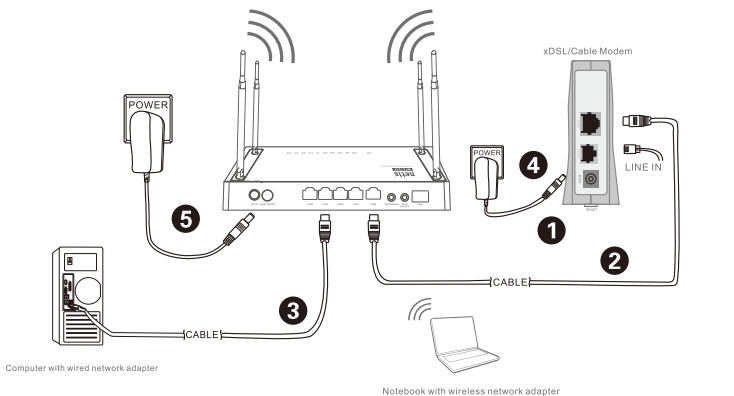

Computer with wired network adapter

Notebook with wireless network adapter

- 1) Power off your Modem.
- 2) Connect the WAN port on netis Router to the Modem's LAN port with an Ethernet cable.
- 3) Connect your computer to one of the LAN ports on netis Router with an Ethernet cable.
- 4) Power on your Modem.
- 5) Plug the provided Power Adapter into the PWR jack of netis Router and the other end to a standard electrical socket. Then wait for one minute.

Application 2: Use Fiber Port

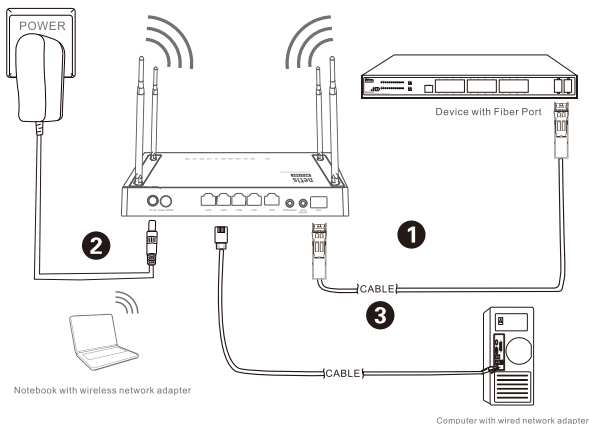

- 1) Plug the SFP module to the fiber port on the switch or other fiber device and the other end to the fiber port of netis Router.
- 2) Connect your computer to one of the LAN ports on netis Router with an Ethernet cable.
- 3) Plug the provided Power Adapter into the PWR jack of netis Router and the other end to a standard electrical socket. Then wait for one minute.

3. Configure the Modem Router via Web Management Page

- 3.1. Set the IP address of the wired network adapter on your computer as **“Automatic”** or **“DHCP”**.

For Windows 8/7/Vista

- 1) Go to **“Settings”** (Win 8)/**“Start”** (Win 7/Vista)>**“Control Panel”**.
- 2) Left-click on **“Network and Internet”**>**“Network and Sharing Center”**>**“Change adapter settings”** (Win 8/7)/**“Manage network connections”** (Win Vista).
- 3) Right-click on **“Local Area Connection”** and left-click on **“Properties”**.
- 4) Double-click on **“Internet Protocol Version 4 (TCP/IPv4)”**.
- 5) Select **“Obtain an IP address automatically”** and **“Obtain DNS server address automatically”** then left-click on **“OK”**.

For Windows XP/2000

- 1) Go to “**Start**”>“**Control Panel**”.
- 2) Left-click on “**Network and Internet Connections**”>“**Network Connections**”.
- 3) Right-click on “**Local Area Connection**” and left-click on “**Properties**”.
- 4) Double-click on “**Internet Protocol (TCP/IP)**”.
- 5) Select “**Obtain an IP address automatically**” and “**Obtain DNS server address automatically**” then left-click on “**OK**”.

For MAC OS

- 1) Click on the “**Apple**” menu>“**System Preferences**”.
- 2) Click on the “**Network**” icon.
- 3) Click on “**Ethernet**” in the left side box and click on “**Advanced**” in the lower right corner.
- 4) In the top options, select “**TCP/IP**”.
- 5) In the pull-down menu next to “**Configure IPv4**” select “**Using DHCP**”.
- 6) Click “**OK**” then “**Apply**”.

- 3.2. Open your browser and type **http://netis.cc** in the address field to visit router's web management page.



- 3.3.
 - 1) In “**Easy Setup**” page, please enter the **User Name** and **Password** given by your ISP in **WAN Configuration** section.
 - 2) Under **Wireless Setting**, configure your wireless network name (SSID) and password.
 - 3) Left-click on “**Apply Changes**” to make your settings take effect.

WAN Configuration	
Please enter the required information below.	
User Name:	<input type="text" value="pppoe@ccs"/>
Password:	<input type="password" value="*****"/>
Obtain your account name and password from your ISP.	
Wireless Setting	
Enable Wireless 2.4GHz: <input type="checkbox"/>	Enable Wireless 5GHz: <input type="checkbox"/>
SSID: <input type="text" value="netis_2.4G_0002C2"/>	SSID: <input type="text" value="netis_5G_0002C2"/>
Encryption: <input type="text" value="WPA2"/>	Encryption: <input type="text" value="WPA2"/>
Pre-Shared Key: <input type="password" value="*****"/>	Pre-Shared Key: <input type="password" value="*****"/>
Pre-Shared Key should be set at least 8 characters.	Pre-Shared Key should be set at least 8 characters.
Apply Changes	

Tip:

Default access address: <http://netis.cc>

2.4G default SSID: netis_2.4G_XXXXXX

5G default SSID: netis_5G_XXXXXX

Default wireless password: password

Default Internet connection type is PPPoE. You can configure other Internet connection type in **"Setup"** page.

(XXXXXX: Last 6 digits of LAN MAC Address)

4. Troubleshooting

Q How do I restore my netis Router's configuration to its default settings?

A With the router powered on, use a pin to press and hold the Default button on the rear panel for 8 to 10 seconds before releasing it. The router will reboot and all configurations are back to factory default.

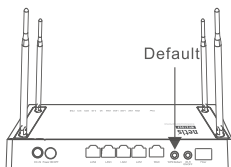

Q What can I do if my Internet cannot be accessed?

- A**
- 1) Check to verify the hardware connections are correct.
Please refer to the **"Hardware Connection"** step.
 - 2) Login to netis Router's web management page and ensure that you set the correct Internet Connection Type.
 - 3) For cable modem users, reboot the modem first and then netis Router. Wait for one minute before you check the Internet again.
 - 4) If Internet access is not available, please connect your computer directly to your modem and try the Internet again.
If the Internet is still not working, please contact your ISP for further help.

FCC Statement:

This equipment has been tested and found to comply with the limits for a Class B digital device, pursuant to part 15 of the FCC Rules. These limits are designed to provide reasonable protection against harmful interference in a residential installation. This equipment generates, uses and can radiate radio frequency energy and, if not installed and used in accordance with the instructions, may cause harmful interference to radio communications. However, there is no guarantee that interference will not occur in a particular installation. If this equipment does cause harmful interference to radio or television reception, which can be determined by turning the equipment off and on, the user is encouraged to try to correct the interference by one or more of the following measures:

- 1.Reorient or relocate the receiving antenna.
- 2.Increase the separation between the equipment and receiver.
- 3.Connect the equipment into an outlet on a circuit different from that to which the receiver is connected.
- 4.Consult the dealer or an experienced radio/TV technician for help.

FCC Radiation Exposure Statement:

This device complies with FCC radiation exposure limits set forth for an uncontrolled environment and it also complies with Part 15 of the FCC RF Rules. This equipment must be installed and operated in accordance with provided instructions and the antenna(s) used for this transmitter must be installed to provide a separation distance of at least 20 cm from all persons and must not be co-located or operating in conjunction with any other antenna or transmitter. End-users and installers must be provide with antenna installation instructions and consider removing the no-collocation statement.

This device complies with Part 15 of the FCC Rules. Operation is subject to the following two conditions: (1) this device may not cause harmful interference, and (2) this device must accept any interference received, including interference that may cause undesired operation.

Caution!

Any changes or modifications not expressly approved by the party responsible for compliance could void the user's authority to operate the equipment.

Technical Support:**USA/Canada:****Toll Free:**+1 866 71 network(+1 866 716 3896)**E-mail:**usa_support@netis-systems.com**Manufacture warranty:**one year from date of purchase.**Other Regions:****E-mail:**support@netis-systems.com