

REMOTE CONTROLLED COUNTDOWN TIMER

MODEL # YLT-36T1

INSTALLATION INSTRUCTIONS

1. INSTALL TIMER to a vertical flat surface close to a properly installed outdoor-rated grounded receptacle.
 - a. Using a screw or hook (not included), secure the MOUNTING TAB at the top of the timer to a wall or post.
 - b. For a more secure mounting, use the two MOUNTING HOLES on the back of the timer.
 - Create a mounting template by placing a sheet of paper over the back of the timer and punching holes through the paper where the mounting holes are located on the timer.
 - Temporarily secure the mounting template to the flat surface where the timer is to be mounted.
 - Drill two 3/32 inch pilot holes where indicated on the mounting template.
 - Insert two #6 sheet metal screws (not included), leaving screw heads protruding 1/8 inch from the surface.
 - Place the timer over the screw heads and push down to lock into place.
2. Plug the receiver into an electrical outlet. Use an outdoor-rated three-pronged grounded electrical outlet. Do not use extension cords to connect the timer to the power source.

3. Remove the plastic battery tab from the battery compartment in the back of the remote control to activate the 3V, CR2032 pre-installed battery.

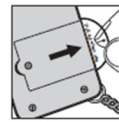

4. Attach up to TWO devices to the timer. Plug the lights or devices to be controlled into the outlets on the bottom of the timer.

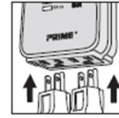

PROGRAMMING INSTRUCTIONS

1. Set the desired "Program".
 - a. Use the "Set" button on the receiver: Press the "Set" button to cycle the LED's to the desired mode. The red light will blink 3 times rapidly to confirm your selection, then the light next to your selection will turn off. There will still be a red light illuminated next to the word "ON" to show that the program has been set.
 - OR
 - b. Use the transmitter: Press the "P" (program) button on the transmitter to cycle the LED's to the desired mode. Then press the "OK" button once to confirm your desired mode. The red light on your transmitter will turn off. The red light on the receiver next to your selection will blink 3 times. There will still be a red light illuminated next to the word "ON" on your receiver to show that the program has been set.

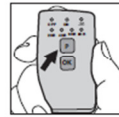
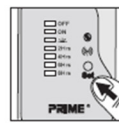

PROGRAM MODES	
OFF	- Power is OFF to attached devices
ON	- Power is ON to attached devices
Dusk-Dawn	- Power will turn on at dusk and remain on until dawn
2 Hrs	- Power will turn on at dusk and remain on for 2 hours
4 Hrs	- Power will turn on at dusk and remain on for 4 hours
6 Hrs	- Power will turn on at dusk and remain on for 6 hours
8 Hrs	- Power will turn on at dusk and remain on for 8 hours

NOTE: The timer will turn ON at dusk and the red light next to the desired setting will be ON. After the timed cycle has been completed the red light next to the desired setting will turn off, but the red light next to the word "ON" will remain lit to show that the program is still active and will repeat at dusk each day until the program mode is changed.

IN CASE OF POWER FAILURE

The timer will stop operating if the power goes out. Once power is restored, reset the desired program mode as explained in step 1 of the programming instructions.

HELPFUL TIPS

- This timer is weather-resistant and rated for outdoor use. The timer will function outdoors when installed and programmed as outlined in this manual.
- This timer operates using a light-sensitive photocell that senses when the environment is getting dark (dusk) or light (dawn). The photocell is located to the right of the program modes on the face of the timer.
- Once programming activates at dusk in the 2hr, 4hr, 6hr or 8hr mode, the program cycle will complete before the timer resets. Headlights, porch lights, street lamps and other external lighting sources will not interfere with the active timer program.
- In the dusk-to-dawn mode, temporary light sources like headlights, porch lights and other external light sources will not interfere with the photocell function unless the external light source is on for more than 15 minutes. In that case, the timer will shut off until darkness is restored.
- When set to "ON", the timer will provide continual power to attached devices until the timer is switched to "OFF", or to any of the other program modes.
- The "Program" indicator light will turn on when the timer programming is activated and power is being provided to attached devices.
- Make sure the receiver is plugged into a working AC outlet.
- Make sure the receiver and connected equipment are on.
- Make sure the 3V, CR2032 battery in the remote control is still functioning.

This device complies with Part 15 of the FCC Rules. Operation is subject to the following two conditions: (1) this device may not cause harmful interference, and (2) this device must accept any interference received, including interference that may cause undesired operation

This device complies with Part 15 of the FCC Rules. Operation is subject to the following two conditions: (1) this device may not cause harmful interference, and (2) this device must accept any interference received, including interference that may cause undesired operation

This device has been tested and found to comply with the limits for a Class B digital device, pursuant to Part 15 of the FCC Rules. These limits are designed to provide reasonable protection against harmful interference in a residential installation. This device generates, uses and can radiate radio frequency energy and, if not installed and used in accordance with the instructions, may cause harmful interference to radio communications.

However, there is no guarantee that interference will not occur in a particular installation. If this device does cause harmful interference to radio or television reception, which can be determined by turning the device off and on, the user is encouraged to try to correct the interference by one or more of the following measures:

- Reorient or relocate the receiving antenna.
- Increase the separation between the device and receiver.
- Connect the device into an outlet on a circuit different from that to which the receiver is connected.
- Consult the dealer or an experienced radio/TV technician for help

Changes or modifications not expressly approved by the party responsible for compliance could void the user's authority to operate the equipment

This device contains licence-exempt transmitter(s)/receiver(s) that comply with Innovation, Science and Economic Development Canada's licence-exempt RSS(s). Operation is subject to the following two conditions: (1) This device may not cause interference. (2) This device must accept any interference, including interference that may cause undesired operation of the device

Cet appareil contient des émetteurs / récepteurs exemptés de licence conformes aux RSS (RSS) d'Innovation, Sciences et Développement économique Canada. Le fonctionnement est soumis aux deux conditions suivantes : (1) Cet appareil ne doit pas causer d'interférences. (2) Cet appareil doit accepter toutes les interférences, y compris celles susceptibles de provoquer un fonctionnement indésirable de l'appareil.