

## TRUE WIRELESS EARBUDS



## QUICK START GUIDE

FCC ID: 2ABHA0059

### GETTING STARTED

- ① Micro USB charging port
- ② Charging Case LED indicators
- ③ Charging Case Power Button (For checking power only)
- ④ Left earbud LED indicator
- ⑤ Left control button
- ⑥ Right earbud LED indicator
- ⑦ Right control button

Left Earbud / Right Earbud  
Pause/Play/Answer Call/End Call

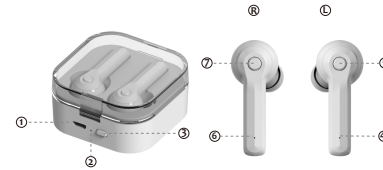

### CHARGING YOUR CASE

- Charge the charging case, with the included micro USB cable for 2 hours. The LED indicator will be lit red during charging and turned off after fully charged
- Do not charge longer than suggested time. Do not charge overnight.*

### CHARGING YOUR EARBUDS



- Please remove the insulating trip before charging earbuds.
- Place Right and Left Earbuds in charging case
- Charging case LED indicator (2) will illuminate Blue and the earbud LED indicators (4, 6) will illuminate Red, indicating that the earbuds are charging properly. When Earbuds LEDs (4, 6) turns off, earbud batteries are fully charged.

### MONO MODE (SINGLE EARBUD USE)



- Remove earbud from charging case
- Once earbud is powered on, it will automatically proceed to **PAIRING**

### STEREO MODE (DUAL EARBUD USE)

- Remove both earbuds from charging case and close each other
- Earbuds will automatically link together after a few seconds, and earbuds will have a tone. One earbuds will flash red and blue, another earbuds will flash blue only. Note: Please double press the control button of one earbuds to make both earbuds pairing each other if they still not paired automatically after 20 seconds.
- Once Earbuds are linked together you may proceed to pairing with your mobile device.

### PAIRING

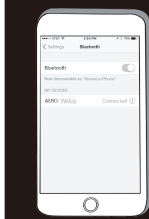

\*Note: Once earbuds have been initially paired successfully with your mobile device, they will automatically pair the next time they are powered on.

### OPERATING BLUETOOTH EARBUDS

Model: SL319  
Item No.: XXXX  
Capacity(Cradle): 350mAh / 3.7V (1.295Wh)  
Capacity(Earbuds): 50mAh / 3.7V (0.185Wh)  
Input: 5V/60mA (Earbuds)  
Input: 5V/300mA (Cradle)

Function	Operation
Power On	Press (5) or (7) for 3 seconds or remove the earbuds from charging case
Power Off	Press (5) or (7) for 3 seconds or place the earbuds in the charging case
Play/Pause	Single press (5) or (7)
Answer	Single press (5) or (7)
Reject	Press (5) or (7) for 2 seconds

Earbuds	LED indications (4) & (6)
Power On	Red and Blue LED will flash alternately
Link Mode	Flashing Blue + Red
Paired Successfully	Flashing Blue
Power Off	LED Off
Earbuds in Cradle	
Charging	Solid Red
Fully Charged	LED off

Charging Case	See CHARGING YOUR CASE
---------------	------------------------

### FCC STATEMENT

This device complies with Part 15 of the FCC Rules. Operation is subject to the following two conditions:  
(1) This device may not cause harmful interference, and  
(2) This device must accept any interference received, including interference that may cause undesired operation.

#### Warning:

Changes or modifications not expressly approved by the party responsible for compliance could void the user's authority to operate the equipment.

Note: This equipment has been tested and found to comply with the limits for a class B digital device, pursuant to Part 15 of the FCC Rules. These limits are designed to provide reasonable protection against harmful interference in a residential installation.

This equipment generates uses and can radiate radio frequency energy and, if not installed and used in accordance with the instructions, may cause harmful interference to radio communications. However, there is no guarantee that interference will not occur in a particular installation. If this equipment does cause harmful interference to radio or television reception, which can be determined by turning the equipment off and on, the user is encouraged to try to correct the interference by one or more of the following measures:

- Reorient or relocate the receiving antenna.
- Increase the separation between the equipment and receiver.
- Connect the equipment into an outlet on a circuit different from that to which the receiver is connected.

- Consult the dealer or an experienced radio/TV technician for help.
- The device has been evaluated to meet general RF exposure requirement. The device can be used in portable exposure condition without restriction

Made in China