

DD1520/DD1522

Emitter Specification

Version NO.: A/00

T Type specification

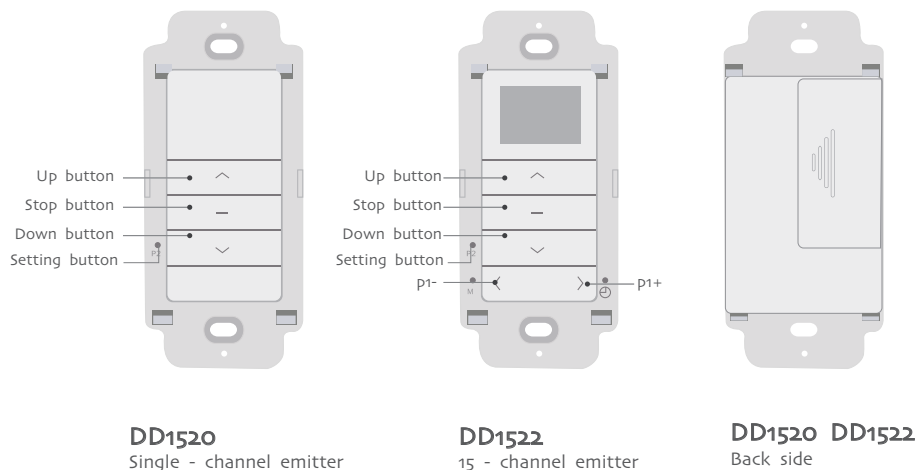

T Technical support

Technical specification	Function instruction
<ul style="list-style-type: none"> Input voltage: 3V Transmitting frequency: 433MHz Transmitting power: 10 milliwatt Operating temperature: -10°C—50°C Transmission distance: 200 meters open office, 35 meters on two walls 	<p>DD1522 fifteen channels double control emitter: each channel had the same function with DD1520. One number of LCD screen means one control channel. Press "channel choose" button P1- (number descending) or P1+ (number increasing) to change the channel. On the analogy of this, loose finger when the indicator light move to suitable channel that you select effective channel. If LCD screen number show "0" that means the group control status. Under the status of group control, pressing a way button will start the group-control function of a way, a way of all the channels will be available. Pressing b way buttons will start the group-control function of b way, b way of all the channels will be available.</p> <p>CAUTION RISK OF EXPLOSION IF BATTERY IS REPLACED BY AN INCORRECT TYPE. DISPOSE OF USED BATTERIES ACCORDING TO THE INSTRUCTIONS</p> <p>Notice: transmitter do not exposed to moisture and strike, so as not to affect life. When you use transmitter, if found emission distance obviously short or less sensitive, please change another same new battery. Please have batteries for recycling.</p>

A DD1522 valid channels selection

Additional function

! In the setting state, press the up or down button you can quit quickly, if you want to change the valid channels, reset it.

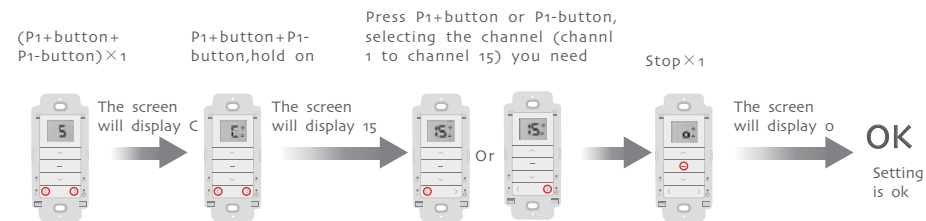

Note: The channel, which we used here, refers to the product control channel, rather than the channel of transmission frequency, only one transmission frequency is 433MHz.

FCC STATEMENT

1. This device complies with Part 15 of the FCC Rules. Operation is subject to the following two conditions:

(1) This device may not cause harmful interference.

(2) This device must accept any interference received, including interference that may cause undesired operation.

2. Changes or modifications not expressly approved by the party responsible for compliance could void the user's authority to operate the equipment.

NOTE: This equipment has been tested and found to comply with the limits for a Class B digital device, pursuant to Part 15 of the FCC Rules. These limits are designed to provide reasonable protection against harmful interference in a residential installation.

This equipment generates uses and can radiate radio frequency energy and, if not installed and used in accordance with the instructions, may cause harmful interference to radio communications. However, there is no guarantee that interference will not occur in a particular installation. If this equipment does cause harmful interference to radio or television reception, which can be determined by turning the equipment off and on, the user is encouraged to try to correct the interference by one or more of the following measures:

Reorient or relocate the receiving antenna.

Increase the separation between the equipment and receiver.

Connect the equipment into an outlet on a circuit different from that to which the receiver is connected.

Consult the dealer or an experienced radio/TV technician for help.