





FL 1 STANDARD	HIGH	MED	LOW
	700 LUMENS	300 LUMENS	100 LUMENS
	2h 30min	5h	13h
	28 m	18 m	10 m
	IPX4 		

BATTERY LIFE
LIGHT ONLY 2.5 Hours 700 Lumens
MUSIC ONLY 12 Hours
LIGHT & MUSIC 3.5 Hours 400 Lumens

FCC STATEMENT OF COMPLIANCE

WARNING: Changes or modifications not expressly approved by the party responsible for compliance could void the user's authority to operate the equipment. This equipment has been tested and found to comply with the limits for a Class B digital device, pursuant to part 15 of the FCC Rules. These limits are designed to provide reasonable protection against harmful interference in a residential installation. This equipment generates, uses and can radiate radio frequency energy and, if not installed and used in accordance with the instructions, may cause harmful interference to radio communications. However, there is no guarantee that interference will not occur in a particular installation. If this equipment does cause harmful interference to radio or television reception, which can be determined by turning the equipment off and on, the user is encouraged to try to correct the interference by one or more of the following measures:

- Reorient or relocate the receiving antenna.
- Increase the separation between the equipment and receiver.
- Connect the equipment into an outlet on a circuit different from that to which the receiver is connected.
- Consult the dealer or an experienced radio/TV technician for help.

Note: This device complies with Part 15 of the FCC Rules.

Operation is subject to the following two conditions: (1) this device may not cause harmful interference, and (2) this device must accept any interference received, including interference that may cause undesired operation.

PRECAUTIONS

- Please store and use this product at room temperature.
- Do not expose this product to rain or damp surroundings.
- Prevent this product from falling as that could result in serious damage.
- Do not dismantle, repair or modify this product on your own.
- In order to avoid any risk, do not dispose this product inappropriately or expose it to fire as there is a built-in, non-replaceable lithium battery.

TIPS

1. Do not turn up the volume to maximum for a long time as this could shorten the service life of this product or impair your hearing.
2. When encountering any fault during operation, please cut off the power supply and disconnect the USB cable to prevent further damage to the speaker or other components.
3. The Bluetooth transmission range or connectivity could be affected by low battery power. In that case, please recharge immediately.



CAUTION: Possible hazardous optical radiation emitted from this product. The luminaire should be positioned so that prolonged staring into the luminaire at a distance closer than 1.5 m / 5.1 ft is not expected.



WARNING: The ventilation should not be impeded by covering the ventilation openings with items such as newspapers, tablecloths and curtains. Allow at least a 10 cm gap all around the product.



WARNING: No naked flame sources, such as lighted candles, should be placed on the speaker.



WARNING: This appliance is intended for domestic household use only and should not be used for any other purpose or in any other application, such as for non-domestic use or in a commercial environment.

Distributed by:
Costco Wholesale Corporation
P.O. Box 34533
Seattle, WA 98124-1535
USA
1-800-774-2678
www.costco.com

Importado por:
Importadora Primex S.A. de C.V.
Blvd. Magnocentro No. 4
San Fernando La Herradura
Huixquilucan, Estado de México
C.P. 52765
RFC: PR8-930907-S70
(55)-5246-5500
www.costco.com.mx

Costco Wholesale UK Ltd /
Costco Online UK Ltd
Hartsgrove Lane
Watford, Herts
WD25 8JS
United Kingdom
01923 213113
www.costco.co.uk

Costco Wholesale Iceland ehf.
Kauptún 3-7, 210 Gardabaer
Iceland
www.costco.is

Costco Wholesale Japan Ltd.
3-1-4 Ikegami-Shincho
Kawasaki-ku, Kawasaki-shi,
Kanagawa 210-0832 Japan
0570-032600
www.costco.co.jp

Costco Wholesale New Zealand Limited
2 Gunton Drive
Westgate
Auckland 0814
New Zealand

Costco Wholesale Canada Ltd.*
415 W. Hunt Club Road
Ottawa, Ontario
K2E 1C5, Canada
1-800-463-3783
www.costco.ca
* faisant affaire au Québec sous
le nom les Entreprises Costco

Costco Wholesale Australia Pty Ltd
17-21 Parramatta Road
Lidcombe NSW 2141
Australia
www.costco.com.au

Costco Wholesale Spain S.L.U.
Polígono Empresarial Los Gavilanes
C/ Agustín de Betancourt, 17
28906 Getafe (Madrid) España
NIF: B86509460
900 111 155
www.costco.es

Costco France
1 avenue de Brehat
91140 Villebon-sur-Yvette
France
01 80 45 01 10
www.costco.fr

Costco Wholesale Korea, Ltd.
40, Iljik-ro
Gwangmyeong-si
Gyeonggi-do, 14347, Korea
1899-9900
www.costco.co.kr

Shanghai Minhang Costco Trading Co., Ltd
No. 235 Zhujian Road
Minhang District, Shanghai
China 201106
+86-21-6257-7065

PRODUCT INFORMATION

Product Model	1600276
Bluetooth Specifications	Bluetooth 5.0
Transmission Distance	≤10m (depending on operation environment and devices to which it connects)
USB Rechargeable Voltage	DC 5V 1A
Built-in Battery	2600 mAh
Output Power	5 W
Product Dimensions	5.5 x 3.0 x 2.5 inch

PROBLEM

Unable to pair up with other devices

The sound is rather low or distorted

The music stops from time to time

The Bluetooth indicator remains off

SOLUTIONS

1. Check whether the speaker is still in the process of search or switch it off and then on.
2. Too many Bluetooth devices in the proximity that cause difficulty in connection. Please turn them off.

1. Check the Bluetooth device's volume and then adjust it to a proper level.
2. Recharge the battery.

1. Check whether the speaker's effective transmission range is exceeded or there is an obstacle standing between the speaker and other Bluetooth devices.

1. It suggests the battery power drops quite low and retry once being recharged.
2. Turn it on again.

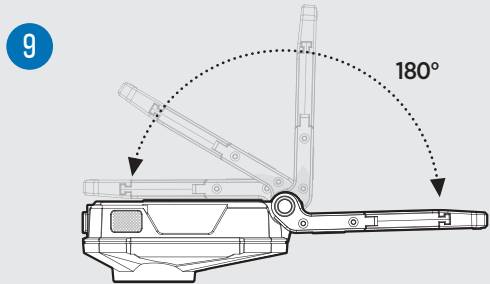
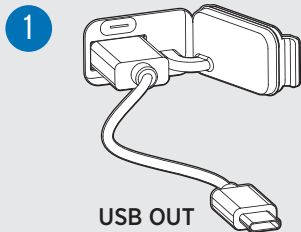
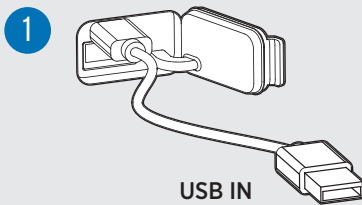

DISCONNECT FROM PHONE BEFORE CONNECTING NEW PHONE

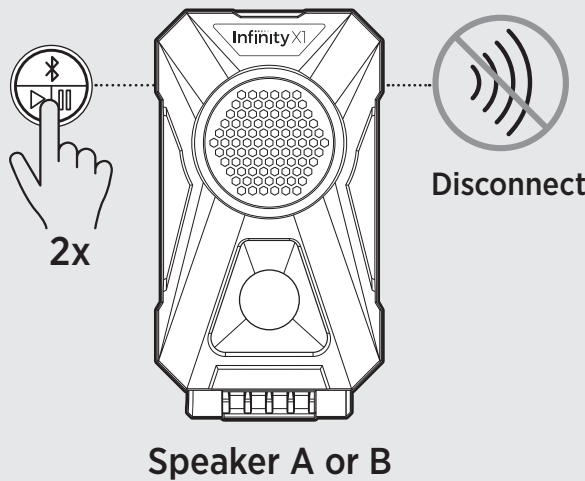

Infinity X1

SMARTER INSIDE. BRIGHTER OUTSIDE.

Manufacturer / Fabricant / Fabricante:
©2021 INFINITY X1 LLC
3525 Del Mar Heights Rd, Suite 867
San Diego, CA 92130, USA
www.infinityx1.com



Questions, problems missing parts?
Before returning to your retailer,
call Customer Service:

CUSTOMER SERVICE

USA: 1-866-544-4891
International: 1-760-230-5611
Hours: M-F 9AM to 5PM Pacific Time
Web: www.infinityx1.com/support
Email: support@infinityx1.com



MADE IN CHINA

FCC Warning Statement

Changes or modifications not expressly approved by the party responsible for compliance could void the user's authority to operate the equipment. This equipment has been tested and found to comply with the limits for a Class B digital device, pursuant to Part 15 of the FCC Rules. These limits are designed to provide reasonable protection against harmful interference in a residential installation. This equipment generates uses and can radiate radio frequency energy and, if not installed and used in accordance with the instructions, may cause harmful interference to radio communications. However, there is no guarantee that interference will not occur in a particular installation. If this equipment does cause harmful interference to radio or television reception, which can be determined by turning the equipment off and on, the user is encouraged to try to correct the interference by one or more of the following measures:

- Reorient or relocate the receiving antenna.
- Increase the separation between the equipment and receiver.
- Connect the equipment into an outlet on a circuit different from that to which the receiver is connected.
- Consult the dealer or an experienced radio/TV technician for help.