

## Using the Keyboard

A wireless keyboard is supplied with your computer.

The wireless keyboard uses a standard key arrangement with additional keys that perform specific functions.

### Using the Wireless Keyboard

Two AA alkaline batteries are supplied with your wireless keyboard. Before attempting to use the wireless keyboard, remove the battery compartment cover (1) from the bottom of the wireless keyboard and install the supplied two AA batteries (2) into the battery compartment.

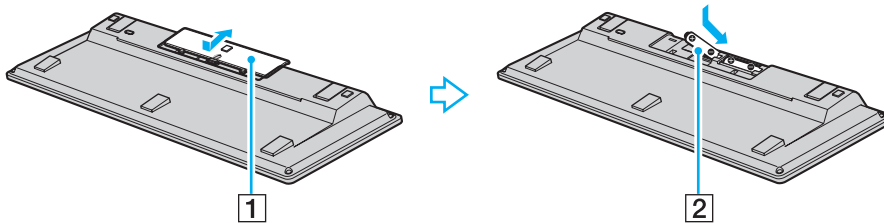

If the wireless keyboard does not operate properly, the batteries may need to be replaced. If you do not intend to use the wireless keyboard for an extended period of time, remove the batteries to avoid possible damage from battery leakage.

If the wireless keyboard is left unused for 20 minutes or longer, your computer enters Sleep mode. To bring it back into Normal mode, press any key on the wireless keyboard.

! To maintain good communication, operate the wireless keyboard within the distance limitations of keyboard: approximately 32.8 feet (10 m) from your computer.

Confirm that the supplied AA batteries are properly installed.

If you find your wireless keyboard not working, for example after you used the keyboard with another VAIO model, reconnect the keyboard. See **To connect the wireless keyboard (page 6)** for the detailed procedure.

Avoid using any wireless devices that exchange radio signals on the 2.4 GHz frequency band near the wireless keyboard. These devices may cause interference, causing the keyboard to stop working properly.

Do not place metal furniture or objects near your computer or wireless keyboard, as this may create interference, causing the keyboard to stop working properly.

Do not mix old (used) and new batteries when replacing batteries in the wireless keyboard. Be sure to use the same type and manufacture of the battery.

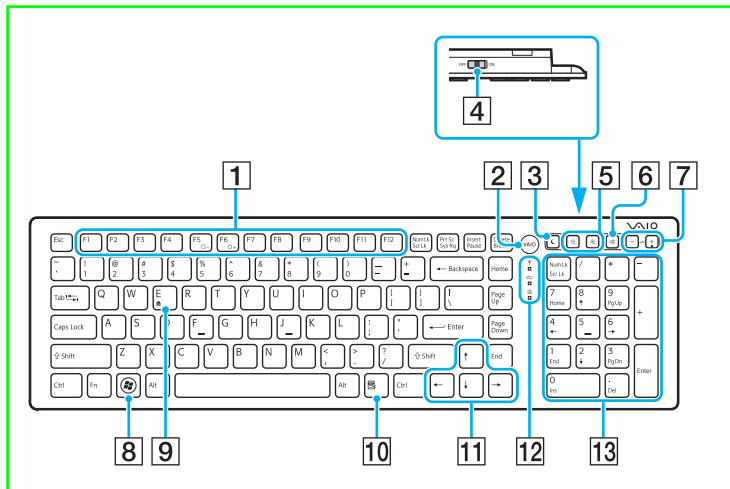

Do not mix alkaline with manganese batteries. Using incompatible batteries or mixing used, new or different types of batteries can damage the wireless keyboard.



 Illustrated above is the English keyboard as an example.

- 1 **Function keys**  
Perform certain tasks. The task associated with each function key varies among software applications except the following combinations with the **Fn** key to change the LCD brightness of your computer screen.  
**Fn+F5**: Decreases lighting intensity of the LCD screen.  
**Fn+F6**: Increases lighting intensity of the LCD screen.



**!** When the HDMI input is selected, you cannot use the function keys on the wireless keyboard to change the LCD brightness. To change the brightness for the HDMI input, see **Using the HDMI Input Control Buttons** for the procedure.

- 2 **VAIO button**  
Starts the **Media Gallery**.
- 3 **Sleep button**  
Provides a lower level of power consumption.  
For details on power management, see **Using the Power Saving Mode**.
- 4 **Power switch**  
Slide the switch to turn the wireless keyboard on and off. Zoom buttons
- 5 **Zoom buttons**  
Change the size of an image or a document displayed on some software.  
Press  to make the view look smaller and further away (zoom out).  
Press  to make the view look bigger and closer (zoom in).  
See the help file included with the **VAIO Control Center** for more information.

- 6 Muting button  
Turns the volume on and off.
- 7 Volume control buttons  
Increase (+) or decrease (-) the volume.

! When the HDMI input is selected, you cannot use the volume control buttons on the wireless keyboard to change the volume. To change the volume for the HDMI input, see **Using the HDMI Input Control Buttons** for the procedure.

- 8 Windows key  
Displays the **Start** menu.
- 9 E key  
Ejects the optical disc drive tray when used in combination with the **Fn** key.
- 10 Applications key  
Displays a shortcut menu in certain software applications.
- 11 Directional arrow keys  
Move the pointer on the computer screen.

- 12 Indicator lights
  -  (Battery): Turns off when the AA batteries for the wireless keyboard are sufficient and blinks when the batteries wear out.
  -  (Caps lock): Turns on when the **Caps Lock** key is activated.
  -  (Connect): Blinks slowly when connection between the computer and the wireless keyboard is down, blinks rapidly when the keyboard is ready for connection with the computer, and turns off when the connection is established.
- 13 Numeric keypad  
Use the numeric keypad to type numbers or to perform basic math calculations.

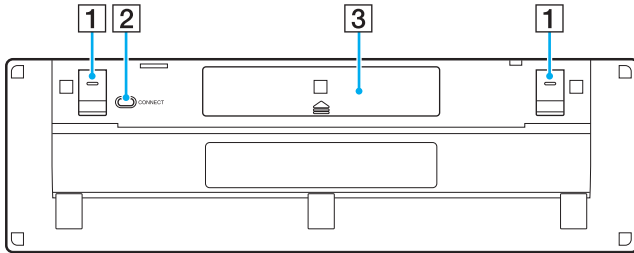

- 1** Keyboard feet  
Flip open to put the wireless keyboard in a more 'ergonomic' position.
- 2** **CONNECT** button  
Press to enable the wireless keyboard to communicate with the computer.
- 3** Battery compartment  
Storage compartment for the AA batteries.

## To connect the wireless keyboard

! To connect the wireless keyboard, it must be located within a range of approximately 11.8 inches (30 cm) to approximately 39.4 inches (1 m) from the computer.

- 1 Make sure the supplied two AA batteries are properly installed.
- 2 Turn on the computer.
- 3 Slide the power switch on the back of the keyboard to the **ON** position.
- 4 Press the **CONNECT** button (1) on the bottom of the keyboard.
- 5 Press the **CONNECT** button (2) on the back of the computer while the connect indicator light  $\Upsilon$  is blinking rapidly. The rapid-blinking connect indicator light turns off when connection is established between the computer and the keyboard. If not, repeat the procedure.

! The connect indicator light  $\Upsilon$  blinks rapidly for about one minute to indicate that the keyboard is ready for connection with the computer. If no connection is made during this period, the indicator light goes blinking slowly to indicate that the connection is down.

