

乐果®

乐享·自由·生活
ENJOY FREE LIFE

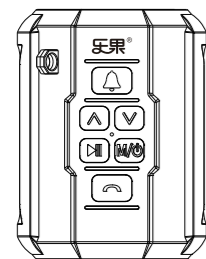

F4 骑行蓝牙音箱
CYCLING BLUETOOTH SPEAKER



本产品记载了重要注意事项和产品使用方法，请仔细阅读并妥善保管。

01 Caution



- Please study this manual carefully before using this speaker.
- Keep the speaker away from high temperature, not allowed roasting, baking or drying.
- Do not throw or drop it, avoid destroying.
- Please use the right adaptor to recharge it.
- If necessary, please use a soft cloth to clean the surface of the speakers.
- In order to protect your ear, please adjust the volume to a suitable level
- Designed for waterproof, can be used in water splash environment but please wipe up when water splash on, not allowed into water.
- Keep this product away from hit of large external force.
- Keep the speaker away from strong magnetic.
- Don't open and repair the speaker by yourself.
- In order to protect the environment, please discard the correct classification

-2-

02 Features

- Free Integrated drive-by-wire makes drive easier to enjoy safety and freedom.
- BAS™ technology makes better balance between loudspeaker & IC & Power cirucs, more perfect sound quality.
- Better hands-free by high sensitive MIC.
- Long life battery: 2600mAh satisfy better driving.
- Multifunctional mount installed on bike handle or frame, can hold speaker or water bottle.
- Two optional electronic bells, save bike handle space and money.
- FM Radio with built-in & external antenna, clear radio even in week signal environment.
- Waterproof, Dustproof, Shock proof.
- Bluetooth 4.0+EDR
- Connect back automatically
- Bluetooth function can run in background
- TF card plug & play:MP3/WMA/WAV/APE/FLAC
- Breakpoint memory for TF card play
- FM station saved automatically, breakpoint memory for FM station.
- Data transfer & AUX play
- Reset by one key
- Voice guide can be closed

-3-

03 Accessories

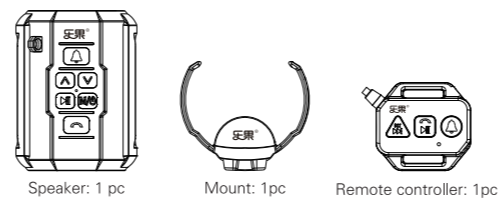

Speaker: 1 pc Mount: 1pc Remote controller: 1pc



Hook: 1pc Allen wrench: 1pc service card: 1pc Manual: 1 pc



AUX cable: 1 pc



USB cable: 1 pc

-4-

04 Buttons Function

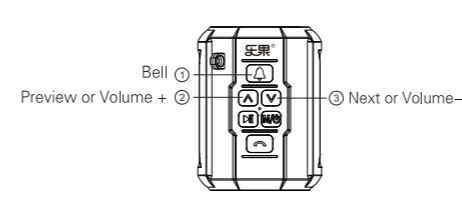

- ① **Bell:** Short or long press to ring, double press to switch ring style. Bell ring is prior when press in any mode.
- ② **Preview or Volume +**
- ③ **Next or Volume -**
 - Short press it to play last/next music
 - Long press to increase/decrease volume, indicator stop twinkling at MAX or MIN volume
- ④ **PAUSE/PLAY/VOICE GUIDE**
 - Bluetooth or TF card mode, short press it to pause/play
 - FM/AUX mode, short press to mute/Play
 - TF card mode, Long press to switch folder in TF card
 - FM mode, long press to automatically search stations, indicator twinkles.

-5-

04 Buttons Function

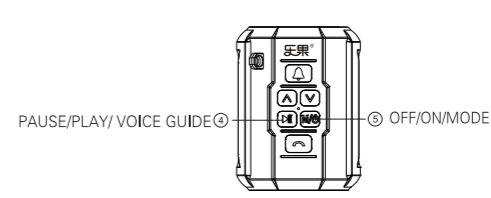

- In AUX mode long press is invalid
- When call in, press it to answer the phone
- Turn it on before connecting the Bluetooth; long press to open/close the voice guide
- ⑤ **OFF/ON/MODE**
 - Press for 2 seconds to turn it on/off, Bluetooth mode default.
 - Short press to change mode among Bluetooth/TF card/FM/AUX
- Remark:**
 - TF card or AUX cable should be inserted into the speaker before change the mode.
 - Press over 8 second to reset speaker.

-6-

04 Buttons Function

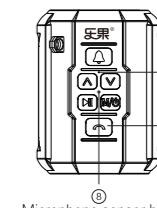

- ⑥ **Answer / refuse coming call:**
 - Bluetooth connected, press to answer coming call in any mode, press again to stop.
 - Bluetooth connected, long press to refuse coming call in any mode
 - Bluetooth connected, double press to callback last call.
 - Bluetooth mode, long press to disconnct
- ⑦ **LED Indicator:**
 - Turn on the speaker: Blue light
 - Bluetooth mode and waiting for connecting: Blue light twinkle
 - Play: Blue light
 - Pause/mute: Blue light twinkle
 - Adjust the volume: during operating, blue light twinkle and stop twinkle when MIN or MAX volume
- ⑧ **Microphone sensor hole**

-7-

05 i Free Controller Function

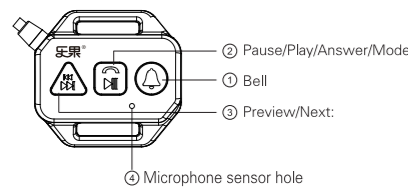

- i Free remote controller function:** Insert the remote controller to the controller port, then you could control the speaker just by the remote controller.
- ① **Bell:** short/long press to ring, double press to switch ring style, Bell ring is prior when press in any mode.
- ② **Pause/Play/Answer/Mode**
 - Bluetooth/TF card mode, short press to pause/play
 - FM mode, short press to mute/play
 - Double press to switch mode in any mode
 - Bluetooth connected, press to answer coming call in any mode, press again to stop.
 - Bluetooth connected, long press to refuse coming call in any mode
 - Bluetooth connected, long press to callback last call.
 - TF card mode, long press to switch folders in TF card
 - FM mode, long press to automatically search stations.
- ③ **Preview/Next:** Short press to next song, long press to previous song
- ④ **Microphone sensor hole**

-8-

06 Interface Function

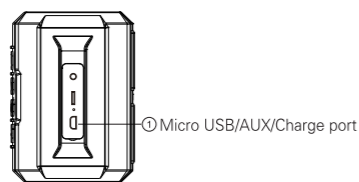

- ① **Micro USB / AUX /Charge port:**
 - Turn speaker off, Transfer data (music files) from the computer to the TF card in speaker.
 - AUX port: connect speaker with a computer by packaged AUX cable to play music in computer.work just fine with any iPod, cellphone or PC.
 - Recharge the battery: connect DC5V~1000mA adaptor or Android cellphone charger or computer USB port.
- Intelligent power saving mode:**
 - 1.Speaker will automatically turn off to save power if not play music or no Bluetooth connected over 10mins
 - 2.When low battery, "beep" sound will appear every minute. Speaker will automatically turn off if without recharge.

-9-

06 Interface Function

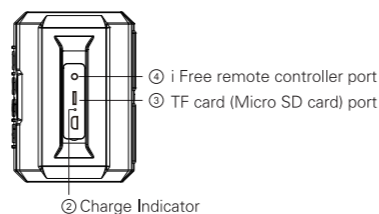

- ② **Charge Indicator:**
 - Red light when charge, light extinguish when battery full.
- ③ **TF card (Micro SD card) port:**
 - TF card plug & play, support MP3/WMA/WAV/APE/FLAC
 - format music file
- ④ **i Free remote controller port:** Insert the remote controller to the port, then you could control the speaker just by the remote controller.

-10-

07 Bluetooth connecting

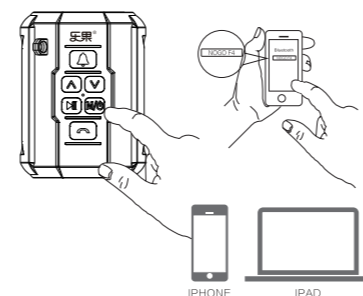

- Turn on the speaker (default Bluetooth mode), blue light twinkle, waiting for connection.
- Find this speaker (NOGO F4) on your hand Bluetooth device.
- Click "NOGO F4" to connect automatically.
- A voice appear when connected, valid distance 30m.
- * Remark:**
 1. If necessary, password: 0000
 2. When restart speaker, automatically connected with last device
 3. Press "M" over 4 seconds to disconnect, blue light twinkle, waiting for connection

-11-

08 Specification

Model No.: F4
 Speaker unit: 1.5" speaker+subwoofer
 Power: 6W
 Bluetooth version: 4.0+EDR
 Play mode: Bluetooth/FM/TF card/AUX
 Memory type: ≤ 32GB TF card
 Music format: APE、FLAC、MP3、WMA、WAV
 Battery : built-in 2600mAh lion battery
 Input: DC5V,1A (Micro USB port)
 Package size: 129mm x 183mm x 73mm
 Speaker size: 93mm x 70.3mm x 67.5mm
 Speaker N.W.:257g
 Speaker with Package G.W.: 620g
 ID Barcode: 694404491125 7

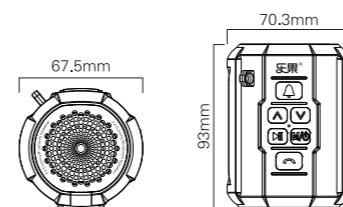

-12-

09 Troubleshooting

TROUBLES	ANSWER
Music Brokenly	Make sure the connecting distance ≤ 10m Make sure there is no barrier between two Bluetooth device Change another Bluetooth device to play the music
No Sound Under AUX	Make sure the cable connected well Make sure change the mode to AUX by press "M" key
No Sound Under TF Card	Make sure the TF card format is FAT32 Make sure the music file format is APE、FLAC、MP3、WMA Or WAV
Button No Function	Turn off the speaker and turn it on in 30 minutes Reset the speaker by pressing RESET key
No Sound	Increase the volume Make sure all connecting ok Make sure the mode is matched
Noise	Check the cables connecting Try different connecting cable Make sure the music source without noise
Recharge Failed	Make sure the USB cable connected well Make sure the adaptor can work Make sure the USB cable can work
Bluetooth Pair Failed	Make sure the speaker is waiting for connecting Restart the speaker and try again

-13-

-14-

FCC Statement

Changes or modifications not expressly approved by the party responsible for compliance could void the user's authority to operate the equipment. This equipment has been tested and found to comply with the limits for a Class B digital device, pursuant to Part 15 of the FCC Rules. These limits are designed to provide reasonable protection against harmful interference in a residential installation. This equipment generates uses and can radiate radio frequency energy and, if not installed and used in accordance with the instructions, may cause harmful interference to radio communications. However, there is no guarantee that interference will not occur in a particular installation. If this equipment does cause harmful interference to radio or television reception, which can be determined by turning the equipment off and on, the user is encouraged to try to correct the interference by one or more of the following measures:

- Reorient or relocate the receiving antenna.
- Increase the separation between the equipment and receiver.
- Connect the equipment into an outlet on a circuit different from that to which the receiver is connected.
- Consult the dealer or an experienced radio/TV technician for help

This device complies with part 15 of the FCC rules. Operation is subject to the following two conditions (1) this device may not cause harmful interference, and (2) this device must accept any interference received, including interference that may cause undesired operation