

NB-230



User Guide

Basic Bluetooth Boom box

Contents

Pls. make sure that all of the contents listed below are found in the box:

- 1 Basic Bluetooth Boom box
- 1 Audio cable(3.5mm plug)
- 1 AC Adaptor
- 1 User guide

Specifications

- Power input: 9V 1.5A
- Power output: 5W x2
- Drivers: 3" full range x2
- S/N: ≥ 75 dB
- THD+N: $\leq 1\%$ (1KHz , Max Power Output)
- Dimension: W340xH130.3xD158.3mm
- Audio input: 1x3.5mm Socket,1xWireless input(Bluetooth)
- Wireless: Bluetooth 2.1(A2DP)

Compatible with A2DP Bluetooth devices

Functionality of the NB-230 is dependent on the device (iPhone, iPod, Mobile Phone, MP3/MP4 Player, PC, Mac, etc.). Devices with A2DP Bluetooth can use the NB-230 to play music and receive calls. Devices without A2DP **cannot** play music through the NB-230; it can only use the NB-230 as a Speaker phone. Other non Bluetooth devices can be connected using the supplied 3.5mm Stereo Line-in cable. Further instructions on Bluetooth connectivity can be found in the user guide for your A2DP Bluetooth device.

Compatibility (Bluetooth device)

Bluetooth 2.1 with A2DP/HFP/HSP

A2DP - Advanced Audio Distribution Profile

HSP - Headset Profile

HFP - HandsFree Profile

Product Overview

Front view

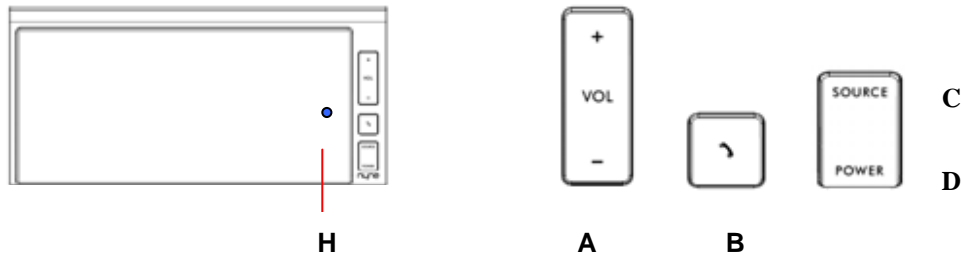

Rear view

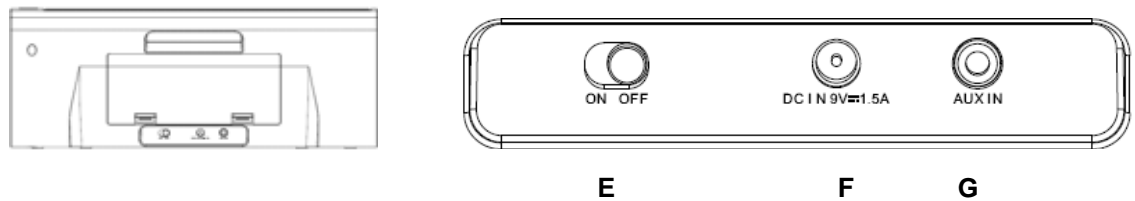

A – Volume Up / Volume Down

B – Answer / Reject Call / Paring

C – Source

D – Power / Standby

E – Power on/off

F – DC in

G – Line in Port

H – Sync LED indicator

Features and Benefits

- Bluetooth 2.1 with NYNE audio and digital signal processing for clean best-in-class wireless stereo sound
- Built-in mic with advanced noise-cancellation enables clear wireless hands-free calling and conferencing
- Two 3inch full range drivers deliver superb music fidelity, powerful and deep bass.
- 6xC batteries for up to 4 hours of playtime
- Connects to iPod or any device with a 3.5 mm headphone port using a mini jack cable (cable not included)
- Auto-search and auto-reconnect with compatible device

Paring the NB-230 with a Bluetooth Device (First time connection)

1. Ensure the NB-230 is connected to a power source or have 6xC batteries.
2. Turn the main power switch located at the back of the NB-230 to the ON position.
3. Press the “Power” button of the NB-230 until the Blue LED is ON.
4. Activate your Bluetooth device to the Searching mode (new device searching)
5. Press and hold the ‘Answer / Reject Call’ button on the front of the NB-230 until the Red/Blue LED starts flashing on front of NB-230. (NB-230 will have 3minutes to connect/pair with your Bluetooth).



6. 'NB-230' will appear on your Bluetooth device.
7. Select 'NB-230' and enter '0000' for the password if necessary.
8. LED on front of the Speaker will stop flashing and a tone will sound to acknowledge successful pairing.
9. Check your Bluetooth device to ensure that connection is successful.

Note: If after 3minutes no connection is made the speaker will sound and the LED will turn OFF.

Basic Operation of NB-230

Volume Up – Press **VOL+** at the front of the NB-230.

Volume Down – Press **VOL-** at the front of the NB-230.

Source – Change audio source between Bluetooth and Aux in.

Power on – Press (Once) **POWER** at the front of the NB-230.

Power off – Press & Hold (3 Seconds) **POWER** at the front of the NB-230.

Operation of NB-230 as a Speaker phone (Device Dependant)

1. To answer a call – Press **↶▶||** at the front of the NB-230.
2. To Reject a call – Press & Hold (3 Seconds) **↶▶||** at the front of the NB-230.
3. To hang up a call – During a Call Press & Hold (3 Seconds) **↶▶||** at the front of the NB-230.
4. To switch a call between speaker and Mobile Phone – Press (Once) **↶▶||** at the front of the NB-230.
5. To Redial Last Calling number - Press & Hold (3 Seconds) **↶▶||** at the front of the NB-230.

LED Status

Power OFF – LED OFF

Power ON – LED ON (Blue or Red)

Pairing Mode – LED Flashing Blue/Red

Low Battery Level – LED Flashing (Red)

Adjust the Vol to Max or Min – LED Flashing (once) (Red)

Switch audio source – LED Flashing (Twice) (Blue)

Set up of Aux In

The NB-230 also offers the ability to allow other portable audio devices such as iPod shuffle, MP3, Mini Disc and Portable CD Players to be connected for use as a speaker system.

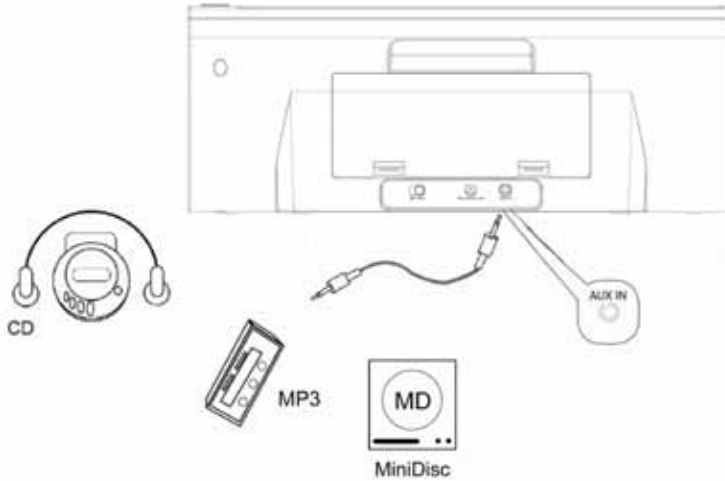

1. Plug in the line in cable into the rear of the NB-230 Aux in socket.
2. Connect the other end of the line in cable to your devices headphone socket.
3. Set your device volume level to maximum and press play on your device.

Trouble Shooting

Problem	What Should I do?
Music cannot be heard through the Speaker	Ensure the Bluetooth device supports A2DP
	Check the device and Speaker are connected
Speaker does not power up	Ensure the Power Switch at the back of the speaker is switched ON
	Ensure the Speaker is fully charged or you have the speaker to power source
Sound is distorting	Adjust the volume lower on the speaker or the Bluetooth device
Cannot answer calls	Ensure your mobile phone supports HSP/HFP
	Check the mobile phone and Speaker are connected
Music does not resume after hanging up a call	Press Play to resume music
I cannot find my 'NB-230' on my Bluetooth device	Ensure you have paired the speaker correctly with your Bluetooth device (Pairing the NB-230 with a Bluetooth Device (First time connection))
	Ensure your NB-230 is not already connected to another device, the Bluetooth Speaker can only connect to 1 device at any 1 time.
	Ensure you have turned on your Bluetooth on your device

IMPORTANT SAFETY INSTRUCTIONS



DANGEROUS VOLTAGE: The lightning flash with arrowhead symbol, within an equilateral triangle is intended to alert the user to the presence of uninsulated dangerous voltage within the product's enclosure that may be of sufficient magnitude to constitute a risk of electric shock to persons.



ATTENTION: The exclamation point within an equilateral triangle is intended to alert the user to the presence of important operating and maintenance (servicing) instructions in the literature accompanying the appliance.

FCC WARNING:

This device complies with Part 15 of the FCC Rules. Operation is subject to the following two conditions: (1) this device may not cause harmful interference, and (2) this device must accept any interference received, including interference that may cause undesired operation.

NOTE: changes or modifications not expressly approved by the party responsible for compliance could void the user's authority to operate the equipment.

This equipment has been tested and found to comply with the limits for a Class B digital device, pursuant to Part 15 of the FCC Rules. These limits are designed to provide reasonable protection against harmful interference in a residential installation. This equipment generates, uses and can radiate radio frequency energy and, if not installed and used in accordance with the instructions, may cause harmful interference to radio communications. However, there is no guarantee that interference will not occur in a particular installation. If this equipment does cause harmful interference to radio or television reception, which can be determined by turning the equipment off and on, the user is encouraged to try to correct the interference by one or more of the following measures:

- Reorient or relocate the receiving antenna.
- Increase the separation between the equipment and receiver.
- Connect the equipment into an outlet on a circuit different from that to which the receiver is connected.
- Consult the dealer or an experienced radio/TV technician for help.

FCC RF warning statement: The device has been evaluated to meet general RF exposure requirement. The device can be used in portable exposure condition without restriction.

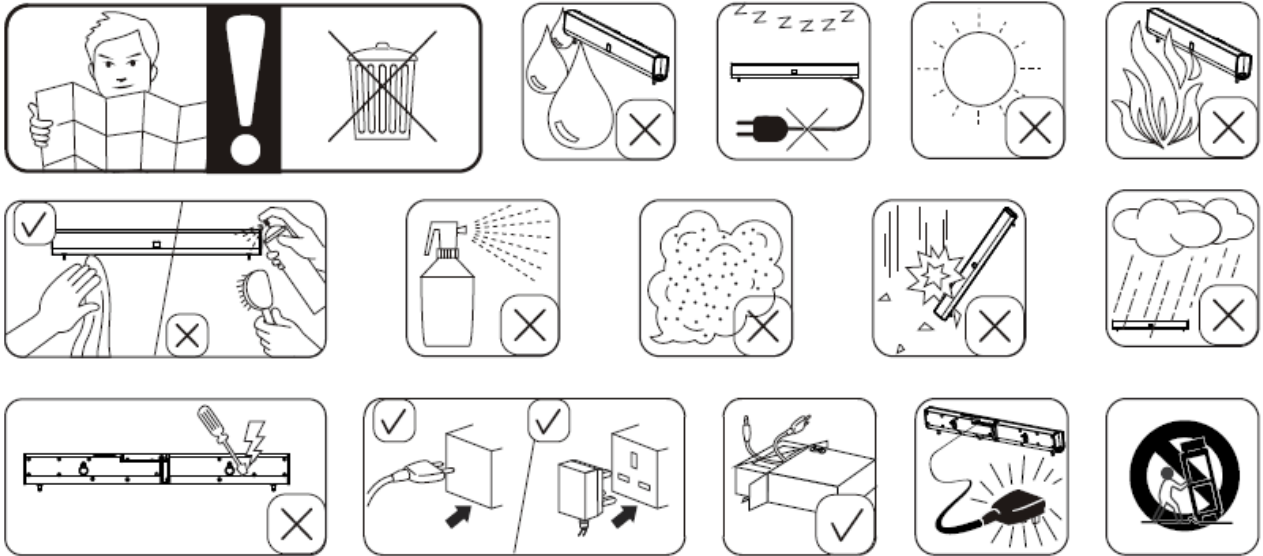

THIS DOCUMENT IS NOT FOR EXTERNAL DISTRIBUTION.
STRICTLY FOR INTERNAL USE ONLY.