

CUBE Card reader MK170W / MK170B

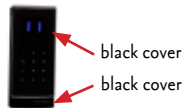

9205454 CUBE Card reader MK170W



9206167 CUBE Card reader MK170B

Note : Always disconnect the supply voltage before you install or modify the connection. Use an ESD-bracelet during the instalment. Cube products contain components which are sensitive to electrostatic discharge.

01

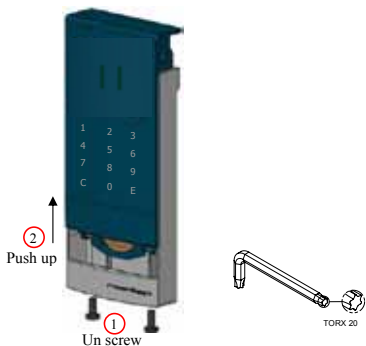

02

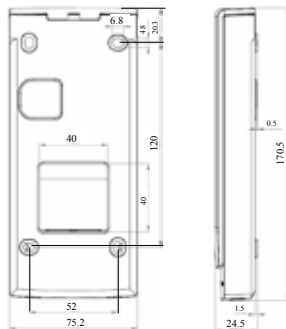

03

wall-mounting

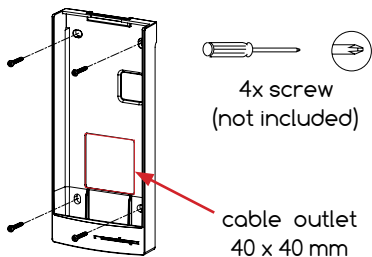

04

cable specifications :

RS485 - 2 x 2 x 0.25mm²
shielded.

 retail GROENLO - HOLLAND

DRW: CB 2012/07/05

CHK:

DESCRIPTION:

CUBE CARD READER MK170W / MK170B | art no. 9205454 - 9206167

DOC. ARTICLE NO: 5279216

REV. : C

Copyright © by N.V. Nederlandsche Apparatenfabriek NEDAP. No part of this drawing may be reproduced or distributed in any form or by any means, or stored in a database or retrieval system without the prior written permission of NEDAP.

SHEET: 45.01 OF 1

DRAWING: T5279-216

05 connect Card reader to the CUBE Core or CUBE Access Plus

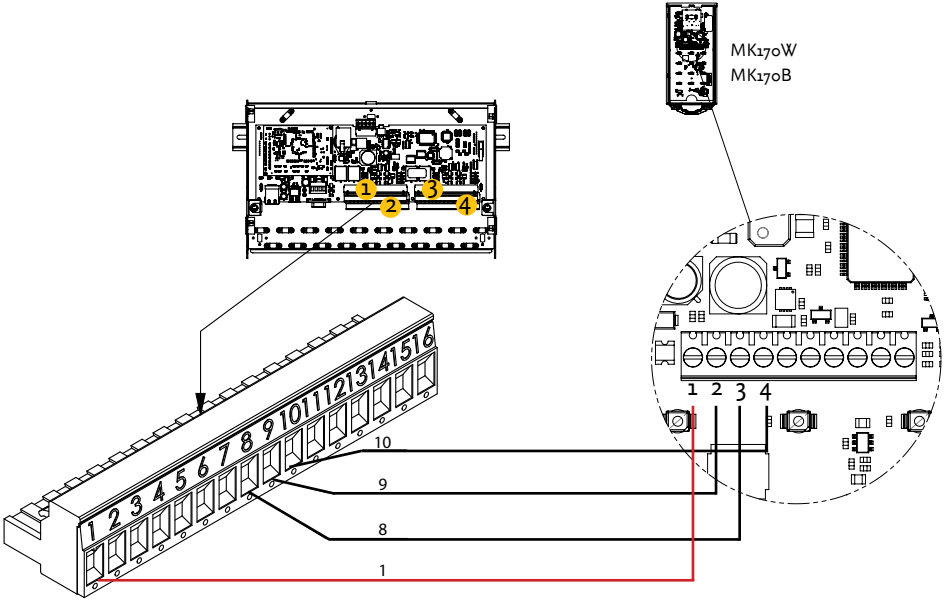

Cable shield must be connected to Power GND of CUBE Card-reader (A2) and GND of external device (metal case)

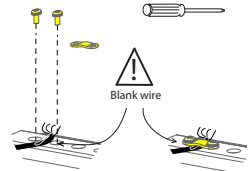

FCC ID: CGDINVEXS170

and

IC: 1444A-INVEXS170

Compliance statements (part15.19)

This device complies with part 15 of the FCC Rules and to RSS210 of Industry Canada.

Operation is subject to the following two conditions:

- (1) this device may not cause harmful interference, and
- (2) this device must accept any interference received, including interference that may cause undesired operation.

Cet appareil se conforme aux normes RSS210 exemptés de license du Industry Canada. L'opération est soumis aux deux conditions suivantes:

- (1) cet appareil ne doit causer aucune interférence, et
- (2) cet appareil doit accepter n'importe quelle interférence, y inclus interférence qui peut causer une opération non pas voulu de cet appareil.

Warning (part15.21)

Changes or modifications not expressly approved by party responsible for compliance could void the user's authority to operate the equipment.