

FCC Warning:

This equipment has been tested and found to comply with the limits for a Class B digital device, pursuant to part 15 of the FCC Rules. These limits are designed to provide reasonable protection against harmful interference in a residential installation. This equipment generates, uses and can radiate radio frequency energy and, if not installed and used in accordance with the instructions, may cause harmful interference to radio communications. However, there is no guarantee that interference will not occur in a particular installation. If this equipment does cause harmful interference to radio or television reception, which can be determined by turning the equipment off and on, the user is encouraged to try to correct the interference by one or more of the following measures:

- Reorient or relocate the receiving antenna.
- Increase the separation between the equipment and receiver.
- Connect the equipment into an outlet on a circuit different from that to which the receiver is connected.
- Consult the dealer or an experienced radio/TV technician for help.

Caution: Any changes or modifications to this device not explicitly approved by manufacturer could void your authority to operate this equipment.

This device complies with part 15 of the FCC Rules. Operation is subject to the following two conditions: (1) This device may not cause harmful interference, and (2) this device must accept any interference received, including interference that may cause undesired operation.

The device has been evaluated to meet general RF exposure requirement. The device can be used in portable exposure condition without restriction.

NEEWER[®]

Q Compact 2.4G trigger

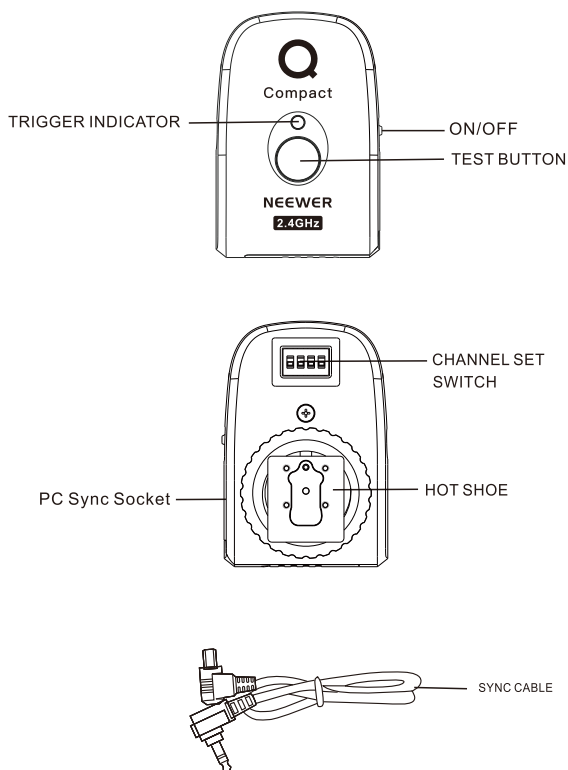

Q Compact 2.4G trigger

The remote control single contact standard hot shoe only supports manual flash trigger

Note: The flash is adjusted to slave mode (while the ID setting is off), the flash and Q Compact trigger set the same channel to trigger the flash

The code matching diagram of the built-in receiver of the flash and the external Q Compact 2.4G trigger is as follows:

Channel number	Flash channel	Trigger corresponding dial code
1	CH 1	1 2 3 4
2	CH 2	
3	CH 3	
4	CH 4	
5	CH 5	
6	CH 6	
7	CH 7	
8	CH 8	
9	CH 9	
10	CH 10	
11	CH 11	
12	CH 12	
13	CH 13	
14	CH 14	
15	CH 15	
16	CH 16	