

For more detailed user's guide,  
Please visit [www.netviewtech.com](http://www.netviewtech.com)  
Version 1.0  
2016 Netview Technologies (Shenzhen) Co. Ltd  
All rights reserved

**VueBell®**  
Internet Video Doorbell  
**QUICK START GUIDE**



App Store



Android

## FCC STATEMENT:

This device complies with Part 15 of the FCC Rules. Operation is subject to the following two conditions:

- (1) This device may not cause harmful interference, and
- (2) This device must accept any interference received, including interference that may cause undesired operation.

**Warning:** Changes or modifications not expressly approved by the party responsible for compliance could void the user's authority to operate the equipment.

NOTE: This equipment has been tested and found to comply with the limits for a Class B digital device, pursuant to Part 15 of the FCC Rules. These limits are designed to provide reasonable protection against harmful interference in a residential installation. This equipment generates uses and can radiate radio frequency energy and, if not installed and used in accordance with the instructions, may cause harmful interference to radio communications. However, there is no guarantee that interference will not occur in a particular installation. If this equipment does cause harmful interference to radio or television reception, which can be determined by turning the equipment off and on, the user is encouraged to try to correct the interference by one or more of the following measures:

- Reorient or relocate the receiving antenna.
- Increase the separation between the equipment and receiver.
- Connect the equipment into an outlet on a circuit different from that to which the receiver is connected.
- Consult the dealer or an experienced radio/TV technician for help.

## FCC Radiation Exposure Statement

The device has been evaluated to meet general RF exposure requirement. The device can be used in portable exposure condition without restriction.

## FCC (USA) 15.9 prohibition against eavesdropping

Except for the operations of law enforcement officers conducted under lawful authority, no person shall use, either directly or indirectly, a device operated purpose of overhearing or recording the private conversations of other unless such use is authorized by all of the parties engaging in the conversation.

## How to use VueBell?

The VueBell Outdoor Unit will remain lightless if no one approaches. The PIR sensor will automatically activate the outdoor unit. A bell pattern with lighting around will be visible when someone comes close enough (within 3 meter). It will also activate the camera and allows it to take photos. Only if when PIR sensor and motion detection sensor detects movements, it will trigger the VueBell Outdoor unit to take snapshots. Photos will be saved on cloud storage for user's reference. At the same time, user will receive a notification on their device which can lead them directly to the photos.

Once the visitor see the bell-shaped touch button and touch it to ring the bell, it will send a signal to the Receiver which will sound. The touch on the screen also triggers the camera to take a photo and send it to the user. User will receive a notification on their device with option to live chat with the visitor through VueBell. User will also be able to unlock the door through VueBell application (if applicable)

## APP Set-up

Download VueBell APP from APP store or Google play market.



## Packing list

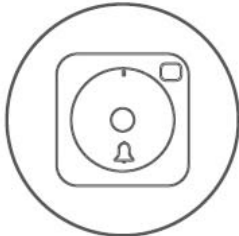

1. outdoor unit

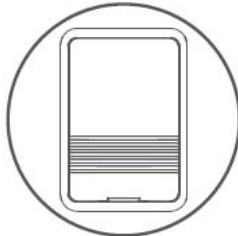

2. indoor receiver



3. accessories

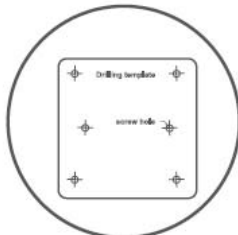

4. location label



5. quick star guide

## Names for parts

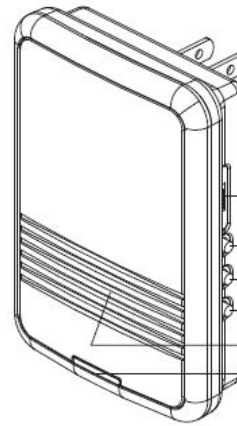

- Sound-and-Flash Switch
- Volume Button
- Melody Selector
- Auto-learning Code Button
- Speaker
- LED Indicator

Receiver front side

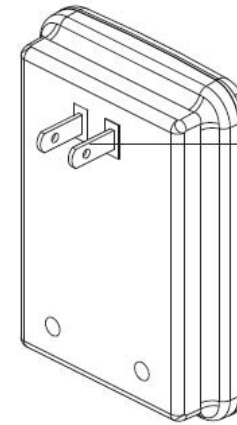

- Plug

Receiver back side

**Outdoor unit front side**

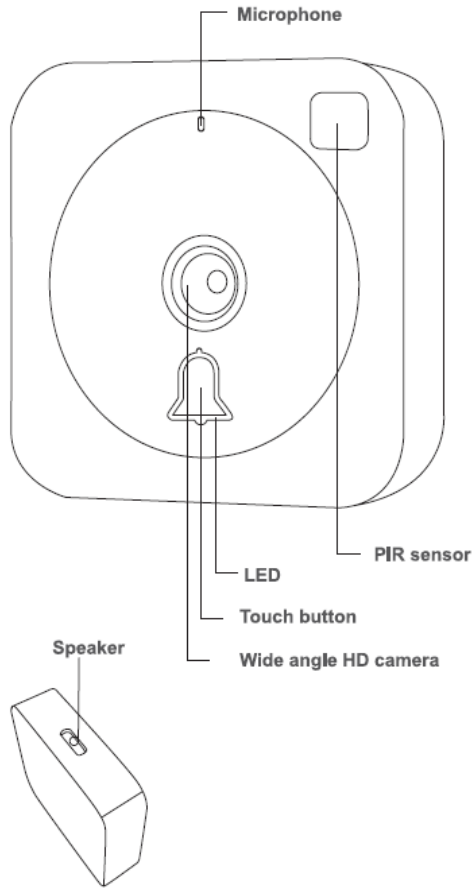

05

**Outdoor unit back cover**

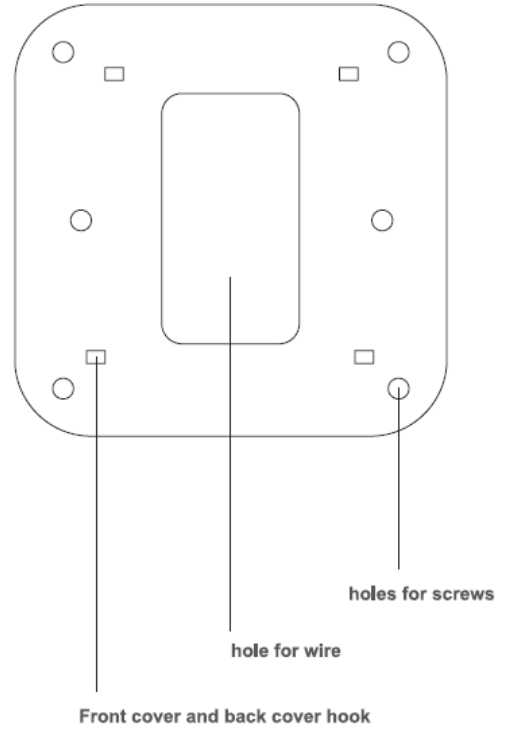

06

### Outdoor unit front cover

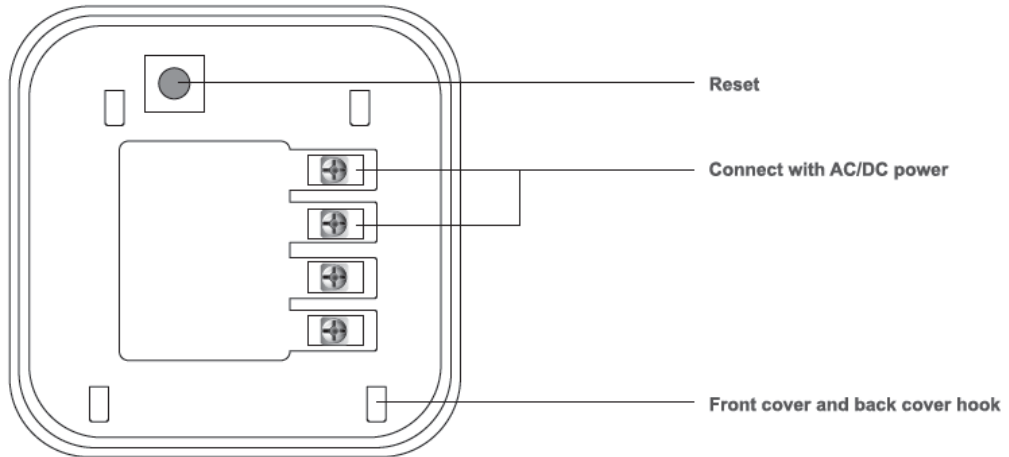

### Notes before Installation

1. Before installation and operation, you will require a drill, a cross-headed screwdriver, a flat head screwdriver, fixing screws and wall plugs. All of these are not supplied with this kit.
2. Avoid the Transmitter positioning on Metal Frames.
3. Avoid positioning above heat sources such as radiators, or in damp areas such as a kitchen or bathroom.
4. The range of operating voltage and the Maximum power : AC8~24V, DC9~36V
5. Please let the lens stay out of the sun when installation.

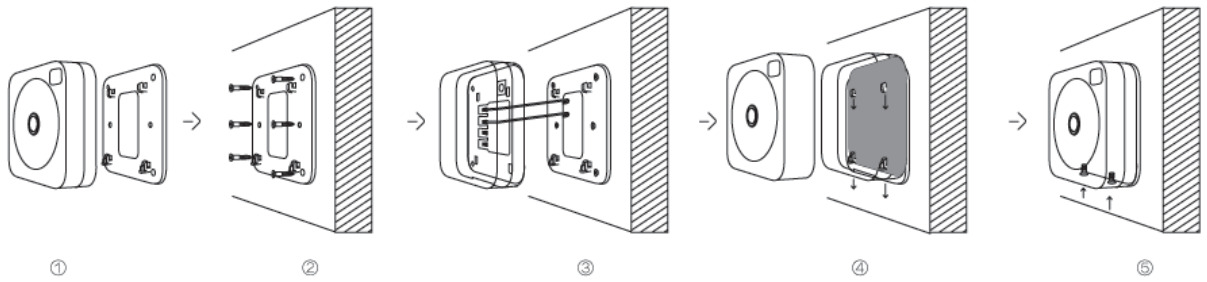

## Installation Procedures

1. Turn off the power at the circuit breaker or fuse box (typically installed on the wall near the front/back door)

-Remove all security screws from the old Receiver, then disable your old Receiver, then you will find the power wire on wall.

-Twist the metal part of the power wires together, then we don't need this old chime device anymore.

-Plug VueBell Indoor Receiver into the AC power.

2. Disable your old bell button and replace it with your new VueBell Outdoor Unit.

-Remove all security screws from the old bell button, Keep the AC/DC power wires and discard the old bell button.

-Stick the location label on the area where you choose to install the VueBell Outdoor unit, punching the screws on the location, then get rid of the label.

-Put the Outdoor unit back cover on wall, AC/DC power wire through the wire hole, then install the screws.(step

①and②)

-Drive each of the two wires to one of the top two screws(which marked "AC/DC Power" on the backside) on the VueBell Outdoor unit front cover. Make sure the metal wires are directly touching the screws. The order does not matter. Tighten the security screws. The bell pattern will be lighting.(step③)

-Hook them up, the outdoor unit front cover and the outdoor unit back cover.(step④)

-Install the security screws.(step⑤)

-Wait 40 seconds for the VueBell system to be ready.

In the case which you have two old bell buttons (one for the front door and one for the back door), follow the same procedures and disregard the second bell button.

In the case which you have two bell buttons and would like to install a second VueBell, simply repeat step 3 for installation of the second VueBell.

## Indoor receiver configuration

The Indoor Receiver is equipped with auto-learning operation code\* ability.

### 1. Operation for 1 Outdoor unit and 1 Indoor Receiver

After the installation of Outdoor unit and plugging the Indoor Receiver into the AC power, press the Auto-learning Code Button on Indoor Receiver, then press the Outdoor unit once to generate a new operation code. The Indoor Receiver will sound, which indicates that a new operation code is registered and memorized.

### 2. Operation for the 2nd / 3rd / 4th / 5th Indoor Receiver and the Outdoor Unit:

(a) Power-off the Outdoor unit, and the 2nd Indoor Receiver is ready for the new code registration.

(b) Press once the auto-learning code button on the Indoor Receiver and it will be ready to receive signal sent from the same Outdoor Unit, Press the touch button

of the Outdoor Unit, the Indoor Receiver will sound to indicate that new operation code is registered and memorized. Thus the Outdoor Unit works successfully with the 2nd Indoor Receiver. For the 3rd, 4th, and 5th Indoor receiver, please operate in the same way to work with the Outdoor unit.

### 3. Interference from another Indoor Receiver operating nearby (For example, Indoor Receiver sounds for no reason):

Unplug the Indoor Receiver from the AC power and rest for 30 seconds, and this will erase the memory.

Plug the Indoor Receiver into the AC power again, and then the Outdoor unit and the Indoor Receiver are ready for the new code registration.

## auto-learning operation code

The Transmitter sends wireless signal to the Receiver. The Receiver would automatically register and memorize the signal as an operation code. So the Transmitter can work with the Receiver by this code.

## VueBell APP introduction



①

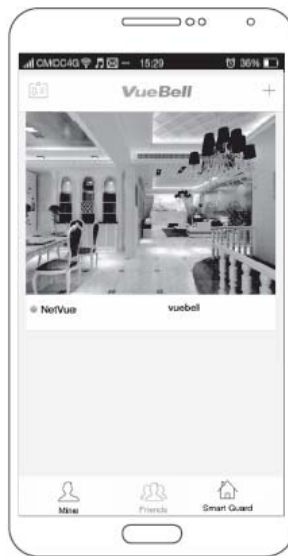

②



③

①

Mine:  
All VueBells listed in this account.

②

Friends:  
The VueBells which your friends shared with you

③

Smart Guard:  
The snapshots of this function under events' list



## Add outdoor unit in VueBell account



1  
Registration and log in



2  
Press + to add VueBell

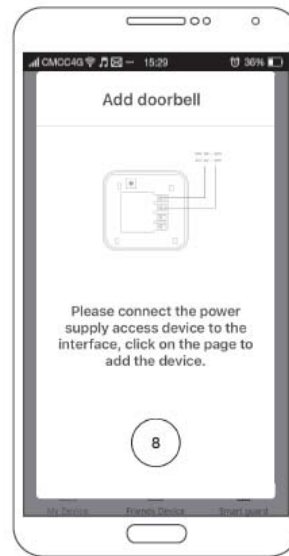

3  
.Connect VueBell with AC DC power



4  
Make sure all the devices in the same network



5  
Get into WiFi



6  
Press RESET button to reset the VueBell

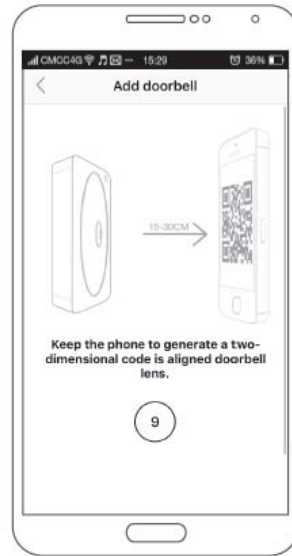

7  
Show you how to scan the QR code



8  
Create a QR code

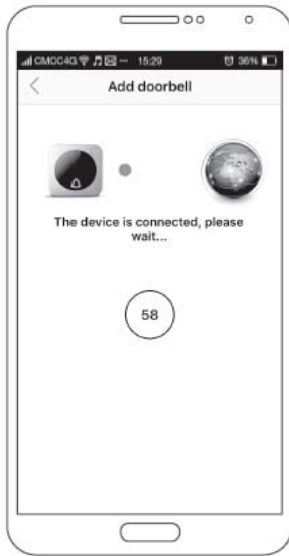

9

Wait for the VueBell to connect with network

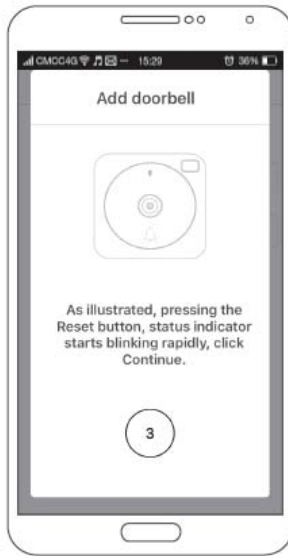

10

Press RESET button to reset the VueBell

## Status on Indicator light

1. Will constantly in blue light when power on.
2. Lights out for 30s after driver loaded successfully.
3. Blue light will flashing quickly after touch the RESET button.
4. Blue light will flashing in slow speed after device connecting with WiFi.
5. Blue light will constantly on after device get in touch with the server successfully, will lights out after 15s
6. BLN mode with blue light will be on when PIR triggering.
7. BLN mode with blue light will be on when triggered the touch button, lights off after 75s.
8. Means abnormal network connection when indicator light turns white.

## **Important**

1. Receiver is designed for indoor use only.
2. Do not mount the Transmitter onto any metal surface or UPVC doorframes, as this will reduce the operation range.
3. Do not expose either unit directly to rain or immerse in water.
4. Do not mount either unit close to fireplace or expose to high temperature.

## **Disclaimer and Waiver of Liability**

Once users have successfully installed and enabled corresponding features, users are considered to understand and acknowledge all functions (includes but not restricted to camera, audio, and live video). NetView Technologies (Shenzhen) Co., Ltd is not responsible of any legal disputes related to information recorded and/or stored by its products.