



# Quick Start Guide



## Outdoor Orbi Overview

Before placing your Orbi outdoors, sync your Orbi indoors in an area near your Orbi router. You can move your Orbi outdoors after it syncs with your router.

You can place the Orbi on a flat surface using the stand, or you can wall-mount it. For information about attaching the Orbi to a stand or wall-mounting it, see the other side of this document.



- 1 Top LED
- 2 Bottom LED
- 3 LED On/Off button
- 4 WPS On/Off button
- 5 Reset button
- 6 Power LED
- 7 Power On/Off button
- 8 DC Power connector

## Manually Sync Your Outdoor Orbi With Your Orbi Router

1. Place your Orbi indoors in an area near your Orbi router.  
You can move your Orbi outdoors after it syncs with your router.
2. Connect your Orbi to a power source.  
The Power LED on the back of the Orbi lights. If the Power LED does not light, press the **Power On/Off** button.
3. Press the **WPS On/Off** button on the back of your Outdoor Orbi, and within two minutes, press the **Sync** button on the back of your router.  
The Orbi router's bottom LED turns off after the setup is complete.

## Outdoor Orbi Sync LED Colors

The bottom LED on the Outdoor Orbi lights white while it attempts to sync with your Orbi router. After the bottom LED lights white, it lights one of the following colors for about three minutes and then turns off:

- **Blue**  
The connection between the Outdoor Orbi and Orbi router is good.
- **Amber**  
The connection between the Outdoor Orbi and Orbi router is fair. Consider moving the Orbi closer to the Orbi router.
- **Magenta**  
The Outdoor Orbi was unable to connect to the Orbi router. Move the Outdoor Orbi closer to the Orbi router.

## Package Contents



Outdoor Orbi  
(Model RBS50Y)



Power adapter  
(varies by region)



Mounting plate

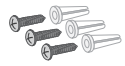

Wall bracket  
screws



Stand

## Wall-Mounting

1. Attach the mounting plate to the wall using the screws.

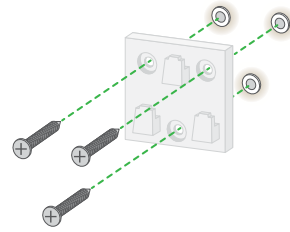

2. Slide the Orbi over the mounting plate.

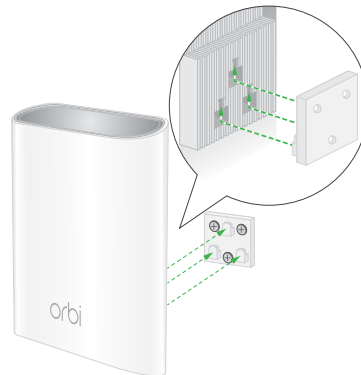

## Attach to Stand

1. Attach the mounting plate to the stand using the screws.

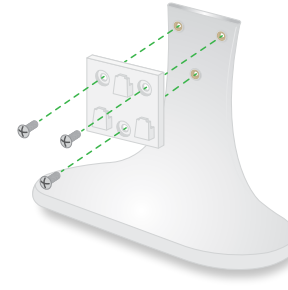

2. Slide the Orbi over the mounting plate.

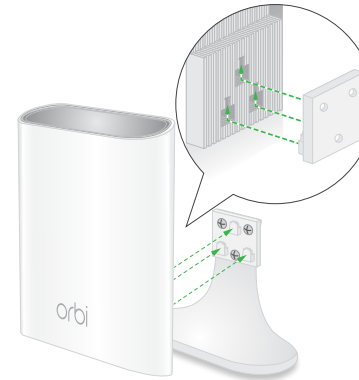

## Support

Thank you for purchasing this NETGEAR product. You can visit [www.netgear.com/support](http://www.netgear.com/support) to register your product, get help, access the latest downloads and user manuals, and join our community. We recommend that you use only official NETGEAR support resources.

Si ce produit est vendu au Canada, vous pouvez accéder à ce document en français canadien à <http://downloadcenter.netgear.com/other/>.

(If this product is sold in Canada, you can access this document in Canadian French at <http://downloadcenter.netgear.com/other/>.)

For the current EU Declaration of Conformity, visit <http://kb.netgear.com/11621>.

For regulatory compliance information, visit <http://www.netgear.com/about/regulatory/>.

See the regulatory compliance document before connecting the power supply.

**NETGEAR, Inc.**  
350 East Plumeria Drive  
San Jose, CA 95134, USA

**CE** **NETGEAR INTL LTD**  
Building 3, University Technology Centre  
Curraheen Road, Cork, Ireland

© NETGEAR, Inc., NETGEAR and the NETGEAR Logo are trademarks of NETGEAR, Inc. Any non-NETGEAR trademarks are used for reference purposes only.