

N300 Wireless USB Adapter WNA3100

Package Contents

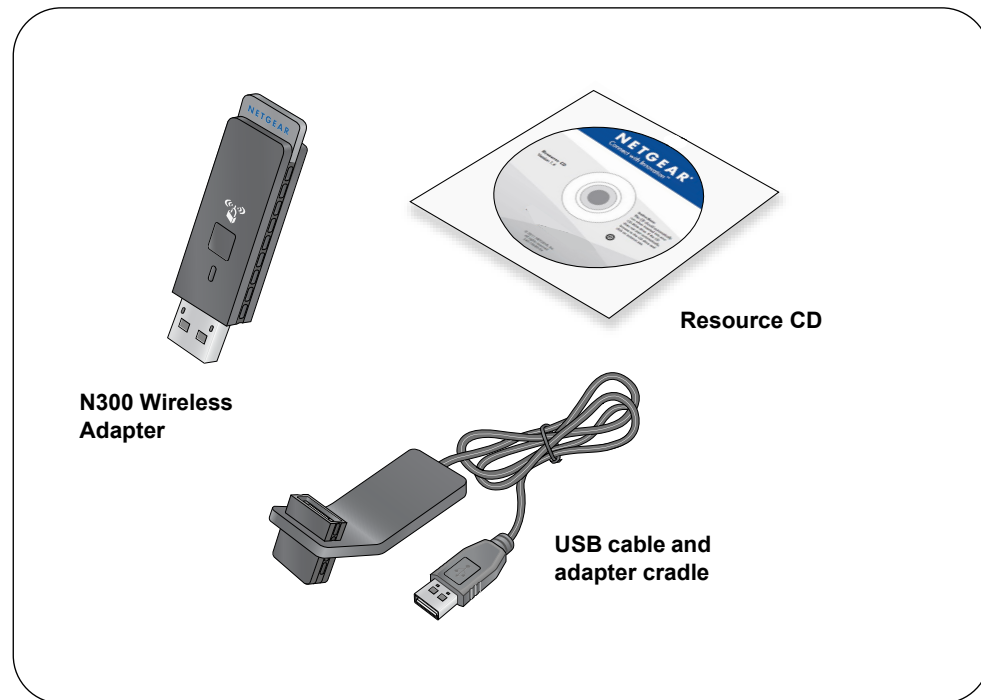

Installation

1. Insert the resource CD into your computer CD drive to install the NETGEAR genie software. If the CD main screen does not display, browse the files on the CD and double-click **Autorun.exe**.
2. Click **Setup**.
The Software Update Check screen displays.
3. If you are connected to the Internet, click **Check for Updates**. If you are not connected, click **Install from CD**.
4. Click **I agree** to accept the license agreement, and then click **Next**.

A message displays asking you to wait while software is installed (installation might take a few minutes). Then you are prompted to insert your adapter.



5. Either insert the adapter into a USB port on your computer or use the USB cable and adapter cradle provided to connect the adapter.
The USB cable and adapter cradle can extend the range of your adapter and improve wireless reception. Insert the adapter in the cradle and attach the USB cable to the computer.
6. Click **Next**.

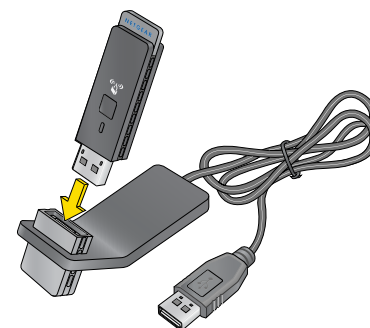

7. NETGEAR genie displays a list of wireless networks in your area.



Join a Wireless Network

You can join a wireless network from this NETGEAR genie screen, or you can use Wi-Fi Protected Setup (WPS) if your wireless network supports it.

- **NETGEAR genie:** Click your wireless network to select it from the list and click **Connect**. If the network is secure, enter its password or network key.
- **WPS:** Press and hold the **WPS** button on the side of the adapter for 2 seconds. Within 2 minutes, press the **WPS** button on your wireless router or gateway.



The adapter joins the network, which can take a few minutes. Your settings are saved in a profile.

Check Connection Status

When you install your adapter, the NETGEAR genie icon displays in the Windows system tray and on the desktop.

You can double-click this icon to open NETGEAR genie to make changes or connect to a different wireless network. The color of the icon indicates the strength of your wireless connection:



Green: 3–5 bars (strong connection)



Yellow: 1–2 bars (weak connection)



Red: 0 (zero) bars (no connection)

If you remove your adapter, NETGEAR genie is not available, and the icon does not display. If you insert the adapter again, the icon returns.

Technical Support

After installing your device, locate the serial number on the label of your product and use it to register your product at <https://my.netgear.com>.

You must register your product before you can use NETGEAR telephone support. NETGEAR recommends registering your product through the NETGEAR web site. For product updates and web support, visit <http://support.netgear.com>.

You can get the user manual online at <http://downloadcenter.netgear.com> or through a link in the product's user interface.



201-16151-01



September 2012

For the complete EU Declaration of Conformity, visit
http://support.netgear.com/app/answers/detail/a_id/11621/.

For indoor use only in all EU countries and Switzerland.



This symbol appears in accordance with the European Union Directive 2002/96 on the Waste Electrical and Electronic Equipment (the WEEE Directive). If you dispose of this product in the European Union, treat and recycle it in accordance with your jurisdiction's laws that implement the WEEE Directive.

NETGEAR, the NETGEAR logo, and Connect with Innovation are trademarks or registered trademarks of NETGEAR, Inc. and/or its subsidiaries in the United States and/or other countries. Information is subject to change without notice. Other brand and product names are trademarks or registered trademarks of their respective holders. ©NETGEAR, Inc. All rights reserved.