

Quick Start Guide



Questions? Get answers 24/7 at NexDock.com/support.

Get to Know Your NexDock

What's in the Box:

- NexDock
- 18W USB-C PD Charger
- 180 cm USB-C charging cable
- 50 cm USB-C smartphone cable (Gen2 USB-C 3.1)
- USB-C to USB-A Adapter
- 100 cm mini HDMI to HDMI cable
- Quick Start Guide

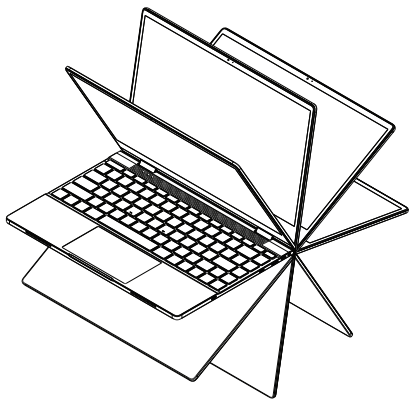

Ports on NexDock:

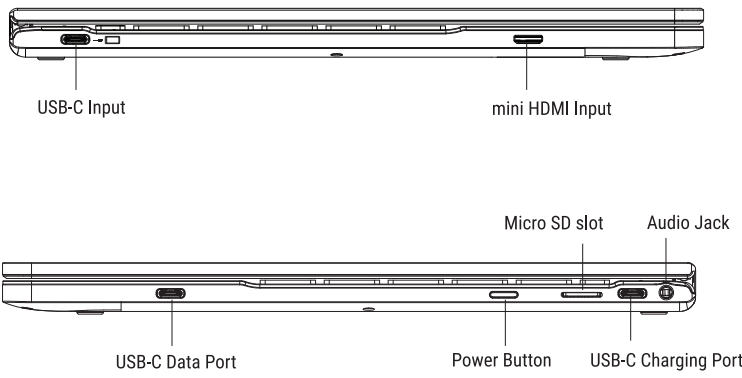

Quick Start Guide for Smartphones

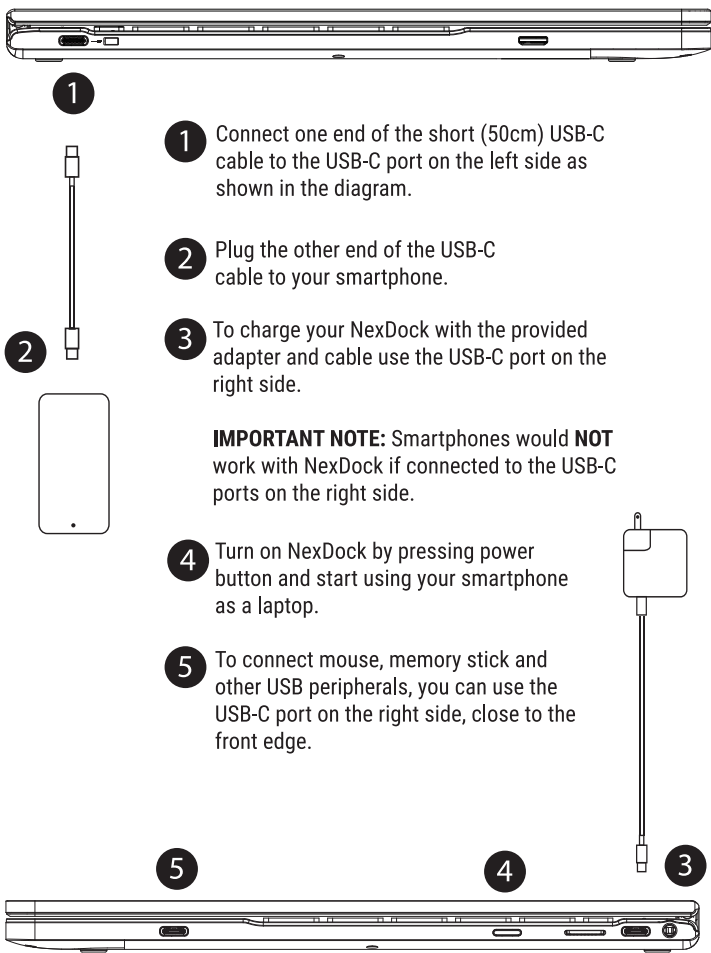

Wireless Connection Guide for Smartphones

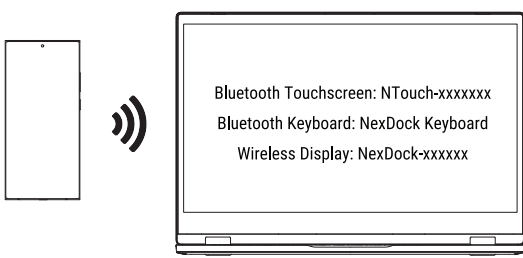

- 1 Turn on your NexDock and wait for "NexDock is ready to connect" screen.
- 2 Open Settings/Connections/Bluetooth on your smartphone.

Click "Scan" and pair to "NexDock Keyboard". For touchscreen connection, pair to "NTouch-xxxxxx" where xxxxxx can be random characters such as NTouch-a1DF168.

- 3 For Samsung phones, pull down the notification bar and tap on DeX in the Quick Settings panel. Alternatively, open "Settings/Advanced Features" and enable "Samsung DeX".

Choose "DeX on TV or Monitor" and "Connect wirelessly". When you see "NexDock-XXXXX" click "Start Now".

NOTE 1: If you are using a non-Samsung phone, search for "Cast" or "Screen Sharing" or "Wireless Display" in Settings and follow the instructions on your phone. For Motorola phones that support "Ready For" go to "Settings/Connected Devices/Ready For" and follow the instructions.

NOTE 2: You can disconnect bluetooth keyboard any time by pressing FN+C keys on NexDock. To disconnect bluetooth touchscreen you need to unpair NTouch-xxxxxx from your smartphone's bluetooth settings.

FCC Caution :  
This device complies with part 15 of the FCC Rules. Operation is subject to the following two conditions: (1) This device may not cause harmful interference, and (2) this device must accept any interference received, including interference that may cause undesired operation.

Any Changes or modifications not expressly approved by the party responsible for compliance could void the user's authority to operate the equipment.

Note: This equipment has been tested and found to comply with the limits for a Class B digital device, pursuant to part 15 of the FCC Rules. These limits are designed to provide reasonable protection against harmful interference in a residential installation. This equipment generates uses and can radiate radio frequency energy and, if not installed and used in accordance with the instructions, may cause harmful interference to radio communications. However, there is no guarantee that interference will not occur in a particular installation. If this equipment does cause harmful interference to radio or television reception, which can be determined by turning the equipment off and on, the user is encouraged to try to correct the interference by one or more of the following measures:

- Reorient or relocate the receiving antenna.
  - Increase the separation between the equipment and receiver.
  - Connect the equipment into an outlet on a circuit different from that to which the receiver is connected.
  - Consult the dealer or an experienced radio/TV technician for help.
- The device has been evaluated to meet general RF exposure requirement. The device can be used in portable exposure condition without restriction.

Connecting other devices

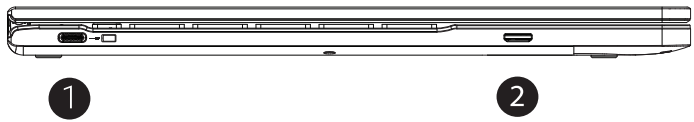

1 USB-C Input

Multiple devices can be connected to NexDock's display, keyboard & touchpad via USB-C cable. This cable can power your device (up to 5V1A) and connect to the other ports on the right side. The devices you can use with USB-C input port are:

- USB-C smartphones with video output
- USB-C Macbooks, USB-C iPads
- USB-C Laptops, Chromebooks
- Nintendo Switch, Steam Deck

2 HDMI Input

The devices you can use with HDMI input are:

- PCs, Laptops, Servers
- Game consoles such as Play Station, Xbox
- TV Sticks, Chromecast and any other device with HDMI out

When a device is connected via HDMI, a secondary USB cable is required to connect to keyboard, touchpad and touchscreen. Raspberry Pi 4 can also be connected via USB-C by adding a line of code to config.txt. Please check NexDock.com/support to learn more.

When a device is connected only through HDMI, you can still control volume, brightness and more settings via OSD Control panel on the touch screen (see next page).

On Screen Display (OSD) Control Panel

OSD control panel lets you adjust the volume, screen brightness, contrast, sharpness, color temperature of the display and more!

To open the OSD control panel swipe down with 2 fingers at lower right corner of the touch screen as shown.

You can also disable smartphone charging, lock screen rotation and check battery charge level of NexDock using OSD control panel.

The settings available on the OSD control panel are:

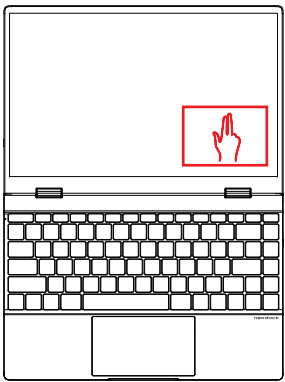

- 1 Volume
- 2 Backlight Brightness
- 3 Sharpness
- 4 Display brightness
- 5 Type C input
- 6 HDMI input
- 7 Wireless Screen Casting
- 8 Smartphone charging ON
- 9 Smartphone charging OFF
- 10 Rotate On/off
- 11 OSD Previous Page
- 12 OSD Next Page
- 13 Exit OSD Panel
- 14 HDR on/off
- 15 Reset
- 16 Information
- 17 Color Temperature (Only in USER mode)

Keyboard Function Keys

Function keys on the keyboard works only when a device is connected via USB-C input or bluetooth and when NexDock is not working in tablet mode.

To use alternate commands hold down Fn and press the Function key at the same time.

The function keys on NexDock are:

- Fn + F1 Switch between the open apps
- Fn + F2 Check battery charge level of NexDock
- Fn + F3 Mute
- Fn + F4 Volume Down
- Fn + F5 Volume Up
- Fn + F6 Brightness Down
- Fn + F7 Brightness Up
- Fn + F8 Previous Track
- Fn + F9 Play/Pause Media
- Fn + F10 Next Track
- Fn + F11 Turn On/Off Keyboard Backlit
- Fn + F12 Take Screenshot
- Fn + C Disconnect bluetooth keyboard

For more technical support, troubleshooting please visit NexDock.com/support.

SAFETY NOTICE  
1. Do not store NexDock in extreme hot, cold, dusty, dry, or humid environment.  
2. Handle NexDock with care. The device can be damaged if dropped, burned, punctured, or crushed, or if it comes in contact with liquid. Do not put heavy object on NexDock or damage it. Consider using a case or cover to protect the device.  
3. Do NOT attempt to open the NexDock by yourself. Disassembling the device may damage it or cause injury to you.  
4. Please note that the new battery is only able to achieve best performance after two or three full charge and discharge cycles.  
During the first three full charge and discharge cycles, please make sure to charging for at least 8-10 hours. After this, the battery can be fully charged in about 4 cycles. This ensures that the lithium battery will achieve its best performance in the future.  
5. Do NOT throw the device in municipal waste. The symbol of the crossed out wheeled bin indicates that device should not be placed in municipal waste. Check local regulations for disposal of electronic products.  
6. NexDock contains a lithium-polymer battery that is flammable. Do NOT throw NexDock in fire. Do NOT short circuit the contacts.

BY USING THIS PRODUCT YOU ARE SUBJECT TO THE FULL TERMS OF USE AS DESCRIBED AT HTTP://NEXDOCK.COM/TERMS-OF-USE/ EXCEPT TO THE EXTENT SET FORTH ABOVE IN THIS LIMITED WARRANTY, THE PERKS AND PRODUCTS ARE PROVIDED ON AN "AS IS" BASIS. THE ENTIRE RISK AS TO QUALITY AND PERFORMANCE OF THE PERKS IS WITH CONTRIBUTOR AND CONTRIBUTOR ASSUMES THE COST OF ANY SERVICING, REPAIR OR REPLACEMENT OF THE PERKS. NEX, DISCLAIMS ALL OTHER WARRANTIES OR CONDITIONS WITH RESPECT TO THE PERKS, WHETHER IMPLIED, EXPRESS OR STATUTORY, INCLUDING THE IMPLIED WARRANTIES OR CONDITIONS OF MERCHANTABILITY FITNESS FOR A PARTICULAR PURPOSE, TITLE AND NON INFRINGEMENT OF THIRD PARTY RIGHTS. NEX DOES NOT WARRANT THAT THE PERKS ARE ERROR-FREE OR WILL FUNCTION WITHOUT INTERRUPTION TO THE EXTENT THAT NEX MAY NOT, AS A MATTER OF APPLICABLE LAW, DISCLAIM CERTAIN IMPLIED WARRANTIES OR CONDITIONS. THE DURATION OF ANY SUCH IMPLIED WARRANTY OR CONDITION SHALL BE LIMITED TO THE SHORTER OF THE WARRANTY PERIOD OR THE MINIMUM TIME PERIOD PERMITTED UNDER SUCH LAW.

LIMITATION OF LIABILITY: IN NO EVENT NEX SHALL BE LIABLE FOR ANY INCIDENTAL, INDIRECT, SPECIAL, EXEMPLARY OR CONSEQUENTIAL DAMAGES OR DATA LOSS OR CONTENT LOSS ARISING FROM OR RELATING TO THIS LIMITED WARRANTY OR THE USE OF OR INABILITY TO USE ANY PERKS EVEN IF NEX KNEW OR SHOULD HAVE KNOWN OF THE POSSIBILITY OF SUCH DAMAGES. NEX'S AGGREGATE CUMULATIVE LIABILITY ARISING FROM OR RELATING TO THIS LIMITED TO WARRANTY AND THE USE OF, OR INABILITY TO USE ANY PRODUCT, WHETHER IN CONTRACT OR TORT OR OTHERWISE SHALL IN NO EVENT EXCEED THE PRICE CONTRIBUTED BY CUSTOMER FOR SUCH PERK. CONSUMER PROTECTION: SOME JURISDICTIONS DO NOT ALLOW THE EXCLUSION OR LIMITATION OF IMPLIED WARRANTIES OR THE EXCLUSION OR LIMITATION OF INCIDENTAL OR CONSEQUENTIAL DAMAGES, SO THE ABOVE LIMITATIONS OR EXCLUSIONS MAY NOT APPLY TO YOU. THIS WARRANTY GIVES YOU SPECIFIC LEGAL RIGHTS AND YOU MAY ALSO HAVE OTHER RIGHTS WHICH VARY FROM JURISDICTION TO JURISDICTION. THE DISCLAIMERS, EXCLUSIONS AND LIMITATIONS OF LIABILITY UNDER THIS LIMITED WARRANTY SHALL NOT APPLY TO THE EXTENT PROHIBITED BY APPLICABLE LAW.



© 2023 Nex Computer LLC. All rights reserved. NexDock, NexDock logo are registered trademarks of Nex Computer LLC. All other logos and trademarks herein not owned by Nex Computer LLC are the property of their respective owners.