User Manual



Product Introduction

Congratulations on purchasing of our Fixed Wireless Terminal. Before using this terminal, please kindly read this user guide carefully.

This is our new design, which uses GSM networks to operate. You can dial the local calls, domestic and international calls with this Terminal connecting with a common wired desktop phone and a standard SIM card. It is widely used in these areas:

Remote country

Mountains

Dwelling house with weak signals

Public telephone shops

Offices

Removable places such as Ships, Trains, and Long distance buses

Our wireless Terminal also has these characteristics as below:

Easy to install

Easy to operation

Powerful capacity of signals receiving

Clear talking setting

Long using life

Steady performance

Key Technical Specifications

Following are the key technical specifications of this Terminal:

1. Networks support: GSM 850/900/1800/1900MHz
2. Frequency range:
TX Frequency Range:
880~915MHz, 1710~1785MHz
824~849MHz, 1850~1910MHz
RX Frequency Range:
925~960MHz, 1805~1880MHz
869~894MHz, 1930~1990MHz
3. Voltage: DC 5V
4. Power consumption:
Static $\leq 25\text{MA}$ emission $\leq 500\text{MA}$
5. Peak power consumption: 1W/2W
6. Receive sensitivity: -104db

Key functions

The key functions of the Terminal are list as below:

1. Can dial the local calls, mobile calls, international calls and special free calls;
2. Password authority administrable;

3. volume adjustable;
4. Time and Date setting and getting

Cautions and Storage

Cautions

1. This terminal should not be used at garage, oil storage, and chemical plant or near to any inflammable or explosive substance.
2. This terminal should be avoided in the hospital. It will interfere with medical electronic equipments such as pacemaker and audiphones.
3. If it is found that the terminal is not successful in login onto network, please check whether the SIM card or antenna is well installed.
4. It is blocked to touch the antenna when the Terminal is being used. (Being making calls or receiving calls), otherwise the terminal will be damaged. This kind of damage is beyond the range of warranty.
5. When the terminal is being used, it should be placed where signal is strong enough. In order to ensure good voice quality, the terminal should be far from other electronic equipment.
6. Don't use chemic substance to clean the terminal, but use dry soft cloth to clean it.
7. Don't disassemble the terminal by yourself. If there is any problem, please contract the authorized personnel.

Storage:

1. The terminal that is packed or not could piled up no more than 10 layers.
2. The terminal should be saved in ventilate and dry place.
3. Don't knock the terminal to avoid breaking the case.



This user guide provides information on the use and operation of your FWT. Kindly read all the information contained in this user guide carefully prior to using the Phone. This will help you in getting the best performance and shall prevent any unintended damage to the Phone. Check the contents of the box as per the packing list and report any discrepancies immediately to the store from where Phone has been purchased.

Do's & Don'ts

- Do not clean the FWT while in operation. Before attempting to clean the FWT, turn the FWT off, disconnect the external power adapter. Use a Damp cloth for cleaning. Do not use liquid or aerosol cleaners.
- Do not hold the antenna. This may affect call quality and cause FWT to operate at unintended power levels.
- Keep the antenna free from obstructions and position the antenna straight up. This will ensure best call quality.

- Do not use a damaged antenna. Have this replaced through a qualified technician. Use only antenna approved by the manufacturer. Unapproved antenna may impair the call quality as well as cause damage to the FWT.
- Do not attempt to change the security codes or components. User is responsible for any consequences arising out of such attempt.
- Avoid shock or impact. Rough handling can cause damage to the FWT body and internal circuits.
- Do not paint.
- During lightening do not touch power plug or FWT line. This can cause Electric shock, even death. Do not touch the external antenna.
- Your FWT is to work with 100-240V AC. Check the voltage before connecting.
- Do not plug many power cords in the outlet.
- Do not touch the plug with wet hands. Always grasp and pull the plug, not the cord. Do not put heavy things on the power cord or bend it too much.
- If the FWT is not working for any reason, do not attempt to repair it. The FWT should be serviced by qualified service personnel only.
- Place the FWT and the power supply in a properly ventilated place.
- Do not place the FWT near high temperature objects, under direct sunlight, near source of water, near fire or near inflammable and explosive materials.
- Do not place any articles over the FWT.
- Place the FWT in a dry place and do not expose to moisture.
- Place the FWT away from other electronic devices like TV and Radio to avoid interference.
- For a better reception, do not place the Instrument in a building with iron or metal roof.
- Hospitals or health care facilities may use equipment which is sensitive to Radio Frequencies. Please ensure that your FWT is turned "OFF" while in the vicinity of such facilities.
- Do not use the FWT in designated "No Fixed FWT Use" area.

Connect the terminal

Connecting Your Service Provider

To use the networks services available in you terminal, you will need to sign up with wirelesses

provider and purchase a SIM (Subscriber Identity Module) Card or purchase a prepaid SIM card. In many cases, the wireless provider will make available descriptions of its services and instructions for using its features. Wireless provider may differ in their support of features. Before you sigh up, make sure a wireless provider support the features that you need.

Installing the Antenna

To choose a proper place for the antenna is the first and very important step for antenna installing. You can use your mobile phone to search for the place where the strongest signal is. Then put the antenna here.

Please do not make the antenna too close to the terminal. It will disturb the signal of the terminal.

Please do not make the antenna and the terminal too close to the TV set, computer, and radiogram. It will disturb the signal of the terminal.

Inserting a SIM Card

Make sure the terminal is switched off and the AC adapter is unplugged: insert the SIM card only when the terminal is switched off and the AC adapter is unplugged. Follow the instructions below to insert a SIM Card into the terminal.

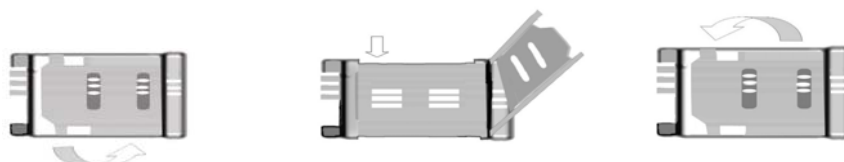

- 1). Screw off the screw of SIM card case, and open the cover.
- 2). Slide back the SIM card door and lift it up.
- 3). Slide the SIM card into the SIM door making sure that the clipped corner of the SIM card lines up with the clipped corner of the SIM holder.
- 4). Close the SIM card door and slide it to lock the SIM card in place.
- 5). Replace the cover of SIM card case and fixes it with a screw.

Connecting your terminal with desktop phone

If you want to use the terminal to make calls, you should connect the terminal with a common wired desktop phone.



There are two communication portals at the back of the terminal. You can connect desktop phones with our terminal. It's very easy to connect the phone and terminal, just need a common communication cable.

Operation and Setting

1. Power on/off the FWT

There is a toggle switch in the back FWT, power on the FWT after switch on this switch.

1.1 LED light and Information after power on



Red LED: Power LED Indicator, It will LED ON permanent after power on.

Green LED: Network Indicator, It will flash after registering on the network.

Reset Button: after press this button, the FWT will reset.

	Green LED light activity	Status
ON	LED ON permanent	FWT is switched ON but not registered on the network
	LED Flashing slowly	FWT is switched ON and registered on the network, but no Call is in progress (Idle mode)
	LED Flashing rapidly	FWT is switched ON and registered on the network, and a Call is in progress
OFF	LED OFF	

The below table show the mean of display information after power on the FWT

inf:0	Without Sim card	Green Indicator
inf:1	Limited Service	LED ON permanent
inf:2	No Service	LED ON permanent
inf:3	Searching networking	LED ON permanent
inf:17~25	Sim Card error	LED ON permanent
INPUT PIN:	Opened SIM Card PIN Function, PLS Close it.	LED ON permanent

2. Date and Time setting and query

2.1 Date Query command: **1010*1#.

Response Confirmation Tone if success and display Year,Month,Day.

The below photo is a sample.

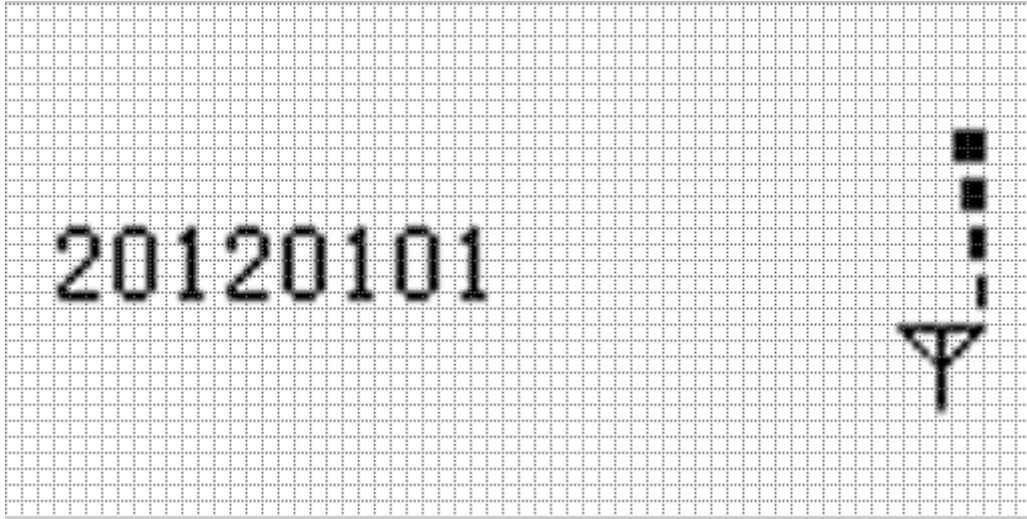

2.2 Time Query Command: **1010*2#.

Response Confirmation Tone if success and display hour and minute.

The below photo is a sample response.

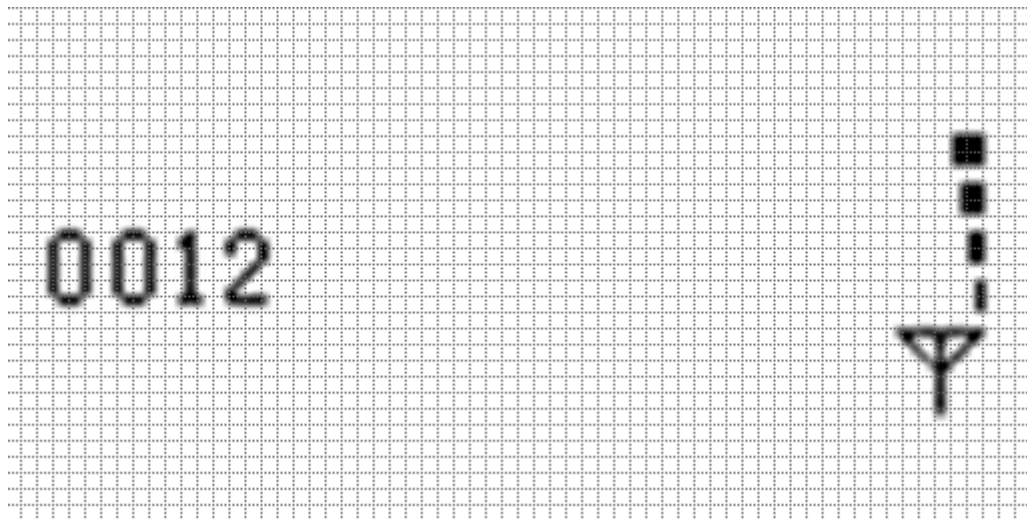

2.3 Set time command: **2011*MMMM*YYMMDDHHMM#

Response Confirmation Tone if success.

MMMM is password, default password is 0505.

YYMMDDHHMM is year (YY) month (MM) day (DD) hour (HH) minute (MM).

2.4 Version Query Command: **1010*0#

Response Confirmation Tone if success and display current Software version number

The below photo is a sample response.

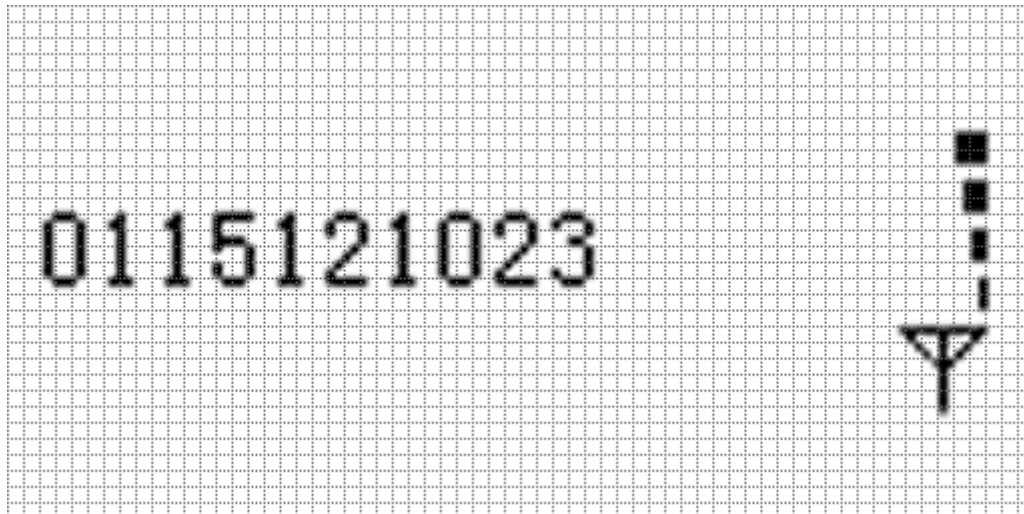

1.Dialing:

Pick up handset, input desired number after hearing dialing tone;

Press “#” key after input desired number to dial it faster, it’ll be dialed out automatically after 4 seconds if you don’t press “#” key;

The LCD will display below photo

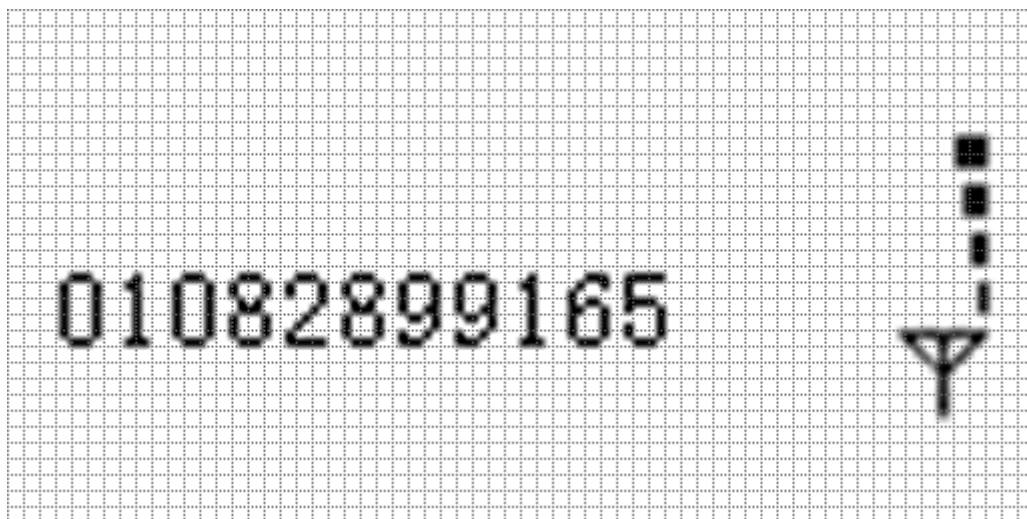

2.Pick up phone call:

When the terminal rings that means there is new call come, the LCD will display above photo, pick up handset to proceed conversation, it will show the below photo.

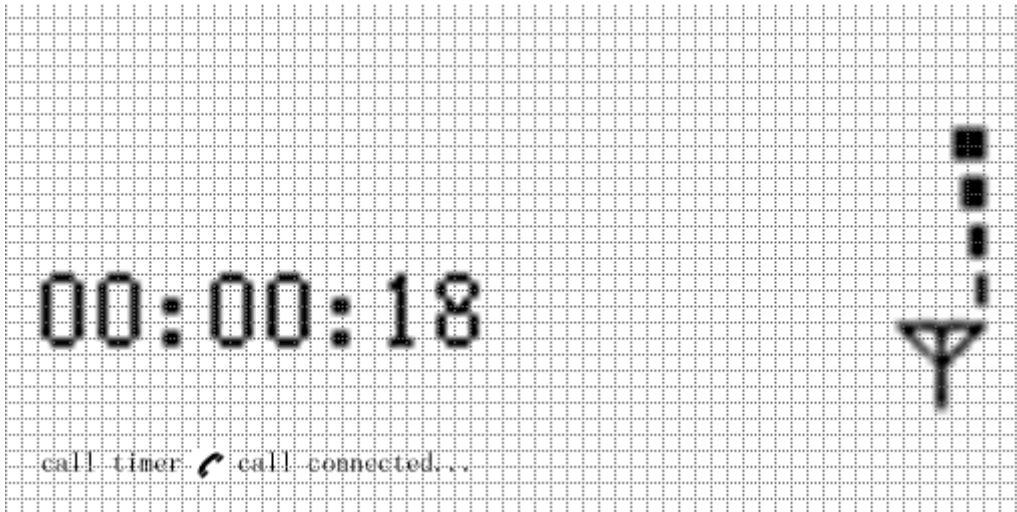

Return handset to the base after conversation completed. The LCD show below photo, it shows the total call timer.



4. Speical setting command.

Password Authority Management Function	Change password	**2010*MMMM*NN NN*NNNN#		MMMM is previous password and NNNN is new password, default password is 0505.
	Set Time	**2011*MMMM*YY MMDDHHMM#	Response Confirmation Tone if success	MMMM is password, YYMMDDHHMM is year (YY) month (MM) day (DD) hour (HH) minute (MM).
	Set command authority	**2012*MMMM#	Response Confirmation Tone if success	The command is used to obtain setting authorization, and it

				will lose efficacy in another minute.
	RESTORE FACTORY SETTINGS	**2030*1234#	Response Confirmation Tone if success	Restore default value.
The following commands need customer to gain some setting permissions. (The red letter ones)				
Function setting	Volume setting	**1020*N#	Response Confirmation Tone if success	N is volume level 1-8, Default level is level 5.
	Set 100ms flash hang up.	**1050*1#	Response Confirmation Tone if success	Default value is 100ms flash hang up.
	Enable ring back tone	**1060*1#	Response Confirmation Tone if success	Play ring back tone when you call out but did not' getting through.
	Disable ring back tone	**1060*0#	Response Confirmation Tone if success	This option is ON by default.
	Enable Caller ID blocking	**1100*1#	Response Confirmation Tone if success	No all SIM card support this function.
	Disable Caller ID blocking	**1100*0#	Response Confirmation Tone if success	Default value
Call in and call out	Display numbers in DTMF mode	**1110*0#	Response Confirmation Tone if success	Show as DTMF by default.
	Query number display mode	**1110*2#	Response Confirmation Tone if success and show up as 10X	Value 0 means DTMF mode.
	Set numbers dial out delayed	**1120*T#	Response Confirmation Tone if success	T is delayed time. Its value is 1~9 second. The minimum time is 1 second, default value is 5 second.

	Query delay seconds and dial out after pressing call number	**1120*0#	Response Confirmation Tone if success and show up as 2XX	XX means delayed time duration. Unit: second, e.g. 03 means 3 seconds.
	Disable international phone call out	**1140*1#	Response Confirmation Tone if success	To restrict overseas call. Overseas call are enabled by default.
	Enable international phone call out	**1140*0#	Response Confirmation Tone if success	Enable international phone call out
	Query international phone call restriction	**1140*2#	Response Confirmation Tone if success and show up as 40X	If value of X is 1, it means there is international call restriction; If value of X is 0, it means there is no international call restriction.
	Restrict all incoming calls	**1141*1#	Response Confirmation Tone if success	All incoming calls are barred. There is no restriction by default.
	Cancel all incoming call restriction	**1141*0#	Response Confirmation Tone if success	No incoming call is barred.
Fixed dialling function	Query all incoming calls setting	**1141*2#	Response Confirmation Tone if success and show up as 40X	If value of X is 1, it means there is international call restriction; If value of X is 0, it means there is no international call restriction.
	Set incoming call blacklist	**1142*M*N#	Response Confirmation Tone if success	M is sequence number, value ranges from 0-9, and means there are 10 groups of number. N means number segment, maximum

				length is 11 digits.
Clear all incoming call blacklist	**1142*#	Response Confirmation Tone if success		Clear all incoming call blacklist
Query incoming call white list	**1143*M*#	Response Confirmation Tone if success and show up as XXNNN		M is sequence number, value ranges from 0-9, means the sequence number in 10 numbers. It is showed as XXNNN..., XX is sequence number, ranges from 0-9; its value is the same as that of M. NNN is restricted number segment.
Set fixed restricted number	**1144*M*N#	Response Confirmation Tone if success		M is sequence number, ranges from 0-9; it means you can set 10 telephone numbers. N is number segment, the length is no more than 11 digits.
Clear all fixed restricted numbers	**1144*#	Response Confirmation Tone if success		Clear all fixed restricted numbers
Inquire fixed restricted number	**1145*M#	Response Confirmation Tone if success and show up as XXNNN...		M is sequence number, ranges from 0-9; it means you are inquiring the Nth phone number in the 10 numbers, and showed as XXNNN..., XX is sequence number, ranges from 0-9; its value is the same

				as M. NNN... means restricted number segment.
--	--	--	--	--

Packing List

With the Fixed Wireless Terminal, there are some accessories. When you get the terminal please check them and to see whether you have all of them. Please contact us or call the distributor in your area to hand back the absent parts if you find that you lack one of them as below:

Name	Quantity	Remark
DC adapter	1pcs	DC5V/1A
Special antenna	1pcs	
User Manual	1pcs	English

FCC Warning:

This device complies with part 15 of the FCC Rules. Operation is subject to the following two conditions: (1) This device may not cause harmful interference, and (2) this device must accept any interference received, including interference that may cause undesired operation.

Any Changes or modifications not expressly approved by the party responsible for compliance could void the user's authority to operate the equipment.

FCC Radiation Exposure Statement:

This equipment complies with FCC radiation exposure limits set forth for an uncontrolled environment .This equipment should be installed and operated with minimum distance 1 m between the radiator & your body.

This transmitter must not be co-located or operating in conjunction with any other antenna or transmitter.