

Remocon App for NextGen BT

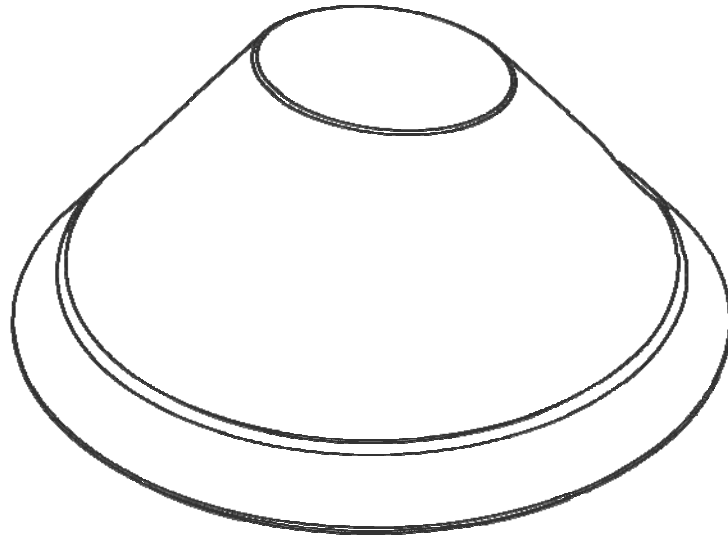

Seoby Electronics CO., Ltd

Index

1. RUNNING REMOCONAPP.....	3
1.1. PAIRING SMARTPHONE AND NEXTGEN BT VIA BLUETOOTH.....	3
1.2. RUNNING APPLICATION.....	4
1.3. APP LOADING SCREEN.....	4
1.4. BLUETOOTH CONNECTION.....	5
1.5. SET-TOP BOX.....	7
1.6. TV.....	9
1.7. DVD/BLU-RAY.....	10
1.8. AUDIO.....	11
1.9. VOICE.....	11
1.10. ADD.....	13
2. SETTING MENU.....	14
3. CODE SEARCH.....	15
3.1. CODE SEARCH.....	15
3.2. HOW TO CODE SEARCH.....	15
4. AUTOSCAN.....	18
4.1. AUTOSCAN.....	18
4.2. HOW TO AUTOSCAN.....	18
5. LEARNING.....	20
5.1. LEARNING.....	20
5.2. HOW TO 'LEARNING'.....	20
6. ADD BUTTON.....	22
6.1. ADD BUTTON.....	22
6.2. HOW TO ADD BUTTON.....	22
7. SETTINGS.....	25
7.1. SOUND.....	25
7.2. APPLICATION INFORMATION.....	25
7.3. SUPPORTING MODEL.....	26
7.4. EDIT VOICE COMMAND.....	26
7.5. VOICE COMMAND LIST.....	28
7.6. VOICE COMMAND CHANNEL.....	28

1. Running RemoconApp

1.1. Pairing Smartphone and NextGen BT via Bluetooth

- In order to use NextGen BT through Smartphone application, Smartphone and NextGen BT must be paired via Bluetooth.
- Method of pairing Smartphone to NextGen BT.
 - ✓ Press 'Pairing key' at the bottom of NextGen BT.
 - ✓ When 'Scan for devices' is pressed on Smartphone, NEXTGEN_BT_EXT_R will pop up on the list.
 - ✓ When NEXTGEN_BT_EXT_R is pressed, it will wait to start pairing.
 - ✓ Smartphone is paired with NextGen BT.

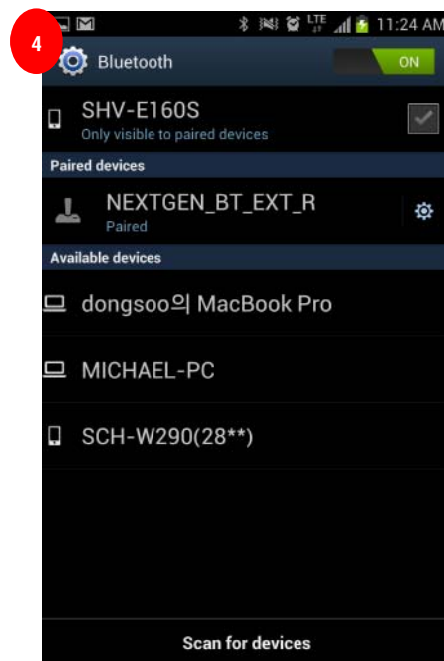
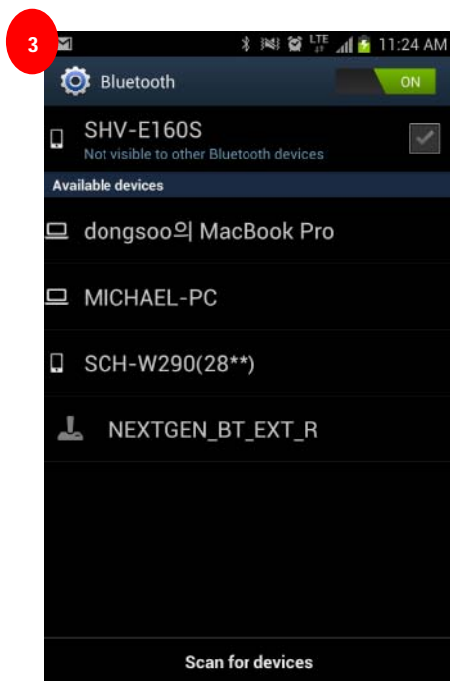
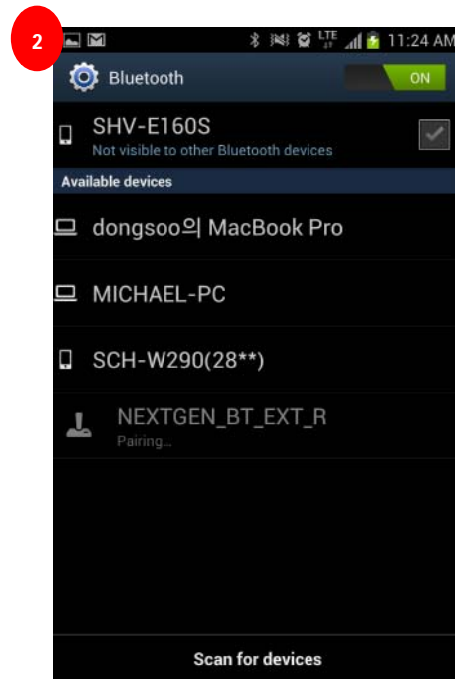
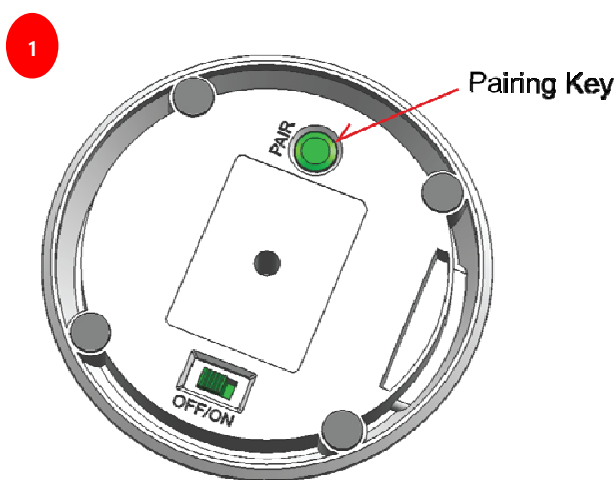

1.2. Running application

- Run NextGen BT by pressing its icon on the screen

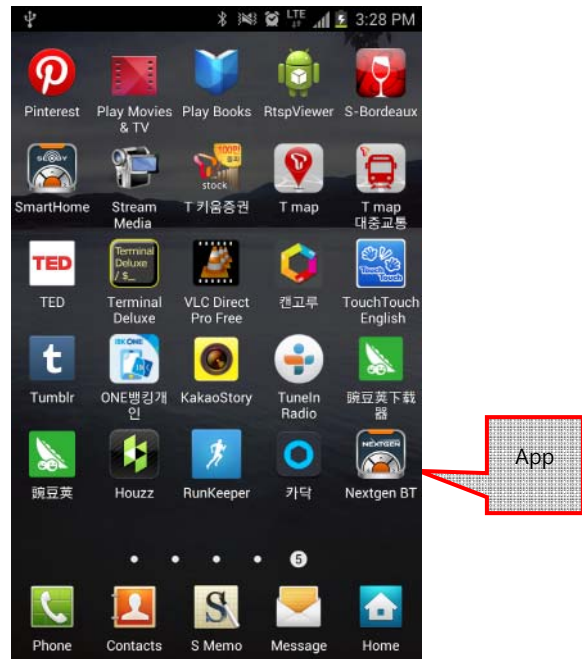

1.3. App loading screen

- NextGen logo will pop up when application started



1.4. Bluetooth connection

- In order to use NextGen BT via Bluetooth, it should be checked if Smartphone and NextGen BT is connected through Bluetooth
- Pair NextGen BT and Smartphone as below.
- Check Bluetooth device list
 - ✓ When application is run, device list which shows paired device or devices scanned by Bluetooth will pop up.
 - ✓ Click "NEXTGEN_BT_EXT_R" on the list.

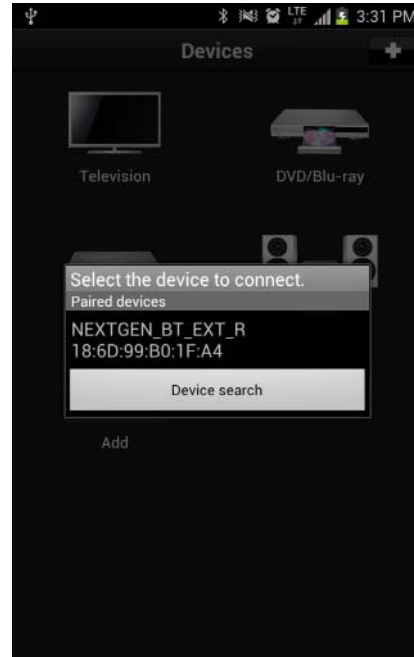

- Check Bluetooth connection
 - ✓ If connected successfully, it will show "Connected to NEXTGEN_BT_EXT_R" at the bottom of the screen.
 - ✓ Also, if connection is succeeded, there will be blue animated line displayed at the top of the screen and 'Voice' icon will be showed on the list.

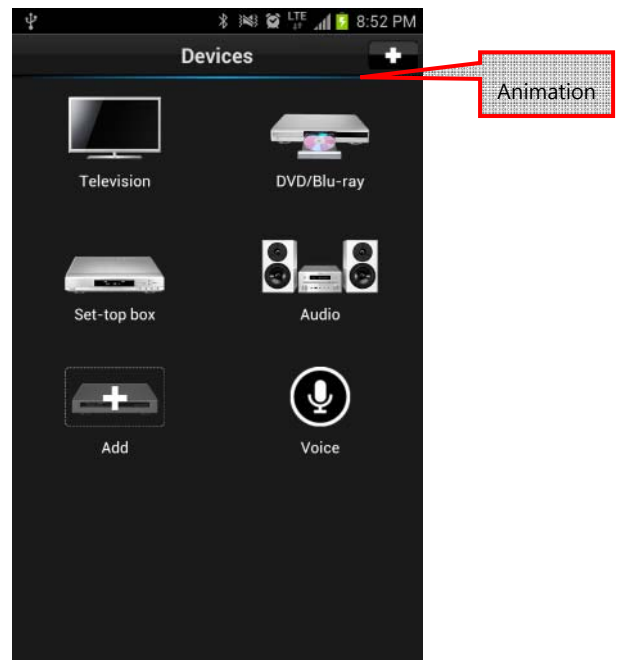
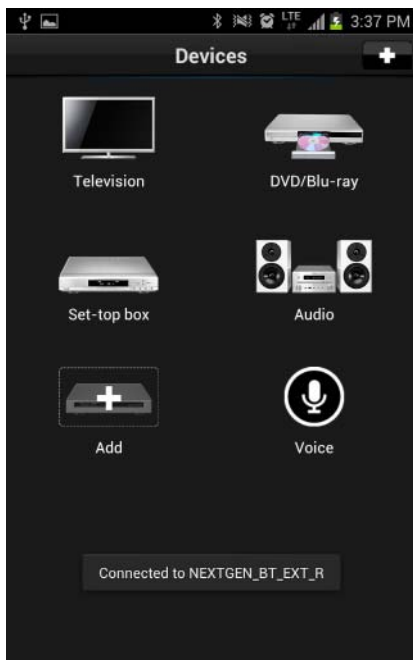

■ Failure of Bluetooth connection

- ✓ When NextGen BT failed to connect, message saying "Unable to connect device" will pop up for 2 seconds and disappear.
- ✓ When it is not connected, blue animated line at the top and 'Voice' icon will not be showed.

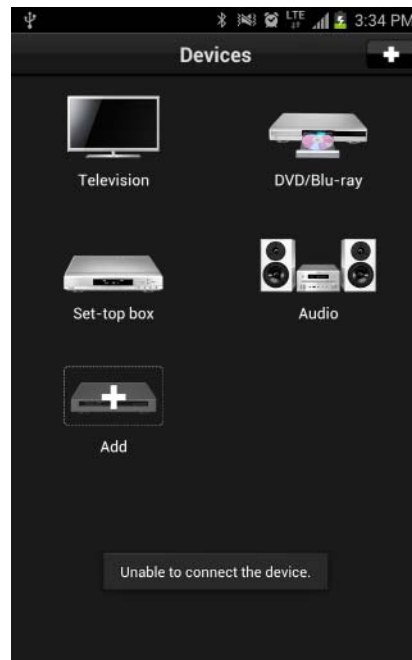

■ Connecting Bluetooth again

- ✓ Press menu button on the phone, and press 'Connection' icon to start connecting again.

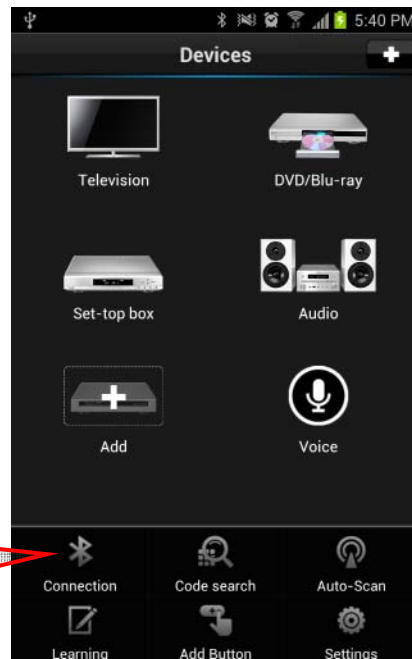

1.5. Set-top box

■ CH/VOL screen

- ✓ Function keys : Power, Mute, Menu, etc.
- ✓ Control keys : Volume Up/Down, Channel Up/Down, Left/Right/Up/Down, etc.

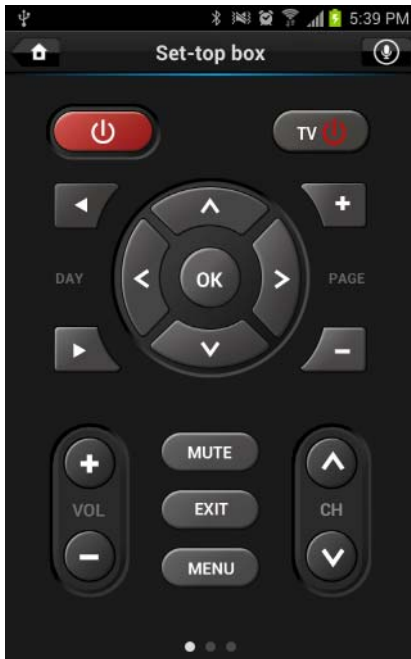

■ Numeric KEY screen

- ✓ Keypad to input channels number



- Navi Key screen
 - ✓ Function keys to control video contents on set-top box

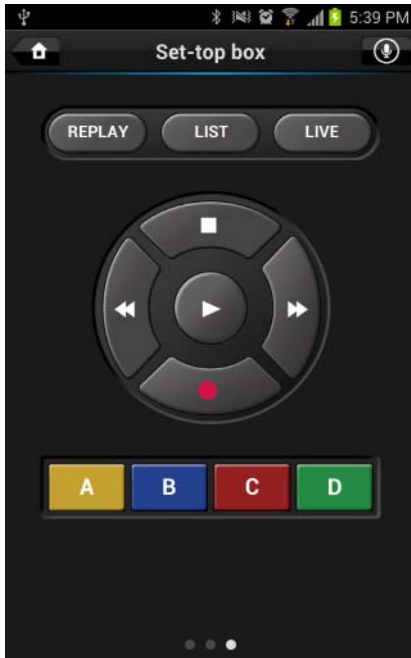

1.6. TV

■ CH/VOL screen

- ✓ Function keys : Power, Sleep, Mute, PIP, etc.
- ✓ Control keys : Volume Up/Down, Channel Up/Down, etc.

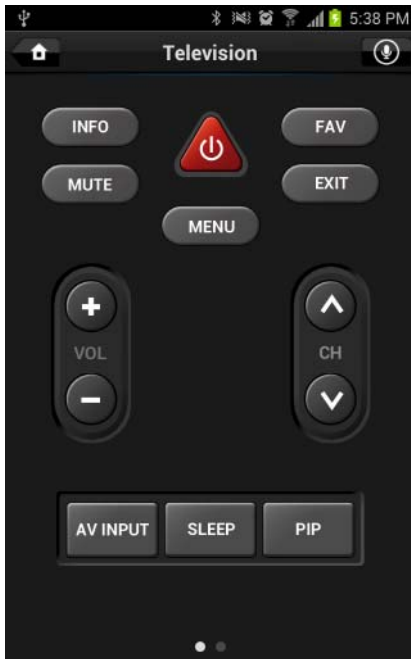

■ Numeric KEY screen

- ✓ Keypad to input channels number

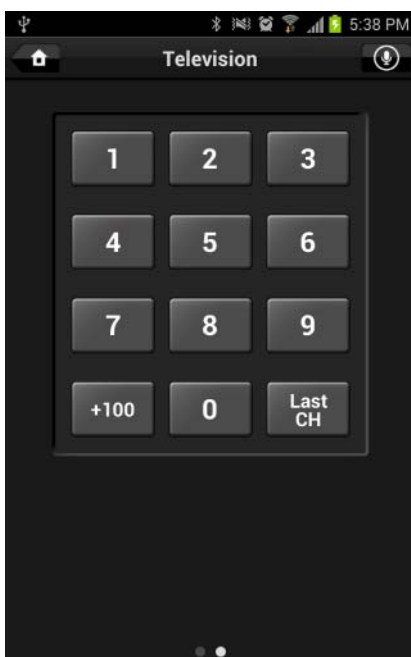

1.7. DVD/Blu-ray

- Navi screen
 - ✓ Keys to use DVD/Blu-ray's functions

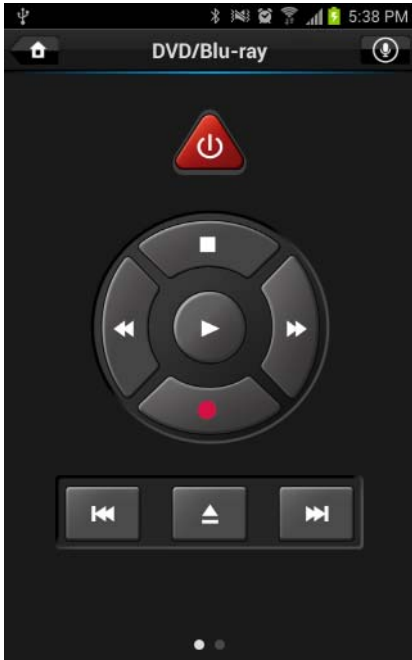

- Fun screen
 - ✓ Function keys to control DVD/Blu-ray

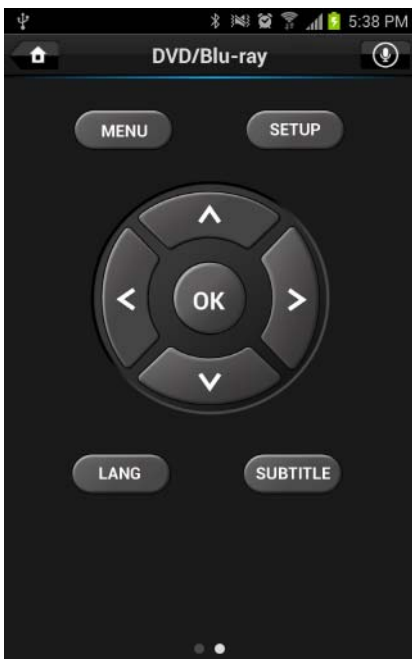

1.8. Audio

- Navi screen
 - ✓ Keys to use Audio's function



1.9. Voice

- Voice recognition function
 - ✓ Via Google voice recognition, if recognized voice commands correspond to remote control commands, it will execute the corresponding function.
 - ✓ If 'Voice' icon is pressed, voice recognition screen will be shown.

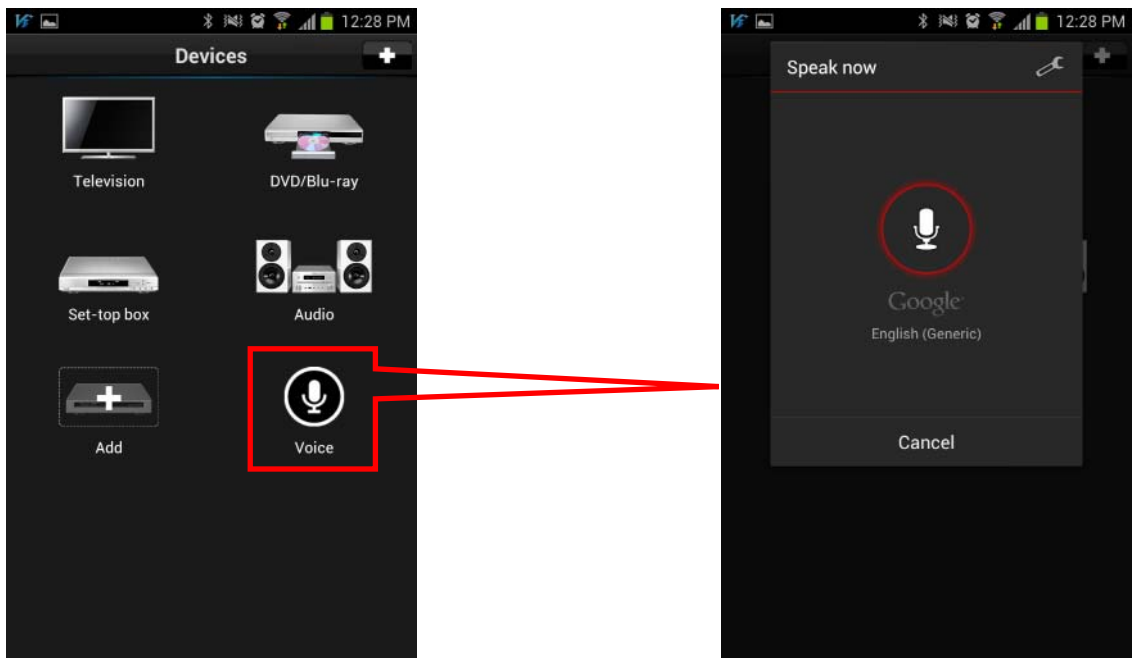

- ✓ On each devices screen, there is microphone icon on the top right, and when it is pressed, voice recognition screen will be popped up.

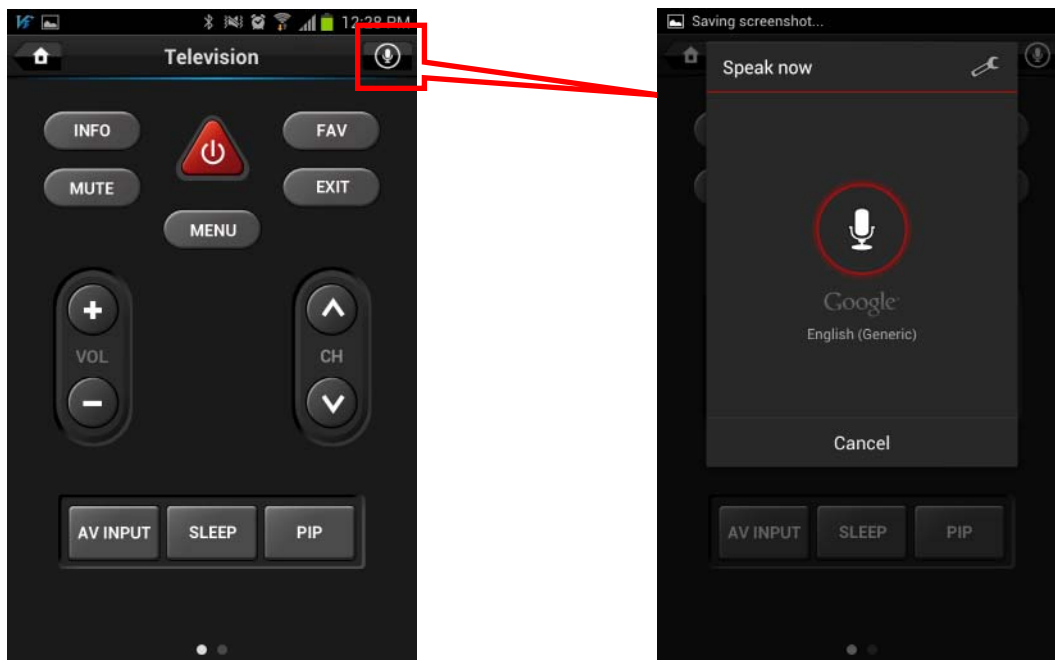

- List of voice recognition commands
 - ✓ Go to Setting - Voice Command List, it will provide list of voice commands that are supported on the application
- Editing voice commands
 - ✓ The basic voice commands provided from this application can be altered as users' wish.
 - ✓ It can be done on Setting – Edit Voice Command
- Voice recognition mode
 - ✓ There are same voice commands for TV MODE and SET-TOP MODE, therefore users have to first choose which mode they want to control through providing a voice command 'TV MODE' or 'SET-TOP MODE'.
 - ✓ Set as TV MODE by providing voice command 'TV MODE', and provide a command 'VOLUME UP', then the TV volume will increase.
 - ✓ Set as SET-TOP MODE by providing voice command 'SET-TOP MODE', and provide a command 'VOLUME UP', then the SET-TOP BOX volume will increase.
- Voice commands to change channels
 - ✓ When changing channels through voice commands, users can change to specific channels.
 - ✓ For example, there are two ways to change to channel 120
 - ◆ Provide the command like 'CHANNEL 120(One hundred twenty)'
 - ◆ Provide the command like 'CHANNEL 1, 2, 0(OneTwoZero)'
 - ✓ Whether 'CHANNEL 120(One hundred twenty)' or 'CHANNEL 1, 2, 0(OneTwoZero)' is inputted into application, NextGen BT will output 1, 2, 0 separately.
- Voice commands to alter volumes
 - ✓ Increase or decrease in volume through application with voice commands, by not just one, but by plural levels of volumes
 - ✓ Voice commands to increase or decrease volumes
 - ◆ To increase volumes by 5 levels at once : VOLUME UP 5
 - ◆ To decrease volumes by 10 levels at once : VOLUME DOWN 10

- ✓ When received 'VOLUME UP 5' NextGen BT will execute 'VOLUME UP' 5 times.

1.10. Add

- Application provides a functions to add a device other than provided devices on the list
 - ✓ If Add button is pressed, it will change to Add screen
 - ✓ Users can arrange the buttons as their wish by finding buttons at the bottom by sliding left to right
 - ✓ To add a button on the screen, press the button for few seconds on the list at the bottom and it will come up on the bottom left
 - ✓ Users then are able to drag and drop to arrange
 - ✓ This function is similar to 'Add Button'

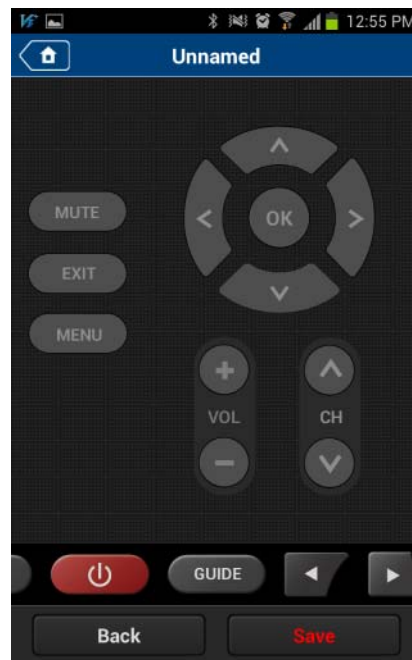
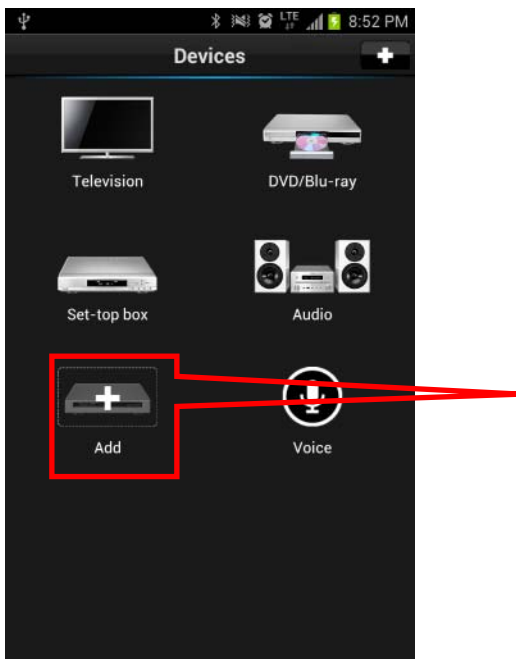

- As above, when arranging buttons are finished, press 'Save' button to proceed to next step
- Add functions to buttons
 - ✓ Users then have to provide functions to each buttons.
 - ✓ Setting button functions are as Learning function.

- Functions provided devices are allowed to change its name
 - ✓ Newly processed devices' name is set as "Unnamed"
 - ✓ It can be altered by pressing top right button
 - ✓ Write the name and press Save



2. Setting Menu

- If press Menu button on Smartphone, it shows this list revealed on the figure.

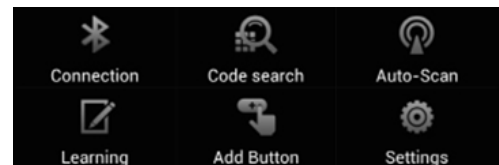

- 1. Bluetooth : refer Chapter 1.4
- 2. Code Search : refer Chapter 3
- 3. Autoscan : refer Chapter 4
- 4. Learning : refer Chapter 5
- 5. Add Button : refer Chapter 6
- 6. Settings : refer Chapter 7

3. Code Search

3.1. Code Search

- A function to select a stored device model
- Devices model database is stored in application, if it knows the users owned devices model, Code Search searched the model, process few test and allows users to use

3.2. How to Code Search

- Choose a device to Code Search

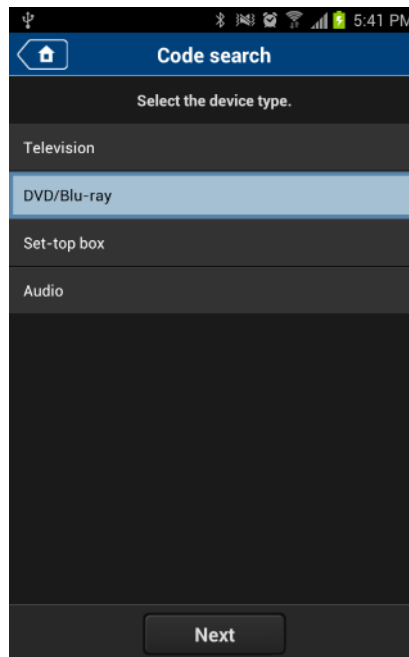

- Choose a brand to Code Search

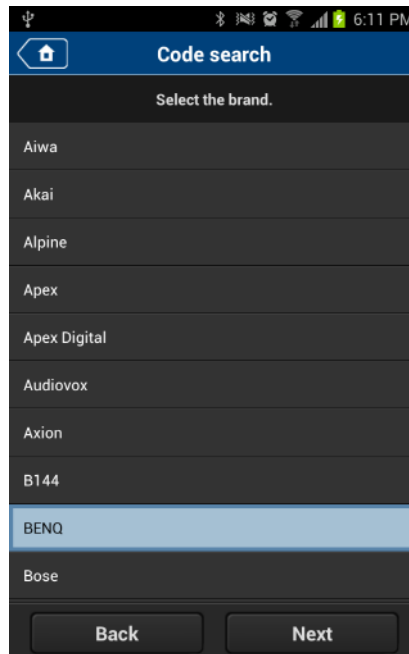

■ Choose a model

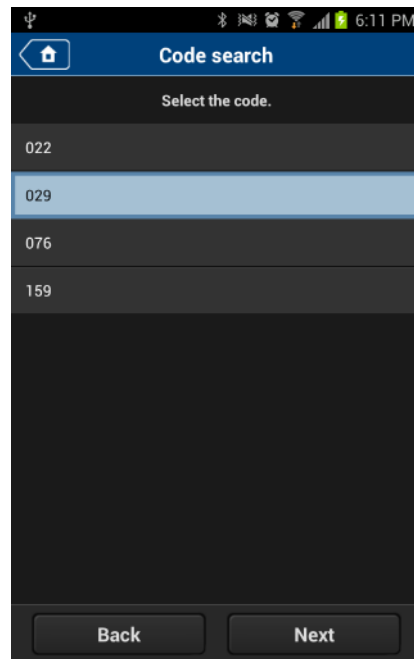

■ Check selected devices function

- ✓ It will output IR signal and if the function works, press YES.
- ✓ If the function is not working, press NO to Code Search again.

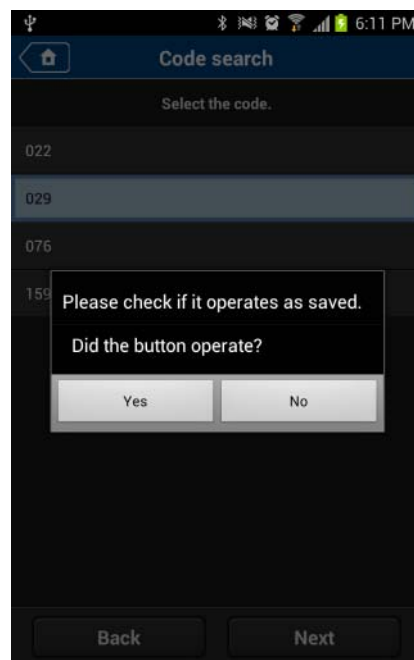

■ Save Code Search

- ✓ If found device model through Code Search, review the detail of the model and save.

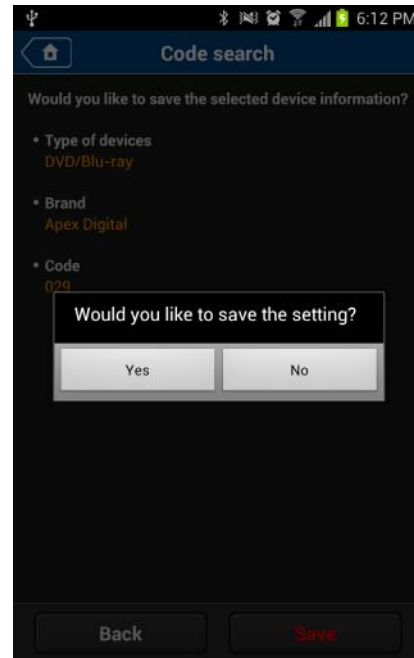
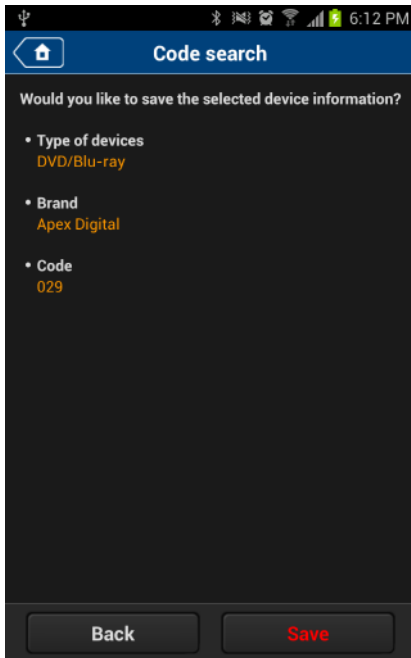

4. AutoScan

4.1. AutoScan

- This functions is used when users are not familiar or not aware with their own devices
- Using application's database to find out which model users have.

4.2. How to AutoScan

- Choose a device to AutoScan

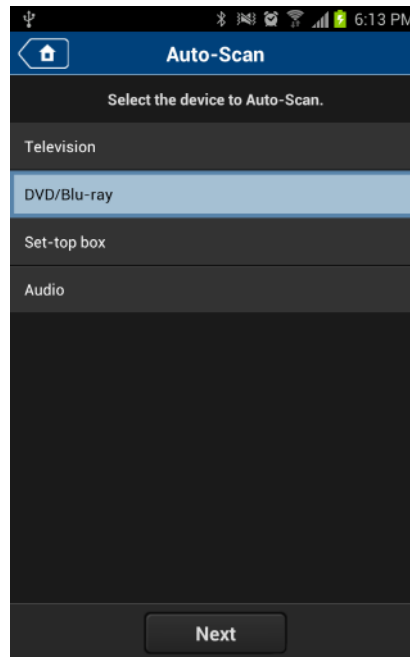

- When AutoScan is started, it will output each brand's signal
 - ✓ When the device corresponds to Autoscan, press STOP and ask whether it worked or not
 - ✓ Then press yes, and it will process to next step

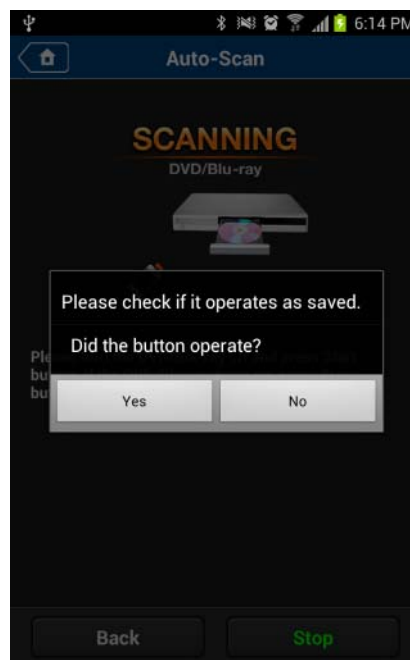
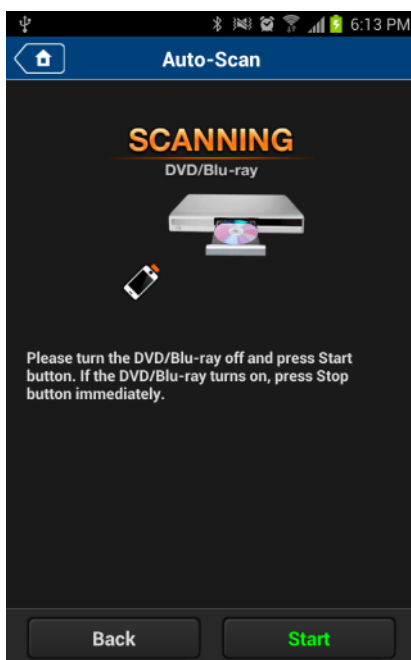

- It will process Autoscan twice for each device, and if it works well, it will proceed to next step, and as the second operating method for each device are different, follow the application and do the next step.

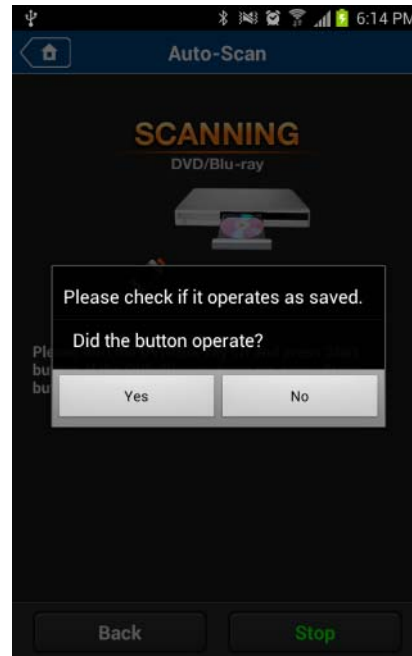
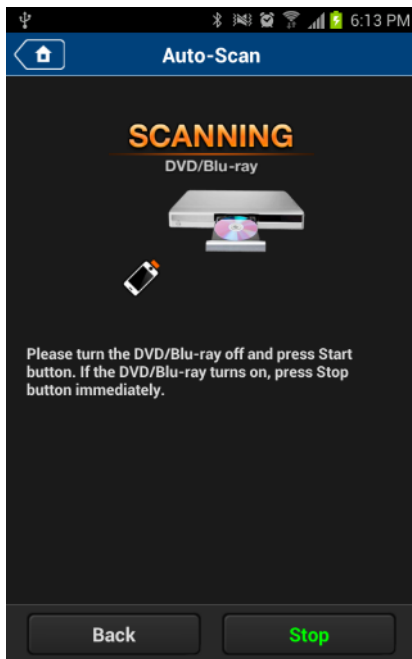

- Finish the Autoscan by saving the detail if it worked perfectly

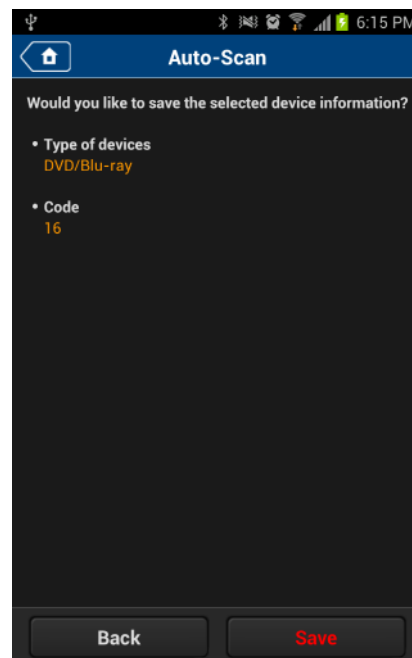

5. Learning

5.1. Learning

- If there are no information of the device model, use the remote controller of the device to send a signal to NextGen BT to register a signal for application
- Users can set variety buttons in an application to set functions for the device

5.2. How to 'Learning'

- Choose a device to 'Learning'
 - ✓ Choose a device
 - ✓ Press Next

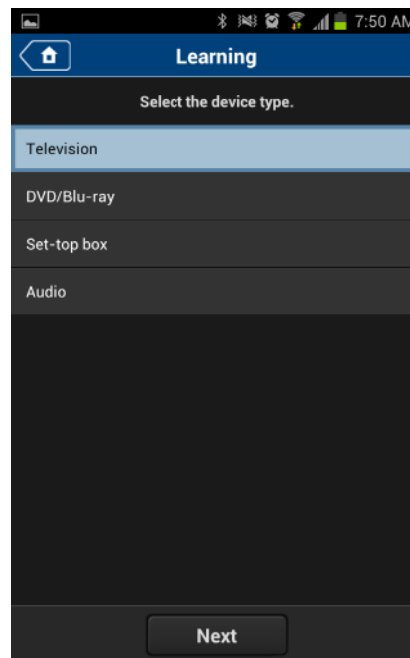

- For NextGen BT to learn a signal, hold a remote controller about 2.5cm far from the NextGen BT's IR receiver and provide a signal



- ✓ To check the signal perfectly, it will receive the signal twice.

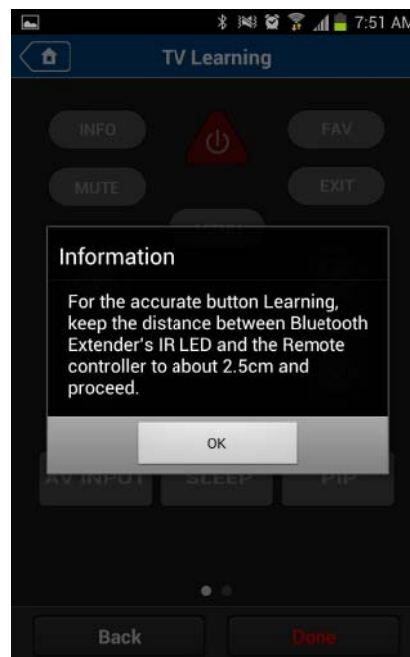

- Choose a button to learn.
 - ✓ Buttons not learnt will not be activated.
 - ✓ If the button is chose and processed in learning, it will be activated.
 - ◆ In example on the right, + button

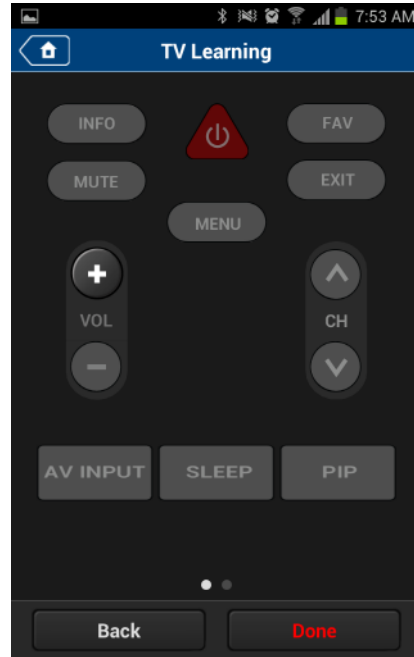

- If the signal is received once, the message will pop up saying input the external remote signal again.

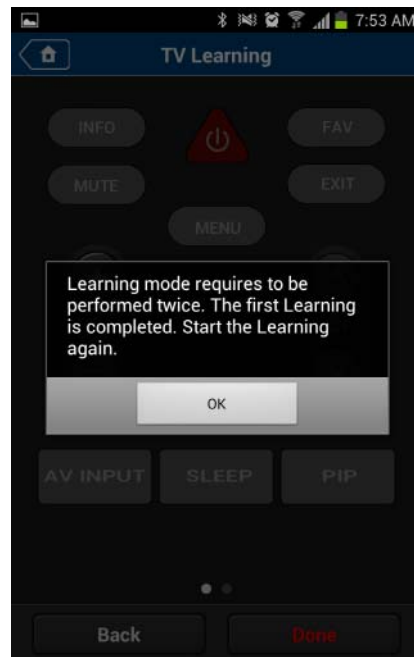

- If the signal is received twice perfectly, the message will pop up saying that it is completed, and learning function is all done.

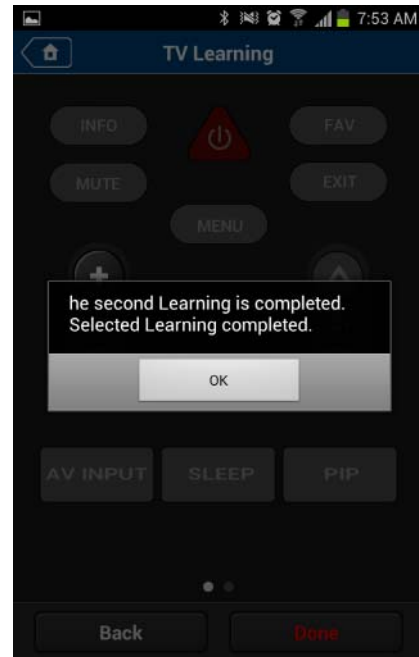

6. Add Button

6.1. Add Button

- add Button is to add new menu-tab, add buttons users want and arrange, and through Learning to provide functions to buttons
- It can be sorted as Device or group, and it can be set as users' wish

6.2. How to Add Button

- Choose a device to Add Button
 - ✓ Choose a device
 - ✓ Choose a group that includes a device
 - ✓ If press Next, it will proceed to Add Button
 - ✓ Press Back button to main screen

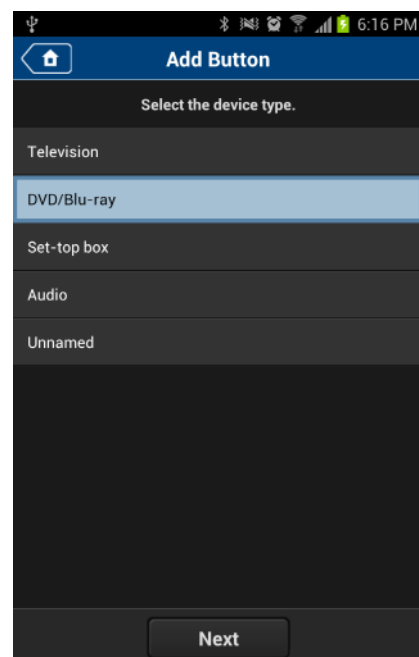

- Add buttons from the list at the bottom
 - ✓ Find the buttons by sliding left or right on the list at the bottom
 - ✓ To add a button on the screen, press the button for few seconds on the list at the bottom and it will come up on the bottom left
 - ✓ Users then are able to drag and drop to arrange
 - ✓ If there are more buttons to add, it can be done as same as above

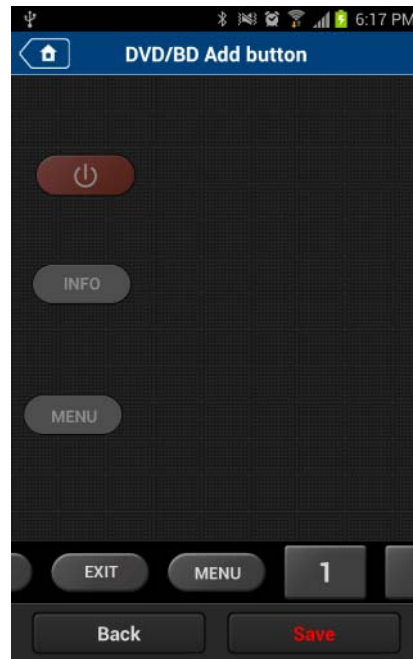
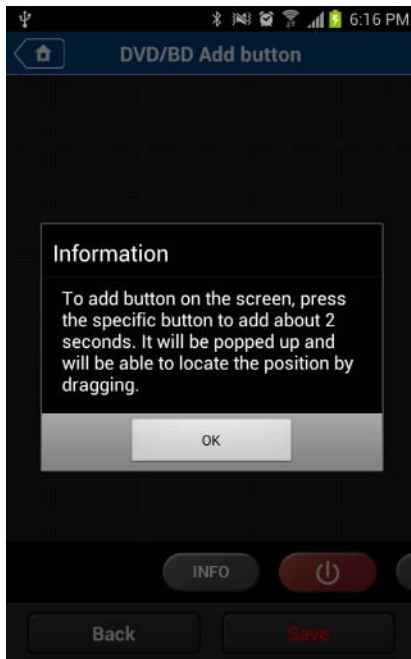

- Complete add button
 - ✓ To finish the add button, press Save on the bottom right.



- Learning- refer to Learning function on this manual

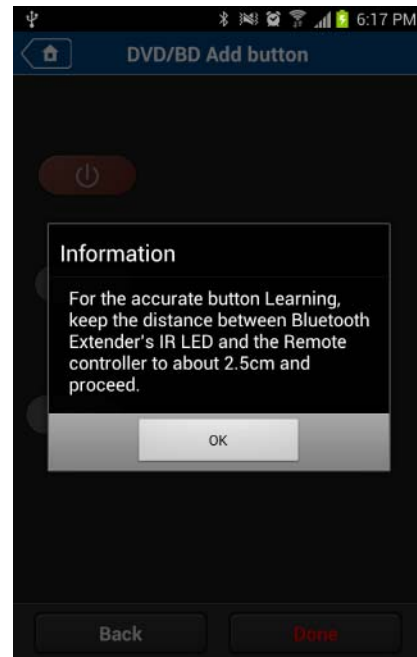

7. Settings

7.1. Sound

- Sound On/Off toggle

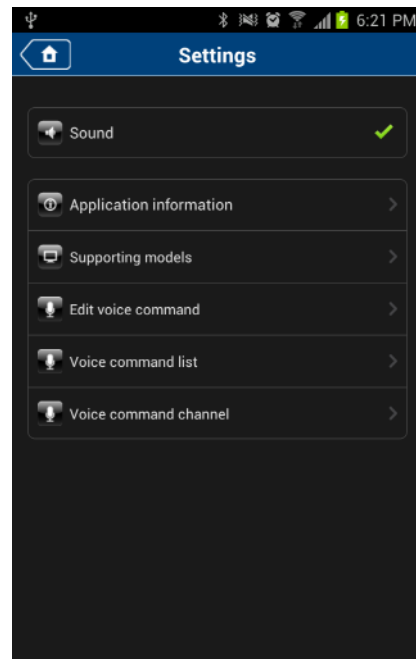

7.2. Application Information

- Version of this application
- Software version : Application's version information
- Protocol version : Protocol version information with BT Extender

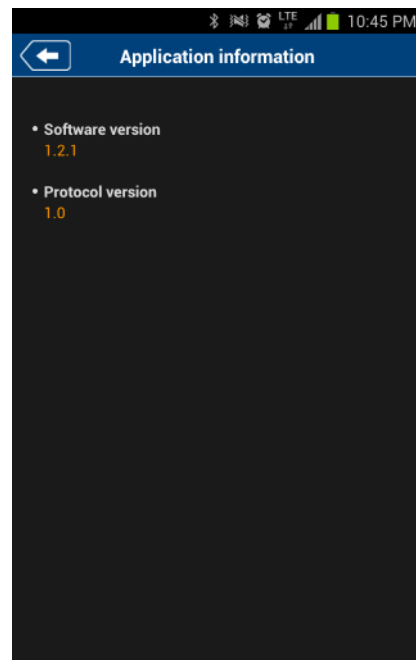

7.3. Supporting Model

- All of the devices supported by the NextGen BT application

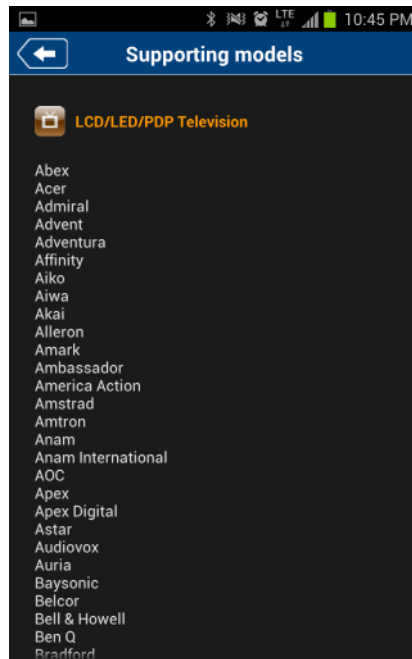

7.4. Edit Voice Command

- It provides a function to alter voice commands
- Choose a device to alter voice commands

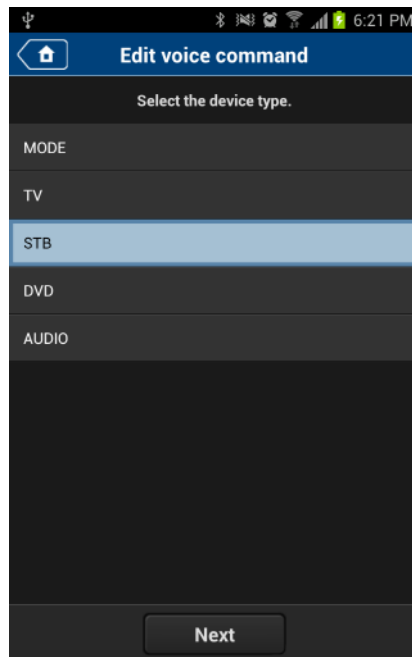

- Choose a voice commands to alter

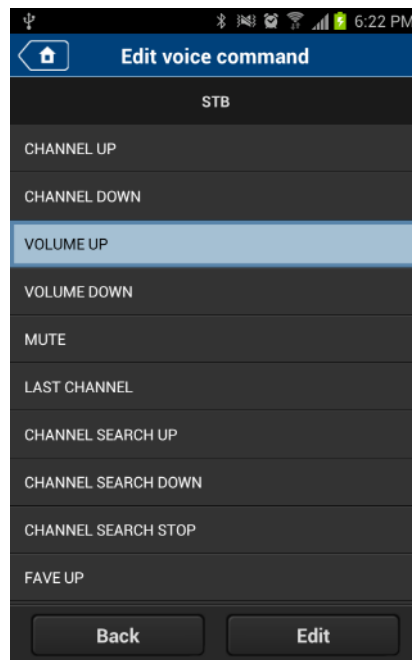

- Write new voice command on the current using command and press OK to save
- Users can also use default voice commands

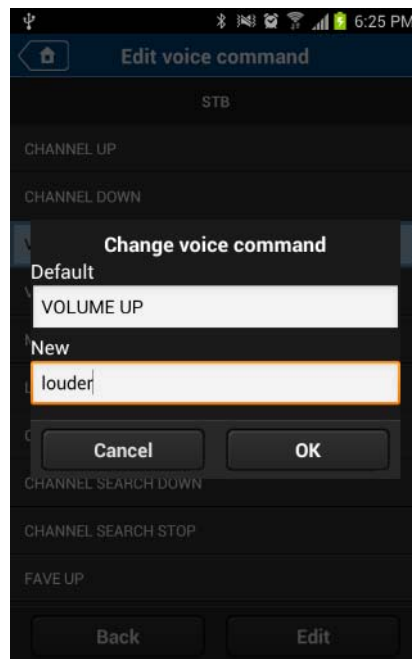

7.5. Voice command list

- Shows every voice commands that application supports

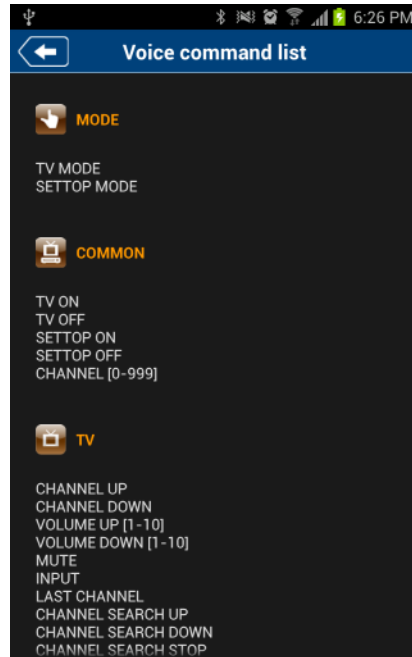

7.6. Voice command channel

- As in broadcasting channels voice commands, set TV and Set-top box's channels, and voice recognize the broadcasting channel, to set TV or set-top box's channel.
- For example, if it is KBS, write as figure below and provide voice command as 'KBS', on TV MODE, it will input 7 or on SET-TOP MODE, it will input 21.
 - ✓ Voice commands : KBS
 - ✓ Television : 7
 - ✓ Set-top box : 21
- Choose a channel to set. If it is not set, it is set as channel.

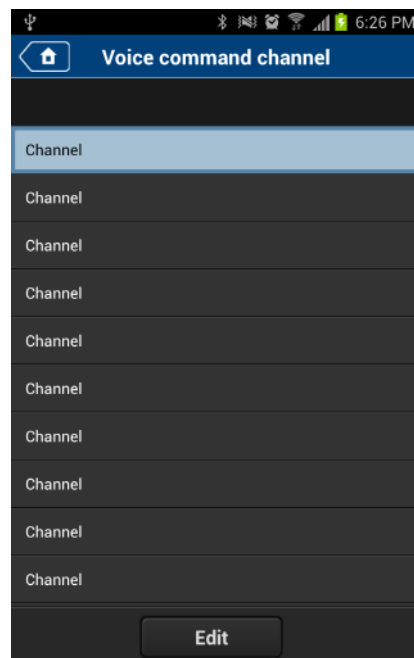

- Input channel's information
 - ✓ Voice Command : word which will be used in voice command
 - ✓ Television : channel number on TV
 - ✓ Set-top box : channel number on Set-top box.
- When inputting is done, press OK

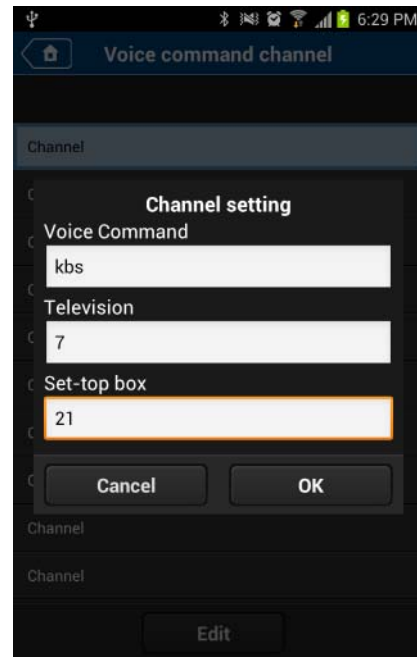

FCC Information to User

This equipment has been tested and found to comply with the limits for a Class B digital device, pursuant to Part 15 of the FCC Rules. These limits are designed to provide reasonable protection against harmful interference in a residential installation. This equipment generates, uses and can radiate radio frequency energy and, if not installed and used in accordance with the instructions, may cause harmful interference to radio communications. However, there is no guarantee that interference will not occur in a particular installation. If this equipment does cause harmful interference to radio or television reception, which can be determined by turning the equipment off and on, the user is encouraged to try to correct the interference by one of the following measures:

- Reorient or relocate the receiving antenna.
- Increase the separation between the equipment and receiver.
- Connect the equipment into an outlet on a circuit different from that to which the receiver is connected.
- Consult the dealer or an experienced radio/TV technician for help.

Caution

Modifications not expressly approved by the party responsible for compliance could void the user's authority to operate the equipment.

FCC Compliance Information : This device complies with Part 15 of the FCC Rules. Operation is subject to the following two conditions: (1) This device may not cause harmful interference, and (2) this device must accept any interference received, including interference that may cause undesired operation

IMPORTANT NOTE:

FCC RF Radiation Exposure Statement:

This equipment complies with FCC RF radiation exposure limits set forth for an uncontrolled environment.

The antennas used for this transmitter must be installed to provide a separation distance of at least 25 cm from all persons and must not be co-located or operating in conjunction with any other antenna or transmitter.

CAUTION

To reduce the risk of electric shock, do not remove the top cover (or the rear section).
No user serviceable parts inside, refer servicing to qualified personnel.



This symbol, wherever it appears, alerts you to the presence of uninsulated dangerous voltage inside the enclosure-voltage that may be sufficient to constitute a risk of shock.



This symbol, wherever it appears, alerts you to the important operating and maintenance instructions in the accompanying literature. Please read the manual.

- 1) Read these instructions.
- 2) Keep these instructions.
- 3) Heed all warnings.
- 4) Follow all instructions.
- 5) Do not use this equipment near water.
- 6) Do not use near any heat sources such as radiators, heat resistors, stove, or other equipment that produce heat.

CAUTION
RISK OF EXPLOSION IF BATTERY IS REPLACED
BY AN INCORRECT TYPE.
DISPOSE OF USED BATTERIES ACCORDING
TO THE INSTRUCTIONS

European CE notice to users and product statements

This product is CE marked according to the provisions of the R&TTE Directive(99/5/EC). Hereby, Next Generation Home Products declares that this product is in compliance with the essential requirements and other relevant provisions of Directive 1999/5/EC.

For further information, please contact [http:// www.nextgen.us](http://www.nextgen.us)

CE1177

Next Generation Home Products

8064 Washington St. Port Richey, FL 34668, U.S.A

Tel: 727.834.9400 / Fax: 727.846.1788

URL: www.nextgen.us