

6 Attach the Cel-Fi Unit to the wall mounted bracket.

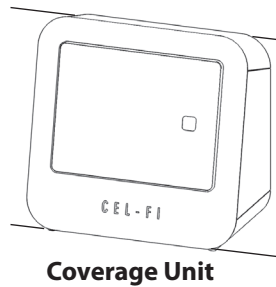

6b Optional: Attach the Cel-Fi Unit to a ceiling mounted bracket.

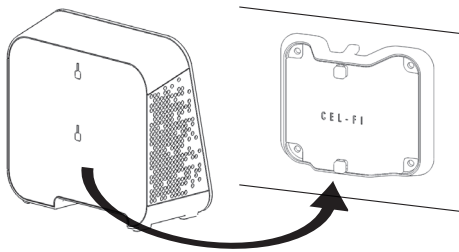
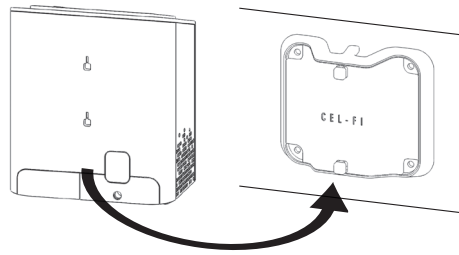
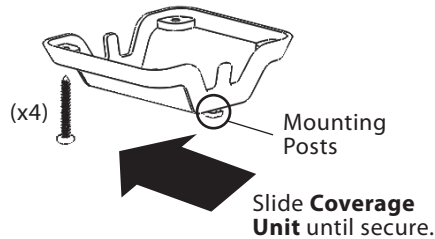
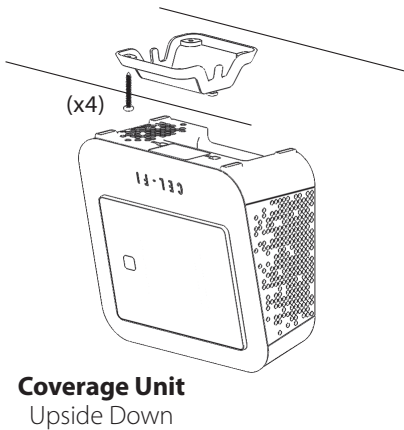

To ensure ceiling mounting is as secure as possible, confirm that the mounting bracket posts are firmly inserted, and in the correct position.

For more information, visit www.Cel-Fi.com

Copyright © 2014 by Nextivity, Inc. U.S. Patents pending. All rights reserved. The Nextivity and Cel-Fi logos are registered trademarks of Nextivity Inc. All other trademarks or registered trademarks listed belong to their respective owners. Designed by Nextivity Inc in California.



Mounting Instructions for Cel-Fi PRO

Network Unit



Coverage Unit



Each Cel-Fi Device may be supplied with mounting brackets and hardware to mount both (or either) the **Coverage Unit** and the **Network Unit**.

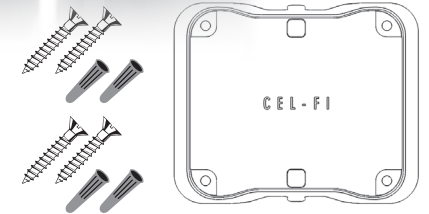

NOTE: The brackets come equipped with screws and inserts for mounting in standard drywall. Before you install the mounts, make sure there are no wires or other objects, or metal plates, behind the drywall layer that will interfere with the inserts, screws, or mount, or mounted units.

NOTE: The **Network Unit** only has mounting holes on the back. The **Coverage Unit** has mounting holes on the bottom and on the back. The holes on the bottom of the **Coverage Unit** can be used for mounting the **Coverage Unit** on a ceiling. (See 6b)

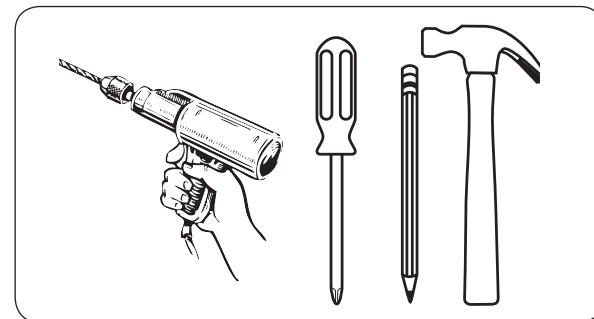

REQUIRED HARDWARE

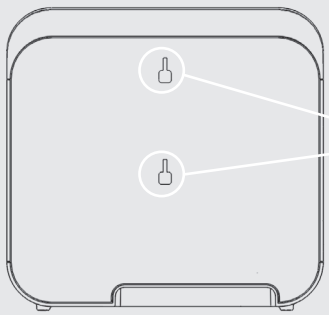

Coverage Unit
Back Mounting Holes

Figure 1. Coverage Unit, back view with mounting holes.

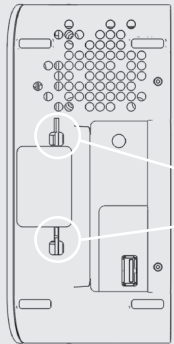

Coverage Unit
Bottom Mounting Holes

Figure 2. Coverage Unit, bottom view of mounting holes.

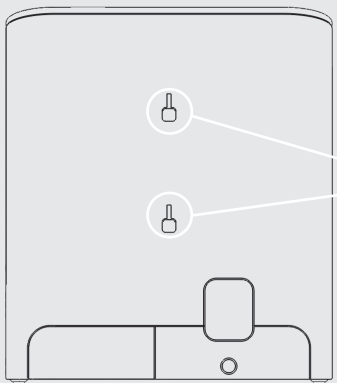

Network (Window) Unit
Back Mounting Holes

Figure 3. Network Unit, back view of mounting holes.

1 Determine Cel-Fi Device Location (refer to Quick Start Guide)



2 Determine Mounting Hole Locations

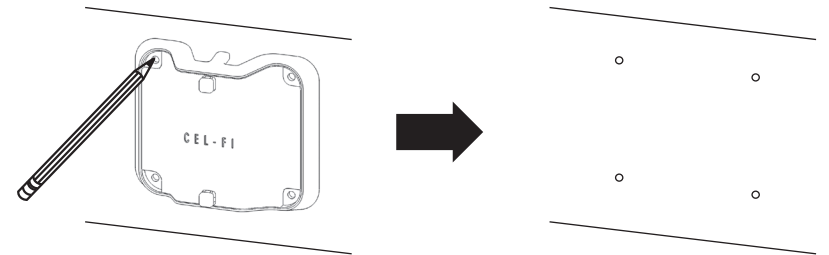

3 Drill Anchor Holes (Drywall)

In each marked spot, use a 3/16" **drill bit** to drill guide holes for the anchors.

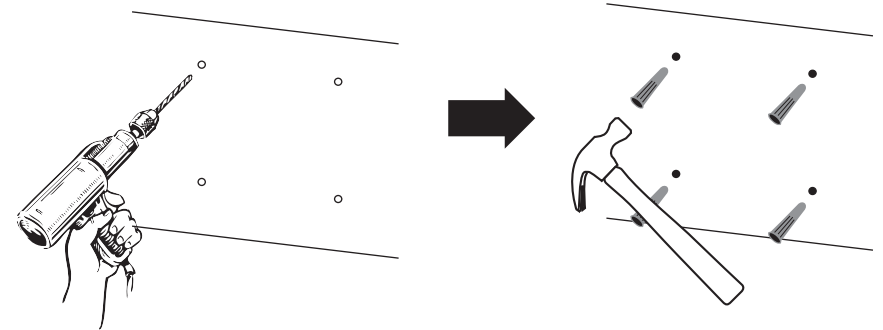

4 Install Anchors (Drywall)

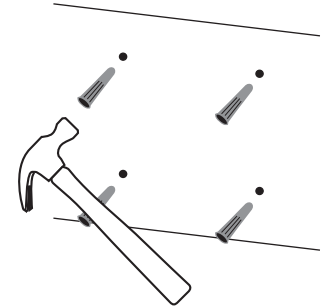

5 Install Mounting Bracket

