

1/18Scale
MANUAL OF INSTRUCTIONS

EXECUTOR

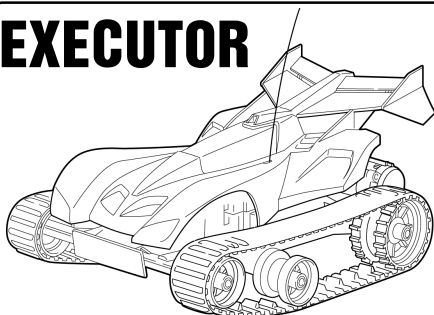

* Read the following instructions carefully before playing.

Repair and Parts Department
Monday to Friday 8:30AM-5:30PM
Central Time

Repair:(800)736-4556

Parts:(800)776-4556

Fax:(972)578-7059

e-mail:nikkocs@airmail.net

RECHARGING

Charger

Household outlet

Ni-Cd battery
pack (4.8 V)

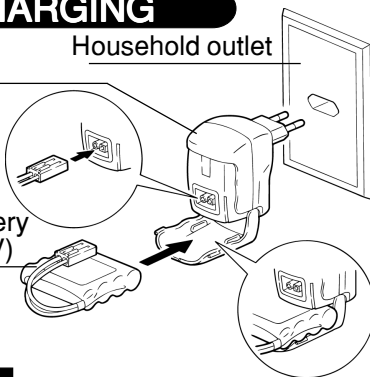

CAUTION:

- Never let the charger or battery pack get wet or damp.
- Over charging can damage the battery pack so observe the prescribed recharging time.
- Do not recharge in high temperatures or bring the battery pack near a flame.
- Do not take the charger or battery pack apart.
- Do not recharge the battery pack while it is still heated after use. Wait until it cools to recharge.

RDC-180031BC

CAUTION: ELECTRIC TOY

Not recommended for children under 8 years of age. As with all electric products, precautions should be observed during handling and use to prevent electric shock. Input: 120 vac, 60 HZ 6W only.

Output: 6VDC, 200MA

ATTENTION PARENTS

It is recommended that this toy and all accessories be periodically examined for potential hazards and that any potentially hazardous parts be repaired or replaced.

NIKKO
AMERICA, INC

CHARACTERISTICS

1. 2-channel full function/high-speed spin turns possible
2. twin motor system
3. wide rubber caterpillars
4. rear suspension system

BATTERIES USED

Vehicle: Ni-Cd battery pack(4.8V)x1

Transmitter: 006P(9V)dry cellx1

1. Join the connector of the charger to the connector of the Ni-Cd battery pack (4.8V).
2. Plug the charger into an electrical outlet.
3. Recharge for about 4-5 hours.
4. When the recharging is over, plug out the charger from the electrical outlet and detach the connectors.

- When detaching the plug or connectors, don't pull the cords or wires (as they can be severed).
- Be sure to detach the Ni-Cd battery pack from the vehicle before recharging.
- The Ni-Cd battery pack should be recharged under the supervision of an adult.
- Do not use any other kinds of batteries except the types specified here.

1.HOW TO INSTALL THE BATTERIES

Transmitter

006P(9V)dry cell battery

Vehicle

Make sure that the power switch on the vehicle body is turned OFF.

- 1.Turn the lid stopper and open the battery box lid.
- 2.Plug the connector on the cord extending from the Ni-Cd battery side into the connector socket and close the battery box lid.

Make sure that the connector is positioned in the right direction.

Don't bring the batteries near a fire!
Install the batteries in the right direction!

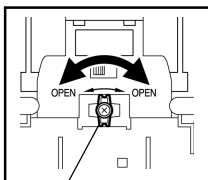

Lid stopper

Ni-Cd battery pack(4.8V)

Battery box lid

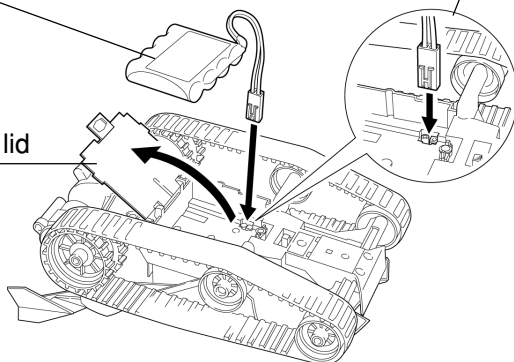

2.HOW TO PLAY

- ① Turn the power switch of the vehicle ON.

OFF  ON



②



Forward

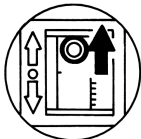

Right turn

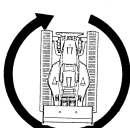

Reverse

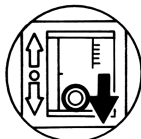
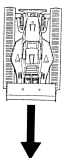

Left turn

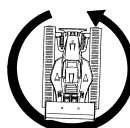

- ③ Turn OFF the power switch on the vehicle after playing.

OFF  ON



- ④ Remove all the batteries after playing to prevent damage from battery leakage.

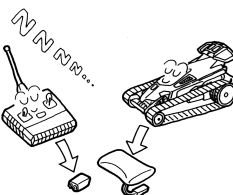

OPERATING SAFETY RULES

Select a **SAFE** place to operate your vehicle. Do not drive in the street. Avoid driving on **SAND** or through puddles of **WATER**. These hazards can impair performance. Check the surface ahead of you and watch for obstacles.

The radio receiver in your vehicle and transmitter are sensitive instruments. Do not leave Vehicle or Transmitter near sources of **HEAT** or under **DIRECT SUNLIGHT** for long periods of time.

Avoid leaving Vehicle or Transmitter **OUTSIDE OVERNIGHT**. **NIGHT DAMPNESS IS HARMFUL TO INTERIOR MECHANISM.**

Cleaning and maintenance:

This toy vehicle needs periodic maintenance and cleaning.

Warning to the parents:

The charger for the Ni-Cd battery pack needs periodic inspection to see that the lead wires, plugs, outer case, and other parts are not damaged in any way. If any of the parts are damaged, do not use the charger until it is completely repaired.

Caution:

Keep out of reach of small children under 36 months old as there is danger of getting hurt.

*** CHANGES OR MODIFICATIONS NOT EXPRESSLY APPROVED BY THE MANUFACTURER FOR COMPLIANCE COULD VOID THE USER'S AUTHORITY TO OPERATE THE EQUIPMENT.**

RADIO INTERFERENCE: Sometimes erratic behavior or loss of control of vehicle is the result of interference caused by high tension wires, high voltage transformers, certain types of building, concrete walls or narrow places where **RADIO SIGNALS** sent from your transmitter **MAY BE SCATTERED** thus making it **DIFFICULT** for your vehicle to receive a **GOOD RADIO SIGNAL**. If you encounter this type of behavior or loss of control, **CHANGE TO A DIFFERENT LOCATION**.

You will encounter **INTERFERENCE** if **ANOTHER** radio controlled vehicle or **CB radio** is operating in the vicinity on your **SAME FREQUENCY**.



THE RBRC™ Seal on the nickel cadmium battery pack indicates that NikkoAmerica is voluntarily participating in an industry program to collect and recycle these batteries at the end of their useful life. The RBRC program provides a convenient alternative to disposing nickel-cadmium batteries into the trash or municipal waste stream, which is illegal in some areas.

Nikko America's payments to RBRC makes it easy for you to drop off the spent battery pack at local retailers who sell replacement nickel-cadmium batteries.

You may also contact your local recycling center for information on where to return the spent battery pack.

RBRC is a trademark of the Rechargeable Battery Recycling Corporation.

THE FCC WANTS YOU KNOW

This device complies with part 15 of the FCC Rules, Operation is subject to the following two conditions:

(1) This device may not cause harmful interference.

(2) This device must accept any interference received, including interference that may cause undesired operation.

Your R/C car might cause TV or radio interference even when it is operating properly.

To determine whether your R/C car is causing the interference, turn off your R/C car.

If the interference goes away, your R/C car is causing the interference.

Try to eliminate the interference by:

- Moving your R/C car away from the receiver.

- Contacting your local store for help.

If you cannot eliminate the interference, the FCC requires that you stop using your R/C car.