



# HUMMER<sup>®</sup>

## 4-Wheel-Drive

### OWNER'S MANUAL

#### 7.2V RADIO CONTROL

Please read carefully before starting to operate.  
Recharge the battery before you start to operate.  
Keep the display box and the manual for future reference.  
**WARNING!** Use under the direct supervision of an adult  
Actual product may vary from illustration of this manual.

#### BATTERY REQUIREMENTS

Vehicle: Ni-Cd rechargeable battery pack  
(7.2V, 1200-1600mAh)  
Transmitter: 1 x 9V(006P) battery

**ATTENTION PARENTS:** It is recommended that toy and all accessories be periodically examined for potential hazards and that any potential hazardous parts be repaired or replaced.

FAST LANE is a mark of/  
es una marca de Geoffrey, Inc.  
© Geoffrey, Inc.  
Distributed by / Distribué près  
Toys"R"Us, Inc., Wayne, NJ 07470  
Printed in Malaysia / Imprime en Malaisie



[www.toysrus.com](http://www.toysrus.com)

KMNA-060009  
NM0-010605

## CAUTION- ELECTRIC TOY

NOT RECOMMENDED FOR  
CHILDREN UNDER 8 YEARS  
OF AGE. AS WITH ALL  
ELECTRIC PRODUCTS,  
PRECAUTIONS SHOULD  
BE OBSERVED DURING  
HANDLING AND USE TO  
PREVENT ELECTRIC SHOCK.

INPUT: 120VAC, 60HZ

11W

OUTPUT: 9 VDC, 500MA

## RECHARGING

**"WARNING! USE UNDER THE DIRECT SUPERVISION OF AN ADULT."**

- The newly purchased Ni-Cd pack is not charged. Charge before operating.

1. Join the connector of the charger to the connector of the Ni-Cd battery pack.
2. Plug the charger into an electrical outlet.
3. Recharge for about 4-5 hours.
4. When the recharging is over, plug out the charger from the electrical outlet and detach the connectors.



### BATTERY CHARACTERISTICS AND RECHARGING TIPS

When playing for the first time after purchase, or after a long interval, the battery power may be weak. Even after recharging, the playing time can be relatively short. The battery will gradually regain power after 2 or 3 repetitions of usage and recharging.

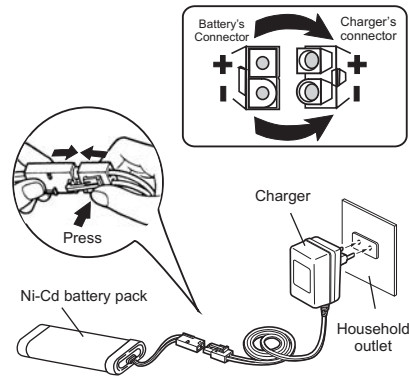

## CAUTION

- Do not charge Battery Pack immediately after use. Wait until it has cooled before charging.
- Avoid short circuits. Short circuits will cause overheating, burning of the cords and other damages to the battery Pack and Charger.
- The Ni-Cd Battery Charger should be used for charging one Battery Pack. Do not use the Charger for charging other type of batteries and battery packs
- Do not use the Charger as a direct current outlet for other electrical appliances or machines.
- Make sure that the Battery Pack and Charger are kept out of the hands of infants and small children while charging.
- Do not charge near fires, where the temperature is extremely high, or where it is wet or damp.
- The charger will become slightly heated while charging. Allow sufficient free space around the Charger.
- If the power of the battery pack is weak in spite of proper charging, the batteries may be worn out from repeated use. Replace it with a new Ni-Cd battery pack.
- Dispose of use Ni-Cd battery packs correctly.
- Disconnect the supply before making or breaking connections to the battery.
- Only use batteries or accumulators of the recommended type or a similar type.

### WARNING AGAINST RECHARGING NON-RECHARGEABLE BATTERIES.

- Please use this battery charger only for the charge of the rechargeable battery pack.
- The Ni-Cd battery pack should be charged under the supervision of an adult.

## VEHICLE

### TOP VIEW

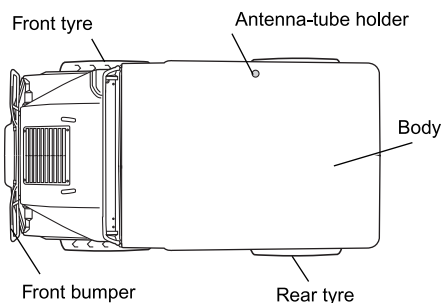

### BOTTOM VIEW

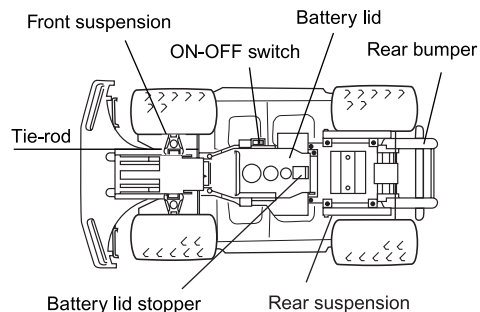

## PREPARATION FOR STARTING OPERATION

### 1. ATTACHING ANTENNA TUBE

Pass the antenna wire through the antenna tube, then insert the tube into the antenna tube holder.

If the antenna tube cannot be successfully inserted into the antenna tube holder, try holding the root of the antenna wire with fingers of one hand and extending the wire with fingers of the other hand.

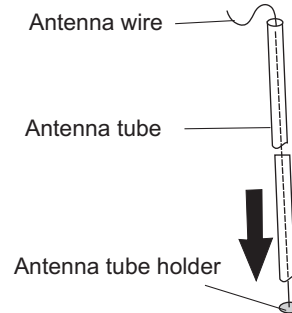

**\* Note: Be careful not to pull antenna wire too strong.**

### 2. INSTALLING TRANSMITTER ANTENNA

Place the transmitter antenna into the antenna holder to screw it in clock-wise.

Do not extend the antenna when installing. It's dangerous.

If the antenna is not screwed in securely, the vehicle may move erratically. Screw the antenna securely.

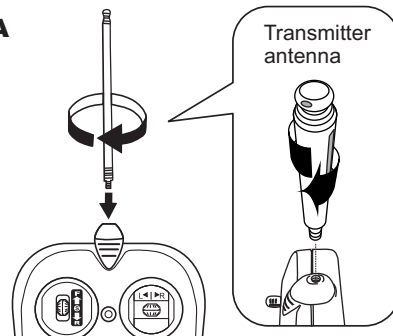

### 3. INSTALLING THE BATTERIES TRANSMITTER

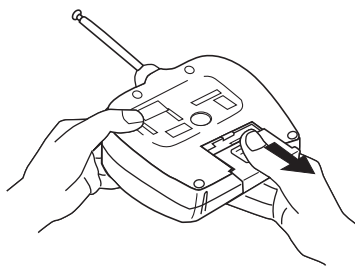

To remove the battery lid, press the point marked "OPEN" and pull the lid downward.

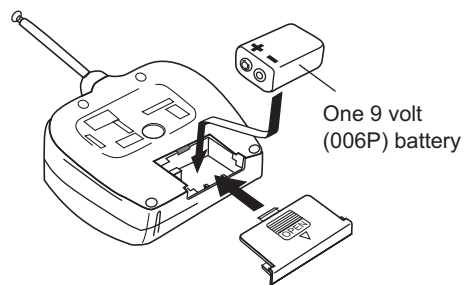

Install battery make sure that (+) and (-) poles are positioned properly.

**\* Dispose the used batteries separately from other trash.**

## VEHICLE

When installing a Ni-Cd battery pack, make sure that the power switch of the vehicle is OFF.

1. Slide the ON/OFF switch under the vehicle to OFF

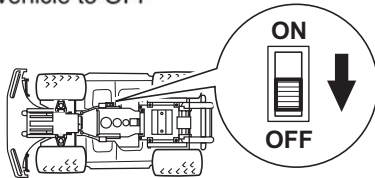

2. Lift the battery compartment's tab and slide the cover in the direction of the arrow marked on it and lift open.



3. Insert the battery pack in the compartment with the connector's side down and away from the vehicle's connector, but inside the vehicle's frame.

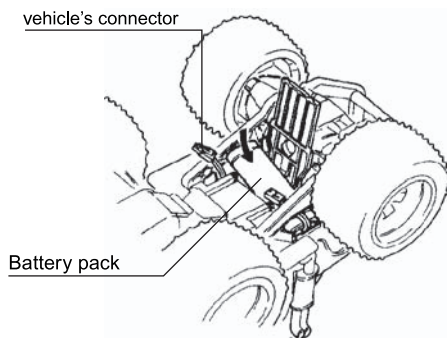

To remove the battery pack, unplug the connectors and open the cover as described in Step 2. Then slide the pack toward the pack's connector and lift the other side of the battery pack.

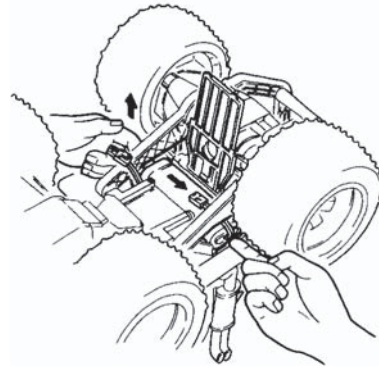

**NOTE:** If you want to run your vehicle for extended periods of time, we suggest you purchase an extra battery pack. You can charge one while you use the other.

4. Close the cover and snap it shut.
5. Attach the battery pack's connector to the vehicle's matching connector. Do not force them. They fit together only one way.

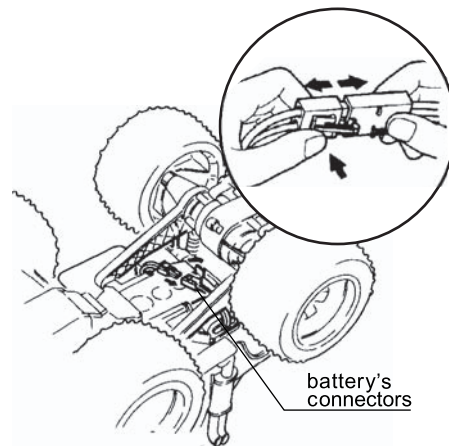

**CAUTION:** Be sure the connectors and wires do not touch any of the vehicle's moving parts. If the vehicle loses power or does not respond to the transmitter, recharge the battery pack. When you disconnect the connectors, don't pull by the wires. Avoid short circuit it is very dangerous. Do not take the Ni-Cd battery apart or try to remodel it.

## USING THE CONTROLLER

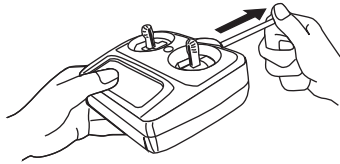

- (1) Extend transmitter antenna to its full length. The vehicle can be controlled from a long distance by holding the transmitter higher with the antenna straight up.

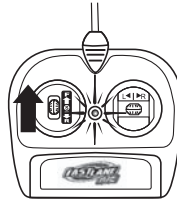

- (2) Turn on the transmitter by operating the control stick. (The power indicator will light up.)



- (3) Turn "ON" the vehicle.

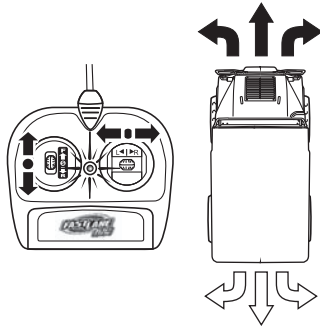

- (4) Start operating the vehicle.

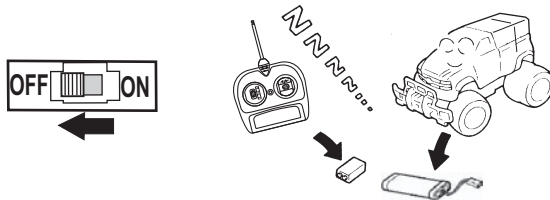
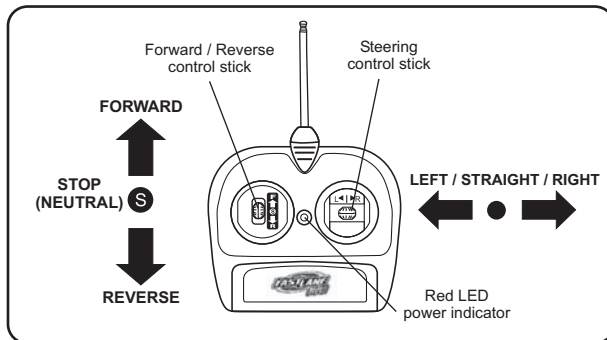

- (5) Turn "OFF" the vehicle.

- (6) Remove all the batteries from the vehicle and the transmitter.

### CAUTION:

- When the vehicle slows down or starts moving erratically, replace vehicle's battery with fresh or fully charged one.
- This vehicle is very fast. Operate the vehicle carefully.
- To protect the racer's motor, let it cool for at least 20 minutes after you use up a battery pack.

## ADJUSTING WORKING LIGHT FUNCTION

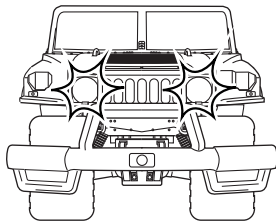

The head lights light up when the vehicle is in "FORWARD or REVERSE" position.

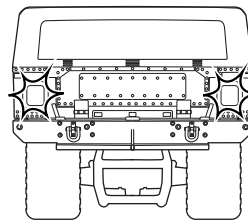

The tail lights light up when the vehicle is in "STOP" position.

### TO ADJUST STEERING ALIGNMENT

Adjust the steering alignment when the vehicle does not run straight forward.

Turn the steering alignment lever towards "L" if the vehicle runs towards right.

Turn the steering alignment lever towards "R" if the vehicle runs towards left.

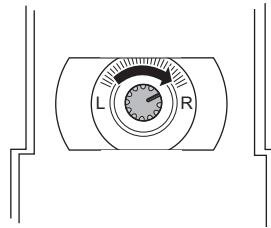
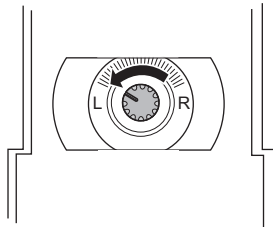

### TROUBLE SHOOTING

• Please read this section before deciding that the vehicle is broken.

THE VEHICLE DOES NOT MOVE	
EXAMINE	SOLUTION
If the batteries of the vehicle or transmitter are weak and out of power.	Fully recharge the Ni-Cd battery pack of the vehicle. Replace the transmitter battery with a new one.
If the (+) and (-) ends of the transmitter battery are positioned in the wrong direction.	Take out the battery and position it properly.
If there is rust or dirt on the metal tabs touching the transmitter battery.	Remove the rust or dirt with some fine grain sand paper.



### CAUTION

- Check the batteries regularly for leakage.
- Remove empty batteries from the toy.
- Never try to charge non-rechargeable batteries.
- Rechargeable batteries may only be charge under the supervision of an adult.
- When inserting the batteries take care not to reverse their polarity.
- Never use batteries of different manufacturers, and do not mix old and new batteries.
- Use only the recommended batteries or batteries of equal quality.
- Never short-circuit the terminals.
- Rechargeable batteries which can be recharged must be removed from the toy prior to charging.

### OPERATION SAFETY RULES



Select a SAFE place to operate your vehicle, Do not drive in the street. Avoid driving on SAND or through puddles of WATER. These hazards can impair performance. Check the surface ahead of you and watch for obstacles.

The radio receiver in your vehicle and transmitter are sensitive instruments. Do not leave Vehicle or Transmitter near sources of HEAT or under DIRECT SUNLIGHT for long periods of time. Avoid leaving Vehicle or Transmitter OUTSIDE OVERNIGHT. NIGHT DAMPNESS IS HARMFUL TO INTERIOR MECHANISM.

### CLEANING AND MAINTENANCE

This toy vehicle needs periodic maintenance and cleaning.

**CAUTION:** DO NOT use chemicals as they can deform or damage the body.

DO NOT operate your vehicle on thick-piled carpets. It can be dangerous since the carpet fiber may twine round a shaft and cause a motor overheated.



### WARNING TO THE PARENTS

The charger for the Ni-Cd battery pack needs periodic inspection to see that the lead wires, plugs, outer case, and other parts are not damaged in any way. If any of the parts are damaged, do not use the charger until it is completely repaired.

**CAUTION**

Keep out of reach of small children under 36 months old as there is danger of getting hurt. CHANGES OR MODIFICATIONS NOT EXPRESSLY APPROVED BY THE MANUFACTURER FOR COMPLIANCE COULD VOID THE USER'S AUTHORITY TO OPERATE THE EQUIPMENT.

**RADIO INTERFERENCE**

Sometimes erratic behavior or loss of control of vehicle is the result of interference caused by high tension wires, high voltage transformers, certain types of building, concrete walls or narrow places where RADIO SIGNALS sent from your transmitter MAY BE SCATTERED thus making it DIFFICULT for your vehicle to receive a GOOD RADIO SIGNAL.

If you encounter this type of behavior or loss of control, CHANGE TO A DIFFERENT LOCATION. You will encounter INTERFERENCE if ANOTHER radio controlled vehicle or CB radio is operating in the vicinity on your SAME FREQUENCY.

**THE FCC WANTS YOU KNOW**

This device complies with part 15 of the FCC Rules, Operation is subject to the following two conditions:

1. This device may not cause harmful interference.
2. This device must accept any interference received, including interference that may cause undesired operation.

Your R/C car might cause TV or radio interference even when it is operating properly.

To determine whether your R/C car is causing the interference, turn off your R/C car.

If the interference goes away, your R/C car is causing the interference.

Try to eliminate the interference by:

- Moving your R/C car away from the receiver.
- Contacting your local store for help.

If you cannot eliminate the interference, the FCC requires that you stop using your R/C car.