

# 1/14 RADIO CONTROL TRUCK

## Owner's Manual

© NIKKO  
PRINTED IN CHINA

Repair and Parts Department  
Monday to Friday 8:30AM-5:30PM Central Time  
Repair : (800)736-4556  
Parts : (800)776-4556  
Fax : (972)578-7059  
e-mail : help@nikkoamerica.com

**NIKKO**  
AMERICA, INC

## CAUTION: ELECTRIC TOY

NOT RECOMMENDED FOR CHILDREN UNDER 8 YEARS OF AGE. AS WITH ALL ELECTRIC PRODUCTS, PRECAUTIONS SHOULD BE OBSERVED DURING HANDLING AND USE TO PREVENT ELECTRIC SHOCK.

INPUT: 120VAC, 60HZ,  
OUTPUT: 7.25VDC, 180mA

## ATTENTION PARENTS

It is recommended that this toy and all accessories be periodically examined for potential hazards and that any potential hazardous parts be repaired or replaced.

**\* Recharge the Battery Before You Start to Operate**

- \* Please read carefully before starting to operate.
- \* Keep the display box and the manual for future reference.
- \* **WARNING!** Use under the direct supervision of an adult.
- \* Actual product may vary from illustration of this manual.

### FEATURES

- 2 channel Full Function
- Runs forward, backward, turns left & right and stops.
- 3 Band Selector Switch.
- Oversized Off-Road tires.
- Impact resistant bumper.

### BATTERY REQUIREMENTS

Vehicle: Ni-Cd battery energy pack (6.0V, 600-800mAh)  
Transmitter: 1x9V(006P) battery

### HOW TO RECHARGE

**"WARNING! USE UNDER THE DIRECT SUPERVISION OF AN ADULT."**

- \* The newly purchased Ni-Cd pack is not charged. Recharge before operate.

- 1 Install the Ni-Cd battery pack into the battery compartment of the battery charger.
- 2 Plug the charger into an ordinary household outlet.
  - \* The (LED) light on charger should light up when the battery pack is being charged.
  - \* Average recharging time is approximately 4 to 5 hours.
- 3 When the recharging is over, remove the charger from the household outlet.
- 4 Push the lever of battery charger and disconnect the battery pack from the battery charger.

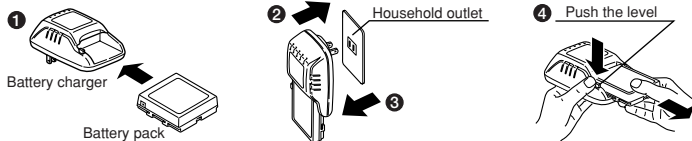

- 1 -

### ✓ BATTERY CHARACTERISTICS AND RECHARGING TIPS

When playing for the first time after purchase, or after a long interval, the battery power may be weak. Even after recharging, the playing time can be relatively short. The battery will gradually regain power after 2 or 3 repetitions of usage and recharging.

### CAUTION :

- \* Do not charge Battery Pack immediately after use. Wait until it is cooled before charging.
- \* Avoid short circuits. Short circuits will cause overheating, burning of the cords and other damages to the Battery Pack and Charger.
- \* The Ni-Cd Battery Charger should be used for charging one Battery Pack. Do not use the charger for charging other types of batteries and battery packs.
- \* Do not use the Charger as a direct current outlet for other electrical appliances or machines.
- \* Make sure that the Battery Pack and Charger are kept out of the hands of infants and small children while charging.
- \* Do not charge near fires, where the temperature is extremely high, or where it is wet or damp.
- \* The charger will become slightly heated while charging. Allow sufficient free space around the Charger.
- \* If the power of the battery pack is weak in spite of proper charging. The batteries may be worn out from repeated use. Replace it with a new Ni-Cd battery pack.
- \* Dispose of use Ni-Cd battery packs correctly.
- \* Disconnect the supply before making or breaking connections to the battery.
- \* Only use batteries or accumulators of the recommended type or a similar type.
- \* **WARNING AGAINST RECHARGING NON-RECHARGEABLE BATTERIES.**
- \* Please use this battery charger only for the charge of the rechargeable battery pack.
- \* The Ni-Cd battery pack should be recharged under the supervision of an adult.
- \* This power unit is intended to be correctly orientated in a vertical or floor mount position.

### CAUTION :

- Check the batteries regularly for leakage.
- Remove empty batteries from the toy.
- Never try to charge non-rechargeable batteries.
- Rechargeable batteries may only be charge under the supervision of an adult.
- When inserting the batteries take care not to reverse their polarity.
- Never use batteries of different manufacturers, and do not mix old and new batteries.
- Use only the recommended batteries or batteries of equal quality.
- Never short-circuit the terminals.
- Removable batteries which can be recharged must be removed from the toy prior to charging.

- 2 -

### PREPARATION FOR STARTING OPERATION

#### 1. HOW TO ATTACH ANTENNA TUBE

- Pass the antenna wire through the antenna tube, then insert the tube into the antenna tube holder.
- If the antenna tube cannot be successfully inserted into the antenna tube holder, try holding the root of the antenna wire with fingers of one hand and extending the wire with fingers of the other hand.

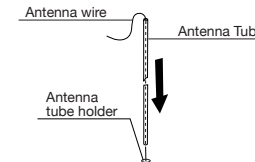

\* Note: Be careful not to pull antenna wire too strong.

#### 2. HOW TO INSTALL THE BATTERY

##### Transmitter

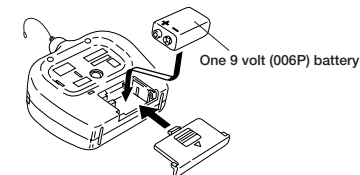
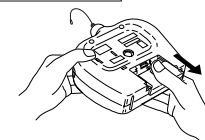

To remove the battery lid, press the point marked "OPEN" and pull the lid downward.

Install battery making sure that (+) and (-) poles are positioned properly.

\* Dispose the used battery separately from other trash.

##### Vehicle

When installing a Ni-Cd battery pack, make sure that the power switch of the vehicle is OFF.

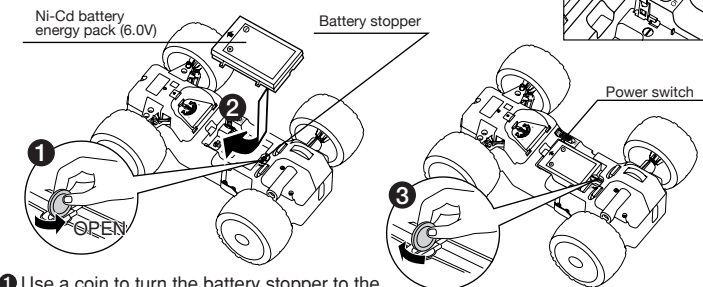

- 1 Use a coin to turn the battery stopper to the "OPEN" position.
- 2 Install the Ni-Cd battery pack into the battery compartment of the vehicle.
- 3 Replace the battery stopper.

### CAUTION:

\* Install battery make sure that (+) and (-) poles are positioned properly.

- 3 -

### 3. HOW TO OPERATE

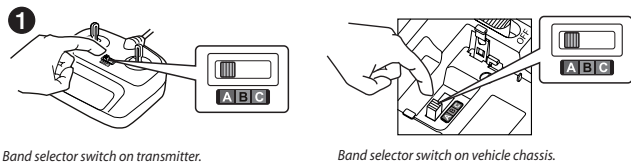

Band selector switch on transmitter.

Band selector switch on vehicle chassis.

- 1 Ensure that band selector switch on transmitter and vehicle are set to the same letter - A, B or C.

#### Race 6 cars at once!

3 bands for frequency 27MHz and 49MHz, allows up to 6 cars to race at once.

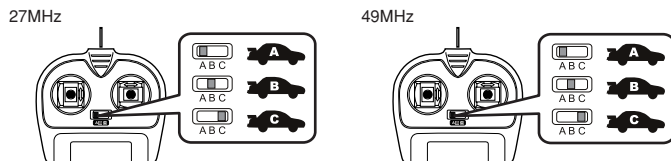

- 2 Turn ON the vehicle.
- 3 Operate the vehicle with transmitter.
- 4 Turn OFF the vehicle after operating.
- 5 Remove all the batteries both from the vehicle and the transmitter.

\* Please follow the above sequence of operation.

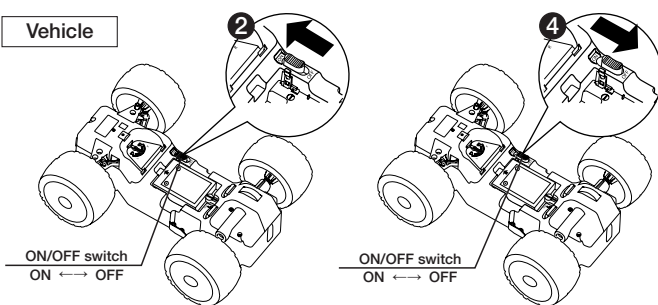

ON/OFF switch  
ON ↔ OFF

ON/OFF switch  
ON ↔ OFF

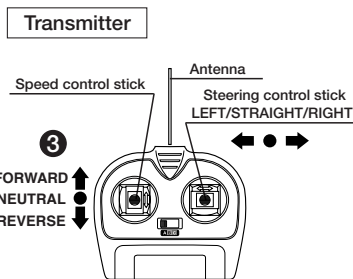

- 3 FORWARD  
NEUTRAL  
REVERSE

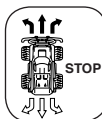

**IMPORTANT:**  
When speed control stick is in NEUTRAL, Steering Wheel WILL NOT produce any steering action.

\*Check to see that the batteries have been INSTALLED in the CORRECT position.

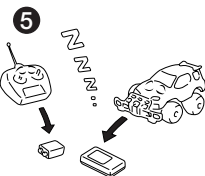

To prevent damage from battery leakage, remove all the batteries from transmitter and vehicle after playing.

#### CAUTION:

\* To protect the racer's motor, let it cool for at least 20 minutes after you use up a battery pack.

#### TO ADJUST STEERING ALIGNMENT

Adjust the steering alignment when the vehicle does not run straight forward.

Turn the steering alignment lever towards "L" if the vehicle runs towards right.

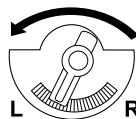

Turn the steering alignment lever towards "R" if the vehicle runs towards left.

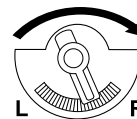

#### ANTI-POWER LOSS TRANSMITTER (To prevent unnecessary power loss)

The transmitter power is automatically turned ON when the speed control stick is operated either to the forward running or reverse running positions. When the stick is returned to the neutral position, the transmitter power is turned OFF. When the transmitter power is turned OFF, the vehicle can be jammed by other transceiver radio waves and start to move abnormally.

#### NOTE:

- You can control the vehicle at a longer distance by holding the antenna straight up.
- When the vehicle slows down or starts moving erratically, replace all the vehicle's batteries with fresh or fully charged ones.

#### OPERATING SAFETY RULES

Select a SAFE place to operate your vehicle. Do not drive in the street. Avoid driving on SAND or through puddles of WATER. These hazards can impair performance. Check the surface ahead of you and watch for obstacles.

The radio receiver in your vehicle and transmitter are sensitive instruments. Do not leave Vehicle or Transmitter near sources of HEAT or under DIRECT SUNLIGHT for long periods of time.

Avoid leaving Vehicle or Transmitter OUTSIDE OVERNIGHT. NIGHT DAMPNESS IS HARMFUL TO INTERIOR MECHANISM.

#### Cleaning and maintenance:

This toy vehicle needs periodic maintenance and cleaning.

#### Warning to the parents:

The charger for the Ni-Cd battery pack needs periodic inspection to see that the lead wires, plugs, outer case, and other parts are not damaged in any way. If any of the parts are damaged, do not use the charger until it is completely repaired.

#### Caution:

Keep out of reach of small children under 36 months old as there is danger of getting hurt.

**IT IS A VIOLATION OF THE FCC REGULATIONS TO REMODEL OR ALTER THIS DEVICE IN ANY WAY WITHOUT PERMISSION. ANYONE WHO VIOLATES THE REGULATIONS WILL LOSE THE RIGHT TO OPERATE THE DEVICE.**

**Caution: CHANGES OR MODIFICATIONS NOT EXPRESSLY APPROVED BY THE MANUFACTURER FOR COMPLIANCE COULD VOID THE USER'S AUTHORITY TO OPERATE THE EQUIPMENT.**

**RADIO INTERFERENCE:** Sometimes erratic behavior or loss of control of vehicle is the result of interference caused by high tension wires, high voltage transformers, certain types of building, concrete walls or narrow places where RADIO SIGNALS sent from your transmitter MAY BE SCATTERED thus making it DIFFICULT for your vehicle to receive a GOOD RADIO SIGNAL. If you encounter this type of behavior or loss of control, CHANGE TO A DIFFERENT LOCATION.

You will encounter INTERFERENCE if ANOTHER radio controlled vehicle or CB radio is operating in the vicinity on your SAME FREQUENCY.

**DO NOT operate your vehicle on thick-piled carpets. It can be dangerous since the carpet fiber may twine round a shaft and cause a motor overheated.**



THE RBRC™ Seal on the nickel cadmium battery pack indicates that NikkoAmerica is voluntarily participating in an industry program to collect and recycle these batteries at the end of their useful life. The RBRC program provides a convenient alternative to disposing nickel-cadmium batteries into the trash or municipal waste stream, which is illegal in some areas.

Nikko America's payments to RBRC makes it easy for you to drop off the spent battery pack at local retailers who sell replacement nickel-cadmium batteries.

You may also contact your local recycling center for information on where to return the spent battery pack.

RBRC is a trademark of the Rechargeable Battery Recycling Corporation.

#### THE FCC WANTS YOU KNOW

This device complies with part 15 of the FCC Rules. Operation is subject to the following two conditions:

- (1) This device may not cause harmful interference.
- (2) This device must accept any interference received, including interference that may cause undesired operation.

Your R/C car might cause TV or radio interference even when it is operating properly.

To determine whether your R/C car is causing the interference, turn off your R/C car.

If the interference goes away, your R/C car is causing the interference.

Try to eliminate the interference by:

- \* Moving your R/C car away from the receiver.
- \* Contacting your local store for help.

If you cannot eliminate the interference, the FCC requires that you stop using your R/C car.