

# Nikko MicroRadioControl System "iBoat"

For ages 6 and over RDC-700500

## Manual of Instructions

- \*Thank you for choosing NIKKO iBoat!
- \*Read this Manual of Instructions carefully to the end before starting to play.
- \*Don't throw away the box or this manual, but keep them for future use.
- \*The actual product may differ slightly from the illustrations.

**ATTENTION PARENTS**  
It is recommended that this toy and all accessories be periodically examined for potential hazards and that any potentially hazardous parts be repaired or replaced.

IT IS A VIOLATION OF THE FCC REGULATIONS TO REMODEL OR ALTER THIS DEVICE IN ANY WAY WITHOUT PERMISSION. ANYONE WHO VIOLATES THE REGULATIONS WILL LOSE THE RIGHT TO OPERATE THE DEVICE.

## Features

- \*The controller (transmitter) has a built-in battery recharger. Attach iBoat to the controller for quick recharging and lasting power.
- \*A large volume, high-power nickel metal hydride battery is built into the boat.
- \*The single-stick controller enables forward-backward running, left-right turns, and stopping with single-hand operations.

### Battery requirements:

Size "AA" "UM3" "R6" alkaline batteries x 2 (No other type of battery should be used)

## Battery Characteristics and Recharging Tips

- When playing for the first time after purchase, or after a long interval, the battery power may be weak. Even after recharging, the running time can be relatively short. The battery will gradually regain power after 2 or 3 repetitions of usage and recharging. Also, if you keep the iBoat power switch turned ON for a long time, the battery power will be discharged. Make sure to turn OFF the power switch immediately after use.
- If the product is used in low temperatures, the battery duration can be shorter than normal. This is a characteristic feature of the battery and is not a defect. The situation can be improved by recharging the battery immediately before playing. The battery power tends to be weakened as time elapses.

**Repair and Parts Department**  
Monday to Friday 8:30AM-5:30PM Central Time  
Repair:(800)736-4556  
Parts:(800)776-4556  
Fax:(972)578-7059  
e-mail:help@nikkoamerica.com

**NIKKO**  
AMERICA, INC

-1-

## CONTROLLER

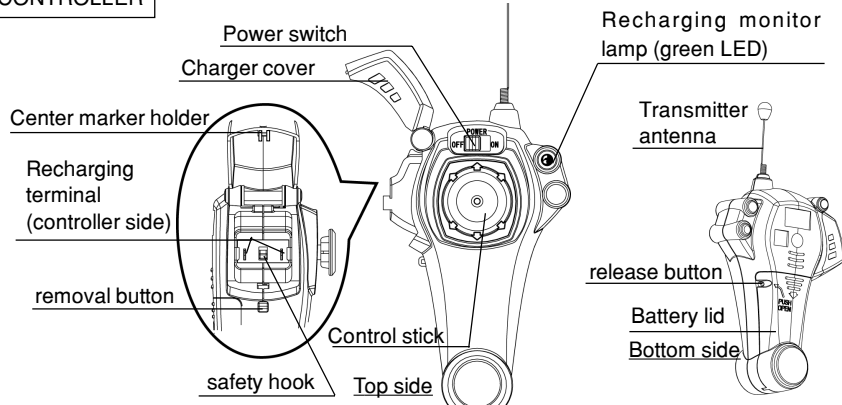

## How to Install the Controller Batteries

- 1 Use a ballpoint pen to open the battery lid.
  - 2 Install 2 alkaline batteries
  - 3 Fit into the groove.
  - 4 close the lid.
- To remove the bottom battery more easily, press the minus (-) end with your finger and pull out the plus (+) end.

### Battery installation:

- \*Install the batteries in the controller. (This product operates only with size "AA" "UM3" "R6" alkaline batteries. If you use manganese or other types of batteries, the nickel metal hydride battery built into the boat may not be recharged fully. Be sure to use ONLY alkaline dry cell batteries.)
- Make sure that the power switch of the controller is turned OFF.
- Use a ballpoint pen, pencil or sharp tools to push the release button of the battery lid. While pressing the button, slide the lid a little bit as shown in the diagram. \*Slide out the lid with your hand and detach.
- \*Be careful so that the pencil lead will not be broken.
- Install 2 size "AA" "UM3" "R6" alkaline batteries, making sure that the (+) and (-) ends are positioned properly.
- Attach the battery lid again. Slide the lid back into position until the release button clicks. (Lift up the rear end of the battery lid slightly to fit the lid into the groove as shown in the diagram. Then, keep the lid flat and slide into the groove.)

## Follow the correct procedures when recharging.

When the battery starts to run out of power, the LED lamp will grow dim.

-3-

## Contents of the Kit

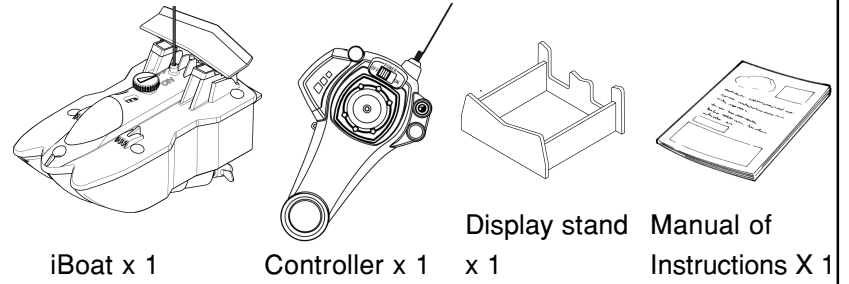

## Names of the Parts

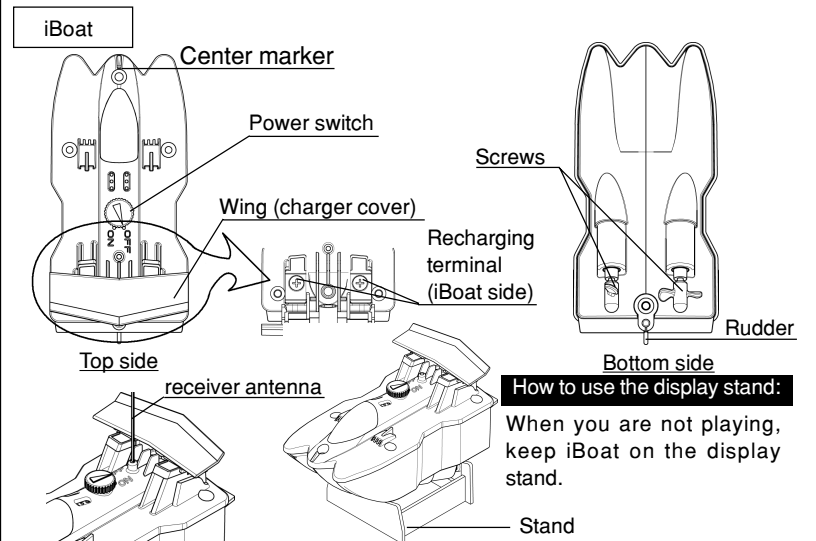

The CONTROLLER is not waterproofing. However, if it should accidentally be submersed in water, or if the internal parts should get wet, remove the batteries immediately and wait until the internal parts are completely dry. Reinstall the batteries and resume operation.

-2-

## Procedures for Recharging iBoat (Remove dust or filth from the charger contacting point.)

Before recharging, wipe off all the water and dampness from the boat. To remove the water remaining in the hull, turn the boat over as shown.

- 1 Turn OFF the power switch of the boat. (You cannot recharge while the power switch of the boat is turned ON.)
- 2 Controller Power switch ON
- 3 Open the charger cover

- 4 Wing (charger cover) is opened receiver antenna  
Before attaching the boat to the controller, bend the antenna toward you to keep it from getting in the way when recharging.  
Push back with your thumb and slide to the position indicated in the diagram.

When recharging, make sure that iBoat on the under side of the controller. If iBoat is on top of the controller, there is the danger that water might seep into the controller terminal and cause short circuits.

- 5 Fit the claw of the controller into the hollow pit in the body of iBoat.
- 6 Slide iBoat forward until you hear a click.

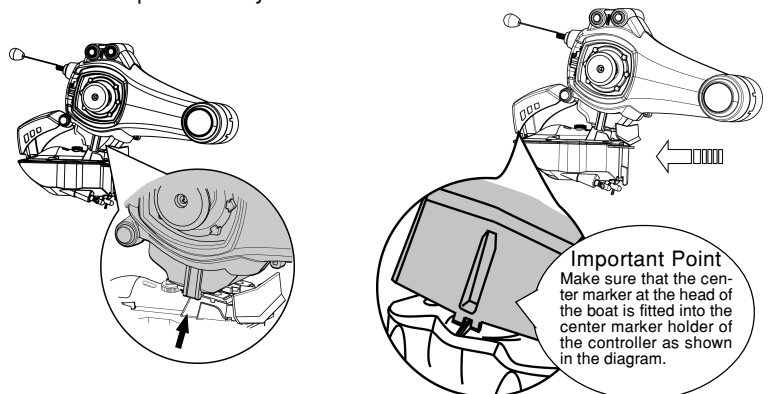

-4-

⑦ The set-up is completed! Check to see that iBoat does not fall off.

⑧ The green LED lamp lights up. The ordinary recharging time is about 2 minutes. (The LED lamp will go out when recharging is completed.)

When you have finished recharging, detach iBoat from the controller and replace the recharger cover and wing.

⑨ There is a safety hook on the controller to prevent iBoat from falling off while recharging. When iBoat is fully recharged, the green LED lamp will turn off. When this has been confirmed, keep pressing the recharging release button on the side of the controller, and pull iBoat toward you to detach it from the controller.

**CAUTION:** Be sure to return the wing (charger cover) to its original position before starting to operate iBoat.

If the wing is not fully returned to its proper position, water can seep into the hull or recharging terminal and cause short circuits. Improper replacement of the wing may damage the stopper clasp as well.

1. Lift the wing up so that it comes directly over the recharging terminal.  
2. Make sure that the drain hole cap fits into the water drain hole and push straight down until the clasp clicks and fits into position.

### How to Operate

**CAUTION:** Before starting to play, make sure that the antenna is standing vertically upright. If the antenna is bent to the left or right, it will affect the balance.

\* First, turn ON the controller power switch, and then turn ON the iBoat power switch.  
\* Tilt the controller stick in the direction you wish to move iBoat, and it will start moving.  
\* If either the antenna on iBoat or the controller is bent, the radio waves will not reach a long distance. Straighten them before playing.  
\* When you finish playing, turn OFF the power switch of iBoat and the controller, and be sure to remove the batteries from the controller.

### Steering Alignment

If iBoat does not move straight forward or straight backward, try adjusting the rudder on the bottom side of iBoat. If the boat tends to go to the right, move the rudder toward L. If the boat tends to go to the left, move the rudder toward R.

### \* Operation Techniques \*

For smooth cornering, move the stick slightly forward or reverse and then slide it to the left or right. This will enable smooth left/right turns. If you master this basic technique, you will be able to make a letter "8", slalom, etc. This cornering technique will enable the user to operate in small pools, etc.

Features of the controller  
Single-stick controller enables single-hand operation for all movements.

Operation mechanism  
iBoat is propelled by a 2-motor 2-screw system. When both screws turn at the same speed, iBoat moves straight forward. When you operate the controller to move to the left/right, the motor on the side you wish to advance stops to change the direction of the boat. If you want to turn right, the right screw stops. If you want to turn left, the left screw stops.

### \*Be careful of the screws!

The screws are very dangerous when spinning. Don't bring your fingers near the screws!

### Extended Operating Time (follow-up recharging)

Recharge the battery once. Without using the battery, recharge a second time. This "follow-up recharging" will lengthen the playing time. Moreover, if you recharge the battery 3 times in a row before use, the playing time will be extended even more. However, be careful NOT to recharge the battery more than 3 times in a row. Also, note that the battery duration differs depending on how you play.

### If there is anything wrong with the boat movements, check the following:

What's wrong?	Cause	Check and see
The boat doesn't move or it malfunctions.	① The power switch on iBoat is in the OFF position.	① Turn ON the power switch on iBoat.
	② The boat is too far away from the controller.	② Shorten the distance between the controller and iBoat.
	③ The (+) and (-) poles of the batteries of the controller are positioned in the wrong direction.	③ Install the batteries in the right direction.
	④ The metal tab touching the controller battery is rusted.	④ Use sandpaper to remove the rust.
	⑤ The metal recharging terminals of the controller or boat may be rusted.	⑤ Use sandpaper to remove the rust.
	⑥ Either the controller batteries or iBoat battery lack power.	⑥ Either change the controller batteries with new ones or recharge iBoat as necessary.
	⑦ There is another radio control boat using the same band being operated nearby.	⑦ Play at a different time or in a different place.
	⑧ The antenna of the controller or iBoat is bent.	⑧ Straighten the antenna.

### Maintenance and Care

If the boat becomes dirty, use a slightly dampened cloth to wipe off the dirt and filth. Then use a dry cloth to wipe of the moisture. You can also use a small brush to remove filth from intricate parts.

To remove dust particles, tie a small bit of cloth to the tip of a toothpick, tweezers, etc. and wipe off.

**CAUTION!** : BE SURE TO READ THE FOLLOWING PRECAUTIONS:  
\*DO NOT use chemicals. The body of the boat can melt and cause machine troubles.  
\*If you keep the boat in a place where the temperature is extremely hot or cold, or where it is extremely humid (such as in a car or under direct sunlight), the boat can be damaged and lead to machine troubles.  
\*Be sure to remove the batteries from the controller when storing the product away.  
Keep this Manual of Instructions carefully for future use.

### CAUTION!

iBoat is operated by use of radio waves. If you operate iBoat where it can be affected by other radio waves, the boat may not respond correctly to your operations, or start to move even though you are not operating it. In such cases, the boat is not broken. Operate your boat in a different place or at a different time.

To play safely, observe the following:  
\*DO NOT operate iBoat where there are water plants, garbage, filth, or other obstacles. Such obstacles may damage the screws.  
\*DO NOT play where the water current is strong or when the wind is blowing strongly.  
\*DO NOT play in ocean water, because salt water can cause rusting.  
\*DO NOT play in thunderstorms.  
\*NEVER touch the screws when they are spinning!  
\*Take iBoat out of the water before the battery power runs out.  
\*Bring the wing (charger cover) back to its normal position before operating iBoat. If you operate iBoat with the wing in the recharging position, the recharging terminal can get wet. This is very dangerous!  
\*The manufacturer prohibits the user to alter the specifications or to remodel the product in any way. Those who violate this rule will be prohibited from operating iBoat.

**THE RBRC™ Seal on the nickel cadmium battery pack indicates that NikkoAmerica is voluntarily participating in an industry program to collect and recycle these batteries at the end of their useful life. The RBRC program provides a convenient alternative to disposing nickel-cadmium batteries into the trash or municipal waste stream, which is illegal in some areas. Nikko America's payments to RBRC makes it easy for you to drop off the spent battery pack at local retailers who sell replacement nickel-cadmium batteries. You may also contact your local recycling center for information on where to return the spent battery pack. RBRC is a trademark of the Rechargeable Battery Recycling Corporation.**

### THE FCC WANTS YOU KNOW

This device complies with part 15 of the FCC Rules, Operation is subject to the following two conditions:  
(1) This device may not cause harmful interference.  
(2) This device must accept any interference received, including interference that may cause undesired operation.

Your R/C boat might cause TV or radio interference even when it is operating properly. To determine whether your R/C boat is causing the interference, turn off your R/C boat. If the interference goes away, your R/C boat is causing the interference. Try to eliminate the interference by:

- Moving your R/C boat away from the receiver.
- Contacting your local store for help.

If you cannot eliminate the interference, the FCC requires that you stop using your R/C boat.