

Section 7

Regulatory Information and Users Manual



FCC / INDUSTRY CANADA INFORMATION

NOTICE: This equipment has been tested and found to comply with the Radio Frequency Radiation Exposure Limits detailed below. A minimum of 20 centimetres (8 inches) separation between this device and the operator and all other persons should be maintained.

This product complies with the requirements for Radio Frequency Radiation Hazard as defined in the FCC rules 47CFR1.1307 and 47CFR2.1091 and Industry Canada Standard RSS-102. Additional information about Radio Frequency Radiation Exposure can be found on the FCC web site (www.fcc.gov) and the Canada web site (<http://canada.gc.ca/>).

Radio Frequency Radiation Exposure Limits

Table 1 Limits for Maximum Permissible Exposure (MPE)				
Frequency Range (MHz)	Electric Field Strength (V/m)	Magnetic Field Strength (A/m)	Power Density (mW/cm ²)	Averaging Time (Minutes)
(A) Limits for Occupational/Controlled Exposures				
1500-100,000	---	---	5	6
(B) Limits for General Population/Uncontrolled Exposure				
1500-100,000	---	---	1.0	30

NOTE 1 to Table 1: Occupational/controlled limits apply in situations in which persons are exposed as a consequence of their employment provided those persons are fully aware of the potential for exposure and can exercise control over their exposure.

Limits for occupational/controlled exposure also apply in situations when an individual is transient through a location where occupational/controlled limits apply provided he or she is made aware of the potential for exposure.

NOTE 2 to Table 1: General population/uncontrolled exposures apply in situations in which the general public may be exposed, or in which persons that are exposed as a consequence of their employment may not be fully aware of the potential for exposure or cannot exercise control over their exposure.

Declaration of Conformity Compliance Information
Residential Subscriber Unit Model Numbers: RDMi25100
CPEi25100

Class B computer peripheral



This device complies with part 15 of the FCC Rules. Operation is subject to the following two conditions: (1) This device may not cause harmful interference, and (2) this device must accept any interference received, including interference that may cause undesired operation.

This Class B digital apparatus complies with Canadian ICES-003.
Cet appareil numérique de la classe B est conforme à la norme NMB-003 du Canada.

Declaration of Conformity Responsible Party:

Motorola, Inc.
2900 West County Road 42, Suite 120
Burnsville, MN 55337
952-929-4008

NOTE: This equipment has been tested and found to comply with the limits for a Class B digital device, pursuant to part 15 of the FCC Rules. These limits are designed to provide reasonable protection against harmful interference in a residential installation. This equipment generates, uses and can radiate radio frequency energy and, if not installed and used in accordance with the instructions, may cause harmful interference to radio communications. However, there is no guarantee that interference will not occur in a particular installation. If this equipment does cause harmful interference to radio or television reception, which can be determined by turning the equipment off and on, the user is encouraged to try to correct the interference by one or more of the following measures:

- Reorient or relocate the receiving antenna.
- Increase the separation between the equipment and receiver.
- Connect the equipment into an outlet on a circuit different from that to which the receiver is connected.
- Consult the dealer or an experienced radio/TV technician for help.

NOTE: Modification of this device may void the user's authority to operate the equipment.

The device is intended to be powered by Listed/CN ITE LPS or Class II power supply with output rated 13 V dc, 1.3 A minimum.



CPEi 100 Series



MOTOROLA, Expedience and the Stylized M Logo are registered in the US Patent & Trademark Office. All other product or service names are the property of their respective owners.
© Motorola, Inc., 2007.

MOTOSTART

MOTOWI⁴

Cable Connection Guide

Connect the cables in numerical order as shown.

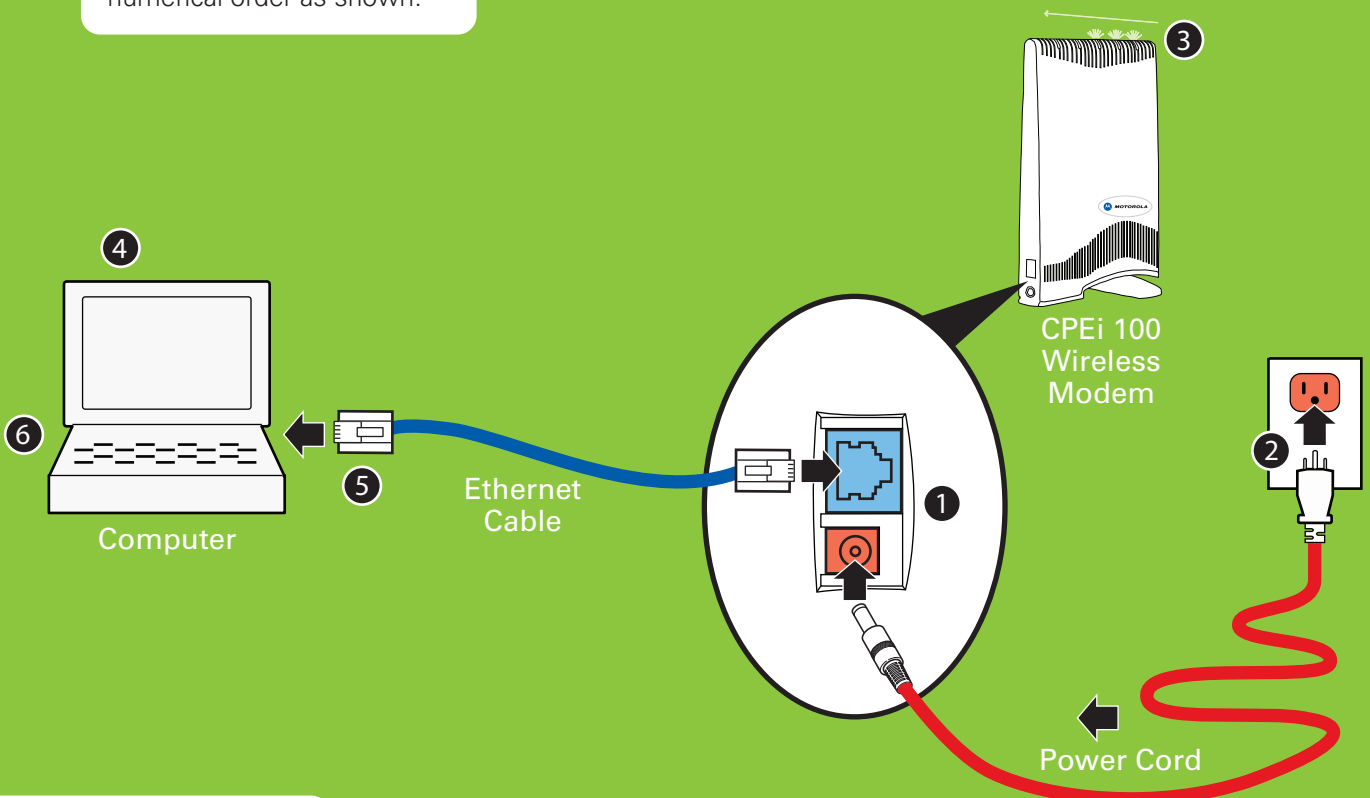

Procedure to Install the Unit

No software applications or drivers are loaded onto the computer.

- 1 Connect the Power cord and Ethernet cable to the CPE.
- 2 Plug the power cord into an AC outlet. The unit will turn on.

Checking the CPE's lights

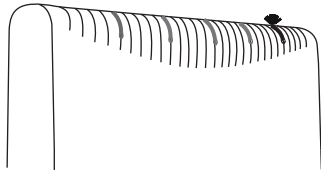

The lights on the CPE blink to indicate the strength of the signal received by the CPE. The CPE is equipped with an internal antenna that receives this signal from your Internet service provider.

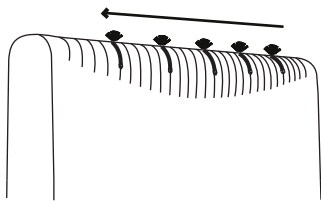

The more lights that blink on the CPE, the stronger the signal that the CPE receives.

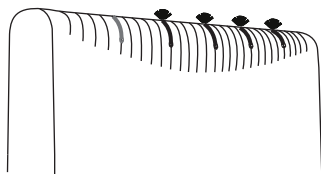

If the CPE is not able to receive any signal, the lights blink in sequence. Choose another location in the building in which to operate the CPE.

After the installation is complete the lights remain continuously lit. This indicates the CPE can provide you with high-speed Internet service.

- 3 Rotate the CPE until you find the best signal strength. More lights = better signal.

Finding the best signal from the ISP

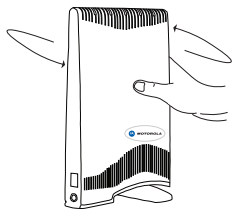

1. Place the CPE on a table or shelf.
2. Point the back of the CPE (the side without the logo) toward a window. Remove your hands from the CPE for a few seconds.
3. Note the number of lights on the CPE that blink.
4. Point the CPE to the left of the starting point, then to the right. At each point, note how many lights blink.



5. Re-orient the back of the CPE to the direction it was pointed when the most lights blinked.
6. Ensure that the lights stay on after you release your hands from the CPE.

- 4 Power off your computer.
- 5 Plug the other end of the Ethernet cable into the Ethernet connector of your computer.
- 6 Power on your computer.
- 7 When the CPE obtains Ethernet communication with your computer and completes its connection to the wireless network, the lights stop blinking and remain on.