

# GB00Z-1

## WIRELESS GLASS BREAK DETECTOR

### Installation Instructions

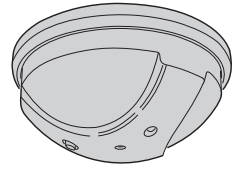

USA & Canada (800) 421-1587 & (800) 392-0123  
 (760) 438-7000 - Toll Free FAX (800) 468-1340  
 www.linearcorp.com

### 1. PRODUCT DESCRIPTION

The Model GB00Z-1 is a battery powered glass break detector with built-in Z-Wave® interoperable two-way RF mesh networking technology designed for use with Lowe's Iris® Smart Home Hub. This device is used for perimeter protection.

The GB00Z-1 can send five different signal types: fault, restore, low battery, status, and tamper. The Iris system hub must be paired with the glass break detector before system testing and operation. Refer to the Lowe's Iris system Web site for details on pairing and testing the detector.

In a typical installation, the detector is mounted on a wall or ceiling within 15 feet of the protected glass window(s). The unit uses dual-stage digital audio processing to detect the sound of breaking glass in a 360° area around the device. If the unit detects breaking glass, a **fault** signal is sent to the system followed by a **restore** signal.

Periodically, the unit sends a **status** signal to update the system. If the battery tests low, a **low battery** signal is included with any transmission. The glass break detector is powered from two 3-Volt CR123A lithium batteries (included).

An internal switch senses if the detector is removed from its base. Removing the detector will send a **tamper** signal to the system.

Three screws and screw anchors are provided for mounting the detector.

### 2. FEATURES

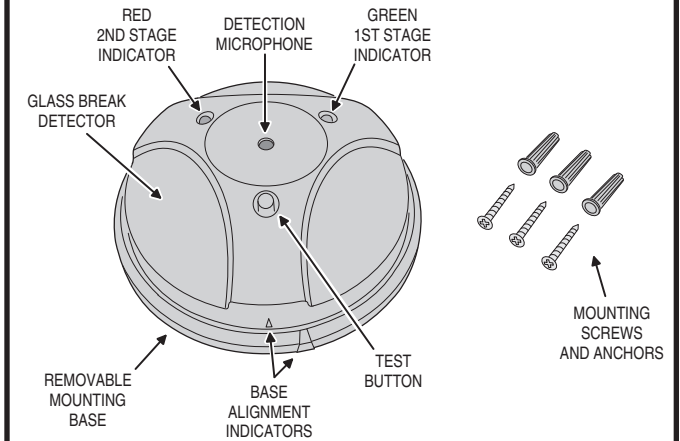

### 3. INSTALLING OR CHANGING BATTERIES

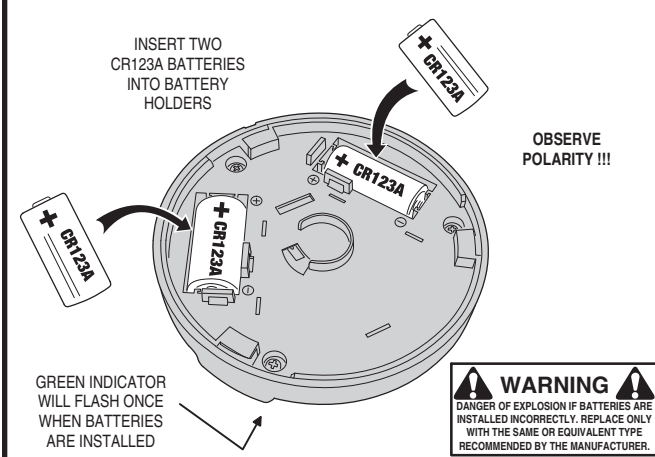

### 4. PAIRING OR UN-PAIRING THE DETECTOR WITH THE HUB

**PAIRING THE DETECTOR**

TO ADD TO HUB

- AFTER INSTALLING BATTERIES, WAIT 5 SECONDS FOR THE POWER UP DELAY
- PLACE DETECTOR WITHIN 10 FEET OF THE IRIS SYSTEM HUB
- FROM THE IRIS WEB SITE, CLICK THE DEVICES TAB, THEN CLICK THE "ADD DEVICES" BUTTON
- SELECT GLASS BREAK DETECTOR FROM THE LIST
- FOLLOW THE ON-SCREEN INSTRUCTIONS TO PAIR THE DETECTOR WITH THE HUB

**UN-PAIRING THE DETECTOR**

TO REMOVE FROM HUB

- FROM THE IRIS WEB SITE, CLICK THE DEVICES TAB
- ON THE GLASS BREAK DETECTOR DEVICE CLICK "MANAGE"
- CLICK REMOVE
- FOLLOW THE ON-SCREEN INSTRUCTIONS TO UN-PAIR THE DETECTOR WITH THE HUB

WHEN INSTRUCTED, PRESS THE BUTTON ON THE DETECTOR

### 5. MOUNTING THE DETECTOR

- LOCATE THE DETECTOR ON THE ADJACENT OR OPPOSITE WALL OR ON THE CEILING WITHIN 15 FEET OF THE WINDOW BEING PROTECTED
- USE THE MOUNTING BASE AS A TEMPLATE TO MARK THE LOCATION OF THE THREE MOUNTING HOLES  
**NOTE: WHEN WALL MOUNTING, ORIENT THE TEST BUTTON DOWN**
- DRILL 3/16" PILOT HOLES FOR THE SCREW ANCHORS AND PUSH THE ANCHORS INTO THE HOLES
- ATTACH THE MOUNTING BASE WITH THE THREE SCREWS
- ATTACH THE DETECTOR TO THE BASE, MATCH THE ALIGNMENT MARKS AND TURN CLOCKWISE

**NOTE: IF THE BATTERIES ARE NOT INSTALLED, THE DETECTOR WILL NOT ALLOW MOUNTING TO THE BASE**

### 6. DETECTOR TESTING

- FROM THE IRIS WEB SITE, CLICK THE DEVICES TAB
- ON THE GLASS BREAK DETECTOR DEVICE CLICK "MANAGE"
- CLICK TEST
- FOLLOW THE ON-SCREEN INSTRUCTIONS TO TEST THE DETECTOR WITH THE HUB

WHEN INSTRUCTED, PRESS THE BUTTON ON THE DETECTOR 3 TIMES

### 7. SPECIFICATIONS

**Operating Temperature:** 32° to 120° F (0° to 49° C)  
**Operating Relative Humidity:** 5 to 95%, non-condensing  
**Operating Frequency:** 908.42 MHz  
**Battery Type:** Two 3-Volt CR123A Lithium Batteries  
**Sensor Type:** Single microphone, dual-stage (thud & crash)

The minimum size for all glass types is 11" x 11" (28 cm x 28 cm) square. Glass must be framed, in a wall of the room or mounted in a barrier of 36" (91 cm) minimum width.

GLASS TYPE	MINIMUM TO MAXIMUM THICKNESS
PLATE	1/8" TO 1/4" (3.2 mm TO 6.4 mm)
TEMPERED	1/8" TO 1/4" (3.2 mm TO 6.4 mm)
SEALED, INSULATING	1/8" TO 1/4" (3.2 mm TO 6.4 mm)

Z-Wave is a registered trademark of Sigma Designs Inc. and/or its subsidiaries.

### 8. LINEAR LIMITED RETAIL WARRANTY

Linear LLC (the Company) warrants to the original purchaser that products delivered hereunder will be free of defects in materials and workmanship for a period of one (1) year from the date of purchase.

The Company within said period shall at its option, either repair or replace free of charge, any product or part thereof found, upon the Company's inspection, to be so defective, and will return the repaired or replaced product to the purchaser at Company's expense.

All products returned for warranty service require a Return Product Authorization Number (RPA#). For warranty service, shipping instructions, and an RPA#, contact Linear Technical Services at 1-800-421-1587. Devices must be sent to the Company at owner's expense and be accompanied with statement of defect and proof of purchase.

This warranty is conditioned on the following:

- The Company must be notified within one year of purchase and have been given the opportunity of inspection by return of any alleged defective product free and clear of all liens and encumbrances to the Company or its distributor; and
- The product must not have been abused, misused or improperly maintained and/or repaired during such period; and
- Such defect has not been caused by corrosion or exposure to other than ordinary wear and tear.

**THE COMPANY MAKES NO OTHER WARRANTY OR REPRESENTATION OF ANY KIND WHATSOEVER INCLUDING ANY WARRANTY OF MERCHANTABILITY OR FITNESS FOR A PARTICULAR PURPOSE ARE HEREBY DISCLAIMED.**

The Company's maximum liability hereunder is limited to the purchased price of the product. In no event shall the Company be liable for any consequential, indirect, incidental or special damages of any nature arising from the sale or use of the product, whether based in contract, tort, strict liability or otherwise.

Note: Some states do not allow limitations on incidental or consequential damages or how long an implied warranty lasts, so that the above limitations may not fully apply. This warranty gives specific legal rights and you may also have other rights which may vary from state to state. This device complies with FCC Part 15 and Canada Rules and Regulations. Operation is subject to the following two conditions: (1) This device may not cause harmful interference and (2) this device must accept any interference received, including interference that may cause undesired operation. Le présent appareil est conforme aux CNR d'Industrie Canada applicables aux appareils radio exempts de licence. L'exploitation est autorisée aux deux conditions suivantes: (1) l'appareil ne doit pas produire de brouillage, et (2) l'utilisateur de l'appareil doit accepter tout brouillage radioélectrique subi, même si le brouillage est susceptible d'en compromettre le fonctionnement.

Copyright © 2013 Linear Corporation 235512 X8