

ITIDWA01

UNIVERSAL DOOR/WINDOW TRANSMITTER

Installation Instructions

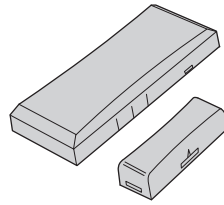

USA & Canada (800) 421-1587 & (800) 392-0123
 (760) 438-7000 - Toll Free FAX (800) 468-1340
 www.linearcorp.com

PRODUCT DESCRIPTION

The ITIDWA01 is a battery powered supervised stationary transmitter designed for use with GE security systems. Triggering the transmitter with its built-in magnetic switch sends a digitally coded wireless signal to its companion receiver. The transmitter also has an external input that accepts normally closed (N/C) dry contact devices.

The ITIDWA01 can send five different signal types: fault, restore, low battery, tamper, and status. Receivers must be programmed to the transmitter's code before system testing and operation. Refer to the receiver's instructions for details on programming.

In a typical installation, the magnet is mounted on a door or window and the transmitter is mounted on the frame. When the door or window is opened, the magnet moves away from the transmitter and a **fault** signal is sent. When the door or window is closed, the magnet returns next to the transmitter and a **restore** signal is sent.

About every 65 minutes the transmitter sends a **status** signal to update the receiver. If the battery tests low, a **low battery** signal is included with any transmission. The transmitter is powered from two 3-Volt CR2032 lithium batteries (included).

An internal switch detects if the transmitter's case is opened. Opening the case will send a **tamper** signal to the receiver.

Two screws and double-stick tape are provided for mounting the transmitter.

FEATURES

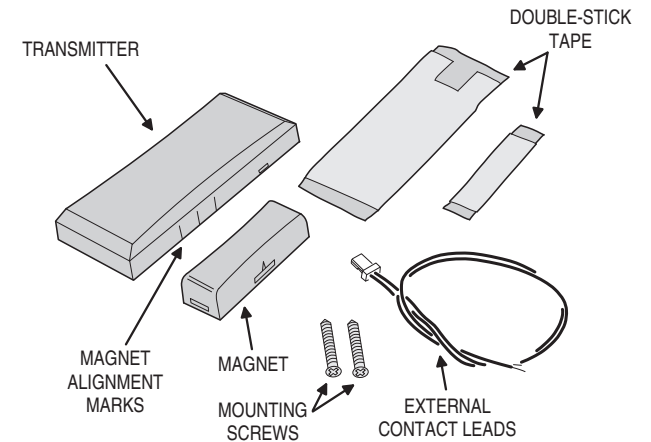

BATTERY INSTALLATION OR REPLACEMENT

1 TWIST SCREWDRIVER IN SLOT ON EITHER SIDE TO OPEN CASE

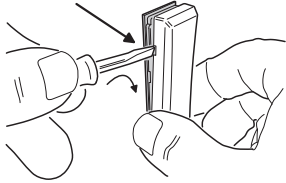

2 INSTALL TWO CR2032 BATTERIES + SIDE UP

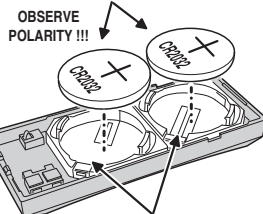

OBSERVE POLARITY !!!

NOTICE TO USERS IN CALIFORNIA - CR COIN CELL LITHIUM BATTERY INFORMATION: THIS PRODUCT CONTAINS A CR COIN CELL LITHIUM BATTERY WHICH CONTAINS PERCHLORATE MATERIAL - SPECIAL HANDLING MAY APPLY - SEE www.dtsc.ca.gov/hazardouswaste/perchlorate

TO REMOVE BATTERIES, TWIST SMALL SCREWDRIVER HERE

KEEP AWAY FROM SMALL CHILDREN. IF BATTERIES ARE SWALLOWED, PROMPTLY SEE A DOCTOR. DO NOT TRY TO RECHARGE THESE BATTERIES. DISPOSAL OF USED BATTERIES MUST BE MADE IN ACCORDANCE WITH THE WASTE RECOVERY AND RECYCLING REGULATIONS IN YOUR AREA.

PROGRAMMING

- 1 REFER TO THE SECURITY SYSTEM'S INSTRUCTIONS AND PLACE THE RECEIVER IN PROGRAM MODE
- 2 PRESS AND RELEASE THE TAMPER SWITCH TO SEND A SIGNAL
- 3 VERIFY THAT THE TRANSMITTER HAS BEEN "LEARNED" BY THE RECEIVER
- 4 SET ANY OTHER SYSTEM PROGRAMMING OPTIONS FOR THE TRANSMITTER
- 5 AFTER INSTALLATION, TEST THE SYSTEM TO VERIFY PROPER OPERATION, CHECK THAT THE SYSTEM INDICATES WHEN THE DOOR IS OPEN OR CLOSED

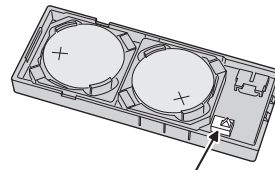

PRESS AND RELEASE THE TAMPER SWITCH

OPTIONAL EXTERNAL CONTACT

AN EXTERNAL NORMALLY CLOSED MAGNETIC CONTACT CAN BE CONNECTED TO THE TRANSMITTER

NOTE: THE INTERNAL MAGNETIC SWITCH CANNOT BE USED IF AN EXTERNAL CONTACT IS CONNECTED

- 1 PLUG EXTERNAL CONTACT LEADS INTO THE TRANSMITTER'S EXTERNAL CONTACT CONNECTOR
- 2 WIRE EXTERNAL CONTACT TO THE LEADS

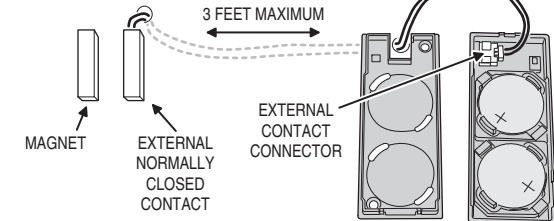

TRANSMITTER MOUNTING

ATTACH MOUNTING PLATE WITH TWO SCREWS OR USE THE DOUBLE-STICK TAPE

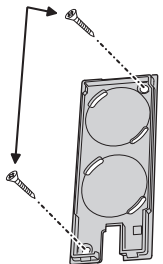

1/2" GAP MAXIMUM !!!

MOUNT MAGNET NEXT TO ALIGNMENT MARKS

TRANSMITTER ON DOOR FRAME

MAGNET ON DOOR

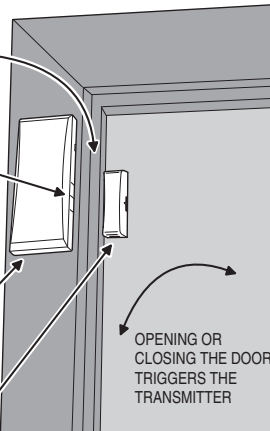

INSTALLATION TIP: TO MINIMIZE PHYSICAL SHOCK TO THE UNIT, ALWAYS MOUNT THE TRANSMITTER ON THE STATIONARY PART OF THE OPENING

NOTE: MOUNTING THE TRANSMITTER WITH DOUBLE-STICK TAPE IS NOT ALLOWED IN UL INSTALLATIONS

OPENING OR CLOSING THE DOOR TRIGGERS THE TRANSMITTER

SPECIFICATIONS

Operating Temperature: 32° to 120° F (0° to 49° C)

Operating Relative Humidity: 5 to 95%, non-condensing

Operating Frequency: 319.5 MHz

Battery Type: Two 3-Volt CR2032 Lithium Batteries

LINEAR LIMITED WARRANTY

This Linear product is warranted against defects in material and workmanship for twelve (12) months. This warranty extends only to wholesale customers who buy direct from Linear or through Linear's normal distribution channels. Linear does not warrant this product to consumers. Consumers should inquire from their selling dealer as to the nature of the dealer's warranty, if any. There are no obligations or liabilities on the part of Linear LLC for consequential damages arising out of or in connection with use or performance of this product or other indirect damages with respect to loss of property, revenue, or profit, or cost of removal, installation, or reinstallation. All implied warranties, including implied warranties for merchantability and implied warranties for fitness, are valid only until the warranty expires. This Linear LLC Warranty is in lieu of all other warranties express or implied.

All products returned for warranty service require a Return Product Authorization Number (RPA#). Contact Linear Technical Services at 1-855-546-3351 for an RPA# and other important details.

Any changes or modifications not expressly approved by the party responsible for compliance could void the user's authority to operate the equipment.

Les changements ou modifications non approuvés expressément par la partie responsable de la conformité pourraient annuler l'autorité de l'utilisateur à faire fonctionner l'équipement.

IMPORTANT! Linear radio controls provide a reliable communications link and fill an important need in portable wireless signaling. However, there are some limitations which must be observed.

- For U.S. installations only: The radios are required to comply with FCC Rules and Regulations as Part 15 devices. As such, they have limited transmitter power and therefore limited range.
- A receiver cannot respond to more than one transmitted signal at a time and may be blocked by radio signals that occur on or near their operating frequencies, regardless of code settings.
- Changes or modifications to the device may void FCC compliance.
- Infrequently used radio links should be tested regularly to protect against undetected interference or fault.
- A general knowledge of radio and its vagaries should be gained prior to acting as a wholesale distributor or dealer, and these facts should be communicated to the ultimate users.

This device complies with FCC Part 15 and Canada Rules and Regulations. Operation is subject to the following two conditions: (1) This device may not cause harmful interference and (2) this device must accept any interference received, including interference that may cause undesired operation.

Le présent appareil est conforme aux CNR d'Industrie Canada applicables aux appareils radio exempts de licence. L'exploitation est autorisée aux deux conditions suivantes: (1) l'appareil ne doit pas produire de brouillage, et (2) l'utilisateur de l'appareil doit accepter tout brouillage radioélectrique subi, même si le brouillage est susceptible d'en compromettre le fonctionnement.