

## NOTICE

The Power Adaptors have been upgraded from 4V 300mA to 6V 400mA.

**x2 Power Adaptors**  
120V AC to  
**6V DC 400mA**

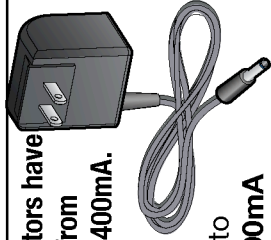

The Wireless Net Extender product is equipped with two 6.0 V DC wall power adaptors with the minimum of 400 mA, not the two 4.0 V DC, 300 mA adaptors as mentioned in the User Manual.

## Mating Numbers

**1 1 0 0**

The Wireless Net Extender product has a 4-digit Mating Number located on the bottom of each unit. This number is for permitting users to differentiate between multiple Wireless Net Extender pairs.

**FCC Advisory:** This equipment has been tested and found to comply with the limits for a Class B digital device, pursuant to Part 15 of the FCC Rules. These limits are designed to provide reasonable protection against harmful interference in a residential installation. This equipment generates, uses and can radiate radio frequency energy and, if not installed and used in accordance with the instructions, may cause harmful interference to radio communications. However, there is no guarantee that interference will not occur in a particular installation. If this equipment does cause harmful interference to radio or television reception, which can be determined by turning the equipment off and on, the user is encouraged to try to correct the interference by one or more of the following measures:

- Reorient or relocate the receiving antenna.
- Increase the separation between the equipment and receiver.
- Connect the equipment into an outlet on a circuit different from that to which the receiver is connected.
- Consult the dealer or an experienced radio/TV technician for help.

You are cautioned that any changes or modifications not expressly approved by the party responsible for compliance could void the user's authority to operate the equipment.

## Folding Diagram

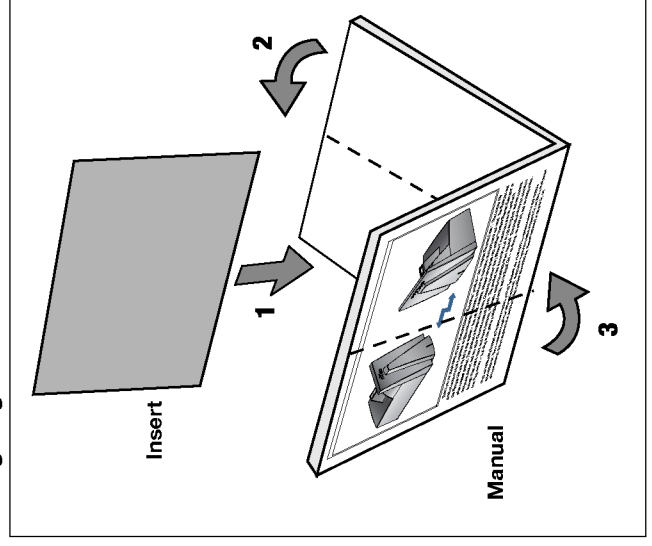

**PROPRIETARY NOTE:** This drawing is the property of Eleven Engineering Inc. (Eleven). It is furnished in confidence for evaluation purposes only and shall not be disclosed or used for any other purpose except as specified by contact between the recipient and ELEVEN. Duplication of any portion of this data requires permission in writing from Eleven and shall include this legend.

Sheet Number: 1/1  
Date: 2003.08.19

Drawing Number: manual\_insert  
Revision: B1.00  
Scale: 1.0  
Filename: manual\_insert.ai

Project Name: GEEK  
Project Number: GEE10  
Client: NYKO

Eleven Engineering Incorporated  
10150-100 street, suite 900  
Edmonton, Alberta, Canada, T5J 0P6  
T: (780)425.6511 F: (780)425.7006  
www.ElevenEngineering.com