

Thank you for purchasing NYKO's Wireless Net Extender™ -- the "Invisible Ethernet Cable". This unique product provides a wireless replacement for long Ethernet cables, at a fraction of the cost of current wireless network equipment. The Base Unit and the Remote Unit are factory matched to one another. They will not connect or interfere with another Wireless Net Extender set, nor with any other wireless product. Though this product is designed for wireless online gaming with PlayStation®2 and Xbox™, this 10Base-T system can also be used with computers, printers, and any other Ethernet enabled devices. The Base and Remote Units have a range of up to 100 feet (30 m) and can transmit through most walls, roofs, and floors. Therefore, no costly network wiring installations are required. The Wireless Net Extender offers the ultimate in true Plug-n-Play -- just plug in the power and Ethernet cable and it's GAME ON -- no drivers, no software and no configuration.

NYKO® and WIRELESS NET EXTENDER™ are trademarks of NYKO Technologies, Inc. PlayStation®2 is a registered trademark of Sony Computer Entertainment Inc. Xbox™ is a trademark of Microsoft Corporation. This is a NYKO product and is not endorsed, manufactured or distributed by the companies listed above.

### Contents

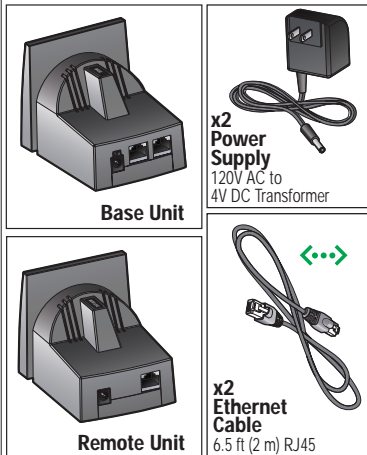

- 1 - Base Unit (1 slider switch + 2 Ethernet ports)
- 1 - Remote Unit (1 Ethernet port)
- 2 - Wall Power Adaptors (120V AC 60Hz 7W to 4V DC 300mA)
- 2 - Ethernet Cables 6.5 feet (2m), RJ45
- 1 - Instruction Manual

### Features:

- Connects to high-speed internet without cables
- No programming or setup -- factory configured -- plug in and play
- Secure encrypted communication with factory matched pairs
- Use multiple sets within the same area
- Can be used for connecting most any Ethernet product: printers, scanners, laptops, game consoles, PCs, etc. up to 100 feet
- 1.5 Mbps, low latency RF wireless link.
- Can also be used with hubs, switches or routers.

### Definitions:

**Game Console:** Any Ethernet enabled gaming device such as PlayStation®2 or Xbox™.

**Network Device:** Any Ethernet enabled device. Examples include: Game Consoles, PCs, laptops, printers and scanners.

### System Requirements:

- The user must have a DSL or Cable Modem with an active account.
- This product is designed for Ethernet enabled PlayStation®2 or Xbox™ game consoles; it can also be used with computers, network printers and other Network Devices.
- The model numbers of Ethernet Adaptors for the current Game Consoles are as follows:
  - PlayStation®2: Network Adaptor - Model # SCPH-10281
  - Xbox™: Ethernet built in

## Quick Start Guide

### STEP 1. Pre-installation Test:

Test your wired Ethernet connection by using your computer to access the Internet via a DSL or Cable Modem. For example, go to [www.nyko.com](http://www.nyko.com) to confirm connection. (Note: Dial-up connections using a 28K or 56K modem are not Ethernet connections.)

or

Test your wired Ethernet connection by using your game console to access the Internet. Play one online game to confirm connection.

**Note:** You can use the Ethernet cables supplied with the Wireless Net Extender, or your current standard Ethernet cables.



Test the current network configuration using standard Ethernet cables.

### Network Device

Personal Computer, Video Game Console, Etc.

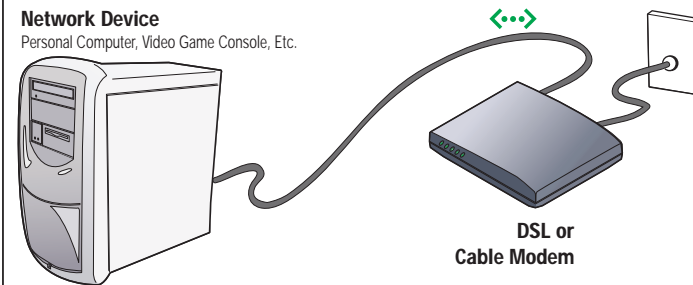

or

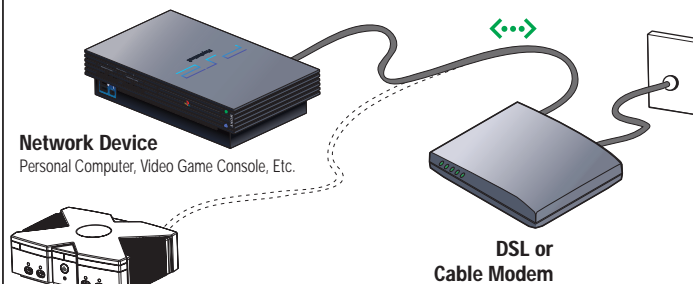

## Quick Start Guide

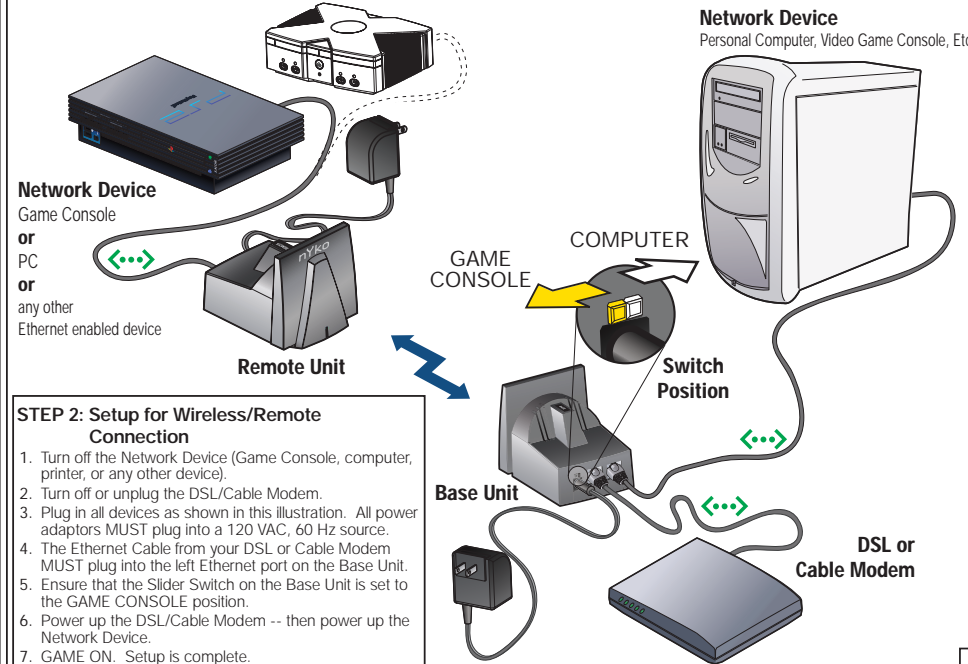

### STEP 2: Setup for Wireless/Remote Connection

1. Turn off the Network Device (Game Console, computer, printer, or any other device).
2. Turn off or unplug the DSL/Cable Modem.
3. Plug in all devices as shown in this illustration. All power adaptors MUST plug into a 120 VAC, 60 Hz source.
4. The Ethernet Cable from your DSL or Cable Modem MUST plug into the left Ethernet port on the Base Unit.
5. Ensure that the Slider Switch on the Base Unit is set to the GAME CONSOLE position.
6. Power up the DSL/Cable Modem -- then power up the Network Device.
7. GAME ON. Setup is complete.

**OPTIONAL**

**Simple Wireless Setup**

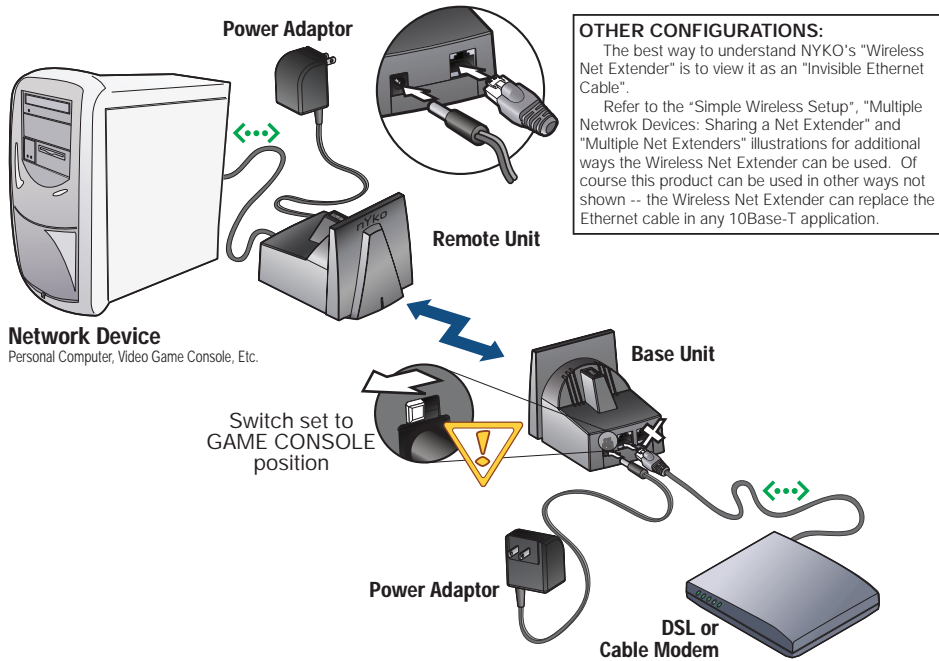

**OTHER CONFIGURATIONS:**  
The best way to understand NYKO's "Wireless Net Extender" is to view it as an "Invisible Ethernet Cable".  
Refer to the "Simple Wireless Setup", "Multiple Network Devices: Sharing a Net Extender" and "Multiple Net Extenders" illustrations for additional ways the Wireless Net Extender can be used. Of course this product can be used in other ways not shown -- the Wireless Net Extender can replace the Ethernet cable in any 10Base-T application.

**OPTIONAL**

**Multiple Network Devices: Sharing a Net Extender**

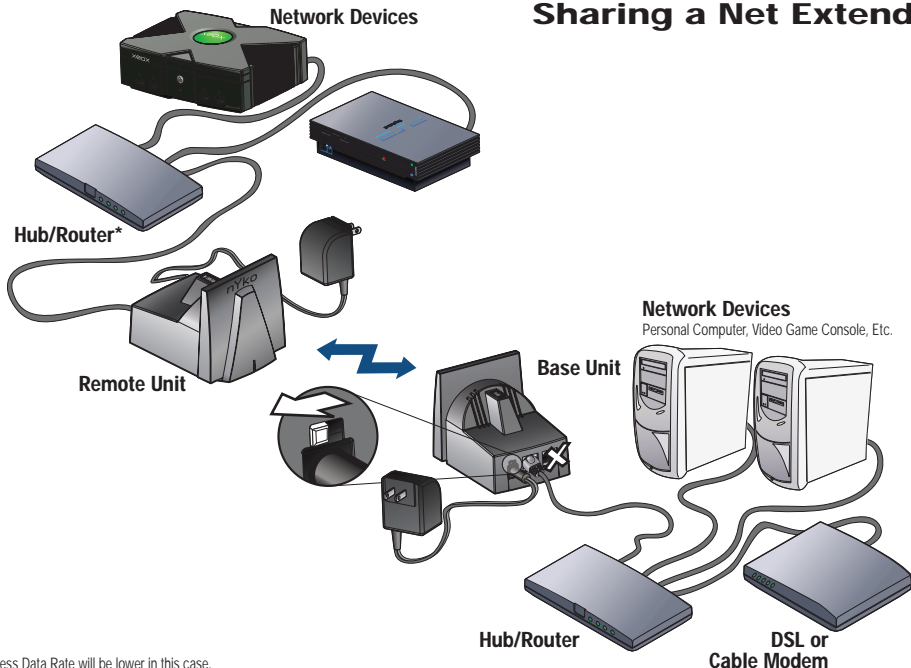

\*Wireless Data Rate will be lower in this case.

**OPTIONAL**

**Multiple Net Extenders**

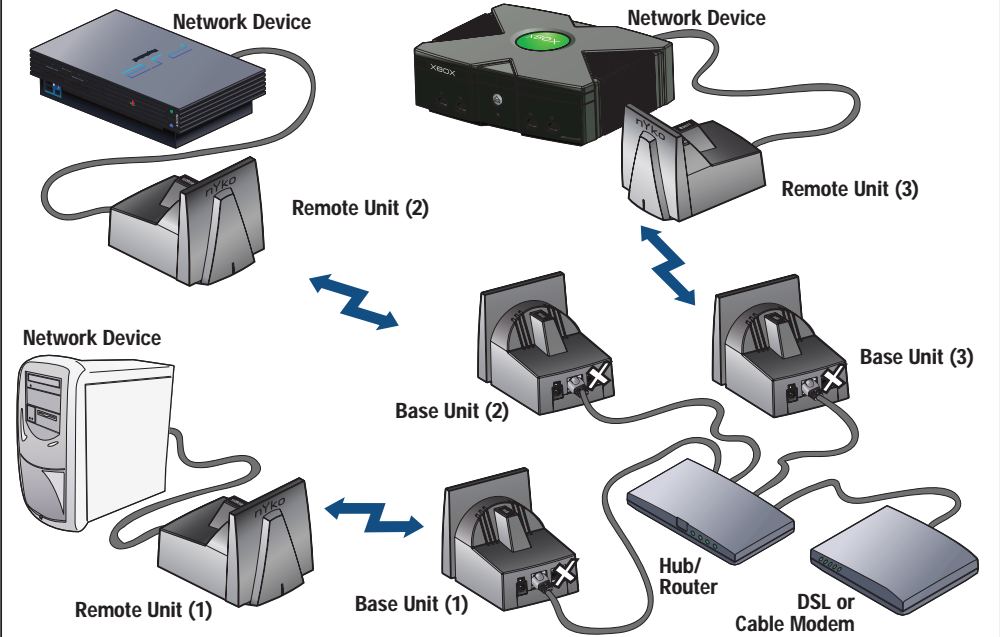

NOTE: Power Adaptors and Base Unit Slide Switch close-ups removed for clarity. Slide switches set to Game Console Mode.

Regulatory Compliance:  
FCC Part 15, Industry Canada RSS-210, and cULus

**Slide Switch**  
Game Console Mode  
10 Base-T

Computer Mode  
10/100 Base-T

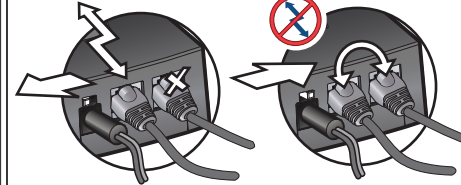

The Slide Switch on the Base Unit selects either of two modes -- **GAME CONSOLE Mode** or **COMPUTER Mode**.  
The **GAME CONSOLE Mode** is the default position for gaming on the net. This enables the wireless Ethernet link between the game console and the DSL/Cable Modem. The right Ethernet cable is disabled.  
The **COMPUTER Mode** turns off the wireless function and directly connects the left and right cables. This hardwires your computer, for example, to the DSL/Cable Modem (see Step 2 illustration)

**LED Indicator**

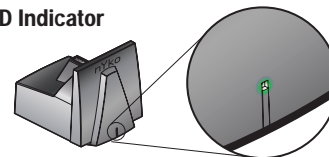

**No Light:** No power.  
**Blinking Light (1/2 second on; 1/2 second off):** Searching for the other Wireless Net Extender unit.  
**Solid Light:** Solid link established; no data flow.  
**Flickering Light:** The Ethernet connection is active (the faster the flicker, the faster the data flow).

**Troubleshooting**

**Are you having connection problems -- what is the LED doing?**  
**No Light:** The Wireless Net Extender unit is not getting power. Check the unit's power connections.  
**Blinking Light (1/2 second on; 1/2 second off) does not turn to solid or flickering:**  
•The other Wireless Net Extender unit is not getting power.  
•The Net Extender(s) are experiencing too much interference from another device or the two Net Extenders are too far apart in the current surroundings. Reorient each unit to face in the general direction of the other unit (through wall, floor, etc) or change the location of the two Net Extenders (avoid placing the Net Extenders close to large metal surfaces or objects, such as metal tables or metal support pillars).  
**Solid Light but still no link:** The Ethernet cable is not plugged into one (or both) of the Wireless Net Extender units or other Network Devices.  
**Flickering Light, however the network connection is not working:** (Do the following until the problem is solved.)  
1. Unplug the power to both Wireless Net Extenders for at least 5 seconds, then power up the two Net Extenders again.  
2. Turn off or unplug the power to the ADSL/Cable Modem for at least 30 seconds, then power up the ADSL/Cable Modem -- the Network Device (game console, computer, etc) may need to be rebooted, too. This usually fixes most Internet related issues.  
3. If you have a computer connected to the Base Unit, put the Slide Switch into Computer Mode. Try to access the Internet from the computer. If unsuccessful, you may need to reset your IP address. Refer to the instructions from your Internet Service Provider.

**Still no success?**  
Replace the Wireless Net Extender with an Ethernet Cable to isolate the problem. If the Ethernet Cable works but the "Wireless Net Extender" does not:  
- go to: <http://www.nyko.com/faqs.htm>  
- or write: [support@nyko.com](mailto:support@nyko.com)

**NYKO Product Limited Warranty**  
This NYKO product is warranted to the original purchaser for the normal intended use for a period of ninety (90) days from the date of purchase. If a defect covered under this warranty occurs, NYKO will replace or repair the product or its defective parts, at its option, at no charge. Warranty does not apply to defects resulting from modification or misuse of this product. The product can be returned to the place of purchase accompanied with proof of purchase or shipped to: NYKO Technologies, Inc., P.O. Box 46697, Los Angeles, CA 90046 with freight charges prepaid. Please allow 3-4 weeks for processing.