

date of issue 2018.12.

**OLYMPUS**

**OLYMPUS AMERICA INC.**

3500 Corporate Parkway, P.O. Box 610, Center Valley, PA 18034-0610, U.S.A. Tel. 484-896-5000

**Technical Support (U.S.A. / Canada)** Our phone customer support is available from 24/7 online automated help: 9 am to 9 pm (Monday to Friday) ET  
<http://www.olympusamerica.com/support> <http://olympusamerica.com/contactus>  
 Phone customer support: <http://www.olympusamerica.com/digital>  
 Tel. 1-800-260-1625 (Toll-free)

**Service Centers**

**U.S.A./CANADA:**  
**Olympus America Inc.**  
 Tel: 1 (800) 622-6372  
<http://www.olympusamerica.com/repair>

**Latin America:**  
<http://www.olympusamericalatina.com>

**OLYMPUS EUROPA SE & CO. KG**

Premises: Consumer Product Division  
 Wendenstrasse 14-18, 20097 Hamburg, Germany  
 Tel: +49 40-23 77 3-0 / Fax: +49 40-23 07 61  
 Goods delivery: Modul H, Willi-Bleicher Str. 36, 52353 Düren, Germany  
 Mailing address: Postfach 10 49 08, 20034 Hamburg, Germany

**European Technical Customer Support:**

Please visit our homepage <http://www.olympus-europa.com> or call our TOLL FREE NUMBER\* : **00800 - 67 10 83 00**

for Austria, Belgium, Denmark, Finland, France, Germany, Luxemburg, Netherlands, Norway, Poland, Portugal, Spain, Sweden, Switzerland, United Kingdom.  
 810-800 67 10 83 00 for Russia  
 800 167 777 for Czech Republic

\* Please note some phone service providers do not permit access to 00800 numbers or require an additional prefix. Charges may apply here. Please contact your service provider directly for more details.

For all not listed European Countries and in case that you can't get connected to the above mentioned number, please make use of the following CHARGED NUMBERS **+49 40 - 237 73 899**

The following importer description applies to products imported into the EU directly by OLYMPUS EUROPA SE & Co. KG only.  
 OLYMPUS EUROPA SE & Co. KG  
 Wendenstrasse 14-18, 20097 Hamburg, Germany  
 Manufactured by OLYMPUS CORPORATION  
 2951 Ishikawa-machi, Hachioji-shi, Tokyo 192-8507, Japan

BE	BG	CZ	DK	DE	EE
IE	EL	ES	FR	HR	IT
CY	LV	LT	LU	HU	MT
NL	AT	PL	PT	RO	SI
SK	FI	SE	UK	IS	NO
CH	LI	TR			

© 2018 OLYMPUS CORPORATION  
 Printed in China

WD516900

OLYMPUS

E-M1X

Basic Manual

**OLYMPUS**

DIGITAL CAMERA

**E-M1X**

Basic Manual



ENGLISH ..... 2  
 FRANÇAIS ..... ##  
 ESPAÑOL ..... ##  
 DEUTSCH ..... ##  
 БЪЛГАРИЯ ..... ##  
 ČESKY ..... ##  
 DANSK ..... ##  
 EESTI ..... ##  
 SUOMI ..... ##  
 ΕΛΛΗΝΙΚΑ ..... ##  
 HRVATSKI ..... ##

MAGYAR .....###  
 ITALIANO .....###  
 LIETUVIŲ .....###  
 LATVIEŠU .....###  
 NEDERLANDS .....###  
 NORSK .....###  
 POLSKI .....###  
 PORTUGUÊS .....###  
 ROMÂNIA .....###  
 РУССКИЙ .....###  
 SVENSKA .....###

SLOVENŠČINA ...###  
 SLOVENČINA.....###  
 СРПСКИ .....###  
 TÜRKÇE .....###  
 УКРАЇНСЬКА .....###  
 العربية .....###  
 한국어 .....###  
 中文(简体) .....###  
 中文(繁体) .....###  
 ไทย .....###  
 Tiếng Việt.....###



Model No. : IM010

Thank you for purchasing an Olympus digital camera.  
 A PDF manual is provided on our website.  
 The PDF manual details all camera functions.  
 In addition to the manual, we also offer software for controlling the camera and managing and retouching images.  
 The PDF manual can also be downloaded using the OLYMPUS Image Share (OI.Share) smartphone app.  
 When downloading items from our websites, note the following.  
**For customers in North America, Central America, South America and the Caribbean:**  
<http://www.getolympus.com/us/en/>  
**For customers in Europe:**  
<https://www.olympus.co.uk/site/en/c/cameras/>  
**For customers in Asia:**  
<http://asia.olympus-imaging.com/>  
 Adobe Reader is required to view the Instruction Manual. See the PDF manual for information on downloading and installing the latest version of OLYMPUS Workspace.  
 We recommend that you take test shots to get accustomed to your camera before taking important photographs.

Olympus will not be held liable for violations of local regulations arising from use of this product outside the country or region of purchase.

**Wireless LAN, Bluetooth®, and GPS**

The camera features built-in wireless LAN, Bluetooth®, and GPS. Use of these features outside the country or region of purchase may violate local wireless regulations; be sure to check with local authorities before use. Olympus will not be held liable for the user's failure to comply with local regulations.

**Preparing the Camera: Loading the battery**

- 1 Unlatch the battery compartment cover and remove the battery cartridge.

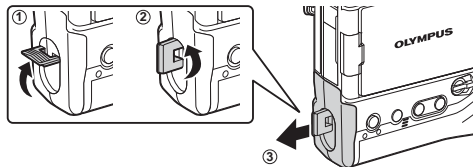

- 2 Insert the batteries into the battery cartridge.

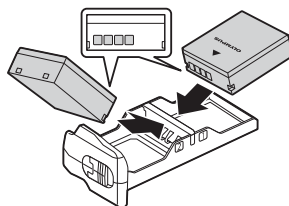

- 3 Insert the battery cartridge into the camera and latch the battery compartment cover.

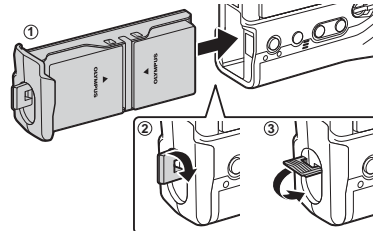

## Preparing the Camera: Loading the card

- 1 Rotate the card compartment cover lock as shown (①), (②) and open the card compartment cover (③).
- 2 Slide the card in until it locks into place.
- 3 Close the card compartment cover.

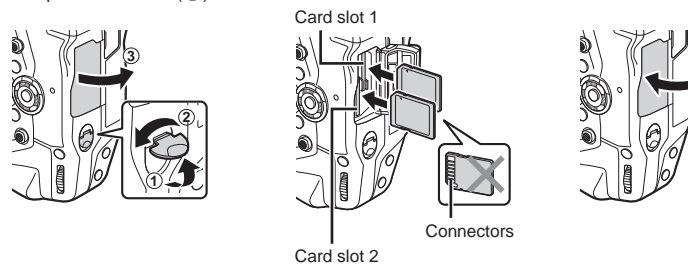

## Preparing the Camera: Attach a lens to the camera

Align the (red) attachment mark on the lens with the (red) attachment mark on the camera body and insert the lens into the camera lens mount.

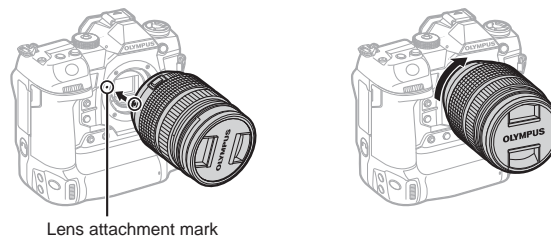

## Preparing the Camera: Using the Monitor

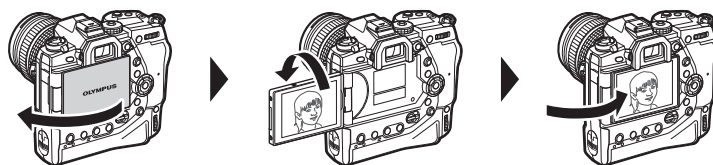

## Initial setup

When first turned on, the camera will prompt you to pick a language and set the clock.

- 1 Rotate the ON/OFF lever to ON. When the camera displays a setup dialog prompting you to select a language, press the OK button.

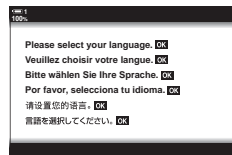
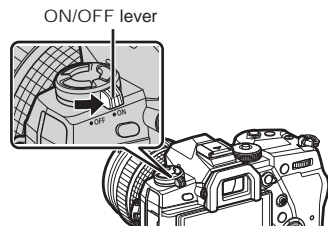

- 2 Highlight the desired language using the arrow pad (Δ ▽ ◀ ▶) or front or rear dial.



- 3 After highlighting the desired language, press the OK button.
  - If you press the shutter button before pressing the OK button, the camera will exit to shooting mode and no language will be selected. The language selection dialog can be displayed by turning the camera off and then on again, after which you can repeat the process from Step 1.
  - The language can be changed at any time from the ⌵ setup menu.
- 4 Choose the time and date.
  - Highlight items using the ◀ ▶ buttons.
  - Edit the highlighted item using the Δ ▽ buttons.
  - The clock can be adjusted at any time from the ⌵ setup menu.
  - Press the OK button when settings are complete.

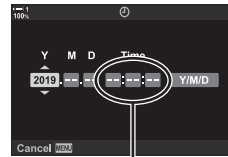

24 hour clock

- 5 Highlight a time zone using the Δ ▽ buttons and press the OK button.
  - Press the INFO button to enable or disable daylight saving time.
- 6 Press the OK button to set the clock.
  - Leaving the camera with the batteries removed may cause the clock to be reset.

## Shooting Modes

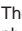
<b>P</b> (Program AE)	The camera chooses the optimal aperture and shutter speed according to subject brightness.
<b>A</b> (Aperture-priority AE)	In this mode, you choose the aperture (f/-number) and the camera automatically sets the shutter speed for optimal exposure according to subject brightness.
<b>S</b> (Shutter-priority AE)	In this mode, you choose the shutter speed and the camera automatically sets aperture for optimal exposure according to subject brightness.
<b>M</b> (Manual exposure)	In this mode, you choose the aperture and shutter speed.
<b>B</b> (Bulb/time / Live composite)	Select this mode to leave the shutter open for a long exposure. You can preview the photo in live view and end the exposure when the desired results have been achieved. Lighten blending is also available.
 (Movie)	A dedicated movie mode. You can choose settings unavailable in or different from those that apply in still photography modes. The  (movie) button can be used for basic movie recording even in still photography modes.
C1–C4 (Custom)	Frequently-used settings and shooting modes can be saved as custom modes and recalled as needed simply by rotating the mode dial.

### ■ Choosing a Shooting Mode

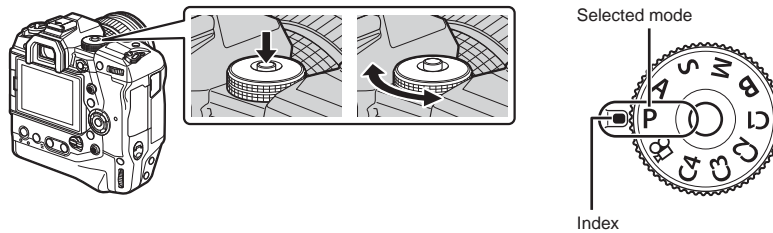

## Shooting still pictures

Use the mode dial to select the shooting mode, and then shoot the image.

### 1 Focus.

- Press the shutter button a short distance to the first stop (referred to as "pressing the shutter button halfway"). The in-focus indicator (●) will be displayed and the AF target for the area in focus will light.

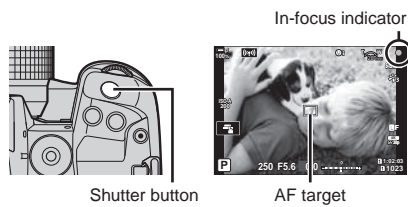

### 2 Take the picture.

- Starting from the halfway point, press the shutter button the rest of the way down ("press the shutter button all the way down").
- The shutter will be released and a photograph will be taken.

## Recording Movies with the Touch Screen

When the mode dial is rotated to  (movie), the movie recording display will appear in the monitor. You can film movies using touch controls.

### 1 Rotate the mode dial to .

- Movie recording info will be displayed.

### 2 Position the AF frame over your subject.

- At default settings, [C-AF] is selected for [ AF Mode] and the camera will continually adjust focus for changes in the distance to the subject in the AF frame.

### 3 To focus on a subject in a different area of the frame without changing the composition, touch the display.

### 4 Press the (movie) button to start recording.

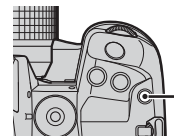

 (movie) button

### 5 Press the button again to end recording.

## Viewing photographs and movies

### 1 Press the button.

- The most recent picture will be displayed (single-frame playback).

### 2 To view a movie, press the OK button.

### 3 Highlight [Play Movie] and press the OK button.

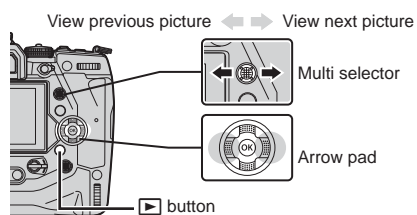

## Connecting the Camera to External Devices

Connect the camera to external devices, including computers or displays, using cables or via wireless LAN.

### **Connecting to Smartphones via Wi-Fi**

With a direct Wi-Fi link to the camera, smartphones can be used to view the pictures on the camera and take pictures remotely. With a **Bluetooth®** or Wi-Fi connection, you can view and download pictures using smartphone controls without even turning the camera on.

Connect using the "OLYMPUS Image Share" (Ol.Share) app.

### **Connecting to Computers via Wi-Fi**

Pictures can be automatically uploaded to a computer connected via a router or access point. You can take pictures using the camera and view them on the computer.

Connect using "OLYMPUS Capture" computer software.

### **Connecting to Computers via USB**

Connect the camera via USB to control it remotely and take pictures from a computer. You also have the option of uploading pictures to the computer automatically. Computers can be used to both take and view pictures at the same time.

Connect using "OLYMPUS Capture" computer software.

Photos and movies that have been uploaded to the computer can be edited or organized using "OLYMPUS Workspace".

### **Connecting to External Displays**

Pictures can be displayed on televisions connected to the camera via HDMI. Use the television to display pictures to an audience. When connected to a television, the camera can be controlled using the TV remote. No app or other software is required.

You can also connect the camera to HDMI monitors or video recorders.







## Using Your Charger Abroad

- The charger can be used in most home electrical sources within the range of 100 V to 240 V AC (50/60 Hz) around the world. However, depending on the country or area you are in, the AC wall outlet may be shaped differently and the charger may require a plug adapter to match the wall outlet.
- Do not use commercially available travel adapters as the charger may malfunction.

## Optional AC Adapters

The camera can be powered by an optional AC-5 AC adapter instead of batteries. Use only AC adapters specifically designated for use with the camera. The power cable supplied with the AC adapter cannot be used with other devices.

## SAFETY PRECAUTIONS

	<b>CAUTION</b> RISK OF ELECTRIC SHOCK DO NOT OPEN	
CAUTION: TO REDUCE THE RISK OF ELECTRICAL SHOCK, DO NOT REMOVE COVER (OR BACK). NO USER-SERVICEABLE PARTS INSIDE. REFER SERVICING TO QUALIFIED OLYMPUS SERVICE PERSONNEL.		
<p> An exclamation mark enclosed in a triangle alerts you to important operating and maintenance instructions in the documentation provided with the product.</p> <p> <b>WARNING</b> If the product is used without observing the information given under this symbol, serious injury or death may result.</p> <p> <b>CAUTION</b> If the product is used without observing the information given under this symbol, injury may result.</p> <p> <b>NOTICE</b> If the product is used without observing the information given under this symbol, damage to the equipment may result.</p>		
<p><b>WARNING!</b> TO AVOID THE RISK OF FIRE OR ELECTRICAL SHOCK, NEVER DISASSEMBLE, EXPOSE THIS PRODUCT TO WATER OR OPERATE IN A HIGH HUMIDITY ENVIRONMENT.</p>		

### General Precautions

**Read All Instructions** — Before you use the product, read all operating instructions. Save all manuals and documentation for future reference.

**Power Source** — Connect this product only to the power source described on the product label.

**Foreign Objects** — To avoid personal injury, never insert a metal object into the product.

**Cleaning** — Always unplug this product from the wall outlet before cleaning. Use only a damp cloth for cleaning. Never use any type of liquid or aerosol cleaner, or any type of organic solvent to clean this product.

**Heat** — Never use or store this product near any heat source such as a radiator, heat register, stove, or any type of equipment or appliance that generates heat, including stereo amplifiers.

**Attachments** — For your safety, and to avoid damaging the product, use only accessories recommended by Olympus.

**Location** — To avoid damage to the product, mount the product securely on a stable tripod, stand, or bracket.

### WARNING

- **Do not use the camera near flammable or explosive gases.**
- **Rest your eyes periodically when using the viewfinder.**  
Failure to observe this precaution could result in eyestrain, nausea, or sensations similar to motion sickness. The length and frequency of the required rest varies with the individual; use your own judgement. If you feel tired or unwell, avoid using the viewfinder and if necessary consult a physician.
- **Do not use the flash and LED (including AF illuminator) on people (infants, small children, etc.) at close range.**
  - You must be at least 1 m (3 ft.) away from the faces of your subjects. Firing the flash too close to the subject's eyes could cause a momentary loss of vision.
- **Do not look at the sun or strong lights with the camera.**
- **Keep young children, infants away from the camera.**
  - Always use and store the camera out of the reach of young children and infants to prevent the following dangerous situations which could cause serious injury:
    - Becoming entangled in the camera strap, causing strangulation.
    - Accidentally swallowing the battery, cards or other small parts.





- Accidentally firing the flash into their own eyes or those of another child.
- Accidentally being injured by the moving parts of the camera.
- **Should you notice that the charger is emitting smoke, heat, or an unusual noise or smell, immediately cease use and unplug the charger from the power outlet, and then contact an authorized distributor or service center.**
- **Stop using the camera immediately if you notice any unusual odors, noise, or smoke around it.**
  - Never remove the batteries with bare hands, which may cause a fire or burn your hands.
- Never hold or operate the camera with wet hands. This may cause overheating, exploding, burning, electrical shocks, or malfunctions.
- **Do not leave the camera in places where it may be subject to extremely high temperatures.**
  - Doing so may cause parts to deteriorate and, in some circumstances, cause the camera to catch fire. Do not use the charger if it is covered (such as a blanket). This could cause overheating, resulting in fire.
- **Handle the camera with care to avoid getting a low temperature burn.**
  - When the camera contains metal parts, overheating can result in a low-temperature burn. Pay attention to the following:
    - When used for a long period, the camera will get hot. If you hold on to the camera in this state, a low-temperature burn may be caused.
    - In places subject to extremely cold temperatures, the temperature of the camera's body may be lower than the environmental temperature. If possible, wear gloves when handling the camera in cold temperatures.
- The camera can be powered by one or two Olympus lithium-ion batteries. Use only batteries of the designated type. Batteries of other types could explode (or rupture). The batteries should only be charged using the designated charger. Do not use chargers of other types.
- Never incinerate or heat batteries in microwaves, on hot plates, or in pressure vessels, etc.
- Never leave the camera on or near electromagnetic devices. This may cause overheating, burning, or exploding.
- Do not connect terminals with any metallic objects.
- Take precautions when carrying or storing batteries to prevent them from coming into contact with any metal objects such as jewelry, pins, fasteners, keys, etc. The short circuit may cause overheating, exploding, or burning, which burn or damage you.
- To prevent causing battery leaks or damaging their terminals, carefully follow all instructions regarding the use of batteries. Never attempt to disassemble a battery or modify it in any way, solder, etc.
- If battery fluid gets into your eyes, flush your eyes immediately with clear, cold running water and seek medical attention immediately.
- If you cannot remove the battery from the camera, contact an authorized distributor or service center. Do not try to remove the battery by force. Damage to the battery exterior (scratches, etc.) may produce heat or an explosion.
- Always store batteries out of the reach of small children and pets. If they accidentally swallow a battery, seek medical attention immediately.
- To prevent batteries from leaking, overheating, or causing a fire or explosion, use only batteries recommended for use with this product.
- If rechargeable batteries have not been recharged within the specified time, stop charging them and do not use them.
- Do not use batteries with scratches or damage to the casing, and do not scratch the battery.
- Never subject batteries to strong shocks or continuous vibration by dropping or hitting. This may cause exploding, overheating, or burning.
- If a battery leaks, has unusual odor, becomes discolored or deformed, or becomes abnormal in any other way during operation, stop using the camera, and keep away from fire immediately.
- If a battery leaks fluid onto your clothing or skin, remove the clothing and flush the affected area with clean, running cold water immediately. If the fluid burns your skin, seek medical attention immediately.

#### CAUTION

- **Do not cover the flash with a hand while firing.**
- Never store batteries where they will be exposed to direct sunlight, or subjected to high temperatures in a hot vehicle, near a heat source, etc.
- Keep batteries dry at all times.
- The battery may become hot during prolonged use. To avoid minor burns, do not remove it immediately after using the camera.
- This camera uses one Olympus lithium-ion battery. Use the specified genuine battery. There is a risk of explosion if the battery is replaced with the incorrect battery type.
- Please recycle batteries to help save our planet's resources. When you throw away dead batteries, be sure to cover their terminals and always observe local laws and regulations.

#### NOTICE

- **Do not use or store the camera in dusty or humid places.**
- **Use SD/SDHC/SDXC memory cards only. Never use other types of cards.**

If you accidentally insert another type of card into the camera, contact an authorized distributor or service center. Do not try to remove the card by force.
- Regularly back up important data to a computer or other storage device to prevent accidental loss.



- OLYMPUS accepts no liability for any loss of data associated with this device.
- Be careful with the strap when you carry the camera. It could easily catch on stray objects and cause serious damage.
- Before transporting the camera, remove a tripod and all other non-OLYMPUS accessories.
- Insert the battery carefully as described in the operating instructions.
- Before loading, always inspect the battery carefully for leaks, discoloration, warping, or any other abnormality.
- Always unload the battery from the camera before storing the camera for a long period.
- When storing the battery for a long period, select a cool location for storage.
- Power consumption by the camera varies depending on which functions are used.

#### Using the wireless LAN/Bluetooth® functions

- **Turn off the camera in hospitals and other locations where medical equipment is present.**  
The radio waves from the camera may adversely affect medical equipment, causing a malfunction that results in an accident. Be sure to disable wireless LAN/Bluetooth® functions in the vicinity of medical equipment.
- **Turn off the camera when onboard aircraft.**  
Using wireless devices onboard may hinder safe operation of the aircraft. Be sure to disable wireless LAN/Bluetooth® functions onboard aircraft.
- **Do not use this product where it may interfere with nearby radar systems.**

#### FCC Notice

This equipment has been tested and found to comply with the limits for a Class B digital device, pursuant to part 15 of the FCC Rules. These limits are designed to provide reasonable protection against harmful interference in a residential installation. This equipment generates, uses and can radiate radio frequency energy and, if not installed and used in accordance with the instructions, may cause harmful interference to radio communications. However, there is no guarantee that interference will not occur in a particular installation. If this equipment does cause harmful interference to radio or television reception, which can be determined by turning the equipment off and on, the user is encouraged to try to correct the interference by one or more of the following measures:

- Reorient or relocate the receiving antenna.
- Increase the separation between the equipment and receiver.
- Connect the equipment into an outlet on a circuit different from that to which the receiver is connected.
- Consult the dealer or an experienced radio/TV technician for help.

- Only the OLYMPUS-supplied USB cable should be used to connect the camera to USB enabled personal computers.

#### FCC/ISED Caution

Changes or modifications not expressly approved by the party responsible for compliance could void the user's authority to operate the equipment.

This equipment must not be co-located or operated in conjunction with any other antenna or equipment except Olympus wireless equipment whose RF exposure was evaluated for this equipment.

For the latest information, please visit the Olympus website.

Website: <https://cs.olympus-imaging.jp/en/support/imsg/digicamera/download/notice/rfsimulist.cfm>

The available scientific evidence does not show that any health problems are associated with using low power wireless devices. There is no proof, however, that these low power wireless devices are absolutely safe. Low power Wireless devices emit low levels of radio frequency energy (RF) in the microwave range while being used. Whereas high levels of RF can produce health effects (by heating tissue), exposure of low-level RF that does not produce heating effects causes no known adverse health effects. Many studies of low-level RF exposures have not found any biological effects. Some studies have suggested that some biological effects might occur, but such findings have not been confirmed by additional research. IM010 has been tested and found to comply with FCC/ISED radiation exposure limits set forth for an uncontrolled environment and meets the FCC radio frequency (RF) Exposure Guidelines and RSS-102 of the ISED radio frequency (RF) Exposure rules.

## For customers in North America, Central America, South America and the Caribbean

Declaration of Conformity	
Model Number	: IM010
Trade Name	: OLYMPUS
Responsible Party	: <b>OLYMPUS AMERICA INC.</b>
Address	: 3500 Corporate Parkway, P. O. Box 610, Center Valley, PA 18034-0610, USA
Telephone Number	: 484-896-5000
Tested To Comply With FCC Standards FOR HOME OR OFFICE USE	
This device complies with part 15 of FCC Rules and Innovation, Science and Economic Development Canada's licence-exempt RSS(s). Operation is subject to the following two conditions:	
(1) This device may not cause harmful interference, and	
(2) This device must accept any interference received, including interference that may cause undesired operation.	

## For customers in Canada

For indoor use only (5150 - 5350MHz)

## For customers in Europe

### Simple Declaration of Conformity

Hereby, OLYMPUS CORPORATION declares that the radio equipment type IM010 is in compliance with Directive 2014/53/EU.

The full text of the EU declaration of conformity is available at the following internet address:  
<http://www.olympus-europa.com/>



This symbol [crossed-out wheeled bin WEEE Annex IV] indicates separate collection of waste electrical and electronic equipment in the EU countries. Please do not throw the equipment into the domestic refuse.



Please use the return and collection systems available in your country for the disposal of this product.



This symbol [crossed-out wheeled bin Directive 2006/66/EC Annex II] indicates separate collection of waste batteries in the EU countries.

Please do not throw the batteries into the domestic refuse.

Please use the return and collection systems available in your country for the disposal of the waste batteries.

For indoor use only (5150 - 5350MHz)

Wireless LAN	
Compatible standard	IEEE 802.11a/b/g/n/ac 2412–2472 MHz 5180–5320 MHz 56 mW or less
Firmware	Version 1.0 or later
Bluetooth®	
Compatible standard	Bluetooth Version 4.0 2402–2480 MHz 4 mW or less
Firmware	Version 1.0 or later

## For customers in Mexico

The operation of this equipment is subject to the following two conditions:

(1) it is possible that this equipment or device may not cause harmful interference, and (2) this equipment or device must accept any interference, including interference that may cause undesired operation.

## For customers in Singapore

Complies with IMDA Standards DB104634
---

## Certifications

Certification marks showing some of the standards with which the camera complies can be viewed via the camera's electronic display. These marks can be displayed as follows:

MENU button → \* tab → [i] tab → [Certification]

## Trademarks

- Wi-Fi is a registered trademark of the Wi-Fi Alliance.
- The Wi-Fi CERTIFIED logo is a certification mark of the Wi-Fi Alliance.
 

- The **Bluetooth**® word mark and logos are registered trademarks owned by the Bluetooth SIG, Inc. and any use of such marks by OLYMPUS CORPORATION is under license.
- All other company and product names are registered trademarks and/or trademarks of their respective owners.

Monitor	3.0" TFT color LCD
USB cable	CB-USB11
Lithium-ion battery	BLH-1
Lithium-ion charger	BCH-1
Operating environment (Temperature)	-10 °C/+40 °C/14 °F/+104 °F (operating); -20 °C/+60 °C/-4 °F/+140 °F (storage)
Water resistance	Type: IEC Standard publication 60529 IPX1 (applies if camera is used with Olympus waterresistant lens)



**OLYMPUS (CHINA) CO., LTD.**

Customer Support: 400-650-0303 Homepage: <http://olympus-imaging.cn>

**Customer Service Center:**

10F, K, Wah Centre, 1010 Huaihai Road(M), Xuhui District, Shanghai  
Zip: 200031

**OLYMPUS HONG KONG AND CHINA LIMITED**

Digital Camera Repair Centre  
L4207, Office Tower, Langham Place, 8 Argyle Street, Mongkok, Kowloon, Hong Kong  
Customer Hotline: +852-2376-2150 Fax: +852-2375-0630  
E-mail: [cs.ohc@olympus-ap.com](mailto:cs.ohc@olympus-ap.com)  
<http://www.olympus.com.hk>

**OLYMPUS KOREA CO., LTD.**

2F-3F Majestar City 1, 12, Seocho-daero 38-gil, Seocho-gu, Seoul,  
06655, Republic of Korea  
Tel. 1544-3200  
E-mail: [hotline.okr@olympus-ap.com](mailto:hotline.okr@olympus-ap.com)  
<http://www.olympus.co.kr>

**OLYMPUS (MALAYSIA) Sdn Bhd**

512, 5th Floor, Block D, Kelana Square 17, Jalan SS 7/26, Kelana Jaya,  
47301 Petaling Jaya, Selangor, Malaysia  
Tel: (603) 7806 2173  
Fax: (603) 7803 7164  
E-mail: [service.oml@olympus-ap.com](mailto:service.oml@olympus-ap.com)  
<http://www.olympus.com.my>

**OLYMPUS (Thailand) CO., LTD.**

23/112 Sorachai Building, 27th Floor, Soi Sukhumvit 63 (Ekamai)  
Sukhumvit road Klongton Nua, Wattana, Bangkok 10110 Thailand  
Tel: 662 787 8200  
E-mail: [imaging.oth@olympus-ap.com](mailto:imaging.oth@olympus-ap.com)