

NOTE: product should be referred to as 'KS Voice One' after first instance. 'app' should have lower case A.

KitSound

VOICE ONE

Smart Speaker

USER MANUAL

Please read this manual carefully before use.

Contents

3	Important Safety Instructions
4	Box contents
6	LED light ring status
6	Instructions for use
7	Power cables
7	App downloads
7	Connecting to a Wi-Fi network
7	Factory reset
7	iOS set up
8	Android set up
9	Brief introduction to the KS Player App
10	Amazon account set up
10	Amazon Alexa App
10	Tired of hearing the weather in Seattle? Here you can change that
10	Alexa Voice Services
10	Alexa
11	Alexa Skills
11	Interacting with the Alexa App
12	Spotify App
12	What is Spotify?
12	How to use Connect
12	When to use your Remote control
13	Multi-room audio set up
14	Connecting a Bluetooth device
14	Line-in connection
15	Care for your KitSound Voice One
15	Specifications
15	Troubleshooting
15	Amazon Alexa Privacy and Advertising Policy

Important Safety Instructions



1. Read these instructions.
2. Keep these instructions.
3. Heed all warnings.
4. Follow all instructions.
5. Do not use this apparatus near water.
6. Clean only with dry cloth.
7. Do not block any ventilation openings. Install in accordance with the manufacturer's instructions.
8. Do not install near any heat sources such as radiators, heat registers, stoves, or other apparatus (including amplifiers) that produce heat.
9. Do not defeat the safety purpose of the polarized or grounding-type plug. A polarized plug has two blades with one wider than the other. A grounding type plug has two blades and a third grounding prong. The wide blade or the third prong are provided for your safety. If the provided plug does not fit into your outlet, consult an electrician for replacement of the obsolete outlet.
10. Protect the power cord from being walked on or pinched particularly at plugs, convenience receptacles, and the point where they exit from the apparatus.
11. Only use attachments/accessories specified by the manufacturer.
12. Unplug this apparatus during lightning storms or when unused for long periods of time.

WARNING: Please refer to the information on exterior bottom enclosure for electrical and safety information before installing or operating the apparatus.

WARNING: To reduce the risk of fire or electric shock, do not expose this apparatus to rain or moisture. The apparatus shall not be exposed to dripping or splashing and that no objects filled with liquids, such as vases, shall be placed on the apparatus.

WARNING: The batteries (battery pack) are not to be exposed to excessive heat sources, such as sunshine, fire etc.

WARNING: The mains plug or an appliance coupler is used as the disconnect device, the disconnect device shall remain readily operable.

WARNING

Do not ingest battery, Chemical Burn Hazard

The remote control supplied with contains a coin/button battery. If the coin/button cell battery is swallowed, it can cause severe internal burns in just 2 hours and can lead to death.

Keep new and used batteries away from children.

If the battery compartment does not close securely, stop using the product and keep it away from children.

If you think batteries might have been swallowed or placed inside any part of the body, seek immediately medical attention.



Warning for apparatus containing user-replaceable Coin/Button Cell Battery



Spotify is all the music you'll ever need.
Millions of
songs available instantly. Just search for
the music
you love, or let Spotify play you something
great.

The Spotify software is subject to third party licenses found here:

www.spotify.com/connect/third-party-licenses

Box contents

- KitSound Voice One Smart Speaker
- Quick Start Guide
- UK power cable
- EU power cable
- US power cable
- 3.5mm Aux cable
- Remote control (coin cell battery included)

Speaker functions

1. Remote sensor
2. Standby & Microphone mute/unmute
3. Volume dial
4. Tap to Talk
5. LED light ring
6. Mode button (Bluetooth, Line-in and Wi-Fi)
7. Play/Pause/Pair button
8. KS LED Indicator*
9. Microphones
10. WPS button
11. Line-in (aux)
12. USB output (USB charge out)
13. AC mains input (AC 100-240 V – 50/60 Hz 0.5 A)

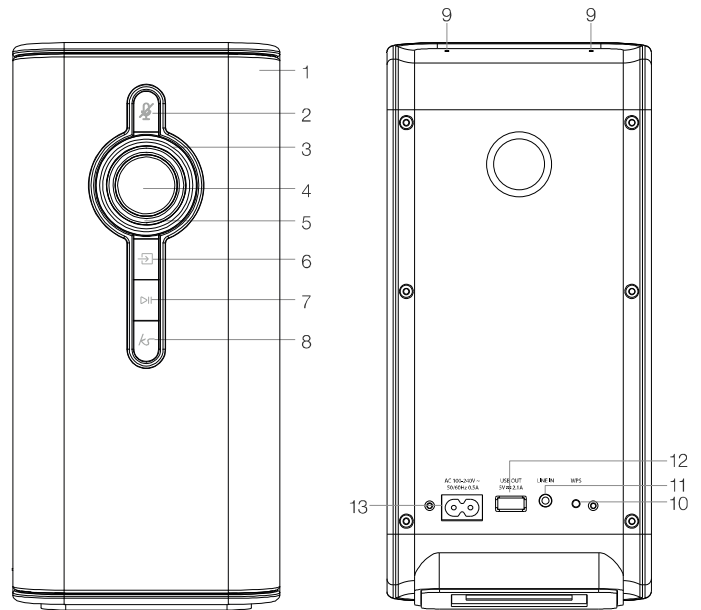

Remote functions

14. Microphone mute/unmute
15. Volume+
16. Previous track
17. Tap to Talk
18. Next track
19. Volume-
20. Mode
21. Play/Pause/Pair
22. Battery cover
23. Sensor

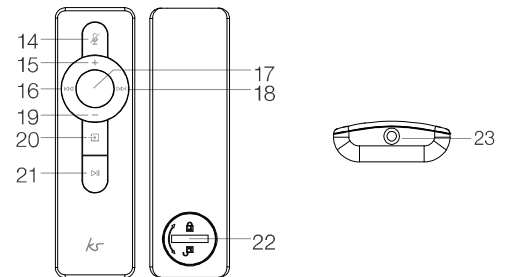

*The KS LED Indicator is not a button, do not press it. If the indicator is solid or flashing, the microphones will not be able to hear you. Reduce the volume or manually push Tap to Talk on the unit or remote.

Main speaker button functions

Control key	Long press (2 seconds)	Short press
Standby & Microphone mute/unmute	Turn unit On/Off	Disable/Enable mics
Tap to Talk	N/A	Wake Alexa to send a voice command without having the word "Alexa" beforehand
Mode	Make a group with chosen speaker becoming master	Change mode (Bluetooth/Line-in/Wi-Fi)
Play/Pause/Pair	Enter pairing mode (Bluetooth mode only)	Short press in Wi-Fi or Bluetooth mode to Play/Pause

LED light ring status

Speaker mode	LED colour	Flashing	Solid ON
Bluetooth	Blue	Disconnected	Connected
Wi-Fi	Turquoise	Alexa thinking	Alexa listening
	Blue & White	Alexa talking	-
	White	Wi-Fi disconnect	Wi-Fi connected
Line-in	Green	N/A	Line-in mode
All modes	Red	N/A	Mics off
All modes (when command is given)	Yellow	N/A	No network connection / not signed into Amazon account

Multi-room set up	
Speaker mode	LED colour
Master speaker (Bluetooth mode)	Blue
Master speaker (Line-in)	Green
Master speaker (Wi-Fi)	White
Slave speaker	Red

Instructions for use

Welcome to your new KS Voice One Smart Speaker. Hopefully you have followed the Quick Start Guide with your Voice One to get your new speaker up and running as quickly as possible.

Power cables

You have three power cables in the box, you must use the correct lead for your region and not use any third party leads as this will invalidate your warranty as we cannot guarantee their safety.

App downloads

The KitSound Player App is used for the setup and configuration of the Voice One Smart Speaker, please use the links below to download before setup.



Please hyper link the App icons with the below

<https://itunes.apple.com/gb/app/ks-player/id1291611967?mt=8>

<https://play.google.com/store/apps/details?id=com.wifiaudio.Kitsound>

To use the smart features on your KS Voice One, you must first connect your KitSound Voice to the KS App installed on your device. See 'Connecting to a Wi-Fi network' to complete this step.

Connecting to a Wi-Fi network

Once you have plugged in and turned on your KS Voice One, the LED light ring (5) will be solid white. Alexa will say "powering up for the first time" followed by "Wi-Fi mode" and then "ready for app setup". The LED light ring (5) will start flashing white.

Note: The default speaker location (Seattle) needs to be changed to reflect your location. Please read the Amazon Alexa app section after the set up.

iOS set up

1. Open up the KS App and select 'Wi-Fi Setup Wizard'



2. Select the option that says 'Settings' – this will take you to your phone's settings



3. Connect to the speaker - select Wi-Fi and select the network name that starts with 'KS Voice One... ', return to the KS Player App once the connection is made

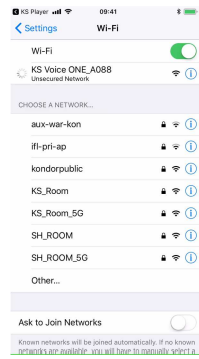

4. Connect to your network - choose your home Wi-Fi network and enter the password – click continue
Note: If you do not know your home network password it can often be found written on the Wi-Fi router

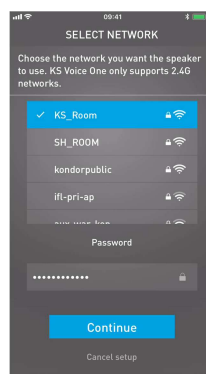

5. Almost done – please wait a few seconds for the speaker to connect to your chosen network. Once connected, the app screen will show your Wi-Fi connection strength

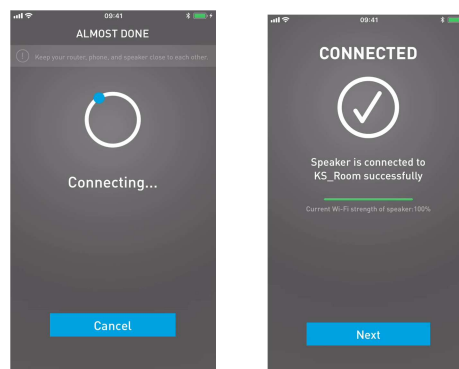

6. Now choose a name for your KitSound Voice One, you can keep the one it has, or set a custom one. If you are using multiple speakers in the home we recommend naming each speaker by location in the home

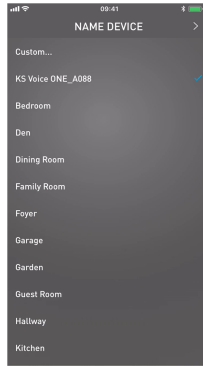

7. Sign in with your Amazon account details or create an account if you do not have one (see Amazon account set up instructions)

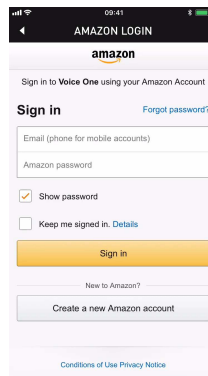

8. Finally, choose your preferred language for Alexa and confirm. Now you are ready to start talking to Alexa

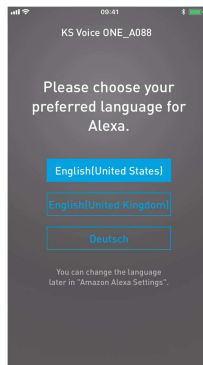

9. Privacy notice – you can mute the microphones on the KS Voice One by pressing the Microphone Mute button (2) on the speaker or (14) using the remote

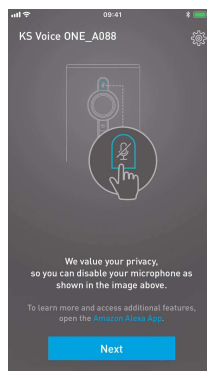

10. Once your speaker set up is complete it will become visible on your device list screen. From this screen you can adjust volume and configure the speaker into groups with other speakers on your network

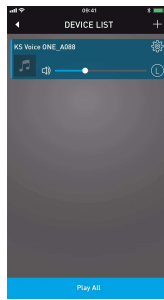

Android set up (Up to version 7)

1. Open up the KS App and select 'Wi-Fi Setup Wizard'

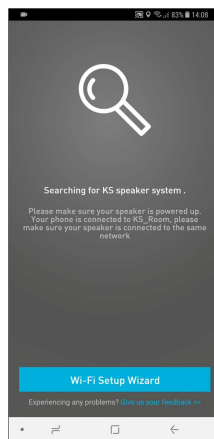

2. Select your speaker - choose the option that says '+Add' next to the KS Voice One – if no speakers appear on the list, please refresh the page by clicking the **Refresh icon** – the screen will appear with 'checking Wi-Fi' and then 'scanning'

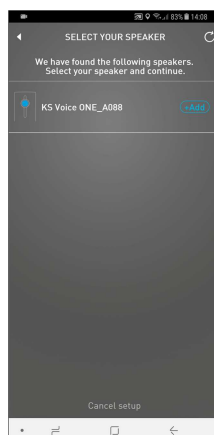

3. Connect to your network - choose your home Wi-Fi network and enter the password – click continue
Note: If you do not know your home network password it can often be found written on the Wi-Fi router

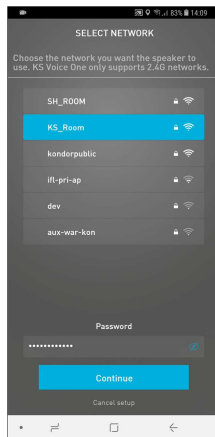

4. Almost done – just wait a few seconds for the speaker to connect to your chosen network – once connected the app screen will show your Wi-Fi connection strength

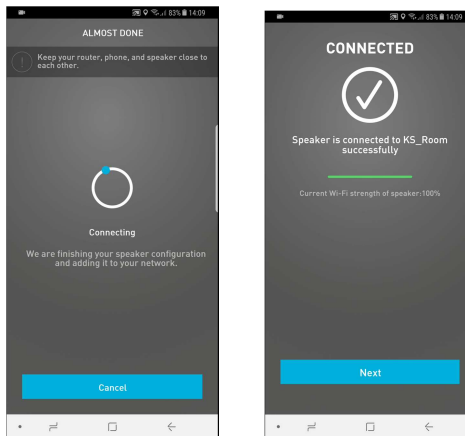

5. Now choose a name for your KitSound Voice One, you can keep the one it has, or set a custom one. If you are using multiple speakers in the home we recommend naming each speaker by location in the home



6. Sign in with your Amazon account details or create an account if you do not have one (see Amazon account set up instructions)

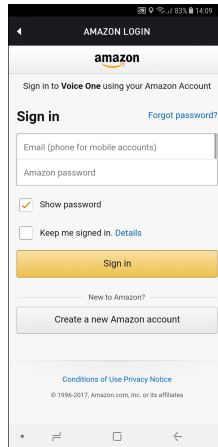

7. Finally, choose your preferred language for Alexa and confirm. Now you are ready to start talking to Alexa



8. Privacy notice – you can mute the microphones on the KS Voice One by pressing the Microphone Mute button (2) on the speaker or (14) using the remote

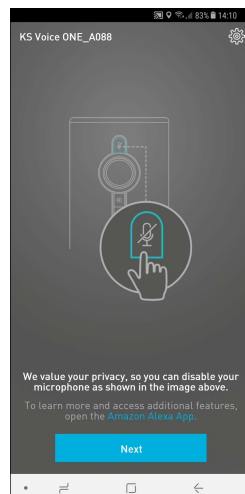

9. Once your speaker set up is complete it will become visible on your device list screen. From this screen you can adjust volume and configure the speaker into groups with other speakers on your network



Android Set Up (Android 8)

1. Open up the KS App and select 'Wi-Fi Setup Wizard'

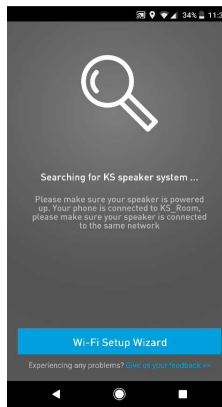

2. Select the option that says 'Settings' – this will take you to your phone's settings

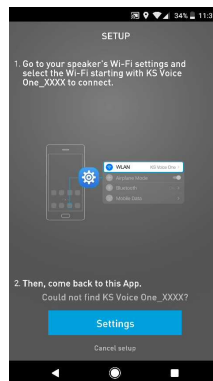

3. Select Wi-Fi and select the network name that starts with 'KS Voice One...' - then return to the KS Player App. An Android notification may show an alert explaining this connection does not have internet access. Select 'yes' to remain connected and continue set up.

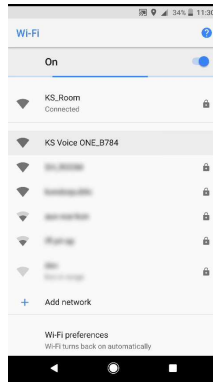

4. Select Network - choose your network and enter the password – click continue
Note: If you do not know your home network password it can often be found written on the Wi-Fi router

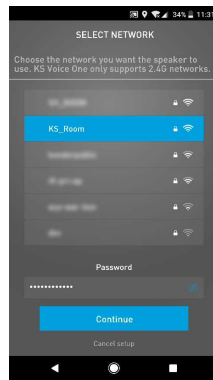

5. Almost done – please wait a few seconds for the speaker to connect to your chosen network – once connected the app screen will show your Wi-Fi connection strength

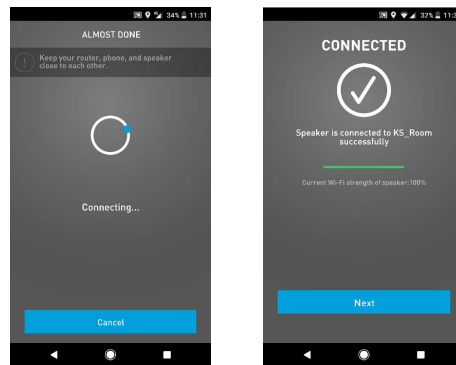

6. Now choose a name for your KitSound Voice One, you can keep the one it has, or set a custom one. If you are using multiple speakers in the home we recommend naming each speaker by location in the home

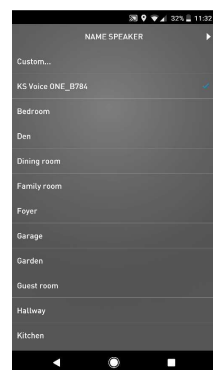

7. Sign in with your Amazon account details or create an account if you do not have one (see Amazon account set up instructions)

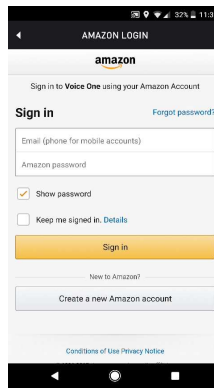

8. Finally, choose your preferred language for Alexa and confirm. Now you're ready to start talking to Alexa

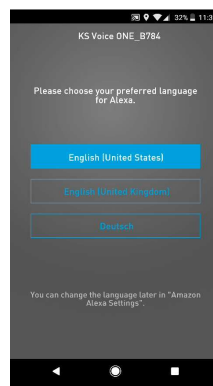

9. Privacy notice – you can mute the microphones on the KS Voice One by pressing the Microphone Mute button (2) on the speaker or (14) using the remote

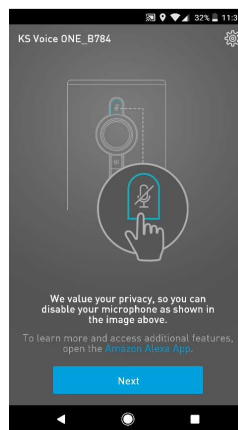

10. Once your speaker set up is complete it will become visible on your device list screen. From this screen you can adjust volume and configure the speaker into groups with other speakers on your network

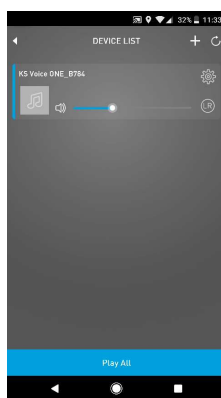

Factory reset

If your Voice One speaker fails to operate correctly, you can perform a factory reset.

- 1.
2. The Voice One will say “factory reset”, wait 10 seconds and remove the power cable from AC mains input (12)
3. Plug the power cable back in and the Voice One will say, “powering up for the first time” followed by “Wi-Fi mode” and then “ready for app setup”. The LED light ring (5) will start flashing white
4. Follow the ‘Connecting to a Wi-Fi network’ for set up

Brief introduction to the KS Player App

Once you’ve set up the speaker with the KS Player app your screen will show the ‘Device List’, this is where you can control your speaker from within the app. Here you can:

- Change the channel of your speakers from ‘stereo’ to ‘left’ or ‘right’ specific
- You can add more Voice One speakers to your network by pressing ‘+’
- Group multiple Voice One speakers (up to 8) by holding and dragging (see multi-room section of this manual for details)
- Select the **(Cog settings icon)** to change your speaker’s name
- Tap top left on the **(Graphic icon, 3 lines)** to show the Side Menu
- Perform system updates on you KS Voice One speaker

Note: Software updates – we are constantly looking to improve the performance of your KitSound Voice One. Over time software updates will be released via the KS Player app. When a software update option appears in the KS Player app we recommend updating as this will improve the performance of your speaker, unlock new services and fix any bugs.

Side Menu

Favourites – Add songs to your ‘favourites list’

My Music – Play music from your device and create playlist – please note that on iOS songs on the iCloud cannot be played here. Song files must be stored on the handset/tablets built in memory

Tunein – Listen to radio stations from around the world

iHeartradio – Listen to radio stations from around the world

Spotify – Is a music, podcast and video streaming service, log in to use Spotify Connect or voice control your music

Tidal - is a music and video streaming service

Naspter - is a music streaming service

Amazon Alexa – question suggestions and allows you to change the language

Edit music services – add or remove services from your main menu

Line-in – Listen to music and redistribute across your network direct from the 3.5mm aux connection

Bluetooth – Listen to music and redistribute across your network from a Bluetooth connection

Note: To exit “Line-in” or “Bluetooth” mode and change back to Wi-Fi mode select one of the online streaming services above

Note: Alexa can still be asked questions when in “Line-in” or “Bluetooth” mode

Settings – Information on the speaker firmware is available as well as a space to leave feedback

Note: If you experience problems when using the KS Voice one or KS player App we recommend you send feedback via the app. This allows our developers to identify the issue to resolve it as quickly as possible.

Amazon account set up

During the Voice One set up you will be asked to sign in to your Amazon account, if you don't have one then please follow these instructions:

1. Scroll down to create a new Amazon account
2. Create an account by entering your name, email address and a password
3. Click 'confirm' and 'I agree' after reading all terms and conditions on the next two screens
4. You have now set up an Amazon account; if you wish to use any of Amazon's services or apps you will need to finish completing your Amazon account details. Go to your Amazon account settings at www.amazon.com on a secure webpage to complete your personal profile details

Note: If you live in a territory outside of the United Kingdom, America and Germany you will need to create an Amazon account in one of those countries by either going to Amazon.co.uk, Amazon.com and Amazon.de. Once you have created your new Amazon account please set up the KS Player app with your new Amazon account. You will also need to login to your Amazon Alexa App with your new details.

Note: If you wish to use Amazon Music, you must either subscribe to Amazon Prime or an Amazon Unlimited Music Service.

Amazon Alexa App

Open the Amazon Alexa App and sign in to your existing Amazon account, or follow the steps shown in the 'Amazon account set up' section of this manual to create an account.

Your Voice One will be listed as a device where you can change your device's name, device location, time zone and other settings.

Changing Speaker Location

Many of Alexas most popular skills such as traffic and weather updates are location based. In order for Alexa to give accurate information you must configure your speakers location settings by following the steps below.

1. Open the Amazon Alexa app and select the side menu in the top left of the screen
2. Press 'Settings' and select your KitSound Voice One speaker
3. Scroll down to 'General' and press 'Edit' on Device Location.
4. Fill in your address and press 'Save'. Select the suggested address and press 'OK'.
5. Your device time zone will update following the address change, please check any alarms you have set.

Note: For users with multiple Voice One speakers, each speakers location will need to be updated by repeating the above process.

Find your FAQ's at: kitsound.co.uk/alexa-faqs

Alexa Voice Services

Alexa

To use Alexa, you must first connect your KitSound Voice **One** to the KS App installed on your device. See 'Connecting to a Wi-Fi network' to complete this step.

Once connected, you will have access to any of the services available via Alexa, including shopping, Amazon Prime music and any other Alexa Skill that has been added to your account.

Alexa Skills

Customise your KS Voice One with the thousands of Alexa Skills available to you. They will ensure your KitSound Voice One gets even smarter, enabling you to get the most out of it.

1. Open your Amazon Alexa App and tap the menu button in the top left corner of the screen, select "Skills"
2. Search for the Skill you want or explore the categories to discover something new
3. Scroll through the thousands of Skills and once you have found one you like, simply press 'Enable Skill' to add the function to your KS Voice One
4. When you're ready to use that Skill, just start by saying, "Alexa"

Note: If that particular Skill is linked to a third-party account, such as pizza delivery or a taxi company – you'll be asked to sign in.

For more information on Amazon Alexa Skills please visit: kitsound.co.uk/alexa-skills

Interacting with the Alexa App

The Amazon Alexa app acts as a dashboard for users to enable Skills and features on their Alexa devices.

Music & Books – from here you can access all supported music services available on your KitSound Voice One speaker.

Lists – shopping lists and to-do lists created using the KitSound Voice One speaker will be visible here. Use your shopping lists to purchase items from amazon online.

Alerts & Alarms – any reminders, timers or alarms created using KitSound Voice One speaker will be visible here.

Skills – browse the thousands of Skills that you can enable on your KitSound Voice One speaker. Navigate to the 'Your Skills' page to edit which skills you currently have enabled on your device.

Smart Home – configure smart home devices into groups, enable smart home skills and create smart home scenes. Scenes are used to control multiple smart home devices using a single voice command.

Things to Try – a list of voice commands for you to use on your KitSound Voice One speaker. This is a great way to get familiar with Alexa.

Settings – update personal information to tailor your Alexa experience.

Player – view information about the media being played on the speaker, navigate through tracks and control volume from your KitSound Voice One speaker.

Queue – view upcoming media in playlists without interrupting playback.

History – see a list of previous voice interactions with KitSound Voice One speaker.

Please follow the link to find out more on 'Things to try': kitsound.co.uk/alexa-things

Spotify App

What is Spotify?

A better way to listen at home. Play Spotify through your speakers, laptop and TV, using the Spotify app as a remote. Enjoy the music together.

How to use Connect

You'll need Spotify Premium to use Connect, see the leaflet in your speaker's box.

1. Add your new device to the same Wi-Fi network as your phone, tablet or PC (see product user instructions for details)
2. Open the Spotify app on your phone, tablet or PC, and play any song
3. If you're using the app on a phone - tap the song image in the bottom left of the screen. For tablet and PC move to step 4
4. Tap the Connect icon 
5. Pick your device from the list. If you can't see it, just check it's

connected to the same Wi-Fi network as your phone, tablet or PC.

All done! Happy listening.

Licenses

The Spotify Software is subject to third party licenses found here:

www.spotify.com/connect/third-party-licenses.

Remote control

We have included a Remote control as an alternative to voice activation. As well as volume and track adjustment, it also features the ability to mute the microphones and wake Alexa ready for a command.

Modes

Change the speaker's mode function by pressing the Mode button (19) to either Bluetooth, Line-in or Wi-Fi mode

Pairing a new device

Whilst in Bluetooth mode, to activate device pairing, long press Play/Pause/Pair (20)

Multi-room

You can use your Remote to make a multi-room speaker group. To create a multi-room group aim the remote at whatever speaker you would like to be the master unit and hold the mode button (19), all remaining speakers will become the slaves. Any slave speaker you point the Remote at whilst holding the mode button (19) will then disconnect from the group.

When you have your music loud

Press the Tap to Talk (16) button on the Remote if you're playing music over volume 8 and you want to ask a question but Alexa can't hear you. This will temporarily lower the volume allowing your voice command to be heard.

Note: In Multi-room set up only the master speaker's Tap to Talk button can be used.

Note: When your Remote stops responding, the coin cell battery will need replacing, you'll need to replace it with a: CR2025e Lithium 3 V.

Note: When speakers are grouped together in multi-room, all commands must be made from the remote to the master speaker

Multi-Room audio set up

You can link up to 8 KitSound Voice One Smart Speakers, for ultimate surround sound. Have one either side of your TV for Left/Right stereo or have one per room, so you can hear your favourite songs all over the house.

In the KS Player App

1. To add more KS Voice One Smart Speakers, press the '+' button in the top right corner, and repeat the steps in 'Connecting to a Wi-Fi network'
2. To link speakers into one group, hold down the selected device and drag it on top of the device you wish to be the master. You can change the channel of the device by clicking the 'LR' button to cycle through 'L' (left channel), 'R' (right channel) and 'LR' (stereo playback). If there is only one speaker in the room you should leave the speaker in 'LR' mode
3. The master speaker's LED light ring (5) will shine the colour indicating the media source (blue, green or white)
4. The LED light ring (5) of the slave speakers will shine red, indicating that their microphones have been disabled and it is part of a group
5. If you wish to remove a speaker from a group you can hold down the selected slave device and drag it into the bottom half of the screen. It will now return to being a separate speaker, free to play separate media

Using the speaker

1. Press and hold the Mode button (6) on the speaker or (19) on the remote, the chose speaker will create a group and become the master, all other speakers on the network will become slave speakers.
2. The LED light rings (5) of the slave speakers will shine red to indicate that the microphones have been disabled and the speaker has joined the new group
3. To remove a speaker from an existing group, simply pres and hold the Mode button (6) on the speaker or (19) on the remote. The LED light ring (5) will now shine blue, green or white depending on input mode and will be free to play media from another source

Note: If you take a speaker out of the group you will have to either use the app to put the speaker back in the group or re-create the group entirely using either of the methods above.

Connecting a Bluetooth device

You can connect Bluetooth enabled devices to your KitSound Voice One. Please follow steps below to pair. Once a device is connected via Bluetooth, audio can be streamed over the Wi-Fi network using the KitSound Player App.

1. Cycle through modes by pressing the mode button (6) or (20) on the remote to get to Bluetooth mode. The speaker will say "Bluetooth mode"
2. Long press the Play/Pause/Pair button (7) or (21) and the LED light ring (5) will flash blue to indicate it's in paring mode
3. Ensure your device's Bluetooth is turned on and search for 'KitSound Voice One' in available devices. Select this device
4. The devices will pair and the flashing LED light ring (5) will turn a solid blue
5. You will now be able to play music through your speaker via Bluetooth
6. To break the Bluetooth connection press and hold the Play/Pause/Pair button (7) or (21) and the KitSound Voice One will re-enter Bluetooth pairing mode
7. To re-pair any devices follow the steps 1-4 in this section

Line-in connection

You can also connect music sources to your KitSound Voice One via a wired connection. Once a device is connected using the 3.5 mm aux cable, audio can be streamed over the Wi-Fi network using the KitSound Player App.

1. Connect an audio device to the KitSound Voice One by inserting one end of the 3.5 mm aux cable into your media device and the other end into the Line-in (11) of the speaker
2. Press the Mode button (6) to cycle through modes until the LED light ring (5) turns solid green
3. You can now play your music from the audio device through the speaker(s)

PLEASE NOTE:

Your device will have an internal amplifier and if it is playing digital files like MP3s it will also have an integrated DAC (Digital Audio Converter). If you turn the volume up to 100%, your device will be sending a distorted signal. To avoid this, and to get the best quality from the speaker, we recommend that you do not run your device any higher than 95% volume when playing music via Bluetooth or Line - In. Some devices output higher than others, so you may need to reduce the volume if you experience distortion. Distortion will not occur when streaming directly from a Wi-Fi music source.

Auto standby

To save power, the Voice One will automatically enter standby if no music is played or no interaction has been made with the speaker for 15 minutes.

Simply saying “Alexa” or pressing the Tap to Talk button (4) or (17) will wake the speaker.

Note: If the microphones are muted and the speaker goes into standby mode, saying “Alexa” will not wake the speaker as the microphones will still be muted. Press the Tap to talk button (4) or (17) to wake the speaker

Care for Your KitSound Voice One

Please DON'T:

- Get the **Voice One** wet
- Drop the **Voice One** speaker as this will invalidate your warranty
- Open up the **Voice One** speaker. There are no user serviceable parts inside
- Expose the **Voice One** speaker to extreme temperatures or rapid changes of hot to cold or vice versa

Please DO:

- Clean the **Voice One** speaker with a soft dry cloth and no detergents

Specifications:

Bluetooth® V2.1 +EDR	
Wi-Fi frequency band	2.4 GHz
Bluetooth connectivity distance	up to 10 m
Remote IF distance	Up to 6 m
S/N	60 dB
Frequency response	60 Hz – 20 kHz
Drivers	2 x 63.5 mm
Power	2 x 10 W
USB charge out	5V, 2.1 A
AC input voltage	100 - 240V ~ 50/60 Hz
Dimensions (mm)	H278 x W130 x D130

Troubleshooting

We hope you've now got all the information you need to get started, but if you are having problems with your KitSound product, please feel free to contact us at: support@kitsound.co.uk

Amazon Alexa Privacy and Advertising Policy

Kondor Ltd is no way affiliated with, or endorsed by any of the skills on the Amazon Alexa system. We do not record any personal information and do not promote any over air advertisements. For more information on Privacy and advertising policy please see www.amazon.com

Hereby, Kondor Ltd declares that the radio equipment type, KSVOGY Voice One Smart Speaker, is in compliance with Directive 2014/53/EU.

The full text of the EU declaration of conformity is available at the following internet address:

<http://kondor.co.uk/product-documents>

FCC ID: LMZ- KS31330 / IC: 1036A - KS31330

This device complies with Part 15 of the FCC rules.

Operation is subject to the following two conditions:

- (1) this device may not cause harmful interference, and
- (2) this device must accept any interference received, including interference that may cause undesired operation.

CAUTION: Changes or modifications not expressly approved by the party responsible for compliance could void the user's authority to operate the equipment.

NOTE: This equipment has been tested and found to comply with the limits for a Class B digital device, pursuant to part 15 of the FCC Rules. These limits are designed to provide reasonable protection against harmful interference in a residential installation. This equipment generates, uses and can radiate radio frequency energy and, if not installed and used in accordance with the instructions, may cause harmful interference to radio communications. However, there is no guarantee that interference will not occur in a particular installation. If this equipment does cause harmful interference to radio or television reception, which can be determined by turning the equipment off and on, the user is encouraged to try to correct the interference by one or more of the following measures:

- Reorient or relocate the receiving antenna.
- Increase the separation between the equipment and receiver.
- Connect the equipment into an outlet on a circuit different from that to which the receiver is connected.
- Consult the dealer or an experienced radio/TV technician for help.

This device complies with Industry Canada's licence-exempt RSSs. Operation is subject to the following two conditions:

- (1) This device may not cause interference; and
- (2) This device must accept any interference, including interference that may cause undesired operation of the device.

Le présent appareil est conforme aux CNR d'Industrie Canada applicables aux appareils radio exempts de licence. L'exploitation est autorisée aux deux conditions suivantes :

- 1) l'appareil ne doit pas produire de brouillage;
- 2) l'appareil doit accepter tout brouillage radioélectrique subi, même si le brouillage est susceptible d'en compromettre le fonctionnement.

The use and operation of this speaker is beyond our control. Warranty of the KS Voice One is limited to defects caused by faulty manufacture or defects in materials only. No warranty whatsoever is given or implied for damage caused by the user under any circumstances.

This does not affect your statutory rights.

Please do not attempt to open this product. There are no user serviceable parts inside. If your product has an embedded, non-replaceable battery, do not attempt to access or remove the battery. This may cause personal injury and will damage the product.

Making any attempt to open the product or carry out repair voids any and all warranties.

We apologise for any inconvenience caused by minor inconsistencies in these instructions, which may occur as a result of product improvement and development.

The Bluetooth® word mark and logos are registered trademarks owned by the Bluetooth SIG, Inc. and any use of such marks by Kondor Ltd. is under license. Other trademarks and trade names are those of their respective owners.

Please recycle this packaging responsibly.

The use and operation of this speaker is beyond our control. Warranty of the KS Voice ONE is limited to defects caused by faulty manufacture or defects in materials only. No warranty whatsoever is given or implied for damage caused by the user under any circumstances.

This does not affect your statutory rights.

Making any attempt to open the product or carry out repair voids any and all warranties.

We apologise for any inconvenience caused by minor inconsistencies in these instructions, which may occur as a result of product improvement and development.

Please recycle this packaging responsibly.

Do not dispose of Lithium coin cell batteries with general waste.
Please return it to battery recycling collection point.

JB. 5745 / Made in China. © KitSound is a trademark of Kondor Limited, 2017
Christchurch, Dorset, BH23 4FL, UK