



APPENDIX H
: USER'S MANUAL



HomeSet™

HS-C200

Owner's Manual



Welcome!

Welcome to the world of HomeSet control and automation. Thank you for your purchase. Before operating the unit, please read this manual thoroughly, observe all safety precautions, and retain it for your future use.

Online Help:

<http://www.homesethome.com/support-manuals/#manuals>

For downloads and frequently asked questions.

Contact Support:

HomeSet is a URC product sold through Authorized Dealers and location throughout the USA. For questions or assistance, contact your Custom Installer/Programmer (write in Company Name, Email & Contact Info):

or Tech Support at: techsupport@universalremote.com

HomeSet/URC

500 Mamaroneck Ave., Harrison, NY 10528

Toll Free: (800) 901-0800

Main: (914) 835-4484

Important Information and Safety Precautions

HomeSet C200 Owner's Manual

© 2016 Universal Remote Control, Inc. all rights reserved. The information in this manual is copyright protected. No part of this manual may be reproduced in any form without written consent from Universal Remote Control.

Universal Remote Control SHALL NOT BE LIABLE FOR OPERATIONAL, TECHNICAL, OR EDITORIAL ERRORS/OMISSIONS MADE IN THIS MANUAL.

This book is intended for use by the homeowner or system user. For system custom installers and programmers, we offer additional manuals. The information in this manual is subject to change without notice. Feature may vary between customized software and URC releases. Contact your custom installation professional with questions to those regards.

URC, HomeSet, and Control the Experience are trademarks of Universal Remote Control, Inc. all other brands or product names are trademarks of their respective companies and owners.

Safety Precautions

For your safety, do not attempt to disassemble the C200 Hub. There are no user-serviceable parts inside. Use only the AC Adapter that is supplied with the unit. Do not expose for extended periods of time to excessive heat, moisture, or direct sunlight. Clean only with a soft, dry cloth. Changing the physical location of this unit to a place other than where originally installed may negatively affect performance of the C200 Hub.

Introduction

Your HomeSet C200 Control Hub lets you easily control and automate electronic components in your home (audio/video and home entertainment devices such as lights, thermostats, security systems, and more) to make life more enjoyable. The hub does this by sending coded infrared and Ethernet commands wirelessly or wired using wires installed by your smart home professional.

In the majority of installations, this hub functions with little or no interactions from you, the homeowner/system user. Please read and observe all precautions in this manual.

By using the HomeSet Mobile Android or iOS app on your smartphone or tablet with the HomeSet hub, you gain two-way control of your connected devices. "Two-way" means that in addition to data being sent to an electronic component (such as a Nest Thermostat), data is also returned to your phone/tablet so you can see graphical information of current status, including "What's Playing", volume, and more. Adding a handheld R200 remote control to the system provides the same two-way feature.

It's also possible to expand control to other rooms or areas of your home. Multiple C200 Hubs can be installed in up to eight (8) rooms using the same local network used for your home's Internet access.



HomeSet C200 Control Hub

The C200 Hub is a network-based product that requires the use of an installed local area Wi-Fi network (LAN).

For handy reference, we suggest you record the name and contact information of the professional who installed your system on the notes section on the last page of this manual.





HomeSet R200 Remote Control (Optional)

Using a HomeSet R200 Remote Control with a C200 Hub allows for control of smart home products such as lights, thermostats, and security as well as control of you audio and video (A/V) devices. The R200 is a Wi-Fi based remote control and does not use “line of sight” infrared (IR) or low frequency RF. It’s the perfect accessory companion for your television room or bedroom.

HomeSet Android and iOS Mobile App (Included)

When used with the C200 Hub, the HomeSet "Entertain" Android and iOS Mobile Apps provide full control of A/V components, without need for a "point and shoot" IR remote control. The mobile app also provides advanced Internet Protocol (IP) command/control of network-based equipment. Use the HomeSet "Automate" app to control your Z-Wave® Lights, Thermostats, Door Locks, and IP Cameras if a URC TRF-ZW Z-Wave bridge has been installed with you system.



Features and Benefits

Enjoy the following key features:

- **Connect with Wi-Fi or Wired Ethernet**

Your professional installer/programmer connects the C200 Hub to a wired or wireless Ethernet network. The Wi-Fi capability of the C200 provides installation flexibility.

- **Control Smart Home Products with Ease**

HomeSet provides an elegant way to control entertainment products plus smart home devices in and around your home. For example, you can check on the kids in the backyard and turn on outside lights at dusk right from your smartphone. Or switch on the TV and your Blu-ray player and start a favorite movie with one press on your smartphone or optional remote.

- **Two-way Meta-data Feedback**

Experience two-way feedback on your smartphone, tablet, or optional R200 remote screen when used with compatible home devices such as entertainment, lights, and more. Two-way control of Nest is available on the R200 remote control and via HomeSet's mobile apps. Enjoy the same feedback when used in conjunction with a regularly-expanding line of products made by other manufactures.



What's Included in the Box:

The following comprise of the parts and pieces of the C200:

1. C200 Control Hub
2. AC Power Adapter/12 Volt 1000 mA Power Supply
3. Ethernet Network Cable
4. Five (5) Standard IR Emitters
5. One (1) Wall Mount Plate with Four (4) Mounting Screws.

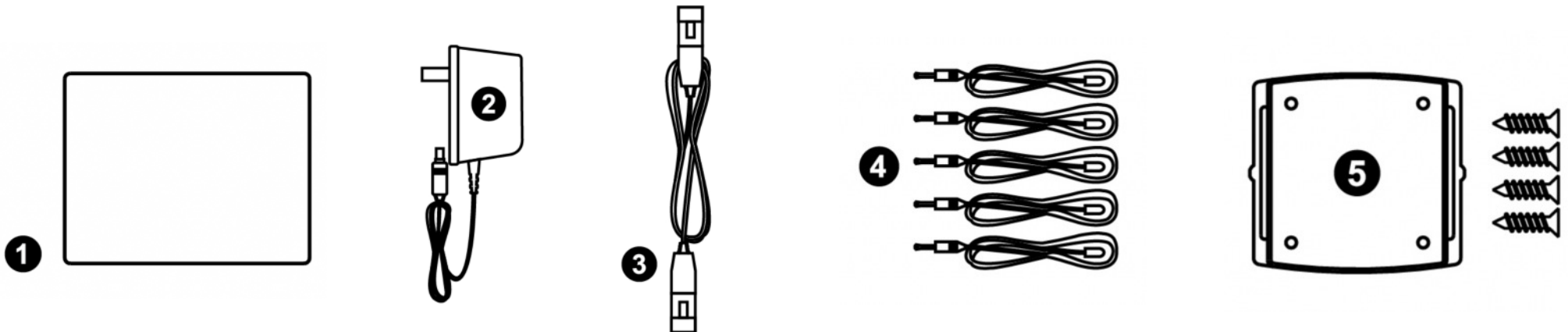

Before Getting Started

Keep in mind the following:

- Designed for use on your local wireless network, the C200 Hub is designed for use on your local wired or wireless network, much in the same way your tablets or computers do.
- By adding an optional R200 Remote or the HomeSet Mobile App on smart devices, the hub controls your home's A/V products. Add an optional TRF-ZW Z-Wave Gateway to control your home's Z-Wave lights, thermostats, door locks, and more.
- Your professional installer who programs your HomeSet system can automate you home entertainment, comfort, and security devices. Further enhancements and upgrades may be possible. Contract your installer for further details.



Notice

Some of the following sections contain information that is useful to the professional installer/programmer who installed your system. It's not necessary for you to learn the details; however, we recommend you read them to be aware of the functions and capabilities of your HomeSet system.

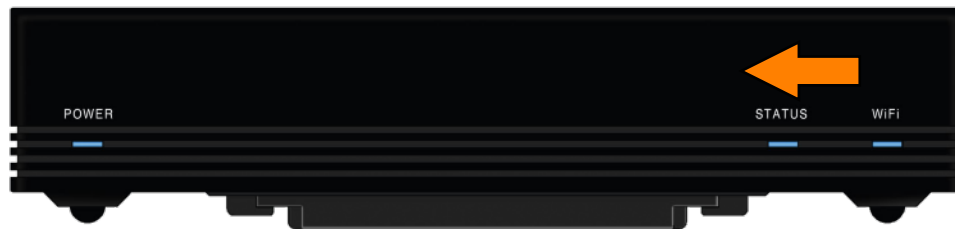

Front Panel

The front panel of the hub houses an IR "blaster". The front panel blaster sends IR commands to components in the same cabinet or in line-of-sight of the hub.

The front panel IR blaster can be enabled or disabled via HomeSet's Web Programming software. Your installer/programmer has programmed your hub to use either the rear panel IR emitter outputs or the front panel IR blaster, but not both.

The front panel IR blaster on the hub can also be used for "learning" IR commands from another remote control. Any "learned" IR command is saved by the HomeSet Web Programming software.

Rear Panel

IR Outputs

The rear panel of the hub houses five (5) infrared emitter ports, allowing for control of any A/V device normally controlled by a simple "point and shoot" IR remote.

Self-adhesive "flashers" (included) affix to the front of your TV, Blu-ray player, and other equipment where there is an IR "window". Thin wires connect flashers to the IR output ports, show below.



Ethernet LAN Connection/Wi-Fi

A standard Ethernet LAN connection port is provided for a wired connection to a local network via included Cat5 cable. The C200 also supports a wireless Ethernet (Wi-Fi) connection to the same local network used for Internet access.

Controlling Other Network Devices (IP Control)

The C200 Hub can also control other IP-compatible equipment connected to the same local network. The hub can send "one-way" IP commands to other network devices such as TVs, projectors, and A/V receivers.

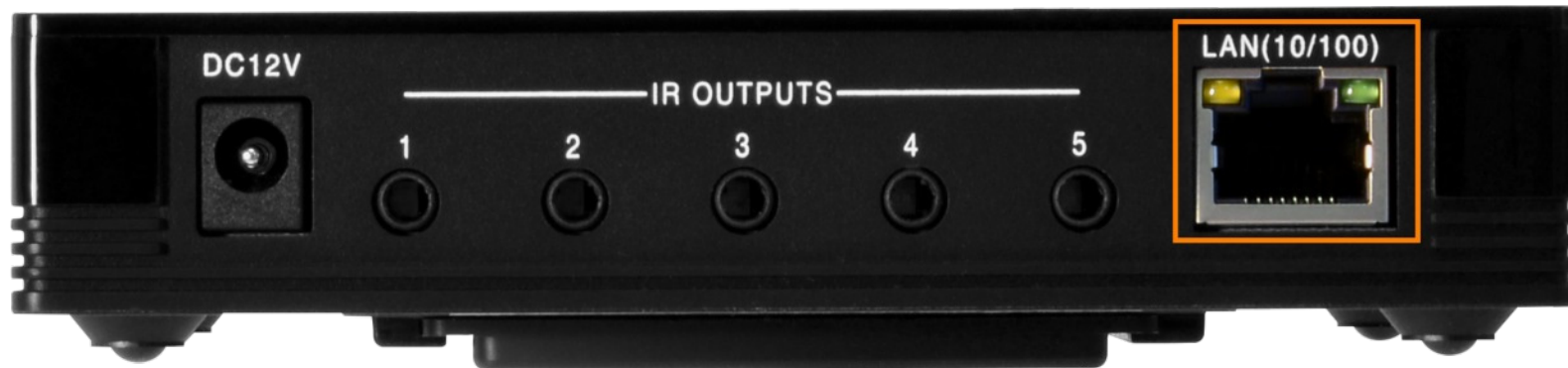

DC Power Input

The C200 is powered by an AC power adapter that plugs into the input port shown below. The power supply is a 12 volt, 1-amp supply. Use only the AC Adapter supplied with the unit in all circumstances.



Top Panel

The top panel of the hub features three LED indicators that display the status of the C200.

Power LED

This LED illuminates blue when DC power is applied.



Status LED

The C200 status LED has six (6) possible states:

Blue LED: illuminates blue when the hub is connected to the HomeSet server and fully programmed to control your home system.

Red LED: illuminates red when the hub is connected to the HomeSet server, but has not yet been programmed to control your home system.

Green LED: illuminates green when the hub is operating in a secondary room within the system.

Blinking Red LED: blinks red when the hub cannot connect to the HomeSet server. Please check your network connections.

Blinking Green LED: blinks green when the hub's firmware is being updated.

Blinking Blue LED: blinks blue when being programmed by the HomeSet server.



Wi-Fi LED

The C200 Wi-Fi LED has six (6) possible states:

Blue LED: illuminates blue when hub is connected to your network via a Wi-Fi signal, with excellent signal strength.

Green LED: illuminates green when the hub is connected to your network via a Wi-Fi signal, with good signal strength.

Yellow LED: illuminates yellow when the hub is connected to your network via a Wi-Fi signal, with fair signal strength.

Red LED: illuminates red when the hub is connected to your network via a Wi-Fi signal, with poor signal strength.

Blinking Red LED: blinks red when there is an error connecting to your network wirelessly.

Off: the LED is off when the hub is connected to your local network via a wired Ethernet connection.



Bottom Panel

Reset Button

A single, momentary press of the Reset button REBOOTS the C200 Hub, similar to removing and then reapplying the DC power source.

DO THIS ONLY IF INSTRUCTED TO DO SO BY YOUR INSTALLER OR BY HOMESET TECH SUPPORT.

Pressing and holding the Reset button for ten (10) seconds results in setting the hub to "factory default". All user data and programming will be erased and your system will not operate until reprogrammed.

DO THIS ONLY IF INSTRUCTED TO DO SO BY YOUR INSTALLER OR BY HOMESET TECH SUPPORT.



MAC Address Stickers

Two (2) MAC address stickers are provided and are located on the bottom panel of the C200 Hub. MAC stands for “media access control”. This unique address is used to identify your hub on the network and on HomeSet’s cloud server.

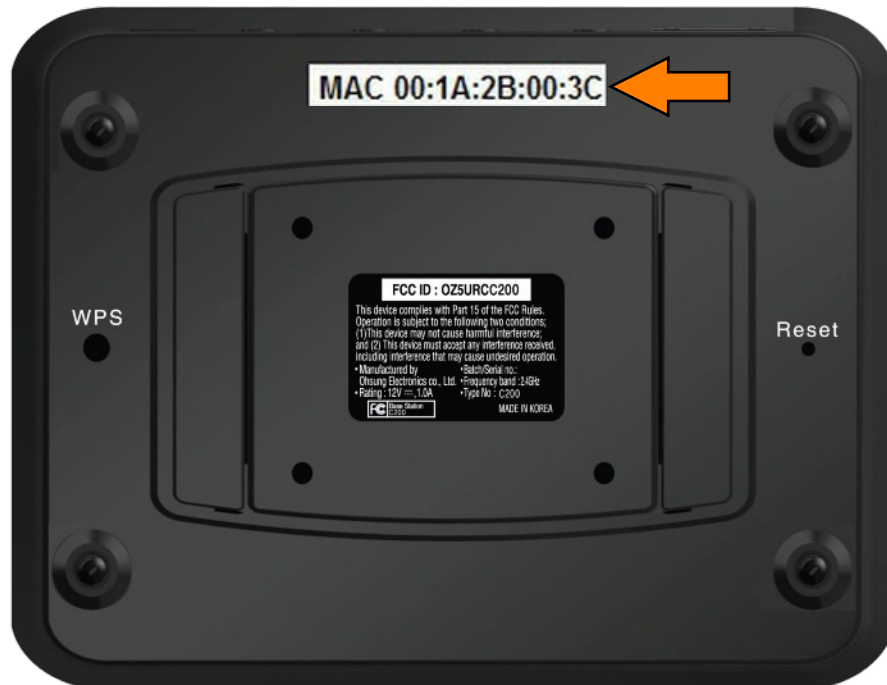

WPS Button

A WPS button is provided, allowing the hub to be installed on a Wi-Fi network using the “WPS” method (Wi-Fi Protected Setup). This control is used by your professional installer.

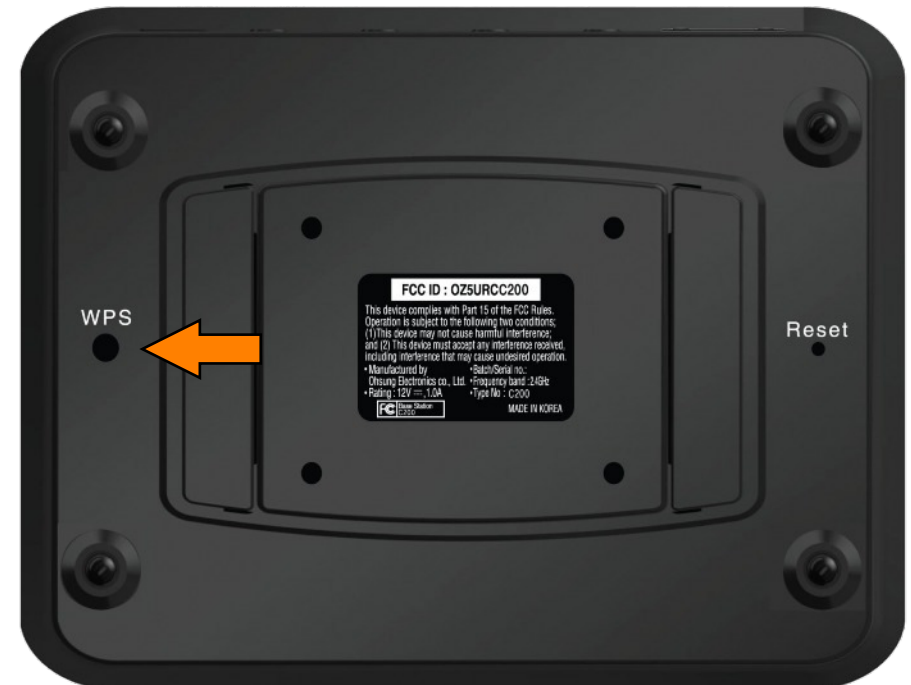

Removable Mounting Plate

A removable mounting plate and four (4) mounting screws are provided and can be used to mount the hub to a flat surface such as a ceiling, wall, or entertainment center.



Network Installation

The C200 Hub can be installed using a Wi-Fi wireless Ethernet connection or via traditional hard-wired Ethernet connection. When installing the hub for the first time, your installer must perform one of the two following steps:

- Connect the hub to your wireless access point by using the WPS button on the hub and the one on the wireless access point.

When successfully connected to the wireless access point, the Wi-Fi LED on the hub will glow either blue, green, yellow, or red based on Wi-Fi signal strength. Setup is now complete. If you wish to set specific network settings see section below:

Or

- Connect the hub to the local Ethernet network via a wired Ethernet connection.

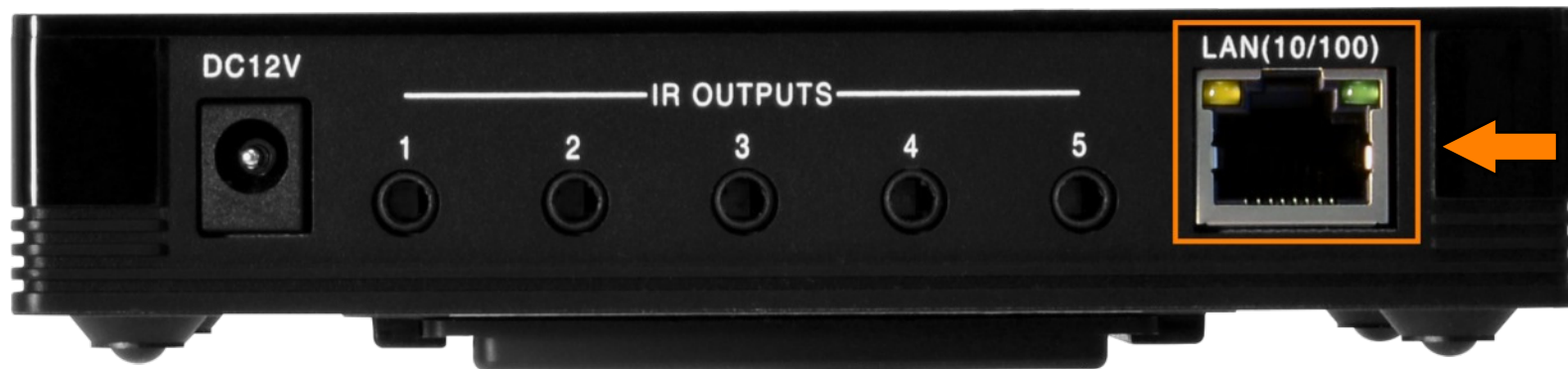

When the Status LED illuminates red, use an R200 remote to set the network properties of the C200 Hub.

Note that the HS-R200 Remote Control is required to be on the same local Ethernet network as the hub to set the network properties of the hub. An R200 is required for setup but not required in a HomeSet system for daily use.

To set the network properties of the hub, insert the battery into the remote control and follow the screen prompts. Setting up the HomeSet system is similar to setting up a new tablet or mobile phone for the first time.

C200 Hub Programming

Each C200 Hub requires professional programming for control of the equipment in your home. By connecting the hub to the network and adjusting the hub's network properties with the R200 remote, the system can be programmed by the HomeSet Web Programming Software.

When the system is programmed with the HomeSet Web Programming Software, a handy backup of the system file is stored within HomeSet's server and can be accessed and edited at any time by a smart home professional installer.

If an optional TRF-ZW Gateway is added to a HomeSet system to enable Z-Wave control, additional programming steps and setup steps will be required.



Limited Warranty Statement and Disclaimers

Please refer to the URC complete Limited Warranty:

www.homesethome.com/limited-warranty-statement/

This Limited Warranty is valid only in the United States of America.

Any URC/HomeSet equipment that is purchased from an unauthorized source will not be eligible for

- a) Technical Support or support of any kind from URC/HomeSet
- b) Any Warranty by URC/HomeSet.

Specifications

- **IR Range (line of sight via IR):** 30 to 50 feet, depending on the environment.
- **IR Port:** 5 available rear ports
- **Macro Capability:** up to 255 steps each
- **Wi-Fi:** IEEE 802.11 b/g/n
- **Size:** 1.2" H x 3.99" D x 5.13" W
- **Weight:** 5.4 oz
- **Memory:** DDR2 SDRAM 256MB
- **Power:** 12V DC 1A

Updating

HomeSet features and hardware may be updated from time to time. Manual HomeSet software and/or hardware updates should only be performed by your authorized HomeSet installer/programmer. Features may vary between customized software and URC software releases. To find out more please contact your custom installation professional with questions. All information, features, benefits, and user screens are subject to change without notice.

End User Agreement

Terms and conditions of the End User Agreement are available at:

www.universalremote.com/end-user-agreement/ apply.

Federal Communication Commission (FCC) Interference Statement

This equipment has been tested and found to comply with the limits for a Class B digital device, pursuant to part 15 of the FCC Rules. These limits are designed to provide reasonable protection against harmful interference in a residential installation.

This equipment generates, uses and can radiate radio frequency energy and, if not installed and used in accordance with the instructions, may cause harmful interference to radio communications. However, there is no guarantee that interference will not occur in a particular installation. If this equipment does cause harmful interference to radio or television reception, which can be determined by turning the equipment off and on, the user is encouraged to try to correct the interference by one more of the following measures:

- Reorient or relocate the receiving antenna.
- Increase separation between the equipment and receiver.
- Connect the equipment into an outlet on a circuit different from that to which receiver is connected.
- Consult your dealer/installer or an experienced radio/TV technician for help.

Warning!

Changes/modifications not expressly approved by OHSUNG Electronics Co., Ltd could void user's authority to operate the equipment. OHSUNG Electronics Co., Ltd is not responsible for any Radio or TV interference caused by unauthorized modifications to this equipment. Such modifications could void the user's authority to operate the equipment.

FCC Caution

This device complies with Part 15 of the FCC Rules. Operation is subject to the following two conditions: (1) this device may not cause harmful interference, and (2) this device must accept any interference received, including interference that may cause undesired operation. Any changes or modifications not expressly approved by the party responsible for compliance could void the authority to operate equipment. The antenna(s) used for this transmitter must not be co-located or operating in conjunction with any other antenna or transmitter.

Federal Communication Commission (FCC) Radiation Exposure Statement

This device is approved as a table-top device which is normally operated at 20cm from a person's body.

Your HomeSet C200 Notes Page

- Custom Installer/Programmer Company Name, Email & Contact Info:

- HomeSet C200 Serial Number:

- Date of Installation/Programming Completion

Notes
