

Main Settings Menu



DISPLAY- Press this setting button to adjust the screen and button backlighting. The longer your screen is lit, the more frequently you'll need to charge the MX-980.

SOUND - Adjust the volume of the sounds your MX-980 makes when you press buttons.

SYSTEM - These settings are for service use. For diagnostic purposes, an installer can turn off the Pick Up sensor, display remaining battery charge and erase all programming permanently. Some of this menu may have been disabled by your installer as a safety measure.

INFORMATION - Adjust the time, date or you can display the amount of memory available and the version number of the firmware loaded into your MX-980.

Adjusting the Display



BACKLIGHT - Specify how long the MX-980 screen should stay lit after you press a button. You can select two different time out settings. One for when it is hand held, another for when it is in the charging base.

BRIGHT - Adjust the brightness of the screen.

BUTTON LIGHT - Turn the backlighting for all buttons on or off. When on, all the buttons backlight so that you can read their labels in total darkness.

Sound Volume

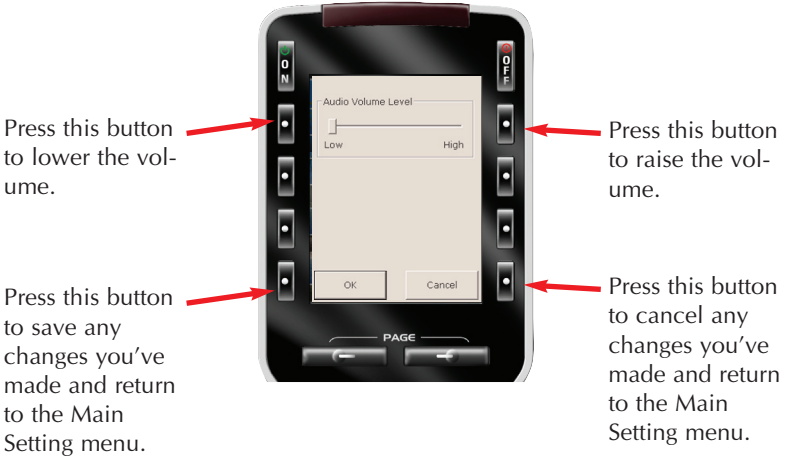

System Settings Menu

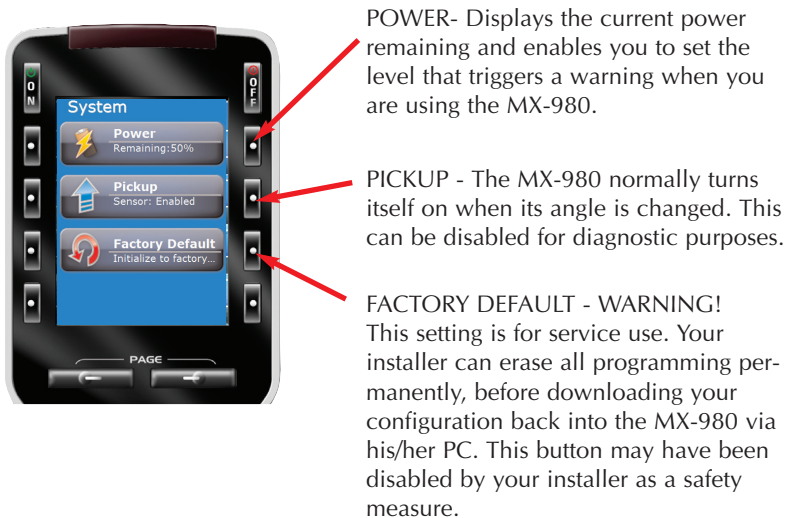

Information Menu



DATE- Press this button to set the date.

TIME - Press this button to set the time.

MEMORY - Press this button to display the amount of memory available.

VERSION - Press this button to display the version of the MX-980 firmware.

Setting Time

Press this button to change from AM to PM.

Press this button to turn daylight savings time on.

Press this button to save any changes you've made and return to the Main Setting menu.



Each time you press this button the hour will change.

Each time you press this button the minute will change.

Press this button to turn daylight savings time off.

Press this button to cancel any changes you've made and return to the Main Setting menu.

USA Limited Warranty Statement

Your Universal Remote Control, when delivered to you in new condition, is warranted against defects in materials or workmanship as follows: UNIVERSAL REMOTE CONTROL, INC. warrants this product against defects in material or workmanship for a period of one (1) year and as set forth below. Universal Remote Control will, at its sole option, repair the product using new or comparable rebuilt parts, or exchange the product for a comparable new or rebuilt product. In the event of a defect, these are your exclusive remedies.

This Limited Warranty covers only the hardware components packaged with the Product. It does not cover technical assistance for hardware or software usage and it does not cover any software products whether or not contained in the Product; any such software is provided "AS IS" unless expressly provided for in any enclosed software Limited Warranty.

To obtain warranty service, you must deliver the product, freight prepaid, in its original packaging or packaging affording adequate protection to Universal Remote Control at the address provided in the Owner's Manual. It is your responsibility to backup any macro programming, artwork, software or other materials that may have been programmed into your unit. It is likely that such data, software, or other materials will be lost during service and Universal Remote Control will not be responsible for any such damage or loss. A dated purchase receipt, Bill of Sale, Installation Contract or other verifiable Proof of Purchase is required. For product support and other important information visit Universal Remote Control's website:

<http://www.UniversalRemote.com>

Or call the Universal Remote Control Customer Service Center (914) 835-4484.

This Limited Warranty only covers product issues caused by defects in material or workmanship during ordinary consumer use. It does not cover product issues caused by any other reason, including but not limited to product issues due to commercial use, acts of God, third-party installation, misuse, limitations of technology, or modification of or to any part of the Universal Remote Control product. This Limited Warranty does not cover Universal Remote Control products sold as USED, AS IS, REFURBISHED, so-called "B STOCK" or consumables (such as batteries). This Limited Warranty is invalid if the factory-applied serial number has been altered or removed from the product. This Limited Warranty is valid only in the United States of America. This Limited Warranty specifically excludes products sold by unauthorized resellers.

Specifications

Microprocessor: ARM9 32bit 202MHz

LCD - 2.4" TFT (QVGA) 262,144 Colors

Memory - 64 Megabytes of SDRAM & 32 Megabytes of Nand Flash
Devices - Supports up to 255 Devices with text, less with heavy graphics usage

Pages - Supports up to 255 Pages on each Device with text, less with heavy graphics usage

Learning Capability - Standard frequencies (15kHz to 455kHz)

Macro Capability - Up to 255 steps each, however nesting is allowed

IR Range (Line of Sight via Infrared): 30-50 feet, depending on the environment

RF Range (radio frequency): 50 to 100 feet, depending upon the environment

RF Frequency: 418MHz

Batteries: 1070mAh, 3.7 Volt Lithium Ion battery pack included

Battery Life: 120 minutes continuous use, 6000 minutes in standby mode.

Weight: 7 oz. (with battery)

Size: 2.4" x 9.2 x 1"

Information To The User

This equipment has been tested and found to comply with the limits for a Class B digital device, pursuant to part 15 of the FCC Rules. These limits are designed to provide reasonable protection against harmful interference in a residential installation. This equipment generates, uses and can radiate radio frequency energy and, if not installed and used in accordance with the instructions, may cause harmful interference to radio communications.

However, there is no guarantee that interference will not occur in a particular installation. If this equipment does cause harmful interference to radio or television reception, which can be determined by turning the equipment off and on, the user is encouraged to try to correct the interference by one more of the following measures:

- ◆ Reorient or relocate the receiving antenna.
- ◆ Increase the separation between the equipment and receiver.
- ◆ Connect the equipment into an outlet on a circuit different from that to which the receiver is connected.
- ◆ Consult the dealer or an experienced radio/TV technician for help.

Warning

Changes or modifications not expressly approved by the manufacturer could void the user's authority to operate the equipment.

Note : The manufacturer is not responsible for any Radio or TV interference caused by unauthorized modifications to this equipment.

Such modifications could void the user's authority to operate the equipment.



 **Universal Remote Control®**

500 Mamaroneck Avenue, Harrison, NY 10528

Phone: (914) 835-4484 Fax: (914) 835-4532

www.universalremote.com