

## RFID (4336821A) installation procedure

A toner cartridge is equipped with RF-ID TAG.□

If toner cartridges are set to a printer, communication of RF-ID TAG and a RFID read writer module will be attained.□

The function of this system is the following: Management of the existence detection and toner residual quantity of a toner cartridge.□

4336821A are attached printer base unit according to the following figure.

1. To assemble Board-RFID to Plate-Shield-RFID with two screws.

RFID Assy – PCB

2. To assemble RFID Assy-PCB to Plate-Inner with two screws.

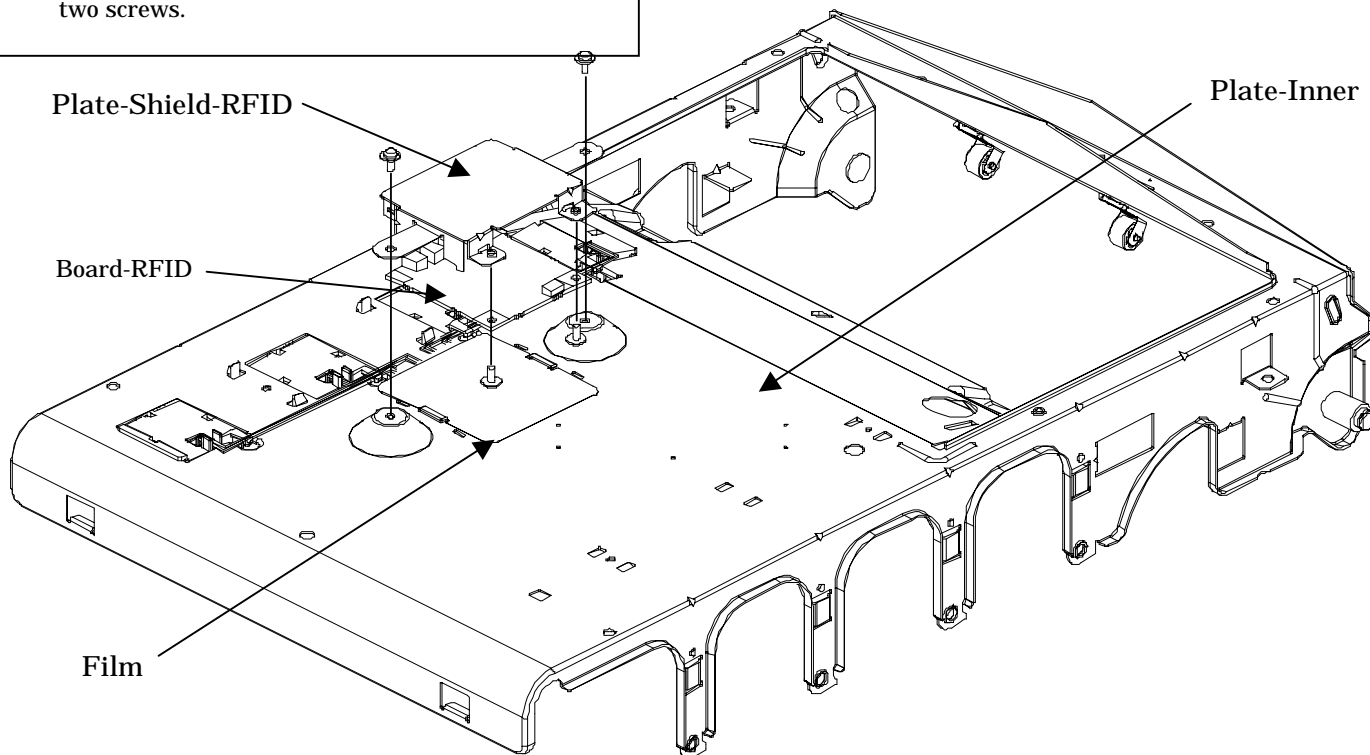

after assembly

Plate Assy – Inner (4336821A)

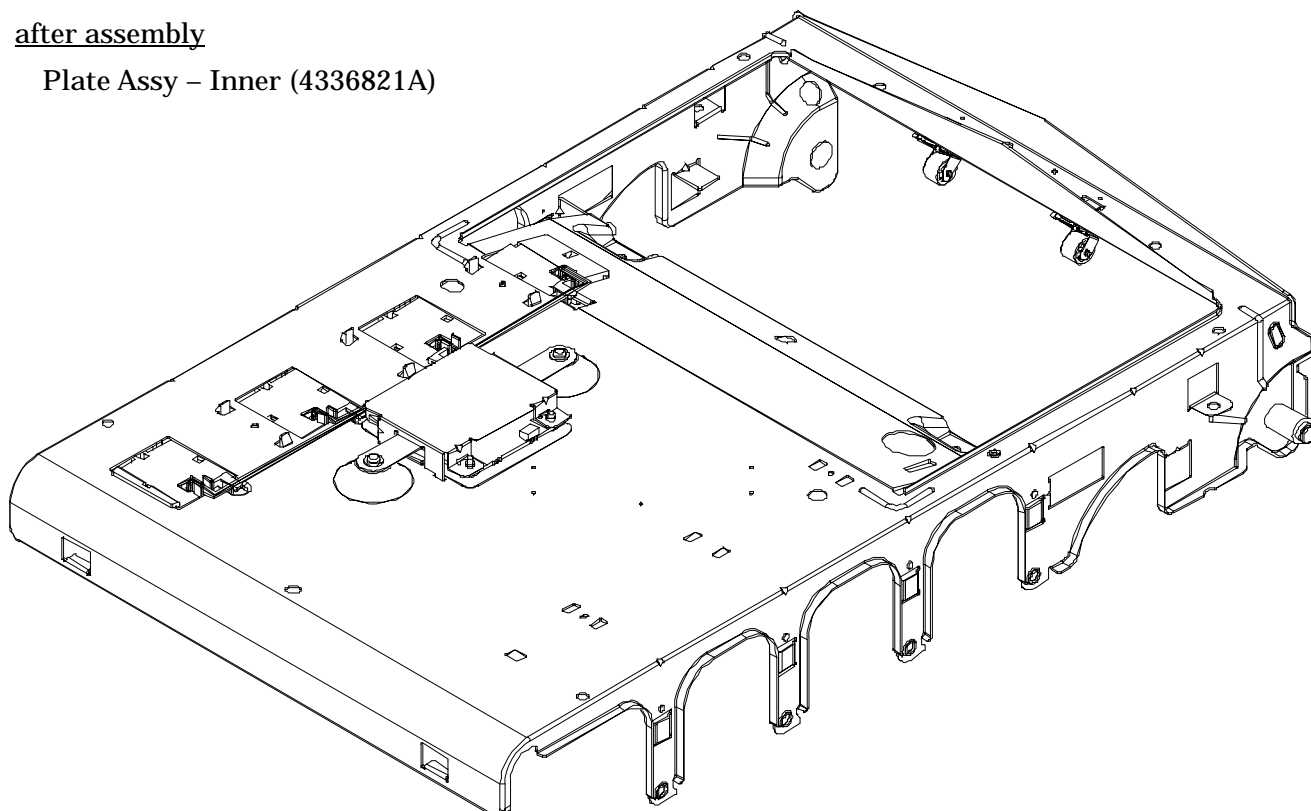

To assemble Head-Cable, Holder-Head,  
Cover-Top(Sub) and etc to Plate Assy –  
Inner (4336821A) with 8 screws.  
Cover Assy - Top

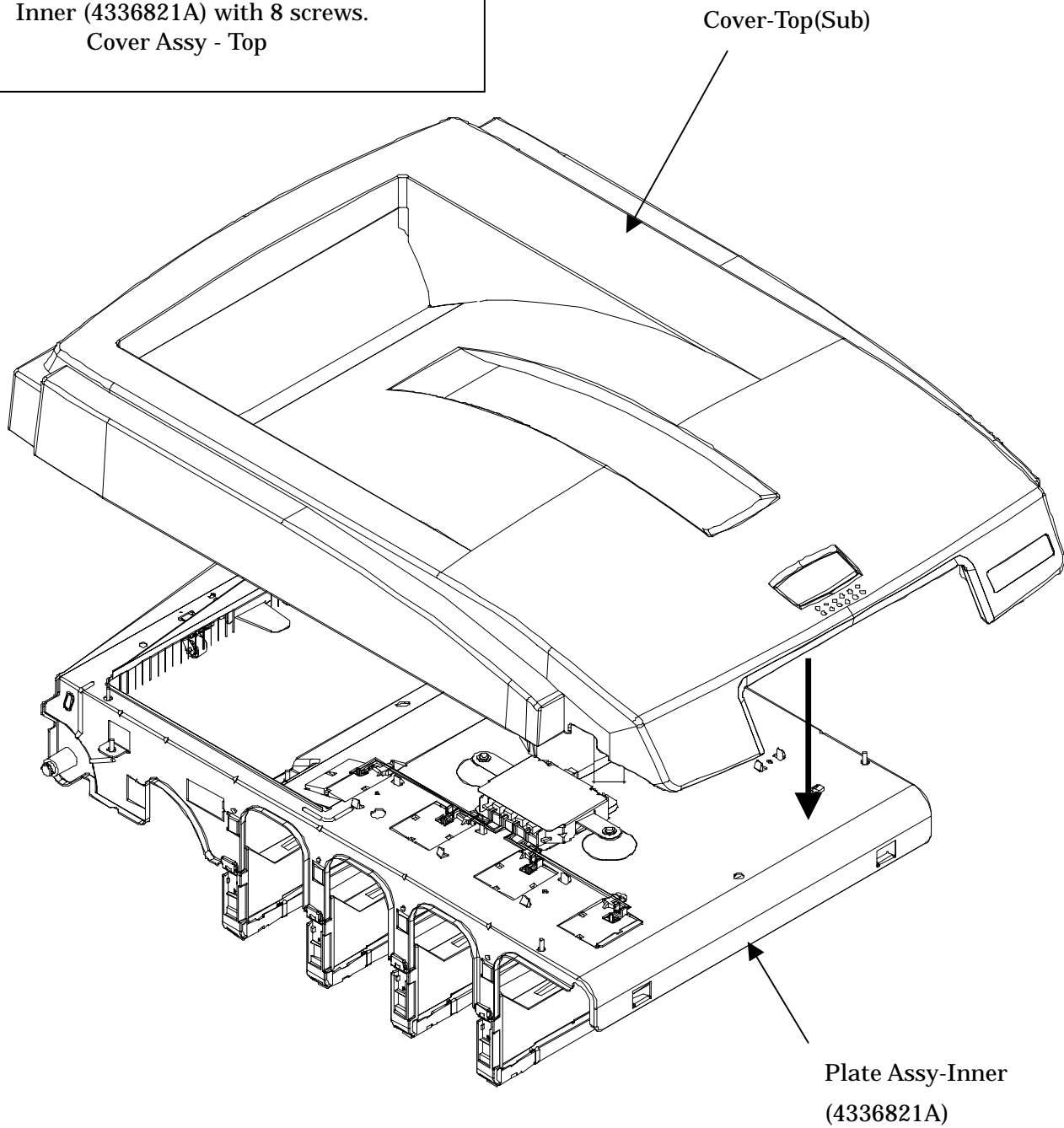

To assemble Cover Assy -Top to  
Printer-Unit.

Cover Assy - Top

Printer-Unit

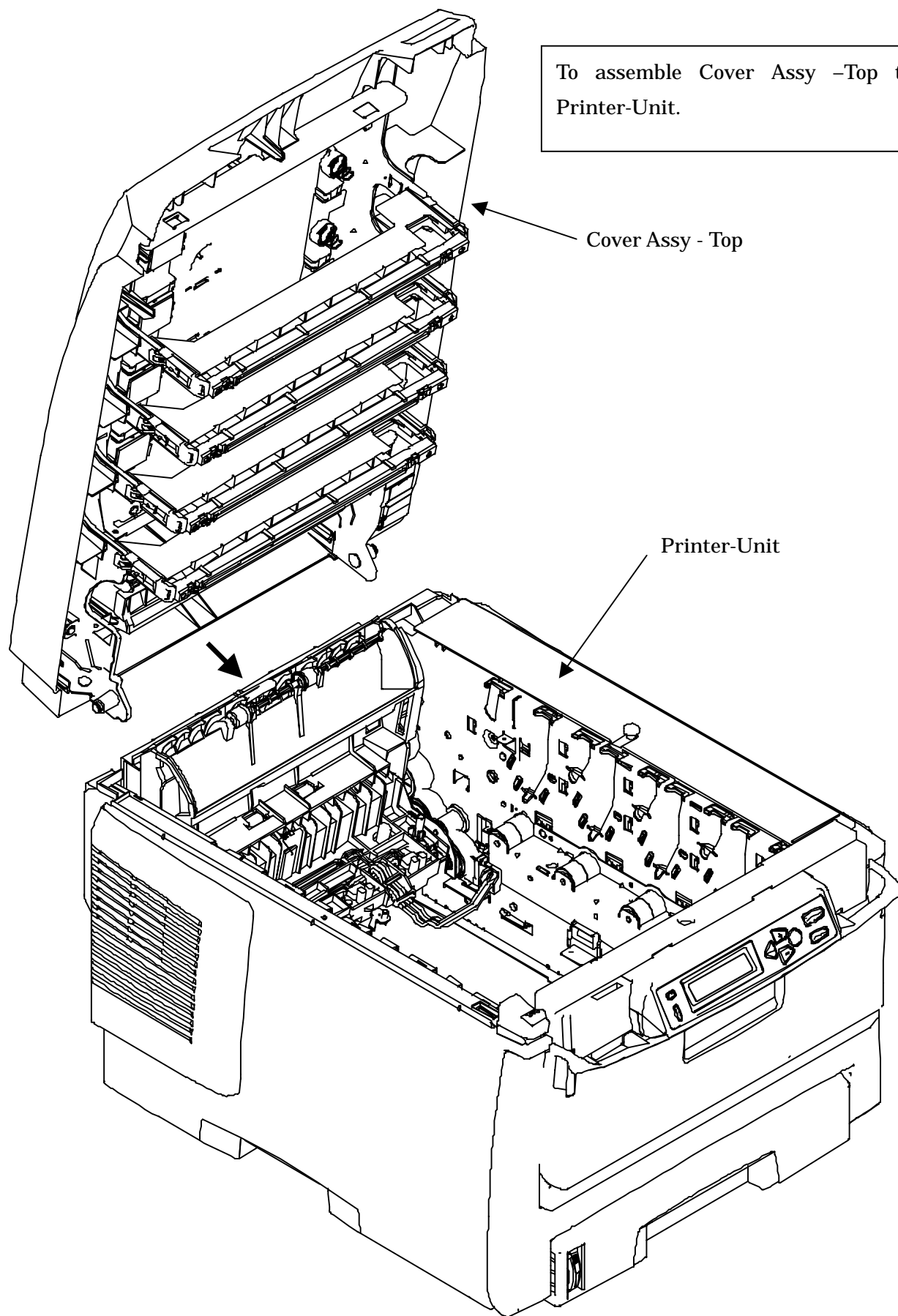

#### FCC WARNING

Changes or modifications not expressly approved by the party responsible for compliance could void the user's authority to operate the equipment.

#### NOTICE

This equipment has been tested and found to comply with the limits for a Class B digital device, pursuant to part 15 of the FCC Rules. These limits are designed to provide reasonable protection against harmful interference in a residential installation.

This equipment generates, uses and can radiate radio frequency energy and, if not installed and used in accordance with the instructions, may cause harmful interference to radio communications. However, there is no guarantee that interference will not occur in a particular installation. If this equipment does cause harmful interference to radio or television reception, which can be determined by turning the equipment off and on, the user is encouraged to try to correct the interference by one or more of the following measures:

- Reorient or relocate the receiving antenna
- Increase the separation between the equipment and receiver.
- Connect the equipment into an outlet on a circuit different from that to which the receiver is connected.
- Consult the dealer or an experienced radio/TV technician for help.