

User Manual



Tonino Lamborghini



Introduction

Thank you for choosing our mobile phone!

Tonino Lamborghini mobile phone meets the local government communications industry standards. In addition to basic functions, card style phonebook, multimedia player and many other useful features, it also gives you tremendous convenience and fun.

To better understand your mobile phone, you are recommended to read the user manual so as to fully use features described.

In view of the mobile network configuration and service provided, some features may not be allowed to utilize so please contact your seller or network provider for details.

Note: If descriptions of the user manual do not conform to the actual mobile phone, please refer to the functionality of the actual mobile phone.

The user manual is written under the mobile in English version, with SIM Card standby mode.

Content

Content	2
Disclaimer	4
Limited Warranty	5
For your Safety	6
TL700 Appearance and Keypad	8
Know Before You Use	10
Using SD Card as U Disk	12
Wi-Fi	13
Bluetooth	15
Mail	17
Gmail	17
Email	18
Dialing	19
Messaging	22

Contacts	24
Internet	26
Recorder	28
Clock	29
Calculator	30
Camera/Video	31
Camera	31
Video	32
Gallery	33
Music	35
Calendar	37
FM Radio	38
Settings	39
Use of Headset	44

Disclaimer

Any games pre-installed or bundled with this product, the application includes the appropriate file (hereinafter referred to as software), or audio-visual information obtained through this product, content, services and related documents, including but not limited to any images, photographs, animation, video, audio, music, text, (hereinafter referred to as services) by a corresponding software / service provider (hereinafter referred to as providers) responsible for its legal, true and accurate by the provider to ensure that no violation of national laws, regulations, public ethics and violations of the legitimate rights and interests of any third party. Providers ensure quality and user information and other information security and network security software and services. For all users of this product in the install / use the software or use services or other all the problems caused by the use of the aforementioned software or services, including the aforementioned problems arising from any direct, indirect, incidental or consequent derivative losses, takes the responsibility of the appropriate provider, are not involved with Tonino Lamborghini, its licensee, or distributor. Part of the software and services require network support, and may need to pay the appropriate fee. In this instruction manual may not exactly match, depending on the mobile phone software or ISP.

In this instruction manual with graphic description, these graphics are schematic, and may be inconsistent with the actual interface. Any incidental or consequential damages for any technical errors in this manual, or editorial errors or missing parts, or provided in this manual, Tonino Lamborghini, its licensee, or distributor are not liable. All information are following "AS IS", does not provide any guarantees and are subject to change without prior notice.

Limited Warranty

The limited warranty to this product and all its accessories (except battery) only applies to initial consumers (hereinafter referred to as consumers) and is non-transferable to any subsequent users.

The limited warranty period for the repaired products is the rest of the time of the original limited warranty period.

In any of the following circumstances, consumers will not be able to enjoy the limited warranty:

The phone has been subjected to abnormal use, abnormal environment, improper storage, exposed to wet environment, exposed to extreme high or low temperature or similar environments, unauthorized change, unauthorized connection, misuse, negligence, abuse, accident, improper installation, acts of God, foods or liquids spills.

Phone serial number or accessories date code has been removed, damaged or altered.

For your Safety

Please read the following simple guidelines and provides detailed information for security.



Please do not put the mobile phone near the air bag area. It will cause you seriously harm when air bag inflates.



Please shut down the mobile phone while vehicle fueling and do not use the mobile phone when near the gas station, place with chemicals and flammable. Mobile phone must be shut down or set to flight mode when you are on the plane so to avoid mobile phone electromagnetic interference with aircraft circuit failure.



To comply with the rules and regulations in the hospital, mobile phone should be shut down and avoid using the mobile phone near medical equipment (such as pacemaker and hearing aids, etc).



It is possible that radio waves affect mobile phone call quality. Please stay away from electronic equipment, such as television, radio, computer, etc. Mobile Phones are strictly forbidden to put together with credit card or near magnetic field.



Note: It is harmful to your hearing if prolonged use of earphone in large volume.

- Mobile phone and its accessories should be placed that children cannot be reached.
- Keep the phone dry, rain, humidity and all types of liquids which contain minerals which corrode electronic circuits.
- Don't touch the mobile phone with wet hands when charging; it will cause electric shock or damage the phone.
- Avoid placing the mobile phone in too high temperature environment. High temperatures will shorten its life, damage the battery, warp or melt certain plastic parts.
- Avoid placing the mobile phone in too low temperature environment. When the temperature rises, the phone will produce water vapor that may damage electronic circuit.
- Avoid placing the mobile phone in dusty & dirty places, or parts may be damaged.
- Keep clear mobile phone near lit cigarette, fire or any heat source.
- Do not disassemble mobile phone, the non-professional approach will damage the mobile phone.
- The circuit board to be damaged if it is rude to use such as high drop, knock or shake the mobile phone.
- Do not coat with paint onto the mobile phone for the paint will obstruct headphones, microphones or other removable accessories and it cannot work properly.
- Use clean, soft, dry cloth to clean the camera lens & touch screen. Prohibit to use hazardous chemicals and cleaning agents cleaning the mobile phone.

TL700 Appearance and Keypad



- | | | | |
|----------------------|-----------------|--------------------------|----------------------|
| 1. Headset Jack | 5. Power Key | 9. Home | 13. Rear Camera Lens |
| 2. Proximity Sensor | 6. Touch Screen | 10. Microphone | 14. Flash Light |
| 3. Front Camera Lens | 7. Return Key | 11. Multifunctional Jack | 15. Battery Cover |
| 4. Handset | 8. Menu Key | 12. Speaker | 16. SOS Key |
| | | | 17. Volume Key |

Keys	Functions
Menu	<ul style="list-style-type: none"> • Press to start the menu which allows you to perform actions in the current interface or options menu
Home	<ul style="list-style-type: none"> • Press to return home from any applications or interfaces
Return	<ul style="list-style-type: none"> • Press to return to the previous interface or to close dialog box, options menu notification panel or keypad
SOS	<ul style="list-style-type: none"> • For emergency call
Power	<ul style="list-style-type: none"> • Press to turn on the menu. Light press to lock the screen in standby mode Select Silent mode, Airplane mode, Reboot or Power off when prolonged press
Volume +	<ul style="list-style-type: none"> • Press to increase the volume
Volume -	<ul style="list-style-type: none"> • Press to reduce the volume • Press to turn the phone to vibration mode from the silent mode
Proximity Sensor	<ul style="list-style-type: none"> • During the call, the backlight is automatically adjusted cause of the close distance between phone and human body
Front Camera	<ul style="list-style-type: none"> • Enter the camera interface, it can be switched to the front camera taking your own photo

Know Before You Use

- **Install SIM card**

Please make sure to turn off the mobile phone before inserting the SIM card. Turn to the back of the mobile phone, push & open the battery cover and take the battery out of the mobile phone. Put the SIM card into the SIM card slot.

Note: SIM card should be placed that children cannot touch.

Please be careful for the inserting & removal of SIM card as any abrasion and bending may be easily damaged SIM card.

- **Install memory card (SD card)**

It is a removable memory card. Power off the mobile phone when inserting or removal of memory card, turn to the back of the mobile phone, push & open the battery cover and take the battery out (See below). Metal part of memory card faces down and insert into memory card slot.

- **Battery Charging**

When battery charging, the icon on the top right side starts rolling. Once the icon is full, the battery charging is completed and stops rolling. The charger should be unplugged. There will be an indication to show while the battery power is running low. Mobile phone will automatically shut down when the battery power is very low.

Battery quality will be affected & its life will be shortening if battery power keeps at low level for a long time.



- **Power on**

Long press the power key, backlight lights which indicates mobile phone is power on. If SIM card is not installed or poor contact with mobile phone, the screen shows "No SIM card", it can be only for emergency call or other non-communication functions. If SIM card is being protected by PIN code, the screen shows "Please enter PIN code", it will be automatically search the web if the PIN code is correct. The screen shows network provider and signal strength. If network cannot be searched, it can be only for emergency call or other non-communication functions.

- **Lock and unlock**

Standby interface , press  from left to right for unlock; light press power key for lock.

- **Power off**

Hold to press the power key and select power off in standby mode.

Using SD Card as U Disk

If user wants to send music, picture or other files to mobile phone's SD card from the computer, user should set SD card as U Disk first.

- **Set memory card as U disk**

- 1) Connect the phone to the computer with USB cable. The notification icon will appear in the status box.
- 2) Open the notification panel.
- 3) In the notification panel, touch USB is connected, then touch "Open the USB Storage Device".

See following picture:



- **Notices:** If you connect your mobile phone to the computer then select the USB device, your mobile phone cannot recognize memory card. In this case, some applications are suspended, such as camera.

Wi-Fi

Wi-Fi provides barrier free farthest 300 feet (100M) of wireless network access. If you use mobile phone to connect Wi-Fi, you should connect to wireless access point or [hot spots].

- **Notices:**

The availability and coverage of Wi-Fi signal depends on the number, Infrastructure and other objects penetrated by signal.

1) Press home > menu > settings > Wireless & networks.

2) Select Wi-Fi, mobile phone will automatically search for available wireless networks.

3) Select Wi-Fi settings, a list of available networks is shown and its security settings (open networks or WEP, WPA/WPA2 PSK). IF you select the network notification, the status box will show this icon (📶) when available wireless networks are founded.

4) Touch one of network for connection; mobile phone will connect it automatically. If you select WEP, WPA.WPA2 PSK, you should input the password first then for connection.

- **Notices:**

When the phone connects to the wireless network, the status box will show the Wi-Fi icon (📶) and the approximate signal strength. Touch the connected network, it displays the name of Wi-Fi network, status, security, signal strength, link speed & IP address. Cancel the wireless settings, touch "forget" and for re-connection to the same network should then to re-enter same settings.

• **Notices:**

1) When the phone connects to the wireless network, the status box shows the Wi-Fi icon () and the approximate signal's strength. Touch the connected network, it displays the name of Wi-Fi network, status, security, signal strength, link speed & IP address. Delete the wireless settings, touch "forget" and for re-connecting to the same network should then to re-enter same settings.

2) Unless you select "forget" to open network, otherwise, it is no need to re-enter next time for re-connecting wireless network. Wi-Fi searches automatically.

3) Unless you select "forget" to encrypted network, otherwise, it is no need to re-enter the password next time for re-connecting wireless network. Wi-Fi searches automatically.

4) In additional mobile phone is defaulted to connect wireless network via GPRS in SIM card. User can select manually, press settings > Wireless & networks > Mobile networks > Data enabled to turn off the data access.

Bluetooth

- **Turn on Bluetooth and set the phone can be detected**

1) Press home > menu > settings

2) Press Wireless & networks > Bluetooth to turn on Bluetooth function, the status box shows the icon (). Press Bluetooth settings > Scan for devices then to scan for all devices within the area.

3) All the devices founded displays in the list under the icon.

(Select "Discoverable" so for your mobile phone can be discovered by other Bluetooth device). Important: The maximum detecting time is 2 minutes.

- **Pairing and connection of Bluetooth headset**

1) Press home > menu > settings.

2) Press Wireless & networks > Bluetooth settings > Scan for devices then to scan for Bluetooth devices within the area.

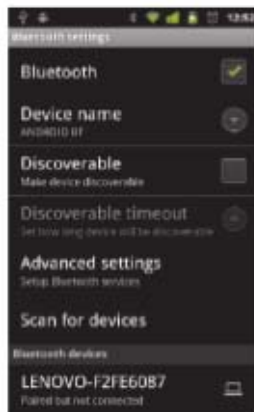

Means that it's Bluetooth stereo headset (supportingA2DP)



Means that phone is under the mode of "can be detected"



Means that it's mono Bluetooth headset

Notices:

Only on pairing needed between two Bluetooth devices. Once connected, there is no need to identify partnership and exchange of information.

If you already connect one headset and want to connect a second one, the first one will be disconnected. If you want to switch to the first one, you should re-select it manually in the Bluetooth equipment list.

Disconnection of Bluetooth

- 1) Press home > menu > settings > Wireless & networks > Bluetooth settings.
- 2) In the list of Bluetooth devices, press and hold to the selected.
- 3) Press "Unpaired" for disconnection

Bluetooth proximity sensor

After pairing the two devices, the strength of signal can be tested by Bluetooth proximity sensor device.

Mail

Gmail

- **Create Gmail**

Select Gmail > settings for users to activate or edit Gmail accounts as well as create a new Gmail accounts

1) Press Gmail, Google account setting interface is shown. Press "next" to create > enter First name, Last name & Username > next.

2) Google server determines whether the name can be used. If so, user is requested to enter the password twice for security, if it does not meet the security, user is asked to re-enter the password.

3) Successfully register a new Gmail account, a messenger created automatically for testing.

- **Log In Gmail**

1) Press Gmail, loading interface is shown and select log in.

2) Enter name and password > Log in

Gmail is initialization and shows login successful. All Google accounts are synchronized.

- **Compose and send mail**

When compose a mail, press Gmail > compose, enter mail account (recipient), subject and compose mail. Press menu key could be with 'Attach', 'Cc/Bcc', 'Send' or 'Discard' & 'Save Draft'.

- **Receive mail**

A notification will be shown for new mail in the status box. Press menu key > refresh, Proper refresh is able to update mail account and unread e mails.

- **Delete mail accounts**

Press Menu > Accounts > Menu > Account settings, press the email account for deletion > Menu > Remove account > OK

Email

- **Load Email**

Enter email address & password. Setting POP server, it will be automatically check server setting.

Set the correct SMTP server and check incoming and outgoing mail server.

Enter account name and display name on outgoing e mail > Finish.

- **Compose and send mail**

When compose a mail, press Gmail > compose, enter mail account (recipient), subject and compose mail. Press menu key could be with 'Attach' , 'Cc/Bcc', 'Send' or 'Discard' & 'Save Draft'.

Dialing

When the network provider shows in the status box, you can be able to dial or receive calls. The signal indication is on the top right corner showing the strength of network signal (The maximum is with 4 signal bars)

- **Dialing**

Main menu > dial. User can make calls.

In the dialer interface, enter the number you want to call. Fuzzy matching based on the input number to search for contact person's information. Fuzzy matching includes contact number and contact name. Press the one you want to make call.

- **Make call in call log**

Each dialed and received calls were saved in the call log. On each calls record is shown the status of call in, out or missed at lower left corner. User can select phone call records of call in, out or missed.

- Press single record and direct dial a phone number. Press the small arrow of the right side of the phone record; you can view the details of specific record
Press & hold any of phone records > Edit menu, user can edit, delete, save the phone number or other operations.



- **Answering**

While mobile phone in standby mode, press "Answer" and slide to right hand side for attending the call.

While mobile phone in use, press the "Answer" for attending the call.

- **Proximity Sensor**

During the call, the backlight is automatically adjusted cause of the close distance between phone and human body which is good for power-saving & prevent inadvertently screen touching.

- **Refuse to answer calls**

While mobile phone in standby mode, press "Reject" and slide to left hand side for refuse answering the call.

While mobile phone in use, press the "Reject" for refuse answering the call.

- **Two-way call/multiparty call (conference call)**

- **Notice:**

SIM card should have this function before using two-way/multiparty call.

1) Already connected a single call.

2) Press "Add call" , dial or receive another calls, phone default "call waiting" is on (Settings > Call settings > Voice call > Additional settings). Upon two calls are connected, status can be read over the call interface.

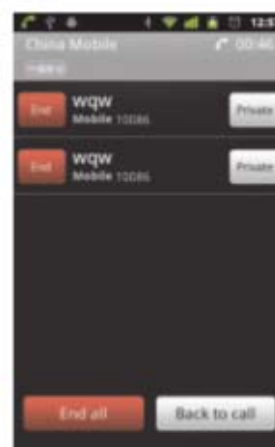
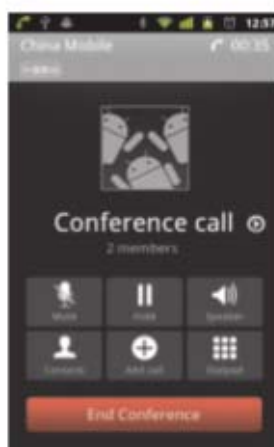
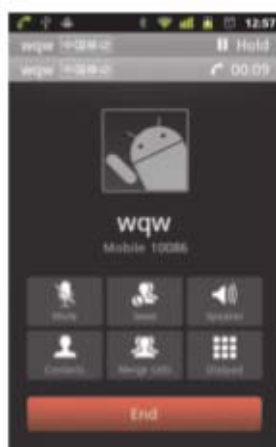

3) Press "Merge call" , two calls can be merged into multi call.

4) When finished the two way or multiparty call, call can be separate or hand up one of them by press the small arrow of the conference call.

- **Call recording**

During the call, press Menu > Start recording.

- **Voice call**

1) Press Settings > Call settings > Voice call > Call forwarding, calls can be forward to other phone number when setting.

2) Press Settings > Call settings > Voice call > Additional settings > Call waiting.

It could be also receive, reject another phone call.

Messaging

- **Important :** The message header is saved by receiving party's phone number instead of normal file manager. Blue dialog box displays in coming messages and green dialog box displays out going messages.

- **Send SMS**

- 1) Press Home > Messaging.
- 2) "Compose new message" interface.
 - a. Press "To" & "Input" box to select the input method.
 - b. Press "send".
 - c. Message can be sent when "recipient" and "Type to compose" box is not empty.

- **Send MMS**

When compose a new message, SMS is defaulted. Upon completion of following operations, it switches to MMS. MMS can be sent when press "send".

- 1) "Compose new message" interface > Menu.
- 2) Press "Attached" for attachment. It will then be MMS automatically.

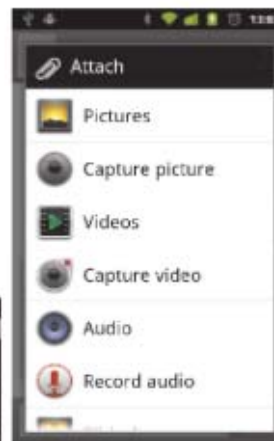
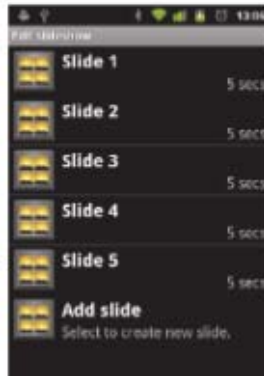

- Supporting GIF, JPEG and other form
- Append the needed photos of the users
- Supporting 3GPP, JMP4 and other form
- Append the needed videos of the users
- Supporting the form of MIDI, Mp3, WAV
- Append the recorded audios of the users

Support GIF, JPEG format
 Camera shots from user
 Support 3GPP, Mp4 Videos
 from user Support MIDI,
 MP3, WAV Audio from user

- **Notice:**

Few multimedia messages can be sent via MMS and transmitted simultaneously.

"Compose new message" interface > Menu > Attach>Slide show.

1) Maximum of 10 photos can be added when press "Add Slide".

2) Press "Add subject", "Subject" appears under box of "recipient", it will then be MMS automatically.

- **Sending a message to multiple phone numbers**

Direct input multiple phone numbers, each phone numbers by an English comma in between for dividing.

Multiple contacts can be selected from address book and click the right box of chosen recipients.

- **Note: It only supports up to 20 recipients**

The specific numbers depend on the number of characters in the "recipients". It can be only entered 312 characters maximum. When the message is being sent or resent, a small yellow envelope is shown. When the message is failed, a red triangle with an exclamation mark is shown.

- **Other features for Menu key when edit messages**

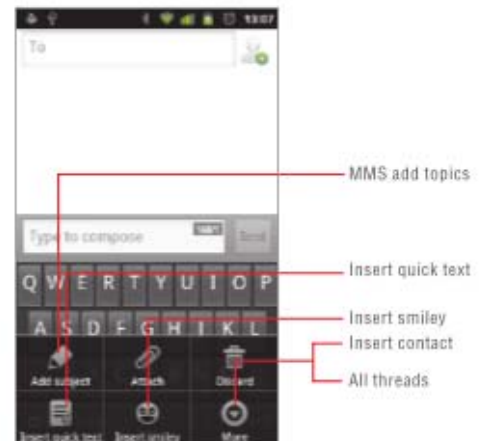

Contacts

- **Open the Main Menu > Contacts**

1) It is defaulted to display phone and SIM card contacts and arrange in alphabetical order.

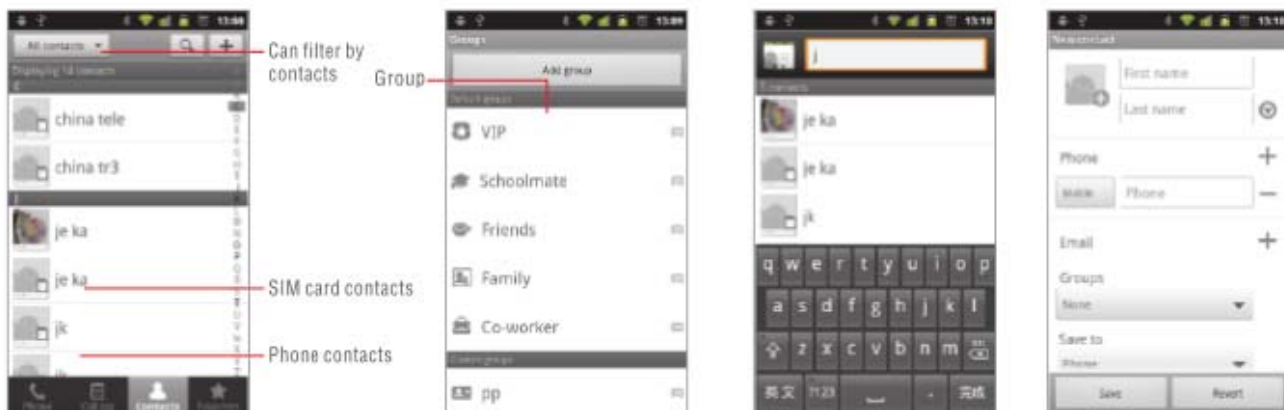

2) Press the Contacts icon to search interface.

3) Press + for add new contact.

- **Contacts > Menu > Search**

1) Searched list is displayed for partial similarity when enter a number or a letter.

2) If there is not matching, "No matching contacts found" is shown.

- **Contacts > Menu > New contact**

1) Choose to save to the phone or SIM card.

2) "New contacts" interface, input name & phone number press "Done".

- **Contacts > Menu > Delete contact**

- 1) Select "Mark all" and press "delete" to delete all contacts inclusive of contacts saved in phone and SIM card.
- 2) Select one or more contacts by press the box in right hand side. Press "delete" to delete the selected contacts.

- **Contacts > Menu > Groups**

- 1) It is defaulted groups included VIP, Schoolmate, Friends, Family and Co-workers.
- 2) Select "Add groups" edit the new group name and go to search interface to add group contacts.

- **Contacts > Menu > Speed Dial**

- 1) Voicemail.
- 2) No. 2 – 9 numbers, press "Tap to add speed dial" , select one of contacts from the list as a speed dial. Press and hold the number on the dialer interface for speed dial.

- **Contacts > Menu > More**

- 1) Import/Export contacts can be copied each others for phone, SIM card and SD card. Select the "Copy contacts from" > next and select the "copy contacts to" and click the contacts > Copy.
- 2) Display options to select all or part of contacts "Only contacts with phones" , "Phone contacts" and "SIMs Contacts".
- 3) Accounts to select "Background data" and "Auto-Sync".
- 4) Share visible contacts enable to import all contacts into SD card or sharing via Bluetooth, Text message or Email/Gmail.

Internet

- **Internet Explorer**

1) Touch the address bar to enter the URL.

2) Appropriate websites is appeared when inputting the URL. Select the appropriate website directly or continue to input URL.

- **Homepage**

Select website, press "homepage" become your homepage. It is using the manufacturing pre-set website if user does not set.

- **Menu > Backward**

After browsing number of websites, it is back to the previous website of the current website.

- **Menu > Forward**

After browsing number of website, it is move to next website after the current website.

- **Menu > Windows**

- See all current viewed websites.

- **Menu > Bookmarks**

Press "Bookmarks" to save the current URL as bookmark.

Press "Bookmarks", listing a bookmarked URL, press to open the website.



- **Menu > More**

- 1) Add bookmarks to save current URL as bookmark.
- 2) Find on page to search what user needs in current website.
- 3) Select text to select piece of text.
- 4) Page info to display website address and other information of the current browsing.
- 5) Share page to select Bluetooth or SMS to share current page.
- 6) Downloads to show all it has been downloaded.
- 7) History to show browsing history and view the most browsing website.
- 8) Setting for Internet Explorer setting.

- **Close**

- Option for minimize or quite.

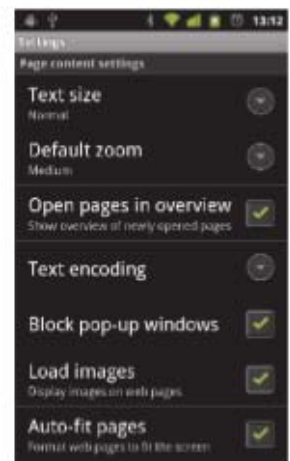

Recorder

The recorder can record sound and quickly send via MMS or Bluetooth as well as set as ringtone.

- **Notice:**

The recorder only use AMR format to save the audio file.

- 1) Press the "Sound recorder" interface.
- 2) Keep the microphone near the voice source.
- 3) Press to record voices, press to stop or playback.

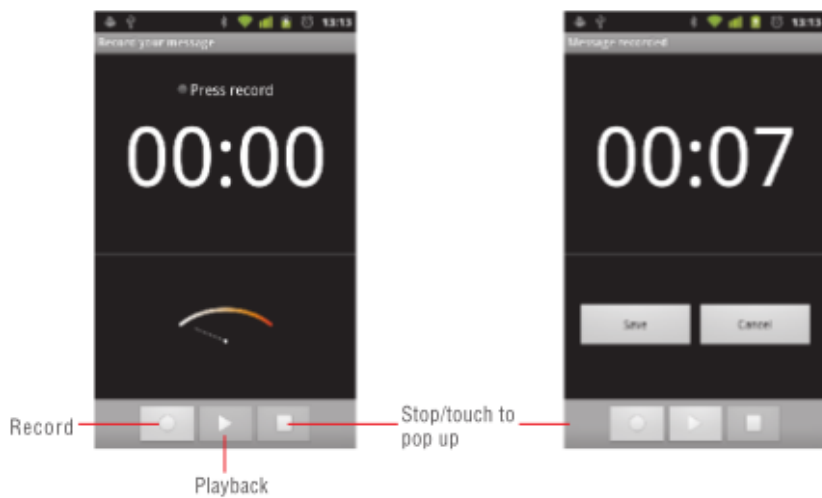

All recordings are saved in the default record in File Manager.

Clock

- **Clock interface**

- 1) Brightness control: Press to control the brightness control of the interface.
- 2) Alarm: Press to enter alarm interface.
- 3) PPT: Press to shuffle pictures in the gallery.
- 4) Home : Back to home interface.

- **Alarm**

Phone is ringing or vibration to remind you to the time setting. Press "Menu key" or press the alarm interface to add alarm. There is two in off mode alarm clock interface (1 alarm clock from Monday to Friday at 8:30 am and Saturday to Sunday at 9:00 am). It can be edited current mode including time setting, ring tones, vibration, repeat and label.

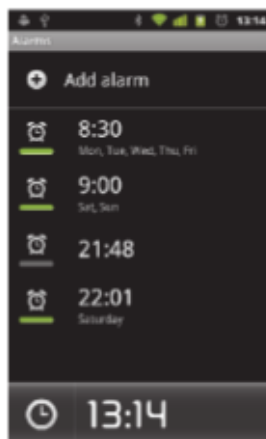

Press and hold the time setting can be able to turn on/off alarm clock, edit alarm and delete alarm.

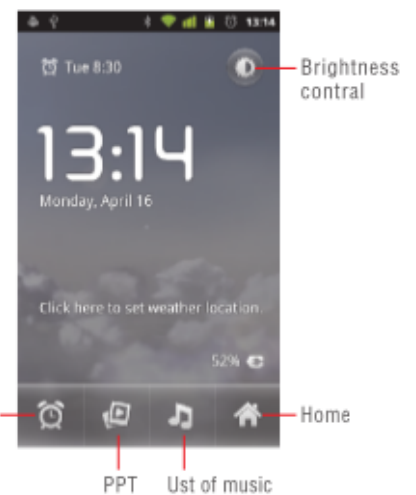

Calculator

- **Calculator**

This function can turn the mobile phone into calculator and make simple calculation.

- **Touch the number keys displays in the blank box**

Press "Menu" and touch senior panel or slide to left in the calculator Interface to senior panel.



Camera/Video

Camera

- **Preparation before taking photo**

Insert SD card before using phone camera and video. All taken photos and videos are saved in the SD card.

- **Turn on the camera**

Press "Camera" to turn on camera. Camera can be switched to video mode. Rear camera lens can be switched to front camera lens for self photo taking.

- **Photo taking**

- 1) Aim to the object
- 2) Press "Shutter" to take photo
- 3) Photos are named by photo taken date, save in Gallery and default in File Manager.
- 4) Press "Gallery" to view photos and to enlarge photos.

- **Camera settings**

Press "Menu" for settings EV, scene mode, picture size, Picture quality, Capture mode, Burst shot, ISO, Self timer, Face detection, AE meter, Anti-flicker, Sharpness, Saturation, Brightness, Contrast, Store location and White balance.



Remaining shooting numbers

Video

• Preparation before taking photo

Insert SD card before using phone camera and video. All taken photos and videos are saved in the SD card.

• Turn on the camera

Press "Camera" to turn on camera. Switch camera mode to video mode.
Rear camera lens can be switched to front camera lens for self video taking.

• Video taking

- 1) Aim to the object.
- 2) Press "Shutter" to take video.
- 3) Videos are named by video taken date, save in Gallery and default in File Manager.
- 4) Press "Gallery" to view videos.

• Video settings

Press "Menu" for settings EV, scene mode, picture size, Picture quality, Capture mode, Burst shot, ISO, Self timer, Face detection, AE meter, Anti-flicker, Sharpness, Saturation, Brightness, Contrast, Store location and White balance.

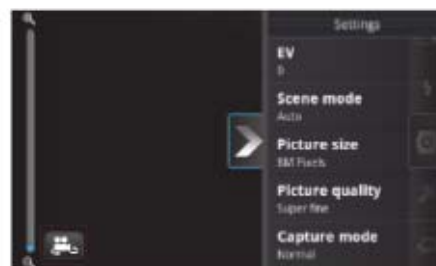
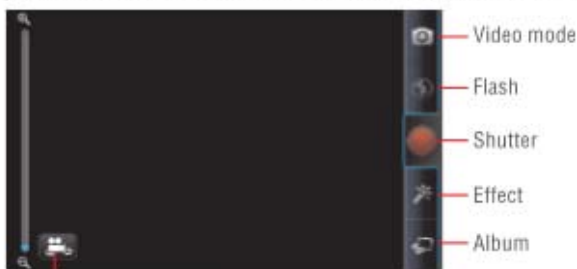

Remaining shooting time

Gallery

- **View gallery**

- 1) Press "Home" > Gallery.
- 2) Under camera interface > Menu key and press album.

- **Use of photos**

View photos or share with friends.

- **View photos**

- 1) Original photos can be enlarging to full screen by finger.
- 2) Touch the screen, slide to left hand side to view next photo or right hand side to view last photo.

- **Crop photos**

- 1) Select photo to be cropped.
- 2) Press "Menu" > More > Crop.
- 3) When completion of cropping, photo is saved to Gallery.

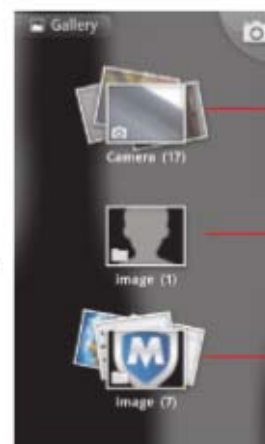

Photos and video taken by camera

Video stored in SD Card

Photos download from websites

- **Send photos via mail**

Select photo from Gallery > Menu > Share > Gmail or Email, photo is automatically attached to mail, compose e mail then send.

- **Send photos via SMS**

Select photo from Gallery > Menu > Share > Messaging, photo is automatically attached to messaging, compose e mail then send.

- **View video**

View video or share with friends.

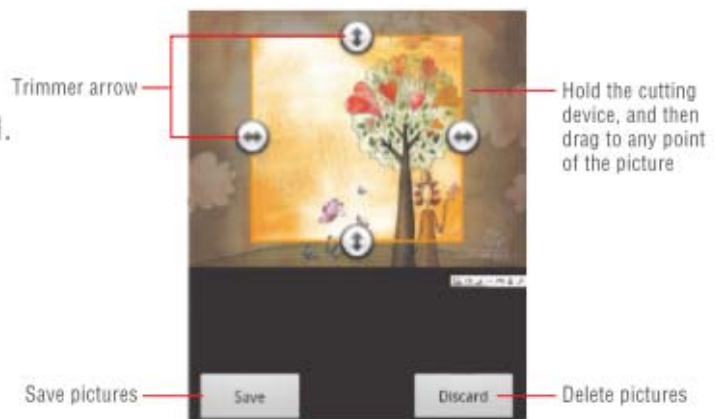

Music

Music can play digital audio files in SD card. Music supports AMR, M4A, MIDI, MP3, WAV, OGG format.

- **Play music**

Press "home" and select music interface.

- **Music library**

Music library is listed as Artists, Albums, Songs and Playlists, by touching one of them for viewing. Continuously touch the screen allows user to the selected songs.

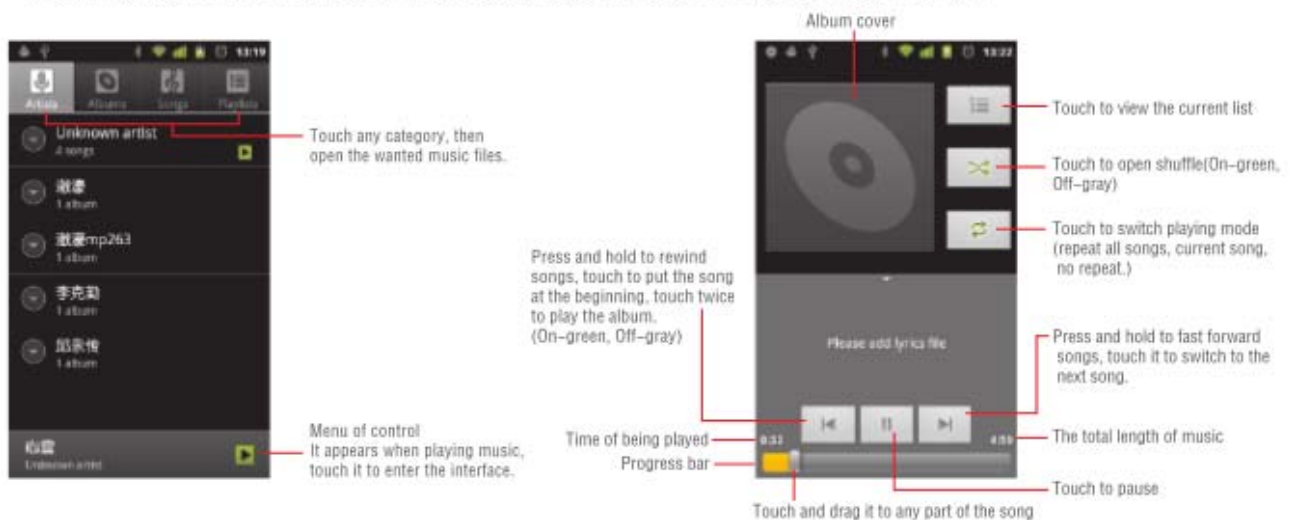

All songs can be played on the Music library or on the screen in random order. Press "Menu" > Party Shuffle, it starts to play the selected song.

- **View lyrics**

When there is with corresponding lyrics, the player displays the lyrics of source. Click the arrow up, song and lyrics are synchronized.

- **Create playlists**

- 1) Select any of Artists, Albums, Songs and Playlists in the music library.
- 2) Slide up or down to browse the song user wants to add to the playlist.
- 3) Press and hold the selected and press "Add to playlist".
- 4) Enter a new song name of the playlist then save.

- **Manage playlists**

Enter music library interface and press playlists.

- 1) Press the selected song to play.
- 2) Delete the song from the playlists, press and hold to the selected song and press "Delete".
- 3) Rename the song from the playlists, press and hold to the selected song and press "Rename" for the new name then save.
- 4) Press and hold the selected song and press "use as phone ringtone". The song will be set as ring tone.

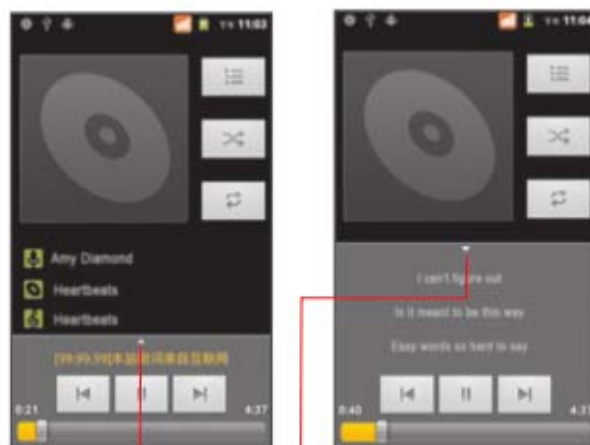

click to expand lyrics when the song is playing the lyrics will be synchronized

Calendar

On the Calendar interface, current month, week and today is defaulted to display in grey. Press "Menu", there are 4 kinds of display mode.

- **Calendar application**

- 1) Day: Schedule for a day, slide right/left to page up and down on daily basis.
- 2) Week: Schedule for a week, slide right/left to page up and down on weekly basis.
- 3) Today: Schedule of today, current month and week is shown in grey.
- 4) Month: Schedule for a month, slide right/left to page up and down on monthly basis.

- **New event**

- 1) Press "Menu" > More > New event
- 2) Enter Event name
- 3) If the event is for all day or period of time, it should be click all day or "From" and "To".
- 4) Enter location, description, repetition and reminders.
- 5) Press "Done".
- 6) Press selected date, press and hold the date, select edit event or delete event for edition or deletion.

FM Radio

User listen FM radio on this device. Ensure wired headset is connected to the mobile phone as the frequency is via wired headset as antenna. User can switch the output either by speaker or by wired headset.







• Turn of FM radio

- 1) For the first time running, the device automatically searches your local FM channels and can be saved in the channel list.
- 2) Press "back", the device moves back, user can still continue to listening program and operate other applications simultaneously.
- 3) View available channels in the channel list, press "Add preset" to edit the channel name.



Settings

Your service provider may have preset some device settings, so you may not be able to change these settings.

- **SIM toolkit**  Press to choose corresponding settings provides by Services Provider.
- **Wireless & networks**  Setting wireless & networks functions
- **Note:**
 - 1) Turn on the Wi-Fi then Airplane mode, Wi-Fi turn off automatically. Turn on Airplane mode first then turn on Wi-Fi, Wi-Fi can be connected. WPS connect to wireless AP and mobile should both support AOSS and without entering password.
 - 2) If AP wireless AP has AOSS, there is a similar to refresh logo on the SSID entry name.
- **Call settings**  Voice call, video call, Internet call & other settings related to calls.
- **Audio profiles**  Predefined profiles are including General, Silent, Meeting and Outdoor.
- **Display**  Display settings to Brightness, Auto-rotate screen, Animation, Screen timeout and keyboard backlight.
- **Location** 
 - 1) Using "Map" interface for the location.
 - 2) GPS for positioning, the accuracy is up to street level. (Turn off GPS can save data traffic).
 - 3) By using GPS EPO assistance to speed up the positioning.

- 4) Turn on the GPS EPO to modify EPO configurations.
- 5) By using A-GPS to speed up the fixed time of location. (Using A-GPS will be having data traffic).

- **Security** 

- 1) Screen lock settings by using Pattern, PIN or Password
 - a. Press "Pattern", a simple introduction & example of securing your phone is shown > next to continue.
 - b. Press "PIN" and enter number for unlock screen.
 - c. Press "Password" to set password and unlock screen.
 - d. Press "None" stop using unlock screen.
- 2) Enter (4 – 8 numbers) PIN to set the lock of SIM card
SIM Card's PIN (Personal Identification Number) is to prevent illegal use. Service provider provides PIN together with SIM card at initial stage simultaneously. Modify the lock PIN, click "Lock SIM card", user is requested to input old PIN and to enter 2 times new PIN. Modified successfully is shown. If it is wrongly input 3 consecutive times, SIM Card's PIN will be locked automatically, PUK code is normally supplied with SIM card. Please refer to Service provider if user does not. If the PUK code is wrongly input 10 consecutive times, SIM card will be locked permanently.
- 3) Visible passwords, show passwords as user type.
- 4) Select device administrators to add or remove.
- 5) The security certificate to allow applications to access the security credentials and other documents.
- 6) Install the encryption certification from SD card.
- 7) Set or change the credential storage password.
- 8) Clear credential storage of all contents and reset its passwords.

• **Applications**

- 1) Unknown sources to allow installation of non-market applications.
- 2) Manage applications to manage and remove installed applications.
- 3) Running service is to view and control currently running services.
- 4) Storage use is to view storage used by download, all and SD card and running.
- 5) Battery use to show what has been using the battery.
- 6) Development
 - a. Debug mode only when USB is connected
 - b. Screen will always stay awake while charging.
 - c. Allow mock locations.

• **Accounts & sync**

- 1) Background data can sync, send and receive data at any time. Disable background data for extended battery and reduce data usage. However, some applications will use the background data connection.
- 2) Auto-sync to sync data automatically.

• **Privacy**

Reset factory data and clear all DRM reset.

• **Storage**

- 1) View SD card and internal storage availability.
- 2) Erase and reformat SD card.

• **Language & keyboard**

- 1) Select language. It is defaulted Chinese simplify and traditional totally of 43 kinds of language.

2) User is able to add or remove words from user dictionary. Press "Menu" to add words, words in the user dictionary is to be shown when it matches.

3) Google Pinyin input method

Sound on key-press, Vibration on key-press, possible coherent words and Chinese-English switch.

4) Android keyboard input method.

Vibrate on key-press, Sound on key-press, Pop-up on key press, Touch to correct words, Auto-capitalization, Show settings key, Voice input, Input languages, Quick fixes, Show suggestions & Auto complete.

5) Input method can be selected either Google Pinyin or Android keyboard.

• **Voice Input & output**

Text-to-speech settings

1) Play a short demonstration of speech synthesis.

2) Default settings below override application settings.

3) Sets the speech synthesis engine to be used for spoken text.

4) Install the voice data required for speech.

5) Speed at which the text is spoken.

6) Sets the language-specific voice for the spoken text.

7) PicoTTS Settings

Voice recognizer settings

1) Default Language – English (UK)

2) Safe Search for moderate-filter explicit images only. Applies only to Google search by voice.

3) Block offensive words

- **Accessibility** 

- **Date & time** 

- 1) Automatically by using network-provided values.
- 2) Sliding year, month and date for date settings.
- 3) Choose your local time zone of the location, Beijing, GMT+08:00, China Standard Time.
- 4) Sliding hour & minutes for time settings.
- 5) Use 24-hour format
- 6) Select date format
Normal (31/12/2012)
12/31/2012
31/12/2012
2012/12/31
Mon, Dec 31, 2012
Mon, 31 Dec 2012
2012 Dec 31, Mon

- **Schedule power on/off** 

Set schedule power on/off time

- **About phone** 

Use of Headset

- **Answering**
Press the headset button once for receiving.
- **Call hold**
Press the headset button once again for call hold.
- **Call re-answering**
Press the headset button once again for call re-answering.
- **End up calling**
Press and hold the headset button 3 seconds or above for hanging up.

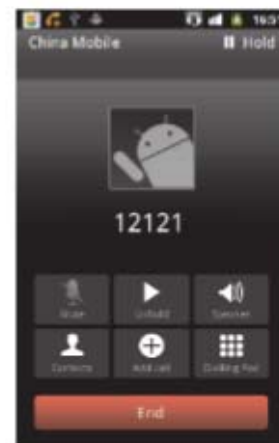

Warning

FCC RF Exposure Information and Statement:

The SAR limit of USA (FCC) is 1.6W/kg averaged over one gram of tissue.

Product: Mobile Phone, model number: TL700 (FCC ID: R6DTL700) has also been tested against this SAR limit. The highest SAR value reported under this standard during product certification for use at the head is 0.107 W/kg and when properly worn on the body is 0.446 W/kg. The device was tested for typical body-worn operations with the back of the handset kept 1 cm from the body. To maintain compliance with FCC RF exposure requirements, use accessories that maintain a 1 cm separation distance between the user body and the back of the handset. The use of belt clips, holders and similar accessories should not contain metallic components in its assembly. The use of accessories that do not satisfy these requirements may not comply with FCC RF exposure requirements, and should be avoided.

This device complies with part 15 of the FCC Rules. Operation is subject to the following two conditions:

(1) This device may not cause harmful interference, and (2) this device must accept any interference received, including interference that may cause undesired operation. Any Changes or modifications not expressly approved by the party responsible for compliance could void the user's authority to operate the equipment.

Note: This equipment has been tested and found to comply with the limits for a Class B digital device, pursuant to part 15 of the FCC Rules. These limits are designed to provide reasonable protection against harmful interference in a residential installation. This equipment generates uses and can radiate radio frequency energy and, if not installed and used in accordance with the instructions, may cause harmful interference to radio communications. However, there is no guarantee that interference will not occur in a particular installation. If this equipment does cause harmful interference to radio or television reception, which can be determined by turning the equipment off and on, the user is encouraged to try to correct the interference by one or more of the following measures:

- Reorient or relocate the receiving antenna.
- Increase the separation between the equipment and receiver.
- Connect the equipment into an outlet on a circuit different from that to which the receiver is connected.
- Consult the dealer or an experienced radio/TV technician for help.



OngloryRich
LIMITED

Under License of Tonino Lamborghini S.p.A www.Lamborghini.it
info@ongloryrich.com

Printed in PRC

© Copyright 2012 All rights reserved