

**Pioneer**

# X-EM26

CD Receiver System

Micro chaîne CD

Sistema receptor de CD

Register your product on / Enregistrez votre produit sur / Registre su producto en

<http://www.pioneerelectronics.com> (US)

<http://www.pioneerelectronics.ca> (Canada)

Operating Instructions

Mode d'emploi

Manual de instrucciones



# IMPORTANT



The lightning flash with arrowhead symbol, within an equilateral triangle, is intended to alert the user to the presence of uninsulated "dangerous voltage" within the product's enclosure that may be of sufficient magnitude to constitute a risk of electric shock to persons.

**CAUTION:**  
TO PREVENT THE RISK OF ELECTRIC SHOCK, DO NOT REMOVE COVER (OR BACK). NO USER-SERVICEABLE PARTS INSIDE. REFER SERVICING TO QUALIFIED SERVICE PERSONNEL.

The exclamation point within an equilateral triangle is intended to alert the user to the presence of important operating and maintenance (servicing) instructions in the literature accompanying the appliance.

D3-4-2-1-1\_A1\_En

## IMPORTANT SAFETY INSTRUCTIONS

- 1) Read these instructions.
- 2) Keep these instructions.
- 3) Heed all warnings.
- 4) Follow all instructions.
- 5) Do not use this apparatus near water.
- 6) Clean only with dry cloth.
- 7) Do not block any ventilation openings. Install in accordance with the manufacturer's instructions.
- 8) Do not install near any heat sources such as radiators, heat registers, stoves, or other apparatus (including amplifiers) that produce heat.
- 9) Do not defeat the safety purpose of the polarized or grounding-type plug. A polarized plug has two blades with one wider than the other. A grounding type plug has two blades and a third grounding prong. The wide blade or the third prong are provided for your safety. If the provided plug does not fit into your outlet, consult an electrician for replacement of the obsolete outlet.
- 10) Protect the power cord from being walked on or pinched particularly at plugs, convenience receptacles, and the point where they exit from the apparatus.

- 11) Only use attachments/accessories specified by the manufacturer.
- 12) Use only with the cart, stand, tripod, bracket, or table specified by the manufacturer, or sold with the apparatus. When a cart is used, use caution when moving the cart/apparatus combination to avoid injury from tip-over.



- 13) Unplug this apparatus during lightning storms or when unused for long periods of time.
- 14) Refer all servicing to qualified service personnel. Servicing is required when the apparatus has been damaged in any way, such as power-supply cord or plug is damaged, liquid has been spilled or objects have fallen into the apparatus, the apparatus has been exposed to rain or moisture, does not operate normally, or has been dropped.

D3-7-13-69\_En

**CAUTION:** USE OF CONTROLS OR ADJUSTMENTS OR PERFORMANCE OF PROCEDURES OTHER THAN THOSE SPECIFIED HEREIN MAY RESULT IN HAZARDOUS RADIATION EXPOSURE.

**CAUTION:** THE USE OF OPTICAL INSTRUMENTS WITH PRODUCT WILL INCREASE EYE HAZARD.

D58-5-1-2a\_A1\_En

This transmitter must not be co-located or operated in conjunction with any other antenna or transmitter.

D8-9-2-5\_A1\_En

This device complies with Industry Canada's licence-exempt RSSs. Operation is subject to the following two conditions: (1) this device may not cause interference, and (2) this device must accept any interference, including interference that may cause undesired operation of the device.

Le présent appareil est conforme aux CNR d'Industrie Canada applicables aux appareils radio exempts de licence. L'exploitation est autorisée aux deux conditions suivantes : (1) l'appareil ne doit pas produire de brouillage, et (2) l'utilisateur de l'appareil doit accepter tout brouillage radioélectrique subi, même si le brouillage est susceptible d'en compromettre le fonctionnement.

This equipment complies with IC radiation exposure limits set forth for an uncontrolled environment and meets RSS-102 of the IC radio frequency (RF) Exposure rules. This equipment has very low levels of RF energy that it deemed to comply without maximum permissive exposure evaluation (MPE). But it is desirable that it should be installed and operated keeping the radiator at least 20 cm or more away from person's body (excluding extremities: hands, wrists, feet and ankles).

D8-9-2-7-3\_A1\_En

This equipment complies with FCC radiation exposure limits set forth for an uncontrolled environment and meets the FCC radio frequency (RF) Exposure Guidelines. This equipment has very low levels of RF energy that it deemed to comply without maximum permissive exposure evaluation (MPE). But it is desirable that it should be installed and operated keeping the radiator at least 20 cm or more away from person's body (excluding extremities: hands, wrists, feet and ankles).

**CAUTION**

This product is a class 1 laser product classified under the Safety of laser products, IEC 60825-1:2007.

CLASS 1 LASER PRODUCT

D58-5-2-2a\_A1\_En

**WARNING**

This equipment is not waterproof. To prevent a fire or shock hazard, do not place any container filled with liquid near this equipment (such as a vase or flower pot) or expose it to dripping, splashing, rain or moisture.

D3-4-2-1-3\_A1\_En

**WARNING**

To prevent a fire hazard, do not place any naked flame sources (such as a lighted candle) on the equipment.

D3-4-2-1-7a\_A1\_En

**VENTILATION CAUTION**

When installing this unit, make sure to leave space around the unit for ventilation to improve heat radiation (at least 10 cm at top, 10 cm at rear, and 10 cm at each side).

**WARNING**

Slots and openings in the cabinet are provided for ventilation to ensure reliable operation of the product, and to protect it from overheating. To prevent fire hazard, the openings should never be blocked or covered with items (such as newspapers, table-cloths, curtains) or by operating the equipment on thick carpet or a bed.

D3-4-2-1-7b\*\_A1\_En

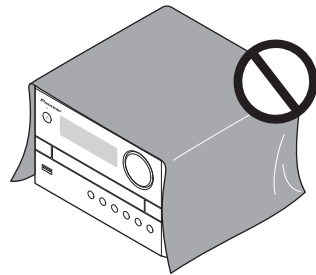
**Operating Environment**

Operating environment temperature and humidity:  
+5 °C to +35 °C (+41 °F to +95 °F); less than 85 %RH  
(cooling vents not blocked)

Do not install this unit in a poorly ventilated area, or in locations exposed to high humidity or direct sunlight (or strong artificial light)

D3-4-2-1-7c\*\_A1\_En

### CAUTION

The  switch on this unit will not completely shut off all power from the AC outlet. Since the power cord serves as the main disconnect device for the unit, you will need to unplug it from the AC outlet to shut down all power. Therefore, make sure the unit has been installed so that the power cord can be easily unplugged from the AC outlet in case of an accident. To avoid fire hazard, the power cord should also be unplugged from the AC outlet when left unused for a long period of time (for example, when on vacation).

D3-4-2-2a\*\_A1\_En

This product is for general household purposes. Any failure due to use for other than household purposes (such as long-term use for business purposes in a restaurant or use in a car or ship) and which requires repair will be charged for even during the warranty period.

K041\_A1\_En

This device complies with Part 15 of the FCC Rules. Operation is subject to the following two conditions:  
(1) this device may not cause harmful interference, and  
(2) this device must accept any interference received, including interference that may cause undesired operation.

### WARNING

Store small parts out of the reach of children and infants. If accidentally swallowed, contact a doctor immediately.

### POWER-CORD CAUTION

Handle the power cord by the plug. Do not pull out the plug by tugging the cord and never touch the power cord when your hands are wet as this could cause a short circuit or electric shock. Do not place the unit, a piece of furniture, etc., on the power cord, or pinch the cord. Never make a knot in the cord or tie it with other cords. The power cords should be routed such that they are not likely to be stepped on. A damaged power cord can cause a fire or give you an electrical shock. Check the power cord once in a while. When you find it damaged, ask your nearest our authorized service center or your dealer for a replacement.

S002\*\_A1\_En

(Symbol examples for batteries)

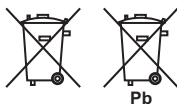

These symbols are only valid in the European Union.

Pb

K058c\_A1\_En

### Radio wave caution

This unit uses a 2.4 GHz radio wave frequency, which is a band used by other wireless systems (Microwave ovens and Cordless phones, etc.). In this event noise appears in your television image, there is the possibility this unit (including products supported by this unit) is causing signal interference with the antenna input connector of your television, video, satellite tuner, etc. In this event, increase the distance between the antenna input connector and this unit (including products supported by this unit).

- We are not responsible for any malfunction of the compatible product due to communication error/malfunctions associated with your network connection and/or your connected equipment. Please contact your Internet service provider or network device manufacturer.
- A separate contract with/payment to an Internet service provider is required to use the Internet.

### Information to User

Alterations or modifications carried out without appropriate authorization may invalidate the user's right to operate the equipment.

### NOTE:

This equipment has been tested and found to comply with the limits for a Class B digital device, pursuant to Part 15 of the FCC Rules. These limits are designed to provide reasonable protection against harmful interference in a residential installation. This equipment generates, uses and can radiate radio frequency energy and, if not installed and used in accordance with the instructions, may cause harmful interference to radio communications. However, there is no guarantee that interference will not occur in a particular installation. If this equipment does cause harmful interference to radio or television reception, which can be determined by turning the equipment off and on, the user is encouraged to try to correct the interference by one or more of the following measures:

- Reorient or relocate the receiving antenna.
- Increase the separation between the equipment and receiver.
- Connect the equipment into an outlet on a circuit different from that to which the receiver is connected.
- Consult the dealer or an experienced radio/TV technician for help.

## The Safety of Your Ears is in Your Hands

Get the most out of your equipment by playing it at a safe level – a level that lets the sound come through clearly without annoying blaring or distortion and, most importantly, without affecting your sensitive hearing. Sound can be deceiving. Over time, your hearing “comfort level” adapts to higher volumes of sound, so what sounds “normal” can actually be loud and harmful to your hearing. Guard against this by setting your equipment at a safe level BEFORE your hearing adapts.

### ESTABLISH A SAFE LEVEL:

- Set your volume control at a low setting.
- Slowly increase the sound until you can hear it comfortably and clearly, without distortion.
- Once you have established a comfortable sound level, set the dial and leave it there.

### BE SURE TO OBSERVE THE FOLLOWING GUIDELINES:

- Do not turn up the volume so high that you can't hear what's around you.
- Use caution or temporarily discontinue use in potentially hazardous situations.
- Do not use headphones while operating a motorized vehicle; the use of headphones may create a traffic hazard and is illegal in many areas.

S001a\_A1\_En

**WARNING:** Handling the cord on this product or cords associated with accessories sold with the product may expose you to chemicals listed on proposition 65 known to the State of California and other governmental entities to cause cancer and birth defect or other reproductive harm.

***Wash hands after handling.***

D36-P5\_B1\_En

### IMPORTANT NOTICE

THE MODEL NUMBER AND SERIAL NUMBER OF THIS EQUIPMENT ARE ON THE REAR OR BOTTOM.

RECORD THESE NUMBERS ON YOUR ENCLOSED WARRANTY CARD AND KEEP IN A SAFE PLACE FOR FUTURE REFERENCE.

### Condensation

If the unit is moved suddenly from a cold place into a warm room (in winter, for example) or if the temperature in the room in which the player is installed rises suddenly due to a heater, etc., water droplets (condensation) may form inside (on operating parts and the lens). When condensation is present, the player will not operate properly and playback is not possible. Let the player stand at room temperature for 1 or 2 hours with the power turned on (the time depends on the extent of condensation). The water droplets will dissipate and playback will become possible.

Condensation can also occur in the summer if the player is exposed to the direct wind from an air-conditioner. If this happens, move the player to a different place.

S005\_A1\_En

Thank you for buying this Pioneer product.

Please read through these operating instructions so that you will know how to operate your model properly. After you have finished reading the instructions, put them in a safe place for future reference.

# Contents

## 01 Before you start

Introduction	7
What's in the box	7
Loading the battery in the remote control	7

## 02 Part names and functions

Overview of the main unit	9
Overview of the remote control	10

## 03 Connections

Speaker connection	11
FM antenna installation	12
Connect power	12

## 04 Getting started

Turning on	13
APS mode	13
Setting the clock	13
Selecting a source	13

## 05 Playing

Playing a disc	14
Playing from a USB storage device	14
Controlling playback	14
Programming tracks	15
For a CD	15
For MP3 files	15
Erasing the program	15

## 06 Bluetooth® Audio playback

Music playback using <i>Bluetooth</i> wireless technology	16
Remote control operation	16
Pairing with the unit (Initial registration)	16
Listen to music on the unit from a Bluetooth capable device	17
Radio wave caution	17
Scope of operation	17
Radio wave reflections	18
Precautions regarding connections to products supported by this unit	18

## 07 Listening to the FM radio

Tuning to an FM radio station	19
Programming radio stations	19
Tuning to a preset radio station	19
Display RDS information	19

## 08 Other features

Turn on automatically	20
Setting the sleep timer	20
Routing audio from other devices	20
Through the AUDIO IN socket	20
USB 500 mA charge	20
Setting and deactivating the DEMO mode	20

## 09 Additional information

USB playability information	21
-----------------------------	----

Supported MP3 disc formats	21
RDS program types	21
Troubleshooting	22
Cautions on use	23
When moving this unit	23
Place of installation	23
Do not place objects on this unit	23
Cleaning the product	24
Cleaning the lens	24
Handling discs	24
Storing	24
Cleaning discs	24
About specially shaped discs	24
Specifications	25

## Chapter 1:

# Before you start

### Introduction

#### With this system, you can:

- enjoy audio from discs, USB storage devices, and other external devices
- listen to FM radio stations
- enjoy audio from *Bluetooth* wireless technology enabled device

#### Playable media:

- Discs: CD-DA, CD-R, CD-RW, MP3-CD
- Files: .mp3
- USB storage device
  - Compatibility: USB 1.1/2.0 (Full Speed)
  - Class support: MSC (Mass Storage Class)
  - File system: FAT12, FAT16, FAT32
  - Maximum number of albums/folders: 99
  - Maximum number of tracks/files: 999
  - Maximum level of directory: 8

### What's in the box

Check and identify the contents of the package:

- Main unit
- Speaker unit x 2
- Remote control
- AAA battery (R03)
- Warranty card
- Operating Instructions (this document)

### Loading the battery in the remote control

**1 Open the rear lid and load the battery as illustrated below.**

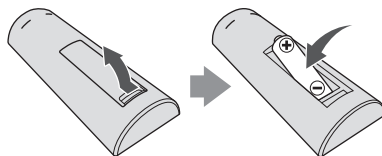

**2 Close the rear lid.**

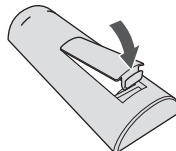

The battery included with the unit has been provided to allow you check product operation and may not last long. We recommend using an alkaline battery that has a longer life.

#### ⚠ CAUTION

- When inserting the battery, make sure not to damage the spring on the battery's \* terminal. This can cause the battery to leak or overheat.



Insert the battery by aligning the \* pole against the remote control's \* terminal

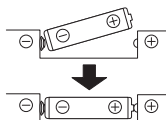

If a battery pushes and bends the \* terminal out of shape, there is possibility of the alkaline battery shorting out

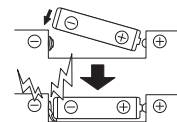

The \* terminal is bent out of shape

- Do not use any battery other than the one specified.
- When loading the battery into the remote control, set it in the proper direction, as indicated by the polarity marks (+ and \*).
- Do not heat the battery, disassemble it, or throw it into flames or water.
- To prevent leakage of battery fluid, remove the battery if you do not plan to use the remote control for a long period of time (1 month or more). If the fluid should leak, wipe it carefully off the inside of the case, then insert a new battery. If a battery should leak and the fluid should get on your skin, flush it off with large quantities of water.
- When disposing of a used battery, please comply with governmental regulations or environmental public institution's rules that apply in your country/area.
- **WARNING**  
Do not use or store batteries in direct sunlight or other excessively hot place, such as inside a car or near a heater. This can cause batteries to leak, overheat, explode or catch fire. It can also reduce the life or performance of batteries.



## Chapter 2:

## Part names and functions

## Overview of the main unit

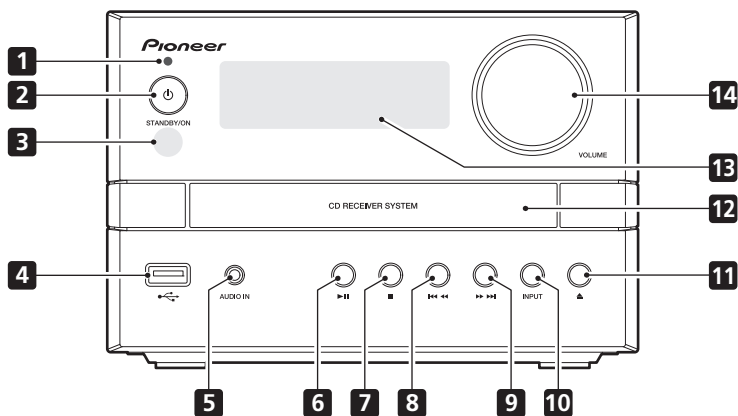
**1 Bluetooth indicator****2 STANDBY/ON**

- Switch between standby and on.

**3 Remote control sensor**

- Point the remote control to this, and then operate it within approximately 7 m. The product may have trouble capturing remote control signals if there is a fluorescent light nearby. If this happens, move the product away from the fluorescent light.

**4**

- Connect to a USB storage device.

**5 AUDIO IN**

- Connect to the audio output socket (usually the headphones socket) of an external device.

**6**

- Use to play, pause, or resume playback.

**7**

- Use to stop playback.

**8**

- Skip to the previous track.
- Press and hold to play reverse quickly within a track.
- Tune to the previous radio station.
- Press and hold to search the previous radio station automatically.

**9**

- Skip to the next track.
- Press and hold to play forward quickly within a track.
- Tune to the next radio station.
- Press and hold to search the next radio station automatically.

**10 INPUT**

- Press repeatedly to select the input source.

**11**

- Open or close the disc tray.

**12 Disc tray**

- Place the disc with the label side up.

**13 Main display****14 VOLUME**

- Rotate to increase or decrease the volume level.

## Overview of the remote control

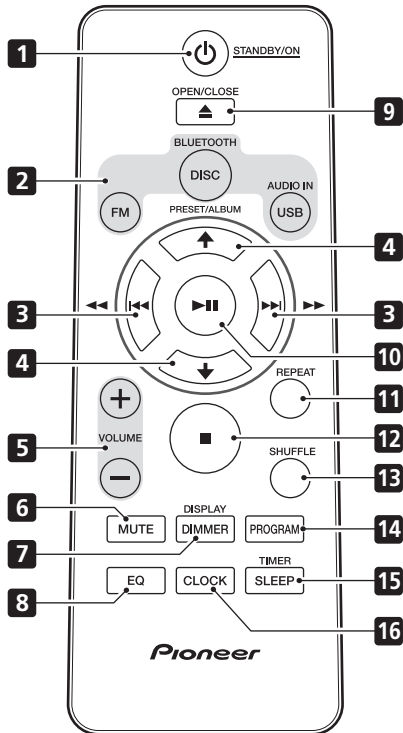

### 1 STANDBY/ON

- Switch between standby and on.

### 2 **Input function buttons**

- Use to select the input source (**DISC**, **BT**, **USB**, **AUDIO IN**, **TUNER**).

### 3

- Skip to the track.
- Press and hold to play quickly within a track.
- Tune to the station.
- Press and hold to search the radio station automatically.

### 4

- Skip to the previous or next album.
- Select a preset radio station.

### 5 **VOLUME +/-**

- Use to set the listening volume.

### 6 **MUTE**

- Use to mute or restore volume.

### 7 **DIMMER/DISPLAY**

- Display the current status or media information.
- Display the available ID3 information of MP3 tracks.
- Press and hold to dim or brighten the display. The brightness can be controlled in three steps. However the brightness cannot be controlled during FM entry.
- Display the available information of an RDS radio station.

### 8 **EQ**

- Use to select EQ.  
[FLAT] → [ROCK] → [CLASSIC] → [POP] → [JAZZ] → (Back to beginning)

### 9 OPEN/CLOSE

- Open or close the disc tray.

### 10 PLAY/PAUSE

- Use to play, pause, or resume playback.
- Use to confirm actions.

### 11 **REPEAT**

- Use to select the repeat mode of each input source.
- [CD]/[BT]  
Repeat 1 [REP ONE] → Repeat all [REP ALL] → (Back to beginning)
- [USB]  
Repeat 1 [REP ONE] → Repeat album [REP ALB] → Repeat all [REP ALL] → (Back to beginning)

### 12

- Use to stop playback.

### 13 **SHUFFLE**

- Shuffled order of track playback from a **DISC**, **USB**.

### 14 **PROGRAM**

- Use to program audio tracks.
- Use to program radio stations.

### 15 **SLEEP/TIMER**

- Set the sleep timer in the working mode.
- Set alarm timer in the standby mode.

### 16 **CLOCK**

- In the working mode or standby mode, press to display the clock for a while.
- In the standby mode, press and hold to set the clock.

## Chapter 3:

## Connections

**CAUTION**

- Be sure to turn off the power and unplug the power cord from the power outlet whenever making or changing connections.
- Connect the power cord after all the connections between devices have been completed.

**Speaker connection**

- Push open the tabs and insert exposed wire.
- Use the provided speaker wires to connect this unit with the speakers. Connect the tip of the red wire to the (+) terminal and the tip of the black wire to the (-) terminal.
- Both speakers can be used on either the right or the left side.

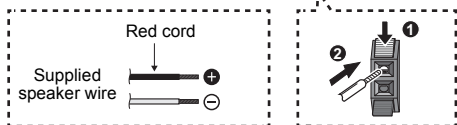
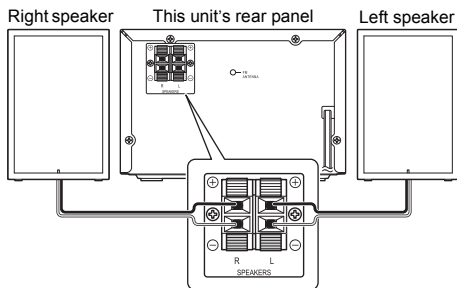
**CAUTION**

- These speaker terminals carry **HAZARDOUS LIVE voltage**. To prevent the risk of electric shock when connecting or disconnecting the speaker cables, disconnect the power cord before touching any uninsulated parts.
- Do not connect any speakers other than those supplied to this system.
- Do not connect the supplied speakers to any amplifier other than the one supplied with this system. Connection to any other amplifier may result in malfunction or fire.
- Do not attach these speakers to the wall or ceiling. They may fall off and cause injury.

- Make sure that the speaker cable cores do not become exposed and make contact with other cable cores. This may cause malfunction of the product.
- Do not allow the speaker cable core to come into contact with the receiver body.

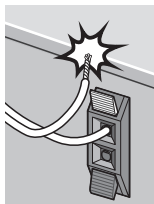

- If the speaker cable core comes into contact with any metal portion of the receiver's body, it may damage the speakers and cause smoke and fire. Insert speaker cables securely into the terminals and check that the cable does not come out of easily.

**Note**

- There is no difference between L and R speakers.

## FM antenna installation

### Note

- The antenna on the back panel is used to improve reception of FM. Extend this antenna and fix it to a position with the best reception.
- Never tug strongly on the antenna line since damage of an antenna may be caused.
- This product does not support MW (medium wave) radio reception.

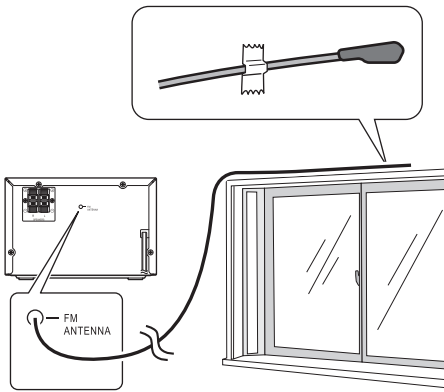

## Connect power

### Note

- Before you connect the AC power cord, make sure that you have completed all other connections.

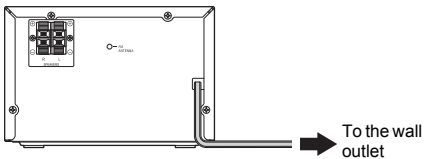

Connect the AC power cord to the wall outlet.

## Chapter 4:

## Getting started

**⚠ CAUTION**

- Use of controls or adjustments or performance of procedures other than herein expressly specified may result in hazardous radiation exposure or other unsafe operation.

Always follow the instructions in this chapter in sequence.

**Turning on****▶ Press  STANDBY/ON**

This product switches to the last selected source.

**APS mode**



- After this product is kept inactive for 15 minutes, it automatically switches to the standby mode.

**Setting the clock**** Note**

- During setting, if no action is made within 90 seconds, the system exits clock setting without saving earlier operations.
- When power supply is restored after unit is plugged in again or after a power failure, reset the clock.

**1 In the standby mode, press and hold CLOCK to activate clock setting.**



[24H] blinks.

**2 Press   to select [24H] or [12H] and then press CLOCK to confirm.**

The hour digits will blink.

**3 Press   to set the hour, and then press CLOCK to confirm.**

The minute digits blink.

**4 Press   to set the minute, and then press CLOCK to confirm.****Selecting a source**

Press **INPUT** repeatedly to select a source.

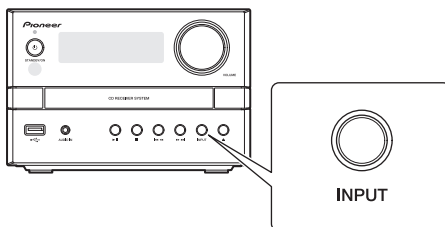

- **[DISC]**: the disc in the disc tray
- **[BT]**: Bluetooth capable device that is paired
- **[USB]**: .mp3 files stored on the connected USB storage device
- **[TUNER]**: the FM radio
- **[AUDIO IN]**: the audio input through the **AUDIO IN** socket

## Chapter 5:

## Playing

## Playing a disc

1 Press **DISC** on the remote control or **INPUT** repeatedly on the main unit to switch the source to **[DISC]**.

2 Press **▲** to eject the disc tray.

3 Load a disc with the printed side facing up.

4 Press **▲** again to close the disc tray.

Playback starts automatically after a few seconds.

- If playback does not start automatically, press **▶||** to start playback.

## Playing from a USB storage device

This system can play .mp3 files that are copied onto a supported USB storage device:

- Flash drive
- Memory card reader
- HDD: hard disk drive (This product can detect only a portable HDD with USB power peak current no more than 500 mA.)

 **Note**

- Pioneer does not guarantee compatibility with all USB storage devices.
- NTFS (New Technology File System) file system is not supported.

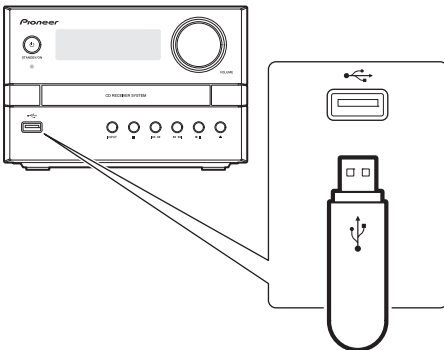

1 Connect the USB storage device to the **USB** socket.

2 Press **USB** on the remote control or **INPUT** repeatedly on the main unit to switch the source to **[USB]**.

Playback starts automatically.

If playback does not start automatically,

1 Press **▲/▼** to select an album.

2 Press **◀◀/▶▶** to select a track.

3 Press **▶||** to start playback.

## Controlling playback

During playback, follow the instructions below to control playback.

Buttons	Functions
<b>▶  </b>	Pause or resume playback.
<b>■</b>	Stop playback.
<b>◀◀/▶▶</b>	Skip to the previous or next track. Press and hold to rewind a track or search forward fast within a track.
<b>◻/▶▶</b>	Skip to the previous or next album when no less than one album exists.
<b>REPEAT</b>	Select an available play mode. <ul style="list-style-type: none"> <li>• Repeat 1 <b>[REP ONE]</b>: repeat the current track</li> <li>• Repeat all <b>[REP ALL]</b>: repeat all tracks</li> <li>• Repeat album <b>[REP ALB]</b>: repeat the current album (only USB function)</li> </ul>
<b>SHUFFLE</b>	Select an available play mode. <ul style="list-style-type: none"> <li>• Shuffle <b>◻</b>: play tracks randomly</li> </ul> Shuffle <b>◻</b> is unavailable for programmed tracks.

## Programming tracks

### Note

- You can program up to 20 tracks.
- During programming, if no operation is made within 20 seconds, the system returns to the stop mode without saving earlier operations.

### For a CD

#### 1 Press **■** to stop playback.

[[T0]], the total number of tracks, and the duration time are displayed.

#### 2 Press **PROGRAM** to activate the programming.

[01 PR01] (the sequence number) are displayed with [01] blinking.

#### 3 Press **◀◀/▶▶** to select a track.

#### 4 Press **PROGRAM** again to program the selected track.

#### 5 Repeat steps 3 and 4 to program more tracks.

#### 6 Press **▶||** to start playback.

### For MP3 files

#### 1 Press **■** to stop playback.

[F XX] (XX indicates the total number of albums) and [XXX] (XXX indicates the total number of tracks) are displayed.

#### 2 Press **PROGRAM** to activate the programming.

[01 PR01] are displayed with [01] blinking.

#### 3 Press **□/▶▶** repeatedly to select an album.

[F XX] (XX indicates the album number) are displayed.

#### 4 Press **◀◀/▶▶** repeatedly to select a track.

[XXX] (XXX indicates the track number) are displayed.

#### 5 Press **PROGRAM** again to confirm the selected track.

#### 6 Repeat steps 3 to 5 to program more tracks.

#### 7 Press **▶||** to start playback.

### Erasing the program

#### ▶ To erase the program,

- Switch to another source.

## Chapter 6:

# Bluetooth® Audio playback

## Music playback using Bluetooth wireless technology

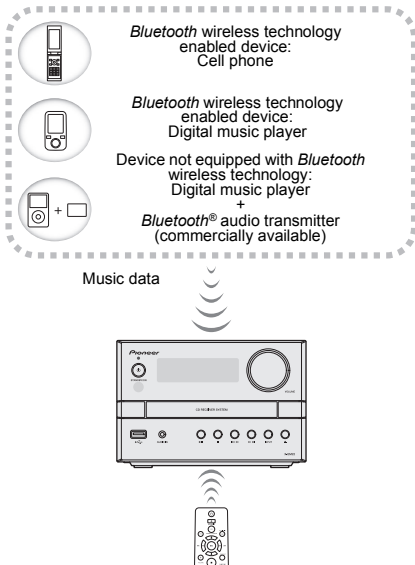

The unit is capable of playing back music stored on Bluetooth capable devices (cell phones, digital music players etc.) wirelessly. You can also use a Bluetooth audio transmitter (sold separately) to enjoy music from devices that do not have Bluetooth functionality. Please refer to the user's manual for your Bluetooth capable device for more details.

### Note

- The Bluetooth® word mark and logos are registered trademarks owned by Bluetooth SIG, Inc. and any use of such marks by PIONEER CORPORATION is under license. Other trademarks and trade names are those of their respective owners.
- The Bluetooth wireless technology enabled device must support A2DP profiles.
- Pioneer does not guarantee proper connection and operation of this unit with all Bluetooth wireless technology enabled devices.

## Remote control operation

The remote control supplied with this unit allows you to play and stop media, and perform other operations.

### Note

- The Bluetooth wireless technology enabled device must support AVRCP profiles.
- Remote control operations cannot be guaranteed for all Bluetooth wireless technology enabled devices.

## Pairing with the unit (Initial registration)

In order for the unit to playback music stored on a Bluetooth capable device, pairing must first be performed. Pairing should be performed when first using the unit with the Bluetooth capable device, or when the pairing data on the device has been erased for any reason.

Pairing is a step required to allow communication using Bluetooth wireless technology to be carried out.

- Pairing is only performed the first time that you use the unit and the Bluetooth capable device together.
- In order to allow communication using Bluetooth wireless technology to take place, pairing must be performed on both the unit and the Bluetooth capable device.

### 1 Press BLUETOOTH on the remote control or INPUT repeatedly on the main unit to switch the source to [BT].

The Bluetooth indicator blinks.

### 2 Turn on the power to the Bluetooth capable device that you wish to pair with, and perform pairing procedure on it.

### Note

- This unit will be displayed as "X-EM26" on all Bluetooth capable devices that you have.

Pairing will start.

- Place the Bluetooth capable device close to the unit.
- Please refer to the user's manual for your Bluetooth capable device for details on when pairing can be performed and the procedures required for pairing.
- When PIN code entry is requested, enter "0000." (This unit does not accept any PIN code setting other than "0000.")



### 3 Confirm on the *Bluetooth* capable device that pairing has been completed.

- If pairing with the *Bluetooth* capable device has been completed correctly, a beep will sound, and the *Bluetooth* indicator will switch from blinking to staying lit.
- If the *Bluetooth* indicator will not switch from blinking to staying lit, the pairing was not completed correctly so please try pairing with the unit again.
- If pairing has been completed correctly, you need not repeat this procedure again.

Even devices that have already been paired with this unit will not connect during pairing mode in the following cases.

In such cases, delete pairing history from the *Bluetooth* wireless technology device and perform pairing again.

In order to pair with the unit, press and hold the ►||| on the unit for 3 seconds.

- Up to 8 pairing history can be recorded with this unit. If connecting to a *Bluetooth* wireless technology device over 8 units, the oldest pairing history will be deleted.
- If the settings are reset to the factory setting, all pairing history will be deleted. In order to reset to factory setting, press and hold the ►||| on the unit for more than 8 seconds.

## Listen to music on the unit from a *Bluetooth* capable device

### 1 Press **BLUETOOTH** on the remote control or **INPUT** repeatedly on the main unit to switch the source to **[BT]**.

The unit will start using the **BT** function, and connect with a *Bluetooth* capable device.

### 2 A *Bluetooth* connection will be created between the *Bluetooth* capable device and the unit.

Procedures for connecting to the unit should be performed from the *Bluetooth* capable device.

- Please refer to the user's manual for your *Bluetooth* capable device for details of the connection procedures.

### 3 Playback music from the *Bluetooth* capable device.

#### Note

- When *Bluetooth* capable device is not connected and no operations have been performed for more than 15 minutes, the unit will automatically power off.

## Radio wave caution

This unit uses a 2.4 GHz radio wave frequency, which is a band used by other wireless systems (see list below). To prevent noise or interrupted communication, do not use this unit nearby such devices, or make sure these devices are switched off during use.

- Cordless phones
- Cordless facsimiles
- Microwave ovens
- Wireless LAN devices (IEEE802.11b/g)
- Wireless AV equipment
- Wireless controllers for game systems
- Microwave-based health aids
- Some baby monitors

Other, less common, equipment that may operate on the same frequency:

- Anti-theft systems
- Amateur radio stations (HAM)
- Warehouse logistic management systems
- Discrimination systems for train or emergency vehicles

#### Note

- In the event noise appears in your television image, there is the possibility that a *Bluetooth* wireless technology enabled device or this unit (including products supported by this unit) are causing signal interference with the antenna input connector of your television, video, satellite tuner, etc. In this event, increase the distance between the antenna input connector and the *Bluetooth* wireless technology enabled device or this unit (including products supported by this unit).
- If there is something obstructing the path between this unit (including devices supported by this unit) and the device equipped with *Bluetooth* wireless technology (such as a metal door, concrete wall, or insulation containing tinfoil), you may need to change the location of your system to prevent signal noise and interruptions.

## Scope of operation

Use of this unit is limited to home use. (Transmission distances may be reduced depending on communication environment).

In the following locations, poor condition or inability to receive radio waves may cause the audio to be interrupted or stopped:

- In reinforced concrete buildings or steel framed or iron-framed buildings.
- Near large metallic furniture.
- In a crowd of people or near a building or obstacle.
- In a location exposed to the magnetic field, static electricity or radio wave interference from radio communication equipment using the same frequency band (2.4 GHz) as this unit, such as a 2.4 GHz wireless LAN device (IEEE802.11b/g) or microwave oven.

- If you live in a heavily populated residential area (apartment, townhouse, etc.) and if your neighbor's microwave is placed near your system, you may experience radio wave interference. If this occurs, move your unit to a different place. When the microwave is not in use, there will be no radio wave interference.

### **Radio wave reflections**

The radio waves received by this unit include the radio wave coming directly from the device equipped with *Bluetooth* wireless technology (direct wave) and waves coming from various directions due to reflections by walls, furniture and building (reflected waves). The reflected waves (due to obstacles and reflecting objects) further produce a variety of reflected waves as well as variation in reception condition depending on locations. If the audio cannot be received properly due to this phenomenon, try moving the location of the device equipped with *Bluetooth* wireless technology a little. Also note that audio may be interrupted due to the reflected waves when a person crosses or approaches the space between this unit and the device equipped with *Bluetooth* wireless technology.

### **Precautions regarding connections to products supported by this unit**

- Complete connections for all devices supported by this unit, including all audio cords and power cables before connecting them to this unit.
- After completing connections to this unit, check the audio and power cables to confirm that they not twisted together.
- When disconnecting this unit, confirm that you have sufficient working space in the surrounding area.
- When changing connections of audio or other cables for products supported by this unit, confirm that you have sufficient working space in the surrounding area.

## Chapter 7:

# Listening to the FM radio

## Tuning to an FM radio station

### Note

- Make sure that you have connected and fully extended the FM antenna.

**1 Press FM on the remote control or INPUT repeatedly on the main unit to switch the source to tuner.**

**2 Press and hold ◀◀/▶▶ until the frequency starts to change.**

- To tune to a station at a specific frequency, press ◀◀/▶▶ repeatedly until the desired frequency is displayed.

## Programming radio stations

### Note

- You can program up to 30 preset radio stations.
- To overwrite a programmed radio station, store another one with its sequence number.

**1 Tune to a radio station.**

**2 Press PROGRAM to activate programming.** [XX] (XX indicates the sequence number) blinks.

**3 Press ▲/▼ to allocate a sequence number from 1 to 30 to this radio station, and then press PROGRAM to confirm.**

The preset sequence number and the frequency of this radio station are displayed.

**4 Repeat steps 1-3 to program more stations.**

### Tip

- Press and holding **PROGRAM** will allow you to freely select any radio station. The selected station will be saved automatically.

## Tuning to a preset radio station

- Press ▲/▼ to select the sequence number of that preset radio station.

## Display RDS information

RDS (Radio Data System) is a service that allows FM stations to show additional information. If you tune to an RDS radio station, [RDS] and the station name are displayed.

**1 Tune to an RDS radio station.**  
**2 Press DISPLAY repeatedly to scroll through the available information:**

- Station name
- Frequency
- Program type such as [NEWS] (news), [SPORT] (sport), [POP M] (pop music)...
- Text messages
- CT (Clock Time)

## Chapter 8:

## Other features

## Turn on automatically

You can set a time for automatic power on.

 Note

- Make sure that you have set the clock before this setup.

**1 In standby mode, press the CLOCK to display time and then press and hold SLEEP/TIMER.**

[SOURCE] (time for auto power on) blinks.

**2 Press ◀◀/▶▶ to select [SOURCE].**

**3 Press SLEEP/TIMER.**

The hour digits blink.

**4 Press ◀◀/▶▶ to set the hour.**

**5 Press SLEEP/TIMER again.**

The minute digits blink.

**6 Press ◀◀/▶▶ to set the minute.**

**7 Press SLEEP/TIMER again.**

**8 Press ◀◀/▶▶ to set the volume.**

**9 Press SLEEP/TIMER.**

The clock time and [TIMER] are displayed.

- To deactivate the timer, display the time and then press **SLEEP/TIMER** again.
- The power cannot be turned on while the timer is being set. Finish setting the time, then turn on the power.

## Setting the sleep timer

In the working mode, press **SLEEP/TIMER** repeatedly to select a preset period (15, 30, 45, 60, 90 or 120 minutes).

When the sleep timer is activated, [SLEEP] is displayed on the lower-right corner of the main display.

- To deactivate the sleep timer, press **SLEEP/TIMER** repeatedly until [SLEEPOFF] is displayed.

## Routing audio from other devices

## Through the AUDIO IN socket

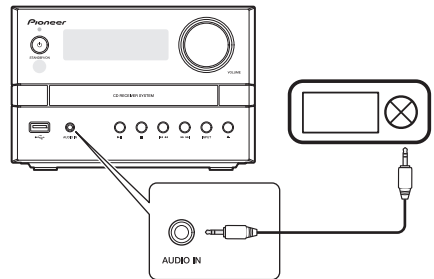

**1 Connect a stereo mini-plug cable (commercially available) to**

- the **AUDIO IN** socket on the front panel of the main unit, and
- the headphones socket on the external device (for example, an MP3 player).

**2 Press AUDIO IN on the remote control or INPUT repeatedly on the main unit to switch the source to [AUDIO IN].**

**3 Play the external device.**

## USB 500 mA charge

The USB terminal on this unit has a 500 mA output. A USB device up to 500 mA can be connected and used/charged.

## Setting and deactivating the DEMO mode

You can set it to DEMO mode where the display scrolls the words. When the power is off (standby mode) press and hold **■**. This will set the DEMO mode. To deactivate, press **■** again.

## Chapter 9:

## Additional information

## USB playability information

## Compatible USB devices:

- USB flash memory (USB1.1/2.0 (Full Speed))
- USB flash players (USB1.1/2.0 (Full Speed))
- Memory cards (an additional card reader is required)

## Supported formats:

- USB or memory file format FAT12, FAT16, FAT32 (sector size: 512 bytes)
- MP3 bitrates (data rates): 32 kbps to 320 kbps and variable bitrates
- Directory nesting up to 8 levels
- Number of albums/folders: maximum 99
- Number of tracks/files: maximum 999 (depending on file name length)
- ID3 tag v2.0 or later (Only English letters and numbers are supported.)
- File name in Unicode UTF8 (maximum length: 16 bytes)

Audio files cannot be played depending on the encoding software settings, USB device type, recording, other conditions.

## Unsupported formats:

- Empty albums: an album that does not contain MP3 files
- Unsupported file formats are skipped. For example, Word documents (.doc) or MP3 files with extension.dlf are ignored and not played.
- AAC, WAV, PCM audio files
- WMA files (.wav, .m4a, .m4p, .mp4, .aac)

## Supported MP3 disc formats

- ISO9660, Joliet
- Maximum track/file number: 999 (depending on file name length)
- Maximum album number: 99
- Supported sampling frequencies: 32 kHz, 44.1 kHz, 48 kHz
- Supported bitrates: 32 kbps to 320 kbps, variable bitrates

Audio files cannot be played depending on the encoding software settings, USB device type, recording, other conditions.

## RDS program types

NO TYPE	No RDS programme type
NEWS	News services
AFFAIRS	Politics and current affairs
INFO	Special information programs
SPORT	Sports
EDUCATE	Education and advanced training
DRAMA	Radio plays and literature
CULTURE	Culture, religion and society
SCIENCE	Science
VARIED	Entertainment programs
POP M	Pop music
ROCK M	Rock music
EASY M	Light music
LIGHT M	Light classical music
CLASSICS	Classical music
OTHER M	Special music programs
WEATHER	Weather
FINANCE	Finance
CHILDREN	Children's programs
SOCIAL	Social Affairs
RELIGION	Religion
PHONE IN	Phone In
TRAVEL	Travel
LEISURE	Leisure
JAZZ	Jazz Music
COUNTRY	Country Music
NATION M	National Music
OLDIES	Oldies Music
FOLK M	Folk Music
DOCUMENT	Documentary
TES	Alarm Test
ALARM	Alarm

## Troubleshooting

### ⚠ WARNING

- Never remove the casing of this apparatus.

Incorrect operation is often mistaken for trouble or malfunction. If you think that there is something wrong with this component, check the points below. Sometimes the trouble may lie in another component. Inspect the other components and electrical appliances being used. If the trouble cannot be rectified even after checking the points below, ask your nearest Pioneer authorized service center or your dealer to carry out repair work.

- If the unit does not operate normally due to external effects such as static electricity, disconnect the power plug from the outlet and insert it again to return to normal operating conditions.

Problem	Solution
No power.	Make sure that the AC power cord is connected properly.
	Make sure that there is power at the AC outlet.
	With a power-saving feature, the system switches off automatically 15 minutes after the system stays inactive.
No sound or poor sound.	Adjust the volume.
	Make sure that the speakers are connected correctly.
No response from the system.	Reconnect the AC power plug, and then turn on the system again.
	With a power-saving feature, the system switches off automatically 15 minutes after the system stays inactive.
Remote control does not work.	Reduce the distance between the remote control and the main unit.
	Insert battery with its polarity (+/- signs) aligned as indicated.
	Replace the batteries.
	Aim the remote control directly at the sensor on the front panel of the main unit.
No disc is detected.	Insert a disc.
	Make sure that you place the disc with its label facing upwards.
	Wait until the moisture condensation at the lens has cleared.
	Replace or clean the disc.
USB storage device is not supported.	Make sure that the recordable disc is finalized and the format is supported.
	Is the USB storage device connected properly? Make sure that the device is firmly inserted.
Cannot play some files on the USB storage device.	Make sure that the file format is supported.
	Make sure that the file quantity does not exceed the maximum. (page 21)
Radio reception is poor.	Increase the distance between the system and other electrical appliances.
	Fully extend the antenna.
Timer does not work.	Set the clock correctly.
	Switch on the timer.
Clock/timer setting is erased.	Power has been interrupted or the AC power cord has been disconnected.
	Reset the clock/timer.

## When the *Bluetooth* wireless technology device is connected or operated

Problem	Solution
The <i>Bluetooth</i> wireless technology device cannot be connected or operated. Sound from the <i>Bluetooth</i> wireless technology device is not emitted or the sound is interrupted.	<p>Check that no object that emits electromagnetic waves in the 2.4 GHz band (microwave oven, wireless LAN device or <i>Bluetooth</i> wireless technology apparatus) is near the unit. If such an object is near the unit, set the unit far from it. Or, stop using the object emitting the electromagnetic waves.</p> <hr/> <p>Check that the <i>Bluetooth</i> wireless technology device is not too far from the unit and that obstructions are not set between the <i>Bluetooth</i> wireless technology device and the unit. Set the <i>Bluetooth</i> wireless technology device and the unit so that the distance between them is less than about 10 m* and no obstructions exist between them.</p> <hr/> <p>* The distance given is to be used as a rough guide. The actual allowable distance between devices may vary depending on conditions in the surrounding environment.</p> <hr/> <p>The <i>Bluetooth</i> wireless technology device may not be set to the communication mode supporting the <i>Bluetooth</i> wireless technology. Check the setting of the <i>Bluetooth</i> wireless technology device.</p>

## Cautions on use

### When moving this unit

When moving this unit, be sure to first check that there is no disc loaded. Then press **⏻** **STANDBY/ON**, wait until **[GOOD BYE]** disappears on main display to turn off, and then unplug the power cord. Damage may occur if the unit is transported or moved with a disc inserted, or when another device is connected to the USB terminal, or **AUDIO IN** mini-plug jack.

### Place of installation

- Choose a stable place near the TV or stereo system being used with this unit.
- Do not place this unit on top of a TV or color monitor. Also, install it away from cassette decks and other devices easily affected by magnetic forces.

### Avoid the following locations:

- Places exposed to direct sunlight
- Humid or poorly ventilated places
- Extremely hot places
- Places exposed to vibrations
- Places in which there is much dust or cigarette smoke
- Places exposed to soot, steam, or heat (kitchens, etc.)

### Do not place objects on this unit

Do not place any objects on top of this unit.

### Do not obstruct the ventilation holes.

Do not use this unit on shaggy rugs, beds, sofas, etc., or wrapped in cloth, etc. Doing so will prevent the heat from dispersing, leading to damage.

### Do not expose to heat.

Do not place this unit on top of an amplifier or other components that generate heat. When rack mounting it, to avoid the heat given off by the amplifier or other audio components, place it on a shelf below the amplifier.

- Turn off the power of this unit when not using it.
- Depending on signal conditions, striped patterns may appear on a TV screen and noise may enter the sound of radio broadcasts when the power of this unit is on. If this happens, turn off the power of this unit.

### Cleaning the product

- Unplug the power cord from the power outlet when cleaning this unit.
- Clean this unit using a soft cloth. For tough dirt, apply some neutral detergent diluted in 5 to 6 parts water to a soft cloth, wring out thoroughly, wipe off the dirt, and then wipe again with a soft, dry cloth.
- Alcohol, thinner, benzene, insecticides, etc., could cause the print or paint to peel off. Also, leaving rubber or vinyl products in contact with this unit for long periods of time could mar the cabinet.
- When using chemical-impregnated wipes, etc., read the cautions included with the wipes carefully.

### Cleaning the lens

- The lens of this unit should not become dirty in normal use, but if for some reason it should malfunction due to dust or dirt, consult your nearest Pioneer authorized service center. Although lens cleaners for players are commercially available, we advise against using them since some may damage the lens.

## Handling discs

### Storing

- Always place discs in their cases and store them vertically, avoiding hot, humid places, places exposed to direct sunlight and extremely cold places.
- Be sure to read the cautions included with the disc.

### Cleaning discs

- Discs may not play if there are fingerprints or dust on them. In this case, use a cleaning cloth, etc., to gently wipe the disc from the inside towards the outside. Do not use dirty cleaning cloths.



- Do not use benzene, thinner or other volatile chemicals. Also, do not use record spray or antistatic agents.
- For tough dirt, apply some water to a soft cloth, wring out thoroughly, wipe off the dirt, and then wipe off the moisture with a dry cloth.
- Do not use damaged (cracked or warped) discs.
- Do not let the signal surface of discs get scratched or dirty.

- Do not attach pieces of paper or stickers to discs. Doing so could warp discs, making it impossible to play them. Also, note that rental discs often have labels attached to them, and the glue of the label may have oozed out. Check that there is no glue around the edges of such labels before using rented discs.

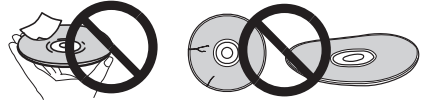

### About specially shaped discs

Specially shaped discs (heart-shaped, hexagonal, etc.) cannot be played on this unit. Do not attempt to play such discs, as they could damage this unit.





## Specifications

### • Amplifier

Rated output power 5 watts minimum continuous  
 All channels: power per channel, 8 ohm loads,  
 2 channels driven at 1 kHz, with a  
 maximum total harmonic  
 distortion of 10% (FTC)  
 2ch x 5 W (8 Ω, 1kHz, 2ch driven)  
 (IEC)

### • Disc

Disc diameter . . . . . 12 cm, 8 cm  
 Support discs . . . . . CD-DA, CD-R, CD-RW, MP3-CD  
 Frequency response . . . . . 20Hz to 20kHz (44.1kHz)

### • Tuner (FM)

Tuning range . . . . . 87.5 MHz to 108 MHz

### • Bluetooth

Version . . . . . Bluetooth Specification Ver. 4.0  
 Output . . . . . Bluetooth Specification Class 2  
 Estimated line-of-sight transmission distance\*  
 . . . . . About 10 m  
 Frequency range . . . . . 2.4000 GHz to 2.4835GHz ISM Band  
 Modulation  
 . . . . . FH-SS (Frequency Hopping Spread Spectrum)  
 Supported Bluetooth profiles . . . . . A2DP, AVRCP  
 Supported Codec . . . . . SBC (Subband Codec)  
 Supported contents protection . . . . . SMSC-T  
 \* The line-of-sight transmission distance is an estimate.  
 Actual transmission distances supported may differ  
 depending on surrounding conditions.

### • Speakers

Type . . . . . 1 way 1 speaker system  
 Speaker composition . . . . . 8 cm cone type  
 Speaker impedance . . . . . 8 Ω

### • General information

AC power . . . . . 120V 60 Hz  
 Operation power consumption . . . . . 12 W  
 Standby power consumption . . . . . ≤ 0.5 W  
 USB Direct . . . . . USB 1.1/2.0 (Full Speed)  
 USB 5V Power . . . . . ≤ 500 mA  
 Dimensions  
 – Main unit (W x H x D) . . . . 180 mm x 121 mm x 221 mm  
 – Speaker box (W x H x D) . . . 121 mm x 182 mm x 200 mm  
 Weight  
 – Main unit . . . . . 1.3 kg  
 – Speaker box . . . . . 1.1 kg x 2

### Note

- The specifications and design of this product are subject to change without notice.
- Corporation and product names mentioned herein are trademarks or registered trademarks of the respective corporations.

“Pioneer” is a trademark of Pioneer Corporation, and is used under license.

© 2016 Onkyo & Pioneer Corporation.  
 All rights reserved.





# Pioneer

2-3-12 Yaesu, Chuo-ku, Tokyo 104-0028 JAPAN

## <U.S.A.>

18 PARK WAY, UPPER SADDLE RIVER, NEW JERSEY 07458, U.S.A.

Tel: 1-201-785-2600 Tel: 1-844-679-5350

## <Germany>

Hanns-Martin-Schleyer-Straße. 35, 47877 Willich, Germany

Tel: +49(0)2154 913222

## <UK>

Anteros Building, Odyssey Business Park, West End Road, South Ruislip, Middlesex, HA4 6QQ United Kingdom

Tel: +44(0)208 836 3612

## <France>

6, Avenue de Marais F - 95816 Argenteuil Cedex FRANCE

Tel :+33(0)969 368 050

Корпорация О энд Пи

2-3-12, Яэсу, Чуо-ку, г. Токио, 104-0028, ЯПОНИЯ

© 2016 Onkyo & Pioneer Corporation. All rights reserved.

© 2016 Onkyo & Pioneer Corporation. Tous droits de reproduction et de traduction réservés.

Printed in China / Imprimé en Chine / Напечатано в Китае

SN xxxxxxxx

Fxxxx-x



YOMxxxxxx-xxxx