

Pioneer

X-HM26

CD Receiver System
Micro chaîne CD
Sistema receptor de CD

Register your product on

<http://www.pioneerelectronics.com> (US)

<http://www.pioneerelectronics.ca> (Canada)

Operating Instructions
Mode d'emploi
Manual de instrucciones



IMPORTANT



The lightning flash with arrowhead symbol, within an equilateral triangle, is intended to alert the user to the presence of uninsulated "dangerous voltage" within the product's enclosure that may be of sufficient magnitude to constitute a risk of electric shock to persons.

CAUTION

RISK OF ELECTRIC SHOCK
DO NOT OPEN

CAUTION:

TO PREVENT THE RISK OF ELECTRIC SHOCK, DO NOT REMOVE COVER (OR BACK). NO USER-SERVICEABLE PARTS INSIDE. REFER SERVICING TO QUALIFIED SERVICE PERSONNEL.



The exclamation point within an equilateral triangle is intended to alert the user to the presence of important operating and maintenance (servicing) instructions in the literature accompanying the appliance.

D3-4-2-1-1_A1_En

IMPORTANT SAFETY INSTRUCTIONS

- 1) Read these instructions.
- 2) Keep these instructions.
- 3) Heed all warnings.
- 4) Follow all instructions.
- 5) Do not use this apparatus near water.
- 6) Clean only with dry cloth.
- 7) Do not block any ventilation openings. Install in accordance with the manufacturer's instructions.
- 8) Do not install near any heat sources such as radiators, heat registers, stoves, or other apparatus (including amplifiers) that produce heat.
- 9) Do not defeat the safety purpose of the polarized or grounding-type plug. A polarized plug has two blades with one wider than the other. A grounding type plug has two blades and a third grounding prong. The wide blade or the third prong are provided for your safety. If the provided plug does not fit into your outlet, consult an electrician for replacement of the obsolete outlet.
- 10) Protect the power cord from being walked on or pinched particularly at plugs, convenience receptacles, and the point where they exit from the apparatus.

- 11) Only use attachments/accessories specified by the manufacturer.
- 12) Use only with the cart, stand, tripod, bracket, or table specified by the manufacturer, or sold with the apparatus. When a cart is used, use caution when moving the cart/apparatus combination to avoid injury from tip-over.



- 13) Unplug this apparatus during lightning storms or when unused for long periods of time.
- 14) Refer all servicing to qualified service personnel. Servicing is required when the apparatus has been damaged in any way, such as power-supply cord or plug is damaged, liquid has been spilled or objects have fallen into the apparatus, the apparatus has been exposed to rain or moisture, does not operate normally, or has been dropped.

D3-7-13-69_En

CAUTION: USE OF CONTROLS OR ADJUSTMENTS OR PERFORMANCE OF PROCEDURES OTHER THAN THOSE SPECIFIED HEREIN MAY RESULT IN HAZARDOUS RADIATION EXPOSURE.

CAUTION: THE USE OF OPTICAL INSTRUMENTS WITH PRODUCT WILL INCREASE EYE HAZARD.

D58-5-1-2a_A1_En

This transmitter must not be co-located or operated in conjunction with any other antenna or transmitter.

D8-9-2-5_A1_En

This device complies with Industry Canada licence-exempt RSS standard(s). Operation is subject to the following two conditions: (1) this device may not cause interference, and (2) this device must accept any interference, including interference that may cause undesired operation of the device.

This equipment complies with IC radiation exposure limits set forth for an uncontrolled environment and meets RSS-102 of the IC radio frequency (RF) Exposure rules. This equipment has very low levels of RF energy that it deemed to comply without maximum permissive exposure evaluation (MPE). But it is desirable that it should be installed and operated keeping the radiator at least 20 cm or more away from person's body (excluding extremities: hands, wrists, feet and ankles).

D8-9-2-7-3_A1_En

This equipment complies with FCC radiation exposure limits set forth for an uncontrolled environment and meets the FCC radio frequency (RF) Exposure Guidelines. This equipment has very low levels of RF energy that it deemed to comply without maximum permissive exposure evaluation (MPE). But it is desirable that it should be installed and operated keeping the radiator at least 20 cm or more away from person's body (excluding extremities: hands, wrists, feet and ankles).

CAUTION

This product is a class 1 laser product classified under the Safety of laser products, IEC 60825-1:2007.

CLASS 1 LASER PRODUCT

D58-5-2-2a_A1_En

WARNING

This equipment is not waterproof. To prevent a fire or shock hazard, do not place any container filled with liquid near this equipment (such as a vase or flower pot) or expose it to dripping, splashing, rain or moisture.

D3-4-2-1-3_A1_En

WARNING

To prevent a fire hazard, do not place any naked flame sources (such as a lighted candle) on the equipment.

D3-4-2-1-7a_A1_En

VENTILATION CAUTION

When installing this unit, make sure to leave space around the unit for ventilation to improve heat radiation (at least 25 cm at top, 15 cm at rear, and 5 cm at each side).

WARNING

Slots and openings in the cabinet are provided for ventilation to ensure reliable operation of the product, and to protect it from overheating. To prevent fire hazard, the openings should never be blocked or covered with items (such as newspapers, table-cloths, curtains) or by operating the equipment on thick carpet or a bed.

D3-4-2-1-7b_A1_En

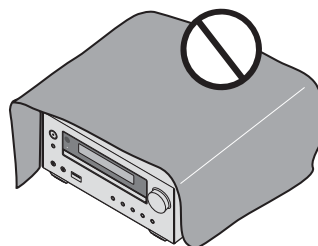

Operating Environment

Operating environment temperature and humidity:
+5 °C to +35 °C (+41 °F to +95 °F); less than 85 %RH
(cooling vents not blocked)

Do not install this unit in a poorly ventilated area, or in locations exposed to high humidity or direct sunlight (or strong artificial light)

D3-4-2-1-7c_A1_En

CAUTION

The **STANDBY/ON** switch on this unit will not completely shut off all power from the AC outlet. Since the power cord serves as the main disconnect device for the unit, you will need to unplug it from the AC outlet to shut down all power. Therefore, make sure the unit has been installed so that the power cord can be easily unplugged from the AC outlet in case of an accident. To avoid fire hazard, the power cord should also be unplugged from the AC outlet when left unused for a long period of time (for example, when on vacation).

D3-4-2-2-2a*_A1_En

This product is for general household purposes. Any failure due to use for other than household purposes (such as long-term use for business purposes in a restaurant or use in a car or ship) and which requires repair will be charged for even during the warranty period.

K041_A1_En

This device complies with Part 15 of the FCC Rules. Operation is subject to the following two conditions:
(1) this device may not cause harmful interference, and
(2) this device must accept any interference received, including interference that may cause undesired operation.

WARNING

Store small parts out of the reach of children and infants. If accidentally swallowed, contact a doctor immediately.

POWER-CORD CAUTION

Handle the power cord by the plug. Do not pull out the plug by tugging the cord and never touch the power cord when your hands are wet as this could cause a short circuit or electric shock. Do not place the unit, a piece of furniture, etc., on the power cord, or pinch the cord. Never make a knot in the cord or tie it with other cords. The power cords should be routed such that they are not likely to be stepped on. A damaged power cord can cause a fire or give you an electrical shock. Check the power cord once in a while. When you find it damaged, ask your nearest our authorized service center or your dealer for a replacement.

S002*_A1_En

(Symbol examples for batteries)

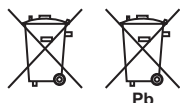

These symbols are only valid in the European Union.

K058c_A1_En

Radio wave caution

This unit uses a 2.4 GHz radio wave frequency, which is a band used by other wireless systems (Microwave ovens and Cordless phones, etc.). In this event noise appears in your television image, there is the possibility this unit (including products supported by this unit) is causing signal interference with the antenna input connector of your television, video, satellite tuner, etc. In this event, increase the distance between the antenna input connector and this unit (including products supported by this unit).

- We are not responsible for any malfunction of the compatible product due to communication error/malfunctions associated with your network connection and/or your connected equipment. Please contact your Internet service provider or network device manufacturer.
- A separate contract with/payment to an Internet service provider is required to use the Internet.

Information to User

Alterations or modifications carried out without appropriate authorization may invalidate the user's right to operate the equipment.

NOTE:

This equipment has been tested and found to comply with the limits for a Class B digital device, pursuant to Part 15 of the FCC Rules. These limits are designed to provide reasonable protection against harmful interference in a residential installation. This equipment generates, uses and can radiate radio frequency energy and, if not installed and used in accordance with the instructions, may cause harmful interference to radio communications. However, there is no guarantee that interference will not occur in a particular installation. If this equipment does cause harmful interference to radio or television reception, which can be determined by turning the equipment off and on, the user is encouraged to try to correct the interference by one or more of the following measures:

- Reorient or relocate the receiving antenna.
- Increase the separation between the equipment and receiver.
- Connect the equipment into an outlet on a circuit different from that to which the receiver is connected.
- Consult the dealer or an experienced radio/TV technician for help.

The Safety of Your Ears is in Your Hands

Get the most out of your equipment by playing it at a safe level – a level that lets the sound come through clearly without annoying blaring or distortion and, most importantly, without affecting your sensitive hearing. Sound can be deceiving. Over time, your hearing “comfort level” adapts to higher volumes of sound, so what sounds “normal” can actually be loud and harmful to your hearing. Guard against this by setting your equipment at a safe level BEFORE your hearing adapts.

ESTABLISH A SAFE LEVEL:

- Set your volume control at a low setting.
- Slowly increase the sound until you can hear it comfortably and clearly, without distortion.
- Once you have established a comfortable sound level, set the dial and leave it there.

BE SURE TO OBSERVE THE FOLLOWING GUIDELINES:

- Do not turn up the volume so high that you can't hear what's around you.
- Use caution or temporarily discontinue use in potentially hazardous situations.
- Do not use headphones while operating a motorized vehicle; the use of headphones may create a traffic hazard and is illegal in many areas.

S001a_A1_En

WARNING: Handling the cord on this product or cords associated with accessories sold with the product may expose you to chemicals listed on proposition 65 known to the State of California and other governmental entities to cause cancer and birth defect or other reproductive harm.
Wash hands after handling.

D36-P5_B1_En

IMPORTANT NOTICE

THE MODEL NUMBER AND SERIAL NUMBER OF THIS EQUIPMENT ARE ON THE REAR OR BOTTOM.
RECORD THESE NUMBERS ON YOUR ENCLOSED WARRANTY CARD AND KEEP IN A SAFE PLACE FOR FUTURE REFERENCE.

Thank you for buying this Pioneer product.

Please read through these operating instructions so that you will know how to operate your model properly. After you have finished reading the instructions, put them in a safe place for future reference.

Contents

01 Before you start

What's in the box	7
Loading the batteries in the remote control	7
Using the remote control	7

02 Part names and functions

Remote control	8
Speaker system	9
Front panel	10
Display	11

03 Connections

Speaker connection	12
Connecting antennas	13
Using external antennas	13
Plugging in	14

04 Getting started

To turn the power on	15
Setting the clock	15
General control	15
Input function	15
Display brightness control	15
Volume auto set-in	15
Volume control	15
Muting	16
Sound controls	16
Equalizer	16
P.BASS control	16
Bass/treble control	16
Setting the wake-up timer	17
Calling the wake-up timer	17
Cancelling the wake-up timer	17
Using the wake-up timer	17
Using the sleep timer	17
Using Headphones	18

05 Disc playback

Playing discs or files	19
Advanced CD or MP3/WMA disc playback	20
Direct track search	20
Repeat play	20
Random play	20
Programmed play (CD or MP3/WMA)	21
About downloading MP3/WMA	21
About folder playback order	21
Specify the folder to play	22
Switch the display contents	22

06 USB playback

Playing USB storage devices	23
Repeat play	23
Random play	23
Specify the folder to play	24
Switch the display contents	24
Playing in the desired order (Programmed Play)	25

07 Using the tuner

Listening to the radio broadcasts	25
-----------------------------------	----

Tuning	25
Saving station presets	25
To recall a memorised station	26
To scan the preset stations	26
To erase entire preset memory	26
Using the Radio Data System (RDS)	26
An introduction to RDS	26
Searching for RDS programs	26
Information provided by RDS	27
Using the Auto Station Program Memory (ASPM)	27
Notes for RDS operation	27
Listening to the DAB+	28
About DAB+ (Digital Audio Broadcasting)	28
Auto Scan	28
Selecting a station in the station list	28
Manual tune	28
Changing the information display	29
Memorising a station	29
DAB Frequency table (BAND III)	29

08 Other connections

Connecting auxiliary components	30
---------------------------------	----

09 Bluetooth® Audio playback

Music playback using Bluetooth wireless technology	31
Remote control operation	31
Pairing with the unit (Initial registration)	31
Listen to music on the unit from a Bluetooth capable device	32
BT STANDBY	32
Radio wave caution	33
Scope of operation	33
Radio wave reflections	33
Precautions regarding connections to products supported by this unit	33

10 Additional information

Troubleshooting	34
Playable discs and formats	36
Regarding copy protected CDs	36
Supported audio file formats	36
Cautions on use	37
When moving this unit	37
Place of installation	37
Do not place objects on this unit	37
About condensation	37
Cleaning the product	37
Cleaning the lens	37
Handling discs	37
Storing	37
Cleaning discs	37
About specially shaped discs	38
Auto power off setting	38
Restoring all the settings to the defaults	38
Specifications	39

Before you start

01

Chapter 1: Before you start

English

What's in the box

Please confirm that the following accessories are in the box when you open it.

- Remote Control
- AAA batteries (R03) x 2
- AM loop antenna (X-HM15 / HM15BT)
- FM wire antenna (X-HM15 / HM15BT)
- DAB/FM wire antenna (X-HM15 BTD)
- Power cord
- Warranty card
- Operating instructions (this document)

- Batteries may have different voltages, even if they are the same size and shape. Do not use different types of batteries together.
- To prevent leakage of battery fluid, remove the batteries if you do not plan to use the remote control for a long period of time (1 month or more). If the fluid should leak, wipe it carefully off the inside of the case, then insert new batteries. If a battery should leak and the fluid should get on your skin, flush it off with large quantities of water.
- When disposing of used batteries, please comply with governmental regulations or environmental public institution's rules that apply in your country/area.
- **WARNING**
Do not use or store batteries in direct sunlight or other excessively hot place, such as inside a car or near a heater. This can cause batteries to leak, overheat, explode or catch fire. It can also reduce the life or performance of batteries.

Loading the batteries in the remote control

- 1 Open the rear lid and load the batteries as illustrated below.

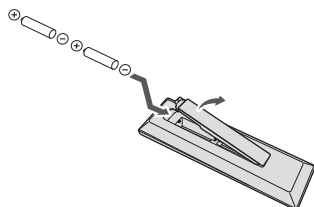

- 2 Close the rear lid.

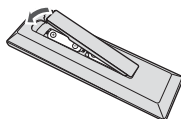

CAUTION

- When inserting the batteries, make sure not to damage the springs on the battery's * terminals. This can cause batteries to leak or over heat.
- Do not use any batteries other than the ones specified. Also, do not use a new battery together with an old one.
- When loading the batteries into the remote control, set them in the proper direction, as indicated by the polarity marks (+ and *).
- Do not heat batteries, disassemble them, or throw them into flames or water.

Using the remote control

The remote has a range of about 7 m at an angle of about 30° from the remote sensor.

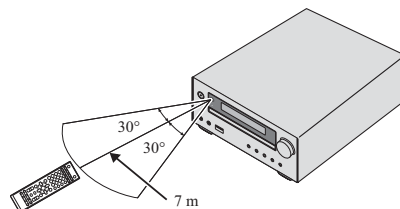

Keep in mind the following when using the remote control:

- Make sure that there are no obstacles between the remote and the remote sensor on the unit.
- Remote operation may become unreliable if strong sunlight or fluorescent light is shining on the unit's remote sensor.
- Remote controllers for different devices can interfere with each other. Avoid using remotes for other equipment located close to this unit.
- Replace the batteries when you notice a fall off in the operating range of the remote.

Chapter 2:

Part names and functions

Remote control

X-HM15 / HM15BT

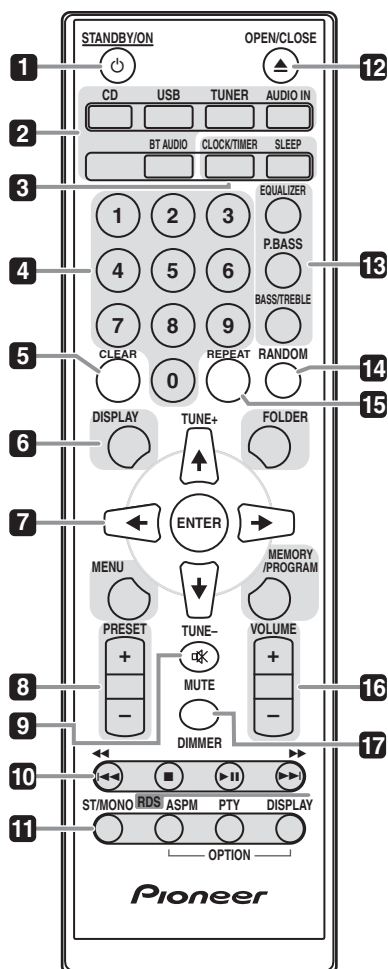

X-HM15BTD

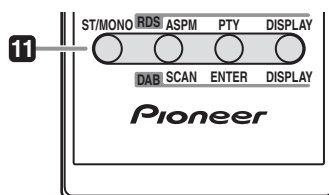
1 **STANDBY/ON**

Switches the receiver between standby and on (page 15).

2 **Input function buttons**

Use to select the input source to this receiver (page 19, 23, 25, 30).

BT AUDIO (X-HM15BT/HM15BTD only)Use to set up or play the audio file using the *Bluetooth* network (pages 31).3 **CD Receiver control buttons**
CLOCK/TIMER

Use for setting the clock, as well as for setting and checking the timers (page 15).

SLEEPSee *Using the sleep timer* on page 17.4 **Numeric buttons (0 to 9)**

Use to enter the number (page 20).

Part names and functions

02

5 CLEAR

Use to clear the programmed play (page 21).

6 CD Receiver control buttons

DISPLAY

Press to change the display for songs playing back from CD or USB (page 22).

FOLDER

Use to select the folder of the MP3/WMA disc or USB mass storage device (page 22).

MENU

Use to access the menu.

MEMORY/PROGRAM

Use to memory or program CD or the MP3/WMA disc or USB mass storage device (page 21).

7 ▲/▼/◀/▶ (TUNE +/-), ENTER

Use to select/switch system settings and modes, and to confirm actions.

Use **TUNE +/-** can be used to find radio frequencies (page 25).

8 PRESET +/-

Use to select preset radio stations (page 25).

9 MUTE

Mutes/unmutes the sound (page 16).

10 Playback control buttons

Use to control each function after you have selected it using the input function buttons (page 19).

11 Tuner control buttons

ST/MONO

Use to switch the sound mode between stereo and monaural. (page 25)

RDS ASPM

Use to search for RDS Auto station program memory (page 27).

RDS PTY

Use to search for RDS program types (page 26).

RDS DISPLAY

Press to change the RDS display for information mode (page 27).

DAB SCAN

Use to scan for DAB radio station (page 28).

DAB ENTER

Use to confirm the DAB radio station (page 28).

DAB DISPLAY

Press to change the DAB display for information mode (page 29).

12 OPEN/CLOSE

Use to open or close the disc tray (page 19).

13 Sound control buttons

Adjust the sound quality (page 16).

14 RANDOM

Randomize order of track playback from a CD or USB (page 20).

15 REPEAT

Press to change the repeat play setting from a CD or USB (page 20).

16 VOLUME control buttons

Use to set the listening volume (page 15).

17 DIMMER

Dims or brightens the display. The brightness can be controlled in four steps (page 15).

Speaker system

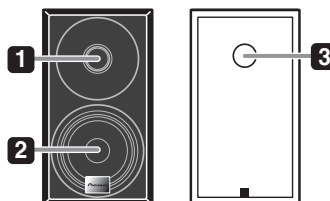

1 Tweeter

2 Woofer

3 Bass Reflex Duct

Important

- Speaker grille cannot be removed.

English

9

En

Front panel

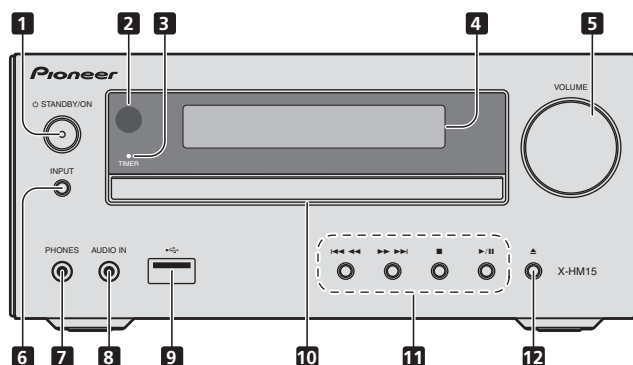
**1** **STANDBY/ON button**

Switches the receiver between standby and on (page 15).

2 **Remote sensor**

Receives the signals from the remote control.

3 **TIMER indicator**

Lights when the unit power is off but when the timer setting is activated.

4 **Character display**

See *Display* on page 10.

5 **Volume control**

Use to set the listening volume (page 15).

6 **INPUT button**

Selects the input source.

7 **Headphone socket**

Use to connect headphones. When the headphones are connected, there is no sound output from the speakers (page 18).

8 **AUDIO IN socket**

Use to connect an auxiliary component using a stereo minijack cable (page 30).

9 **USB terminal**

Use to connect your USB mass storage device as an audio source (page 23).

10 **Disc tray**

Place the disc, label side up (page 19).

11 **Playback control buttons**

Select the desired track or file to be played back. Stop current playback. Stop playback or resume playback from the point where it was paused.

12 **Disc tray open/close button**

Use to open or close the disc tray (page 19).

Display

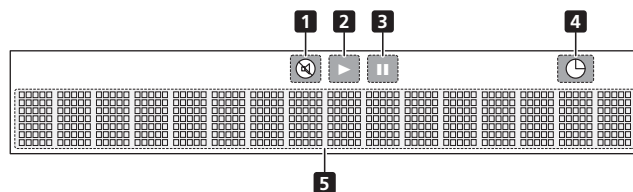

Part names and functions

02

1

Lights when the sound is muted.

Note

- The mute icon will be displayed in red.

2

Start playback.

3

Pause playback.

4

Timer function is set.

5 **Character display**

Displays various system information.

English

11

En

Chapter 3:

Connections

⚠ CAUTION

- Be sure to turn off the power and unplug the power cord from the power outlet whenever making or changing connections.
- Connect the power cord after all the connections between devices have been completed.

Speaker connection

- Push open the tabs and insert exposed wire.
- Connect the black wire to (–) terminal, and the red wire to the (+) terminal.

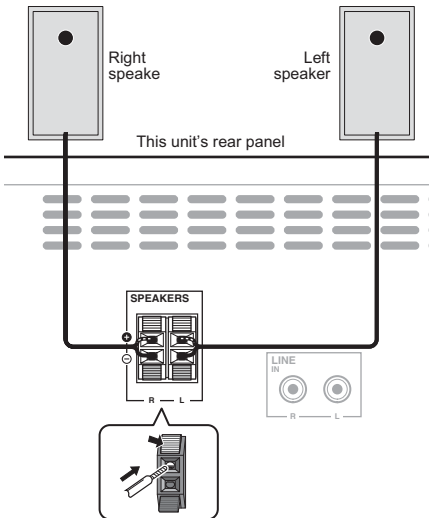
**⚠ CAUTION**

- These speaker terminals carry **HAZARDOUS LIVE voltage**. To prevent the risk of electric shock when connecting or disconnecting the speaker cables, disconnect the power cord before touching any uninsulated parts.
- Do not connect any speakers other than those supplied to this system.
- Do not connect the supplied speakers to any amplifier other than the one supplied with this system. Connection to any other amplifier may result in malfunction or fire.
- Do not attach these speakers to the wall or ceiling. They may fall off and cause injury.

- These speakers are magnetically shielded. However, depending on the installation location, color distortion may occur if the speaker system is installed extremely close to the screen of a television set. If this happens, turn off the television set, and then turn it on after 15 to 30 minutes. If the problem persists, move the speaker system away from the television set.
- Make sure that the speaker cable cores do not become exposed and make contact with other cable cores. This may cause malfunction of the product.
- Do not allow the speaker cable core to come into contact with the receiver body.



- If the speaker cable core comes into contact with any metal portion of the receiver's body, it may damage the speakers and cause smoke and fire.

Insert speaker cables securely into the terminals and check that the cable does not come out of easily.

📝 Note

- There is no difference between L and R speakers.

Connections

03

Connecting antennas

X-HM15/HM15BT

Connect the AM loop antenna and the FM wire antenna as shown below. To improve reception and sound quality, connect external antennas (see *Using external antennas* below).

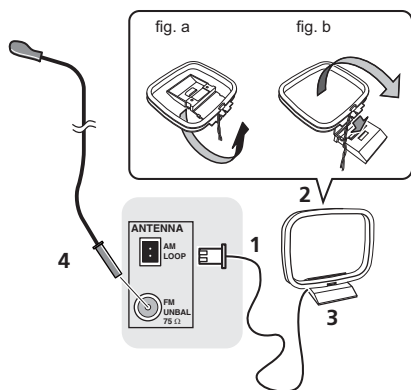

1 Connect the AM antenna wires.

Hold the terminal part of the wire when connecting.

2 Fix the AM loop antenna to the attached stand.

To fix the stand to the antenna, bend in the direction indicated by the arrow (fig. a) then clip the loop onto the stand (fig. b).

3 Place the AM antenna on a flat surface and in a direction giving the best reception.

4 Connect the FM wire antenna into the FM antenna socket.

For best results, extend the FM antenna fully and fix to a wall or door frame. Don't drape loosely or leave coiled up.

X-HM15BTD

Connect the DAB/FM wire antenna as shown below. To improve reception and sound quality, connect external antenna (see *Using external antennas* below).

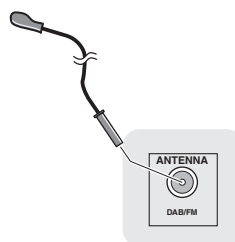

1 Connect the DAB/FM wire antenna into the DAB/FM antenna socket.

For best results, extend the DAB/FM antenna fully and fix to a wall or door frame. Don't drape loosely or leave coiled up.

Using external antennas

To improve FM reception

Use a PAL connector (not supplied) to connect an external FM antenna.

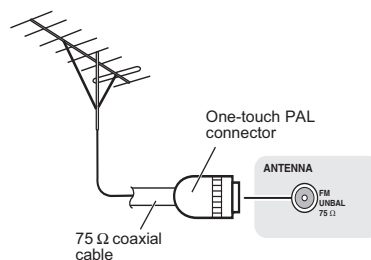

English

Plugging in

⚠ CAUTION

- Do not use any power cord other than the one supplied with this unit.
- Do not use the supplied power cord for any purpose other than that described below.

Before making or changing the connections, switch off the power and disconnect the power cord from the AC outlet.

After you've finished making all connections, plug the unit into an AC outlet.

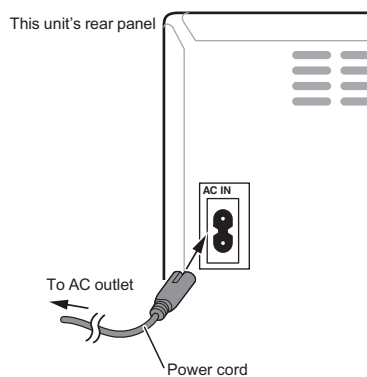

Chapter 4: Getting started

English

To turn the power on

Press the **STANDBY/ON** to turn the power on.

After use:

Press the **STANDBY/ON** to enter the power stand-by mode.

Note

- When power supply is restored after unit is plugged in again or after a power failure, reset the clock.

Setting the clock

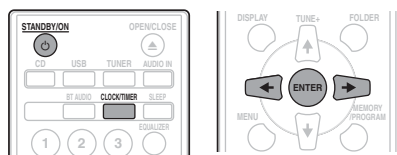

- Press **STANDBY/ON** to turn the power on.
- Press **CLOCK/TIMER** on the remote control. "CLOCK" is shown on the main display.
- Press **ENTER**.
- Press **←/→** to set the day, then press **ENTER**.
- Press **←/→** to set the hour, then press **ENTER**.
- Press **←/→** to set the minute, then press **ENTER** to confirm.
- Press **ENTER**.

To confirm the time display:

When the power is ON:

Press the **CLOCK/TIMER**. The time display will appear for about 10 seconds.

When it is on standby:

Press the **CLOCK/TIMER**. The time display will appear for about 10 seconds.

Press any button other than **STANDBY/ON** or **▲** on the unit. The time display will appear for about 10 seconds.

To readjust the clock:

Perform "Setting the clock" from step 1.

General control

Input function

When the **INPUT** on main unit is pressed, the current function will change to different mode. Press the **INPUT** repeatedly to select desired function.

X-HM15



X-HM15BT

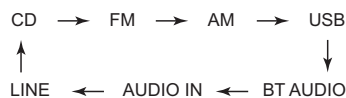

X-HM15BTD

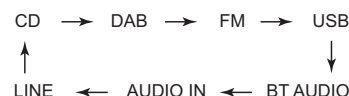

Display brightness control

Press **DIMMER** to dim the display brightness. The brightness can be controlled in four steps.

Volume auto set-in

If you turn off and on the main unit with the volume set to 31 or higher, the volume starts at 30 and sets in to the last set level.

Volume control

Turn the **VOLUME** on the unit or press **VOLUME +/-** on the remote control to increase or decrease the volume.

⚠ CAUTION

- The sound level at a given volume setting depends on speaker efficiency, location, and various other factors. It is advisable to avoid exposure to high volume levels. Do not turn the volume on to full at switch on. Listen to music at moderate levels. Excessive sound pressure from earphones and headphones can cause hearing loss.

Muting

The volume is muted temporarily when pressing the **MUTE** on the remote control. Press again to restore the volume.

Sound controls**Equalizer**

When the **EQUALIZER** is pressed, the current mode setting will be displayed. To change to a different mode, press the **EQUALIZER** repeatedly until the desired sound mode appears.

→	FLAT	A flat and basic sound.
	↓	
	ACTIVE	A powerful sound that emphasizes low and high tones.
	↓	
	DIALOGUE	A sound that allows the radio or vocals to be heard more easily.
	↓	
	NIGHT	A sound that can be enjoyed at night even with lower volume.

P.BASS control

When the power is first turned on, the unit will enter the P.bass mode which emphasises the bass frequencies. To cancel the P.bass mode, press the **P.BASS** on the remote control.

Bass/treble control

Press the **BASS/TREBLE**, then press **◀/▶** to adjust the bass or treble.

📌 Note

- The **EQUALIZER** and **P.BASS** cannot operate simultaneously. The most recently selected of these two functions will be the one used.
- BASS/TREBLE** can operate alongside either the **EQUALIZER** or **P.BASS**.

When one of the above two functions is selected, the function that is not selected will be displayed as follows.

- When P.BASS setting (ON/OFF) is changed**
 - EQUALIZER** : FLAT
- When EQUALIZER setting is changed**
 - P.BASS** : OFF

Getting started

04

Setting the wake-up timer

Used to change the existing timer setting, or to set a new timer.

- 1 Press **⏻** STANDBY/ON to turn the power on.
- 2 Press and hold **CLOCK/TIMER** on the remote control.
- 3 Press **←/→** to select "ONCE" or "DAILY", then press **ENTER**.
 - ONCE – Works once only at a preset time.
 - DAILY – Works at the preset time on a preset day.
- 4 Press **←/→** to select "TIMER SET", then press **ENTER**.
- 5 Press **←/→** to select the timer playback source, then press **ENTER**.
 - X-HM15/HM15BT : CD, FM, AM and USB can be selected as the playback source.
 - X-HM15BTD : CD, DAB, FM and USB can be selected as the playback source.
- 6 Press **←/→** to select the timer day, then press **ENTER**.
- 7 Press **←/→** to set the hour, then press **ENTER**.
- 8 Press **←/→** to set the minute, then press **ENTER**.
 - Set the time to finish as in steps 7 and 8 above.
- 9 Adjust the volume press **VOLUME +/-**, then press **ENTER**.
- 10 Press **⏻** STANDBY/ON to enter the power standby mode.
 - The **TIMER** indicator lights up.

Calling the wake-up timer

An existing timer setting can be reused.

- 1 As well as steps 1 to 3 in "Setting the wake-up timer".
- 2 Press **←/→** to select "TIMER ON", then press **ENTER**.

Cancelling the wake-up timer

Turn off the timer setting.

- 1 As well as steps 1 to 3 in "Setting the wake-up timer".
- 2 Press **←/→** to select "TIMER OFF", then press **ENTER**.

Using the wake-up timer

- 1 Press **⏻** STANDBY/ON to turn the power off.
- 2 At the wake-up time, this unit will turn on automatically and play the selected input function.

Note

- Some discs may not be played automatically at the wake-up time.
- When setting the timer set at least one minute between the start and end time.

Using the sleep timer

The sleep timer switches off the unit after a specified time so you can fall asleep without worrying about it.

- 1 Press **SLEEP** repeatedly to select a switch off time.

Choose between 10 min, 20 min, 30 min, 60 min, 90 min, 120 min, 150 min, 180 min or OFF. The newly set value displays for 3 seconds, and then the setting is completed.

Note

- The sleep timer can be set by pressing **SLEEP** while the remaining time is displayed.

English

17

En

Using Headphones

Connect to the jack plug of the headphones.

When the headphones are connected, there is no sound output from the speakers.

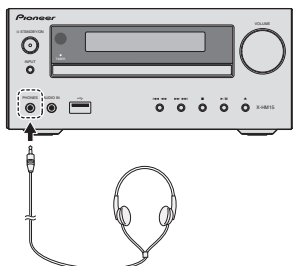

- Do not turn the volume on to full at switch on and listen to music at moderate levels. Excessive sound pressure from earphones and headphones can cause hearing loss.
- Before plugging in or unplugging the headphone, reduce the volume.
- Be sure your headphone has a 3.5 mm diameter plug and impedance between 16 Ω and 50 Ω . The recommended impedance is 32 Ω .

Disc playback

05

English

Chapter 5:

Disc playback

This system can play back a standard CD, CD-R/RW in the CD format and CD-R/RW with MP3 or WMA files, but cannot record on them. Some audio CD-R and CD-RW discs may not be playable due to the state of the disc or the device that was used for recording.

MP3:

MP3 is a form of compression. It is an acronym which stands for MPEG Audio Layer 3. MP3 is a type of audio code which is processed by significant compression from the original audio source with very little loss in sound quality.

- This system supports MPEG-1/2 Audio Layer 3 (Sampling rates: 8 kHz to 48 kHz; Bit rates: 32 kbps to 320 kbps).
- During VBR file playback, time counter in the display may differ from its actual playback time.

WMA:

WMA (Windows Media Audio) files are Advanced System Format files that include audio files which are compressed with Windows Media Audio codec. WMA is developed by Microsoft as an audio format file for Windows Media Player.

- This system supports WMA (Sampling rates: 32 kHz/44.1 kHz/48 kHz; Bit rates: 64 kbps to 320 kbps).
- During VBR file playback, time counter in the display may differ from its actual playback time.

CAUTION

- Do not place two discs in one disc tray.
- Do not play discs of special shapes (heart, octagon, etc). It may cause malfunctions.
- Do not push the disc tray whilst it is moving.
- If the power fails whilst the tray is open, wait until the power is restored.
- Be sure to place 8 cm disc in the middle of the disc tray.

Note

- Due to the structure of the disc information, it takes longer to read an MP3/WMA disc than a normal CD (approximately 20 to 90 seconds).
- When the beginning of the first track is reached during fast reverse, the unit will enter the playback mode (only for CD).
- Rewritable multi-session discs with unfinished writing, can still be played.
- If TV or radio interference occurs during CD operation, move the unit away from the TV or radio.

Tip

- When no operation has done in CD mode and the audio file is not played for more than 20 minutes, the power will automatically turn off. In this case it is required that the Auto power off is switched to **ON**.
- Auto power off can be switched to **ON/OFF** (page 38).

Playing discs or files

- 1 Press **⏻** STANDBY/ON to turn the power on.
- 2 Press **CD** on the remote control or **INPUT** repeatedly on the main unit to select CD input.
- 3 Press **▲** OPEN/CLOSE to open the disc tray.
- 4 Place the disc on the disc tray, label side up.



- 5 Press **▲** OPEN/CLOSE to close the disc tray.

- 6 Press **▶||** to start playback.

After the last track is played, the unit will stop automatically.

Various disc functions

Function	Main unit	Remote control	Operation
Play			Press in the stop mode.
Stop			Press in the playback mode.
Pause			Press in the playback mode. Press de to resume playback from the paused point.
Track up/down			Press in the playback or stop mode. If you press the button in the stop mode, press de to start the desired track.
Fast forward/reverse			Press and hold down in the playback mode. Release the button to resume playback.

Advanced CD or MP3/WMA disc playback

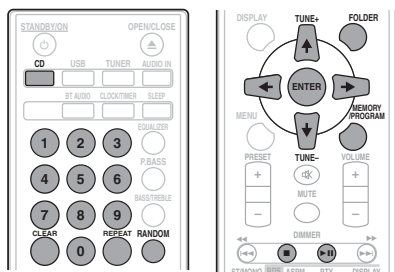

Direct track search

By using the numeric buttons, the desired tracks on the current disc can be played.

Use the numeric buttons on the remote control to select the desired track whilst playing the selected disc.

Note

- A track number higher than the number of tracks on the disc cannot be selected.

To stop playback:

Press ■.

Repeat play

Repeat play can play one track, all tracks or a programmed sequence continuously.

To repeat one track:

Press **REPEAT** repeatedly until "REPEAT ONE" appears. Press **ENTER**.

To repeat all tracks:

Press **REPEAT** repeatedly until "REPEAT ALL" appears. Press **ENTER**.

To repeat desired tracks:

Perform steps 1 to 5 in "Programmed play (CD or MP3/WMA)" section on next page and then press **REPEAT** repeatedly until "REPEAT ALL" appears. Press **ENTER**.

To cancel repeat play:

Press **REPEAT** repeatedly until "REPEAT OFF" appears. Press **ENTER**.

Note

- After performing repeat play, be sure to press ■. Otherwise, the disc will play continuously.
- During repeat play, random play is not possible.

Random play

The tracks on the disc can be played in random order automatically.

To random play all tracks:

Press **RANDOM** repeatedly until "RANDOM ON" appears. Press **ENTER**.

To cancel random play:

Press **RANDOM** repeatedly until "RANDOM OFF" appears. Press **ENTER**.

Note

- In random play, the unit will select and play tracks automatically. (You cannot select the order of the tracks.)
- During random play, repeat play is not possible.

Disc playback

05

English

Programmed play (CD or MP3/WMA)

You can choose up to 32 selections for playback in the order you like.

- 1 Whilst in the stop mode, press **MEMORY/PROGRAM** on the remote control to enter the programming save mode.
- 2 Press **◀▶** or the numeric buttons on the remote control to select the desired tracks.
- 3 Press **ENTER** to save folder and track number.
- 4 Repeat steps 2 to 3 for other folder/tracks. Up to 32 tracks can be programmed.
 - If you want to check the programmed tracks, press **MEMORY/PROGRAM**.
 - If you make a mistake, the last programmed tracks will be canceled by pressing **CLEAR**.
- 5 Press **▶||** to start playback.

To cancel the programmed play mode:

To cancel the programmed play, press **■** twice on the remote control. The display will show "PRG CLEAR" and all the programmed content will be cleared.

Adding tracks to the program:

Press the **MEMORY/PROGRAM**. Then follow steps 2 to 3 to add tracks.

Note

- When a disc is ejected, anything programmed is cleared.
- If you press the **⏻** **STANDBY/ON** to enter the standby mode or change the function from **CD** to another, the programmed selections will be cleared.
- During the program operation, random play is not possible.

About downloading MP3/WMA

There are many music sites on the internet that you can download MP3/WMA music files. Follow the instructions from the website on how to download the music files. You can then play back these downloaded music files by burning them to a CD-R/RW disc.

- Your downloaded song/files are for personal use only. Any other usage of the song without owner's permission, is against the law.

About folder playback order

If MP3/WMA files are recorded in several folders, a folder number will be set to each folder automatically.

These folders can be selected by the **FOLDER** on the remote control. If there is no supported file formats inside the selected folder, the folder is skipped and the next folder will be selected.

Example: How the folder numbers are assigned if MP3/WMA format files are recorded are as shown below.

- 1 **ROOT folder is set as FOLDER 1.**
- 2 **As for folders inside ROOT folder (FOLDER A and FOLDER B), the folder which is recorded earlier on the disc will be set as FOLDER 2 and FOLDER 3.**
- 3 **As for folder inside FOLDER A (FOLDER C and FOLDER D), the folder which is recorded earlier on the disc will be set as FOLDER 4 and FOLDER 5.**
- 4 **FOLDER E that is inside FOLDER D will be set as FOLDER 6.**

- The folder and file order information which is recorded on the disc depends on the writing software. There maybe possibilities that this unit will playback the files not according to our expected playback order.
- From a disc with MP3/WMA files up to 255 folders and 999 files (including non playable files) can be read.

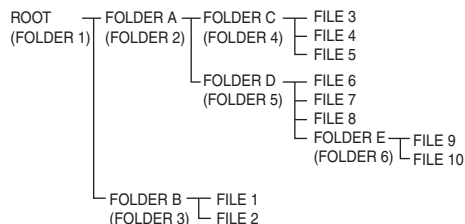

Specify the folder to play

To specify the folder to play, do the following steps.

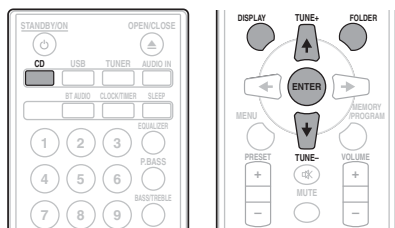

1 Press CD, and load an MP3/WMA disc.

2 Press FOLDER, and press \uparrow/\downarrow to select desired playback folder.

3 Press ENTER.

Playback will start from the first song of the selected folder.

- Even if it is stopped, it is possible to press \uparrow/\downarrow , to select a folder.

Switch the display contents**1 Press DISPLAY.**

If the title, artist and album name has been written to the file, that information will be displayed. (You can view this unit is only alphanumeric characters. Non-alphanumeric character are displayed in the "**".)

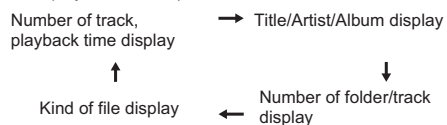
**Note**

- "Copyright protected WMA files" or "Not supported playback file" cannot be played back. In these case the files will be skipped automatically.
- There may be cases where no information can be displayed.
- Displaying title, artist and album name is only supported for MP3 files.

USB playback

06

Chapter 6:

USB playback

English

Playing USB storage devices

It is possible to listen to two-channel audio using the USB interface on the front of this receiver.

- Pioneer does not guarantee that any file recorded on a USB storage device will play or that power will be supplied to a USB storage device. Also note that Pioneer will accept no responsibility whatsoever for loss of files on USB storage devices caused by connection to this unit.

1 Press USB as the input source.

"USB" is shown on the main display.

2 Connect the USB storage device.

The number of folders or files stored on the connected USB storage device appear on the main display automatically.

- This receiver does not support a USB hub.

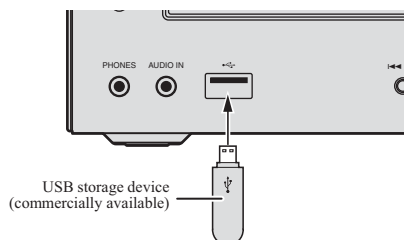

3 When the recognition is completed, press **▶||** to start playback.

When changing to a different input source, stop the USB memory playback first before changing.

4 Disconnect USB storage device from the USB terminal.

Turn the power off before removing the USB storage device.

Note

- This unit may not recognize a USB storage device, play files or supply power to a USB storage device. For details, see *When a USB storage device is connected* on page 35.
- When a USB storage device is not playing and the unit has not been operated for 20 minutes or more, the power will automatically turn off. In this case it is required that the Auto power off is switched to **ON** (page 38).

Repeat play

Repeat play can play one track, all tracks or a programmed sequence continuously.

To repeat one track:

Press **REPEAT** repeatedly until "REPEAT ONE" appears. Press **ENTER**.

To repeat all tracks:

Press **REPEAT** repeatedly until "REPEAT ALL" appears. Press **ENTER**.

To repeat desired tracks:

Perform steps 1 to 5 in "Programmed play (CD or MP3/WMA)" section on next page and then press **REPEAT** repeatedly until "REPEAT ALL" appears. Press **ENTER**.

To cancel repeat play:

Press **REPEAT** repeatedly until "REPEAT OFF" appears. Press **ENTER**.

Note

- After performing repeat play, be sure to press **■**. Otherwise, the file of USB storage device will play continuously.
- During repeat play, random play is not possible.

Random play

The file of USB storage device can be played in random order automatically.

To random play all tracks:

Press **RANDOM** repeatedly until "RANDOM ON" appears. Press **ENTER**.

To cancel random play:

Press **RANDOM** repeatedly until "RANDOM OFF" appears. Press **ENTER**.

Note

- In random play, the unit will select and play tracks automatically. (You cannot select the order of the tracks.)
- During random play, repeat play is not possible.

23

En

Specify the folder to play

To specify the folder to play, do the following steps.

- 1 Press **USB**, and connect the USB storage device.
- 2 Press **FOLDER**, and press **▲/▼** to select desired playback folder.
- 3 Press **ENTER**.

Playback will start from the first song of the selected folder.

- In case of stop, press **▲/▼**, and the folder can be selected.

Switch the display contents

The unit can display the information recorded in the USB storage device. For details, see *Switch the display contents* on page 22.

Playing in the desired order (Programmed Play)

- This unit can play repeatedly folders stored in the USB storage device.
- From a USB storage device with MP3/WMA files up to 255 folders and 999 files (including non playable files) can be read.

Using the tuner

07

Chapter 7:

Using the tuner

English

Listening to the radio broadcasts

The following steps show you how to tune in to FM and AM (X-HM15/HM15BT) radio broadcasts using the automatic (search) and manual (step) tuning functions. Once you are tuned to a station you can memorize the frequency for recall later. See *Saving station presets* below for more on how to do this.

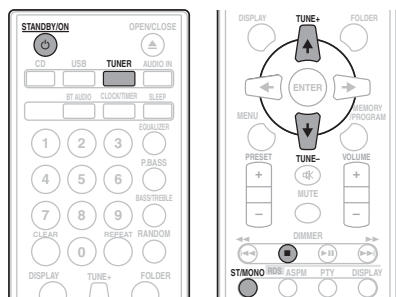

Tuning

- 1 Press the **STANDBY/ON** to turn the power on.
- 2 Press **TUNER** repeatedly to select desired frequency band (**FM** or **AM**).
- 3 Press **TUNE +/-** on the remote control to tune in to the desired station.

Automatic tuning:

Press and hold **TUNE +/-**, scanning will start automatically and the tuner will stop at the first receivable broadcast station.

Manual tuning:

Press the **TUNE +/-** repeatedly to tune in to the desired station.

Note

- When radio interference occurs, automatic tuning may stop automatically at that point.
- Automatic tuning will skip weak signal stations.
- To stop the automatic tuning, press **■**.
- When an RDS (Radio Data System) station is tuned in, the frequency will be displayed first. Finally, the station name will appear.

- Full auto tuning can be achieved for RDS stations using Auto Station Program Memory (ASPM) mode, see page 27.

To receive an FM stereo transmission:

Press **ST/MONO** to select stereo mode and "AUTO" will be displayed.

Improving poor FM reception:

- 1 Press **ST/MONO** repeatedly to select **MONO**.

This will change the tuner from stereo to mono and usually improve the reception.

Saving station presets

If you often listen to a particular radio station, it's convenient to have the receiver store the frequency for easy recall whenever you want to listen to that station (Preset tuning). This saves the effort of manually tuning in each time. This unit can memorize up to 45 stations.

(X-HM15/HM15BT : FM 30 stations/AM 15 stations,
X-HM15BTD : FM 30 stations/DAB 10 stations)

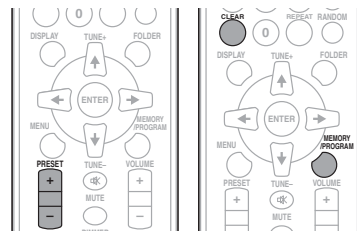

- 1 Tune to a station you want to memorize.

See *Tuning* above for more on this.

- 2 Press **MEMORY/PROGRAM**.

The preset number will flash.

- 3 Press **PRESET +/-** to select the preset channel number.

- 4 Press **MEMORY/PROGRAM** to store that station in memory.

If the preset number has changed from flashing to lighting, before the station is memorised, repeat the operation from step 2.

- Repeat steps 1 to 4 to set other stations, or to change a preset station. When a new station is stored in the memory, the station previously memorised for that preset channel number will be erased.

Note

- The backup function protects the memorised stations for a few hours should there be a power failure or the AC power cord become disconnected.

How to recall a memorised station

1 Press PRESET +/- to select the desired station.

How to scan the preset stations

The stations saved in the memory can be scanned automatically. (Preset memory scan)

1 Press and hold PRESET +/-.

The preset number will appear and the programmed stations will be tuned in sequentially, for 5 seconds each.

2 Press PRESET +/- again when the desired station is located.

How to erase entire preset memory

1 Press TUNER on the remote control.

2 Press CLEAR until "MEMORY CLEAR" appears.

Note

- All stations will be erased.

Using the Radio Data System (RDS)**An introduction to RDS**

Radio Data System (RDS) is a system used by most FM radio stations to provide listeners with various kinds of information—the name of the station and the kind of show they're broadcasting, for example.

One feature of RDS is that you can search by type of program. For example, you can search for a station that's broadcasting a show with the program type, **JAZZ**.

You can search the following program types:

News – News
Current Affairs – Current Affairs
Information – General Information
Sport – Sport
Education – Educational
Drama – Radio plays, etc.
Cultures – National or regional culture, theater, etc.
Science – Science and technology
Varied Speech – Usually talk-based material, such as quiz shows or interviews.
Pop Music – Pop music
Rock Music – Rock music
Easy Listening – Easy listening
Light Classics M – 'Light' classical music
Serious Classics – 'Serious' classical music
Other Music – Music not fitting above categories
Weather & Metr – Weather reports

Finance – Stock market reports, commerce, trading, etc.
Children's Progs – Programs for children
Social Affairs – Social affairs
Religion – Programs concerning religion
Phone In – Public expressing their views by Phone
Travel & Touring – Holiday-type travel rather than traffic announcements
Leisure & Hobby – Leisure interests and hobbies
Jazz Music – Jazz
Country Music – Country music
National Music – Popular music in a language other than English
Oldies Music – Popular music from the '50s and '60s
Folk Music – Folk music
Documentary – Documentary
Alarm Test – Broadcasting when testing emergency broadcast equipment or receivers.

Searching for RDS programs

You can search a program type listed above.

1 Press TUNER on the remote control.

RDS is only possible in the FM.

2 Press RDS PTY on the remote control.

"SELECT" will appear for about 6 seconds.

3 Press Δ / to select the program type you want to hear.

Each time the button is pressed, the program type will appear. If the button is held down, the program type will appear continuously.

4 Whilst the selected program type is displayed (within 6 seconds), Press RDS PTY again.

After the selected program type has been lit for 2 seconds, "SEARCH" will appear, and the search operation will start.

Note

- If the display has stopped flashing, start again from step 2. If the unit finds a desired program type, the corresponding channel number will be lit for about 8 seconds, and then the station name will be displayed.

Using the tuner

07

- If you want to listen to the same program type of another station, press the **RDS PTY** whilst the channel number or station name is flashing. The unit will look for the next station.
- If no station can be found, "NOT FOUND" will appear for 4 seconds.

Information provided by RDS

Each time the **RDS DISPLAY** is pressed, the display will switch as follows:

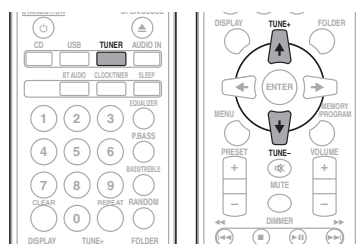

When tuning in to a station other than an RDS station or to an RDS station which sends weak signal, the display will change in the following order:

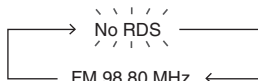

Using the Auto Station Program Memory (ASPM)

Whilst in the ASPM operation mode, the tuner will automatically search for new RDS stations. Up to 30 stations can be stored.

If you have already stored some stations in memory, the number of new stations you can store will be less.

1 Press TUNER on the remote control.

2 Press and hold down RDS ASPM on the remote control.

After "ASPM" has flashed for about 4 seconds, scanning will start (87.5 MHz to 108 MHz).

After scanning, the number of stations stored in memory will be displayed for 4 seconds, and then "END" will appear for 4 seconds.

To stop the ASPM operation before it is complete:

Press **■** whilst it is scanning for stations. The stations which are already stored in memory will be kept there.

Note

- If the same station is broadcasting on different frequencies, the strongest frequency will be stored in memory.
- Any station which has the same frequency as the one stored in memory will not be stored.
- If 30 stations have already been stored in memory, the scan will be aborted. If you want to redo the ASPM operation, erase the preset memory.
- If no station have been stored in memory, "END" will appear for about 4 seconds.
- If the RDS signals are very weak, station names may not be stored in memory.
- The same station name can be stored in different channels.
- In a certain area or during certain time periods, the station names may temporarily be different.

Notes for RDS operation

If any of the following events occur, it does not mean that the unit is faulty:

- "PS", "NO PS" and a station name appear alternately, and properly.
- If a particular station is not broadcasting properly or a station is conducting tests, the RDS reception function may not work properly.
- When you receive an RDS station whose signal is too weak, information like the station name may not be displayed.
- "NO PS", "NO PTY" or "NO RT" will flash for about 5 seconds, and then the frequency will be displayed.

Notes for radio text:

- The first 16 characters of the radio text will appear and then they will scroll across the display.
- If you tune in to an RDS station which is not broadcasting any radio text, "NO RT" will be displayed when you switch to the radio text position.
- Whilst radio text data is received or when the text contents change, "RT" will be displayed.

English

27

En

Listening to the DAB+

X-HM15BTD only

About DAB+ (Digital Audio Broadcasting)

Digital Audio Broadcasting is a digital transmission system where audio signals are converted to digital signals for broadcasting. DAB+ is broadcast as a group of data called multiplex (ensemble) which may contain one or more stations (services). Each station contains a primary service and there may be one or more secondary services. This allows several programmes or services to be transmitted on a single frequency.

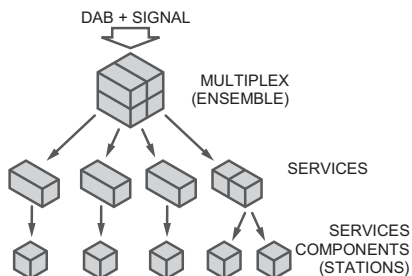

Auto Scan

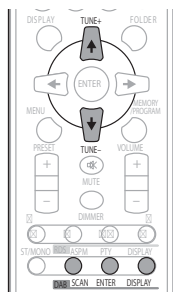

When turned on for the first time, the unit scans radio stations automatically to create a station list. You can make the auto scan again when you move the unit to other areas or add multiplex channels to the station list.

1 Press the TUNER until “DAB” appears on the display.

2 Press DAB SCAN on the remote control for more than 3 seconds.

Auto Scan scanning begins.

After the scan:

The stations will be stored in alphanumeric order and the first station on the list will be selected and you will hear it through the speakers.

- To listen to other stations, see *Selecting a station in the station list* below.

Note

- If no station is found, “NO SIGNAL” appears.
- Up to 100 appears for total received stations.

Selecting a station in the station list

Once a DAB+ station is received, you can select stations in the station list.

1 Press the TUNER until “DAB” appears on the display.

2 Whilst receiving a DAB+ station, press the TUNE +/- to select the desired station.

3 Within 10 seconds, press the DAB ENTER on the remote control to tune into the desired station.

Manual tune

You can manually store stations which Auto Scan cannot find. If reception is poor, you can adjust the sensitivity. Manual tune is only available after Auto tune. Perform Auto Scan first.

1 Press the TUNER until “DAB” appears on the display.

2 Press the DAB SCAN once.

3 Within 10 seconds, press the TUNE +/- to select the DAB+ frequency.

4 Within 10 seconds, press the DAB ENTER.

- If the level is too low, move the aerial or unit to improve reception.

Using the tuner

07

Changing the information display

You can switch DAB+ display information.

Press the **DAB DISPLAY** button.

Each time the button is pressed, the information display changes in the following order.

When "NO SIGNAL" appears, the **DAB DISPLAY** button does not allow you to change the display.

[Station Name]

Station name is displayed. (set by default)

[Scrolling text]

Information scrolls across the display when sent from the station.

[Programme type]

A description of the type of content being broadcast by the station.

[Multiplex name]

The name of the multiplex (ensemble) which provides the current service.

[Frequency]

The DAB+ frequency for the station.

[Stereo mode]

Display stereo mode.

[Transfer speed]

The data transfer speed.

[Signal quality]

The signal quality is displayed as a number (0 - 100).

[85-100: Good, 70-84: Fair, 0-69: Poor]

Memorising a station

You can store 10 DAB stations in memory and recall them at the push of a button. (Preset tuning)

1 Tune to the desired DAB station.

2 Press the MEMORY/PROGRAM.

The preset number will flash.

3 Within 10 seconds, press the PRESET +/- to select the preset channel number.

Store the stations in memory, in order, starting with preset channel 1.

4 Within 10 seconds, press the MEMORY/PROGRAM to store that station in memory.

If the preset number indicators disappear before the station is memorised, repeat the operation from step 2.

5 Repeat steps 1 - 4 to set other stations, or to change a preset station.

When a new station is stored in the memory, the station previously memorised for that preset channel number will be erased.

DAB Frequency table (BAND III)

Frequency	Label	Frequency	Label
174.928 MHz	5A	208.064 MHz	9D
176.640 MHz	5B	209.936 MHz	10A
178.352 MHz	5C	211.648 MHz	10B
180.064 MHz	5D	213.360 MHz	10C
181.936 MHz	6A	215.072 MHz	10D
183.648 MHz	6B	216.928 MHz	11A
185.360 MHz	6C	218.640 MHz	11B
187.072 MHz	6D	220.352 MHz	11C
188.928 MHz	7A	222.064 MHz	11D
190.640 MHz	7B	223.936 MHz	12A
192.352 MHz	7C	225.648 MHz	12B
194.064 MHz	7D	227.360 MHz	12C
195.936 MHz	8A	229.072 MHz	12D
197.648 MHz	8B	230.784 MHz	13A
199.360 MHz	8C	232.496 MHz	13B
201.072 MHz	8D	234.208 MHz	13C
202.928 MHz	9A	235.776 MHz	13D
204.640 MHz	9B	237.488 MHz	13E
206.352 MHz	9C	239.200 MHz	13F

English

Chapter 8:

Other connections

⚠ CAUTION

- Before making or changing the connections, switch off the power and disconnect the power cord from the AC outlet.

Connecting auxiliary components

Connect the front panel **AUDIO IN** mini-plug jack to your auxiliary playback component.

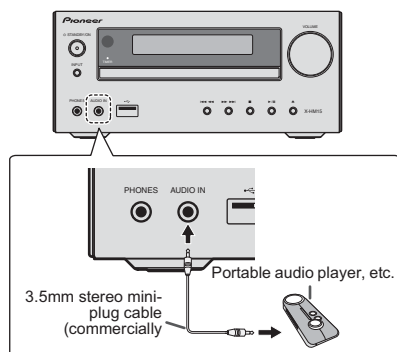
**1 Press AUDIO IN as the input source.**

When **AUDIO IN** is selected "AUDIO IN" will be displayed on the main display.

Note

- If the **AUDIO IN** mini-plug jack is connected to auxiliary phones jack, the volume of the unit will be adjusted by the volume on the playback component. If the sound is distorted after you lower the volume of the unit, try lowering the volume on the auxiliary playback component.

Connect the rear panel **LINE IN** audio jacks to your auxiliary playback component.

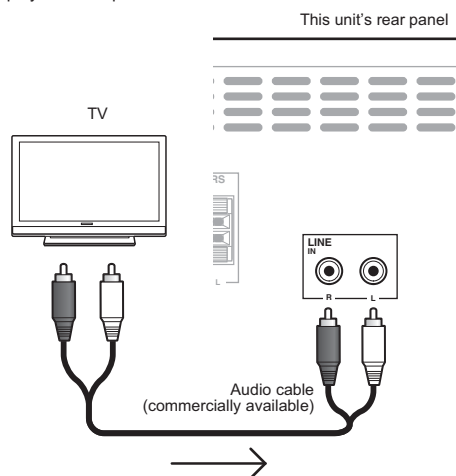
**1 Press AUDIO IN twice as the input source.**

When is selected "LINE" will be displayed on the main display.

Bluetooth® Audio playback

09

Chapter 9:

Bluetooth® Audio playback

X-HM15BT/HM15BTD only

English

Music playback using *Bluetooth* wireless technology

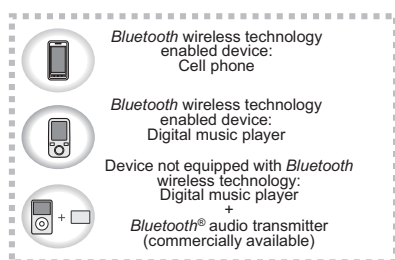

The unit is capable of playing back music stored on *Bluetooth* capable devices (cell phones, digital music players etc.) wirelessly. You can also use a *Bluetooth* audio transmitter (sold separately) to enjoy music from devices that do not have *Bluetooth* functionality. Please refer to the user's manual for your *Bluetooth* capable device for more details.

Note

- The *Bluetooth*® word mark and logos are registered trademarks owned by Bluetooth SIG, Inc. and any use of such marks by Onkyo Corporation is under license. Other trademarks and trade names are those of their respective owners.
- The *Bluetooth* wireless technology enabled device must support A2DP profiles.
- Onkyo does not guarantee proper connection and operation of this unit with all *Bluetooth* wireless technology enabled devices.

Remote control operation

The remote control supplied with this unit allows you to play and stop media, and perform other operations.

Note

- The *Bluetooth* wireless technology enabled device must support AVRCP profiles.
- Remote control operations cannot be guaranteed for all *Bluetooth* wireless technology enabled devices.

Pairing with the unit (Initial registration)

In order for the unit to playback music stored on a *Bluetooth* capable device, pairing must first be performed. Pairing should be performed when first using the unit with the *Bluetooth* capable device, or when the pairing data on the device has been erased for any reason.

Pairing is a step required to allow communication using *Bluetooth* wireless technology to be carried out.

- Pairing is only performed the first time that you use the unit and the *Bluetooth* capable device together.
- In order to allow communication using *Bluetooth* wireless technology to take place, pairing must be performed on both the unit and the *Bluetooth* capable device.
- After pressing the **BT AUDIO** and switching to **BT AUDIO** input, perform the pairing procedure on the *Bluetooth* capable device. If pairing has been performed correctly, you will not need to perform the pairing procedures for the unit as shown below.

Please refer to the user's manual for your *Bluetooth* capable device for more details.

1 Press the **STANDBY/ON** and turn the power to the unit on.

2 Press the **BT AUDIO**.

The unit switches to **BT AUDIO** and "PAIRING" will be displayed.

3 Turn on the power to the *Bluetooth* capable device that you wish to pair with, and perform pairing procedure on it.

31

En

Note

- This unit will be displayed as "X-HM15" on all *Bluetooth* capable devices that you have. Pairing will start.

- Place the *Bluetooth* capable device close to the unit.
- Please refer to the user's manual for your *Bluetooth* capable device for details on when pairing can be performed and the procedures required for pairing.
- When PIN code entry is requested, enter "0000." (This unit does not accept any PIN code setting other than "0000.")

4 Confirm on the Bluetooth capable device that pairing has been completed.

If pairing with the *Bluetooth* capable device has been completed correctly, the name of the *Bluetooth* capable device will be displayed on the front panel of the unit. (Only single-byte alphanumeric characters can be displayed. Any character that cannot be displayed will be indicated by a "**".)

Listen to music on the unit from a Bluetooth capable device**1 Press the BT AUDIO.**

The unit will switch to **BT AUDIO** input.

2 A Bluetooth connection will be created between the Bluetooth capable device and the unit.

Procedures for connecting to the unit should be performed from the *Bluetooth* capable device.

- Please refer to the user's manual for your *Bluetooth* capable device for details of the connection procedures.

3 Playback music from the Bluetooth capable device.**Note**

- When *Bluetooth* capable device is not connected and no operations have been performed for more than 20 minutes, the unit will automatically power off. In this case it is required that the Auto power off is switched to **ON**.
- Auto power off can be switched to **ON/OFF** (page 38).

BT STANDBY

- The following can be done when the unit is on standby with the **BT STANDBY** switched **ON**.
- By selecting a *Bluetooth* capable device that already has a connection history (pairing has already been conducted) with this unit, this unit will automatically turn on with the **BT AUDIO** function.

BT STANDBY settings

- Switch **ON/OFF** by long pressing the **INPUT** button located on the unit for 3 seconds.
- When the power is **ON**, long press the **INPUT** button. This cannot be operated if the power is not on.
- The setting operation can only be performed by using the **INPUT** button on the unit. The setting cannot be performed using the remote control.

Note

- When the **BT STANDBY** is **ON**, "BT STANDBY ON" is displayed on the main display.
- When the **BT STANDBY** is **OFF**, "BT STANDBY OFF" is displayed on the main display.

Connection while in BT STANDBY mode with Bluetooth capable device

When connection history (pairing has already been conducted) with a *Bluetooth* capable device exists for the unit during **BT STANDBY**, the unit can receive a connection request directly from the connection history.

The unit will start using the **BT AUDIO** function, and connect with a *Bluetooth* capable device.

Even devices that have already been paired with this unit will not connect during **BT STANDBY** in the following cases.

In such cases, delete pairing history from the *Bluetooth* wireless technology device and perform pairing again.

- Up to 8 pairing history can be recorded with this unit. If connecting to a *Bluetooth* wireless technology device over 8 units, the oldest pairing history will be deleted.
- If the settings are reset to the factory setting, all pairing history will be deleted.

Bluetooth® Audio playback

09

English

Radio wave caution

This unit uses a 2.4 GHz radio wave frequency, which is a band used by other wireless systems (see list below). To prevent noise or interrupted communication, do not use this unit nearby such devices, or make sure these devices are switched off during use.

- Cordless phones
- Cordless facsimiles
- Microwave ovens
- Wireless LAN devices (IEEE802.11b/g)
- Wireless AV equipment
- Wireless controllers for game systems
- Microwave-based health aids
- Some baby monitors

Other, less common, equipment that may operate on the same frequency:

- Anti-theft systems
- Amateur radio stations (HAM)
- Warehouse logistic management systems
- Discrimination systems for train or emergency vehicles

Note

- In the event noise appears in your television image, there is the possibility that a *Bluetooth* wireless technology enabled device or this unit (including products supported by this unit) are causing signal interference with the antenna input connector of your television, video, satellite tuner, etc. In this event, increase the distance between the antenna input connector and the *Bluetooth* wireless technology enabled device or this unit (including products supported by this unit).
- If there is something obstructing the path between this unit (including devices supported by this unit) and the device equipped with *Bluetooth* wireless technology (such as a metal door, concrete wall, or insulation containing tinfoil), you may need to change the location of your system to prevent signal noise and interruptions.

Scope of operation

Use of this unit is limited to home use. (Transmission distances may be reduced depending on communication environment).

In the following locations, poor condition or inability to receive radio waves may cause the audio to be interrupted or stopped:

- In reinforced concrete buildings or steel framed or iron-framed buildings.
- Near large metallic furniture.
- In a crowd of people or near a building or obstacle.
- In a location exposed to the magnetic field, static electricity or radio wave interference from radio communication equipment using the same frequency band (2.4 GHz) as this unit, such as a 2.4 GHz wireless LAN device (IEEE802.11b/g) or microwave oven.

- If you live in a heavily populated residential area (apartment, townhouse, etc.) and if your neighbor's microwave is placed near your system, you may experience radio wave interference. If this occurs, move your unit to a different place. When the microwave is not in use, there will be no radio wave interference.

Radio wave reflections

The radio waves received by this unit include the radio wave coming directly from the device equipped with *Bluetooth* wireless technology (direct wave) and waves coming from various directions due to reflections by walls, furniture and building (reflected waves). The reflected waves (due to obstacles and reflecting objects) further produce a variety of reflected waves as well as variation in reception condition depending on locations. If the audio cannot be received properly due to this phenomenon, try moving the location of the device equipped with *Bluetooth* wireless technology a little. Also note that audio may be interrupted due to the reflected waves when a person crosses or approaches the space between this unit and the device equipped with *Bluetooth* wireless technology.

Precautions regarding connections to products supported by this unit

- Complete connections for all devices supported by this unit, including all audio cords and power cables before connecting them to this unit.
- After completing connections to this unit, check the audio and power cables to confirm that they not twisted together.
- When disconnecting this unit, confirm that you have sufficient working space in the surrounding area.
- When changing connections of audio or other cables for products supported by this unit, confirm that you have sufficient working space in the surrounding area.

33

En

Chapter 10:

Additional information

Troubleshooting

Incorrect operations are often mistaken for trouble and malfunctions. If you think that there is something wrong with this component, check the points below. Sometimes the trouble may lie in another component. Investigate the other components and electrical appliances being used. If the trouble cannot be rectified even after exercising the checks listed below, ask your nearest Pioneer authorized service center or your dealer to carry out repair work.

- If the unit does not operate normally due to external effects such as static electricity disconnect the power plug from the outlet and insert again to return to normal operating conditions.

General problem

Problem	Check	Remedy
Settings you have made have been cleared.	Was the power cord unplugged?	When power cord is unplugged, the settings you have made is cleared. Please set the clock again. If you do not want to clear the settings, do not unplug the power cord.
Difference in volume between CDs, MP3, WMA, Tuner, AUDIO IN and .	This is not a problem with this unit.	The volume may sound differently depending on the input source and recording format. When using an analogue player with this unit, connect a device equipped with phono equalizer.
This unit cannot be operated with the remote control.	Are you operating from far away?	Operate within 7 m, 30° of the remote sensor on the front panel (page 7).
	Is the remote control sensor exposed to direct sunlight or strong artificial light from a fluorescent bulb, etc.?	The remote control signals may not be received properly if the remote control sensor is exposed to direct sunlight or strong artificial light from a fluorescent bulb, etc.
	Are the batteries dead?	Replace the batteries (page 7).
Disc cannot be played or disc is ejected automatically.	Is the disc scratched?	Scratched discs may not play.
	Is the disc dirty?	Wipe the dirt off the disc (page 37).
	Is this unit placed in a humid location?	There could be condensation inside. Wait a while for the condensation to evaporate. Do not place this unit near an air-conditioner, etc. (page 37).
Folder or file names are not recognized (WMA, MP3).	Have you exceeded the maximum number of folder or file names this unit can recognize?	Up to 255 folders can be recognized on one disc. Up to 999 files can be recognized within one folder. Depending on the folder structure, however, this unit may not be able to recognize certain folders or files.
The unit turns off automatically.		If no play back and no operation has done for 20 minutes or more, the unit turns off automatically. In this case it is required that the Auto power off is switched to ON (page 38).

Additional information

10

English

When a USB storage device is connected

Problem	Check	Remedy
USB storage device is not recognized.	Is the USB storage device properly connected?	Connect the device securely (all the way in).
	Is the USB storage device connected via a USB hub?	This unit does not support USB hubs. Connect the USB storage device directly. This unit only supports USB mass storage class devices.
		This unit supports portable flash memory and digital audio playback devices.
		Only the FAT16 and FAT32 file systems are supported. Other file systems (exFAT, NTFS, HFS etc.) are not supported.
		This device does not support the use of external hard disc drives.
	This is not a problem with this unit.	Turn the power off then back on. Some USB storage devices may not be recognized properly.
File cannot be played.	Is the file copyright-protected (by DRM)?	Copyright-protected files cannot be played.
	This is not a problem with this unit.	Files stored on a computer cannot be played. It may not be possible to play some files.
Folder or file names are not displayed or are not properly displayed.	Do the folder or file names contain more than 30 characters?	The maximum number of characters displayable for the folder and file names is 30.
Folder or file names are not displayed in alphabetical order.	This is not a problem with this unit.	The order in which the folder and file names are displayed depends on the order in which the folders or files were recorded on the USB storage device.
Much time is required to recognize the USB storage device.	What is the USB storage devices capacity?	Some time may be required to load the data when large capacity USB storage devices are connected (this could take several minutes).
Power is not supplied to the USB storage device.	Is AUTH ERROR displayed on the front panel display? No power is supplied if the power consumption is too high.	Turn the power off then back on.
		Turn the power off, then disconnect and reconnect the USB storage device. Press INPUT to switch to the other mode, then switch again to the USB mode.

35

En

When the *Bluetooth* wireless technology device is connected or operated*X-HM15BT/HM15BTD only*

Problem	Remedy
The <i>Bluetooth</i> wireless technology device cannot be connected or operated. Sound from the <i>Bluetooth</i> wireless technology device is not emitted or the sound is interrupted.	Check that no object that emits electromagnetic waves in the 2.4 GHz band (microwave oven, wireless LAN device or <i>Bluetooth</i> wireless technology apparatus) is near the unit. If such an object is near the unit, set the unit far from it. Or, stop using the object emitting the electromagnetic waves.
	Check that the <i>Bluetooth</i> wireless technology device is not too far from the unit and that obstructions are not set between the <i>Bluetooth</i> wireless technology device and the unit. Set the <i>Bluetooth</i> wireless technology device and the unit so that the distance between them is less than about 10 m* and no obstructions exist between them.
	* The distance given is to be used as a rough guide. The actual allowable distance between devices may vary depending on conditions in the surrounding environment.
	The <i>Bluetooth</i> wireless technology device may not be set to the communication mode supporting the <i>Bluetooth</i> wireless technology. Check the setting of the <i>Bluetooth</i> wireless technology device.

Playable discs and formats

Audio CD	<ul style="list-style-type: none"> Commercially available audio CDs CD-R/ -RW/ -ROM discs containing music recorded in the CD-DA format
WMA	WMA files recorded on CD-R/ -RW/ -ROM discs or USB storage devices
MP3	MP3 files recorded on CD-R/ -RW/ -ROM discs or USB storage devices

- Only the discs that have been finalized can be played.
- Discs recorded in packet write mode (UDF format) are not compatible with this unit.
- Only discs recorded in ISO9660 Level 1, Level 2 and Joliet can be played.
- Files protected by DRM (Digital Rights Management) cannot be played.
- Corporation and product names mentioned herein are trademarks or registered trademarks of the respective corporations.

Regarding copy protected CDs

This unit is designed to conform to the specifications of the audio CD format. This unit does not support the playback or function of discs that do not conform to these specifications.

Supported audio file formats

- This unit does not support lossless encoding.

Note

- This unit does not support multisession discs or multiborder recording.
- Multisession/multiborder recording is a method in which data is recorded on a single disc in two or more sessions/borders. A "session" or "border" is one recording unit, consisting of a complete set of data from lead-in to lead-out.

Additional information

10

English

Cautions on use

When moving this unit

When moving this unit, be sure to first check that there is no disc loaded. Then press u (STANDBY/ON), wait for "STAND BY" disappears on main display to turn off, then unplug the power cord. Damage may occur if the unit is transported or moved with a disc inserted, or when another device is connected to the USB terminal or AUDIO IN mini-plug jack.

Place of installation

- Choose a stable place near the TV or stereo system being used with this unit.
- Do not place this unit on top of a TV or color monitor. Also install it away from cassette decks and other devices easily affected by magnetic forces.

Avoid the following locations:

- Places exposed to direct sunlight
- Humid or poorly ventilated places
- Extremely hot places
- Places exposed to vibrations
- Places in which there is much dust or cigarette smoke
- Places exposed to soot, steam or heat (kitchens, etc.)

Do not place objects on this unit

Do not place any objects on top of this unit.

Do not obstruct the ventilation holes.

Do not use this unit on shaggy rugs, beds, sofas, etc., or wrapped in cloth, etc. Doing so will prevent the heat from dispersing, leading to damage.

Do not expose to heat.

Do not place this unit on top of an amplifier or other component that generates heat. When rack mounting it, to avoid the heat given off by the amplifier or other audio component, place it on a shelf below the amplifier.

- Turn off the unit's power when not using it.
- Depending on signal conditions, striped patterns may appear on a TV screen and noise may enter the sound of radio broadcasts when the unit's power is on. If this happens, turn the unit's power off.

About condensation

If this unit is moved suddenly from a cold place into a warm room (in winter, for example) or if the temperature in the room in which this unit is installed rises suddenly due to heater operation, etc., water droplets (condensation) may form inside (on operating parts and the lens). When condensation is present, this unit will not operate properly and playback is not possible. Let this unit stand at room temperature for 1 or 2 hours with the power turned on (the time depends on the extent of condensation). The water droplets will dissipate and playback will become possible. Condensation can also occur in the summer if this unit is directly exposed to the air flow from an air-conditioner. If this happens, move this unit to a different place.

Cleaning the product

- Unplug the power cord from the power outlet when cleaning this unit.
- Clean this unit using a soft cloth. For tough dirt, apply some neutral detergent diluted in 5 to 6 parts water to a soft cloth, wring out thoroughly, wipe off the dirt, then wipe again with a soft, dry cloth.
- Alcohol, thinner, benzene, insecticides, etc., could cause the print or paint to peel off. Also, leaving rubber or vinyl products in contact with this unit for long periods of time could mar the cabinet.
- When using chemical-impregnated wipes, etc., read the cautions included with the wipes carefully.

Cleaning the lens

- This unit's lens should not become dirty in normal use, but if for some reason it should malfunction due to dust or dirt, consult your nearest Pioneer authorized service center. Although lens cleaners for players are commercially available, we advise against using them since some may damage the lens.

Handling discs

Storing

- Always place discs in their cases and store them vertically, avoiding hot, humid places, places exposed to direct sunlight and extremely cold places.
- Be sure to read the cautions included with the disc.

Cleaning discs

- Discs may not play if there are fingerprints or dust on them. In this case, use a cleaning cloth, etc., to gently wipe the disc from the inside towards the outside. Do not use dirty cleaning cloths.



- Do not use benzene, thinner or other volatile chemicals. Also do not use record spray or antistatic agents.
- For tough dirt, apply some water to a soft cloth, wring out thoroughly, wipe off the dirt, then wipe off the moisture with a dry cloth.
- Do not use damaged (cracked or warped) discs.
- Do not let the signal surface of discs get scratched or dirty.

37

En

- Do not attach pieces of paper or stickers to discs. Doing so could warp discs, making it impossible to play them. Also note that rental discs often have labels attached to them, and the label's glue may have oozed out. Check that there is no glue around the edges of such labels before using rented discs.

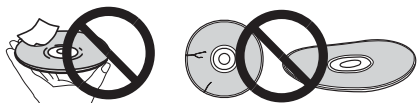

About specially shaped discs

Specially shaped discs (heart-shaped, hexagonal, etc.) cannot be played on this unit. Do not attempt to play such discs, as they could damage this unit.



Auto power off setting

Long press the **g** on the unit for 3 seconds to switch auto power off setting **ON/OFF**.

- The operation can be conducted using only the **g** on the unit.
- No need to set this using the remote control.
- Initial setting is set to **ON**.

Note

- When the auto power off is set to **ON**, "APD ON" will be displayed on the main display.
- When the auto power off is set to **OFF**, "APD OFF" will be displayed on the main display.

Restoring all the settings to the defaults

Use the steps below to restore the all settings to their defaults.

- Press **⏻** **STANDBY/ON** to turn the power on.
- Press **CD** on the remote control or **INPUT** on the main unit repeatedly to select **CD** input.
- Press **▲** **OPEN/CLOSE** to open the disc tray.
- Press **⏻** **STANDBY/ON** on the unit for **3 seconds while pressing ■**.
 - "DEFAULT" is displayed while the settings are being restored. Power is turned off.
 - No need to set this using the remote control.

Additional information

10

Specifications

• Amplifier section

RMS Power Output: 15 W + 15 W
(1 kHz, 10 %, T.H.D., 8 Ω)

• Tuner section

X-HM15/HM15BT
Frequency Range (FM) 87.5 MHz to 108 MHz
Antenna Input (FM) 75 Ω unbalanced
Frequency Range (AM) 522 kHz to 1620 kHz
Antenna (AM) Loop antenna
X-HM15BTD
Frequency Range (FM) 87.5 MHz to 108 MHz
Frequency Range (DAB) 174.928 MHz to 239.200 MHz
Antenna Input (DAB/FM) 75 Ω unbalanced

• Bluetooth

X-HM15BT/HM15BTD only

Version Bluetooth Specification Ver. 3.0
Output Bluetooth Specification Class 2
Estimated line-of-sight transmission distance*
. About 10 m
Frequency range 2.4 GHz
Modulation
. FH-SS (Frequency Hopping Spread Spectrum)
Supported *Bluetooth* profiles A2DP, AVRCP
Supported Codec SBC (Subband Codec)
Supported contents protection SCMS-T
* The line-of-sight transmission distance is an estimate.
Actual transmission distances supported may differ
depending on surrounding conditions.

• Miscellaneous

USB terminal 5 V, 500 mA
Power source AC 220 V to 240 V, 50 Hz/60 Hz
Power consumption
Power on 38 W
Power stand-by 0.5 W or less
Power stand-by (BT STANDBY ON) 0.5 W or less
Dimensions 215 mm (W) x 95 mm (H) x 315 mm (D)
Weight (without package) 2.0 kg

• Speaker

Magnetically shielded speaker system
Type
2-way type speaker system
Piezoelectric Tweeter
10 cm Woofer
Maximum input power 15 W
Impedance 8 Ω
Dimensions 130 mm (W) x 212 mm (H) x 228.5 mm (D)
Weight 2.0 kg/each

• Accessories

Remote control 1
AAA batteries (R03) 2
AM loop antenna (X-HM15/HM15BT) 1
FM wire antenna (X-HM15/HM15BT) 1
DAB/FM wire antenna (X-HM15BTD) 1
Power cord
Warranty card
Operating instructions (This document)

✎ Note

- The specifications are applicable when the power supply is 230 V.
- Specifications and the design are subject to possible modifications without notice, due to improvements.

"Pioneer" is a trademark of Pioneer Corporation, and is used under license.

© 2016 Onkyo & Pioneer Corporation.

All rights reserved.

English

39

En

© 2016 Onkyo & Pioneer Corporation.
All rights reserved.

© 2016 Onkyo & Pioneer Corporation.
Tous droits de reproduction et de traduction réservés.

Pioneer

2-3-12 Yaesu, Chuo-ku, Tokyo 104-0028 JAPAN

<U.S.A.>

18 PARK WAY, UPPER SADDLE RIVER, NEW JERSEY 07458, U.S.A.

Tel: 1-201-785-2600

<Germany>

Hanns-Martin-Schleyer-Straße. 35, 47877 Willich, Germany

Tel: +49(0)2154 913222

<UK>

Anteros Building, Odyssey Business Park, West End Road, South Ruislip, Middlesex, HA4 6QQ United Kingdom

Tel: +44(0)208 836 3612

<France>

6, Avenue de Marais F - 95816 Argenteuil Cedex FRANCE

Tel :+33(0)969 368 050

Корпорация О энд Пи

2-3-12, Яэсу, Чуо-ку, г. Токио, 104-0028, ЯПОНИЯ

Сделано в Китае

Printed in China / Imprimé en Chine