

# MicroMechanic™

## Product Guide

### Quick Start Tips

- Micro Mechanic™ will only work with vehicles produced 1996 or later. Please check your car's user manual for more details.
- Only operate Micro Mechanic™ when in PARK, not in motion and in a well-ventilated area if ignition is on.

**1** Download an OBDII app for your iOS or Android device. For best results, we recommend\*:

- OBD AUTO DOCTOR
- MINI OBDII
- CAR SCANNER ELM OBD2
- CARISTA
- DASHCOMMAND
- TRACKADDICT
- OBD CAR DOCTOR
- TORQUE

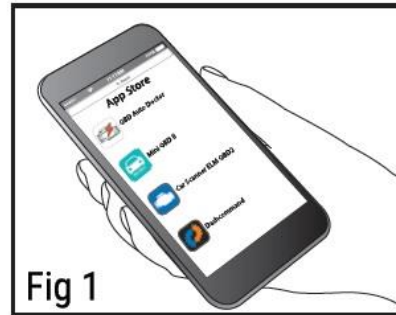

**2** Find the OBDII port in your car. See Fig 2 for most common locations and what to look for. For more information consult your car's user manual.

*NOTE: The port may be covered by a protective panel or cap.*

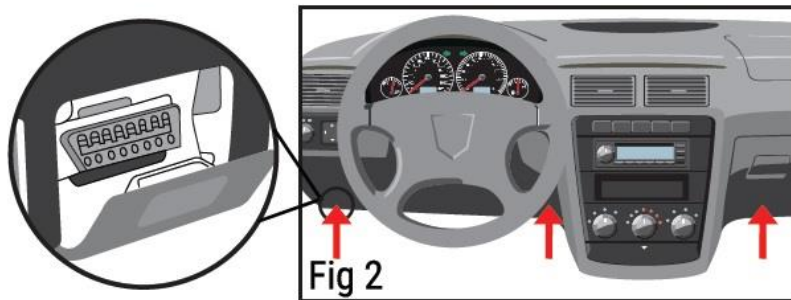

**3** Plug your Micro Mechanic™ into the OBDII port. Push in until secure. (See Fig 3) Turn on your car. Micro Mechanic™ can only operate when vehicle is powered on.

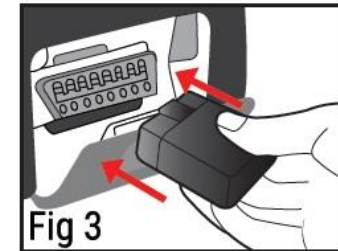

**4** Open the App you downloaded and follow the prompts to use Micro Mechanic™. There is usually a "Connect Device" option and/or "Diagnose" option to begin. Then, follow instructions as directed by the app. (See Fig 4)

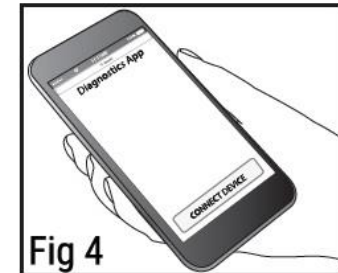

**5** When done, store Micro Mechanic™ in included case in a cool, dry area. (See Fig 5)

### Need More Help?

If you are having issues with setup or connecting to Micro Mechanic™, download a different app and repeat setup process.

If you require more help setting up your Micro Mechanic™, there are several helpful videos available; search OBDII installation in your favorite search engine. We are also here to help – contact us at 855-380-3104 or [micromechanics@worldpackusa.com](mailto:micromechanics@worldpackusa.com)



## WARNINGS:

Changes or modifications not expressly approved by the party responsible for compliance could void the user's authority to operate this device. To prevent injury or damage to vehicles and/or Micro Mechanic™ read this instruction manual first and observe the following safety precautions at a minimum whenever working on a vehicle. **SAVE THESE INSTRUCTIONS.**

- Always perform automotive testing in a safe environment.
- Wear safety eye protection that meets ANSI standards.
- Keep clothing, hair, hands, tools, test equipment, etc. away from all moving or hot engine parts.
- Operate the vehicle in a well-ventilated work area: Exhaust gases are poisonous.
- Put blocks in front of the drive wheels and never leave the vehicle unattended while running tests.
- Use extreme caution when working around the ignition coil, distributor cap, ignition wires and spark plugs. These components create hazardous voltages when the engine is running.
- Put the transmission in PARK (for automatic transmission) or NEUTRAL (for manual transmission) and make sure the parking brake is engaged.
- Keep a fire extinguisher suitable for gasoline/chemical/ electrical fires nearby.
- Don't connect or disconnect any test equipment while the ignition is on or the engine is running.
- Keep Micro Mechanic™ dry, clean, free from oil/water or grease. Use a mild detergent on a clean cloth to clean the outside of the Micro Mechanic™, when necessary.

### SPECIFICATIONS:

Communication Method: Bluetooth 2.0/3.0/ 4.0

Software Platform: Supports iOS, Android, Windows

Operating Voltage: 9V-16V

Operating Current: 50mA

Operating Humidity: <60%

Operating Temperature: -30C to 60C

### Supported Protocols OBDII:

SAE J1850 PWM (41.6Kbaud)

SAE J1850 VPW (10.4Kbaud)

ISO 9141-2 (5 baud init, 10.4 Kbaud)

ISO 14230-4 KWP (5 baud init, 10.4 Kbaud)

ISO 14230-4 KWP (fast init, 10.4 Kbaud)

ISO 15765-4 CAN (11 bit, 500 Kbaud)

ISO 15765-4 CAN (29 bit, 500 Kbaud)

ISO 15765-4 CAN (11 bit, 250 Kbaud)

ISO 15765-4 CAN (29 bit, 250 Kbaud)

\*OBD Auto Doctor, Mini OBDII, Car Scanner ELM OBD2, Carista, Dashcommand, Trackaddict, OBD Car Doctor, Torque do not sponsor, authorize or endorse this product.

Distributed by



Fairfield, NJ 07004  
©2018 Ontel Products Corp.  
All Rights Reserved.  
Made In China  
MMIM10118-TVP

**NOTE:** This product has been tested and found to comply with the limits for a Class B digital device, pursuant to Part 15 of the FCC Rules. These limits are designed to provide reasonable protection against harmful interference in a residential installation. This product generates, uses and can radiate radio frequency energy and, if not installed and used in accordance with the instructions, may cause harmful interference to radio communications. However, there is no guarantee that interference will not occur in a particular installation. If the product does cause harmful interference to radio or television reception, which can be determined by turning the equipment off and on, the user is encouraged to try to correct the interference by one or more of the following measures:

- Reorient or relocate the receiving antenna.
- Connect the product into an outlet on a circuit different from that to which the receiver is connected.
- Increase the separation between the product and receiver.
- Consult the dealer or an experienced radio/TV technician for help.

The device complies with Part 15 of the FCC Rules. Operation is subject to the following two conditions:

(1) this device may not cause harmful interference, and (2) this device must accept any interference received, including interference that may cause undesired operation.

### FCC exposure statement:

This equipment complies with FCC radiation exposure limits set forth for an uncontrolled environment.

This transmitter must not be co-located or operating in conjunction with any other antenna or transmitter.



FCC ID: 2A0XK18002