



Key Information

The new designed MICROS customer display implements the NFC function. The Rear Display is attached to MICROS POS docking station- mStation. The Pole Display stands alone the mStation. Except the normal display function, both new models have NFC function.

Specification

<i>Model</i>	<i>LCD Rear Display w/RFID Series 2 LCD Pole Display w/RFID Series 2</i>
<i>Overall Dimension (not including mounting fixture)</i>	<i>63.2 x 135.9 x 29.3mm</i>
<i>LCD module size</i>	<i>37 x 116 x 12.9mm</i>
<i>Backlight</i>	<i>LED Backlight</i>
<i>Number of character</i>	<i>20CH x 2 Lines</i>
<i>Power in</i>	<i>DC 5V from mStation customer display port</i>
<i>Rating</i>	<i>DC 5V, 250mA max.</i>
<i>Max. Operating Temperature</i>	<i>65°C</i>
<i>NFC Function</i>	<i>YES</i>

Product final location



Installing of LCD Pole Display w/RFID Series 2

As above picture shown, fix the position of the pole display (beside the mStation), and connect the cable to mStation customer display port.

Installing of LCD Rear Display w/RFID Series 2

The following procedure describes how to attach the Rear LCD Customer Display (LCD Rear Display Series 2) to the MICROS mStation. The customer display is provided as a complete assembly ready to install.

1. Remove the AC power cable from the mStation.
2. Place the mStation face down. Find the 2 screw holes for attach LCD customer display, which at the edge of unit.
3. Attach the LCD customer display to it and tighten the captive screws as shown in figure 1.

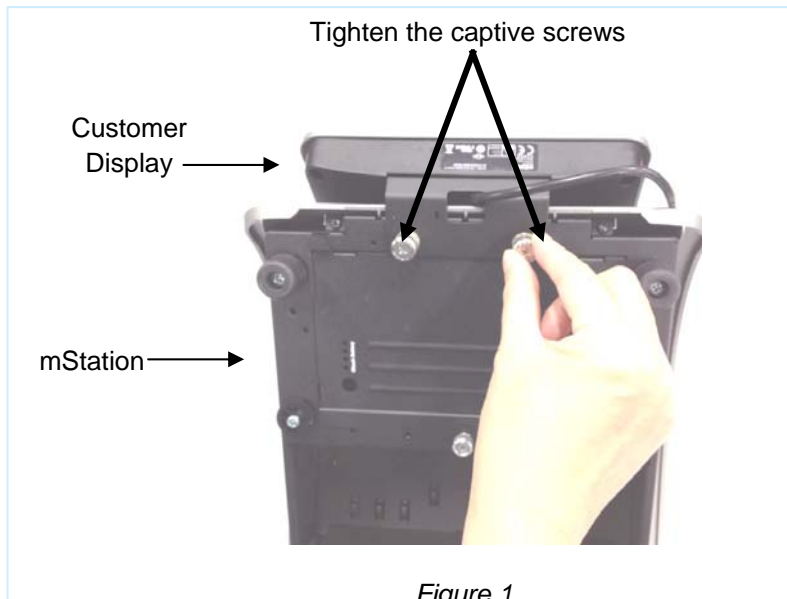

4. Feed the interface cable to IO port labeled "Customer Display"
5. Snap-in the cable to the clip and rubber footer. And then use cable tie to fix the cable inside the concave as shown in figure 2.

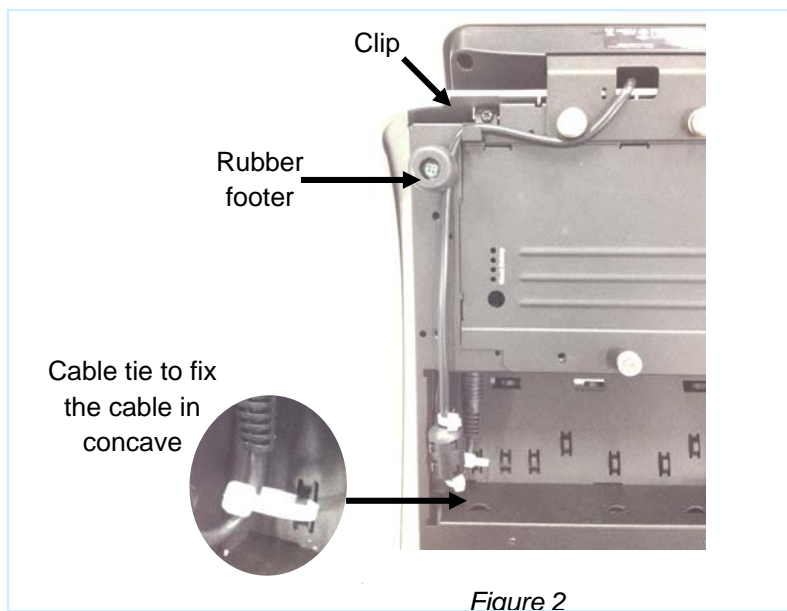



6. Return the mStation to the normal operating position, connect the AC power cord and press the power button. The Integrated LCD Customer Display is automatically detected.



Figure 3

Test the Customer Display

1. From the Window Embedded Compact 7 Desktop, go to MyDevice > Boot > Utilities > Diagutility_Vienna. The [Micros Diagnostic] screen displayed.
2. Press the "Customer Display" icon,
 - Select display data
 - Click [Send] or [Full Update] button
3. The text message displayed on the customer display screen.
4. NFC function
 - Put the card near the rear display or pole display
 - Display NFC antenna will sense the card and transfer the data to the mTablet.

**Caution:**

This device complies with Part 15 of the FCC Rules / Industrie Canada licence-exempt RSS standard(s). Operation is subject to the following two conditions: (1) this device may not cause harmful interference, and (2) this device must accept any interference received, including interference that may cause undesired operation.

Le présent appareil est conforme aux CNR d'Industrie Canada applicables aux appareils radio exempts de licence. L'exploitation est autorisée aux deux conditions suivantes : (1) l'appareil ne doit pas produire de brouillage, et (2) l'utilisateur de l'appareil doit accepter tout brouillage radioélectrique subi, même si le brouillage est susceptible d'en compromettre le fonctionnement.

Changes or modifications not expressly approved by the party responsible for compliance could void the user's authority to operate the equipment.

This equipment has been tested and found to comply with the limits for a Class B digital device, pursuant to part 15 of the FCC Rules. These limits are designed to provide reasonable protection against harmful interference in a residential installation. This equipment generates uses and can radiate radio frequency energy and, if not installed and used in accordance with the instructions, may cause harmful interference to radio communications. However, there is no guarantee that interference will not occur in a particular installation. If this equipment does cause harmful interference to radio or television reception, which can be determined by turning the equipment off and on, the user is encouraged to try to correct the interference by one or more of the following measures:

- Reorient or relocate the receiving antenna.
- Increase the separation between the equipment and receiver.
- Connect the equipment into an outlet on a circuit different from that to which the receiver is connected.
- Consult the dealer or an experienced radio/TV technician for help.

Under Industry Canada regulations, this radio transmitter may only operate using an antenna of a type and maximum (or lesser) gain approved for the transmitter by Industry Canada. To reduce potential radio interference to other users, the antenna type and its gain should be so chosen that the equivalent isotropically radiated power (e.i.r.p.) is not more than that necessary for successful communication.

Conformément à la réglementation d'Industrie Canada, le présent émetteur radio peut fonctionner avec une antenne d'un type et d'un gain maximal (ou inférieur) approuvé pour l'émetteur par Industrie Canada. Dans le but de réduire les risques de brouillage radioélectrique à l'intention des autres utilisateurs, il faut choisir le type d'antenne et son gain de sorte que la puissance isotrope rayonnée équivalente (p.i.r.e.) ne dépasse pas l'intensité nécessaire à l'établissement d'une communication satisfaisante.