



ZEVO® PULSE LIGHT ENGINE
INSTALLATION GUIDE

PLEASE NOTE BEFORE YOU BEGIN:
DO NOT ATTEMPT TO PAIR THROUGH PHONE SETTINGS;
CONNECT THROUGH APP.

WARNING

- Keep components out of reach of small children.
- To avoid possible fire, product damage, or early product failure, do not position components in areas exposed to high heat.
- Changes or modifications to this unit not expressly approved by the party responsible for compliance, could void the users' authority to operate the equipment. Consult state and local regulations regarding the use of accent color lighting on your vehicle.
- Do not install this product if it interferes with vehicle control or safety features such as air bags, steering wheel, brakes, clutch or gas pedals
- This device complies with part 15 of the FCC Rules. Operation is subject to the following two conditions: (1) This device may not cause harmful interference, and (2) this device must accept any interference received, including interference that may cause undesired operation.

1 Introduction

Your new ZEVO® Pulse system uses LED Light Engines to dynamically project colored light to your vehicle's headlight reflectors.

Carefully unpack your ZEVO® Pulse system. Lay all components out individually. Read all instructions completely prior to installation.



2 Finding the best location

There are many different headlight reflector designs. You will need to determine the best location to attach your ZEVO® Pulse Light. Placing the light engine along the lower edge of the headlight reflector is often best – the choice is up to you. Place a piece of masking tape on each lens to identify your chosen mounting positions. You will not be mounting the light engines until the controller is first mounted and the wires are routed.

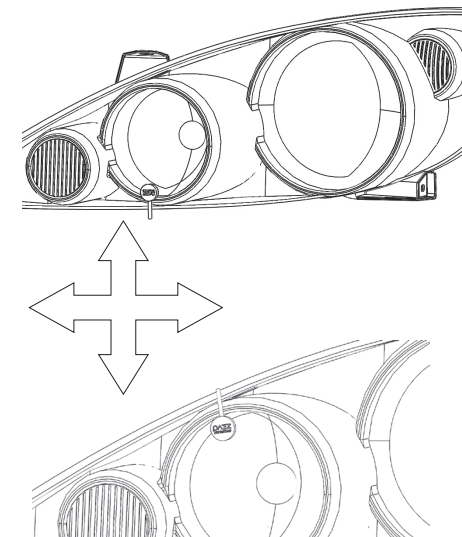

3 Disconnect the "Try-Me" wire harness

If your package has a "Try-Me," separate the spade connectors from the red & black wires.

The "Try Me" harness may be discarded.

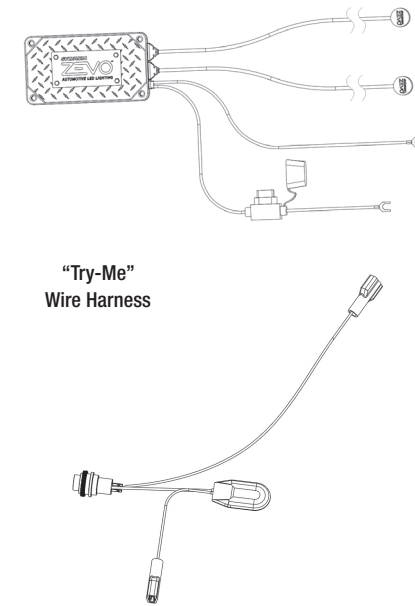

4 Installing and mounting the controller box

The power supply wires are 39 inches long. The light engine wires are 78 inches long. Select a mounting location for the ZEVO® Pulse controller within the engine compartment so the wires can reach the 12V source and the headlight lenses. It is critical to keep the controller and the wires away from hot surfaces. Ensure the selected controller mounting location allows for the wires to be neatly routed and secured along the way. Use the provided wire ties to secure the ZEVO® Pulse controller. Connect the power supply wires—the black wire to battery (-) and the red wire to a suitable +12V circuit.

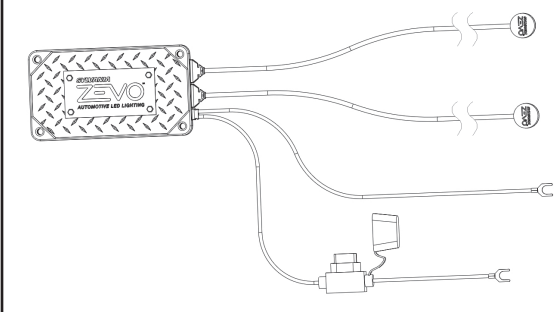

5 Mounting the light engines

Take each light engine cable and secure the wires along the route to the headlight. Take the provided alcohol wipe and clean the light engine mounting surface on the LED side as well as the headlight lens location where the light engine is to be attached. Take care to properly clean these surfaces, as any residual contaminant from handling the light engine or anything on the headlight lens mounting location will result in poor adhesion.

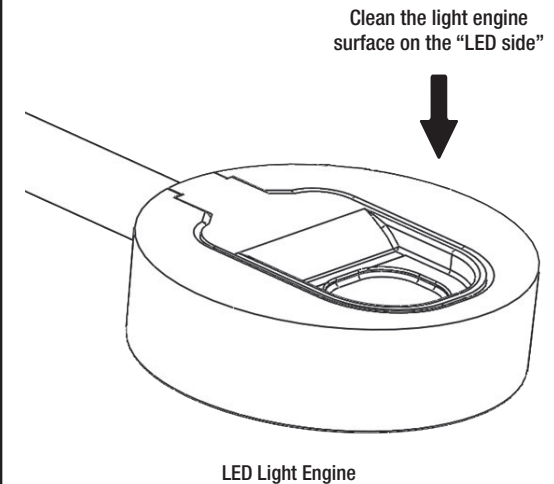

6 Mounting tape has release film on both sides

Peel off the release film from one side of the double-sided mounting tape for the Light engine.

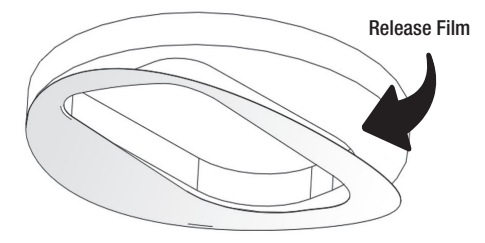

8

Remove the remaining film from the mounting tape.

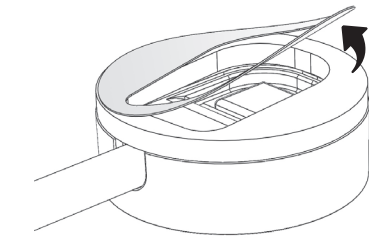

7

Attach double sided mounting tape to each ZEVO® light engine on the LED side. Be sure to align the tape opening with the LED side opening on the light engine.

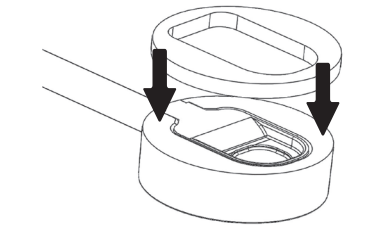

9

Attach the ZEVO® Pulse light engine at the previously cleaned, headlight lens position. Press and hold the light engine to the headlight lens for about 15 seconds, to allow the adhesive to set.

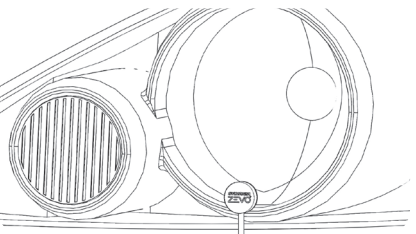

INSTALLING THE APPLICATION

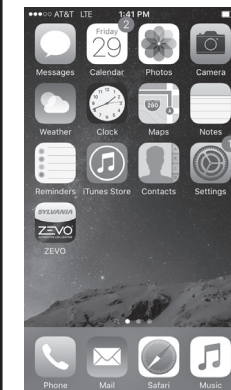

10

Download the SYLVANIA ZEVO® app from Google Play™ or the App Store®. Once it is loaded on your device, open the ZEVO® app.

Google Play is a trademark of Google Inc.
App Store is a registered Trademark of Apple, Inc.

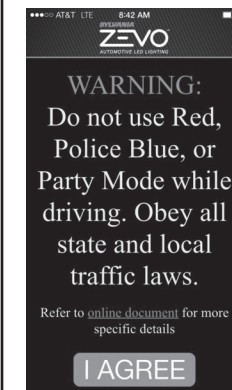

11

Upon opening, the app gives you a WARNING screen. Read the warning and then touch the "I AGREE" button to continue.

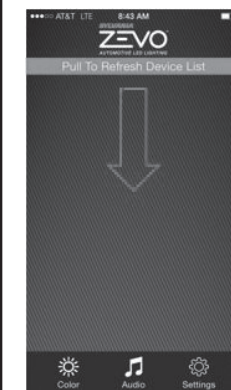

12

Make sure your hand held device has the Bluetooth® function turned on. Swipe down from the center of the screen for your hand held device to search for your ZEVO® Pulse controller. If your ZEVO® Pulse is not found after a few swipes, make sure you are close enough to it. If you are close enough, then cycle power to the controller and swipe the screen to refresh again.

Note: Do NOT use the phone's Bluetooth® setting menu to connect to the ZEVO® Pulse.

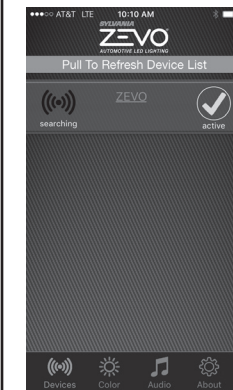

13

Once your handheld device locates your ZEVO® Pulse, it will change from "searching" to "connected". A checked "active" indicates you can change Color or Audio settings. A default name (shown here as "ZEVO") will be assigned.

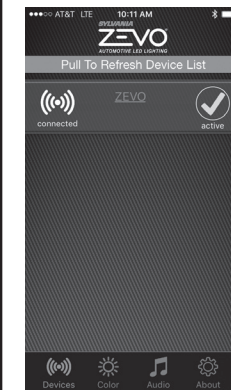

14

Touching the default name (shown here as "ZEVO") allows you to change it.

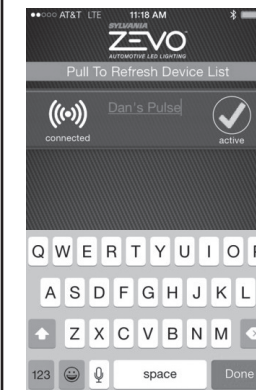

15

Touch "Done" when you have finished editing the name.

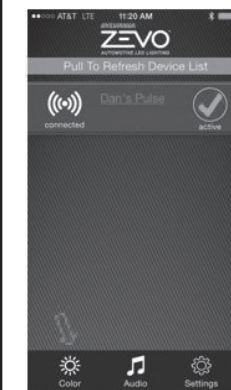

16

Use the "Color" tab, located at the lower left corner, to manually select a light color.

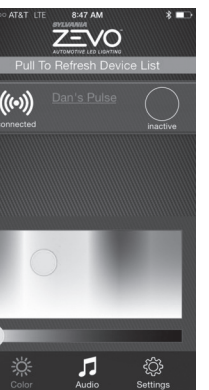

17

Touch the colored display to select a color. The lower bar controls the brightness. Slide it left for brighter, or to the right for dimmer.

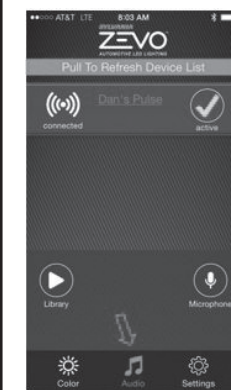

18

Use the "Audio" tab, located at the lower center, to have your ZEVO® Pulse react to the beat of your music.



19

Select "Library" to open the music files on your Bluetooth® device. The Pulse colors will dynamically respond to your music selections.

Select "Microphone" to enable your Pulse to respond to the microphone in your Bluetooth® device.

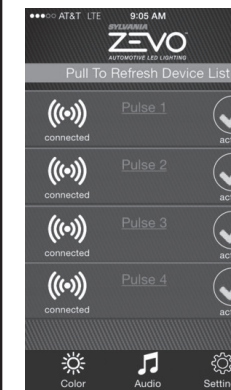

20

The app can control multiple ZEVO® Hybrid and ZEVO® Pulse controllers. Here we show 4 connected systems. To set them all to the same mode, leave the "active" checked. To set them to different modes or colors, deselect the systems you wish not to change, then change the settings of the selected system.

FREQUENTLY ASKED QUESTIONS

Q: Do I need a switch to turn off the power to the ZEVO® Pulse controller?
A: You do not need to shut off the controller as it uses only 5mA in sleep mode.

Q: My Bluetooth® device cannot find my ZEVO® Pulse controller. What do I do?
A: Remove the fuse for a moment and replace it. Then swipe down to refresh device list.

Q: If my Bluetooth® device is shut off or moves far away from the vehicle, what happens?
A: Your ZEVO® Pulse will continue to operate for about 30 minutes and then shut off.

Q: Can anyone else change my ZEVO® Pulse settings from their Bluetooth® device?
A: Your ZEVO® Pulse Controller is not accessible to others while your Bluetooth® device is connected. If your Bluetooth® device is out of range or off, another Bluetooth® device with the proper app can communicate with your ZEVO® Pulse controller.