

PDi®

PDI-TR100

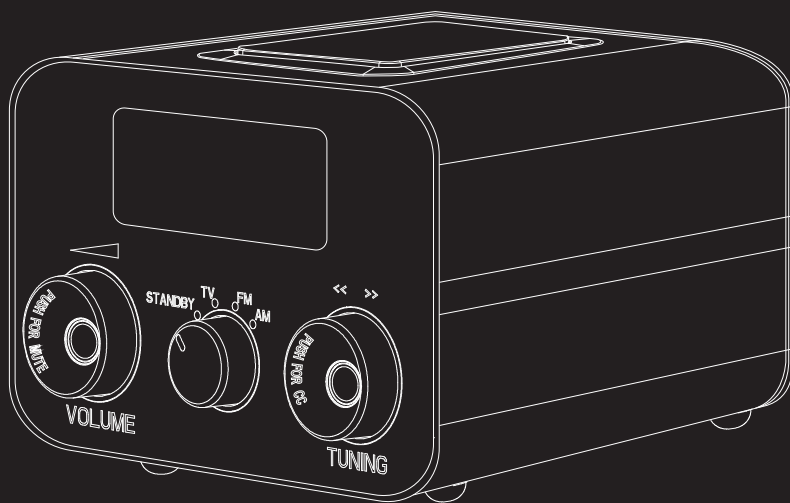

TABLE RADIO



The lightning flash with arrow-head symbol within an equilateral triangle is intended to alert the user to the presence of uninsulated "dangerous voltage" within the unit's enclosure that may be of sufficient magnitude to constitute a risk of electric shock.



The exclamation point within an equilateral triangle is intended to alert the user to the presence of important operating and maintenance (servicing) instructions in the literature accompanying the unit.

CAUTION

TO REDUCE THE RISK OF ELECTRIC SHOCK, DO NOT REMOVE COVER OR BACK. THERE ARE NO USER-SERVICEABLE PARTS INSIDE. REFER SERVICING TO QUALIFIED SERVICE PERSONNEL.

TO REDUCE THE RISK OF FIRE OR ELECTRIC SHOCK, DO NOT EXPOSE THIS UNIT TO RAIN OR MOISTURE.

FCC INFORMATION

This equipment has been tested and found to comply with the limits for Class B digital devices, pursuant to part 15 of FCC Rules. These limits are designed to provide reasonable protection against harmful interference installation. This equipment generates, uses and can radiate radio frequency energy and, if not installed and used in accordance with the

institutions, may cause harmful interference to radio communications. However, there is no guarantee that interference will not occur in a particular installation. If this equipment does cause harmful interference to radio or television reception, which can be determined by turning the equipment off and on, the user is encouraged to try to correct the interference by one or more of the following measures:

Reorient or relocate the receiving antenna.

Increase the separation between the equipment and receiver.

Connect the equipment into an outlet on a circuit different from that to which the receiver is connected.

Consult the dealer or an experienced radio/TV technician for help.

This equipment complies with Part 15 of the FCC Rules.

Operation is subject to the following two conditions:

Statement:

Changes or modifications not expressly approved by the party responsible for compliance could void the user's authority to operate the equipment.

CONTENTS

Read this manual carefully to get the best performance from this unit.

Package contents	1
Mount clock battery	2
Specifications	2
Menu	2
Front panel	3
Rear panel	4
Operation	5
(1)AM/FM OPERATION	5
(2) TV WIRELESS CONNECTION	5
(3)MUTE FUNCTION	5
(4)BASS/TREBLE FUNCTION	6
(5)ALARM CLOCK	6
(6)DIMMER ADJUSTMENT	6

Package contents

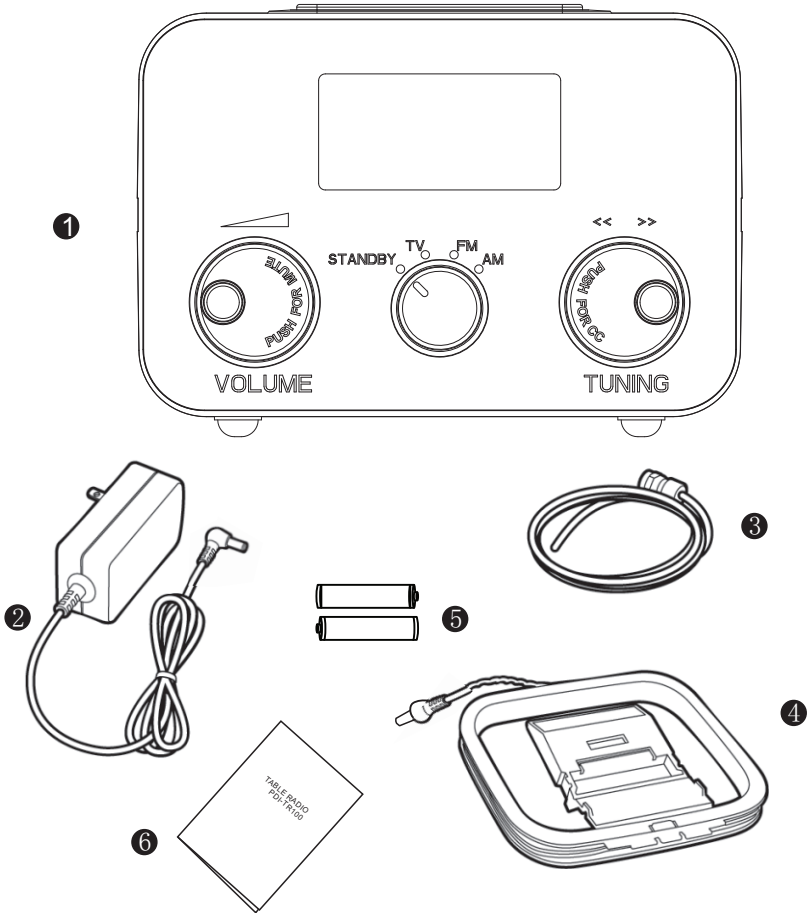

- 1.PDI-TR100 unit 1PC.
- 2.15V AC adaptor 1PC.
- 3.FM antenna 1PC.
- 4.AM antenna 1PC.
- 5.2XAAA batteries 2PC.
- 6.Owners manual 1PC.

Mount clock battery

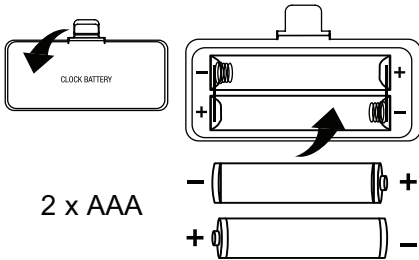

Specifications

- FM/AM tuner.
- FM Frequency range: 87.5-108MHz.
- AM Frequency range: 530-1700KHz.
- Wireless audio output.
- Driver: 3" full range.
- Back-lit display.
- TV channel selection.
- INPUT:15V 1.6A DC, external power supply.
- OUTPUT:Battery back-up for clockAlarm function.
- Working temperature: -5C to +40C.
- Size: H120xD140xW180mm.

Menu

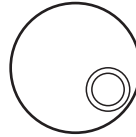

- BASS -3 > +3
- TREBLE -3 > +3
- ALARM
 - └ ALM OFF
 - └ ALM On
 - └ HOUR
 - └ Min
- DIMMER DIM HI (high light)
DIM MI (medium light)
DIM LO (low light)

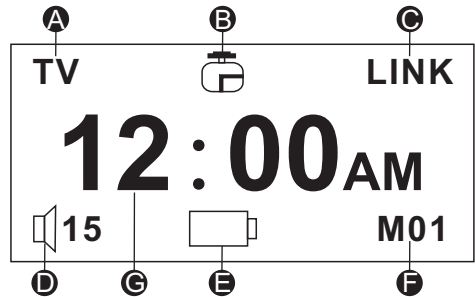

- (A) Indicates Function on.
- (B) Indicates ALARM on.
- (C) Blinks when link to TV.
- (D) Indicates Volume.
- (E) Blinks when poor or no battery.
- (F) Display memory-station.
- (G) Display frequency, clock.

Front panel

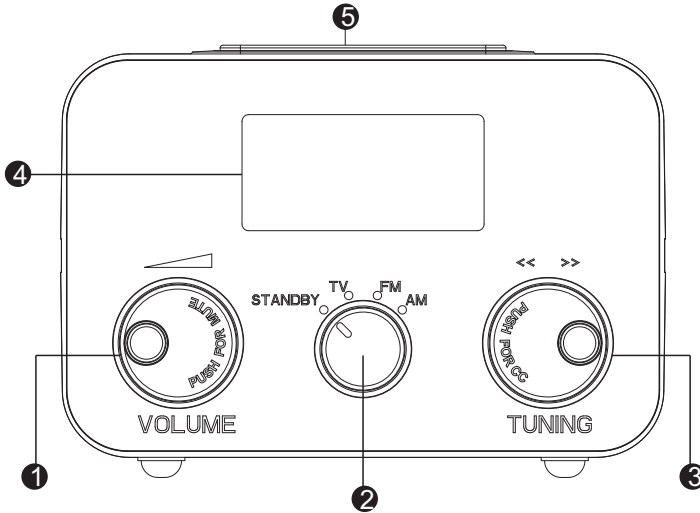

(1) VOLUME KNOB

- Adjust the volume knob to desired listening level.
- Push for mute and push again or tuning the knob to turn on the volume.

(2) FUNCTION KNOB

- STANDBY (Display the clock)
- TV MODE
- FM MODE
- AM MODE

(3) TUNING KNOB

- Adjust the “TUNING” to choose the radio station .
- Adjust the “TUNING” to choose the TV station.
- Longpush “TUNING” for 3 seconds to enter the “MENU”.

(4) LCD DISPLAY

(5) SPEAKER

Rear panel

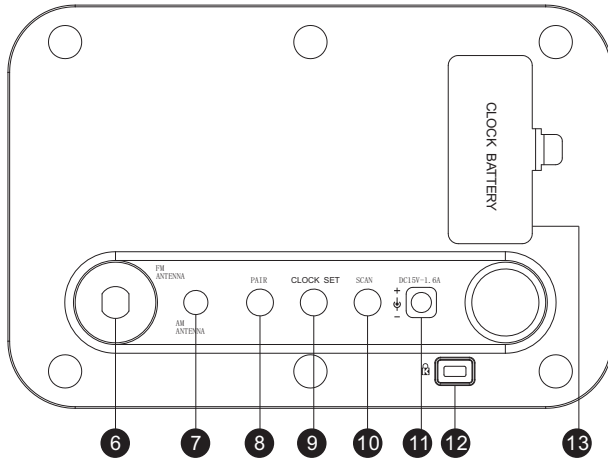

(6) FM EXTERNAL ANTENNA JACK

·Connect the enclosed external FM antenna if reception is poor
,You can also connect a communal aerial.

(7) AM EXTERNAL ANTENNA JACK

·Connect the enclosed external AM antenna if reception is poor
,You can also connect a communal aerial.

(8) PAIR TO TV BUTTON

(9) CLOCK SET BUTTON

(10) AUTO SCAN BUTTON

(11) DC ADAPTOR JACK

(12) LOCK FOR UNIT

(13) BATTERY LID

OPERATION

(1) AM/FM OPERATION

- Make sure the DC power adaptor is connecting to the unit .
- Choose the function to AM/FM mode, Adjust the “TUNING”(3)to choose the desired radio station .
- Fine tune by short adjust AM -/+10KHz, FM -/+100KHz.
- Choose the function to AM/FM mode,push “SCAN”(10)on the rear panel. After scan,“M01-M20” will display on the right corner of the LCD. Adjust the “TUNING”(3)to choose the radio station. If you want cancel the scan, push the “SCAN”(10)again.
- ”M01-M20” it means the unit can restore most 20pcs stations.

(2) TV WIRELESS CONNECTION

- Make sure the DC adaptor is connecting to unit.Adjust the function knob to “STANDBY”,Long push “VOLUME”(1) until “TR100-01”display on the LCD.
- Adjust the function knob to “TV”(2),Long push the “PAIR”(8) 5 seconds.the “PAIR” will display and blink on the LCD. In the mean time ,you can open the TV wirless connect mode to search the unit .”TR100-01”will display on the LCD. Then input the code “0000”,Once the pair is successful ,”LINK”will display on the LCD of TV and TR100. Then adjust the “TUNING”(3) to choose the TV channel.
- The limited time of pairing is one minute ,If the pair is unsuccessful. You can reset the “PAIR”(8) 5 seconds again. Once the pairing is successful, You don’t to pair the TV any more in the future .

(3) Mute function

- Push the “VOLUME”(1) for mute, Push again to cancel the mute.

(4) BASS/TREBLE FUNCTION

- In TV/FM/AM mode , ,long push the “TUNING”(3) for 3 seconds

• “MENU” will display on the LCD. Push “TUNING”(3) to choose the “BASS” FUNCTION, Adjust the “TUNING”(3) right or left to choose the range from -3----+3.

In TV/FM/AM mode , , long push the “TUNING”(3) for 3 seconds. “MENU” will display on the LCD. Push “TUNING”(3) to choose the “TREBLE ” FUNCTION, Adjust the “TUNING”(3) right or left to choose the range from -3----+3.

(5) **ALARM CLOCK**

In SATANDBY /TV/FM/AM mode , long push the “TUNING”(3) for 3 seconds. “MENU” will display on the LCD. Push “TUNING”(3) to choose “ALARM”. Adjust the “TUNING”(3)” to choose “ON/OFF”, Push “TUNING”(3) “HOUR ” will blink , Adjust the “TUNING”(3) to choose the hour , then push the “TUNING”(3) to confirm the hour. then “MINUTE” will blink , Adjust the “TUNING”(3) to choose the minute , The alarm have set already .After 3 seconds , the display of LCD will return the current settings.

——If you want to cancel the alarm clock during the ring , you can Adjust the “TUNING” or “VOLUME” to cancel the “beep”.

(6) **DIMMER ADJUSTMENT**

In SATANDBY /TV/FM/AM mode, long push the “TUNING”(3) for 3 seconds. “MENU” will display on the LCD. Push “TUNING”(3) to choose “DIMMER”, Adjust the “TUNING”(3)” to choose “HI”/”MI”/”LO”.