



Power on the Crasher Slim by Press hold 2+ seconds.



Crasher Slim will automatically be in Bluetooth Pairing mode. Light will blink blue to indicate Crasher Slim is ready to connect to device.

Turn on Bluetooth in your device settings.

Select "Crasher Slim" in your device settings to connect.

The light will stay **solid blue** once connected

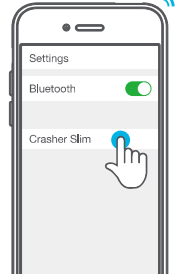

LINK CRASHER SPEAKERS

1 Power ON one Crasher Speaker and pair to your device.

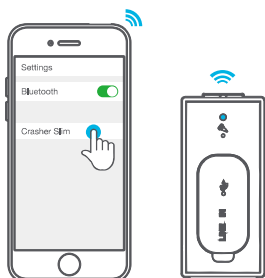

2 Once speaker is paired to your device, Power ON second speaker by Press and hold 2+ seconds

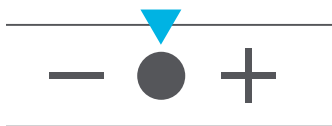

(Make sure this speaker is not connected to any Bluetooth device.)

3 From the speaker that is paired to your device, Press hold both buttons 3+ seconds

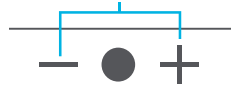

They will automatically link

Parent will be **solid blue**

Child will be **solid white**



For full User Manual + other JLab products visit jlabaudio.com

FCC ID: 24HYVCRSHSLIM
PEANG LLC DBA JLABAUDIO
2281 Las Palmas Drive, Suite 101, Carlsbad, CA 92011

Accessories



MICRO USB CABLE

Speaker Ports/Buttons

POWER ON/OFF: Press hold 2+ seconds
BLUETOOTH PAIRING: Double click
PLAY/PAUSE/ANSWER/HANG UP: Single click

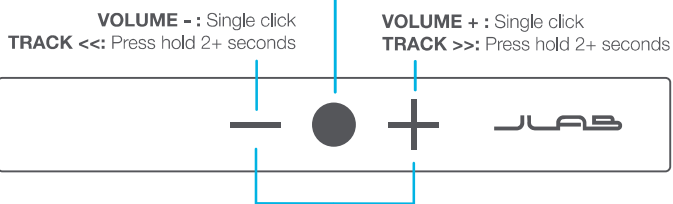

LINK SPEAKER FUNCTION: Press hold both buttons 3+ seconds

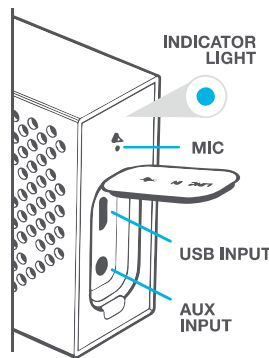

Review Sweepstakes

Leave a product review at jlabaudio.com and you're automatically entered for a chance to win a \$100 Gift Card to jlabaudio.com. One winner is announced each month.

Learn more: jlabaudio.com/reviewsweeps

3 MONTHS pandora™ FREE PREMIUM

With purchase. Visit jlabaudio.com/pandoraoffer

Contact Us

If you're unsatisfied with your purchase, please contact us and we'll take care of you! You can contact our US based customer support team:

Website: jlabaudio.com/contact

Email: support@jlabaudio.com

Phone: During business hours (M-F 9am-5pm PST) 1.405.445.7219

Visit jlabaudio.com/warranty to initiate a return or exchange.



JLab Audio + Burn-in Tool

Warm-up Your Headphones

Burn-in your audio equipment with the JLab Audio App.



OFFICIAL AUDIO PARTNER OF MAJOR LEAGUE SOCCER

#FINDYOURGO

QUICK START GUIDE

— |

FCC Information

This equipment has been tested and found to comply with the limits for a Class B digital device, pursuant to Part 15 of the FCC Rules. These limits are designed to provide reasonable protection against harmful interference in a residential installation. This equipment generates, uses and can radiate radio frequency energy and, if not installed and used in accordance with the instructions, may cause harmful interference to radio communications. However, there is no guarantee that interference will not occur in a particular installation. If this equipment does cause harmful interference to radio or television reception, which can be determined by turning the equipment off and on, the user is encouraged to try to correct the interference by one or more of the following measures:

- Reorient or relocate the receiving antenna.
- Increase the separation between the equipment and receiver.
- Connect the equipment into an outlet on a circuit different from that to which the receiver is connected.
- Consult the dealer or an experienced radio/TV technician for help.

If you cannot eliminate the interference, the FCC requires that you stop using your product. Changes or modifications not expressly by the party responsible for compliance could void the user's authority to operate the equipment.

This device complies with Part 15 of the FCC Rules. Operation is subject to the following two conditions: (1) this device may not cause harmful interference, and (2) this device must accept any interference received, including interference that may cause undesired operation.

Battery Caution & Disposal Information

- Improper operation of the battery (e.g., overcharging, crushing, puncture, excessive heat or moisture) may produce smoke. In such an event, ventilate the area.
 - Extinguish any flames with carbon dioxide, dry-powder fire extinguisher, or cover with sand or mud.
 - Do not disassemble, crush, puncture or incinerate.
 - Do not expose to temperatures above 140° F.
 - Do not dispose of the battery in the trash.
 - Charge fully before storage or if stored for longer than three months.
 - Do not dispose of batteries in a fire.
 - Batteries should be disposed or recycled per state and local guidelines.
- |