

FCC ID: EENDB102

Data Broadcast Systems

**EXHIBIT NEEDED FOR FCC CERTIFICATION
EUT: Data Broadcast Modem; Type: DB102**

Operating Instructions

PHILIPS DATA BROADCAST DECODER DB101 ISA

Installing the Data Broadcast Decoder

- Insert the Data Broadcast Decoder into a free 16-bit ISA slot of computer (1).
- Connect the serial cable (3) from the antenna (Y) to the serial socket or optionally connect the video signal to the video socket CVBS (2).
If you also want to connect the serial signal to a TV, attach first the serial cable to the antenna split (4).
- Restart the computer

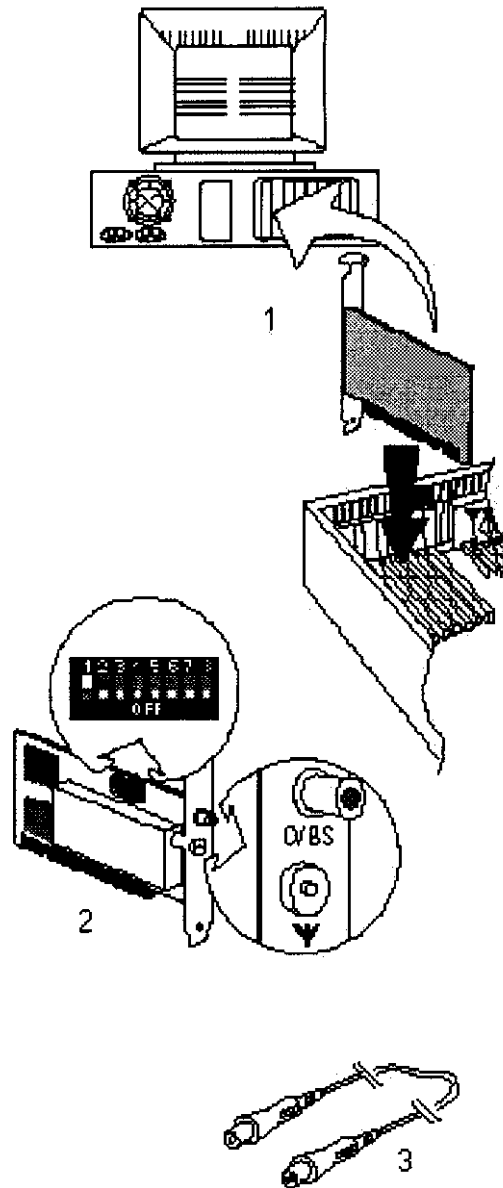

Dipswitch functionality

Dipswitch 1: Enable/Disable Plug & Play autoconfiguration

Dipswitch 1	Function
ON	Plug & Play autoconfiguration enabled
OFF	Plug & Play autoconfiguration disabled

If Plug & Play autoconfiguration is enabled, the IRQ number and I/O address of the Data Broadcast decoder are automatically set during the Plug&Play initialisation phase. The settings of all other dipswitches is ignored.
If Plug & Play autoconfiguration is disabled, the IRQ number and I/O address of the Data Broadcast decoder are defined by dipswitches 3 to 8 (see below).

Dipswitch 3 and 4: I/O address setting (COM-port)

Dipswitch 3	Dipswitch 4	Function
OFF	OFF	I/O Address 3F8 - 3FF (COM1)
OFF	ON	I/O Address 2F8 - 2FF (COM2)
ON	OFF	I/O Address 3E6 - 3EF (COM3)
ON	ON	I/O Address 2E6 - 2EF (COM4)

Dipswitches 5 - 8: IRQ setting

Dipswitch 5	Dipswitch 6	Dipswitch 7	Dipswitch 8	Function
OFF	OFF	OFF	OFF	Not applicable
OFF	OFF	OFF	ON	Not applicable
OFF	OFF	ON	OFF	Not applicable
OFF	OFF	ON	ON	IRQ3
OFF	ON	OFF	OFF	IRQ4
OFF	ON	OFF	ON	IRQ5
OFF	ON	ON	OFF	IRQ6
OFF	ON	ON	ON	IRQ7
ON	OFF	OFF	OFF	Not applicable
ON	OFF	OFF	ON	IRQ9
ON	OFF	ON	OFF	IRQ10
ON	OFF	ON	ON	IRQ11
ON	ON	OFF	OFF	IRQ12
ON	ON	OFF	ON	Not applicable
ON	ON	ON	OFF	Not applicable
ON	ON	ON	ON	IRQ15

Philips Electronics N.V.
New Business & Special Projects
Data Broadcast Systems
Prof. Holstlaan 4
Building WAEp 113
5050 AA Eindhoven
The Netherlands