

- Install the application software from the CD ROM included in the SHB6101 package. Refer to the on screen instructions for further details.
- Download and install the latest version of your preferred **VoIP** software for Internet calls such as Skype, Google Talk, Windows Live! messenger, Yahoo messenger etc. from the corresponding website.
- Make sure the headset is powered off and press the multi-function button for 4 seconds until your headsets LED will flash red and green alternately indicating that it has entered pairing mode. The headset will remain in pairing mode for three minutes.
- Start the Blue Soleil Bluetooth application software and start the USB adapters search for the headset by clicking on the orange circle in the center of the screen. This search may take a couple of seconds.
- Select the stereo headset icon from the list of found Bluetooth devices by double-clicking on it. Please enter the headsets **PIN “0000” (4 zeros)** in the pairing window that pops up. Your headset’s LED will flash green every 3 seconds indicating that it is now successfully paired.

Connect the headset to your PC

Your Blue Soleil Software can connect to your music using the A/V profile (A2DP) for Stereo Music or the Bluetooth Headset profile for two way communication for VoIP applications like Skype, Windows Live! Messenger etc.

- Click on the icon labeled “Philips SHB6100” before you connect using one of the profiles by following the steps below.

Connect to your PC's music

- To connect the headset for **stereo music listening** click on the speaker icon  in the upper right corner of the screen. You can control the music in your Windows Media Player using on screen controls or the buttons on your headset as described in the mobile phone section.

Connect for VoIP communication

- To connect for **two-way communication** click on the mono headset  icon in the upper right corner of the screen. .
- After connecting your headset will ring. "Pick up" using the multi-function button to start using the microphone and headset speakers for two-way communication. You are now ready to chat using your headset.

Advanced features

To speed up future connections you can create a short cut on your desktop. After connecting the headset and your PC right click the icon labeled "Philips SHB6100" and choose "Save connection as shortcut" from the menu.

For additional information please check your Software's online help.

Control your music

To adjust the volume of music use the **VOL +** and **VOL -** key on your Bluetooth headset.

The following functions are only supported with devices that support the Audio Video Remote Control Profile (AVRCP) such as Bluetooth enabled PC's, typical Bluetooth stereo enabled mobile phones and many proprietary, non-3.5mm Bluetooth audio adapters. Universal 3.5mm Bluetooth audio adapters will not support these features.

- To stop music playing press the multi function button for 2 seconds, to pause tap the multi function button briefly.
- To skip forward to the next song press the skip forward button. Pressing the skip backward button once will take you to the beginning of the current song, pressing it twice will take you to the beginning of the previous song.

Wearing your headset

EN

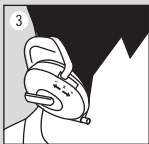
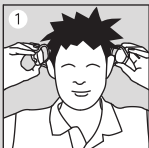

The OptiFit neckband features an ergonomically optimized hinge, carefully placed in the center of the ear shell for optimum wearing comfort, and the best sound performance that results from the best possible speaker placement on your ear.

To personalize the fit of your headset adjust the ear loops onto the largest position marked with “L”. Pick up the headset with both hands with the microphone pointing away from you and lower the headset on your ears. While wearing the headset personalize the fit by moving the ear loop adjustment markers up and down to the position optimal for you.

If you bought the SHB6102 with the included Bluetooth audio adapter you can use the included stretch-pouch to attach the audio adapter to your music player for portable use.

Specifications

- Up to 12 hours of talk time or 10 hours of continuous music listening
- Up to 260 hours of standby time
- Typical time for a full charge: 3 hours
- Rechargeable Li-Po battery
- Operating range up to 33 feet (10 meters)
- Bluetooth 1.2, Bluetooth stereo (A2DP – Advanced Audio Distribution Profile) support, Audio Video Remote Control Profile support (AVRCP), Headset (HSP) and Handset Profile (HSP) support.
- OptiFit ergonomic design.
- Switchstream: switch between music and calls
- Music control buttons

Health and safety

Using this headset with both ears covered may be illegal in some countries while driving. For your safety avoid distractions from music or phone calls while in traffic or other potentially dangerous environments.

Using this headset continuously at full volume may damage your hearing!

Troubleshooting

EN

<i>Problem</i>	<i>Possible cause</i>	<i>Solution</i>
<i>Bluetooth headset does not switch on.</i>	<i>Battery is very low.</i>	<i>Charge your Bluetooth headset.</i>
<i>No connection to mobile phone.</i>	<i>Bluetooth disabled.</i>	<i>Enable Bluetooth on your mobile phone and turn the headset on.</i>
<i>Mobile phone cannot find headset</i>	<i>Headset may not be in pairing mode. (Pairing mode lasts for 3 min.)</i>	<i>Put your headset in pairing mode as described above.</i>
	<i>Pairings may have been reset or headset has been previously paired with other device.</i>	<i>Start the pairing process as describe above.</i>
<i>Redialing does not work.</i>	<i>Your mobile phone may not support this feature.</i>	
<i>Voice dialing does not work.</i>	<i>Your mobile phone may not support this feature.</i>	
<i>The headset is connected to the Bluetooth stereo enabled phone, but music will play on phone only.</i>	<i>Phone may have option to listen to music via speaker or headset.</i>	<i>Check your phones user guide on how to transfer the music to the headset. ("A/V headset, A2DP headset, Bluetooth Stereo headset" etc.)</i>
<i>Audio quality when streaming from phone is very low.</i>	<i>Phone may not be A2DP compatible and only support (mono) HSP/HFP.</i>	<i>Check your phones compatibility.</i>

Please visit www.philips.com/support for additional support.

Federal Communication Commission Interference Statement

This device complies with Part 15 of the FCC Rules. Operation is subject to the following two conditions: (1) this device may not cause harmful interference, and (2) this device must accept any interference received, including interference that may cause undesired operation.

This equipment has been tested and found to comply with the limits for a Class B digital device, pursuant to Part 15 of the FCC Rules. These limits are designed to provide reasonable protection against harmful interference in a residential installation. This equipment generates, uses and can radiate radio frequency energy and, if not installed and used in accordance with the instructions, may cause harmful interference to radio communications. However, there is no guarantee that interference will not occur in a particular installation. If this equipment does cause harmful interference to radio or television reception, which can be determined by turning the equipment off and on, the user is encouraged to try to correct the interference by one or more of the following measures:

- Reorient or relocate the receiving antenna.
- Increase the separation between the equipment and receiver.
- Connect the equipment into an outlet on a circuit different from that to which the receiver is connected.
- Consult the dealer or an experienced radio/TV technician for help.

Warning: Changes or modifications made to this equipment not expressly approved by Philips may void the FCC authorization to operate this equipment.

IMPORTANT NOTE:

FCC Radiation Exposure Statement:

This equipment complies with FCC radiation exposure limits set forth for an uncontrolled environment. End users must follow the specific operating instructions for satisfying RF exposure compliance.

This transmitter must not be co-located or operating in conjunction with any other antenna or transmitter.

Trademarks

The Bluetooth word mark and logos are owned by the Bluetooth SIG, Inc. and any use of such marks by Koninklijke Philips Electronics N.V. is under license. Other trademarks and trade names are those of their respective owners.