

Avigo RC Coupe



Owner's Manual

The Owner's manual contains assembly, use and maintenance instructions. The Avigo RC Coupe must be assembled by an adult who has read and understands the instructions in this manual. Keep the packaging away from children and dispose all packaging before use. Keep instructions for future reference.

Thank You

Thank you for purchasing the Kid Trax Avigo RC Coupe. With the Avigo RC Coupe your child will have fun and enjoyment for years to come. Some of the features on the Avigo RC Coupe include: manual operation, 4-direction remote control (with parental password control), a forward and reverse shifter, a steering wheel with music and sound and lights simulating a real car.

Please call us at Kid Trax Toys Consumer Relations at **877-741-6154** with comments or questions.

Contents

Safety	1
Parts	2
Assembly	3
Front Wheel	3
Rear Wheel	4
Attaching the Steering Wheel	5
Attaching the Window Frame	6
Attaching the Roll Bar	7
Attaching the Seat	8
Use	9
Charging the Battery	9
Using the Controls	10
User Requirements	11
Operating the Vehicle	11
Manual Operation	11
Remote Operation	12
Maintenance	13
General	13
Battery	13
Re-Charge Interval and Time	15
Battery Storage	15
Battery Replacement and Disposal	16
Battery Fuse	17
Troubleshooting Guide	18
Services, Repairs and Parts	21
FCC Information	22

Safety

WARNING!

The following safety hazards may result in serious injury or death to the user of the Avigo RC Coupe:

- This product contains small parts that are for adult assembly only. Keep small children away when assembling. Remove and dispose of all protective material and poly bags before assembly. Be sure to remove all packaging materials and parts from underneath the cycle body.
- Riding the vehicle without a helmet. Riders must always wear a fitted helmet that complies with U.S. Consumer Product Safety Commission (CPSC) Standard CFR 1203.
- Body parts such as hands, legs, hair and clothing can get caught in moving parts. Never place a body part near a moving part or wear loose clothing while using the vehicle. Always wear shoes when using the vehicle.
- Using the vehicle near streets, motor vehicles, drop-offs such as: steps, water (swimming pools), sloped surfaces, hills, wet areas, flammable vapors, in alleys, at night or in the dark could result in an unexpected accident. Always use the vehicle in a safe, secure environment with continuous adult supervision.
- Using the vehicle in unsafe conditions such as snow, rain, loose dirt, mud, sand or fine gravel may result in unexpected action such as tip over and skidding.
- Using the vehicle in an unsafe manner. Examples include but are not limited to:
 - a. Pulling the vehicle with another vehicle or similar device
 - b. Allowing more than one rider
 - c. Pushing the user from the back
 - d. Traveling at an unsafe speed

Always use common sense and safe practices when using the vehicle.

Parts

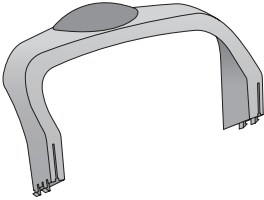

Roll Bar

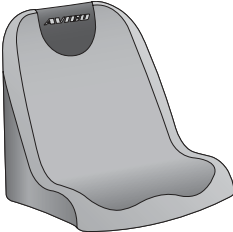

Seat

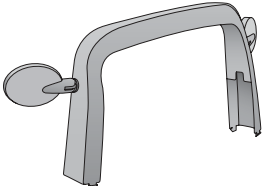

Window frame

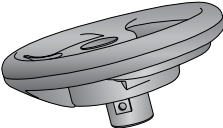

Steering wheel

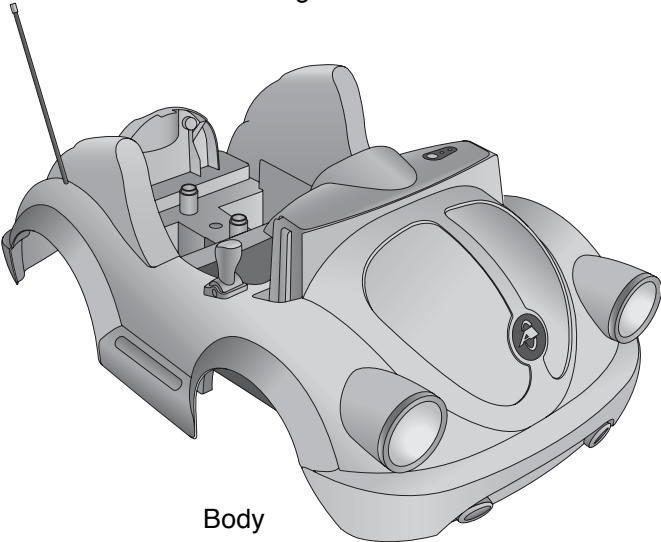

Body



Front wheel



Rear wheel

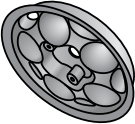

Wheel cover



Hub caps

Assembly

Front Wheel

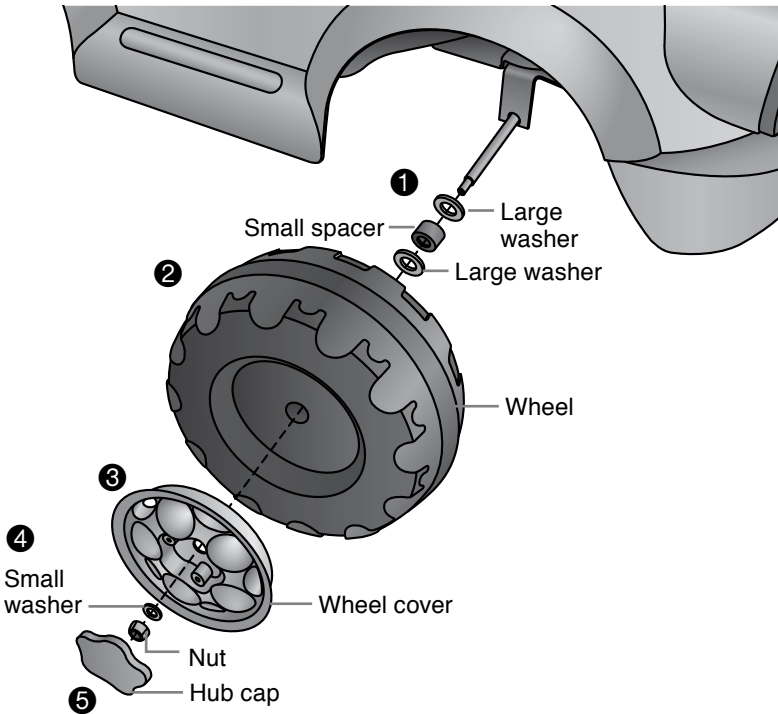

- 1 Slide a large washer, small spacer and large washer onto the axle as shown.
- 2 Locate a wheel marked **front**. Slide the wheel onto the axle with the word **front** facing in, toward the vehicle.
- 3 Align the four posts on the back of the wheel cover with the holes in the wheel and slide the wheel cover into the wheel.
- 4 Slide a small washer and then the nut onto the axle. Tighten the nut until it is snug. Do not overtighten.
- 5 Align the pins in the hubcap with the holes in the wheel cover and press in place

Note: Do not use a hammer. Repeat steps 1-5 to attach both front wheels.

Rear Wheel

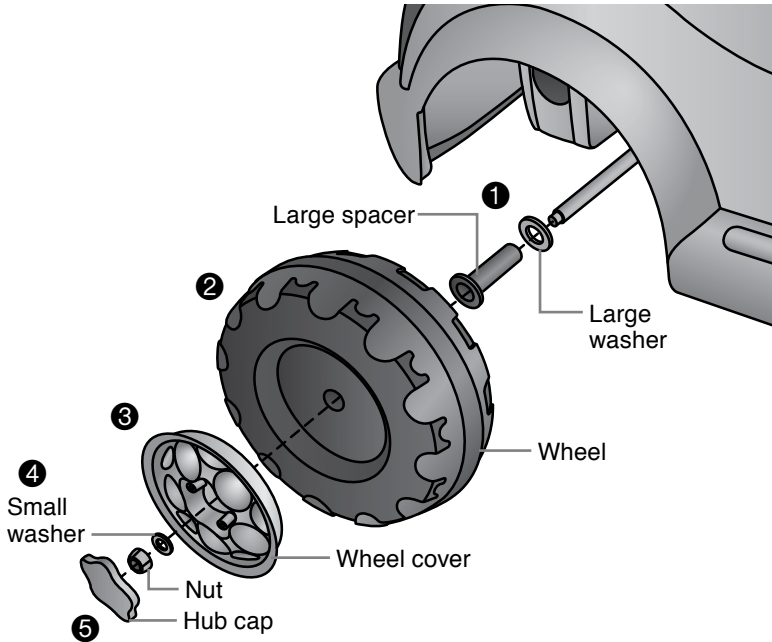

- 1 Slide a large washer and large spacer onto the axle as shown.

Note: On the motor side simply slide the wheel onto the axle and align the gear so it fits into the pocket. No washer or spacer is needed.

- 2 Locate a wheel marked **rear**. Slide the wheel onto the axle with the word **rear** facing in, toward the vehicle.
- 3 Align the four posts on the back of the wheel cover with the holes in the wheel and slide the wheel cover into the wheel.
- 4 Slide a small washer and then the nut onto the axle. Tighten the nut until it is snug. Do not overtighten.
- 5 Align the pins in the hubcap with the holes in the wheel cover and press in place

Note: Do not use a hammer. Repeat steps 1-5 to attach both rear wheels.

Attaching the Steering Wheel

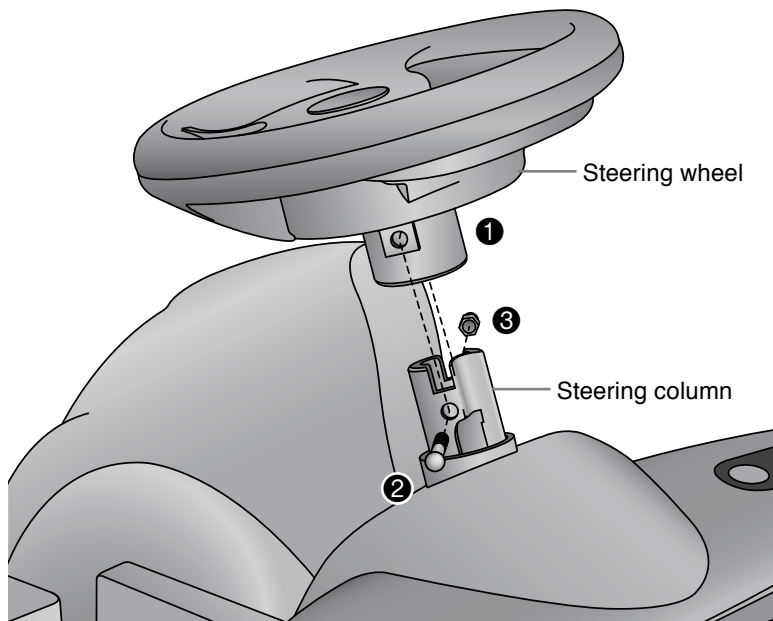

- 1 Place the steering wheel onto the steering column and line up the screw holes.
- 2 Insert the screw through the holes and thread the nut onto the screw.
- 3 Tighten the nut.

Attaching the Window Frame

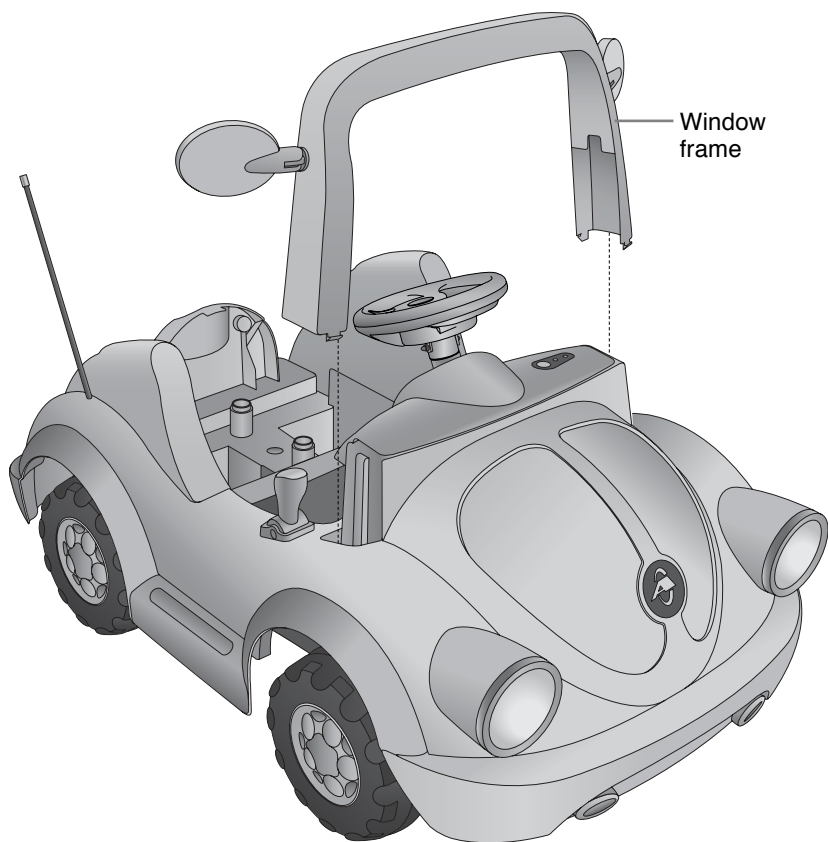

- 1 Place the window frame over the dashboard. Slide it into the slots on both sides until you hear the tabs lock into place.

Attaching the Roll Bar

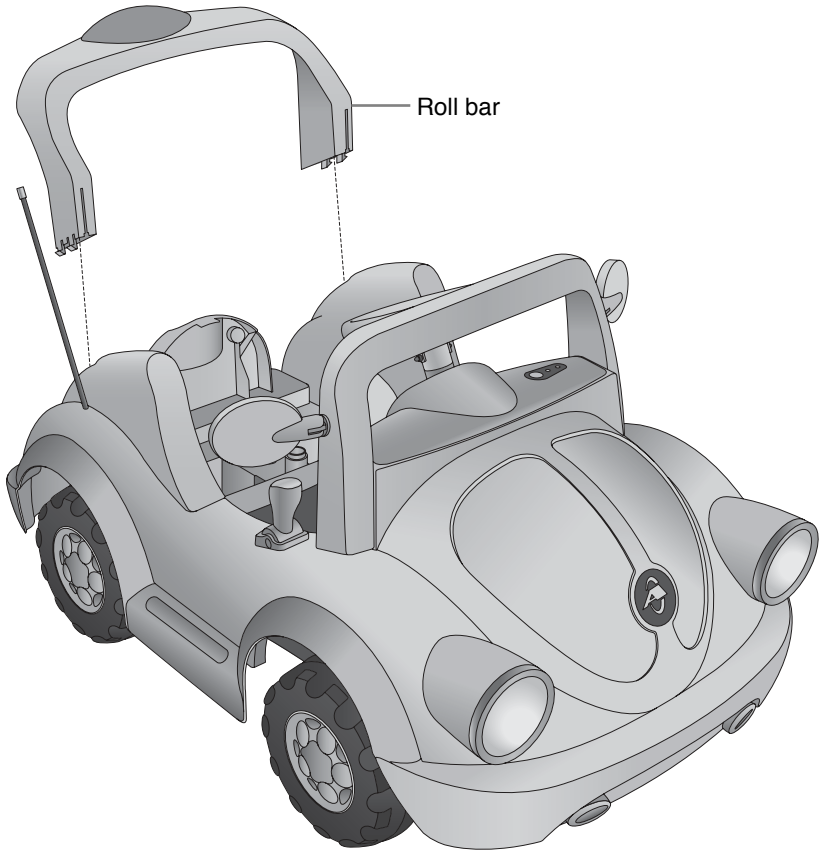

- 1 Place the Roll Bar between the rear wheels. Slide it into the holes on either side until you hear a click.

Attaching the Seat

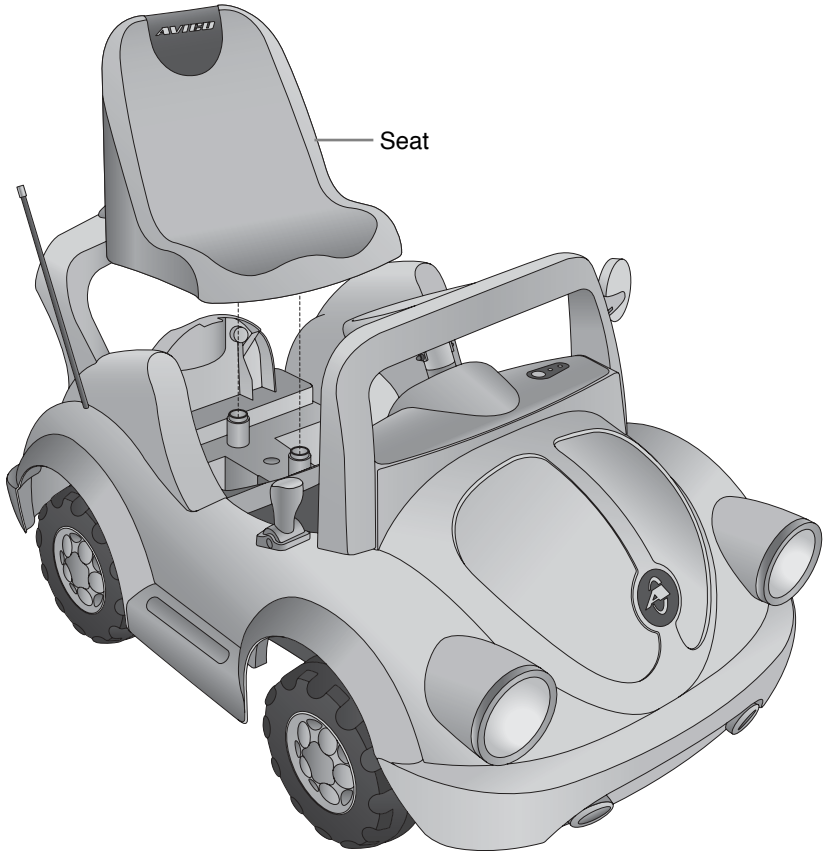

- 1 Locate hooks behind the seat.
- 2 Place and lock the seat down onto the hooks.
- 3 Secure the seat by screwing the plastic screw into body.

Use

Charging the Battery

Important! Before using the Avigo RC Coupe for the first time the battery needs to be charged for a full 24 hours. Only an adult who has read and understands the safety warnings should handle, charge or recharge of the battery (see Maintenance, Battery page 13 - 17).

Note: It is not necessary to remove the battery from the vehicle for charging. However, if the adapter cord will not safely reach a 120V wall outlet, the battery can be removed for charging (see page 16 for instructions concerning battery replacement).

- ❶ Open the rear cover. Carefully set it aside.
- ❷ Remove the battery cover.
- ❸ Unplug the battery connectors.
- ❹ Plug the charger connector into the battery. Only use the Kid Trax Toys 12V charger included with the Avigo RC Coupe (Input: AC120V~, 0.5A, 60Hz Output: DC14.2V, 1.5A).
- ❺ Plug the charger into a standard 120V wall outlet. The light on the charger will glow red.
Note: The charger may feel warm during charging. This is normal and not a cause for concern.
- ❻ After charging is complete (at least 16 hours, but not more than 30) unplug the charger from the wall outlet.
- ❼ Unplug the charger from the 12V battery.
- ❽ Re-connect the battery connectors. Make sure connection is tight.
- ❾ Replace the rear cover.

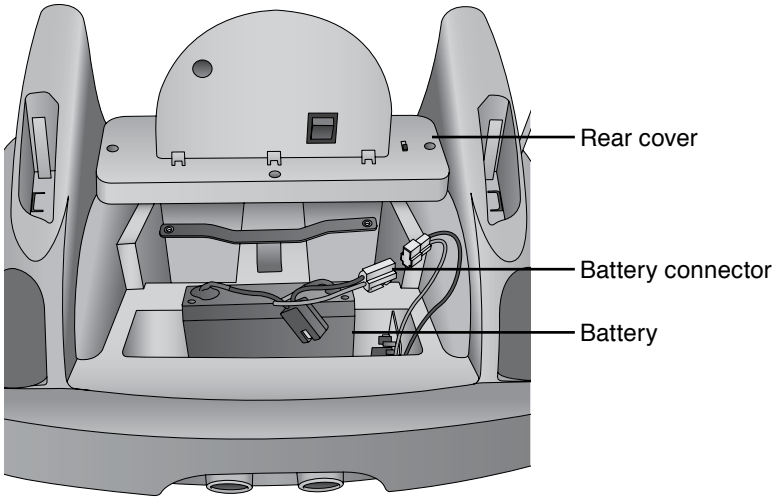

Using the Controls

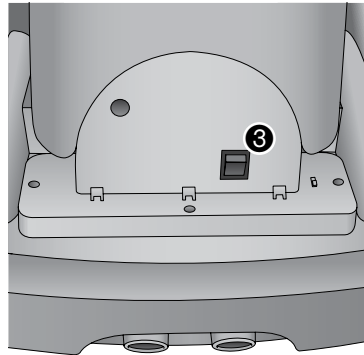
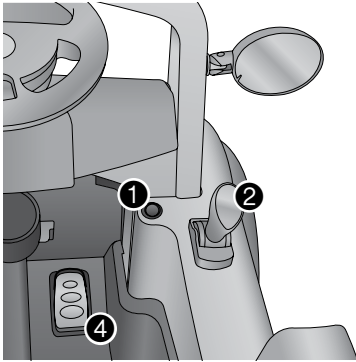

- 1 Power Switch: The power switch turns the vehicle **on** and **off**.
 - 2 Forward and Reverse Shifter: The shifter changes the direction the vehicle moves from forward to reverse.
 - 3 Manual/ Remote: The manual / remote button switches the vehicle control from manual to the remote.
- Note:** See Remote Control for more details on remote operation.
- 4 Foot Pedal: The foot pedal applies power (speed) the vehicle.

User Requirements

The suitable age range for a child using the Avigo RC Coupe is between 2 to 8 years old. The max. weight of the child is 76 lbs (35kg).

Before using the Avigo RC Coupe the child should understand the vehicle controls and safety issues. They must also demonstrate the capability to handle the vehicle and operate its controls. It is the responsibility of the adult to educate the child and supervise the vehicles use.

Here are basic safe riding rules you should read aloud to your child and playmates:

- Only use the vehicle when an adult is present to watch (supervise)
- Always sit in the seat when using the vehicle
- Keep your hands, hair and clothes away from moving parts
- Only one rider is allowed at a time
- Friends under 3 years old cannot use the vehicle
- Only drive on level ground. Don't go near water, drop-offs or up and down steep slopes.
- Don't drive the vehicle into loose dirt, mud, sand or fine gravel.
- Do not drive the vehicle on streets or near cars.

Operating the Vehicle

Manual Operation

- ① Child must be seated securely.
- ② Turn the power switch **on**.
- ③ Set the forward/reverse shifter to the desired direction.

Important! The vehicle must be completely stopped when shifting from forward to reverse or visa-versa. Failure to do so may damage the gears and motor.

- ④ Press on the foot pedal to apply power (speed) to the vehicle

Important! Removing foot from foot pedal will stop the vehicle.

Remote Operation

- 1 On the vehicle, switch the manual/remote switch to remote.
- 2 Turn the vehicle power switch **on**.

Remote Control Buttons

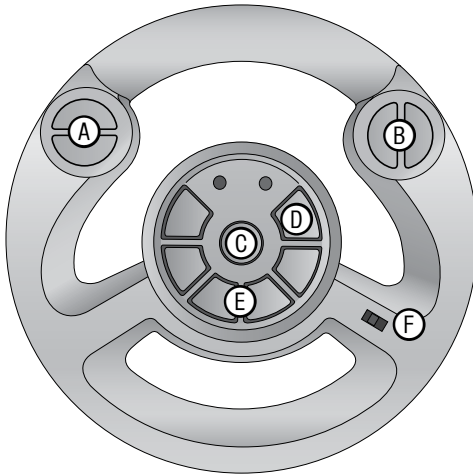

- (A) Forward/Reverse
- (B) Left/Right
- (C) Sound key (S)
- (D) Enter key (E)
- (E) Password keys (1-4)
- (F) Coding Switch (A-D)

- 3 Turn the remote power switch **on** (the Power LED should be red)
- 4 Move the Coding Switch on the remote to match the setting on the vehicle.
- 5 Enter the password for the remote (default password is 1134). The Setting LED should light up according to each press of the numeric keys.
Note: to reset the password, see Maintenance: Resetting the Remote Password
- 6 Press the Enter (E) key to confirm the password
- 7 Test the connection from the remote to the vehicle, see Troubleshooting for problem resolution.
- 8 Operate the vehicle.

Maintenance

General

The vehicle should be checked for damage, missing or badly worn parts before each use.

- Check the tightness of the fasteners before each use.
- Check the tightness of the wheel nuts. Use a flat head screwdriver to gently pry off the hubcap.

Note: If the wheel nuts are not tight the wheels will not engage the forward gears and the vehicle will not run.

- Ensure the battery bracket is securely in place before use
- Occasionally use lightweight oil to lubricate moving parts such as wheels and steering linkage. Do not use oil on plastic or nylon parts. No lubrication is required.
- Store the vehicle indoors or cover it with a tarp to protect it from the wet weather. Keep it away from sources of heat, such as stoves and heaters.
- Clean the vehicle with a soft, dry cloth. To restore shine to plastic parts, use a non-wax furniture polish. Do not use car wax, abrasive cleaners or wash the vehicle with soap and water. Water will damage the motor, electrical system and battery.
- Kid Trax Toys recommends that you take the vehicle to an authorized service center for periodic maintenance and service. Call Kid Trax Toys Consumer Relations at **877-741-6154** for an authorized service center.

Battery

Only an adult who has read and understands the safety warnings should handle, charge or recharge of the battery. Failure to comply with the following safety warnings may result in serious injury or death.

WARNING!

The following safety hazards may result in serious injury or death to the user of the Avigo RC Coupe:



- Use of a battery or charger other than the supplied Kid Trax Toys 12V rechargeable battery and charger may cause a fire or explosion. Only use the supplied Kid Trax Toys 12V rechargeable battery and charger with the vehicle.
- Using the Kid Trax Toys 12V rechargeable battery and charger for any other product may result in overheating, fire or explosion. Never use the Kid Trax Toys 12V rechargeable battery and charger with another product.
- Explosive gases are created during charging. Charge the battery in a well ventilated area. Do not charge the battery near heat or flammable materials.
- Contact between the positive and negative terminals may result in fire or explosion. Avoid direct contact between the terminals. Picking up the battery by the wires or charger can cause damage to the battery and may result in a fire. Always pick up the battery by its case or handles.
- Liquids on the battery may cause fire or electric shock. Always keep all liquids away from the battery and keep the battery dry.



- Contact or exposure to battery leakage (lead acid) may cause serious injury. If contact or exposure occurs immediately call your physician. If the chemical is on the skin or in the eyes, flush with cool water for 15 minutes. If the chemical was swallowed, immediately give the person water or milk. Do not give water or milk if the patient is vomiting or has a decreased level of alertness. Do not induce vomiting.

WARNING! (cont'd)

The following safety hazards may result in serious injury or death to the user of the Avigo RC Coupe:

- Battery posts, terminals and related accessories contain lead and lead compounds (acid), chemicals known to the State of California to cause cancer, reproductive harm and are toxic and corrosive. Never open the battery.



- Tampering or modifying the electric circuit system may cause a shock, fire or explosion and permanently damage the system. Exposed wiring, circuitry in the charger may cause electric shock. Always keep the charger housing closed.

Re-Charge Interval and Time

Important!

- Damage to the battery may occur if it is allowed to drain completely. Do not allow the battery to drain completely.
- Check the battery and charger (supply chord, connector) for wear and damage before charging. Do not charge the battery if damage has occurred. Only replace with a Kid Trax Toys 12V rechargeable battery and charger.

The battery should be charged after each use, or if not used regularly, once a month at a minimum. Charge the battery for a full 16 hours. Do not charge the battery for more than 30 hours. Failure to charge the battery as directed would cause permanent damage to the battery and void the warranty.

Battery Storage

Do not leave the battery connected in the vehicle for long period of times while not being used. This may drain the battery completely and cause permanent damage. Disconnect the battery connectors from the battery when the vehicle is not going to be used for a long period of time.

It is best to leave the battery in the battery compartment when the vehicle is being stored for long periods. Follow these guidelines if the battery is removed:

- Store the battery where temperatures are between -10° F (-24° C and 75° F (24° C)
- Store the battery on a wood surface. Do not place the battery on cement floors for extended periods. This will result in battery discharge.
- Wipe the battery clean with a dry cloth prior to storage.
- Charge the battery once every month for 16 hours.

Battery Replacement and Disposal

The Kids Trax Toys 12V battery will eventually lose the ability to hold a charge. Depending on the amount of use, and varying conditions, the battery should operate for one to three years.

Follow these steps to replace and dispose the battery:

- ➊ Remove the seat.
- ➋ Remove the rear cover
- ➌ Disconnect the battery connectors
- ➍ Remove the metal battery bracket
- ➎ Carefully lift the battery.
 - Depending on the condition of the battery (i.e.: leakage) you may want to wear protective gloves before removal
 - Do not lift the battery by its connectors or cables
- ➏ Place the dead battery in a plastic bag.

Important! Recycle the dead battery responsibly. The battery contains lead acid (electrolyte) and must be disposed of properly and legally. It is illegal in most areas to incinerate lead acid batteries or dispose of them in landfills. Take it to a federally or state-approved lead acid battery recycler, such as a Kid Trax Toys authorized service center or your local automotive battery retailer. Do not throw the battery away with your regular household trash!
- ➐ Replace the battery with a Kid Trax Toys 12V battery and reconnect the connectors.
- ➑ Replace the metal battery bracket
- ➒ Replace the rear cover
- ➓ Replace the seat

Battery Fuse

The Kid Trax Toys 12V battery features a thermal fuse with a reset fuse on the circuit board that will automatically trip and cut all power to the vehicle if the motor, electric system or battery is overloaded. The fuse will reset and power will be restored after the unit is turned **off** and turned **on** again. If the thermal fuse trips repeatedly during normal use, the vehicle may need repair. Call Kid Trax Toys Consumer Relations at **877-741-6154** for an authorized service center.

To avoid losing power, follow these guidelines:

- Do not overload the vehicle
- Do not tow anything behind the vehicle
- Do not drive up steep slopes
- Do not drive into fixed objects, which may cause the wheels to spin, causing the motor to overheat.
- Do not drive in very hot weather; components may overheat.
- Do not allow water or other liquids to come in contact with the battery or other electric components.
- Do not tamper with the electric system. Doing so may create a short, causing the fuse to trip.

Resetting the Remote Password

Follow these steps if you need to change reset the password:

- ① Open the battery compartment in the remote.
- ② Press and hold the reset button for 3 seconds (the Setting LED will flash green)
- ③ Press the **Enter** key (the Setting LED will be constant green for 3 seconds, then flash)
- ④ Press the numeric keypads to enter the new password
- ⑤ Press the **Enter** key to confirm
- ⑥ Password should be reset and the Setting LED should be constant green.

Troubleshooting Guide

The following are examples of potential problems. Completely read through this manual and the troubleshooting guide table before calling Kid Trax Toys Consumer Relations. If you still need help resolving the problem please call **877-741-6154**.

Kid Trax Toys recommends that you take the vehicle to an authorized service center for periodic maintenance and service. Call the number listed above for the closest center to you.

Problem	Possible Cause	Remedy
Vehicle does not run	Battery low on power	Recharge batter (see Battery: Recharge Interval and Time)
	Thermal fuse has tripped	Reset fuse (see Maintenance: General)
	Wheel nuts are loose	Tighten wheel nuts (see Maintenance: General)
	Battery connector or wires are loose	Check that the battery connectors are firmly plugged into each other. If wires are loose around the motor call Consumer Relations at 877-741-6154 for an authorized service center
	Battery is dead	Replace battery (see Battery: Replacement and Disposal)
	Electrical system is damaged	Call Consumer Relations at 877-741-6154 for an authorized service center
	Motor is damaged	Call Consumer Relations at 877-741-6154 for an authorized service center

Problem	Possible Cause	Remedy
Vehicle does not run very long	Battery is under charged	Check that the batter connectors are firmly plugged into each other when recharging (see Batter: Recharge Interval and Time)
	Battery is old	Replace battery (see Battery: Replacement and Disposal)
Vehicle runs sluggishly or beeping occurs	Battery low on power	Recharge battery (see Battery: Recharge Interval and Time)
	Battery is old	Replace battery (see Battery: Replacement and Disposal)
	Vehicle is overloaded	Reduce weight on vehicle (see User Requirements and Safety Warnings)
	Vehicle is being used in harsh conditions	Operate the vehicle level ground and firm surfaces (see User Requirements and Safety Warnings)
Vehicle needs a push to go forward	Poor contact of wires or connectors	Check that battery connectors are firmly plugged into each other. If wires are loose around the motor call Consumer Relations at 877-741- 6154 for an authorized service center

Problem	Possible Cause	Remedy
Vehicle needs a push to go forward (cont'd)	"Dead Spot" on motor	A dead spot means the electric power is not being delivered to the terminal connection and the vehicle needs repair. Call Consumer Relations at 877-741-6154 for an authorized service center
Difficult shifting from forward to reverse or visa-versa	Attempting to shift while the vehicle is in motion	Completely stop the vehicle and shift (see Use: Manual Operation)
Loud grinding or clicking noises coming from motor or gear box	Motor or gears are damaged	Call Consumer Relations at 877-741-6154 for an authorized service center
12V Battery will not recharge	Battery connector or adapter connector is loose	Check that battery connectors are firmly plugged into each other
	Charger not plugged in	Check that battery charger is plugged into a working wall outlet
	Charger is not working (lights not glowing)	Call Consumer Relations at 877-741-6154 for an authorized service center
Battery bubbles or gurgles when charging	This is normal and not a cause for concern	
Charger feels warm when recharging	This is normal and not a cause for concern	

Services, Repairs and Parts

Do not return this product to the place of purchase. If your Avigo RC Coupe needs service, repairs or replacement parts, call:

Kid Trax Toys Consumer Relations

Hours: 8:00am – 5:00pm (CST) Monday - Friday

Phone: **877-741-6154**

Email: customerservice@kidtraxtoys.com

Web: www.kidtraxtoys.com

For service and repairs you will be directed to an authorized service center. To order parts have the model and serial number, found underneath the vehicle body and a brief description of the part. The following is a list of available replacement parts:

- Front wheel
- Rear wheel
- Wheel cover
- Hub caps
- Hardware bag for wheel assembly
- Hardware bag for dash and steering column
- Seat
- Hood
- 12-volt battery
- Charger
- Key fob
- Mirrors
- Steering Wheel

FCC Information

This device complies with part 15 of the FCC Rules.

Operation is subject to the following two conditions (1) this device may not cause harmful interference, and (2) this device must accept any interference received, including interference that may cause undesired operation.

This equipment has been tested and found to comply with the limits for a Class B digital device, pursuant to Part 15 of the FCC rules. These limits are designed to provide reasonable protection against harmful interference in a residential installation.

This equipment generates, uses and can radiate radio frequency energy and, if not installed and used in accordance with the instructions, may cause harmful interference to radio communications. However, there is no guarantee that interference will not occur in a particular installation. If this equipment does cause harmful interference to radio or television reception, which can be determined by turning the equipment off and on, the user is encouraged to try to correct the interference by one or more of the following measures:

- Reorient or relocate the receiving antenna.
- Increase the distance between the equipment and the receiver.
- Consult dealer or an experienced radio/TV technician for help.

Changes or modifications not expressly approved by the party responsible for compliance could void the user's authority to operate the equipment.

Warranty

One-Year Limited Warranty

Six-Month Limited Warranty on Battery

Pacific Cycle, Inc. (PC) warrants this product to the original retail purchaser as follows:

The vehicle (except for the 12-volt battery) is warranted against defective materials or workmanship for one year from the date of original purchase. The 12-volt battery is warranted against defective materials or workmanship for six months from the date of original purchase. An original receipt is required to validate your warranty. PC will, at its option, provide replacement parts or replace this product. PC reserves the right to substitute if the part or model has been discontinued.

To make a claim under this warranty you may contact us at www.kidtraxtoys.com; fax us at **1-800-207-8182**, 24 hours a day; write to Kid Trax Consumer Relations Department, Kid Trax Toys, P.O. Box 344 Olney, IL 62450 or call **1-877-741-6154** from 8 a.m. to 5 p.m., Monday through Friday, CST. **Proof of purchase is required, and shipping charges are the responsibility of the consumer.**

Warranty Limitations

This warranty does not include damages which arise from accident, misuse, abuse, neglect or other causes not arising out of defects in materials or workmanship, nor does it cover damages arising out of service by other than an authorized PC service center. For personal use only. Not for commercial use. The original owner shall pay all labor charges connected with the repair or replacement of all parts. Under no circumstances does this limited warranty include the cost of shipment or transportation to or from an authorized Kid Trax repair center or Kid Trax retailer.

Limitation of Damages:

The warranty and remedies as set forth are exclusive and in lieu of all others, oral or written, expressed or implied. In no event will PC or the dealer selling this product be liable to you for any damages, including incidental or consequential damages, arising out of the use or inability to use this product. Some states do not allow limitations as the exclusion or limitation of incidental or consequential damages, so the above limitation may not apply to you.

Limitation of Warranties and Warranty Terms

Any implied warranties, including implied warranties of the merchantability and fitness for a particular purpose, shall be limited to the duration and terms of the express written warranty. Some states do not allow limitations as the exclusion or limitation of incidental or consequential damages, so the above limitation may not apply to you. This warranty gives you specific legal rights, and you may have other rights, which vary from state to state. Neither PC nor the dealer selling this product authorized any person to create for it any other warranty, obligation or liability in connection with this product.

Contact Information

If you have any questions or comments please contact us at:

In U.S.A.
Pacific-Cycle Inc.
4902 Hammersly Rd.
Madison, WI 53711

Customer Service:
877-741-6154
customerservice@kidtraxtoys.com
www.kidtraxtoys.com

©2008 Harley-Davidson, All Rights Reserved.
Distributed by Toys"R"US. Inc.
Under License from Harley-Davidson Motor Company

©2008 Geoffrey, Inc.
Distributed by Toys "R" US. Inc. Wayne, NJ 07470
Made in China