

SoftBank 001P  
English User Guide



SoftBank

# Introduction

**Thank you for purchasing SoftBank 001P.**

- For proper handset use, read User Guide (this guide).
- Accessible services may vary by service area, subscription, etc.

**SoftBank 001P is compatible with both 3G and GSM network technologies.**

## Note

- Unauthorized copying of any part of this guide is prohibited.
- Guide content is subject to change without prior notice.
- Efforts have been made to ensure the accuracy and clarity of this guide. Please contact SoftBank Mobile Customer Center, General Information (☎ P.XX-XX) about unclear or missing information.

# Getting Started

## Contents

### Getting Started

Contents .....	1-1
Package Contents .....	1-2
Using This Guide .....	1-2
Using This Manual .....	1-3
USIM Card Installation .....	1-5
Charging Battery .....	1-6
microSD Card Installation.....	1-7
Parts & Functions.....	1-8
Basic Operations.....	1-10
Display.....	1-11
Function List.....	1-13
Handset Security .....	1-14
Mobile Manners.....	1-15
Touch Panel Operations .....	1-16

### Universal Operations, etc.

Text Entry.....	2-1
Entering Text.....	2-2
Editing Text.....	2-4
Text Entry in Touch Panel .....	2-5

### Calling

Emergency Calls .....	3-1
Voice Calls .....	3-1
Video Calls.....	3-4
Answer Phone.....	3-5
Optional Services .....	3-5
Phone Book .....	3-10

### Messaging

Basics.....	4-1
Customizing Handset Address .....	4-2
Sending S! Mail & SMS.....	4-3
Receiving Messages .....	4-4
PC Mail .....	4-6

### Internet

Getting Started .....	5-1
Yahoo! Keitai .....	5-1
Browsing PC Sites.....	5-2
Internet Settings .....	5-3

### Connectivity

Infrared.....	6-1
Bluetooth® .....	6-3
Wi-Fi (Wireless LAN) .....	6-6
External Devices .....	6-9

### Camera & Imaging

Before Using Camera.....	7-1
Capturing Still Images.....	7-4
Recording Videos.....	7-5
Other Camera Functions.....	7-5

### Others

Digital TV.....	8-1
Picture Album .....	8-5

### Appendix

Handset Data Backup.....	9-1
Software Update .....	9-2
Troubleshooting.....	9-3
Safety Precautions.....	9-5
Handling Precautions .....	9-11
Copyrights and Others.....	9-16
Specific Absorption Rate (SAR) .....	9-19
Specifications .....	9-20
Support.....	9-20

## Getting Started

---

### Package Contents

□ Handset (001P)

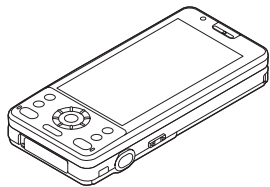

□ Battery (PMBAS1)

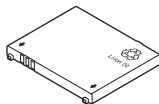

□ Quick Start Guide (Japanese)

□ Safety Precautions (Japanese)

#### Note

- Use SoftBank specified AC Charger (sold separately) to charge battery.
- 001P accepts microSD Card (not included). Purchase microSD Card to use related functions.

### Using This Guide

**Before reading this guide, make a note of the following:**

- In this guide, SoftBank 001P User Guide, SoftBank 001P is referred to as "handset" or abbreviated as "001P."
- "microSD Card" and "microSDHC Card" are referred to as "microSD Card" in this guide.
- Sample screenshots, etc. are provided for reference only. Actual handset windows, menus, etc. may differ in appearance.
- Key icons use simplified labels.
- Most operation descriptions begin in Standby.
- Pressing a key for more than one second is described as "Press and hold."

## Getting Started

# Using This Manual

## Guide Symbols

### Softkeys

Press the corresponding key to execute the function or operation indicated at the bottom of Display.

Example:

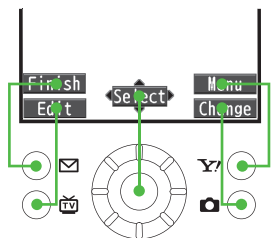

### Speed Selector

Use Speed Selector to select items, navigate menus, etc. In this guide, Speed Selector operations are indicated as shown below.

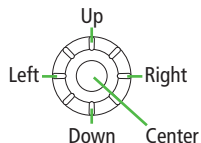

Up	Up/Down	Up/Down/Left/Right
Down	Left/Right	Center
Left		
Right		

### Available Operations

- Select items
- Move cursor
- Scroll pages
- Adjust volume in volume control windows
- Adjust Camera zoom
- Toggle still images



Example 1:  
Selecting Items



Example 2:  
Moving Cursor

### Operation From Standby

From Standby, rotate Speed Selector to open Key Guidance.

## Japanese Functions & Services

When "(Japanese)" appears in a title, Japanese ability is required to use full range of the function or service.

## Getting Started

### Operation Descriptions

- The following examples are for reference only and may differ from actual operations.

#### Basic Operations

Operations are expressed as shown here.

Example 1:

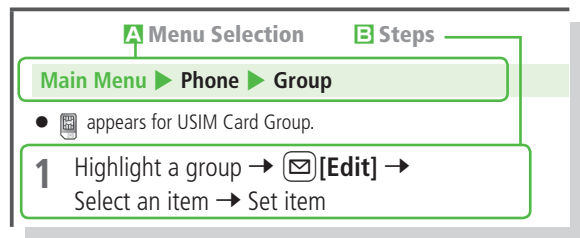

#### A Menu Selection

- 1 Press in Standby to open Main Menu.
- 2 Use to highlight **Phone**; then press [Select].
- 3 Use to highlight **Group**; then press [Select].

#### B Steps

- 1 Use to highlight a group; then press [Edit].
- 2 Use to highlight an item; then press [Select].
- 3 Set respective items.

Example 2:

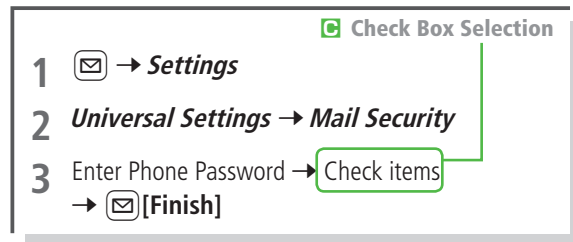

#### C Check Box Selection

- 1 Use to highlight an item; then press .  
Check Box changes to .
- 2 To deselect an item, use to highlight item; then press .  
Check mark disappears.

## Getting Started

### USIM Card Installation

- Always turn off handset power before removing battery.  
(Battery Installation: ☞ P.XX)

#### Inserting

- 1 With IC chip down, insert USIM Card

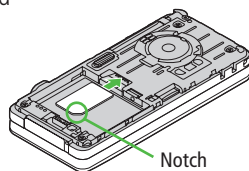

#### Removing

- 1 Slide out USIM Card gently

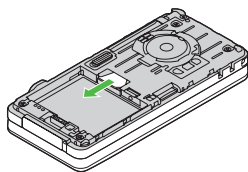

#### Important

- USIM Card is the property of SoftBank.
- Return USIM Card to SoftBank upon service cancellation.
- USIM Card will be reissued for a fee if lost or damaged.
- If USIM Card/handset with USIM Card inserted is lost or stolen, contact SoftBank Mobile Customer Center or Global Call Center (☞ P.XX).
- Back up USIM Card files. SoftBank is not liable for lost files.
- USIM Card specifications/performance may change without prior notice.
- Pre-installed S! Appli may be unusable while a different or replacement USIM Card is inserted into handset.
- Returned USIM Cards are recycled.

#### Note

- Some downloaded files may be inaccessible after upgrades/repairs, USIM Card/handset replacement.

## Getting Started

# Charging Battery

## Battery Installation

- Always turn off handset power before removing Battery Cover.

### 1 Press and slide to remove cover

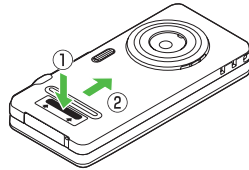

### 2 Insert Battery

Align battery contacts with handset pins

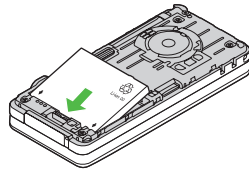

### Remove Battery

Lift battery out as shown

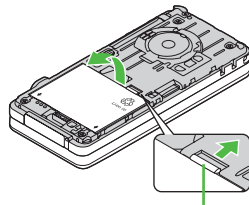

### 3 Replace battery cover

Cover should click into place

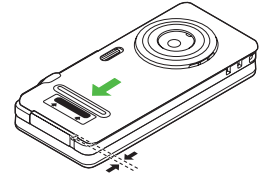

#### Note

- Lithium-ion batteries are valuable and recyclable resources.
  - Recycle used lithium-ion battery at a shop displaying the symbol shown to the right.
  - To avoid fire or electric shock, do not:
    - Short-circuit battery
    - Disassemble battery



Li-ion 00



## Getting Started

### Charging Battery

Use only specified AC Charger (sold separately).

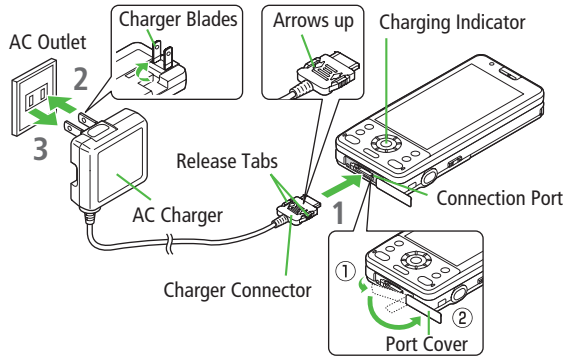

- 1 Connect AC Charger to Handset
- 2 Extend Charger Blades, and plug AC Charger into AC Outlet  
Charging Indicator illuminates and charging starts.  
When charging is complete, Charging Indicator goes out.
- 3 When charging is complete, unplug AC Charger from AC Outlet, then disconnect handset  
Squeeze Release Tabs and pull straight out to remove Charger Connector.

### microSD Card Installation

001P is compatible with up to 2 GB commercial microSD Cards and up to 16 GB commercial microSDHC Cards (as of December 2010).

- Turn off handset before inserting/removing microSD Card. (Battery Installation: P.XX)

#### Inserting

- 1 Insert microSD Card until it clicks

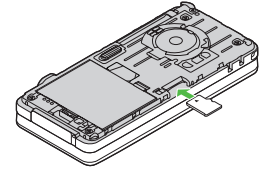

#### Format microSD Card

- > Main Menu ► Tools ► microSD Backup ► [Menu] ► *microSD format*  
► Enter Phone Password ► **YES**

#### Removing

- 1 Push microSD Card in
  - microSD Card pops out with a light push.

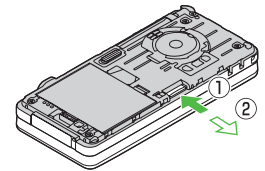

## Parts & Functions

### Handset

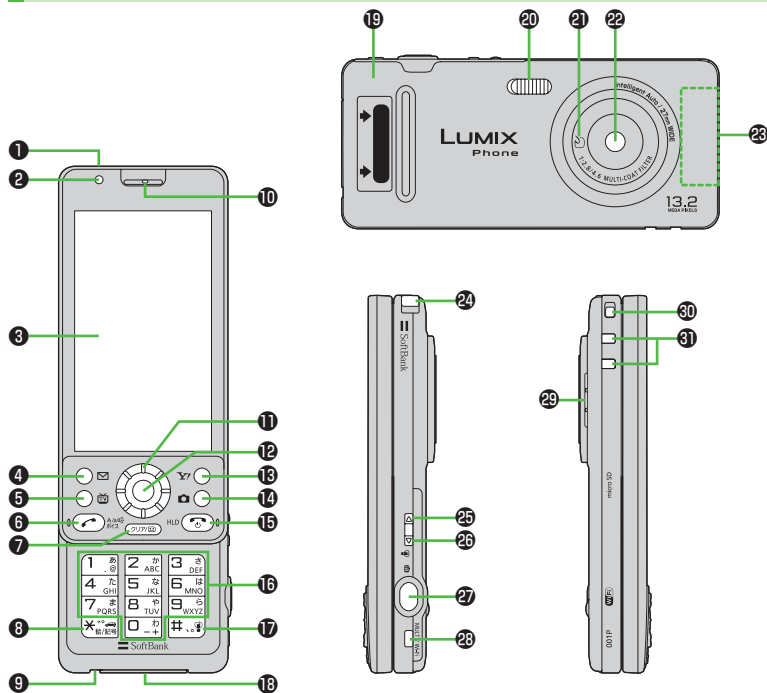

### Opening/Closing Handset

Slide Display up/down.

Do not touch keypad when opening/closing handset; may cause malfunction.

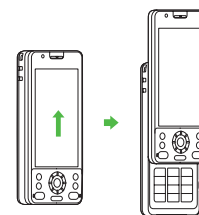

### Using Earphone Microphone or Video Output Cable

(A) Earphone Microphone or Video Output Cable

(B) Stereo Earphone Conversion Cable

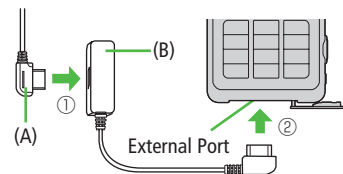

## Getting Started

### 1 Infrared Port

- Transfer data via Infrared

### 2 Light Sensor

- Detects ambient light

### 3 Display/Touch Panel

### 4 Mail Key

- Open Messaging menu
- Execute Upper Left Softkey function

### 5 TV Key

- Activate TV
- Execute Lower Left Softkey function

### 6 Send Key

- Initiate or answer calls
- Toggle upper/lower case in text entry windows

### 7 Clear/Memo Key

- Delete characters
- Cancel menus
- Use Answer Phone

### 8 \* /Pictograph/Symbol/Driving Mode Key

- Enter " \* "
- Access pictographs/symbols/smiley/URLs in text entry windows
- Toggle Driving Mode On/Off

### 9 Microphone

### 10 Earpiece

### 11 Speed Selector

- Move cursor or select menus

### 12 Notification Light/Charging Indicator

- Flashes for incoming transmissions
- Lights in red for charging

### 13 Yahoo! Keitai Key

- Open Yahoo! Keitai top menu
- Execute Upper Right Softkey function

### 14 Camera Key

- Activate Camera
- Execute Lower Right Softkey function

### 15 End/Escape & Power Key

- Power on/off ( P.P.XX)
- End calls
- Return to Standby

### 16 Keypad

- Enter phone number/text

### 17 #/Manner Key

- Enter "#"
- Toggle Manner Mode

### 18 External Port

- Connect AC Charger, Stereo Earphone Conversion Cable or other accessories here

### 19 Battery Cover

### 20 Flash

- Lights/flashs during Camera use
- Use when shooting in dark places

### 21 Logo

- Place Logo over a reader/writer when using Osaifu-Keitai®

### 22 Camera

### 23 Antenna

### 24 TV Antenna

### 25 Upper Side Key

- Increase earpiece/TV volume
- Activate Slideshow

### 26 Lower Side Key

- Decrease earpiece/TV volume
- [Closed Position]

- Set/cancel Manner Mode

### 27 Shutter Key

- Activate Camera
- Capture still images/videos

### 28 (MULTI/Wi-Fi) MULTI/Wi-Fi Key

- Open TASK MENU
- Toggle Wi-Fi function On/Off

### 29 Speaker



### 30 Strap Eyelet

### 31 Charging Terminals

## Getting Started

# Basic Operations

## Power On/Off

- 1 Press and hold  Start-up window and waterproof precautions appear and handset enters Standby.
  - Enter PIN if PIN Authentication is ON (☞ P.XX).
- 2 Press  for 2+ seconds Handset shuts down.
  - Do not turn on handset immediately after turning off. Wait a few seconds.





## Initial Setup

The first time handset powers up and Initial setting window appears, select **YES** and set the following: (Each item can be set separately.)

Date & Time*	Set date and time
Phone Password	Enter 9999, and enter new Phone Password (4-8 digits)
Key Tone	Select <b>ON</b> or <b>OFF</b>
Font Size	Set Display font size all at once

\* May be automatically set

## Retrieving Network Information

When , ,  or  is pressed for the first time in Standby, handset may initiate Network Information retrieval; press  to retrieve it.

- Update Network Information to use messaging, Internet, etc.
- Update Network Information manually: **Main Menu** ▶ **Settings** ▶ **Connectivity** ▶ **Retrieve NW Info** ▶ **YES**

## English Interface

**Main Menu** ▶ **設定** ▶ **ディスプレイ設定** ▶ **Language** ▶ **English**

## Date & Time

**Main Menu** ▶ **Settings** ▶ **Date & Time** ▶ **Date & Time**

- 1 Enter year → Enter date → Enter time → time zone → to select a time zone → My Number

## My Number

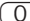
- 1  → 

# Display

## Icons & Indicators



### 1 Display Indicators

#### Signal Strength

📶 Strong 📶 Moderate 📶 Weak 📶 Low

🔌 Offline Mode Active

OUT Out-of-Range

📶 3G/GSM Packet Transmitting

📶 / 📶 3G/GSM Packet Transmission Available  
(Appears only while abroad)

- 📶 Wi-Fi On (Out-of-Range)
- 📶 / 📶 Keitai Wi-Fi/Direct Access Available  
(In-Range/Transmitting)
- 📶 / 📶 Direct Access Available  
(In-Range/Transmitting)
- 🔒 Secure Content
- 💻 PC Site Browser Active
- 🌐 Direct Browser Active
- 📶 Infrared Transmission
- 🔌 USB Cable Connected
- 🔒 Keyguard Active
- 🔄 Software Update  
(Notification/Updating/Result)
- 141E 📧 Voice Mail
- 🔌 (Blue) Bluetooth® Device Connected
- 📶 microSD Card Inserted
- 📧 Unread Message
- 🔒 Manner Mode Active
- 📶 Digital TV Active

📺 During Timer Recording

📺 / 📺 Recording TV Program/Paused

Time

#### Battery Level

🔋 → 🔋 → 🔋 → 🔋 (Red)

🚗 Driving Mode

📞 / 📞 Answer Phone Active (Number of Recorded  
Messages (Voice Calls))

📺 / 📺 Answer Phone Active (Number of Recorded  
Messages (Video Calls))

### 2 Information Window (📧 P.XX)

## Getting Started

### Information Window

In Standby, Information window opens to notify of missed events. Select a notification to view/access information.

- 1 Highlight an item →  [Select]

Follow onscreen instructions.

Widgets and shortcuts re-appear when all items have been viewed.

#### Close Information Window

>  [Exit] /  /  → OK (Select **Confirm once** to show confirmation only once)

#### Open Information Window

> 

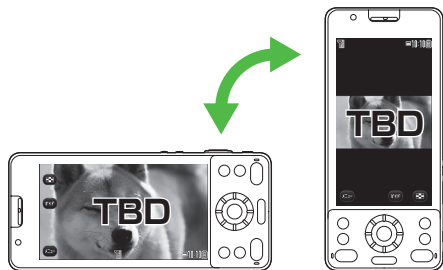

### Motion Control

Change handset orientation to switch Portrait/Landscape View.

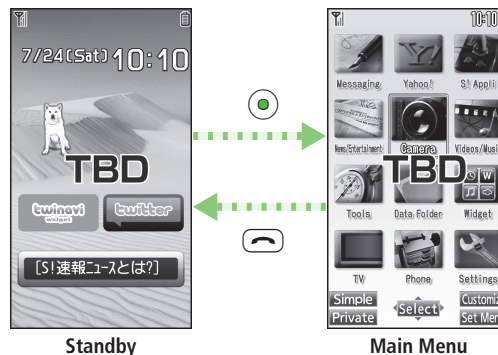

### Handset Menus



- 1 In Standby,   
Main Menu appears.
- 2  to highlight an icon →  [Select]  
Selected function menu appears.

● To return to Standby: 

#### Note

- Standby window returns after 15 seconds of inactivity in Main Menu.

## Getting Started

### Function List

<b>Messaging</b>
Incoming Mail
Create New
Retrieve New
Drafts
Templates
Sent/Unsent
Server Mail
Create New PC Mail
Create New SMS
Settings
Memory Status
<b>Yahoo!</b>
Yahoo! Keitai
Menu List
Bookmarks
Saved Pages
Web Search
Enter URL
History
PC Site Browser
Direct Browser
Set Yahoo! Keitai
Reset

<b>S! Appli</b>
S! Appli List
Osaifu-Keitai
S! Appli Settings
S! Appli History
Information
<b>News/Entertainment</b>
S! Info Ch./Weather
S! Quick News
Free Contents
S! Contents Store
Post Blog
<b>Camera</b>
Digicam Mode
Photo Mode
Video Camera
Picture Album
<b>Videos/Music</b>
Videos/Music
<b>Tools</b>
Alarms
Calendar
Calculator
Notepad

Tasks
Osaifu-Keitai
Dictionary
Sound Recorders
Bar Code Reader
Wi-Fi
S! GPS Navi
Bluetooth
Receive via Infrared
Music Player
microSD Backup
Picture Jump
Templates/User Dic.
Pedometer
<b>Data Folder</b>
Pictures
Ring Songs&Tones
S! Appli
Widget
Music
Videos
PC Movies
TV
Lifestyle-Appli
Books
Customized Screen

Templates
Font
Other Documents
<b>Mobile Widget</b>
Widget Store
Widget Contents
Settings
<b>TV</b>
Watch TV
Program List
Timer Watching
Timer Recording
Recording Result
TV Link
Channel List
Channel Setting
User Settings
<b>Phone</b>
Phone Book
Create New Entry
Call Log
Account Details
S! Addressbook BkUp
Group
Memory Manager
Restrictions

Settings
Memory Status
<b>Settings</b>
Sound Settings
Display Settings
Customized Screen
Incoming Settings
Phone Settings
Date & Time
Security
Call Settings
Video Call
International Call
Connectivity
Notification Light

## Getting Started

# Handset Security

## USIM PINs

There are two USIM Card security codes: PIN & PIN2

- PIN and PIN2 are set to **9999** by default.
- PIN/PIN2 can be changed (☎P.XX).

<b>PIN</b>	4 to 8-digit code used to prevent unauthorized handset use. <ul style="list-style-type: none"><li>● When PIN Authentication (☎P.XX) is <b>ON</b>, PIN entry is required each time handset is turned on (with USIM Card inserted).</li></ul>
<b>PIN2</b>	Required to clear call times/costs or set maximum cost (☎P.XX).

## PIN Authentication

**Main Menu** ► **Settings** ► **Security** ► **PIN Authentication**

Enter Phone Password → **PIN Authentication** → **ON** or **OFF** → Enter PIN

## PIN Lock & Cancellation (PUK/PUK2)

**PIN Lock or PIN2 Lock is activated if PIN or PIN2 is incorrectly entered three times. Cancel PIN Lock or PIN2 Lock by entering the PIN Unblocking Key (PUK/PUK2).**

### Note

- If PUK/PUK2 is incorrectly entered ten times, USIM Card is locked and handset is disabled. Write down PUK/PUK2.
- For procedures required to unlock USIM Card, contact SoftBank Mobile Customer Center, General Information (☎P.XX).

## Passwords

### Phone Password

<Default> 9999

**4 to 8-digit number required to use/change some handset functions.**

- Enter number within 15 seconds.
- \_ appears for each digit entered.

### Changing Phone Password

> **Main Menu** ► **Settings** ► **Security** ► **Change Phone Password**  
► Enter current 4 to 8-digit Phone Password ► Enter new 4 to 8-digit Phone Password ► **YES**

### Center Access Code Call Barring Password

**4-digit number specified at initial subscription; required to access Voice Mail via landlines, subscribe to fee-based information or restrict handset services.**

- Enter number within 15 seconds.
- If entered incorrectly three times, Security Code settings lock; Security Code & Center Access Code must be changed. Reach SoftBank Mobile Customer Center, General Information (☎P.XX) for details.



## Getting Started

### Mobile Manners

#### Minding Mobile Manners



Please use your handset responsibly. Use these basic tips as a guide. Inappropriate handset use can be both dangerous and bothersome. Please take care not to disturb others when using your handset. Adjust handset use according to your surroundings.

- Turn it off in theaters, museums and other places where silence is the norm.
- Refrain from use in restaurants, lobbies, elevators, etc.
- Observe signs and instructions regarding handset use aboard trains, etc.
- Refrain from use that interrupts the flow of pedestrian or vehicle traffic.

#### Manner-related Features

<b>Manner Mode</b>	Mute handset tones and activate vibration for incoming transmissions.
<b>Vibration Mode</b>	Activate in public places, meetings, etc. for silent call/message alerts.
<b>Ringer Volume</b>	Adjust call/message tones, etc.
<b>Offline Mode</b>	Suspend all handset transmissions.
<b>Answer Phone</b>	Use to handle incoming calls when inappropriate/unsafe to answer.
<b>Driving Mode</b>	While driving, send a voice message informing the caller that you cannot answer the call. (Handset does not ring.)

#### Manner Mode



- 1 In Standby, press and hold   
 appears.
  - To cancel: Press and hold  again

#### Offline Mode

[Main Menu](#) ► [Settings](#) ► [Call Settings](#) ► [Offline Mode](#)

- 1 **YES**  
 appears.
  - To cancel: Follow the same steps

#### Driving Mode

- 1 In Standby, press and hold   
 appears.
  - To cancel: Press and hold  again

# Touch Panel Operations

## Basic Operations

### Tap

Lightly touch Display

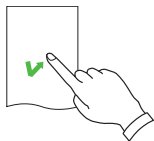

### Hold

Touch and hold Display

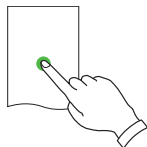

### Scroll

Slide up, down, left or right across Display

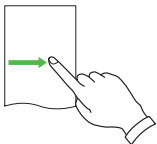

### Swipe

Swipe up, down, left or right across Display and release

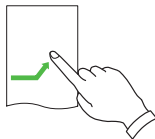

### Pinch

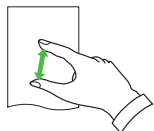

### Control Key and Slide Lever

- In Viewer Position, use Control Keys and Slide Levers for operations.
- Use Slide Lever to adjust volume/zoom. During video playback, use Slide Lever to change playback position.



### Touch Panel Operation Guide (Japanese)

#### View operation guide for Viewer Position.

- Available when handset language (言語設定) is set to 日本語 (☞ P.18-4).

#### 1 ㊦ tab → タッチガイド → Tap an item

- Tap **OK** when confirmation appears. Tap **OK (以後確認しない)** to hide confirmation.

## Getting Started

### Display Lock





Lock Display to disable Touch Panel Operations.

#### Display Lock Automatically Activates When:

Display enters Power Saver Mode.

Return handset to Normal Position to deactivate Display Lock.

### Canceling Display Lock

- 1 In Viewer Position,    
Display turns on.
- 2 Slide  to the right
  - Slide to  within 10 seconds

### Touch Panel Menus

TBD

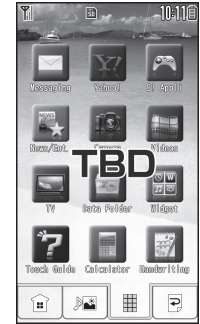

## Getting Started

### Main Menu

Messaging
Incoming
Create New
Retrieve
Drafts
Templates
Sent/Unsent
Server Mail
New PC Msg.
New SMS
Handwriting
Settings
Memory Stat

Yahoo!
Yahoo!
Menu List
Bookmarks
Saved Pages
Web Search
Enter URL
History
PC Site Brw
Direct Brw
Settings
Reset
S! Appli
Download S! Appli
News/Ent.
S! Info Ch.
S! News
Camera
Digicam
Pict. Album
Videos
—

TV
Watch TV
Video
Data Folder
Pict. Album
Videos
PC Movies
Widget
Store
Contents
Settings
Calculator
—
Utilities
Touch Guide
Handwriting
P-egg
—

# Universal Operations, etc.

## Text Entry

Enter alphanumerics, hiragana, kanji, katakana, symbols and pictographs.

- Two types of character input methods are available: 5-touch and 2-touch. In this guide, examples are described in 5-touch.

### 2-touch

Press two numeric keys to enter a character.

### Text Entry Window

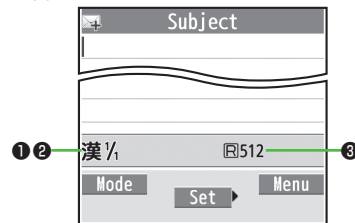

① Character Input Methods		Operations
5-touch/2-touch		Press and hold  [Mode]
② Input Modes (Double-byte/Single-byte)		Operations
5-touch	漢 <sup>1</sup> / <sub>1</sub> : Kanji (hiragana) (double-byte) か <sup>1</sup> / <sub>1</sub> / 加 <sup>1</sup> / <sub>2</sub> : Katakana 英 <sup>1</sup> / <sub>1</sub> / 英 <sup>1</sup> / <sub>2</sub> : Upper case alphanumerics abc <sup>1</sup> / <sub>1</sub> Sm / abc <sup>1</sup> / <sub>2</sub> Sm: Lower case alphanumerics 数 <sup>1</sup> / <sub>1</sub> / 数 <sup>1</sup> / <sub>2</sub> : Numbers	[Mode] → Select a character type
	2-touch	
③ Remaining Bytes		

## Entering Text

### Entering Characters

Example: Enter 鈴木

1 In alphanumeric mode, [Mode] →

漢字

す: (3) three times

ず: (3)\* → (3) three times → (X)

き: (2) twice

\* When the next character is on the same key, press (3) first to move cursor.

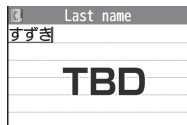

2 (3) to enter Suggestion List

- To exit List, press (PUPD).
- Available suggestion lists:  
Predictive Candidates  
Conversion Candidates  
Context Forecast  
abc/123/Kana Candidates (P.3-6)



3 (3) to select 鈴木

### Other Input Functions

Enter katakana/alphanumerics	[Mode] → Select input mode (character type) → Enter characters
Enter small kana (つ, ツ, etc.)	Enter a character → (↶) to convert to small character • Alternatively, press a key repeatedly to enter an assigned small kana.
Enter upper case characters	Enter a character → (↷) • Alternatively, press a key repeatedly to enter an assigned upper case character.
Add ° or °	Enter a character to add ° or ° → (X) for ° or (X) twice for ° • In single-byte katakana mode, ° and ° are entered as a single-byte character.
Insert line feed	[Line FD] to insert line feeds in text
Insert space at end of text	(3)
Insert space within text	(#) repeatedly until single-byte space appears*, or (X)[Menu] → <i>Input Space</i> (Double-byte (single-byte) space is entered in 2 bytes (1 byte) input mode.)
Toggle characters in reverse order	[Rev.] Example: From c, press to toggle as follows: c → b → a → 2...
Move cursor to beginning/end of sentence	(X)[Menu] → <i>Jump</i> → <i>To beginning</i> or <i>To end</i>
Undo	[Undo]

\* Space cannot be entered in number mode. Use symbol list.

## Universal Operations, etc.

### Pictographs/Symbols/Smileys/URL

- Pictographs do not appear in messages sent to incompatible SoftBank handsets or e-mail addresses.

#### 1 In text entry window,

List Log may appear first.

**My Pict.**<sup>1</sup>: My Pictograms tab  
**Univrsl.**<sup>2</sup>: Universal (cross-carrier) pictographs tab  
**Full**: All pictographs tab  
**Symbol**: Symbols tab  
**Smiley**: Smileys tab  
**URL**: URLs tab

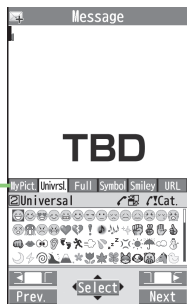

<sup>1</sup> Only in S! Mail text entry window

<sup>2</sup> Only for S! Mail

#### 2 To toggle tabs: /

#### 3 to select a pictograph/symbol/smiley/URL

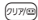
- To close list: 

### Templates

Insert templates (greetings, URLs, emoticons) or edit preinstalled templates.

#### Inserting Templates

##### 1 In text entry window, press and hold

- Not available in number mode.

##### 2 Select a category → Select a template

#### Editing Templates

Main Menu ► Tools ► Templates/Users Dic. ► Templates

##### 1 Select a category

##### 2 Highlight a template → [Edit] → Edit template

#### ■ Reset Edited Templates

> After Step 1, (highlight a template →  [Menu] → *Reset this* or *Reset all* (→ For *Reset all*, enter Phone Password) → **YES**

#### ■ Manage Template Folders

> In Step 1, highlight a category →  [Menu] → *Edit folder name* → Edit folder name

- To reset folder name,  [Menu] → *Reset name* → **YES**

### Editing Text

#### Deleting & Replacing

##### 1 Delete Characters within Lines

Place cursor before a character → 

A character after cursor is deleted.

- Press and hold  to delete all characters after cursor.

##### Delete Characters from the End of Text

Place cursor at the end of text → 

A character before cursor is deleted.

- Press and hold  to delete all characters before cursor.

##### 2 Enter another character

#### Copy/Cut & Paste

1 In text entry window,  [Menu] → *Copy* or *Cut*

##### 2 Select Text to Copy/Cut

Place cursor before (or after) text to select →  [Start] →

Place cursor after (or before) text →  [End]

##### Select All (In S! Mail Message Text Entry Window Only)

 [All] →  [End]

3 Place cursor at target location →  [Menu] → *Paste*



## Universal Operations, etc.

### Text Entry in Touch Panel

Use Touch Panel for text entry in Viewer Position.

#### Text Entry Window



5	Conversion Candidates	Shows Conversion Candidates Show/hide candidates with ▼/▲
6	Input Mode/Conversion Key	<b>Mode:</b> Toggle Input modes (character types) Touch and hold to toggle input methods <b>Conv./Pred.:</b> Toggle Conversion/Predictive Candidates
7	Control Key	Shows functions available during text entry <ul style="list-style-type: none"> <li>● Functions vary by windows.</li> <li>● Tap <b>Set</b> after entering characters.</li> </ul>

	Item	Description
1	Input Method/Input Mode	(☞ P.3-2)
2	Remaining Bytes	Remaining number of enterable byte appears
3	Multi Selector	Move cursor or insert single byte space/line feed
4	Touch Keypad	Same operations as Keypad (☞ (1)-(9), (*), (#)) in Normal Position. <ul style="list-style-type: none"> <li>● Long press key operations (opening Templates list, etc.) are unavailable.</li> </ul>

# Calling

## Emergency Calls

Call 110 (Police), 119 (Fire & Ambulance) or 118 (Coast Guard) even when some handset restrictions are active.

### Calls Cannot be Made in Following Cases:

- When **Set Max Cost Limit** is **ON** and charge limit is reached
- In PIN/PIN2, PUK/PUK2 entry window

### Emergency Positioning Request

When an emergency call is made from a mobile phone, location is reported to first response agencies such as the police.

- Location information may be inaccurate due to location or signal conditions. Describe location or nearby landmarks.
- Base Station Positioning System is accurate within 100 meters to 10 kilometers. Location information from distant base stations may be inaccurate.
- Function available where first response agencies have completed system installation.
- Dialing 184 before 110, 119 or 118, cancels location report. However, first responders may obtain location information for immediate and serious threats to life.
- Not available for international roaming.
- Requires no separate subscription or transmission fees.

## Voice Calls



### Making Voice Calls

1 Enter number with area code → 





- To adjust volume: 

2  to end call

### Calling from Redial Log

>  → Select an entry → 

### Making Calls from Phone Book

>  →  to select a page of the required reading → Select an entry →  → Select a phone number → 

### Showing/Hiding Caller ID

> Enter number →  [Menu] → **Notify caller ID** → **OFF** or **ON**

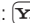
- To cancel setting:  [Menu] → **Notify caller ID** → **Cancel prefix**

### Answering Voice Calls

1 When a call is received,  to talk

2  to end call

## Calling

### International Call

- Application not required. For details, go to:  
[http://mb.softbank.jp/en/global\\_services/call/](http://mb.softbank.jp/en/global_services/call/)

1 Enter a phone number

2  [Menu] → *Int'l dial assist*  
Country/region code list appears.

3 Select a country/region





4 **Voice Calls**



**Video Calls**



■ **Enter Country/Region Code Directly**

>  → Press and hold  to display + (IDD Prefix) → Enter a country/region code → Enter a number (omit first 0)  
→ Voice Calls:  / Video Calls:  [V. Call]

- Do not omit leading 0 to call Italy (country code: 39).

### Global Roaming

- May require application to Global Roaming Service. For details, go to:  
[http://mb.softbank.jp/en/global\\_services/global\\_roaming/](http://mb.softbank.jp/en/global_services/global_roaming/)

**Example: When Roaming Dial Assistant is ON**

- Roaming Dial Assistant ( P.2-10) is set to **ON** and **Japan** by default.

1 **Voice Calls**

Enter a phone number → 

**Video Calls**

Enter a phone number →  [V. Call]

2 Select an item (See below)

Item	Operation/Description
Call to Japan*	Call Japan
Call to set code*	Call a country/region set for <b>Roaming Dial Assistant</b>
As is Call	Manually enter number to call Select when calling within the country/region

\* First 0 is replaced by IDD Prefix and country/region code (e.g. +81). (When calling Italy, +39 is added before first 0.)

- Confirmation window appears for the first time. Select **NO** to set Roaming Dial Assistant to **OFF**.

#### Note

- IDD Prefix and country/region code can be manually entered in Step 1.  
Alternatively, save IDD Prefix and country/region code in Phone Book entries.

## Calling

### Global Roaming Settings

From ► **Main Menu** ► **Settings** ► **International Call**

#### International Call Settings

> **Int'l Dial Assist** → Select an item (See below)

Item	Operation/Description
<b>Roaming Dial Assistant</b>	Automatically inserts prefixes (IDD Prefix and country code) > <b>ON</b> or <b>OFF</b> (→ For <b>ON</b> , select a country/region)
<b>Country/Area Code</b>	Save up to 27 country/region codes > Highlight <b>&lt;Not Recorded&gt;</b> → [Edit] → Enter a country/region name → Enter a country/region code <ul style="list-style-type: none"><li>● To view an entry: Select a saved country/region</li><li>● To delete: Highlight a country/region → [Menu] → <b>Delete this</b> or <b>Delete all</b> (→ For <b>Delete all</b>, enter Phone Password) → <b>YES</b></li></ul>
<b>IDD Prefix</b>	Edit IDD Prefix. IDD Prefix is set to <b>0046010</b> by default > [Menu] → <b>Edit</b> → Edit IDD Prefix

#### Network Mode

<Default> **Automatically**

> **Select Network** → Select an item (See below)

Item	Operation/Description
<b>Automatically</b>	Handset automatically selects 3G network in Japan, and available network (3G or GSM) when abroad.
<b>Manually</b>	> Select an item <ul style="list-style-type: none"><li>· <b>3G/GSM</b>: 3G/GSM service area in Japan or abroad. Handset selects an available network automatically.</li><li>· <b>3G</b>: 3G service area in Japan or abroad.</li><li>· <b>GSM</b>: GSM service area abroad. Unavailable in Japan.</li></ul>

● **Automatically** is recommended.

#### Select Operator

<Default> **Auto**

> **Select Operator** → Select an item (See below)

Item	Operation/Description
<b>Auto</b>	Select an operator automatically
<b>Manual</b>	Select an operator manually > Select an operator <ul style="list-style-type: none"><li>● Operators with <b>X</b> are not available.</li><li>● To show operator list: [Update]</li></ul>
<b>Network Re-search</b>	Search available networks <ul style="list-style-type: none"><li>● When <b>Auto</b> is set, handset selects an available operator automatically. When <b>Manual</b> is set, operator list appears.</li></ul>

## Calling

### Video Calls

#### ■ Video Call Window

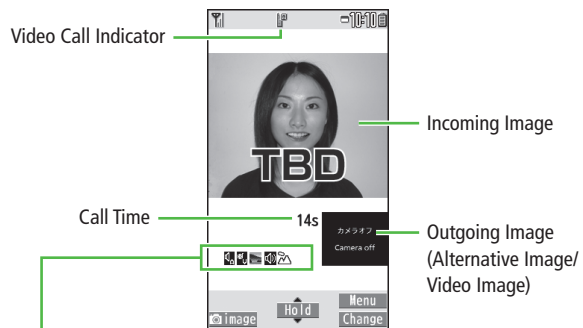

#### Indicators

: Incoming/Outgoing Sound OK	: Speaker ON
(Gray): Incoming/Outgoing Sound NA	: AV output
: Incoming/Outgoing Image OK	: During Bluetooth® handsfree call
(Gray): Incoming/Outgoing Image NA	: Close-up
: Video ON	: Landscape
: Alternative Image ON	: Night mode

- Display appearance may vary by settings/conditions.

#### Making Video Calls

- 1 Enter number with area code → [V.Call]
  - To adjust volume:
- 2 to end call

#### Answering Video Calls

- 1 When a video call is received,
  - To send Video Image: [image]
- 2 to end call

## Calling

### Answer Phone

Record up to five voice messages or up to two video messages (up to 20 seconds per message) on handset.

- When Answer Phone is active, – (Voice Call) or – (Video Call) appears in Standby (Voice Calls are prioritized).
- Unavailable when: handset is off or in Offline Mode; OUT appears. Use Voice Mail ( P.XX-XX).

### Activating/Canceling Answer Phone

<Default> OFF

- 1 Press and hold .
  - To toggle settings, repeat operation.

### Playing Messages

When a new message is recorded, Information window ( P.1-20) opens in Standby.

- 1 Select an item → Select a message



### Optional Services

#### Call Forwarding

Forward unanswerable calls to a preset number when handset is off, out-of-range, etc.

- Call Forwarding and Voice Mail cannot be set simultaneously.
- When forwarding Video Calls, set a destination phone that supports 3G-324M standard video calls. If not, Video Calls are not forwarded.

#### Activating Call Forwarding

Main Menu ► Settings ► Call Settings ► Voice Mail/Call Fwding ► Call Forwarding ON

- 1 Select a type
- 2 Enter a destination phone number
  - to select number from Phone Book.
- 3 Select an item (See below)

Item	Operation/Description
Ringer ON	Forward missed calls > Select a ring time → YES
Ringer OFF	Forward all calls without ringing/vibrating > YES

## Calling



### ■ Check Call Forwarding Status

- > **Main Menu** ▶ **Settings** ▶ **Call Settings** ▶ **Voice Mail/Call Fwding**
  - ▶ **Get Status**

### ■ Cancel Call Forwarding

- > **Main Menu** ▶ **Settings** ▶ **Call Settings** ▶ **Voice Mail/Call Fwding**
  - ▶ **Deactivate All** ▶ **YES**

#### Note

- Toll free numbers and international call numbers cannot be saved as a destination number.
- When using Call Forwarding together with Answer Phone, the function with shorter ring time takes priority (Priority may change due to signal condition).
- When **Ringer ON** is set, following operations are available while handset is ringing (within ring time):
  - To answer call: 
  - To forward call:  [Menu] → **Call Forwarding**

## Voice Mail

Unanswered calls are forwarded to Voice Mail Center as set or when handset is off, out-of-range, engaged, etc.

- Calls are forwarded to Voice Mail Center via Call Forwarding function; Call Forwarding and Voice Mail cannot be set simultaneously.
- Voice Mail is not available for Video Calls.



## Activating Voice Mail

- Main Menu** ▶ **Settings** ▶ **Call Settings**
  - ▶ **Voice Mail/Call Fwding** ▶ **Voice Mail ON**

1 Select an item (See below)

Item	Operation/Description
<b>Ringer ON</b>	Forward missed calls > Select a ring time → <b>YES</b>
<b>Ringer OFF</b>	Forward all calls without ringing/vibrating > <b>YES</b>

#### Note

- When using Voice Mail together with Answer Phone, the function with shorter ring time takes priority (Priority may change due to signal condition).
- When **Ringer ON** is set, following operations are available while handset is ringing (within ring time):
  - To answer call: 
  - To forward call:  [Menu] → **Call Forwarding**

## Calling

### Checking Voice Mail Messages

Information window (☞ P.1-20) and  appear in Standby when new messages are recorded.

#### 1 Select an item → YES

Follow voice guidance.

Information window and  disappear after messages are checked.

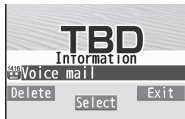

#### ■ View Details

View callers' phone numbers and date/time Voice Mail messages were left before playing messages.

● Activate Missed Call Notification beforehand (☞ PXX-XX).

>  → **Voice Mail Notif.** →  ()

### Missed Call Notification

When Missed Call Notification function is active, Information window appears for calls missed while handset was off, out-of-range, engaged etc.

● Available only when Voice Mail is active.

Main Menu ► Settings ► Call Settings ► Missed Call Notifi.

#### 1 YES

Handset connects to the Network.

Follow voice guidance.

#### When Calls are Received while Missed Call Notification is Active...

Information window appears for missed calls when handset is turned on or comes into range. Select information to view Missed Calls.

● **Had incoming call(s)** appears when Voice Mail messages are recorded (☞ Left).





## Calling

### Call Waiting

Place the current call on hold and answer a second, or alternate between calls.



#### Activating/Canceling Call Waiting

Main Menu ► Settings ► Call Settings ► Call Waiting

1 *Activate* or *Deactivate* → YES

#### Answering Second Call

1 When tone sounds, 

- Press  to alternate between calls.
- Press  to disconnect active call.
- When the party hangs up, active call ends.
- Press  to re-engage the party on hold.
- When a second call comes in while first call is on hold, hold status is canceled and first call resumes.

#### Reject Second Call

> When tone sounds,  [Menu] → Call Rejection

##### Note

- When Voice Mail or Call Forwarding is set to **Ringer ON** while Call Waiting is active, unanswered calls are transferred to Voice Mail Center or the forwarding number.
- When Voice Mail or Call Forwarding is set to **Ringer OFF**, Call Waiting is disabled.

### Call Barring

Restrict incoming/outgoing Voice Calls/Video Calls and SMS messages.

- **Bar All Outgoing** and **Bar All Incoming** are not available when Call Forwarding or Voice Mail is active (Call Forwarding or Voice Mail takes priority).
- Security Code is required ( P.1-28).

#### Activating/Deactivating Call Barring

Main Menu ► Settings ► Call Settings ► Call Barring

1 Select an item (See below)

Item	Operation/Description
<b>Bar All Outgoing</b>	Restrict all non-emergency calls
<b>Bar All Int'l</b>	Allow only domestic calls
<b>Bar Int'l</b>	Restrict all international calls except to Japan
<b>Bar All Incoming</b>	Reject all calls
<b>Bar All Roaming</b>	Reject calls when outside Japan

2 *Activate* or *Deactivate* → YES

3 Enter Security Code

## Calling

### ■ Check Call Barring Status

> After Step 1, *Get Status*

### ■ Cancel All Call Barring

> In Step 1, *Cancel All Barring* → Enter Security Code

### ■ Change Security Code

> In Step 1, *Set Security Code* → Enter current Security Code → Enter new Security Code → Reenter Security Code

#### Note

- Emergency numbers (110, 119, 118) are dialable even while Call Barring for outgoing calls is active.
- If call is attempted when Call Barring is active, warning message appears. It may take longer to appear in some areas. Check Call Barring settings if the message does not appear.

## Caller ID

Show or hide your number when calling.

<Default> Network Set

Main Menu ► Settings ► Call Settings ► Show My Number  
► Activate

### 1 ON, OFF or Network Set

- *Network Set* Caller ID setting varies by subscription.

### ■ Check Caller ID Status

> Main Menu ► Settings ► Call Settings ► Show My Number  
► Check Setting

#### Note

- Alternatively, enter these numbers/symbols before the phone number to show or hide Caller ID:

Show: 1 8 6 or \* 3 1 #

Hide: 1 8 4 or # 3 1 #

## Phone Book

### Phone Book Entry Items

Save up to 1000 entries in handset Phone Book; 50 entries to USIM Card Phone Book.

Phone Book Entry Items		Handset	USIM Card
Basic Item	Name (Reading)	Available	Available
	Group	19	10
	Phone number	5	2
	Mail address	5	1
	Address	Available	N/A
	Location information	Available	N/A
	Birthday	Available	N/A
	Memo	Available	N/A
	Image	100	N/A
	Memory number	000 - 999	N/A
Incoming Settings	Ringtone	Available	N/A
	Vibrator		
	Notification Light		
	Screen		
	Msg Ringtone		
	Msg Vibrator		
	Msg Notif. Light		
	Answer message		

### Saving to Phone Book

1 Press and hold → Enter Last name → Enter First name  
→ An item → Enter information →

#### Save Settings

> Main Menu ► Phone Book ► Settings ► Save Settings

► Phone, USIM or Ask Every Time

- Select Ask Every Time to select target each time you save an entry.

#### Edit Phone Book Entries

> → Select an entry → [Edit] → Edit ( From Step 3 on P.4-3) → YES

# Messaging

## Basics

### Send messages via S! Mail, SMS or PC Mail.

- SoftBank messaging services are available in Japan and overseas.

<b>S! Mail</b>	Exchange text messages with SoftBank or e-mail compatible handsets, PCs, etc.; attach image or sound files etc.
<b>SMS</b>	Exchange short text messages with SoftBank handsets.
<b>PC Mail</b>	Send/receive messages via PC mail account.

- For more information, visit SOFTBANK MOBILE Corp. Website (<http://www.softbank.jp>)

## Messaging Folders

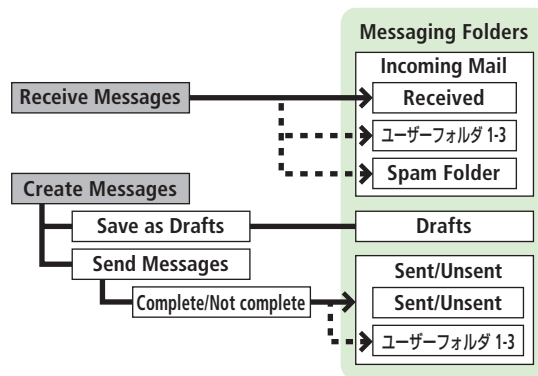

### Operations while Using PC Mail

Setting PC Mail accounts creates account folders in Messaging Folders. S! Mail/SMS operations may change as a result.

#### ■ Deactivate Auto Resend Unsent Messages

> *Auto Resend* → ON or OFF

#### ■ Auto Delete (For Sent/Unsent)

> *Auto Delete* → *Auto Sent Msg Del* → ON or OFF

#### ■ Auto Delete (For Incoming Mail)

> *Auto Delete* → *Auto Received Msg Del* → Select an item

#### ■ View Memory Status

> [Envelope icon] → *Memory Status*

## Messaging Folder Contents

Received/Sent Date & Time,  
Sender/Recipient, S! Mail Subject/  
SMS Message Text

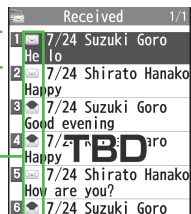

Example: Received Folder  
in Incoming Mail

### Message Type/Status

Message Type	Message Status
Unread/Read S! Mail	Attachments
Unread/Read S! Mail Notice	(Silver) Protected
Unread/Read SMS	Forwarded Message
Unread/Read USIM Card SMS	Replied Message
Forwarded Server Mail	Failed (Sent/Unsent Message)
Unread/read PC Mail	Resend Scheduled
Unread/read PC Mail (notice only)	New Delivery Report (Sent/Unsent Message)
	High Priority
	Low Priority

## Customizing Handset Address

Change your handset mail address (alphanumerics before @) to reduce the risk of receiving spam. Default account name is random alphanumerics.

abc123-xyz @ softbank.ne.jp

[ Account ] [ Domain ]  
Name Name

(Customize here)

1 → **Settings** → **Custom Mail Address**

Handset connects to the Network.  
Follow onscreen instructions.

# Sending S! Mail & SMS

## Sending S! Mail

1 Press and hold 

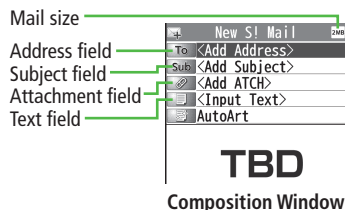

2 Select Address field

3 **Select from Phone Book**

**Phone Book** → Select a SoftBank handset number or mail address

**Enter Directly**

**Enter Mail Address** or **Enter Phone Number** → Enter a mail address/SoftBank handset number

**Select from Sent/Received Logs**

**Sent Address** or **Received Address** → Select a log →

 [Select]

4 Select Subject field → Enter subject

5 Select Text field → Enter text

6  [Send]

## Additional Functions



**Add Attachments**

> Select Attachment field → Select a folder in Data Folder → Select a file →  [Send]

**Add Address**

> Select Address field → < *Not entered* > → Search/enter address → Select an address or enter directly →  [Finish]

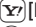
**Use Templates**

>  [Menu] → *Load Template* → Highlight a template →  [View] →  [Select]

**Use My Pictograms**

> In text entry window,  [My Pict.] → Select a My Pictogram

### Sending SMS Messages

#### 1 → **Create New SMS**

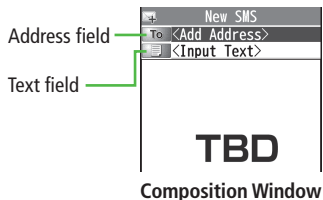

#### 2 Select Address field

#### 3 **Select from Phone Book**

**Phone Book** → Select a SoftBank handset number

#### **Enter Directly**

**Direct Entry** → Enter a SoftBank handset number

#### **Select from Sent/Received Logs**

**Sent Address** or **Received Address** → Select a log →

 [Select]

#### 4 Select Text field → Enter text

- When number of entered character exceeds limit, S! Mail conversion option message appears.

#### 5 [Send]

#### **Manual Mail Conversion**

> In SMS Composition window,  [Menu] → **Change mail type** → Select an item

### Receiving Messages

#### Retrieving S! Mail Automatically

Auto Download retrieves up to 1 MB messages. Transmission fees are incurred; adjust to use. (To disable Auto Download/limit message size for Auto Download: )

When a new message is received,  appears and Information window opens in Standby.

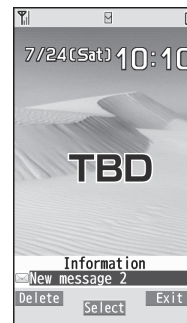

#### 1 In Information window, **New message**

- When Information window does not appear, 
  - ▶ **Incoming Mail** ▶ select a folder
  - ▶ Select a message.



### Retrieve Complete S! Mail

When Center sends initial portion of message (S! Mail Notice), retrieve the complete message manually.

- 1 Select a message with  or  →  
Select **continue (xxxKB)** at the end of message text



### Incoming Options (S! Mail Only)

From ► **Main Menu** ► Messaging ► Settings  
► S! Mail Settings ► Incoming Options

- 1 Select an item (See below)

Item	Operation/Description
<b>Download Size Limit</b>	Limit maximum incoming message size > <b>300KB</b> or <b>2MB</b>
<b>Auto Retrieve Size</b>	Deactivate/limit Auto retrieval > <b>Auto Retrieve Size</b> → Select an item
<b>Auto Retrieve for</b>	Limit Auto-retrieval by Message Type > Selected Messages → <b>Address Stored in PB</b> or <b>SoftBank Domain Only</b> →  [Finish]



## PC Mail

### PC Mail Account Setup

- Check ISP information in advance.
- PC Mail services may not be available depending on services, settings, contract details for PC mail account.
- Quick Yahoo! Mail Address Setup is available for setting your Yahoo! account.

1 → **Settings** → **PC Mail Settings** → **Account Settings**

2 **<Not Recorded>** → Select an item (See below)

Item	Operation/Description
Account Name	> Enter an account name
Incoming Options	> Select an item → Enter/select an item → <ul style="list-style-type: none"> <li>• <b>User Name</b>, <b>Password</b> and <b>Receiving Server</b> are required.</li> </ul>
Sending Options	> Select an item → Enter/select an item → <ul style="list-style-type: none"> <li>• <b>Mail Address</b> and <b>Sender Server</b> are required.</li> </ul>

3 [Finish] → **OK**

#### ■ Set Default Account

- > After Step 1, highlight an account → [Menu] → **Default account**
- ★ appears for selected account.

#### ■ Delete Account

- > After Step 1, highlight an account → [Menu] → **Delete account** → Enter Phone Password → **YES**

### Sending PC Mail

- 1 Press and hold → **PC Mail**
- 2 Compose a message and send ( From Step 2 on P.XX)

Account field

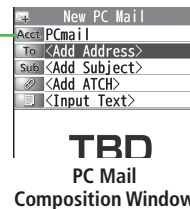

#### ■ Change Account

- > After Step 1, select Account field → Select an account

#### ■ Attach Image/Music Files

- > Highlight a file → [Menu] → **Attach to message** → **PC Mail** → Compose a message and send ( From Step 2 on P.XX)

### PC Mail Settings

From ► **Main Menu** ► **Messaging** ► **Settings**  
 ► **PC Mail Settings** ► **Check New Mail**

#### ■ Auto-retrieve for New Messages

- > **Auto Check** → Select an account ( to toggle **ON/OFF**) → [Finish]

#### ■ Set Auto-retrieve Interval/Condition

- > **Check Interval** → Select an item

#### ■ Auto-retrieve (while Abroad)

- > **Auto Check in Roaming** → **ON** or **OFF**

## Messaging

---

- **Disable Auto-retrieval between Set Time Period**
  - > *Inactivate Time* → *ON* or *OFF* (→ For *ON*, enter time)

# Internet

## Getting Started

Access Yahoo! Keitai Mobile Internet and PC sites.

### Internet

#### Yahoo! Keitai

- View Mobile Internet Websites
- Download image/sound files, etc.
- Movies/Music Streaming

#### PC Site Browser/Direct Browser

- View PC Sites
- Download still images

- Separate subscription is required for Network access.
- For more information, visit SOFTBANK MOBILE Corp. Website (<http://www.softbank.jp>).

### Connecting Via Wi-Fi

Once connection setup is complete, handset automatically connects to that Wi-Fi network when within range.

- Wi-Fi:  P.XX-XX
- Switch to 3G from Wi-Fi:  P.XX-XX

## Yahoo! Keitai

From ▶ Main Menu ▶ Yahoo!

### Opening Yahoo! Keitai Menu

- 1 **Open Top Menu**  
*Yahoo! Keitai*

**Open Menu List**  
*Menu List*

- 2 Select a menu item
  - Repeat Step 2 as required.

### Web Search

- 1 **Web Search** → Enter text →  [OK]

## Internet

### Entering URL

- 1 **Enter URL Directly**  
*Enter URL* → *Direct Entry* → Enter URL  
**Use URL History**  
*Enter URL* → *URL History List* → Select a URL

### Using Access Histories

- 1 **History** → Select a history

### Exiting Mobile Internet

- 1  → **YES**

## Browsing PC Sites

View PC websites using PC Site Browser or Direct Browser.

- Some pages may not be viewable.
- Viewing PC websites via PC Site Browser may incur high charges.

From ► **Main Menu** ► **Yahoo!**  
► **PC Site Browser** or **Direct Browser**

### Opening Menu

- 1 **Homepage**  
For PC Site Browser, confirmation appears. Select **NO**.
  - To show confirmation each time: **YES**
- 2 Select a menu item
  - Repeat Step 2 as required.

### Web Search

- 1 **Web Search** → Enter text

## Internet

### Entering URL

Follow same operation accessed from Yahoo! Keitai.

### Using Access Histories

Follow same operation accessed from Yahoo! Keitai.



### Exiting Internet

1  → YES

## Internet Settings

### Browser Display Settings/Memory Manager





Yahoo! Keitai





From  **Main Menu**  **Yahoo!**  **Set Yahoo! Keitai**

PC Site Browser

From  **Main Menu**  **Yahoo!**  **PC Site Browser**  
 **Set PC Site Browser**

Direct Browser

From  **Main Menu**  **Yahoo!**  **Direct Browser**  
 **Set Direct Browser**

Setting/Operation	Default
 <b>Font Size</b> > <i>Font Size</i> → Select a size	Normal
 <b>Scroll Unit</b> > <i>Scroll Unit</i> → Select an item	Single Line
 <b>Images On/Off</b> > <i>Downloads</i> → <i>Display Image</i> → <i>ON</i> or <i>OFF</i>	ON
 <b>Sound On/Off</b> > <i>Downloads</i> → <i>Play Sounds</i> → <i>ON</i> or <i>OFF</i>	ON
 <b>Change Pointer (Scroll) Speed<sup>1</sup></b> > <i>Pointer Speed</i> → Select a speed	Medium Speed

## Internet

<ul style="list-style-type: none"> <li>■ Show/Hide Warning Messages when Activating PC Site Browser or Switching to Yahoo! Keitai<sup>2</sup></li> <li>&gt; <i>Warning Messages</i> → <i>PC Site Browser</i> (when activating) or <i>Yahoo! Keitai</i> (when switching) → <i>ON</i> or <i>OFF</i></li> </ul>	ON
<ul style="list-style-type: none"> <li>■ Clear Cache</li> <li>&gt; <i>Memory Manager</i> → <i>Clear Cache</i> → <i>YES</i></li> </ul>	—
<ul style="list-style-type: none"> <li>■ Delete Cookies</li> <li>&gt; <i>Memory Manager</i> → <i>Delete Cookies</i> → <i>YES</i></li> </ul>	—
<ul style="list-style-type: none"> <li>■ Delete User ID or Password Entered when Authentication is Required</li> <li>&gt; <i>Memory Manager</i> → <i>Delete Certificates</i> → <i>YES</i></li> </ul>	—
<ul style="list-style-type: none"> <li>■ Set Data Storage Location to microSD Card<sup>3</sup></li> <li>&gt; <i>Save Settings</i> → <i>Phone</i> or <i>microSD</i></li> </ul>	Phone

<sup>1</sup> PC Site Browser/Direct Browser only

<sup>2</sup> PC Site Browser only

<sup>3</sup> Yahoo! Keitai Browser only

## Security Settings

Setting/Operation	Default
<ul style="list-style-type: none"> <li>■ Auto Send Manufacturer's Number (for Authentication)<sup>1</sup></li> <li>&gt; <i>Security</i> → <i>Manufacture Number</i> → <i>ON</i> or <i>OFF</i></li> </ul>	ON
<ul style="list-style-type: none"> <li>■ Referer Information</li> <li>&gt; <i>Security</i> → <i>Send Referer</i> → <i>ON</i> or <i>OFF</i></li> </ul>	ON

<ul style="list-style-type: none"> <li>■ Cookie Storage</li> <li>&gt; <i>Security</i> → <i>Cookies</i> → Select an item</li> </ul>	ON
<ul style="list-style-type: none"> <li>■ Script Execution in PC Site/Direct Browser<sup>2</sup></li> <li>&gt; <i>Security</i> → <i>Script</i> → Select an item</li> </ul>	ON
<ul style="list-style-type: none"> <li>■ View Server Certificates Issued by Certificate Authorities</li> <li>&gt; <i>Security</i> → <i>Root Certificates</i> → Select an item</li> </ul>	—
<ul style="list-style-type: none"> <li>■ Authentication Information</li> <li>&gt; <i>Security</i> → <i>Certificate Retention</i> → Select an item</li> </ul>	Keep While Browsing
<ul style="list-style-type: none"> <li>■ Show/Hide Confirmation when Connecting to Secure Site</li> <li>&gt; <i>Security</i> → <i>Secure Prompt</i> → <i>ON</i> or <i>OFF</i></li> </ul>	ON

<sup>1</sup> Yahoo! Keitai Browser/PC Site Browser only

<sup>2</sup> PC Site Browser/Direct Browser only

## Reset

Setting/Operation	Default
<ul style="list-style-type: none"> <li>■ Reset Browser Settings</li> <li>&gt; <i>Reset</i> → <i>Restore Defaults</i> → <i>YES</i> → Enter Phone Password</li> </ul>	—
<ul style="list-style-type: none"> <li>■ Initialize Browser</li> <li>&gt; <i>Reset</i> → <i>Initialized Browser</i> → <i>YES</i> → Enter Phone Password</li> </ul>	—