

SoftBank 002P
English User Guide



SoftBank

Introduction

Thank you for purchasing SoftBank 002P.

- For proper handset use, read User Guide (this guide).
- Accessible services may vary by service area, subscription, etc.

SoftBank 002P is compatible with both 3G and GSM network technologies.

Note

- Unauthorized copying of any part of this guide is prohibited.
- Guide content is subject to change without prior notice.
- Efforts have been made to ensure the accuracy and clarity of this guide. Please contact SoftBank Mobile Customer Center, General Information (☎ P.XX-XX) about unclear or missing information.

Getting Started

Contents

Getting Started

Contents	1-1
Package Contents	1-2
Using This Guide	1-2
USIM Card Installation	1-5
Charging Battery	1-6
Memory Card Installation.....	1-7
Parts & Functions.....	1-8
Basic Operations.....	1-10
Display.....	1-11
Function List.....	1-13
Handset Security	1-14
Manner Mode	1-15

Universal Operations, etc.

Text Entry.....	2-1
Entering Text.....	2-2
Editing Text.....	2-4

Calling

Emergency Calls	3-1
Voice Calls	3-1
Video Calls.....	3-4
Optional Services	3-5
Phone Book	3-10

Messaging

Basics.....	4-1
Customizing Handset Address.....	4-2
Sending S! Mail & SMS.....	4-3
Receiving Messages	4-4

Internet

Getting Started	5-1
Yahoo! Keitai	5-1
Browsing Using PC Sites.....	5-2
Internet Settings	5-3

Connectivity

Infrared.....	6-1
External Device.....	6-3

Camera & Imaging

Before Using Camera.....	7-1
Capturing Still Images.....	7-4
Recording Videos.....	7-5
Other Camera Functions.....	7-5

Others

Digital TV	8-1
------------------	-----

Appendix

Handset Data Backup.....	9-1
Software Update	9-2
Troubleshooting.....	9-3
Safety Precautions.....	9-5
Handling Precautions	9-12
Copyrights and Others.....	9-15
Specific Absorption Rate (SAR)	9-17
Specifications	9-19
Support.....	9-19

Getting Started

Package Contents

□ Handset (002P)

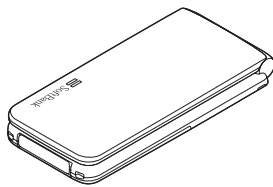

□ Battery (PMBAS1)

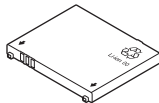

□ Quick Start Guide (Japanese)

□ Safety Precautions (Japanese)

Note

- Use SoftBank specified AC Charger (sold separately) to charge battery.
- 002P accepts microSD Card (not included). Purchase microSD Card to use related functions.

Using This Guide

Screenshots

Before reading this guide, make a note of the following:

- In this guide, SoftBank 002P English User Guide, SoftBank 002P is abbreviated as 002P.
- "microSD Card" is referred to as "Memory Card" in this guide.
- Sample screenshots, etc. are provided for reference only. Actual handset windows, menus, etc. may differ in appearance.
- Key icons use simplified labels.
- Most operation descriptions begin in Standby.
- Pressing a key for more than one second is described as "Press and hold."

Getting Started

Guide Symbols

Press the corresponding key to execute the function or operation indicated at the bottom of Display.

Example:

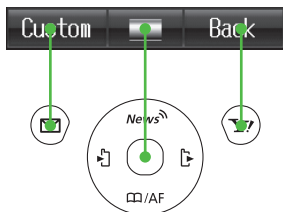

- Images shown above are for reference only.

Multi Selector

Use Multi Selector to select items, navigate menus, etc. In this guide, Multi Selector operations are indicated as shown below.

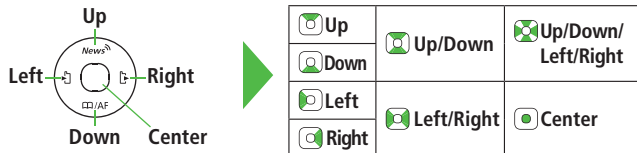

Japanese Functions & Services

When “(Japanese)” appears in a title, Japanese ability is required to use full range of the function or service.

Getting Started

Operation Descriptions

- The following examples are for reference only and may differ from actual operations.

Basic Operations

Operations are expressed as shown here.

Example 1:

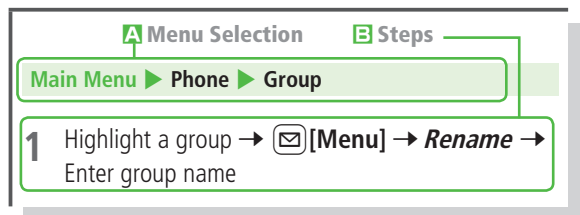

A Menu Selection

- 1 Press in Standby to open Main Menu.
- 2 Use to highlight **Phone**; then press .
- 3 Use to highlight **Group**; then press .

B Steps

- 1 Use to highlight a group; then press [Menu].
- 2 Use to highlight **Rename**; then press .
- 3 Enter Group name.

Example 2:

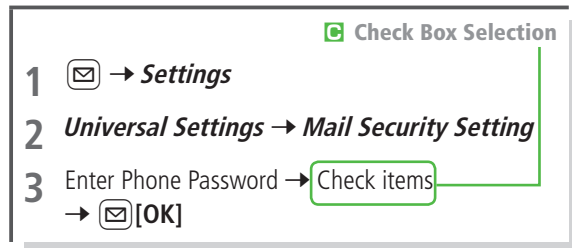

Check Box Selection

- 1 → **Settings**
- 2 **Universal Settings** → **Mail Security Setting**
- 3 Enter Phone Password → Check items → [OK]

Check Box Selection

- 1 Use to highlight an item; then press .
 changes to .
Repeat to select multiple items.
- 2 To deselect an item, use to highlight item; then press .
Check mark disappears.

Getting Started

USIM Card Installation

- Always turn off handset power before removing battery. (Battery Installation:  P.XX-XX)

Inserting

- 1 With IC chip down, insert USIM Card

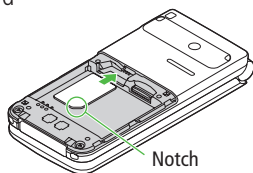

Removing

- 1 Slide out USIM Card gently

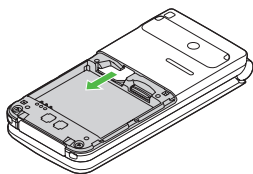

Important

- USIM Card is the property of SoftBank.
- Return USIM Card to SoftBank upon service cancellation.
- USIM Card will be reissued for a fee if lost or damaged.
- If USIM Card/handset with USIM Card inserted is lost or stolen, contact SoftBank Mobile Customer Center or Global Call Center ( P.XX-XX).
- Back up USIM Card files. SoftBank is not liable for lost files.
- USIM Card specifications/performance may change without prior notice.
- Pre-installed S! Appli may be unusable while a different or replacement USIM Card is inserted into handset.
- Returned USIM Cards are recycled.

Note

- Some downloaded files may be inaccessible after upgrades/repairs, USIM Card/handset replacement.

Getting Started

Charging Battery

Battery Installation

- Always turn off handset power before removing battery.

1 Press and slide to remove cover

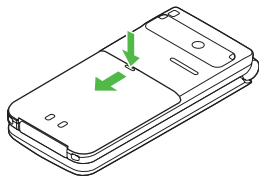

2 Insert Battery

Align battery contacts with handset pins.

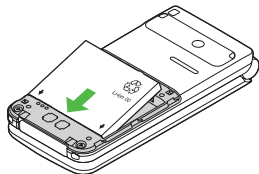

Remove Battery

Lift battery out as shown.

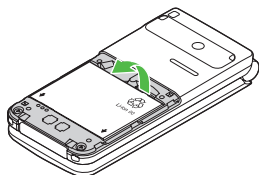

3 Replace battery cover

Cover should click into place.

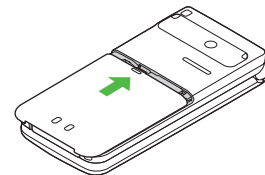

Note

- Lithium-ion batteries are valuable and recyclable resources.
 - Recycle used lithium-ion battery at a shop displaying the symbol shown to the right.
 - To avoid fire or electric shock, do not:
 - Short-circuit battery
 - Disassemble battery



Li-ion 00

Getting Started

Charging Battery

Use only specified AC Charger (sold separately).

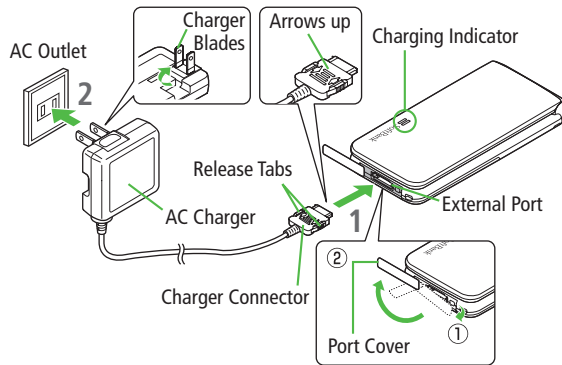

- 1 Connect AC Charger to handset
Insert Charger Connector (arrows up) into External Port.
- 2 Extend Charger Blades, and plug AC Charger into AC Outlet
Charging Indicator illuminates and charging starts.
When charging is complete, Charging Indicator goes out.
- 3 When charging is complete, unplug AC Charger, then disconnect handset
Squeeze Release Tabs to remove Charger Connector, and replace Port Cover.

Memory Card Installation

002P is compatible with up to 2 GB commercial Memory Cards (as of December 2010).

- Turn off handset before inserting/removing Memory Card.
- Battery Installation: 📖 P.1-13

Inserting

- 1 Insert Memory Card until it clicks

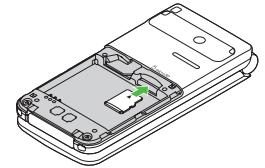

Format Memory Card

- > Main Menu ▶ Settings ▶ Memory Card Manager
- ▶ Format Memory Card ▶ Enter Phone Password

Removing

- 1 Gently push Memory Card in
 - Memory Card pops out with a light push.

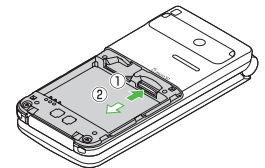

Parts & Functions

Handset

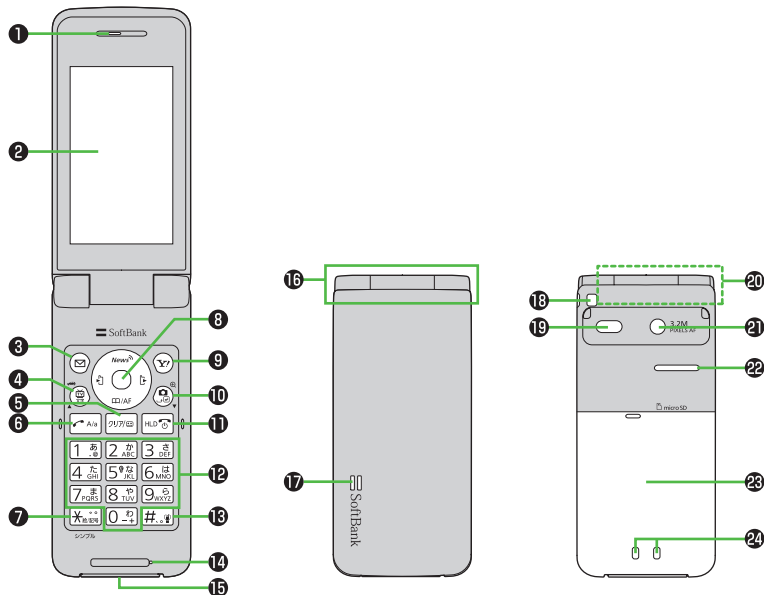

Using Earphone Microphone

Connect Earphone Conversion Cable (sold separately) to External Port to use Earphone Microphone. Stereo Earphone Conversion Cable (PMLA1) is also compatible with 002P.

- Do not press answer button on microphone when connecting. Doing so may cause microphone to malfunction. In that case, pull out Earphone Microphone, and connect again.

Getting Started

1 Earpiece

2 Display

3 Mail Key

- Open Messaging menu
- Execute Left Softkey function

4 TV/Input Mode Key

- Activate TV
- Toggle input modes in text entry windows
- Toggle Drive Mode

5 Clear/Memo Key

- Delete characters
- Cancel menus
- Use Answer Phone

6 Send Key

- Initiate or answer calls
- Toggle upper/lower case in text entry windows

7 * /Simple Mode Key

- Enter "*"
- Access pictographs in text entry windows
- Access symbol list from pictograph list
- Toggle Simple Mode

8 Multi Selector

- Scroll up/down/left/right to navigate menus and text
- Open/Select Standby Window (Unavailable in Simple Mode)
- Open Phone Book; set Auto Focus Lock
- Open Incoming Call Logs
- Open Outgoing Call Logs

9 Yahoo! Keitai Key

- Open Yahoo! Keitai Main Menu
- Execute Right Softkey function

10 Camera/Line Break Key

- Activate Camera; activate Magnifying Loupe
- Enter a line break
- Toggle letters in reverse order in text entry windows

11 End/Escape & Power Key

- Power on/off (P:XX-XX)
- End calls
- Return to Standby
- Place Call on hold

12 0 - Keypad

- Enter phone number/text

13 #/Manner Mode Key

- Enter "#"
- Toggle Manner Mode

14 Microphone

15 External Port

- Connect AC Charger (sold separately) or other accessories here

16 Hinge

17 Notification Light/Charging Indicator

- Flashes for incoming transmissions; flashes while Camera is active
- Lights in red for charging

18 Strap Eyelet

19 Infrared Port

- Transfer data via Infrared

20 Antenna

21 Camera

22 Speaker



23 Battery Cover

24 Charging Terminals

Getting Started

Basic Operations

Power On/Off

- 1 Press and hold .
Start-up window and waterproof precautions appear and handset enters Standby.
 - Enter PIN if PIN Certification is ON ( P.XX-XX).
- 2 Press  for 2+ seconds.
Handset shuts down.
 - Do not turn on handset immediately after turning off. Wait a few seconds.

The First Time Handset Powers Up...





Setup window appears.

Enter date → Enter time (24 hours)

Day of the week is set automatically.

- If unentered, 2000/01/01 00:00 is set.

Retrieving Network Information

When , , or  is pressed for the first time in Standby, handset may initiate Network Information retrieval; press  to retrieve it.

- Update Network Information to use messaging, Internet, etc.
- Update Network Information manually: **Main Menu** ▶ **Settings**
▶ **Retrieve NW Info** ▶ 

English Interface

Main Menu ▶ **設定** ▶ **一般設定** ▶ **言語選択** ▶ **English**

Date & Time

Main Menu ▶ **Settings** ▶ **Phone Settings** ▶ **Date & Time**
▶ **Home Clock** ▶ **Date & Time**

- 1 Enter date → Enter time

My Number

- 1  → 

Display

Icons & Indicators



1 Display Indicators

Signal Strength

Strong Moderate Weak Low

Out-of-Range

Emission OFF Mode Active

(Red) Only Packet Transmission Available

Inserted

Video Call

Voice Call

Unread Message

Software Update
(Notification/Updating/Result)

Digital TV Active

PC Site Browser Active

Infrared Active

USB Cable Connected

3G Packet Transmission Available

GSM Packet Transmission Available

Manner Mode Active

Drive Mode Active

Battery Level

(Red)

Call Forwarding or Voice Mail Active

Voice Mail

Answer Phone Active

Answer Phone Full

New Message Recorded

Multi Selector

Keyguard Active

2 Information Window (☞ P.XX)

Getting Started

Information Window

In Standby, Information window opens to notify of missed events. Select an event indicator to view/access information.

1  to select an item

■ Close Information window

>  ,  [Exit] or 

■ Open Information Window

> 



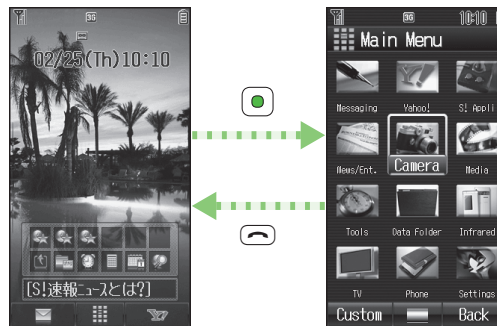

Handset Menus



Standby

Main Menu

- 1 In Standby, 
Main Menu appears.
- 2  to highlight an icon → 
Selected function menu appears.
 - To return to Standby: 

Getting Started

Function List

Messaging
Incoming Mail
Create New S! Mail
Retrieve New
Drafts
Templates
Sent Messages
Unsent Messages
Server Mail Box
Create New SMS
Settings
Memory Status

Yahoo!
Yahoo! Keitai
Menu List
Bookmarks
Saved Pages
Web Search
Enter URL
History
PC Site Browser
Settings

S! Appli
S! Appli List
S! Appli Settings
Information

Entertainment
S! Information Channel/ Weather
S! Quick News
Free Contents

Camera
Camera
Video Camera
Bar Code Reader
Magnifying Loupe

Media
Audio
Video

Tools
Alarms
Calendar
Calculator
Notepad
Count Down Timer
Answer Phone
Voice Recorder
Bar Code Reader
Software Update
One Touch Guide

Data Folder
Pictures
Ring Songs-Tones
S! Appli
Music
Videos
Books
Customized Screen
Templates
Flash(R)
Other Documents
Memory Status

Infrared
Infrared ON/OFF
Send Account Details
Send All Phone Book

TV
Watch TV
Program List
TV Link
Channel List
Channel Settings
User Settings

Phone
Phone Book
Create New Entry
Mail & Call Log
Group
Account Details
One Touch Key
S! Addressbook Back-up
Memory Manager
Settings
Memory Status

Settings
Sound Settings
Display Settings
Customized Screen
Phone Settings
Security
Call Settings
Manner Mode Settings
Location Settings
Memory Card Manager
Key Settings
Battery/eco Mode Settings

Handset Security

USIM PINs

There are two USIM Card security codes: PIN & PIN2

- PIN and PIN2 are set to **9999** by default.
- PIN/PIN2 can be changed (☎ P.XX-XX).

PIN	4 to 8-digit code used to prevent unauthorized handset use. <ul style="list-style-type: none">● When PIN Certification is ON (☎ P.XX-XX), PIN entry is required each time handset is turned on (with USIM Card inserted).
PIN2	Required to clear call costs or set maximum cost (☎ P.XX-XX).

PIN Certification

Main Menu ► **Settings** ► **Security** ► **PIN Certification**

> **ON** or **OFF** → Enter PIN

PIN/PIN2 Lock & Cancellation (PUK/PUK2)

PIN Lock or **PIN2 Lock** is activated if **PIN** or **PIN2** is incorrectly entered three times. **Cancel PIN Lock** or **PIN2 Lock** by entering **PIN Unblocking Key (PUK/PUK2)**.

Note

- If PUK/PUK2 is incorrectly entered ten times, USIM Card is locked and handset is disabled. Write down PUK/PUK2.
- For procedures required to unlock USIM Card, contact SoftBank Mobile Customer Center, General Information (☎ P.XX-XX).

Passwords

Phone Password

<Default> 9999

4 to 8-digit number required to use/change some handset functions.

- * appears for each digit entered.
- Phone Password can be changed on handset (☎ P.XX-XX).

Changing Phone Password

> **Main Menu** ► **Settings** ► **Security** ► **Change Phone Password**
► Enter current 4 to 8-digit Phone Password ► Enter new 4 to 8-digit Phone Password ► **YES**

Center Access Code (Call Barring Password)

4-digit number specified at initial subscription; required to access Voice Mail via landlines, subscribe to fee-based information or restrict handset services.

- If entered incorrectly three times, Security Code settings lock; Security Code & Center Access Code must be changed. Reach SoftBank Mobile Customer Center, General Information (☎ P.XX-XX) for details.

Getting Started

Manner Mode

Minding Mobile Manners



Please use your handset responsibly. Use these basic tips as a guide. Inappropriate handset use can be both dangerous and bothersome. Please take care not to disturb others when using your handset. Adjust handset use according to your surroundings.

- Turn it off in theaters, museums and other places where silence is the norm.
- Refrain from use in restaurants, lobbies, elevators, etc.
- Observe signs and instructions regarding handset use aboard trains, etc.
- Refrain from use that interrupts the flow of pedestrian or vehicle traffic.

Manner-related Features

Manner Mode	Mute handset tones and activate vibration for incoming transmissions.
Vibration	Activate in public places, meetings, etc. for silent call/message alerts.
Ringer Volume	Mute call/message tones.
Emission OFF Mode	Suspend all handset transmissions.
Answer Phone	Use to handle incoming calls when inappropriate/unsafe to answer.
Drive Mode	While driving, send a voice message informing the caller that you cannot answer the call. (Handset does not ring.)

Manner Mode



- 1 In Standby, press and hold  **#**
 appears.
 - To cancel: Press and hold  **#** again

Emission OFF Mode

Main Menu ► Settings ► Call Settings ► Emission OFF Mode

- 1 **ON** or **OFF**
 appears.
 - To cancel: Follow the same steps

Drive Mode

- 1 In Standby, press and hold  (Side Key)
 appears.
 - Press and hold  (Side Key) again

Universal Operations, etc.

Text Entry

Enter alphanumerics, hiragana, kanji, katakana, symbols and pictographs.

■ Text Entry Window

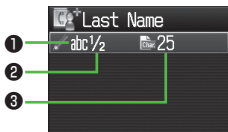

① Input Modes	Operation
漢: Kanji (Hiragana) か: Katakana abc: Alphanumerics 123: Numbers	
② Double-byte/Single-byte	Operation
1/1: Double-byte 1/2: Single-byte	Press and hold
③ Character/Byte Count	
Remaining number of enterable characters appears, regardless of input mode.	
Remaining number of enterable byte appears.	

Note

- Follow the steps below to toggle input modes and single-/double-byte at the same time:
 [Menu] → *Input Options* → *Change Input Mode*

■ Help

Help describes text entry operations.

> In text entry window, [Menu] → *Help* → Select an item

Entering Text

Entering Characters

Example: Enter 鈴木

1 In alphanumerics mode, twice to switch to kanji (hiragana) mode

す: three times

ず: * → three times →

き: twice



*When the next character is on the same key, press first to move cursor.

2 to enter Forecast List

- To change word before converting, press .

- There are four types of word suggestion list: **Forecast**, **Normal**, **E-1-Kana** and **Prediction** (P.3-5)



3 to select 鈴木

Other Input Functions

Enter katakana/alphanumerics	several times to select an input mode → Enter characters
Enter small kana (っ, っ, etc.)	Enter a character → <ul style="list-style-type: none"> • Alternatively, press a key repeatedly to enter an assigned small kana.
Enter upper case characters	Enter a character → <ul style="list-style-type: none"> • Alternatively, press a key repeatedly to enter an assigned upper case character.
Add ° or °	Enter a character → for ° or twice for ° <ul style="list-style-type: none"> • In single-byte katakana mode, ° and ° are entered as a single-byte character.
Insert line break	to insert line breaks in text
Insert space at end of text	
Insert space within text	repeatedly until single-byte space appears*, or use symbol list for double-byte or single-byte space ()
Toggle characters in reverse order	 Example: From c, press to toggle as follows: c → b → a → 2...
Undo	[Menu] → Undo

* Space cannot be entered within text in Numbers mode by following the steps above.

Universal Operations, etc.

Pictographs & Symbols

- Pictographs do not appear in messages sent to incompatible SoftBank handsets or e-mail addresses.

1 Open Pictograph List

In text entry window, (✳)

Open Symbol List

In text entry window, press and hold (#) or (✳) in pictograph list

List Log may appear first.

Pictograph List Number

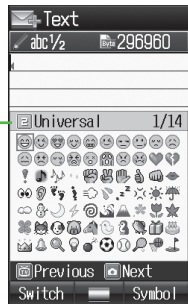

Symbol List Number

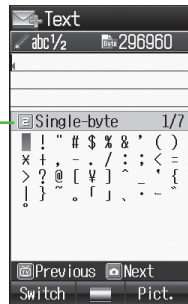

- Functions Available in Pictograph/Symbol List (☞ P.3-4)

2 (🌀) to select a pictograph or symbol

List Log/Symbol Log

- In Symbol Log, single-byte symbols appear in upper half of window; double-byte symbols in lower half.
- In List Log, pictographs appear in upper half of window; My Pictograms in lower half (only in S! Mail text entry window).

Pictograph Type

- Universal (Cross-carrier)
Pictographs
- All Pictographs
- My Pictograms

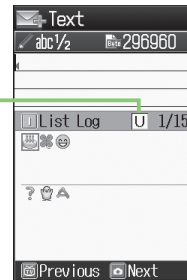

Editing Text

Deleting & Replacing

1 Delete Characters within Lines

Place cursor before a character → 

A character after cursor is deleted.

- Press and hold  to delete all characters after cursor.

Delete Characters from the End of Text

Place cursor at the end of text → 

A character before cursor is deleted.

- Press and hold  to delete all characters before cursor.

2 Enter another character

Copy/Cut & Paste

- Up to seven copied/cut entries are stored; six text entries and one Graphic Mail entry.

1 In text entry window,  [Menu] → *Copy* or *Cut*

2 Select Text to Copy/Cut

Place cursor before (or after) text to select →  →

Place cursor after (or before) text → 

Select All

 [All] → 

3 Paste Text

Place cursor at target location → Press and hold 

Paste Previously Copied/Cut Text

Place cursor at target location →  [Menu] → *Paste* →

Select data

Note

- Turning off power deletes stored text data.
- Graphic Mail entry is deleted when S! Mail text entry window is closed.

Calling

Emergency Calls

Call 110 (Police), 119 (Fire & Ambulance) or 118 (Coast Guard) even when some handset restrictions are active.

Calls cannot be Made in Following Cases:

- While Emission OFF Mode is active
- In PIN entry window upon turning on handset (PIN Certification is **ON**)
- While Secure Remote Lock is active
- When USIM Card is not inserted

Emergency Positioning Request

When an emergency call is made from a mobile phone, location is reported to first response agencies such as the police.

- Location information may be inaccurate due to location or signal conditions. Describe location or nearby landmarks.
- Base Station Positioning System is accurate within 100 meters to 10 kilometers. Location information from distant base stations may be inaccurate.
- Function available where first response agencies have completed system installation.
- Dialing 184 before 110, 119 or 118, cancels location report. However, first responders may obtain location information for immediate and serious threats to life.
- Not available for international roaming.
- Requires no separate subscription or transmission fees.

Voice Calls

Making Voice Calls

1 Enter number with area code → 

- To adjust volume: 

2  to end call

Calling from Call Log

>  → Select an entry → 

Making Calls from Phone Book

>  → Select an entry → Select a phone number → 

Showing/Hiding Caller ID

> Enter number →  [Menu] → *My caller ID* → *Show* or *Hide*

Answering Voice Calls

1 When a call is received,  to talk

2  to end call

Calling

International Call

- Application not required. For details, go to:
http://mb.softbank.jp/en/global_services/call/

1 Enter a phone number

2  [Menu] → **International Call**

Country/Area Number List appears.

3 Select a country/region

4 **Voice Call**



Video Call



■ Enter Country/Region Code Directly

- >  → Press and hold  to display +(IDD Prefix) → Enter a country/region code → Enter a number (omit first 0) → Voice Call: /Video Call: 
- International Code is set to **0046010** by default. The number can be changed if required (👉 P.16-9).
 - Do not omit leading **0** to call to Italy (country code: 39).

Global Roaming

- May require application to Global Roaming Service. For details, go to:
http://mb.softbank.jp/en/global_services/global_roaming/

Example: When Roaming Dial Assistant is ON

- **Roaming Dial Assistant** is set to **ON** by default.



1 **Voice Call**

Enter a phone number → 

Video Call

Enter a phone number → 

2 Select an item (See below)

Item	Operation/Description
Call to Japan*	Call Japan
Call to Visited Country/Area	Call within the country/region
Call to Other Country/Area*	Call other countries/regions > Select a country/region → Voice Call:  /Video Call: 
As is Call	Manually enter number to call Select when calling within the country/region

* Leading **0** is omitted and IDD Prefix and country/region code (e.g. **+81**) are added. (When calling Italy, leading **0** is not omitted.)

Note

- IDD Prefix and country/region code can be manually entered in Step 1. Alternatively, save IDD Prefix and country/region code in Phone Book entries.

Calling

Global Roaming Settings

■ Add to Country/Area Number List

> Within Japan: Enter a number → [Menu] → **International Call** → [Menu] → **Add** → Enter a country/region name → Enter country/region code

> Outside Japan: Enter a number → Voice Call: [Video Call] → **Call to Other Country/Area** → [Menu] → **Add** → Enter a country/region name → Enter country/region code

■ Network Mode

<Default> Automatic

> **Main Menu** ▶ **Settings** ▶ **Call Settings** ▶ **Optional Services**
▶ **International Setting** ▶ **Select Network** ▶ Select an item (See below)

Item	Operation/Description
Automatic	Handset automatically selects 3G network in Japan, and available network (3G or GSM) when abroad.
Manual	> Select an item <ul style="list-style-type: none">• 3G/GSM : 3G/GSM service area in Japan or abroad. Handset selects an available network automatically.• 3G : 3G service area in Japan or abroad.• GSM : GSM service area abroad. Unavailable in Japan.

● **Automatic** is recommended.

■ Select Operator

> **Select Operator** → **Select Auto/Manual** → **Manual** → Select an operator

■ Deactivate Roaming Dial Assistant

> **Roaming Dial Assistant** → **ON** or **OFF**

● When set to **OFF**, Voice/Video/International calls from abroad are placed in the same manner as calling from Japan.

Video Calls

Video Call Window

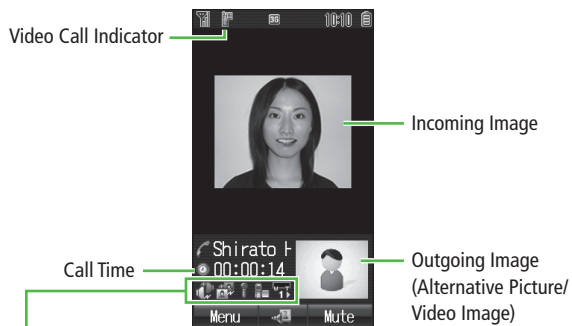

Indicators

- | | |
|---|---|
| Incoming/Outgoing Sound OK | Incoming Image OK/
Outgoing Image NA |
| Incoming Sound NA/
Outgoing Sound OK | Incoming/Outgoing Image NA |
| Incoming Sound OK/
Outgoing Sound NA | Microphone ON |
| Incoming/Outgoing Sound NA | Microphone OFF |
| Incoming/Outgoing Image OK | Video ON |
| Incoming Image NA/
Outgoing Image OK | Alternative Picture ON |
| | Zoom Level (1-25) |

● Display appearance may vary by settings/conditions.

Making Video Calls

- 1 Enter number with area code → [V.Call]
 - To adjust volume:
- 2 to end call



Answering Video Calls

- 1 When a video call is received, or
 - To send Video Image: [image]
- 2 to end call

Calling

Answer Phone

Record up to eight voice messages on handset.



- When Answer Phone is active,  appears in Standby.
- Unavailable when: handset is off or in Emission OFF Mode; **OUT** or  (red) appears. Use Voice Mail ( P.XX-XX).

Activating/Canceling Answer Phone

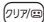
<Default> ON

- 1 Press and hold 
Toggles **ON** and **OFF**.

Playing Messages

When a new message is recorded, Information window opens ( P.XX-XX) and  appears in Standby.

- 1 In Information window, **Answer Phone**
→ Select a message

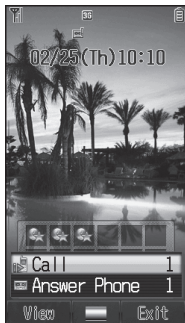

Optional Services

Call Forwarding

Forward unanswerable calls to a preset number when handset is off, out-of-range, etc.

- Call Forwarding and Voice Mail cannot be set simultaneously.
- When forwarding Video Calls, set a destination phone that supports 3G-324M standard video calls. If not, Video Calls are not forwarded.

Activating Call Forwarding

Main Menu ► Settings ► Call Settings ► Optional Services
► Voice Mail/Call Forwarding

- 1 **Call Forwarding ON** → Select a type
- 2 Select an item (See below)

Item	Operation/Description
Ringer Off	Forward all calls without ringing/vibrating
Ringer On	Forward missed calls

- 3 **Select from Phone Book**
Phone Book → Select an entry → Select a phone number
Direct Entry
Direct Entry → Enter a phone number



Calling

4 If **Ringer On** is selected in step 2, select ring time

■ Cancel Call Forwarding

> In Step 1, **Cancel All** → 

Note

- Toll free numbers and international call numbers cannot be saved as a destination number.
- When using Call Forwarding together with Answer Phone, the function with shorter ring time takes priority. (Priority may change due to signal conditions.)
- When **Ringer On** is set, following operations are available while handset is ringing/vibrating (within ring time).
 - To answer a call: 
 - To forward a call:  **[Forward]**

Voice Mail

Unanswered calls are forwarded to Voice Mail Center as set or when handset is off, out-of-range, engaged, etc.

- Calls are forwarded to Voice Mail Center via Call Forwarding function; Call Forwarding and Voice Mail cannot be set simultaneously.
- Voice Mail is not available for Video Calls.

Activating Voice Mail

Main Menu ► Settings ► Call Settings ► Optional Services
► Voice Mail/Call Forwarding



1 **Voice Mail ON** → Select an item (See below)

Item	Operation/Description
Ringer Off	Forward all calls without ringing/vibrating
Ringer On	Forward missed calls > Select a ring time

■ Cancel Voice Mail

> In Step 1, **Cancel All** → 

Note

- When using Voice Mail together with Answer Phone, the function with shorter ring time takes priority. (Priority may change due to signal conditions.)
- When **Ringer On** is set, following operations are available while handset is ringing/vibrating (within ring time).
 - To answer a call: 
 - To forward a call:  **[Forward]**

Calling

Checking Voice Mail Messages

Information window (P.1-19) and  appear in Standby when new messages are recorded.

1 In Information window, **Voice Mail**

Follow voice guidance.

Information window and  disappear after messages are checked.



■ View Details

View callers' phone numbers and date/time Voice Mail messages were left before playing messages.

● Activate **Missed Call Notification** beforehand. (P.1-19)

>  to open Incoming Call Log → Select a Voice Mail notification → View details →  [Menu] → **Listen to Voice Mail**

Note

● Alternatively, follow these steps to check Voice Mail:

Main Menu ► **Settings** ► **Call Settings** ► **Optional Services**
► **Voice Mail/Call Forwarding** ► **Listen to Voice Mail**

Missed Call Notification

When Missed Call Notification function is active, Information window appears for calls missed while handset was off, out-of range, engaged etc.

● Available only when Voice Mail is active.

Main Menu ► **Settings** ► **Call Settings** ► **Optional Services**
► **Missed Call Notification**

1

Handset connects to the Network.

Follow voice guidance.

When Calls are Received while Missed Call Notification is Active...

Information window appears for missed calls when handset is turned on or comes into range.

Select **Missed Call** in Information window to view Incoming Call Log.

● **Voice Mail** appears in Information window when Voice Mail messages were recorded (P.1-19).



Calling

Call Waiting

Place the current call on hold and answer a second, or alternate between calls.





Activating/Canceling Call Waiting

Main Menu ► Settings ► Call Settings ► Optional Services
► Call Waiting

Current status appears.

1 [Menu] → *Activate* or *Deactivate*

Answering Second Call

- 1 When tone sounds, 
- Press  to alternate between calls.
 - When the party hangs up, active call ends.
 - Press  to re-engage the party on hold.
 - Press  to disconnect all lines.

Reject Second Call

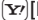
> When tone sounds,  [Reject]

Note

- When Voice Mail or Call Forwarding is set to **Ringer On** while Call Waiting is active, unanswered calls are transferred to Voice Mail Center or the forwarding number.
- When Voice Mail or Call Forwarding is set to **Ringer Off**, Call Waiting is disabled.

Group Calling

Call another party during a call and alternate between calls. Add other parties to talk on up to five lines simultaneously.

- Separate subscription is required for this service.





Dialing New Number during a Call

- 1 Enter a phone number during a call → 
- The line switches. The other line is placed on hold.

Use Phone Book

> During a call, [Menu] → *Phone Book* → Select an entry → Select a number → 

Swap Calls

- 1 During a call, 
- Press  to toggle lines.
 - When the party hangs up, the call ends.
 - Press  to re-engage the line on hold.
 - Press  to disconnect all lines.

Calling

Connecting to Multiple Parties

1 While switching between two lines, [Menu] → **Speak with All**

- Connect up to five lines simultaneously.
- Press [] to disconnect all lines.

Item	Operation/Description
Add a New Party to a Call	> Enter a number during Group Calling → [] → After the party is connected, [Menu] → Speak with All
Check Members	> During Group Calling, [Menu] → Member
Talk with One Party	> Highlight a member [Menu] → Split
End Calls Individually	> Highlight a member → [End]

Call Barring

Restrict incoming/outgoing Voice Calls, Video Calls or SMS messages.

- When Call Forwarding or Voice Mail is active, **Bar All Outgoing Calls** and **Bar All Incoming Calls** are not available. (Call Forwarding or Voice Mail takes priority.)

Activating/Deactivating Call Barring

Main Menu ▶ Settings ▶ Call Settings ▶ Optional Services ▶ Call Barring

1 **Outgoing Calls** or **Incoming Calls** → Select an item (See below)

Item	Operation/Description
Bar All Outgoing Calls	Restrict all non-emergency calls
Bar All International Calls	Allow only domestic calls
Bar International Calls	Restrict all international calls except to Japan
Bar All Incoming Calls	Reject all calls
Bar All If Roamed	Reject calls when outside Japan

2 [Menu] → **ON** or **OFF**

3 Enter Call Barring Password

Calling

■ Cancel All Call Barring

> In Step 1, **Cancel All Barring** → Enter Call Barring Password

Note

- Emergency numbers (110, 119, 118) are dialable when Call Barring for outgoing calls is active.
- If call is attempted when Call Barring is active, warning message appears. It may take longer to appear in some areas. Check Call Barring settings if the message does not appear.

Caller ID

Show or hide your number when calling.

<Default> Network Set

Main Menu ► Settings ► Call Settings ► Show My Number

1 Select an item

- **Network Set** Caller ID setting varies by subscription.

Note

- Alternatively, enter these numbers/symbols before the phone number to show or hide Caller ID:

Show: 1 8 6 or * 3 1 #

Hide: 1 8 4 or # 3 1 #

Phone Book

Phone Book Entry Items

Save up to 1000 entries in handset Phone Book; 50 entries to USIM Card Phone Book.

Phone Book Entry Items	Handset	USIM Card
Last Name/First Name	Available	Available
Reading	Available	Available
Phone Number	5	2
Email Address	5	1
Birthday	Available	N/A
Address	Available	N/A
Note	Available	N/A
Voice Call Ringtone	Available	N/A
Video Call Ringtone	Available	N/A
Message Ringtone	Available	N/A
Notification Light	Available	N/A
Picture	Available	N/A
Group	Available	Available
Secret Setting	Available	N/A

Calling

Saving to Phone Book

- 1 Press and hold  →  [Menu] → *New Entry* → Select an item → Enter information →  [Save]

■ Save Settings

- > **Main Menu** ▶ *Phone Book* ▶ *Settings* ▶ *Save Settings*
 - ▶ *Phone, USIM* or *Ask Every Time*

■ Edit Phone Book Entries

- >  → Highlight a Phone Book entry →  [Menu] → *Edit* → Edit entry →  [Save]

Messaging

Basics

Send messages via S! Mail or SMS.

- SoftBank messaging services are available in Japan and overseas.

S! Mail [Separate subscription required]	Exchange text messages with SoftBank or e-mail compatible handsets, PCs, etc.; attach image or sound files etc.
SMS	Exchange short text messages with SoftBank handsets.

- For more information, visit SOFTBANK MOBILE Corp. Website (<http://www.softbank.jp>).

Messaging Folders

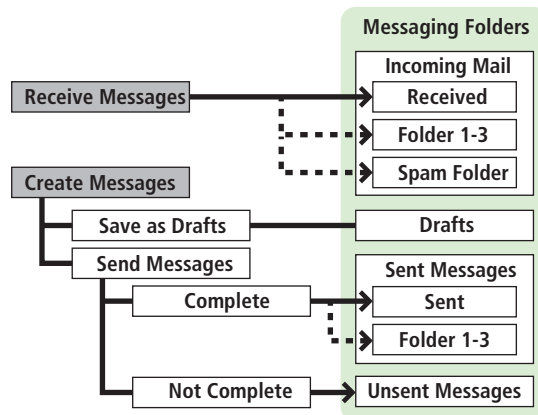

■ Set Auto Delete Off

- > Auto Delete → Auto Delete Sent Messages or Auto Delete Incoming Messages → OFF

■ View Memory Status

- > [Envelope Icon] → Memory Status → Phone or USIM (→ For Phone, Outgoing or Incoming)

Messaging Folder Contents

Received/Sent Date & Time,
Sender/Recipient S! Mail Subject/
SMS Message Text

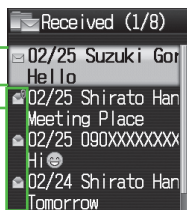

Example: Received Folder
in Incoming Mail

Message Type/Status

Message Type	Message Status
Unread/Read S! Mail	Attachment(s)
Unread/Read S! Mail Notice	(Gold) Protected
Unread/Read SMS	Forwarded Message
Unread/Read USIM Card SMS	Replied Message
Forwarded Server Mail	New Delivery Report (Sent Messages)
	SMS Concatenating
	High Priority
	Low Priority

Customizing Handset Address

Change your handset mail address (alphanumerics before @) to reduce the risk of receiving spam. Default account name is random alphanumerics.

abc123-xyz @ softbank.ne.jp
 [Account] [Domain]
 Name Name
 (Customize here)

- For details, visit SOFTBANK MOBILE Corp. Website (<http://www.softbank.jp>).

1 → Settings → Custom Mail Address

Handset connects to the Network.
Follow onscreen instructions.

Sending S! Mail & SMS

Sending S! Mail

1 Press and hold 

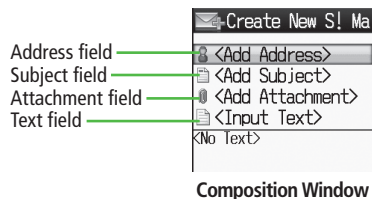

2 Select Address field

3 **Select from Phone Book**

Phone Book → Select a Phone Book entry → Select a SoftBank handset number/mail address

Enter Directly

Enter Number or **Enter Address** → Enter a SoftBank handset number/mail address

Select from Sent/Received Logs

Send Logs →  to select a Log → Highlight a record →

 **[Select]**

4 Select Subject field → Enter subject

5 Select Text field → Enter text

6  **[Send]**

Additional Functions



Add Attachments

> Select Attachment field → Select a folder in Data Folder → Select a file →
 **[Send]/[Select]**

Add Address

> Select Address field → **<Add Recipient>** → Search/enter address → Select an address or enter directly

Use Templates

> Select Address field →  **[Menu]** → **Insert Template** → Select a template →  **[Set]**

Use My Pictograms

> In S! Mail text entry window,  →  **[Switch]** as required → Select a My Pictogram

Sending SMS Messages

1 → *Create New SMS*

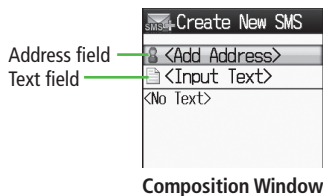

2 Select Address field



3 **Select from Phone Book**

Phone Book → Select a Phone Book entry → Select a SoftBank handset number

Enter Directly

Enter Number → Enter a SoftBank handset number

Select from Sent/Received Logs

Send Logs →  to select a Log → Highlight a record →  [Select]

4 Select Text field → Enter text

- When number of entered character exceeds limit, S! Mail conversion option message appears.

5 [Send]

■ **Manual Mail Conversion**

> In SMS Composition window,  [Menu] → **Switch Message Type**

Receiving Messages

Retrieving S! Mail Automatically

Auto Download retrieves complete messages and any attachments. Transmission fees are incurred; adjust to use. (To disable Auto Download:  P.XX-XX)

When a new message is received,  appears and Information window opens in Standby.

1 In Information window, **Message**



- When information window does not appear, 
 - ▶ **Incoming Mail** ▶ Select a folder
 - ▶ Select a message.



Messaging

Retrieving Complete S! Mail

When Center sends initial portion of message (S! Mail Notice), retrieve the complete message manually.

- 1 Select a message with  or  →
Select ***There are sequels*** at the end of message text

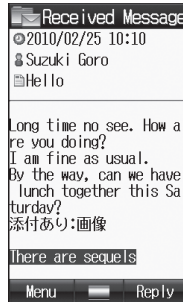

Incoming Options

TBD

Internet

Getting Started

Access Yahoo! Keitai Mobile Internet and PC sites.

Internet

Yahoo! Keitai

- View Mobile Internet Websites
- Download image/sound files, etc.
- Video/Music Streaming
- Register S! Quick News

PC Sites

- View PC Sites
- Download still images

- Separate subscription is required for Network access.
- For more information, visit SOFTBANK MOBILE Corp. Website (<http://www.softbank.jp>).

Yahoo! Keitai

From ► Main Menu ► Yahoo!

Opening Yahoo! Keitai Menu

- 1 Open Top Menu
Yahoo! Keitai

Open Menu List
Menu List

- 2 Select a menu item
 - Repeat Step 2 as required.

Web Search

- 1 *Web Search* → Enter text

Entering URL

- 1 **Enter URL Directly**
Enter URL → *Direct Entry* → Enter URL
Use URL History
Enter URL → *URL History List* → Select a URL

Using Access Histories

- 1 **History** → Select a history

Exiting Mobile Internet

- 1  → 



Browsing Using PC Sites

View PC websites using PC Site Browser.

- Some pages may not be viewable.
- Viewing PC websites may incur high charges.

From ► **Main Menu** ► **Yahoo!** ► **PC Site Browser**

Opening Menu

- 1 **Homepage** →  [OK] →  [YES]/ [NO]
- 2 Select a menu item
Repeat Step 2 as required.

Web Search

Follow same operation accessed from Yahoo! Keitai.

Entering URL

Follow same operation accessed from Yahoo! Keitai.

Internet

Using Access Histories

Follow same operation accessed from Yahoo! Keitai.

- Follow Step 1 of same operation accessed from Yahoo! Keitai. (☞P.XX-XX)

Exiting Internet



Internet Settings

Browser Display Settings/Memory Manager

Yahoo! Keitai

From ► **Main Menu** ► Yahoo! ► Settings

PC Site Browser

From ► **Main Menu** ► Yahoo! ► PC Site Browser
► PC Site Browser Settings

Setting/Operation	Default
■ Font Size > <i>Font Size</i> → <i>Large</i> or <i>Small</i>	Normal
■ Scroll Unit > <i>Scroll Unit</i> → <i>Whole Screen</i> or <i>Half Screen</i>	Single Line
■ Images Off > <i>Downloads</i> → <i>Display Images</i> → <i>OFF</i>	ON
■ Sounds Off > <i>Downloads</i> → <i>Play Sounds</i> → <i>OFF</i>	ON
■ Hide Warning Messages when Activating PC Site Browser or Switching to Yahoo! Keitai* > <i>Warning Messages</i> → <i>Activate PC Site Browser</i> or <i>Switch To Yahoo! Keitai</i> → <i>OFF</i>	ON (Show)

* PC Site Browser only

Internet

Memory Manager & Reset

Setting/Operation	Default
<ul style="list-style-type: none"> ■ Clear Cache > <i>Memory Manager</i> → <i>Clear Cache</i> → <input type="checkbox"/> 	-
<ul style="list-style-type: none"> ■ Delete Cookies > <i>Memory Manager</i> → <i>Delete Cookies</i> → <input type="checkbox"/> 	-
<ul style="list-style-type: none"> ■ Delete User ID or Password Entered when Authentication is Required > <i>Memory Manager</i> → <i>Delete Certificates</i> → <input type="checkbox"/> 	-
<ul style="list-style-type: none"> ■ Delete Input Memory > <i>Memory Manager</i> → <i>Delete Input Memory</i> → <input type="checkbox"/> 	-

Security Settings

Setting/Operation	Default
<ul style="list-style-type: none"> ■ Set Auto Send Off for Manufacturer's Number (for Authentication) > <i>Security</i> → <i>Manufacture Number</i> → <i>OFF</i> 	ON (Send)
<ul style="list-style-type: none"> ■ Set Not to Send Referrer Information > <i>Security</i> → <i>Send Referrer</i> → <i>OFF</i> 	ON (Send)
<ul style="list-style-type: none"> ■ Select whether or Not to Allow Cookies to be Stored on handset > <i>Security</i> → <i>Cookies</i> → <i>OFF</i> or <i>Ask Every Time</i> 	ON (Save)

Setting/Operation	Default
<ul style="list-style-type: none"> ■ Select whether or Not to Run Scripts in Yahoo! Keitai¹ > <i>Security</i> → <i>Script</i> → Select an item 	Ask before Connect
<ul style="list-style-type: none"> ■ Select whether or Not to Run Scripts in PC Site Browser² > <i>Security</i> → <i>Script</i> → Select an item 	ON (Run)
<ul style="list-style-type: none"> ■ View Electronic Certificates Issued by Certificate Authorities > <i>Security</i> → <i>Root Certificates</i> → Select an item 	-
<ul style="list-style-type: none"> ■ Select whether or Not to Retain Authentication Information > <i>Certificate Retention</i> → <i>Always Keep</i> or <i>Not Keep</i> 	Keep while Browsing

¹ Yahoo! Keitai Browser only

² PC Site Browser only

Reset

Setting/Operation	Default
<ul style="list-style-type: none"> ■ Initialize Browser > <i>Initialized Browser</i> → <input type="checkbox"/> → Enter Phone Password 	-
<ul style="list-style-type: none"> ■ Reset Browser Settings > <i>Reset Defaults</i> → <input type="checkbox"/> [YES] → Enter Phone Password 	-

Connectivity

Infrared

Before Using Infrared

Transfer Phone Book/Schedule entries, messages, bookmarks and Data Folder files wirelessly between handset and compatible devices, including PCs and other mobiles.

- 002P infrared function is based on IrMC1.1, however, some IrMC1.1-based device transmissions may not be transmitted/received within specification.
- Debris may inhibit infrared transfers; clean infrared ports with a soft cloth beforehand.
- Direct sunlight/fluorescent light may inhibit transfers.
- When data transfer is interrupted, it may take some time for process to complete.
- Align infrared ports within 20 cm of one another and make sure no objects are placed between them. Do not move the devices until transfer is complete.

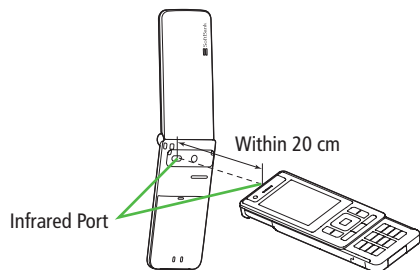

Transferable Files

Transferable File \ Condition	One File	All Files
Phone Book (Account Details) ^{1,2}	Available	Up to 1000
Schedule entries ^{1,3}	Available	N/A
Messages	Available	N/A
Data Folder files	Available	N/A
Bookmarks	Available	N/A

¹ Ringtone, Notification Light, Picture and other entry settings are lost in transfers.

² Group, Secret Setting and other entry settings are also lost when one entry is transferred.

³ Entries without specified date/time cannot be received. Entries with date/time that cannot be set on 002P are not saved (👉 P.12-3).

Note

- Depending on their content, some incoming Phone Book/Schedule entries, messages or bookmarks may not be received, or may be altered beyond the parameters.
- If memory becomes full, remaining entries are truncated.

Connectivity

Sending

One File Transfer

1 Highlight a file →  [Menu] → Follow the steps below

Files	Operation/Description
Phone Book/ Account Details/ Data Folder files	> <i>Send</i> → <i>Infrared</i>
Messages/ Schedule entries/ Bookmarks	> <i>Send via Infrared</i>
SMS in Incoming Mail folder	> <i>Local Connectivity</i> → <i>Infrared</i>

All Phone Book Transfers

Precaution

- Receiving all files overwrites all saved files including secret entries.
- Sending all Phone Book entries transfers Account Details as well. User-saved Account Details is overwritten on receiving handset (handset number remains).

Infrared Authentication Code

Infrared Authentication Code (4 digits) is required for all data transfers via Infrared. Sender and recipient must enter same Authentication Code to complete transfers.

Main Menu ► **Infrared** ► **Send All Phone Book**

1  → Enter Phone Password → Enter Authentication Code

Receiving

Main Menu ► **Infrared** ► **Infrared ON/OFF**

1 **ON** → When a file is received, 

2 **One File Transfer**

Select an item → Follow the steps

All File Transfers

 → Enter Phone Password → Enter Authentication Code

External Device

SoftBank Utility Software (Japanese)

Phone Book, Calendar, messages, bookmarks and Data Folder files can be transferred to a PC, edited or managed by using SoftBank Utility Software.

- USB cable (not included) is necessary for using SoftBank Utility Software.
- For details on and downloading SoftBank Utility Software, visit <http://www.softbank.jp/mb/r/sbu/> (Japanese)

USB (Japanese)

Connect handset to a PC via USB cable (not included) specified by SoftBank for data transfer or data communication.

- Transfer data using SoftBank Utility Software.

Data Communication via USB Cable

Use handset as a modem for Internet access by connecting handset with a PC.

- Download utility software from URL below and install on PC.
<http://panasonic.jp/mobile/support/download/002p/index.html>
- 1 Install "USB ドライバ (USB Driver)" and "Modem Wizard" from Utility Software (002P) to a PC
 - 2 Connect handset to PC via USB cable
 - Power up handset before connecting to PC via USB cable.
 - 3 Start up "002P Modem Wizard", and operate communication setup
 - "Modem Wizard" enables you to set up APN and dial-up easily.
For setup/starting procedures, see "Modem Wizard" Help.

Note

- Connecting handset to a PC or PDA for Internet access may incur high packet transmission fees.

Connectivity

USB Charge

Connect handset to a PC via USB cable to charge battery.

- Both PC and handset must be powered up.
- USB Charging may be slower/less effective than AC Charger.

Camera & Imaging

Before Using Camera

002P features approximately 3.2 Mega Pixel CMOS Auto-focus Camera capable of capturing still images and videos.

Notes

- Remove dust/debris from lens cover with a soft cloth.
- Handset movement may blur images especially in dark places; hold handset firmly.
- Capturing/saving images immediately after handset has been left in a hot place may affect image quality.
- Exposing lens to direct sunlight may affect image quality.
- While Camera is active, Notification Light/Charging Indicator illuminates. Notification Light/Charging Indicator cannot be turned off.
- Shutter click sounds at fixed volume even in Manner Mode.

Note

- Camera is not available when battery is low.
- Incoming calls, Alarm and low battery cancel Camera. Captured images/recorded videos are saved.
- When left in preview window for three minutes, Camera is canceled and previous window returns.

Image File Formats

Still images/videos are saved to Data Folder.

Image Type	File Format	Save Location
Still images	JPEG (.jpg)	Pictures (Data Folder)
Videos	MPEG-4 (.3gp)	Videos (Data Folder)

Change Save Location

> *Save to* → *Phone* or *Memory Card*









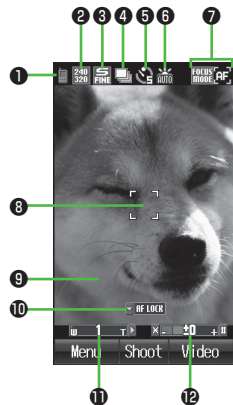







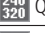

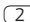







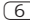

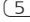



Camera Display Indicators

● Images shown below are for reference only.

Picture Preview Window

● Press  to open key assignment guide.

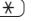

	Item	Description	Operation
①	Save to	 Phone  Memory Card	
②	Size	 XQGA  UXGA  SXGA  VGA  QVGA  QQVGA  Wallpaper	
③	Quality	 Super Fine  Fine  Normal	
④	Multi Shot	 Multi Shot	
	Night Mode	 Night Mode	
⑤	Self-Timer	 5 seconds  10 seconds	
⑥	White Balance	 Automatic  Fine  Cloudy  Light Bulb	
⑦	Focus Setting	 Auto Focus  Close-up  Scenery	
⑧	Focus Guide	Adjust focus automatically	—
⑨	Effect	Normal/Sepia/Monochrome/Negative	
⑩	Auto Focus Lock	Lock focus on the subject	 to set Auto Focus Lock
⑪	Zoom	Indicate zoom level (Level 1 to 25)	 to zoom in/  to zoom out ● Long press: continuous zoom
⑫	Brightness	Adjust brightness (Level -2 to +2)	 Brighter/  darker

Camera & Imaging

Video Preview Window

- Press to open key assignment guide.



Item	Description	Operation
1 Save to	Phone Memory Card	
2 Quality	Super Fine Fine Normal	<ul style="list-style-type: none"> Available only when Recording Time is set to Extended Video.
3 Recording Time	Attach to S! Mail Extended Video	
4 Self-Timer	5 seconds 10 seconds	
5 White Balance	Automatic Fine Cloudy Light Bulb	
6 Focus Setting	Close-up Scenery	
7 Effect	Normal/Sepia/Monochrome/Negative	
8 Zoom	Indicate zoom level (Level 1 to 25)	to zoom in/ to zoom out <ul style="list-style-type: none"> Long press: continuous zoom
9 Brightness	Adjust brightness (Level -2 to +2)	Brighter/ darker

Capturing Still Images

1 

2 Frame subject

3  **[Shoot]** to capture the image

Camera automatically focuses on subject before capturing image.

Shutter click sounds at fixed volume.

4  **[Save]**

● To return to preview window without saving the image: 

5  to exit

Return to Standby.



Picture Preview Window



Continuous Shooting

Capture a succession of 15 still images automatically with a single press.

- Picture size is fixed to **QVGA (240x320)**.
- When **Multi Shot** is **ON**, Night Mode is set to **OFF** automatically.

1 In Picture Preview Window, 

2 Frame subject →  **[Shoot]**

- Image thumbnails appear.
- To stop shooting halfway: 
- To return to preview window without saving the image:  **[Delete]** → Go to Step 1

3 To view captured images,  to select an image

Full-size image appears.

- Press  to toggle full-size images.

4 **When Viewing a Full-size Image**

 **[Save All]** or  **[Save]**

- Press  **[Save]** to save the full-size image.

When Viewing Thumbnailed Images

 **[Menu]** → **Save All Pictures** or **Save This One Only**

Note

- Data Folder opens when Phone memory becomes full. Delete files; image is automatically saved.
- If save location is set to Memory Card and memory becomes full, image is saved to Phone memory automatically.

Recording Videos



Video Preview Window appears.



Tone sounds.

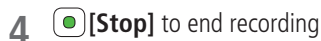

Tone sounds.

- Recording stops automatically at maximum recording time.
- To return to preview window without saving the image:  [Back]
- To review: **Playback**

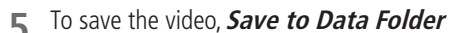

Return to Standby.

Note

- If Phone memory becomes full, Data Folder opens. Delete files; image is automatically saved.
- If save location is set to Memory Card, file is saved to Memory Card automatically. To delete the saved file, select **Delete**.





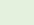
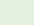
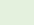

Video Preview Window

Other Camera Functions







From  Camera:  Video Camera:  →  [Video]

Auto Focus Lock



To focus on an off-centered subject, lock focus on the subject and recompose your picture.

- Check if Focus Setting is set to **Auto Focus** (☞ P.6-3).
- > Adjust Focus Guide to subject →  → Recompose your picture →  [Shoot] →  [Save]
- When in focus, handset sounds and Focus Guide turns green. When out of focus, Focus Guide turns red.
- To try again: 

Self-Timer

- >  → Frame subject →  [Shoot]/[Record] (→ For Video Camera,  [Stop] →  [Save] or **Save to Data Folder**
- Self-Timer tone sounds. After set period of time, shutter is released and capturing starts.
- Press  to toggle **5 seconds**, **10 seconds** and **OFF**.
- While Self-Timer is active, press  [Cancel] to return to preview window without canceling Self-Timer.

Send Still Images via S! Mail

- > Frame subject →  [Shoot] →  [S! Mail] → Create message (☞ From Step 2 on P.13-4)

Send Video via S! Mail

- Set Recording Time to **Attach to S! Mail** beforehand (☞ P.6-4).
- > Frame subject →  [Record] →  [Stop] → **Attach to S! Mail** → Create message (☞ From Step 2 on P.13-4)

Others

Digital TV

Initial Setup

Set channels for your area.

- Up to ten Channel Lists can be saved.

Main Menu ▶ TV ▶ Channel Settings ▶ Select Area

- 1 Select a region → Select a prefecture → 

Automatic Channel Setup

- If manual setup fails, try automatic channel setup.

Main Menu ▶ TV ▶ Channel Settings
▶ Set from Current Location

- 1  → After channel search,  → Enter title







Watching TV

- 1 

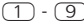

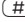
Viewer

- 2 Select a channel

Direct Channel Access	  (Channel 10)  (Channel 11)  (Channel 12)
Previous/ Next Channel	
Channel Search	Press and hold  ● To stop:  [Cancel] / 









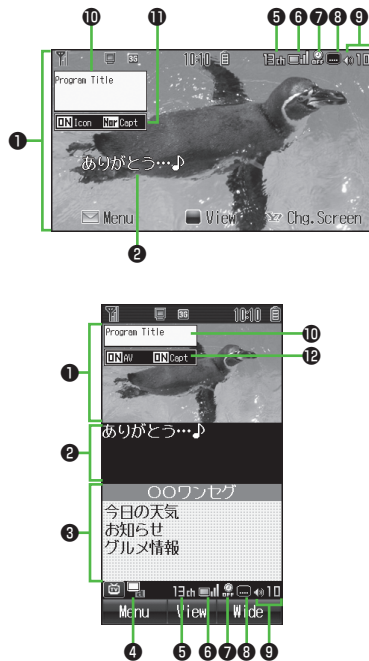



- 3 To end TV,  → 

Others

Indicators

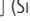
- Screenshots are provided for reference only.
Actual handset windows differ in appearance.



	Item	Description	Operation
1	Image	—	—
2	Captions	—	—
3	Data Broadcast	(☞ P.5-7)	—
4	Operation Mode ¹	 AV Mode  Broadcast Mode	 ● Each key press toggles modes.
5	Channel	(☞ P.5-3)	—
6	Signal Strength Level	    Strong ← → Weak Out of range	—
7	TV Off Timer	(☞ P.5-8)	—
8	Receiving Captions	—	—
9	Volume	—	● Adjust volume:  ³ ● Mute/Resume:  ³ /  (Side Key)
10	Program Title	—	 / 
11	Indicator/Caption Setting ²	Indicators: ON/OFF Caption: Normal/Small/OFF	 ● Each key press toggles settings.
12	Display/Caption ¹	Display: ON/OFF Caption: ON/OFF	 ● Each key press toggles settings.

¹ Available only in Normal Screen ² Available only in Wide Screen ³ Available only in AV Mode

Appendix

Handset Data Backup

Back up handset data (Phone Book, Calendar, Messages, Bookmarks, Content Keys) to Memory Card; restore handset data after accidental loss/alteration.

Main Menu ► Settings ► Memory Card Manager
► Memory Card Backup/Restore

1 Enter Phone Password

2 Select an item

- For **Messaging**, select a messaging folder

3 Backup

Copy to Memory Card →  → 

Restore

Overwrite to Phone →  →

Select a file → 

- Backup date serves as file name.

Example: "100202000.vcf" indicates that the file was backed up on 2 February 2010

- Backup files restored from Incoming Mail/Sent Messages folders are saved to Received/Sent folders.

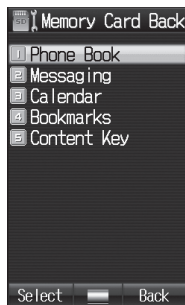

■ Delete Backup Files

> In Step 3, **Overwrite to Phone** →  → Highlight a file →  [Menu] → **Delete** → 

- Content Key backup files cannot be deleted.

■ Back Up Content Key

> Main Menu ► Settings ► Memory Card Manager



► Memory Card Backup/Restore ► Enter Phone Password

► Content Key ► Copy to Memory Card or Copy to Phone

- Content Keys with expiration dates or usage limits cannot be backed up.
- USIM Card inserted when Content Keys were moved to Memory Card must be inserted to move Content Keys from Memory Card.
- Some applications are not compatible with handset. Only Content Keys for compatible applications are backed up. Also, note that some keys are moved to Memory Card when backed up. Contact SoftBank Mobile Customer Center, General Information for more information (☎XX-XX).
- Backing up Content Keys overwrites previously saved Content Key backup.

Software Update

Check for 002P software updates and download as required.

- Transmission fees do not apply to updates (including checking for updates, downloading and rewriting).
- Software Update may take approximately 30 minutes.
- Fully charge battery beforehand. Even if  appears, low battery message may appear. In this case, charge battery until Charging Indicator goes out.
- Select a place where signal is strong and stable.
- Other functions are not available during Software Update.
- Software Update does not affect Phone Book entries, files saved in Data Folder or other content, but it is recommended that you create a backup of any important information and data (note that some files cannot be copied).
- SoftBank is not liable for damages resulting from loss of data, information, etc.
- Do not remove battery during the update. Update will fail.
- Software Update failure may disable handset. Contact SoftBank Mobile Customer Center, Customer Assistance ( P.XX-XX).

Main Menu ► Tools ► Software Update ► Software Update

1 → Follow onscreen instructions

After download is complete, handset automatically turns off and restarts before Software Update begins.

After Software Update is complete, handset automatically turns off and restarts before information appears for successful update. (This process takes approximately 30 seconds.)

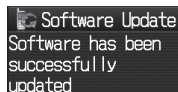

 Software Update
Software has been
successfully
updated

Update Results

In Information window, *Update Results*

- When Information window does not appear,
**Main Menu ► Tools ► Software Update
► Update Results.**



Scheduled Update

Follow onscreen instructions for setup.



Confirmation appears at scheduled update time. Press  or wait ten seconds for update to start.

Note

- SoftBank is not liable for damages resulting from loss of data, information, etc.
- Update may temporarily cancel Keyguard.
- Alarm tone does not sound during update.
- For more information, visit SOFTBANK MOBILE Corp. Website (<http://www.softbank.jp>).

Troubleshooting



Handset does not turn on

- Was  pressed for more than three seconds?
- Is battery level sufficient?
- Is battery inserted properly? ( P.XX-XX)



Handset functions do not work after turning power on

- Does PIN entry window appear?
PIN Certification is **ON**. Enter PIN. ( P.XX-XX)



Insert USIM or INVALID USIM appears when handset is turned on or operations attempted

- Is USIM Card inserted correctly? ( P.XX-XX)
- Unusable USIM Card may be inserted ( P.XX-XX).
- USIM Card IC chip may be dirty.
Wipe with a clean cloth, then insert USIM Card correctly.

Keypad does not respond

- Does  appear in Standby?
Keyguard is active ( P.XX-XX).
Cancel Keyguard.

Outgoing calls or Video Calls will not connect or message and Internet connections are unavailable

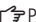
- Does **OUT**  (red) appear?
Is handset out-of-range or in a location where signal is weak?
Move to a location where signal is strong.
- Does  appear?
Cancel Emission OFF Mode ( P.XX-XX).
- Are you using handset overseas?
Set international settings (e.g. select operator) to use abroad ( P.XX-XX).

Outgoing calls will not connect

- Is area code entered?
- Is restricting outgoing calls in Call Barring? ( P.XX-XX)



Outgoing calls will not connect or busy signal sounds

- Did you enter area code?

Call is interrupted or disconnected

- Does **OUT** appear? Is handset out-of-range or in a location where signal is weak?
Move to a location where signal is strong.

Display clock is reset

- Replacing battery does not reset Display clock; however, if battery is removed for long periods, the clock may be reset. Set Date & Time ( P.XX-XX) or Retrieve NW Info ( P.XX-XX) again.

Digital TV does not work

- Is handset out of terrestrial Digital TV broadcasting service area or in a location where airwaves are weak?
Move to a location where airwaves are strong ( P.XX-XX).

Appendix

Cannot charge battery

- Is AC Charger (sold separately) firmly connected to handset or Desktop Holder (not included)? (☞ P.XX-XX)
- Is AC Charger securely plugged into an outlet?
- Is battery installed in handset correctly? (☞ P.XX-XX)
- Is handset correctly mounted in Desktop Holder?
- Make sure handset, battery, Desktop Holder and AC Charging terminals are clean.
- Is ambient temperature between +5°C and +35°C? Otherwise, battery may not reach full charge.
- When charging battery during a call/data transmission, Notification Light/Charging Indicator may go out due to handset temperature increase. When handset temperature returns to normal level, Notification Light/Charging Indicator illuminates again.
- Battery may need to be replaced.

Handset/accessories feel warm

- AC Charger/Desktop Holder may warm during charging. Handset may warm during long use. This is normal if you can hold it comfortably. Low temperature burns may occur if handset is held against skin for long periods.

Battery Operating Time is greatly reduced



- Battery Operating Time may be reduced by environmental factors such as temperature, charging conditions or signal strength, as well as by operations or settings. See "Charging Time & Operating Time Estimates" (☞ P.XX-XX) and "Battery Time" (☞ P.XX-XX).

Warning Signs

Problem	Causes and Remedies
OUT appears	Handset is out-of-range. Move to a location where signal is strong.
🔒 appears	Keyguard is active (☞ P.XX-XX). Cancel Keyguard to use keys. Answer calls even if Keyguard is active.
Low battery message appears and battery alarm tone sounds	Battery is low. Charge (☞ P.XX-XX) or replace battery (☞ P.XX-XX).

Safety Precautions

- Before use, read these safety precautions carefully and use your handset properly. Keep this guide in a safe place for future reference.
- These safety precautions contain information intended to prevent bodily injury to the user and to surrounding people, as well as damage to property, and must be observed at all times.
- SoftBank is not liable for any damages resulting from use of this product.
- These symbols indicate level of harm from failure to observe cautions or improper usage. Make sure to understand these symbols and precautions before reading this guide.

	Danger	Great risk of death or serious injury from improper use
	Warning	Risk of death or serious injury from improper use
	Caution	Risk of minor injury or damage to property from improper use

- **Symbol Explanations**
Make sure to understand these symbols and precautions before reading this guide.

	Prohibited Action		Avoid Moisture
	Disassembly Prohibited		Always Dry Hands First
	Compulsory Action		Disconnect Power Source

Handset, Battery, USIM Card, AC Charger (sold separately) & Memory Card (not included)



Danger



Do not use or leave handset, battery or Charger (sold separately) in locations subject to high temperature, such as near an open flame/heater, in sunlight or inside a car on an extremely hot day.

Battery may leak, overheat, explode, catch fire. Handset or related hardware may deform or malfunction. Part of the casing may also become hot and cause burns.



Do not use excessive force to attach battery or connect Charger to handset. Battery or connector may be the wrong way around.

Battery may leak, overheat, explode or catch fire.



Do not disassemble, modify or solder handset or related hardware.

May cause accidents such as fire, bodily injury, electric shock or equipment malfunction. Battery may leak, overheat, explode or catch fire. Modifying handset is a violation of Radio Law and subject to prosecution.



Do not get handset, battery and Charger wet.

If handset, battery or Charger is left wet or battery is charged after exposure to liquids such as water or pet urine, overheating, electric shock, fire, injury or malfunction may occur.

Be mindful of location when using handset, battery and Charger. Handle with care.

Appendix



Use specified battery, Charger and Desktop Holder (not included).

Battery may leak, overheat, explode or catch fire, and Charger may overheat, catch fire or cause malfunction.



Warning



Do not place handset, battery or Charger inside cooking appliances, such as microwave ovens or high-pressure containers, or on IH cooking heaters.

Battery may leak, overheat, explode or catch fire. Handset or Charger may overheat, emit smoke, catch fire or cause malfunction.



Do not drop, throw or otherwise subject to strong force or impacts.

Battery may leak, overheat, explode, catch fire, or cause electric shock or damage to handset.



Do not allow liquids (water, pet urine, etc.) or conductive objects (pencil leads, metal pieces, necklaces, hair pins, etc.) to contact Charger terminals, external port terminals or Memory Card slot.

May cause fire or malfunction triggered by short-circuit.



Keep handset off and Charger disconnected near propane gas, in filling stations or places where flammable gas is generated.

Handset use in such areas may lead to fire.



If handset, battery or Charger emits an unusual sound, smoke or odor, perform following steps:

1. Unplug Charger from outlet.
2. Turn off handset.
3. Remove battery. (Take care to avoid burns or injuries.)

May cause fire or electric shock.



Caution



Do not place handset, battery or Charger on an unstable surface.

May fall, causing injury or malfunction. Take extra precautions while vibration alert is active or during charging.



Keep handset and related hardware out of the reach of young children.

May result in accidental ingestion or bodily injury.



If for use by child, guardian should teach proper handling and ensure handset and related hardware is used as directed.

May result in bodily injury.

Battery



Danger

See battery label to confirm battery type.

Label	Battery Type
Li-ion 00	Lithium-ion



Do not throw battery into fire.

Battery may leak, explode or catch fire.



Do not pierce battery with a nail or other sharp object, hit it with a hammer, step on it, or subject it to strong shocks.

Battery may leak, overheat, explode or catch fire.



Do not touch terminals with metallic objects or carry/store battery with conductive objects (pencil leads, metal pieces, necklaces, hair pins, etc.).

Battery may leak, overheat, explode or catch fire.



If battery fluid gets into eyes, do not rub; flush with clean water and see a doctor immediately.

Failure to do so may cause blindness.



Warning



If battery fluid comes into contact with your skin or clothing, stop handset use immediately and rinse fluid off with clean water.

Battery fluid is harmful to your skin.



If battery does not charge after specified time, stop charging.

Battery may leak, overheat, explode or catch fire.



If battery emits an unusual odor, overheats, discolors or deforms, immediately remove battery and move it away as far as possible from any flame or fire. Take care to avoid burns or injuries.

Battery may leak, overheat, explode or catch fire.



Caution



Do not dispose of battery with ordinary refuse.

Place tape over the terminals to insulate battery, and take it to a SoftBank retailer or institution that handles used batteries in your area. Comply with local waste disposal regulations for recycling.

Handset



Warning



Do not use handset while driving a vehicle.

Doing so may interfere with safe driving and cause an accident. Stop your vehicle to park in a safe place before using handset. Drivers using handsets while driving are subject to prosecution.



Do not aim the infrared port at eyes when using infrared communication.

Doing so may affect eyes.



Turn off handset near high-precision electronic devices or devices using weak electronic signals.

Handset may cause these devices to malfunction.

*Electronic devices that may be affected: Hearing aids, implantable cardiac pacemakers, implantable cardioverter defibrillators, other medical electronic devices, fire alarms, automatic doors and other automatically controlled devices.



Turn off handset aboard aircraft.

Handset signal may interfere with aircraft operation.

When in-flight handset use is permitted, follow airline instructions for proper use.



If you have a weak heart, take extra precautions when setting functions such as Vibration or Ringer Volume for incoming transmissions.

May affect heart.



In a thunderstorm, immediately turn off handset and seek shelter.

There is a risk of being struck by lightning and suffering electric shock.



Caution



If handset affects car electronics, stop use.

Handset use may affect electronics in some models. In this case, stop use; could impede safe driving.



Do not place a magnetic card near or in handset.

The stored magnetic data in cash cards, credit cards, telephone cards and floppy disks, etc. may be erased.



Do not swing handset by its strap, etc.

Handset may strike you or others, or strap may be broken resulting in injury or damage to handset or other property.



Do not place your ear too close to the speaker while ringer sounds or sound files play.

May impair hearing.



If skin abnormality occurs, immediately stop use and seek medical treatment.

Handset contains metals. Handset use may cause itching, rashes, eczema or other symptoms depending on the user's physical condition.

Parts		Materials/Surface Finish
Outer case	Main Display side	PC resin/Acrylic UV cured coating
	Keypad side, Battery side, Battery Cover	ABS resin/Acrylic UV cured coating
	External Display side	PC+ABS resin/Acrylic UV cured coating Handset color: Venetian Rosso: Evaporated tin coating)
Main Display panel, Camera panel		Acrylic resin/Hard coating
External Display panel		PC resin/Acrylic UV cured coating

Appendix

Parts		Materials/Surface Finish
Ornamental parts on External Display side		PC resin/Evaporated coating, Acrylic UV cured coating
Keypad		PC resin/Acrylic UV cured coating
Side Key		ABS resin/Acrylic UV cured coating
One-push Open Button		PC resin
Metal part of One-push Open Button		Aluminium/Alumite treatment
External Port cover		Elastomer resin
Charging Terminals	TBD	Phosphor bronze/ Gold plating on nickel plating
Stop pads		Acrylic urethane resin
Screws (Battery compartment)		Aluminium killed steel/Nickel plating
Battery compartment		PC resin
Battery terminals	Resin part	PPS resin
	Metal part	Beryllium copper/ Gold plating on nickel plating
Battery	Battery	PC resin (Label:PET resin)
	Terminals	Glass fiber reinforced epoxy board/ Gold plating on nickel plating



Do not turn up the volume unnecessarily high when using earphones.

Using earphones with volume turned up for an extended period may impair hearing or injure ears.



Handset may become hot while used in a hot environment.

Avoid prolonged skin contact that may result in burns.



Make sure not to trap fingers or objects when opening/closing handset.

May result in injury or damage to display.



Watch TV with adequate lighting and distance from Display.

May damage eyesight.

Appendix

AC Charger (sold separately)



Warning



Do not cover or wrap Charger during charging.

May cause overheating, fire or malfunction.



Always use the specified power supply/voltage.

Using incorrect voltage may cause fire or malfunction.

AC Charger: AC100V-240V (household AC outlet only)

In-Car Charger: DC12V, 24V (vehicles with a negative earth only)



Use In-Car Charger in vehicles with a negative (-) earth. Do not use In-Car Charger if vehicle has a positive (+) earth.

May cause fire.



Do not use Charger in thunderstorms.

There is a risk of suffering electric shock.



Do not handle Charger with wet hands.

May cause electric shock or malfunction.



If In-Car Charger fuse blows, always replace it with specified fuse.

Using the incorrect fuse may cause fire or malfunction. Refer to the respective manuals for information on the correct fuse specifications.



If dust accumulates on plug, unplug Charger and wipe with a dry cloth.

May cause fire.



When plugging Charger into outlet, keep conductive materials (pencil leads, metal parts, necklaces, hair pins, etc.) away from Desktop Holder terminals or Charger plug/terminals and plug Charger firmly into outlet.

May cause electric shock, short-circuit or fire.



Unplug Charger during periods of disuse.

May cause electric shock, fire or malfunction.



If liquid such as water or pet urine get into Charger, unplug it immediately.

May cause electric shock, smoke emission or fire.



Caution



Pull Charger (not cord) to unplug Charger.

Pulling on the cord may damage the cord and cause electric shock or fire.



Always unplug Charger before cleaning it.

May result in electric shock.

Near Electronic Medical Equipment



Warning

This section is based on "Guidelines on the Use of Radio Communications Equipment such as Cellular Telephones and Safeguards for Electronic Medical Equipment" (Electromagnetic Compatibility Conference, April 1997) and "Report of Investigation of the Effects of Radio Waves on Medical Equipment, etc." (Association of Radio Industries and Businesses, March 2001).



If you use an implantable cardiac pacemaker or cardioverter defibrillator, keep handset more than 22 cm away from the implant at all times.

Handset radio waves may affect implantable cardiac pacemaker or cardioverter defibrillator operations.



Persons using electronic medical equipment outside medical facilities should consult the vendor about possible radio wave effects.

Handset radio waves may affect electronic medical equipment operations.



Observe the following in medical facilities. Handset radio waves may affect electronic medical equipment.

- Do not take handset into operating rooms, Intensive Care Units or Coronary Care Units.
- Turn off handset inside hospital wards.
- Turn off handset even outside hospital wards (in hospital lobbies, etc.); electronic medical equipment may be in use nearby.
- Where a medical facility has specific instructions prohibiting the carrying and use of mobile phones, observe those instructions strictly.



Turn off handset in crowded places such as rush hour trains; implantable cardiac pacemakers or cardioverter defibrillators may be in use nearby.

Handset radio waves may affect implantable cardiac pacemaker or cardioverter defibrillator operations.

Handling Precautions

General Notes

- SoftBank is not liable for damages from accidental loss/alteration/repair of handset/Memory Card information (Phone Book entries, image/sound files, etc.). Back-up important information.
- Handset transmissions may be disrupted inside buildings, tunnels or underground, or when moving into/out of such places.
- Use handset without disturbing others.
- Handsets are radios as stipulated by the Radio Law. Under the Radio Law, handsets must be submitted for inspection upon request.
- Handset use near landlines, TVs or radios may cause interference.
- Read Memory Card manual beforehand for proper use.
- Beware of eavesdropping.
Digital signals reduce interception, however transmissions may be overheard. Deliberate/accidental interception of communications constitutes eavesdropping. "eavesdropping" means radio communication is received by another receiver deliberately or accidentally.
- Be cautious of unsafe websites. Take extra precautions especially when posting personal information on websites.

Electromagnetic Waves

For body worn operation, this mobile phone has been tested and meets RF exposure guidelines when used with an accessory containing no metal and positioning the handset a minimum 15 mm from the body. Use of other accessories may not ensure compliance with RF exposure guidelines.

FCC Notice

- This device complies with part 15 of the FCC Rules. Operation is subject to the following two conditions:
 - (1) This device may not cause harmful interference, and
 - (2) this device must accept any interference received, including interference that may cause undesired operation.
- Changes or modifications not expressly approved by the manufacturer responsible for compliance could void the user's authority to operate the equipment.

Appendix

FCC RF Exposure Information

Your handset is a radio transmitter and receiver. It is designed and manufactured not to exceed the emission limits for exposure to radio frequency (RF) energy set by the Federal Communications Commission of the U.S. Government.

The guidelines are based on standards that were developed by independent scientific organization through periodic and thorough evaluation of scientific studies. The standards include a substantial safety margin designed to assure the safety of all persons, regardless of age and health.

The exposure standard for wireless handsets employs a unit of measurement known as the Specific Absorption Rate, or SAR. The SAR limit set by the FCC is 1.6 W/kg.

The tests are performed in positions and locations (e.g. at the ear and worn on the body) as required by the FCC for each model.

The highest SAR value for this model handset as reported to the FCC when tested for use at the ear is 0.816 W/kg, and when worn on the body in a holder or carry case, is 0.461 W/kg.

Body-worn Operation; This device was tested for typical body-worn operations with the back of the handset kept 1.5 cm from the body. To maintain compliance with FCC RF exposure requirements, use accessories that maintain a 1.5 cm separation distance between the user's body and the back of the handset. The use of beltclips, holsters and similar accessories should not contain metallic components in its assembly.

The use of accessories that do not satisfy these requirements may not comply with FCC RF exposure requirements, and should be avoided. The FCC has granted an Equipment Authorization for this model handset with all reported SAR levels evaluated as in compliance with the FCC RF emission guidelines. SAR information on this model handset is on file with the FCC and can be found under the Display Grant section of

<http://www.fcc.gov/oet/ea/> after searching on FCC ID UCE210036A.

Additional information on Specific Absorption Rates (SAR) can be found on the Cellular Telecommunications & Internet Association (CTIA) website at <http://www.phonefacts.net>.

European RF Exposure Information

Your mobile device is a radio transmitter and receiver. It is designed not to exceed the limits for exposure to radio waves recommended by international guidelines. These guidelines were developed by the independent scientific organization ICNIRP and include safety margins designed to assure the protection of all persons, regardless of age and health.

The guidelines use a unit of measurement known as the Specific Absorption Rate, or SAR. The SAR limit for mobile devices is 2 W/kg and the highest SAR value for this device when tested at the ear was 0.846 W/kg*. As mobile devices offer a range of functions, they can be used in other positions, such as on the body as described in this user guide**. In this case, the highest tested SAR value is 0.836 W/kg. As SAR is measured utilizing the devices highest transmitting power the actual SAR of this device while operating is typically below that indicated above. This is due to automatic changes to the power level of the device to ensure it only uses the minimum level required to reach the network.

The World Health Organization has stated that present scientific information does not indicate the need for any special precautions for the use of mobile devices. They note that if you want to reduce your exposure then you can do so by limiting the length of calls or using a hands-free device to keep the mobile phone away from the head and body.

*The tests are carried out in accordance with international guidelines for testing.

** Please see Electromagnetic Waves on page XX-XX for important notes regarding body worn operation.

Declaration of Conformity

CE0168

We, Panasonic Mobile Communications Development of Europe Ltd., declare that SoftBank 002P conforms with the essential and other relevant requirements of the directive 1999/5/EC.

A declaration of conformity to this effect can be found at <http://panasonic.net/pmc/support/index.html>

- This product is only intended for sale in Japan.
- Compliance to the European RTTE directive applies to: SoftBank 002P handset, Battery (PMBAS1) and AC Charger (SoftBank ZTDAA1 , marked MITSUMI).

Handset Care

- **002P is not waterproof. Avoid exposure to liquids and high humidity.**
 - Do not expose handset to precipitation.
 - Air conditioned air may cause condensation, resulting in corrosion.
 - Do not put handset in damp places like bathrooms.
 - On the beach, keep handset away from sun and surf.
 - Perspiration in handset may cause malfunction.
- If handset is left with no battery or an exhausted one, data may be altered/lost. SoftBank is not liable for any resulting damages.
- Use handset within temperatures of 5°C to 35°C and humidity 35% to 85%. Avoid extreme temperatures/direct sunlight.
- Handset may become warm during use or charging. This is not malfunction.
- Battery may swell as service life nears end; this is not a problem.
- Exposing lens to direct sunlight may damage color filter and affect image color.

- Soiled terminals may cause poor connection. If the terminals are dirty, use a dry cloth or cotton swab to wipe them clean.
- Clean handset with dry, soft cloth. Using alcohol, thinner, etc. may damage it.
- Avoid forceful rubbing or scratching handset displays.
- Do not subject handset to excessive force.
 - Do not sit down with handset in a back pocket.
 - Do not place heavy objects on a bag with handset inside.
- Do not remove nameplate from handset; doing so invalidates warranty.
- Always turn off handset before removing battery. If battery is removed while saving or sending mail, data may be altered or lost.
- LCD is manufactured with high precision technology, however, some pixels may appear darker/brighter.
- Connect only specified products to External Port.
- While walking, moderate earphone volume to make sounds around you audible and help avoid accidents.
- When holding handset in use, do not cover Speaker.

Function Usage Limits

These functions are disabled after handset replacement/upgrade or service cancellation: Camera; Digital TV; Media Player; SI Appli. After a period of disuse, these functions may become unusable.

Mobile Camera

- Be sure to observe proper etiquette when using the camera.
- Do not expose the camera lens to direct sunlight. Concentrated sunlight through the lens may cause the handset to malfunction.
- Be sure to try taking and previewing pictures before using the camera on important occasions like wedding ceremonies.
- Do not commercially use or transfer pictures taken with the camera without the permission of the copyright holder (photographer), except for personal use.
- Do not use the camera in locations where taking photos and recording videos are prohibited.

Copyrights and Others

Right of Portrait

Portrait right is the right of an individual to refuse to be photographed by others and protects from the unauthorized publication or use of an individual's photograph by others. Right of personality is a portrait right applicable to all citizens and right of publicity is a portrait right (property right) designed to protect celebrities' interests. Be careful when taking pictures with the handset camera. Photographing, publicizing and distributing photographs of citizens and celebrities without permission are illegal.

Copyrights

Sounds, images, computer programs, databases, other copyrighted materials, their respective works and copyright holders are protected by copyright laws. Duplicated materials are limited to private use only. If duplications (including conversion of data types), modifications, transfer of duplicates or distribution on networks are made without permission of copyright holders, this constitutes "Literary Piracy" and "Infringement of Copyright Holder Rights" and a criminal action for reparations and criminal punishment may be filed. If duplicates are made using handset, please observe the copyright laws. Materials captured with handset camera are also subject to the above.

Appendix

This product is licensed under the MPEG-4 patent portfolio license and AVC patent portfolio license for the personal and non-commercial use of a consumer to

(i) encode video in compliance with the MPEG-4 Visual Standard and AVC Standard ("MPEG-4/AVC Video") and/or

(ii) decode MPEG-4/AVC Video that was encoded by a consumer engaged in a personal and non-commercial activity and/or was obtained from a licensed video provider licensed to provide MPEG-4/AVC Video.

No license is granted or implied for any other use.

Additional information may be obtained from MPEG LA, L.L.C. See <http://www.mpegla.com>.

Java and all Java based trademarks and logos are trademarks or registered trademarks of Sun Microsystems, Inc. in the U.S. and other countries.



Aplix, microJBlend and JBlend, and all Aplix- or JBlend-related trademarks and logos are trademarks or registered trademarks of Aplix Corporation in the U.S., Japan and other countries.

QR Code is a registered trademark of DENSO WAVE INCORPORATED.



microSD Logo is a trademark.

Chaku-Uta® and Chaku-Uta Full® are registered trademarks of Sony Music Entertainment (Japan) Inc.

Machi-Uta® is a registered trademark of KDDI CORPORATION.

Powered by MascotCapsule®

MascotCapsule® is a registered trademark of HI CORPORATION

©2010 HI CORPORATION. All Rights Reserved.

NetFront®
Mobile Client Suite

ACCESS™

This product contains NetFront Mobile Client Suite of ACCESS CO., LTD. ACCESS and NetFront are trademarks or registered trademarks of ACCESS CO., LTD. in the United States, Japan and other countries.

©2008 ACCESS CO., LTD. All rights reserved.

This software is based in part on the work of the Independent JPEG Group.



This product contains Adobe® Flash® Lite™ Player under license from Adobe Systems Incorporated. Copyright© 1996-2008 Adobe Macromedia Software LLC. All rights reserved.

Adobe, Flash and Flash Lite are either registered trademarks or trademarks of Adobe Systems Incorporated in the United States and/or other countries.

"AutoArt" adopted by this product is based on Emoji Lite®, protected by the intellectual property rights of Acrodea, Inc.

SOFTBANK, SOFTBANK's equivalent in Japanese and the SOFTBANK logo are registered trademarks or trademarks of SOFTBANK CORP. in Japan and other countries.

S! Mail, Graphic Mail, Feeling Mail and 3G HighSpeed are trademarks or registered trademarks of SOFTBANK MOBILE Corp.

Yahoo! and the "Yahoo!" or "Y!" logos are trademarks and/or registered trademarks of Yahoo! Inc. in the U.S.

This product is manufactured or sold under license from InterDigital Technology Corporation.

Other company and product names mentioned herein are trademarks or registered trademarks of their respective owners.

Appendix

The software contained in 002P is copyrighted material; copyright, moral right and other related rights are protected by copyright laws. Do not copy, modify, alter, disassemble, decompile or reverse-engineer the software, and do not separate it from hardware in whole or part.

Specific Absorption Rate (SAR)

This mobile phone 002P meets the MIC's* technical regulation for exposure to radio waves.

The technical regulation established permitted levels of radio frequency energy, based on standards developed by independent scientific organizations through periodic and thorough evaluation of scientific studies.

The regulation employs a unit of measurement known as the Specific Absorption Rate, or SAR.

The SAR limit is 2 watts/kilogram (W/kg)** averaged over ten grams of tissue. The limit includes a substantial safety margin designed to assure the safety of all persons, regardless of age and health.

The value of the limit is equal to the international guidelines recommended by ICNIRP***.

All mobile phones should be confirmed to comply with the regulation, before they are available for sale to the public.

The highest SAR value for this mobile phone is 0.793 W/kg when tested for use at the ear.

The test for SAR was conducted in accordance with MIC's testing procedure, using standard operating positions, with the phone transmitting at its highest permitted power level.

While there may be differences between the SAR levels of various phones and at various positions, all phones meet MIC's technical regulation.

Although the SAR is determined at the highest certified power level, the actual SAR of the phone during operation can be well below the maximum value.

For more information about SAR, see the following websites:

- Ministry of Internal Affairs and Communications (MIC)
<http://www.tele.soumu.go.jp/e/sys/ele/body/index.htm>
- Association of Radio Industries and Businesses (ARIB)
<http://www.arib-emf.org/> (Japanese)

*Ministry of Internal Affairs and Communications

Appendix

**The technical regulation is provided in Article 14-2 of the Ministry Ordinance Regulating Radio Equipment.

***International Commission on Non-Ionizing Radiation Protection

Appendix

Specifications

002P

Weight (including battery)		XXX g*
Dimensions (closed)		XXX x XXX x XXX mm*
Standby Time (closed)	3G	XXX hours*
	GSM	XXX hours*
Talk Time	3G	XXX minutes*
	Video Call	XXX minutes*
	GSM	XXX minutes*
TV Reception Time		XXX hours*
Charging Time	AC Charger	130 minutes*
	In-Car Charger	130 minutes*
Maximum Output	3G	0.25 W
	GSM	2.0 W

* Approximate value

Battery

Voltage	3.7 V
Battery Type	Lithium-ion
Capacity	800 mAh
Dimensions	45 x 4.5 x 37 mm*

* Approximate value

- Specifications subject to change without notice.

Support

Warranty

Warranty is provided when you purchase a 002P.

- Check name of distributor and date of purchase.
- Read through contents and keep in a safe place.
- The warranty term is described in the warranty.

SoftBank is not liable for any damage resulting from use of this product.

After-Sales Service

See "Troubleshooting" (☞ P.XX-XX) before contacting SoftBank for service or repairs. If you cannot find solutions or solve problems, contact SoftBank Mobile Customer Center, Customer Assistance (☞ P.XX-XX) in your subscription area and provide a detailed description of the problem.

- Repairs within warranty are performed under terms and conditions described.
- Out of warranty, any repairs are performed upon request at subscriber's expense.

Appendix

Customer Service

For information about SoftBank handsets or services, call General Information.

For repairs, call Customer Assistance.

SoftBank Mobile Customer Center

General

From a SoftBank handset, dial toll free at 157
From a landline/IP phone, dial toll free at 0800-919-0157

Customer

From a SoftBank handset, dial toll free at 113
From a landline/IP phone, dial toll free at 0800-919-0113

If you cannot reach a toll free number, use the number (charges apply) below for your service area:

Hokkaido Area, Tohoku Area Hokuriku Area, Kanto Koshinetsu Area	022-380-4380	Tokai Area	052-388-2002
Kansai Area	06-7669-0180	Chugoku, Shikoku Area Kyushu, Okinawa Area	092-687-0010

SoftBank Mobile Global Call Center

From outside Japan, dial +81-3-5351-3491 (toll free from SoftBank handsets)
If handset is lost/stolen, call this number immediately (international charges apply)

SoftBank 002P User Guide

February 2011, First Edition

SOFTBANK MOBILE Corp.

For additional information, please visit a SoftBank shop.

Model: SoftBank 002P

Manufacturer: Panasonic Mobile Communications Co., Ltd.



モバイル・リサイクル・ネットワーク
携帯電話やHSのリサイクルにご協力を。

Please help the mobile industry maintain high environmental standards. Recycle your old handsets, batteries and charger units (all manufacturers and brands). Before you recycle, please remember these important points:

- Handsets, batteries and chargers submitted for recycling cannot be returned.
- Always erase all data recorded on old handsets (Phone Book entries, call records, mail, etc.) before recycling.