

Panasonic®

Owner's Manual Home Theater Audio System

Model No. SC-HTB550



Thank you for purchasing this product.
For optimum performance and safety, please read these instructions carefully.
Please keep this manual for future reference.

If you have any questions, contact:
U.S.A. and Puerto Rico: 1-800-211-PANA (7262)
Canada: 1-800-561-5505

P PC

RQT9660-P

Confidential until
2012/04/30

IMPORTANT SAFETY INSTRUCTIONS

Read these operating instructions carefully before using the unit. Follow the safety instructions on the unit and the applicable safety instructions listed below. Keep these operating instructions handy for future reference.

- 1 Read these instructions.
- 2 Keep these instructions.
- 3 Heed all warnings.
- 4 Follow all instructions.
- 5 Do not use this apparatus near water.
- 6 Clean only with dry cloth.
- 7 Do not block any ventilation openings. Install in accordance with the manufacturer's instructions.
- 8 Do not install near any heat sources such as radiators, heat registers, stoves, or other apparatus (including amplifiers) that produce heat.
- 9 Do not defeat the safety purpose of the polarized or grounding-type plug. A polarized plug has two blades with one wider than the other.
A grounding-type plug has two blades and a third grounding prong. The wide blade or the third prong are provided for your safety. If the provided plug does not fit into your outlet, consult an electrician for replacement of the obsolete outlet.
- 10 Protect the power cord from being walked on or pinched particularly at plugs, convenience receptacles, and the point where they exit from the apparatus.
- 11 Only use attachments/accessories specified by the manufacturer.
- 12 Use only with the cart, stand, tripod, bracket, or table specified by the manufacturer, or sold with the apparatus. When a cart is used, use caution when moving the cart/apparatus combination to avoid injury from tip-over.
- 13 Unplug this apparatus during lightning storms or when unused for long periods of time.
- 14 Refer all servicing to qualified service personnel. Servicing is required when the apparatus has been damaged in any way, such as power-supply cord or plug is damaged, liquid has been spilled or objects have fallen into the apparatus, the apparatus has been exposed to rain or moisture, does not operate normally, or has been dropped.



WARNING

Unit

- To reduce the risk of fire, electric shock or product damage,
 - Do not expose this unit to rain, moisture, dripping or splashing.
 - Do not place objects filled with liquids, such as vases, on this unit.
 - Use only the recommended accessories.
 - Do not remove covers.
 - Do not repair this unit by yourself. Refer servicing to qualified service personnel.

Button-type battery (Lithium battery)

- Risk of fire, explosion and burns. Do not disassemble, heat above 60 °C (140 °F) or incinerate.

If any electrolyte should come into contact with your hands or clothes, wash it off thoroughly with water.
If any electrolyte should come into contact with your eyes, never rub the eyes. Rinse eyes thoroughly with water, and then consult a doctor.

<For USA-California only>

This product contains a CR Coin Cell Lithium Battery which contains Perchlorate Material – special handling may apply.

See www.dtsc.ca.gov/hazardouswaste/perchlorate.

CAUTION

Unit

- Do not place sources of naked flames, such as lighted candles, on this unit.

Placement

- To reduce the risk of fire, electric shock or product damage,
 - Do not install or place this unit in a bookcase, built-in cabinet or in another confined space. Ensure this unit is well ventilated.
 - Do not obstruct this unit's ventilation openings with newspapers, tablecloths, curtains, and similar items.

Button-type battery (Lithium battery)

- Danger of explosion if battery is incorrectly replaced. Replace only with the type recommended by the manufacturer.
- When disposing the batteries, please contact your local authorities or dealer and ask for the correct method of disposal.
- Insert with poles aligned.
- Do not touch the terminals (+ and –) with metal objects.
- Do not recharge, disassemble, remodel, heat or throw into fire.
- Keep out of reach of children.
- Mishandling of batteries can cause electrolyte leakage and may cause a fire.
 - Remove the battery if you do not intend to use the remote control for a long period of time. Store in a cool, dark place.
- Do not heat or expose to flame.
- Do not leave the battery(ies) in a car exposed to direct sunlight for a long period of time with doors and windows closed.

	CAUTION RISK OF ELECTRIC SHOCK DO NOT OPEN	
<p>CAUTION: TO REDUCE THE RISK OF ELECTRIC SHOCK, DO NOT REMOVE SCREWS. NO USER-SERVICEABLE PARTS INSIDE. REFER SERVICING TO QUALIFIED SERVICE PERSONNEL.</p>		

 The lightning flash with arrowhead symbol, within an equilateral triangle, is intended to alert the user to the presence of uninsulated "dangerous voltage" within the product's enclosure that may be of sufficient magnitude to constitute a risk of electric shock to persons.

 The exclamation point within an equilateral triangle is intended to alert the user to the presence of important operating and maintenance (servicing) instructions in the literature accompanying the appliance.

<p>THE FOLLOWING APPLIES ONLY IN THE U.S.A. AND CANADA</p> <p>This device complies with Part 15 of FCC Rules and RSS-Gen of IC Rules.</p> <p>Operation is subject to the following two conditions: (1) This device may not cause interference, and (2) this device must accept any interference, including interference that may cause undesired operation of this device.</p> <p>This transmitter must not be co-located or operated in conjunction with any other antenna or transmitter.</p> <p>This product is restricted to indoor use due to its operation in the 5.150 GHz to 5.250 GHz and 5.725 GHz to 5.850 GHz frequency range.</p> <p>FCC and IC require this product to be used indoors for the frequency range 5.150 GHz to 5.250 GHz and 5.725 GHz to 5.850 GHz to reduce the potential for harmful interference to co-channel Mobile Satellite systems. High power radars are allocated as primary users of the 5.25 GHz to 5.35 GHz and 5.65 GHz to 5.85 GHz bands. These radar stations can cause interference with and/or damage this product.</p> <p>This equipment complies with FCC/IC radiation exposure limits set forth for an uncontrolled environment and meets the FCC radio frequency (RF) Exposure Guidelines in Supplement C to OET65 and RSS-102 of the IC radio frequency (RF) Exposure rules. This equipment has very low levels of RF energy that is deemed to comply without maximum permissive exposure evaluation (MPE). But it is desirable that it should be installed and operated keeping the radiator at least 20 cm (7 7/8") or more away from person's body (excluding extremities: hands, wrists, feet and ankles).</p>
--

<p>THE FOLLOWING APPLIES ONLY IN THE U.S.A.</p> <p>FCC Note:</p> <p>This equipment has been tested and found to comply with the limits for a Class B digital device, pursuant to Part 15 of the FCC Rules.</p> <p>These limits are designed to provide reasonable protection against harmful interference in a residential installation. This equipment generates, uses and can radiate radio frequency energy and, if not installed and used in accordance with the instructions, may cause harmful interference to radio communications.</p> <p>However, there is no guarantee that interference will not occur in a particular installation. If this equipment does cause harmful interference to radio or television reception, which can be determined by turning the equipment off and on, the user is encouraged to try to correct the interference by one or more of the following measures:</p> <ul style="list-style-type: none"> • Reorient or relocate the receiving antenna. • Increase the separation between the equipment and receiver. • Connect the equipment into an outlet on a circuit different from that to which the receiver is connected. • Consult the dealer or an experienced radio/TV technician for help. <p>Any unauthorized changes or modifications to this equipment would void the user's authority to operate this device.</p> <p>This device complies with Part 15 of the FCC Rules. Operation is subject to the following two conditions: (1) This device may not cause harmful interference, and (2) this device must accept any interference received, including interference that may cause undesired operation.</p> <p>Responsible Party: Panasonic Corporation of North America One Panasonic Way, Secaucus, NJ 07094</p> <p>Support Contact: Panasonic Consumer Marketing Company of North America Telephone No.: 1-800-211-PANA (7262)</p>
--

<p>THE FOLLOWING APPLIES ONLY IN CANADA.</p> <p>This device complies with RSS-210 of the IC Rules. Operation is subject to the following two conditions: (1) This device may not cause harmful interference, (2) This device must accept any interference received, including interference that may cause undesired operation of the device.</p>

Table of contents

IMPORTANT SAFETY INSTRUCTIONS	2
<hr/> <hr/>	
Before use	
<hr/> <hr/>	
Supplied items	5
System (SC-HTB550)	5
Accessories	5
Control reference guide	6
Main unit and active subwoofer (Front)	6
Main unit and active subwoofer (Rear)	6
Remote control	7
<hr/> <hr/>	
Getting started	
<hr/> <hr/>	
Step 1 Selecting the placement method	8
Speaker system	9
Active subwoofer	9
Wireless interference	9
Step 2 Assembling the speakers	10
When attaching the speakers to a wall	10
When placing the speakers on a table	14
Additional speaker fall prevention measures	17
Step 3 Connections	19
Connection with the TV	19
Connection with other devices	20
Speaker cable connection	21
AC power supply cord connection	21
Active subwoofer wireless connection	22
Bluetooth® connection	22
<hr/> <hr/>	
Operations	
<hr/> <hr/>	
Using this unit	23
3D sound	24
Audio output modes	24
Linked operations with the TV (VIERA Link™ “HDAVI Control™”)	25
Advanced operations	26
<hr/> <hr/>	
Reference	
<hr/> <hr/>	
Troubleshooting	28
Indicator illumination	30
About Bluetooth®	31
Unit care	31
Specifications	32
Limited Warranty (ONLY FOR U.S.A. AND PUERTO RICO)	34
Limited Warranty (ONLY FOR CANADA)	35

- The illustrations shown may differ from your unit.
- Operations in this Owner's Manual are described mainly with the remote control, but you can perform the operations on the main unit if the controls are the same.





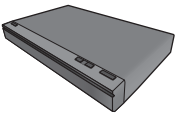
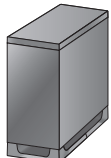
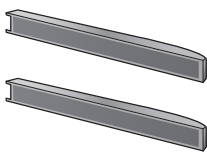

Supplied items

System (SC-HTB550)

<input type="checkbox"/> 1 Main unit (SU-HTB550) 	<input type="checkbox"/> 1 Active subwoofer (SB-HWA550) 	<input type="checkbox"/> 2 Front speakers (SB-HTB550) 
---	--	--

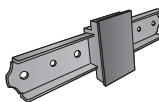
Accessories

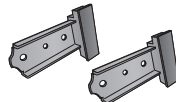
Check the supplied accessories before using the system.

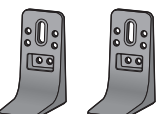
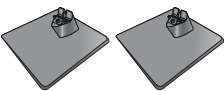
<input type="checkbox"/> 1 Remote control (with a battery) (N2QAYC000063) 	<input type="checkbox"/> 2 AC power supply cords (K2CB2YY00059) 	<input type="checkbox"/> 2 Speaker cables (REEX1266A: RED) (REEX1267A: WHITE) Length: 3 m (9.8 ft) 	<input type="checkbox"/> 1 Speaker joint (RAQ0085) 
<input type="checkbox"/> 6 Screws (XYN5+J14FJK) 	<input type="checkbox"/> 2 Speaker feet (RKAX0028-K) 	<input type="checkbox"/> 2 Front ornaments (RAQ0089) 	<input type="checkbox"/> 2 Support legs (RYQ0970-K) 
<input type="checkbox"/> 2 Stands (RYQ0853-KJ) 	<input type="checkbox"/> 2 Speaker bases (RAQ0086) 	<p>(ONLY FOR CANADA) The enclosed French Canadian label sheet corresponds to the English display on the remote control and the top and rear of the main unit and active subwoofer.</p>	



- Product numbers are correct as of December 2011. These may be subject to change.
- For U.S.A. and Puerto Rico:
To order accessories, refer to "Accessory Purchases (United States and Puerto Rico)" on page 34.
- For Canada: To order accessories, call the dealer from whom you have made your purchase.
- The supplied AC power supply cord is for use with this unit and the active subwoofer only.
Do not use it with other equipment. Also, do not use cords from other equipment with this unit or active subwoofer.

Precautions

Before use

Getting started

Operations

Reference

Control reference guide

Main unit and active subwoofer (Front)

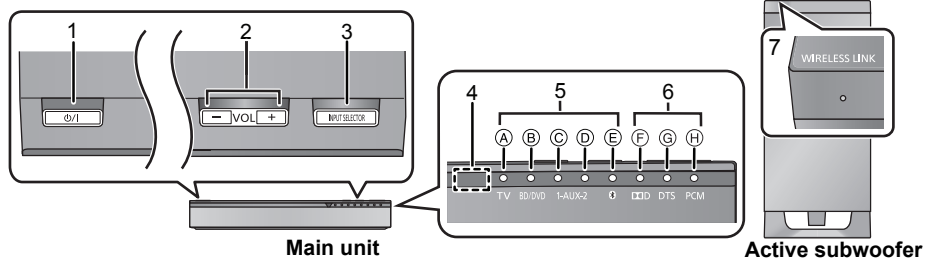

- | | |
|---|---|
| <p>1 Standby/on switch (⏻/⏻)
Press to switch the unit from on to standby mode or vice versa. In standby mode, the unit is still consuming a small amount of power.</p> <p>2 Adjust the volume of the speakers</p> <p>3 Select the input source
“TV”→“BD/DVD”→“AUX1”
↑ “⏻” ← “AUX2” ←</p> <p>4 Remote control signal sensor (⇒ 7)</p> <p>5 Input selector indicators*1</p> <p> (A) TV indicator
 Lights green when the TV is the audio source</p> <p> (B) BD/DVD indicator
 Lights amber when the device connected to the BD/DVD terminal is the audio source</p> <p> (C) AUX1 indicator
 Lights amber when the device connected to the AUX1 terminal is the audio source</p> | <p> (D) AUX2 indicator
 Lights amber when the device connected to the AUX2 terminal is the audio source</p> <p> (E) Bluetooth® indicator
 Lights blue when the Bluetooth® device is the audio source</p> <p>6 Audio format indicators*1</p> <p> (F) Dolby Digital indicator
 Lights when Dolby Digital is the current audio format</p> <p> (G) DTS indicator
 Lights when DTS is the current audio format</p> <p> (H) PCM indicator
 Lights when PCM (2ch, Multi-channel) is the current audio format</p> <p>7 WIRELESS LINK indicator (⇒ 22)</p> |
|---|---|

Main unit and active subwoofer (Rear)

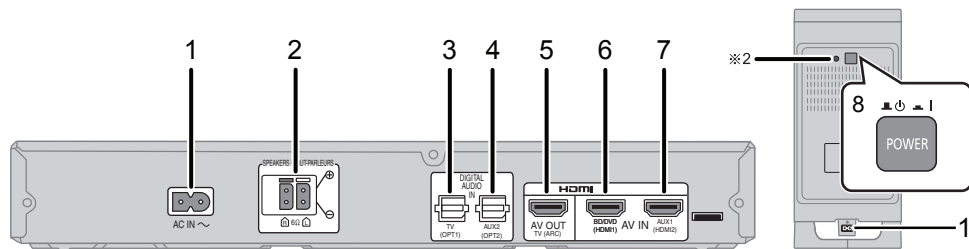

- | | |
|--|--|
| <p>1 AC IN terminal (⇒ 21)</p> <p>2 Speaker terminals (⇒ 21)</p> <p>3 TV terminal (⇒ 19)</p> <p>4 AUX2 terminal (⇒ 20)</p> | <p>5 HDMI OUT terminal (ARC compatible) (⇒ 19)</p> <p>6 BD/DVD terminal (⇒ 20)</p> <p>7 AUX1 terminal (⇒ 20)</p> <p>8 Active subwoofer on/off button</p> |
|--|--|

*1 The indicators will also blink in various conditions (⇒ 30)

*2 The I/D SET button is only used when the main unit is not paired with the active subwoofer (⇒ 29)

Remote control

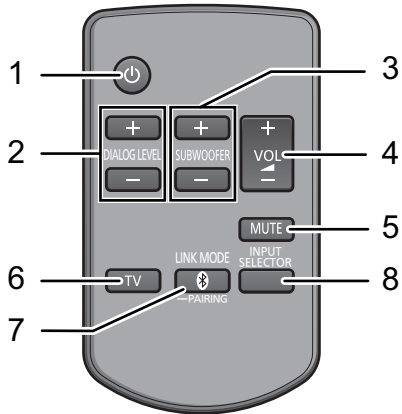

- 1 Turn the main unit on or off (⇒ 23)
- 2 Adjust the dialog effect level (⇒ 23)
- 3 Adjust the output level of the active subwoofer (bass sound) (⇒ 23)
- 4 Adjust the volume of this system (⇒ 23)
- 5 Mute the sound (⇒ 23)
- 6 Select the TV as the source (⇒ 23)
- 7 Select the Bluetooth® device as the source (⇒ 23)
- 8 Select the input source (⇒ 23)
 “TV” → “BD/DVD” → “AUX1”
 ↑ “” ← “AUX2” ←

Remove the insulation sheet **A** before using.

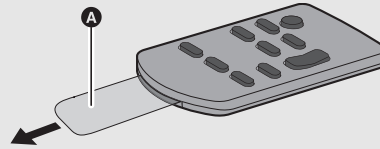

■ To replace a button-type battery

- ① While pressing the stopper **B**, pull out the battery holder.

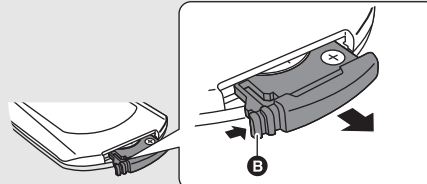

- ② Set the button-type battery with its (+) mark facing upward and then put the battery holder back in place.

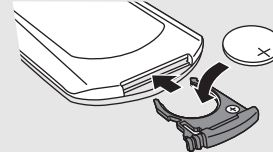

- When replacing the battery, use: CR2025 (Lithium battery)
- Keep the button-type battery out of reach of children to prevent swallowing.

Before use

■ Remote control operation range

The remote control signal sensor is located on the main unit.

- Use the remote control within the correct operation range.

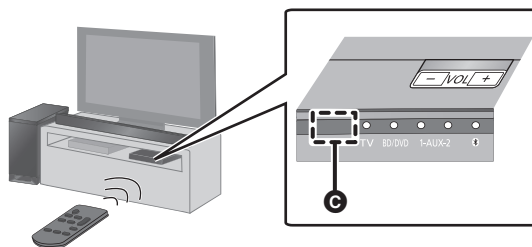

- Remote control signal sensor

• Operation range

- Distance: Within approx. 7 m (23 ft) directly in front
- Angle: Approx. 30° left and right

Step 1 Selecting the placement method

- Choose a placement method that suits you best.

When attaching the speakers to a wall

Place the speakers horizontally

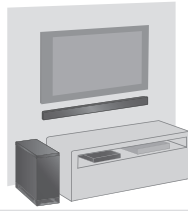

Page 10

Place the speakers vertically

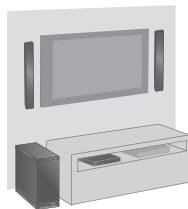

Page 12

When placing the speakers on a table

Place the speakers using the stands



Page 14

Place the speakers using the support legs and speaker feet



Page 15

Place the speakers using the speaker bases

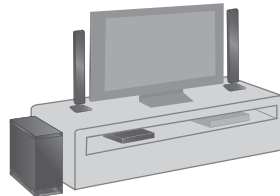

Page 16



Caution

- This system is to be used only as indicated in these instructions. Failure to do so may lead to damage to the amplifier and/or the speakers, and may result in the risk of fire. Consult a qualified service person if damage has occurred or if you experience a sudden change in performance.
- Do not attempt to attach these speakers to a wall using methods other than those described in this manual.

Speaker system

- Use a screwdriver (+) for assembling the speakers.
- Do not hold the speakers in one hand to avoid injury, you may drop the speakers when carrying them.

■ When attaching the speakers to a wall

The wall or pillar on which the speakers are to be attached should be capable of supporting 33 kg (72.8 lbs) per screw. Consultation with a qualified building contractor is recommended when attaching the speakers to a wall. Improper attachment may result in damage to the wall and speakers, and personal injury.

■ When placing the speakers in front of the TV

The speakers may block or interfere with the TV's various sensors (C.A.T.S. (Contrast Automatic Tracking System) sensor, remote control sensor, etc.) and the 3D Eyewear transmitters on a 3D compatible TV.

• If the stands are being used

Move the speakers further away from the TV. If the TV still does not function properly, try removing the stands.

• If the stands are not used

Move the speakers further away from the TV. If the TV still does not function properly, try placing them beside the TV (⇒ 8).

Active subwoofer

When carrying the active subwoofer

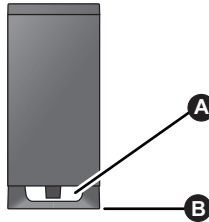

- A Do not hold the active subwoofer from this opening.**
The parts inside (speaker unit) may be damaged.
- B Always hold the bottom of the active subwoofer when moving it.**

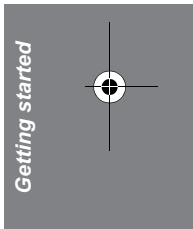

Wireless interference

To avoid interference, maintain the following distances between the main unit/active subwoofer and other electronic devices that use the same radio frequency (2.4 GHz and 5 GHz band).

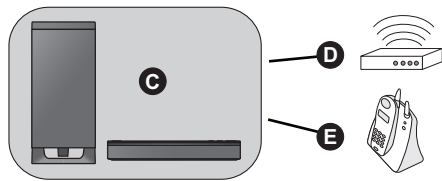

- C Main unit/active subwoofer**
- D Wireless LAN: approx. 2 m (6 1/2 ft)**
- E Cordless phone and other electronic devices: approx. 2 m (6 1/2 ft)**



- Place the active subwoofer within a few meters of the main unit and in a horizontal position with the top panel faced upward.
- Do not use the main unit or active subwoofer in a metal cabinet.
- Placing the active subwoofer and the speakers too close to the walls and corners can result in excessive bass. Cover walls and windows with thick curtains.
- If irregular coloring occurs on your TV, turn the TV off for about 30 minutes. If it persists, move the speakers further away from the TV.
- Keep magnetized items away. Magnetized cards, watches, etc., can be damaged if placed too close to the active subwoofer and the speakers.

Step 2 Assembling the speakers

When attaching the speakers to a wall



Place the speakers horizontally

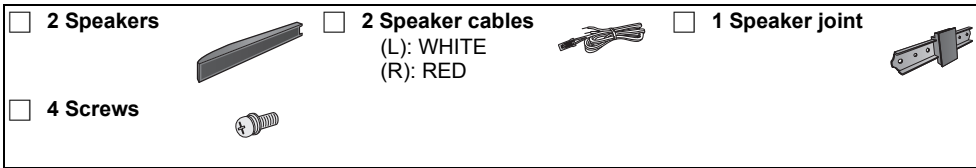

- For a safety measure to prevent the speakers from falling, refer to page 17.
- To prevent damage or scratches, lay down a soft cloth and perform the assembly on it.

1 Assemble the speakers.

- The two speakers are interchangeable.

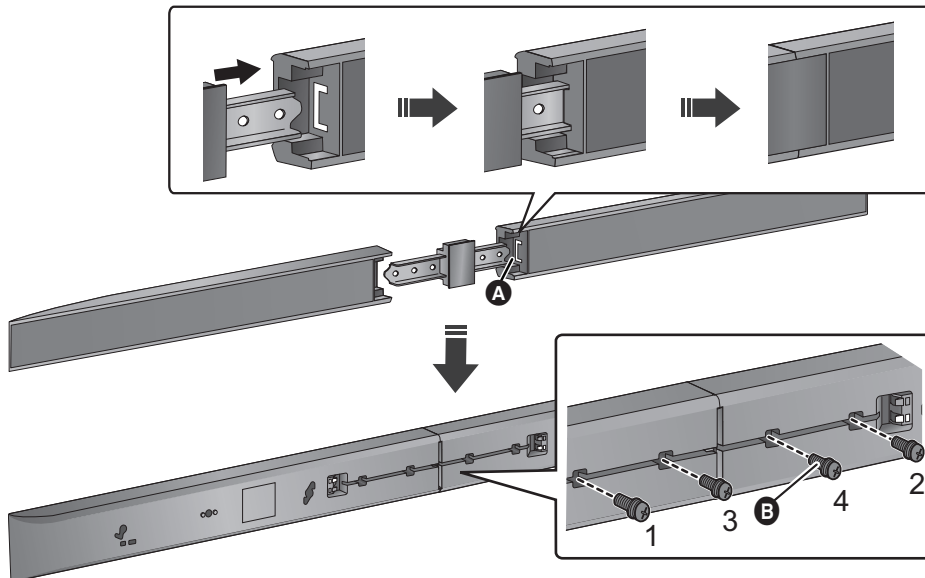

- A** "C" shaped slit
 - Insert the speaker joint fully into the slit.
- B** Screw (supplied)
 - Be sure to insert the screws following the order as indicated in the illustration.
 - Keep the screws out of reach of children to prevent swallowing.

2 Connect the speaker cables.

- Use the "Panasonic" logo to identify the left and right speakers, then connect the cables (as illustrated).

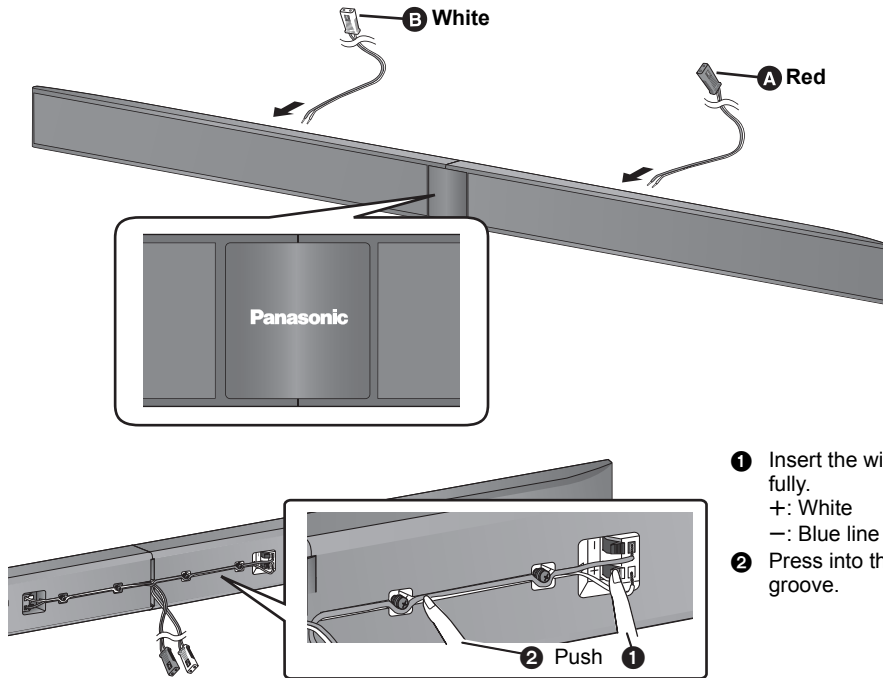

- Insert the wire fully.
+ : White
- : Blue line
- Press into the groove.

- A RED:** Right speaker channel (R)
- B WHITE:** Left speaker channel (L)

- Insert the wire fully, taking care not to insert beyond the wire insulation.

3 Drive a screw into the wall.

- Use the measurements indicated below to identify the screwing positions on the wall.
- Leave at least 20 mm ($\frac{25}{32}$ ") of space above and on each side of the speaker to allow enough space for fitting the speaker.
- The position on the wall where the screw is to be attached, as well as the screw, should be capable of supporting over 33 kg (72.8 lbs).
- Keep the screws out of reach of children to prevent swallowing.

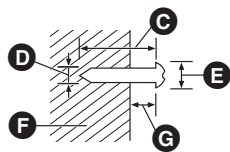

- C** At least 30 mm ($1 \frac{3}{16}$ ")
- D** $\varnothing 4.0$ mm ($\frac{5}{32}$ ")
- E** $\varnothing 7.0$ mm to $\varnothing 9.4$ mm ($\frac{9}{32}$ " to $\frac{3}{8}$ ")
- F** Wall or pillar
- G** 5.5 mm to 6.5 mm ($\frac{7}{32}$ " to $\frac{1}{4}$ ")

Front view (semi-transparent image)

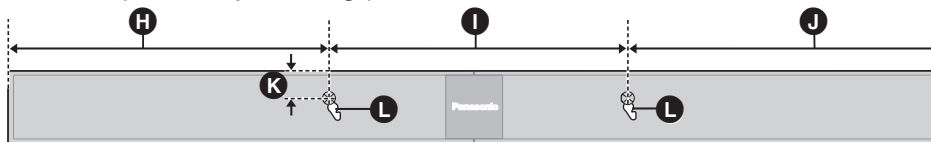

- H** 326 mm ($12 \frac{27}{32}$ ")
- I** 316 mm ($12 \frac{7}{16}$ ")
- J** 316 mm ($12 \frac{7}{16}$ ")
- K** 26 mm ($1 \frac{1}{16}$ ")
- L** Wall mounting hole

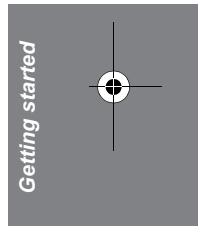



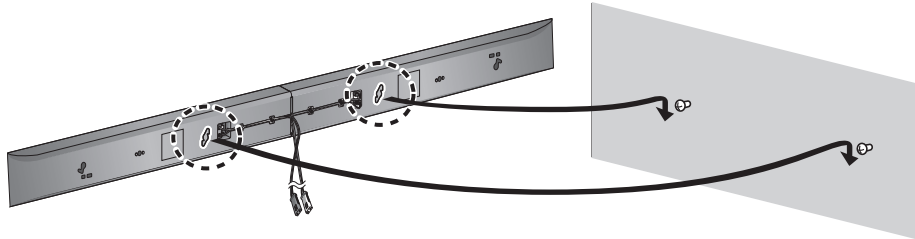

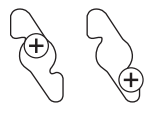
4 Fit the speaker securely onto the screw(s).

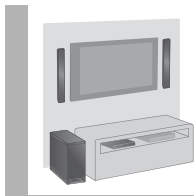

DO	DO NOT
 <ul style="list-style-type: none"> • Move the speaker so that the screw is in this position. 	 <ul style="list-style-type: none"> • In this position, the speaker will likely fall if moved to the left or right.

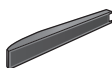

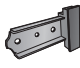
Place the speakers vertically

<input type="checkbox"/> 2 Speakers 	<input type="checkbox"/> 2 Speaker cables (L): WHITE (R): RED 	<input type="checkbox"/> 2 Front ornaments 
<input type="checkbox"/> 4 Screws 		

- For a safety measure to prevent the speakers from falling, refer to page 17.
- To prevent damage or scratches, lay down a soft cloth and perform the assembly on it.

1 Attach the front ornaments.

- The two speakers are interchangeable.
- Keep the screws out of reach of children to prevent swallowing.

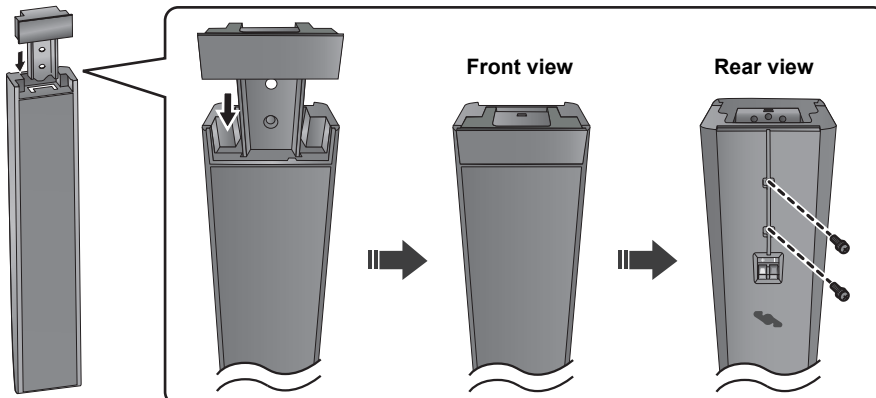

2 Connect the speaker cables.

- Insert the wire fully, taking care not to insert beyond the wire insulation.

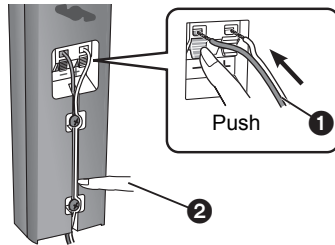

- 1 Insert the wire fully.
+ : White
- : Blue line
- 2 Press into the groove.

3 Drive a screw into the wall.

- Use the measurements indicated below to identify the screwing positions on the wall.
- Leave at least 20 mm ($\frac{25}{32}$ ") of space above and on each side of the speaker to allow enough space for fitting the speaker.
- The position in the wall where the screw is to be attached as well as the screw should be capable of supporting over 33 kg (72.8 lbs).
- Keep the screws out of reach of children to prevent swallowing.

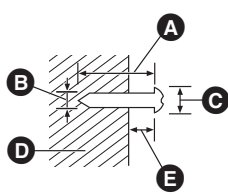

- A** At least 30 mm ($1 \frac{3}{16}$ ")
- B** $\varnothing 4.0$ mm ($\frac{5}{32}$ ")
- C** $\varnothing 7.0$ mm to $\varnothing 9.4$ mm ($\frac{9}{32}$ " to $\frac{3}{8}$ ")
- D** Wall or pillar
- E** 5.5 mm to 6.5 mm ($\frac{7}{32}$ " to $\frac{1}{4}$ ")

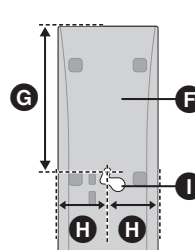

- F** Front speaker (Rear view)
- G** 102 mm ($4 \frac{1}{32}$ ")
- H** 37 mm ($1 \frac{15}{32}$ ")
- I** Wall mounting hole

4 Fit the speaker(s) securely onto the screw(s).

- Place the speaker that is connected with the speaker cable with a red connector on the observers' right, and connect with the speaker cable with a white connector on the observers' left.

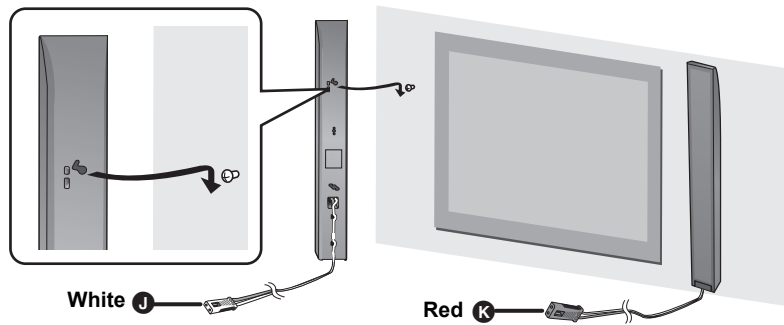

J WHITE: Left speaker channel (L)

K RED: Right speaker channel (R)

DO	DO NOT
<ul style="list-style-type: none"> • Move the speaker so that the screw is in this position. 	<ul style="list-style-type: none"> • In this position, the speaker will likely fall if moved to the left or right.

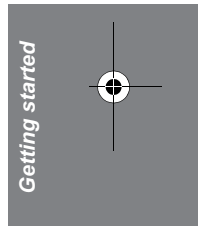

When placing the speakers on a table



Place the speakers using the stands

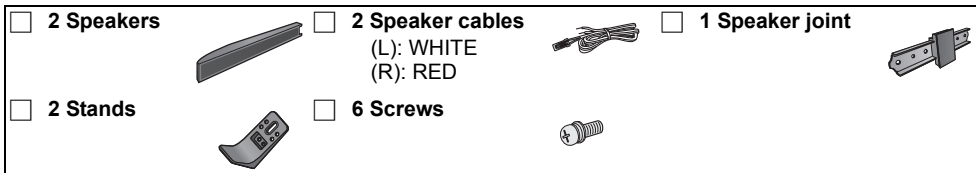

- For a safety measure to prevent the speakers from falling, refer to page 17.
- To prevent damage or scratches, lay down a soft cloth and perform the assembly on it.

1 Assemble the speakers following steps 1 and 2 of “Place the speakers horizontally” (⇒ 10).

2 Attach the stands.

- Use the “Panasonic” logo to identify the top and bottom of the speaker.
- Keep the screws out of reach of children to prevent swallowing.

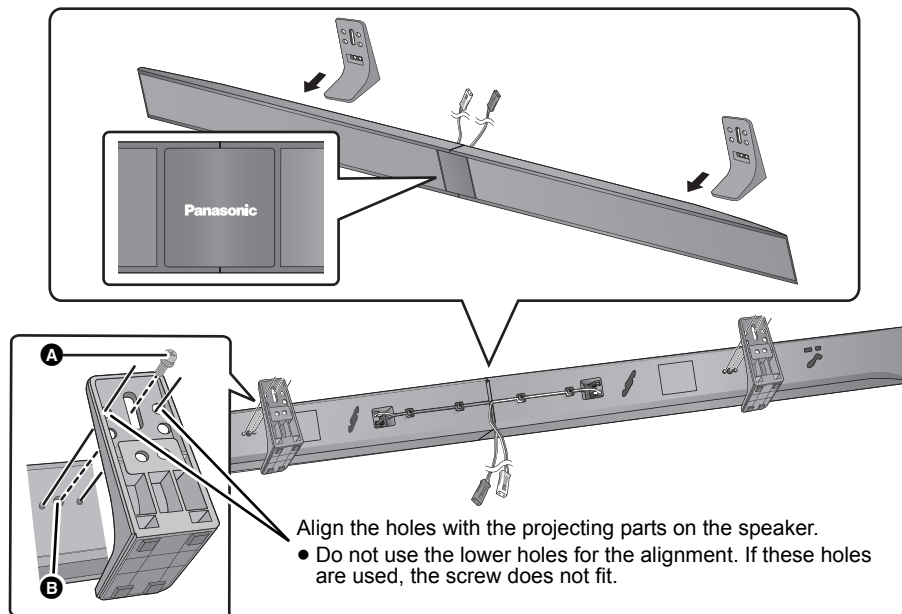

- A** Screw (supplied)
- B** Screw hole

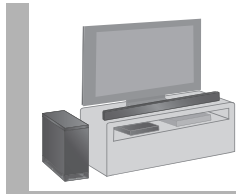

Place the speakers using the support legs and speaker feet

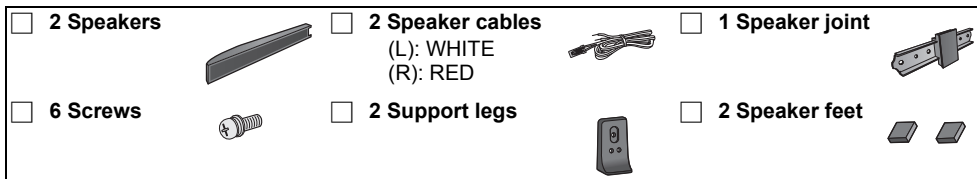

- For a safety measure to prevent the speakers from falling, refer to page 17.
- To prevent damage or scratches, lay down a soft cloth and perform the assembly on it.

1 Assemble the speakers following steps 1 and 2 of “Place the speakers horizontally” (⇒ 10).

2 Attach the support legs and speaker feet.

- Use the “Panasonic” logo to identify the top and bottom of the speaker.
- Keep the screws and the speaker feet out of reach of children to prevent swallowing.

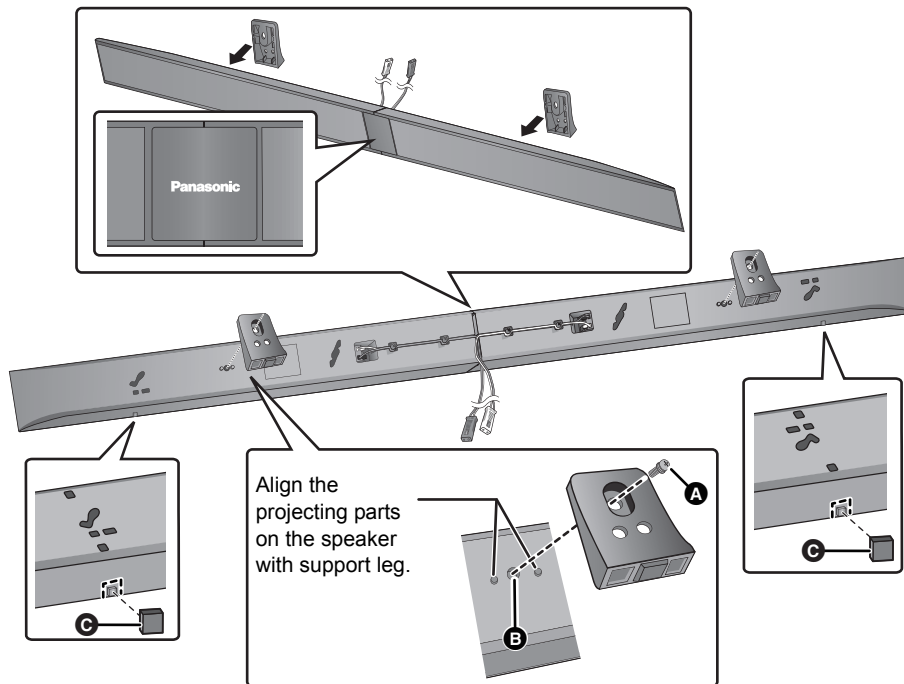

- A** Screw (supplied)
- B** Screw hole
- C** Speaker foot (supplied)
 - Attach the speaker foot directly below the wall mounting hole (as illustrated).

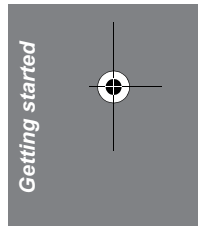

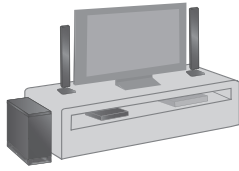

Place the speakers using the speaker bases

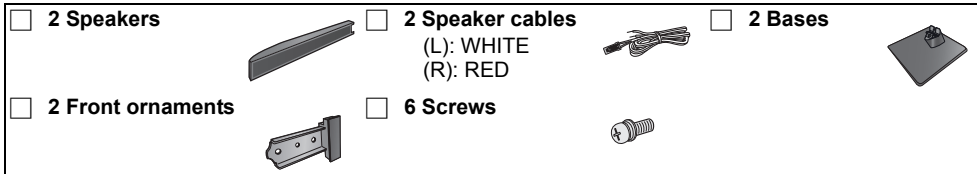

- For a safety measure to prevent the speakers from falling, refer to page 17.
- To prevent damage or scratches, lay down a soft cloth and perform the assembly on it.

1 Assemble the speakers following step 1 of “Place the speakers vertically” (⇒ 12).

2 Insert the speaker cable through the base.

- Be sure to insert the speaker cable through the threading hole as indicated in the illustration. (If the speaker cable is twisted, it might not fit through the opening. Straighten the speaker cable before inserting.)

Position the cable between the ridges.

- Leave about 110 mm (4 21/64")

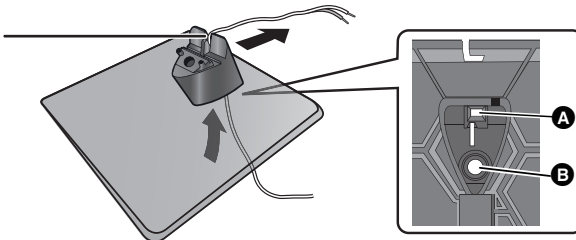

- A** Threading hole
- B** Screw hole

3 Attach the speaker to the base.

- The two speakers are interchangeable.
- Keep the screws out of reach of children to prevent swallowing.

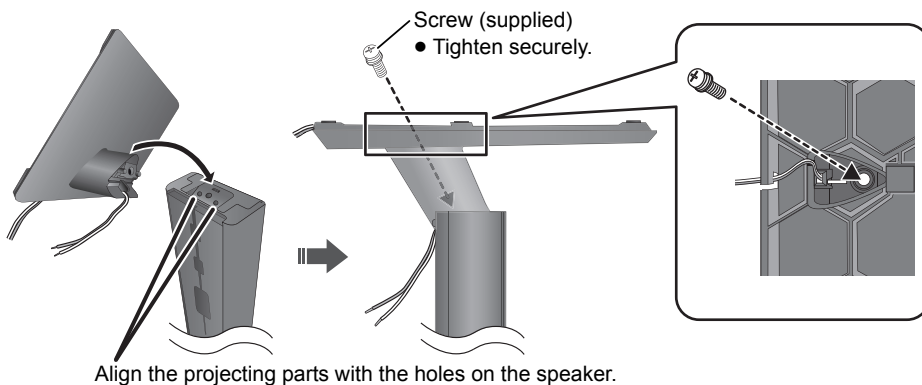

4 Connect the speaker cables.

- Insert the wire fully, taking care not to insert beyond the wire insulation.

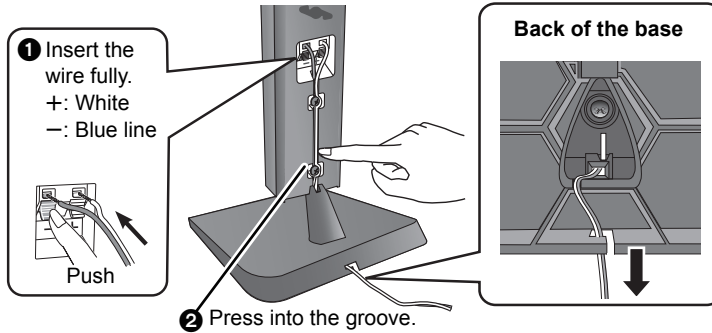

- Place the speaker that is connected with the speaker cable with a red connector on the observers' right, and connect with the speaker cable with a white connector on the observers' left.

Additional speaker fall prevention measures

To prevent the speakers from falling, it is recommended, as an additional protection measure, to attach the speakers to the wall or table with a fall prevention cord (hereafter "cord").



- Consultation with a qualified housing contractor concerning the appropriate procedure when attaching to a concrete wall or a surface that may not have strong enough support is recommended (⇒ 11, 13). Improper attachment may result in damage to the wall and speakers, and personal injury.
- Use a cord of less than $\varnothing 2.0$ mm ($5/64$ "), which is capable of supporting over 10 kg (22.05 lbs).
- Keep the screws out of reach of children to prevent swallowing.
- Make sure that the slack of the cord is minimal.

When attaching the speakers to a wall

Horizontal placement

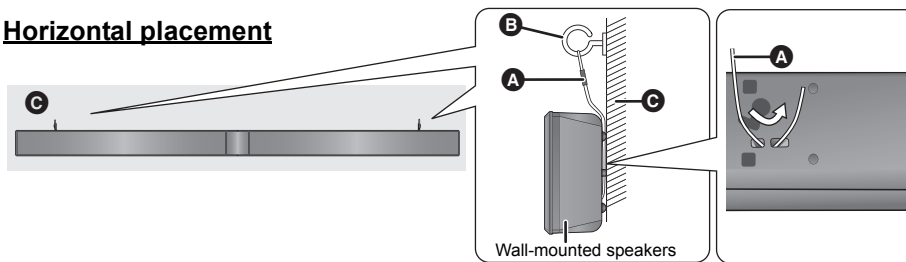

Vertical placement

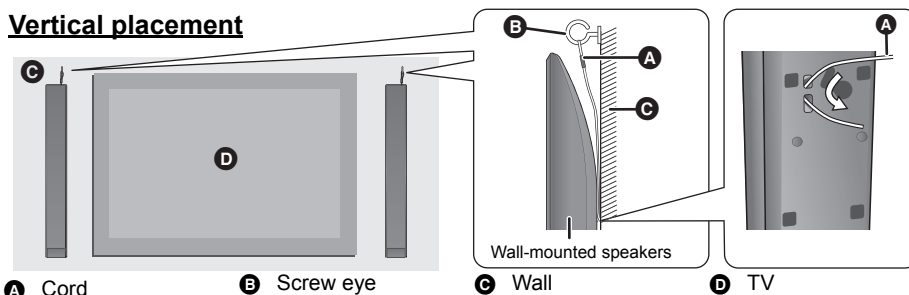

Getting started

When placing the speakers on a table

Horizontal placement

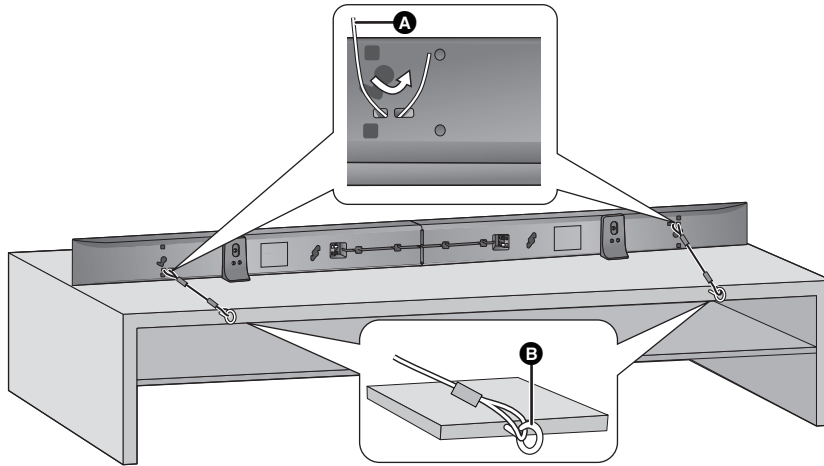

Vertical placement

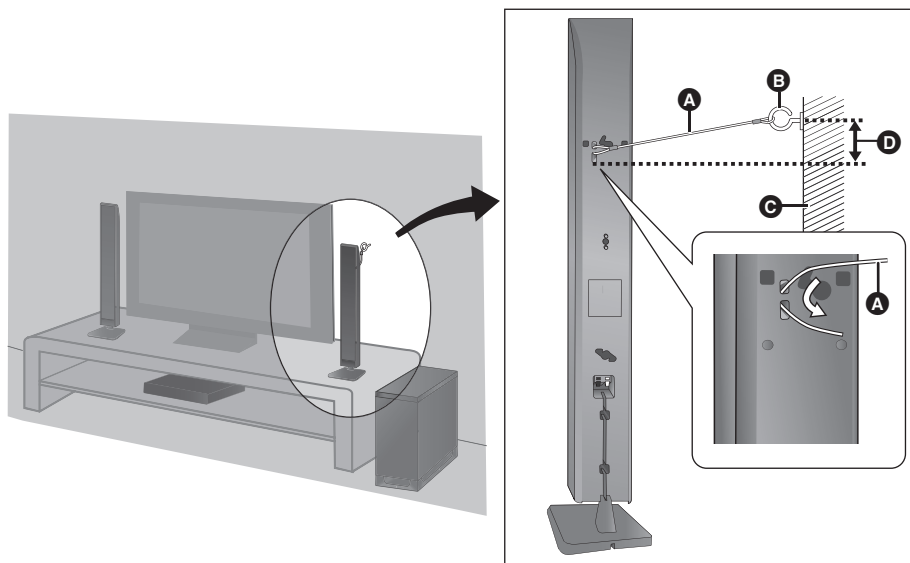

- A** Cord
 - B** Screw eye
 - C** Wall
 - D** Approx. 150 mm (5 ²⁹/₃₂"
- Depending on the placement of the speakers, the screwing position of the screw eye may differ.