

Panasonic[®]

Range Extender

Model No. **KX-TGA405**

Installation Guide for Range Extender

By installing this unit, you can extend the range of your phone system, to include areas where reception was previously not available.

The unit extends the range in all directions, allowing several floors to be covered.

Important:

- This unit is an accessory unit for use with the following series of Panasonic Digital Cordless phones:
KX-TG4011/KX-TG4021/KX-TG4031/KX-TG4051/KX-TG4071/KX-TG6511/
KX-TG6521/KX-TG6531/KX-TG6541/KX-TG7531
- You must register this unit with your base unit before it can be used.
- This leaflet only describes the steps needed to install and use the unit. Please read the base unit's operating instructions for further details.

For best performance

Placement

- We recommend installing the unit to a raised position (such as on a wall), which is well within range of the base unit.
- Avoid positioning the unit close to objects that will interfere with reception, such as thick walls, radiators, metal shelving, etc.
- For maximum distance noise-free operation, place the unit away from electrical appliances such as TV, radio, personal computer or other telephone equipment.

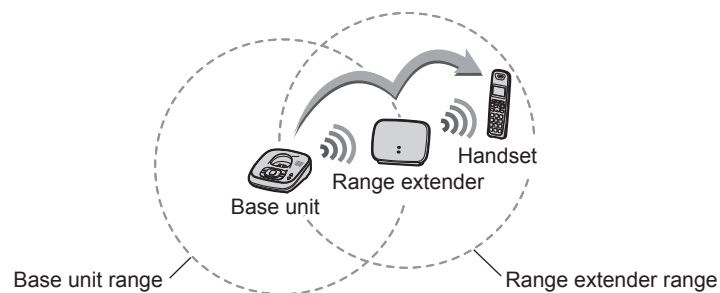

Controls

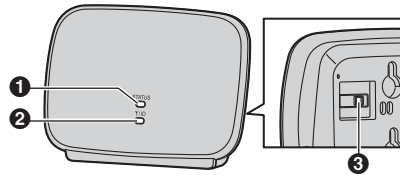

- ❶ STATUS indicator
- ❷ Y indicator
ID indicator
- ❸ PROGRAM

Understanding the STATUS indicator and Y indicator

Indicator	Light status		Meaning
STATUS indicator	Green	On	• Within base unit range. The unit is ready for use.
		Flashing	• 1 handset is communicating with the base unit through this unit.
		Flashing rapidly	• 2 handsets are communicating with the base unit through this unit.
	Red	On	• Out of base unit range.
	Off		• The power is off. (AC adaptor is not connected properly.)
Y indicator	Green	On	• Signal strength of the base unit is strong.
	Amber	On	• Signal strength of the base unit is weak.
	Red	On	• Out of base unit range.
	Off		• The unit is not being used. • The power is off.

Installation

1 Base unit:

Press and hold [LOCATOR] for about 5 seconds until the registration tone sounds.

- The next step must be completed within 90 seconds.

2 Connect the unit.

- Use only the supplied Panasonic AC adaptor PQLV219.

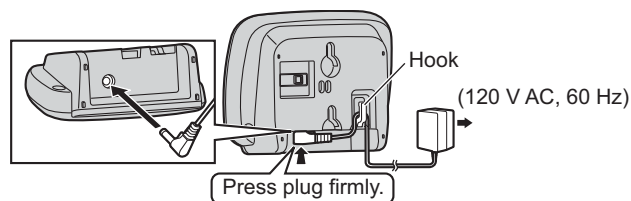

- When the unit is turned on, the STATUS indicator and Y indicator light amber for about 2 seconds.

3 Confirm that the STATUS indicator and Y indicator light green. (The unit is ready for use.)

- If the indicators do not light green, re-position the unit in a place where the indicators light green.
- To stop the registration tone, press [LOCATOR] on the base unit.

Note:

- The AC adaptor must remain connected at all times. (It is normal for the adaptor to feel warm during use.)
- The unit can support a maximum of 2 handsets at a time.

Wall Mounting

Drive the screws (not supplied) into the wall. Mount the unit, then slide it down.

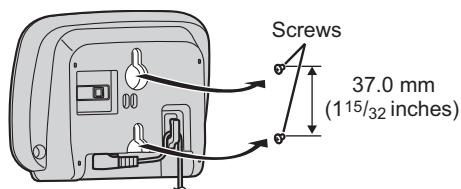

Specifications

- **Standard:** DECT 6.0 (Digital Enhanced Cordless Telecommunications 6.0)
- **Frequency range:** 1.92 GHz to 1.93 GHz
- **RF transmission power:** 115 mW (max.)
- **Power source:** 120 V AC, 60 Hz
- **Power consumption:** Standby: Approx. 1.0 W, Maximum: Approx. 1.8 W

Troubleshooting

Problem	Cause/solution
The unit does not work.	<ul style="list-style-type: none">• When the indicators do not light, the AC adaptor is not connected properly. Check the connections.• When the indicators light red, the unit is out of base unit range. Move the unit closer to the base unit.• Registration may have been canceled. Deregister the unit, then re-register. <p>Deregister:</p> <ol style="list-style-type: none">1 Unplug the AC adaptor, then press and hold [PROGRAM].2 While pressing and holding [PROGRAM], re-connect the AC adaptor.3 Keep pressing and holding [PROGRAM] for about 10 seconds until the STATUS indicator flashes amber. Then release [PROGRAM]. <p>Re-register:</p> <ol style="list-style-type: none">1 Range extender: Unplug the AC adaptor.2 Base unit: Press and hold [LOCATOR] for about 5 seconds until the registration tone sounds.<ul style="list-style-type: none">– The next step must be completed within 90 seconds.3 Range extender: Connect the AC adaptor, then wait until the STATUS indicator lights green.4 Base unit: To stop the registration tone, press [LOCATOR].
While talking using the handset, sound cuts in and out.	<ul style="list-style-type: none">• The handset is out of range. Move the handset closer to this unit.

For your safety

To prevent severe injury and loss of life/property, read this section carefully before using the product to ensure proper and safe operation of your product.

WARNING

Power connection

- Use only the power source marked on the product.
- Do not overload power outlets and extension cords. This can result in the risk of fire or electric shock.
- Completely insert the AC adaptor/power plug into the power outlet. Failure to do so may cause electric shock and/or excessive heat resulting in a fire.
- Regularly remove any dust, etc. from the AC adaptor/power plug by pulling it from the power outlet, then wiping with a dry cloth. Accumulated dust may cause an insulation defect from moisture, etc. resulting in a fire.
- Unplug the product from power outlets if it emits smoke, an abnormal smell, or makes an unusual noise. These conditions can cause fire or electric shock. Confirm that smoke has stopped emitting and contact the Panasonic Call Center at 1-800-211-PANA (1-800-211-7262).
- Unplug from power outlets and never touch the inside of the product if its casing has been broken open.
- Never touch the plug with wet hands. Danger of electric shock exists.

Installation

- To prevent the risk of fire or electrical shock, do not expose the product to rain or any type of moisture.
- Do not place or use this product near automatically controlled devices such as automatic doors and fire alarms. Radio waves emitted from this product may cause such devices to malfunction resulting in an accident.
- Do not allow the AC adaptor to be excessively pulled, bent or placed under heavy objects.

Operating safeguards

- Unplug the product from power outlets before cleaning. Do not use liquid or aerosol cleaners.
- Do not disassemble the product.
- Do not spill liquids (detergents, cleansers, etc.) onto the telephone line cord plug, or allow it to become wet at all. This may cause a fire. If the telephone line cord plug becomes wet, immediately pull it from the telephone wall jack, and do not use.

Medical

- Consult the manufacturer of any personal medical devices, such as pacemakers or hearing aids, to determine if they are adequately shielded from external RF (radio frequency) energy. (The product operates in the frequency range of 1.92 GHz to 1.93 GHz, and the RF transmission power is 115 mW (max.)
- Do not use the product in health care facilities if any regulations posted in the area instruct you not to do so. Hospitals or health care facilities may be using equipment that could be sensitive to external RF energy.

CAUTION

Installation and location

- The AC adaptor is used as the main disconnect device. Ensure that the AC outlet is installed near the product and is easily accessible.

Important safety instructions

When using your product, basic safety precautions should always be followed to reduce the risk of fire, electric shock, and injury to persons, including the following:

1. Do not use this product near water for example, near a bathtub, washbowl, kitchen sink, or laundry tub, in a wet basement or near a swimming pool.
2. Avoid using a telephone (other than a cordless type) during an electrical storm. There may be a remote risk of electric shock from lightning.
3. Do not use the telephone to report a gas leak in the vicinity of the leak.
4. Use only the power cord indicated in this manual.

SAVE THESE INSTRUCTIONS

For best performance

Range extender location/avoiding noise

The range extender and other compatible Panasonic units use radio waves to communicate with each other.

- For maximum coverage and noise-free communications, place your base unit:
 - at a convenient, high, and central location with no obstructions between the handset and base unit in an indoor environment.
 - away from electronic appliances such as TVs, radios, personal computers, wireless devices, or other phones.
 - facing away from radio frequency transmitters, such as external antennas of mobile phone cell stations. (Avoid putting the base unit on a bay window or near a window.)
- Coverage and voice quality depends on the local environmental conditions.
- If the reception for a base unit location is not satisfactory, move the base unit to another location for better reception.

Environment

- Keep the product away from electrical noise generating devices, such as fluorescent lamps and motors.
- The product should be kept free from excessive smoke, dust, high temperature, and vibration.
- The product should not be exposed to direct sunlight.
- Do not place heavy objects on top of the product.
- When you leave the product unused for a long period of time, unplug the product from the power outlet.
- The product should be kept away from heat sources such as heaters, kitchen stoves, etc. It should not be placed in rooms where the temperature is less than 0 °C (32 °F) or greater than 40 °C (104 °F). Damp basements should also be avoided.
- The maximum calling distance may be shortened when the product is used in the following places: Near obstacles such as hills, tunnels, underground, near metal objects such as wire fences, etc.
- Operating the product near electrical appliances may cause interference. Move away from the electrical appliances.

Routine care

- **Wipe the outer surface of the product with a soft moist cloth.**
- Do not use benzene, thinner, or any abrasive powder.

Other information

Notice for product disposal, transfer, or return

- This product can store your private/confidential information. To protect your privacy/confidentiality, we recommend that you erase information such as phonebook or caller list entries from the memory before you dispose of, transfer, or return the product.

Notice

- This product is designed for use in the United States of America. Sale or use of this product in other countries may violate local laws.
- Cet appareil est conçu pour être utilisé aux États-Unis d'Amérique. La vente ou l'emploi de cet appareil dans certains autres pays peut constituer une infraction à la législation locale.
- Este producto está diseñado para usarse en los Estados Unidos de América. La venta o el empleo de este producto en ciertos países puede constituir violación de la legislación local.
- 本產品專為美國使用而設。若在其他國家銷售或使用，可能會違反當地法例。
- この製品は、日本国外での使用を目的として設計されており、日本国内での使用は法律違反となります。従って、当社では日本国内においては原則として修理などのサービスは致しかねます。

FCC and other information

This device complies with Part 15 of the FCC Rules. Operation is subject to the following two conditions:

- (1) This device may not cause harmful interference, and (2) this device must accept any interference received, including interference that may cause undesired operation.

CAUTION:

Any changes or modifications not expressly approved by the party responsible for compliance could void the user's authority to operate this device.

NOTE:

This equipment has been tested and found to comply with the limits for a Class B digital device, pursuant to Part 15 of the FCC Rules. These limits are designed to provide reasonable protection against harmful interference in a residential installation. This equipment generates, uses, and can radiate radio frequency energy and, if not installed and used in accordance with the instructions, may cause harmful interference to radio communications. However, there is no guarantee that interference will not occur in a particular installation. If this equipment does cause harmful interference to radio or television reception, which can be determined by turning the equipment off and on, the user is encouraged to try to correct the interference by one or more of the following measures:

- Reorient or relocate the receiving antenna.
- Increase the separation between the equipment and receiver.
- Connect the equipment into an outlet on a circuit different from that to which the receiver is connected.

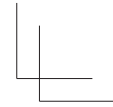
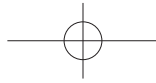
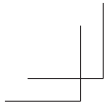

– Consult the dealer or an experienced radio/TV technician for help.

Some cordless telephones operate at frequencies that may cause interference to nearby TVs and VCRs. To minimize or prevent such interference, the base of the cordless telephone should not be placed near or on top of a TV or VCR. If interference is experienced, move the cordless telephone further away from the TV or VCR. This will often reduce, or eliminate, interference.

FCC RF Exposure Warning:

- This product complies with FCC radiation exposure limits set forth for an uncontrolled environment.
- To comply with FCC RF exposure requirements, the range extender must be installed and operated 20 cm (8 inches) or more between the product and all person's body (excluding extremities of hands, wrist and feet).
- This product may not be collocated or operated in conjunction with any other antenna or transmitter.



Notice

- FCC ID can be found on the bottom of the unit.

