

**Panasonic®**

## Operating Instructions

**Expandable Digital Cordless Phone**

Model No. **KX-TH1201**

Model No. **KX-TH1211**

**with 2 Handsets**

Model No. **KX-TH1212**

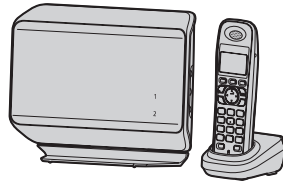

Model shown is KX-TH1201.



This unit is compatible with Caller ID. You must subscribe to the appropriate service offered by your service provider/telephone company.

**Charge the batteries for about 7 hours before initial use.**

Please read these operating instructions before using the unit and save them for future reference.

For assistance, visit our website:

<http://www.panasonic.com/help> for customers in the U.S.A. or Puerto Rico.

## Table of Contents

### Introduction

Product information . . . . .	3
Accessory information . . . . .	5
For your safety . . . . .	7
Important safety instructions . . . . .	8
For best performance . . . . .	9

### Preparation

Controls . . . . .	10
Display/Indicators . . . . .	11
Connections . . . . .	12
Battery installation and replacement . . . . .	13
Battery charge . . . . .	14
Symbols used in these operating instructions . . . . .	15
Setting up the unit before use . . . . .	16

### Link to Cell

Link to cell feature . . . . .	17
Registering a cellular phone . . . . .	17
Link to cell settings . . . . .	18

### Making/Answering Calls

Making calls using a cellular line . . . . .	20
Making calls using the landline . . . . .	21
Answering calls . . . . .	22
Useful features during a call . . . . .	22

### Shared Phonebook

Shared phonebook . . . . .	24
----------------------------	----

### Programming

Programmable settings . . . . .	26
Special instructions for programmable settings . . . . .	33
Registering a unit . . . . .	35

### Caller ID Service

Using Caller ID service . . . . .	37
Caller list . . . . .	38

### Voice Mail Service for Landline

Voice mail service for landline . . . . .	41
---	----

### Intercom/Locator

Intercom . . . . .	43
Transferring calls . . . . .	43

Conference calls on the landline . . . . .	43
Handset locator . . . . .	44

### Useful Information

Belt clip . . . . .	45
Wall mounting . . . . .	45
Headset (optional) . . . . .	46
Error messages . . . . .	47
Troubleshooting . . . . .	49
FCC and other information . . . . .	56
Specifications . . . . .	59
Customer services . . . . .	60
Warranty . . . . .	61

### Index

Index . . . . .	63
-----------------	----

**Introduction**

**Product information**

Thank you for purchasing a new Panasonic digital cordless phone.

**Notable differences between the models**

**KX-TH1201 series**

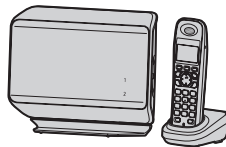

Model No.	Base unit	Handset	
	Part No.	Part No.	Quantity
KX-TH1201	KX-TH1201	KX-TGA930	1

**KX-TH1211 series**



• Model shown is KX-TH1212.

– With telephone line jack on the back of the base unit

Model No.	Base unit	Handset	
	Part No.	Part No.	Quantity
KX-TH1211	KX-TH1211	KX-TGA930	1
KX-TH1212	KX-TH1211	KX-TGA930	2

## Introduction

### Feature differences

Model No.	Link to cell <sup>*1</sup>	Landline <sup>*2</sup>	Intercom
			 <sup>*3</sup>
KX-TH1201	●	—	— <sup>*4</sup>
KX-TH1211	●	●	— <sup>*4</sup>
KX-TH1212	●	●	●

<sup>\*1</sup> Cellular lines can be used to make/answer calls with the handset by registering your cellular phones to the base unit (page 17).

<sup>\*2</sup> Landline can be used to make/answer calls.

<sup>\*3</sup> Intercom calls can be made between the handsets.

<sup>\*4</sup> Intercom calls can be made between the handsets by purchasing and registering one or more optional handsets (page 6).

### Feature highlights

#### ■ Link to cell

Allows you to make or answer cellular calls using the handset by registering up to 2 cellular phones. Your cellular phones must be Bluetooth<sup>®</sup> wireless technology compatible with this product (page 17). It is useful for maximizing the benefits of cellular services such as a cellular to cellular calling plan. For more information on this feature, please visit our website at:  
[www.panasonic.com/CompatibleCellPhones](http://www.panasonic.com/CompatibleCellPhones)

#### ■ Talking Caller ID

Allows the handset to announce the caller's name or phone number when a call is received (page 37).

#### ■ Block calls

Allows the unit to reject calls from specified phone numbers that you do not want to answer such as junk calls (page 33).

#### ■ Night mode

Allows you to select a span of time during which the handset will not ring for outside calls (page 34).

#### ■ Talking battery alert/Talking alarm clock

Allows the handset to alert you if the battery is low (talking battery alert; page 15) and to alert you at the set time with a selected voice announcement such as "Good morning" as a wake-up greeting (talking alarm clock; page 34).

**Introduction**

**Accessory information**

**Supplied accessories**

No.	Accessory item/ Order number	Quantity		
		KX- TH1201	KX- TH1211	KX- TH1212
①	AC adaptor for base unit/ PQLV207T	1	1	1
②	Telephone line cord/ PQJA10075Z	–	1	1
③	Base unit stand* <sup>1</sup> / PNKL1003Z1	1	1	1
④	Rechargeable batteries* <sup>2</sup>	2	2	4
⑤	Handset cover* <sup>3</sup> / PNYNTGA430BR	1	1	2
⑥	Belt clip/ PNKE1004Z1	1	1	2
⑦	Charger/ PNLC1004ZB	1	1	2
⑧	AC adaptor for charger/ PQLV209T	1	1	2

\*1 The base unit stand comes attached to the base unit.

\*2 See page 6 for replacement battery information.

\*3 The handset cover comes attached to the handset.

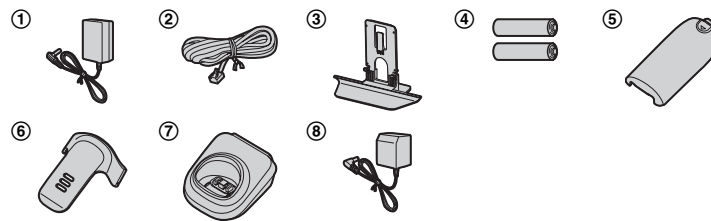

## Introduction

### Additional/replacement accessories

Please contact your nearest Panasonic dealer for sales information.

No.	Accessory item	Order number
①	Headset	KX-TCA60, KX-TCA66, KX-TCA86, KX-TCA92, KX-TCA93, KX-TCA94, KX-TCA95
②	T-adaptor*1	KX-J66
③	Battery back-up power supply	KX-TCA230
④	Base unit stand	PNKL1003Z1

\*1 KX-TH1211/KX-TH1212

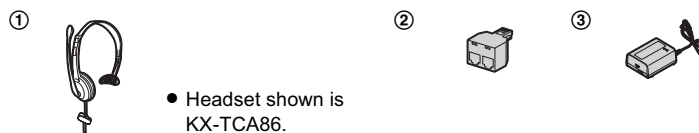

### Replacement battery information:

- Replace batteries only with a nickel metal hydride (Ni-MH) type of battery. This model requires 2 AAA (R03) batteries for every handset. For best performance, we recommend using Panasonic rechargeable batteries (Order No. HHR-4DPA). To order, please call 1-800-332-5368 or visit <http://www.panasonic.com/batterystore>

### Expanding your phone system

You can expand your phone system by registering optional handsets (max. 6) to a single base unit.

### Optional handset feature overview

Feature	Model No.	
	KX-TGA930*1	KX-TGA935
Drop and splash resistance	—	●

\*1 Same handset supplied with the base unit

### Sales and support information

- To order additional/replacement accessories, call 1-800-332-5368.
- TTY users (hearing or speech impaired users) can call 1-866-605-1277.

## Introduction

### For your safety

To prevent severe injury and loss of life/property, read this section carefully before using the product to ensure proper and safe operation of your product.

### WARNING

#### Power connection

- Use only the power source marked on the product.
- Do not overload power outlets and extension cords. This can result in the risk of fire or electric shock.
- Completely insert the AC adaptor/power plug into the power outlet. Failure to do so may cause electric shock and/or excessive heat resulting in a fire.
- Regularly remove any dust, etc. from the AC adaptor/power plug by pulling it from the power outlet, then wiping with a dry cloth. Accumulated dust may cause an insulation defect from moisture, etc. resulting in a fire.
- Unplug the product from power outlets if it emits smoke, an abnormal smell, or makes an unusual noise. These conditions can cause fire or electric shock. Confirm that smoke has stopped emitting and contact the Panasonic Call Center at 1-800-211-PANA (1-800-211-7262).
- Never touch the plug with wet hands. Danger of electric shock exists.

#### Installation

- To prevent the risk of fire or electrical shock, do not expose the product to rain or any type of moisture.
- Do not place or use this product near automatically controlled devices such

as automatic doors and fire alarms. Radio waves emitted from this product may cause such devices to malfunction resulting in an accident.

#### Operating safeguards

- Unplug the product from power outlets before cleaning. Do not use liquid or aerosol cleaners.
- Do not disassemble the product.
- KX-TH1211/KX-TH1212: Do not spill liquids (detergents, cleansers, etc.) onto the telephone line cord plug, or allow it to become wet at all. This may cause a fire. If the telephone line cord plug becomes wet, immediately pull it from the telephone wall jack, and do not use.

#### Medical

- Consult the manufacturer of any personal medical devices, such as pacemakers or hearing aids, to determine if they are adequately shielded from external RF (radio frequency) energy. (The product operates in the frequency range of 1.92 GHz to 1.93 GHz, and the RF transmission power is 125 mW (max.).)
- Do not use the product in health care facilities if any regulations posted in the area instruct you not to do so. Hospitals or health care facilities may be using equipment that could be sensitive to external RF energy.

### CAUTION

#### Installation and relocation

- KX-TH1211/KX-TH1212: Never install telephone wiring during an electrical storm.
- KX-TH1211/KX-TH1212: Never install telephone line jacks in wet locations

## Introduction

unless the jack is specifically designed for wet locations.

- KX-TH1211/KX-TH1212: Never touch uninsulated telephone wires or terminals unless the telephone line has been disconnected at the network interface.
- KX-TH1211/KX-TH1212: Use caution when installing or modifying telephone lines.
- The AC adaptor is used as the main disconnect device. Ensure that the AC outlet is installed near the product and is easily accessible.
- This product is unable to make calls when:
  - the handset batteries need recharging or have failed.
  - there is a power failure.

## Battery

- We recommend using the batteries noted on page 6. **USE ONLY rechargeable Ni-MH batteries AAA (R03) size.**
- Do not mix old and new batteries.
- Do not open or mutilate the batteries. Released electrolyte from the batteries is corrosive and may cause burns or injury to the eyes or skin. The electrolyte may be toxic if swallowed.
- Exercise care when handling the batteries. Do not allow conductive materials such as rings, bracelets or keys to touch the batteries, otherwise a short circuit may cause the batteries and/or the conductive material to overheat and cause burns.
- Charge the batteries provided with or identified for use with this product only, in accordance with the instructions and limitations specified in this manual.
- Only use a compatible charger to charge the batteries. Do not tamper

with the charger. Failure to follow these instructions may cause the batteries to swell or explode.

## Important safety instructions

When using your product, basic safety precautions should always be followed to reduce the risk of fire, electric shock and injury to persons, including the following:

1. Do not use this product near water for example, near a bathtub, washbowl, kitchen sink or laundry tub, in a wet basement or near a swimming pool.
2. Avoid using a telephone (other than a cordless type) during an electrical storm. There may be a remote risk of electric shock from lightning.
3. Do not use the telephone to report a gas leak in the vicinity of the leak.
4. Use only the power cord and batteries indicated in this manual. Do not dispose of batteries in a fire. They may explode. Check with local codes for possible special disposal instructions.

## SAVE THESE INSTRUCTIONS



## Introduction

### For best performance

#### Base unit location/avoiding noise

The base unit and other compatible Panasonic units use radio waves to communicate with each other.

- For maximum coverage and noise-free communications, place your base unit:
  - at a convenient, high, and central location with no obstructions between the handset and base unit in an indoor environment.
  - away from electronic appliances such as TVs, radios, personal computers, wireless devices or other phones.
  - avoid facing radio frequency transmitters, such as external antennas of mobile phone cell stations (avoid putting the base unit on a bay window or near a window).
- Coverage and voice quality depends on the local environmental conditions.
- If the reception for a base unit location is not satisfactory, move the base unit to another location for better reception.

#### Environment

- Keep the product away from electrical noise generating devices, such as fluorescent lamps and motors.
- The product should be kept free from excessive smoke, dust, high temperature, and vibration.
- The product should not be exposed to direct sunlight.
- Do not place heavy objects on the power cord or top of the product.
- When you leave the product unused for a long period of time, unplug the product from the power outlet.

- The product should be kept away from heat sources such as heaters, kitchen stoves, etc. It should not be placed in rooms where the temperature is less than 5 °C (41 °F) or greater than 40 °C (104 °F). Damp basements should also be avoided.
- The maximum calling distance may be shortened when the product is used in the following places: Near obstacles such as hills, tunnels, underground, near metal objects such as wire fences, etc.
- Operating the product near electrical appliances may cause interference. Move away from the electrical appliances.

#### Routine care

- **Wipe the outer surface of the product with a soft moist cloth.**
- Do not use benzine, thinner, or any abrasive powder.

#### Notice for product disposal, transfer, or return

- This product can store your private/confidential information. To protect your privacy/confidentiality, we recommend that you erase the information such as phonebook or caller list entries from the memory before you dispose of, transfer, or return the product.

**Preparation**

**Controls**

**Base unit**

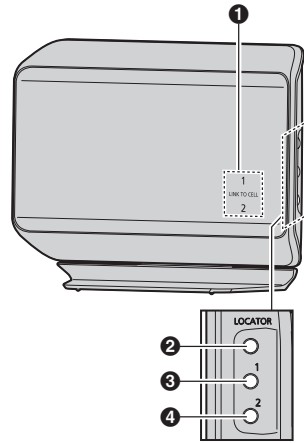

- 1 LINK TO CELL indicator 1, 2
- 2 [LOCATOR]
- 3 Cellular select button [1]
- 4 Cellular select button [2]

**Handset**

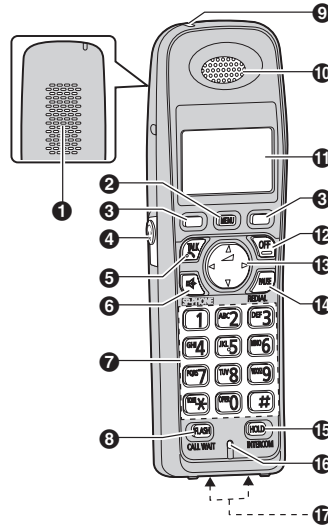

- 1 Speaker
- 2 [MENU]
- 3 Soft keys
- 4 Headset jack
- 5 [TALK]
- 6 [SP-PHONE: Speakerphone]
- 7 Dial keypad  
([\*]: TONE)
- 8 [FLASH] [CALL WAIT]
- 9 Charge indicator  
Ringer indicator  
Message indicator\*1
- 10 Receiver
- 11 Display
- 12 [OFF]
- 13 Navigator key ([▲]/[▼]/[←]/[→])  
◀ (Volume: [▲]/[▼])
- 14 [PAUSE] [REDIAL]
- 15 [HOLD] [INTERCOM]
- 16 Microphone
- 17 Charge contacts

## Preparation

\*1 KX-TH1211/KX-TH1212

### Using the navigator key

The handset navigator key can be used to navigate through menus and to select items shown on the display by pressing [▲], [▼], [←], or [→].

To adjust the receiver or speaker volume, press [▲] to increase the volume, or press [▼] to decrease the volume repeatedly while talking.

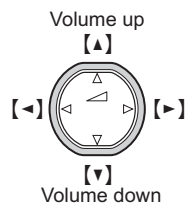

### Soft keys

The handset features 2 soft keys. By pressing a soft key, you can select the feature shown directly above it on the display.

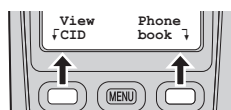

## Display/Indicators

### Handset display items

Item	Meaning
[■ ■ ■]	Battery level
[1]	Handset number

Item	Meaning
<b>C 1</b> <b>C 2</b> <b>C 1 2</b> (displayed in the left)	The cellular phone is connected. You are ready to make/receive cellular calls.
<b>C 1</b> <b>C 2</b> (displayed in the right)	<ul style="list-style-type: none"> <li>– The cellular line is selected for the ringer setting.</li> <li>– A cellular call is being received or blocked on that line.</li> </ul>
<b>Cell in use</b>	Someone is using a cellular line.
<b>Line in use</b> <sup>*1</sup>	Someone is using the landline.

\*1 KX-TH1211/KX-TH1212

### LINK TO CELL indicator 1, 2

The LINK TO CELL indicators on the base unit show the status of cellular lines.

Status		Meaning
Color	Light pattern	
Green	On	The cellular phone is connected. You are ready to make/receive cellular calls.
	Flashing	The base unit is registering a cellular phone.
	Flashing rapidly	The base unit is searching for the registered cellular phone to connect (page 18).

**Preparation**

Status		Meaning
Color	Light pattern	
Red	On	The cellular line is in use.
	Flashing	A cellular call is on hold.
	Flashing rapidly	A cellular call is being received.
Amber	on	A cellular phone is registered but not connected to the base unit (page 18).
Light off	–	A cellular phone is not registered to the base unit.

**Connections**

Connect the AC adaptor cord (1) by pressing the plug firmly (2).  
KX-TH1211/KX-TH1212: Connect the telephone line cord until it clicks into the base unit and telephone line jack (3).

**Base unit**

- Use only the supplied Panasonic AC adaptor PQLV207.
- KX-TH1211/KX-TH1212: Use only the supplied telephone line cord. Using another telephone line cord may not allow the unit to work properly.

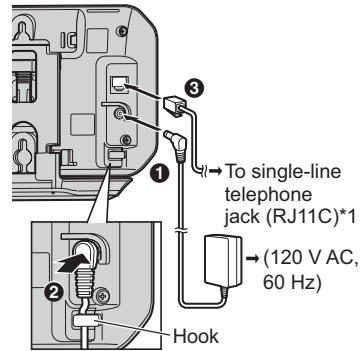

\*1 KX-TH1201: The base unit does not have a telephone line jack.

- Model shown is KX-TH1211.

## Preparation

### Charger

- Use only the supplied Panasonic AC adaptor PQLV209.

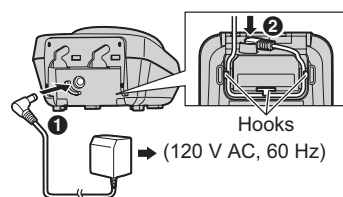

### Note:

- The AC adaptor must remain connected at all times. (It is normal for the adaptor to feel warm during use.)
- The AC adaptor should be connected to a vertically oriented or floor-mounted AC outlet. Do not connect the AC adaptor to a ceiling-mounted AC outlet, as the weight of the adaptor may cause it to become disconnected.

### During a power failure (KX-TH1211/ KX-TH1212)

The unit will not work during a power failure. We recommend connecting a corded-type telephone (without AC adaptor) to the same telephone line or to the same telephone line jack using a Panasonic T-adaptor (page 6). Emergency power can be supplied to the unit by connecting a Panasonic battery back-up power supply noted on page 6.

### If you subscribe to a DSL/ADSL service (KX-TH1211/KX-TH1212)

Please attach a DSL/ADSL filter (contact your DSL/ADSL provider) to the telephone line between the base unit and the telephone line jack in the event of the following:

- noise is heard during conversations.

- Caller ID features do not function properly.

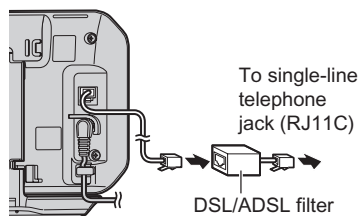

## Battery installation and replacement

### Important:

- Use the supplied rechargeable batteries (Part No. HHR-65AAABU).
- When installing the batteries:
  - Wipe the battery ends ( $\oplus$ ,  $\ominus$ ) with a dry cloth.
  - Avoid touching the battery ends ( $\oplus$ ,  $\ominus$ ) or the unit contacts.
  - Ensure correct polarities ( $\oplus$ ,  $\ominus$ ).
- When replacing the batteries:
  - USE ONLY rechargeable Ni-MH batteries AAA (R03) size.
  - Do NOT use Alkaline/Manganese/Ni-Cd batteries.
  - We recommend using the Panasonic rechargeable batteries noted on page 6, 8.

### Preparation

- 1 Press the notch on the handset cover firmly, and slide it in the direction of the arrow.

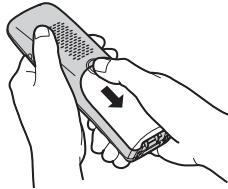

- 2 Insert the batteries negative (⊖) end first. Close the handset cover.

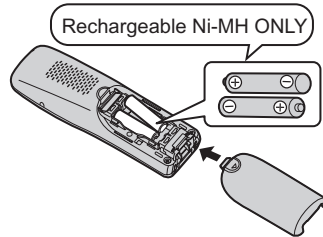

**Note:**

- When replacing batteries, remove the old batteries.

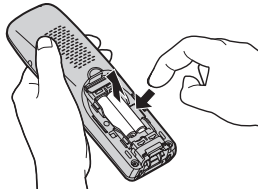

**Attention:**



A nickel metal hydride battery that is recyclable powers the product you have purchased.

Please call 1-800-8-BATTERY (1-800-822-8837) for information on how to recycle this battery.

### Battery charge

Place the handset on the charger for about 7 hours before initial use.

- While charging, "Charging" is displayed and the charge indicator on the handset lights up. When the batteries are fully charged, "Charge completed" is displayed.



**Note:**

- It is normal for the handset to feel warm during charging.
- If you want to use the handset immediately, charge the batteries for at least 15 minutes.
- Clean the charge contacts of the handset and charger with a soft and dry cloth once a month. Clean more often if the unit is exposed to grease, dust, or high humidity.

## Preparation

handset on the charger and let it charge for at least 7 hours.

### Battery level

Battery icon	Battery level
	High
	Medium
	Low <ul style="list-style-type: none"> <li>When flashing: Needs to be charged.</li> </ul>
	Empty

#### Note:

- The batteries need to be charged if:
  - the handset alerts you with a voice announcement (**talking battery alert**) after you finish talking.
  - the handset beeps while you are engaged in a call.

### Panasonic Ni-MH battery performance (supplied batteries)

Operation	Operating time
In continuous use	5 hours max.
Not in use (standby)	11 days max.
While using the clarity booster feature (page 23)	3 hours max.

#### Note:

- Actual battery performance depends on a combination of how often the handset is in use and how often it is not in use (standby).
- Even after the handset is fully charged, the handset can be left on the charger without any ill effect on the batteries.
- The battery level may not be displayed correctly after you replace the batteries. In this case, place the

## Symbols used in these operating instructions

Symbol	Meaning
[ ]	The words in the brackets indicate button names/soft key names on the handset and base unit. <b>Example:</b> Unit keys: [], [OFF] Soft keys: [View CID], [Phonebook]
→	Proceed to the next operation.
“ ”	The words in quotations indicate the menu on the display. <b>Example:</b> “Alarm”
[▼]/[▲]: “ ”	Press [▼] or [▲] to select the words in quotations. <b>Example:</b> [▼]/[▲]: “off”

## Preparation

### Setting up the unit before use

#### Display language

You can select either "English" or "Español" as the display language. The default setting is "English".

- 1 [MENU] → [⇄][1][1][0]
- 2 [▼]/[▲]: Select the desired setting.
- 3 Press the right soft key to save. → [OFF]

#### Voice guidance language

You can select either "English" or "Español" as the voice announcement language of the talking alarm clock and talking battery alert. The default setting is "English".

- 1 [MENU] → [⇄][1][1][2]
- 2 [▼]/[▲]: Select the desired setting.
- 3 [Save] → [OFF]

#### Dialing mode

Available for:  
KX-TH1211/KX-TH1212

If you cannot make calls, change this setting according to your telephone line service. The default setting is "Tone".  
"Tone": For tone dial service.  
"Pulse": For rotary/pulse dial service.

- 1 [MENU] → [⇄][1][2][0]
- 2 [▼]/[▲]: Select the desired setting.
- 3 [Save] → [OFF]

### Date and time

- 1 [MENU] → [⇄][1][0][1]
- 2 Enter the current month, date, and year by selecting 2 digits for each.  
**Example:** July 15, 2008  
[0][7] [1][5] [0][8]
- 3 Enter the current hour and minute (12-hour clock format) by selecting 2 digits for each.  
**Example:** 9:30  
[0][9] [3][0]
- 4 [AM/PM]: Select "AM" or "PM".
- 5 [Save] → [OFF]

#### Note:

- When English is selected as the display language, 12-hour clock format is used. When Spanish is selected, 24-hour clock format is used.
- To correct a digit, press [▲], [▼], [←], or [→] to move the cursor to the digit, then make the correction.
- The date and time may be incorrect after a power failure. In this case, set the date and time again.



## Link to Cell

### Link to cell feature

Your cellular phone must be Bluetooth wireless technology compatible with this product, so that you can use the handset to make or answer calls using a cellular line.

This feature is useful for maximizing the benefits of cellular services (such as free night and weekend calls, or cellular to cellular calling plans) by utilizing unused peak minutes with your home phone.

To use this feature, you must first register your cellular phone to the base unit and connect it to the base unit (page 18).

#### Important:

- Up to 2 cellular phones can be registered. There can be only one active Bluetooth connection at a time.
- To keep the cellular line stable between the base unit and cellular phone, we recommend you use the cellular phone within the range of the base unit.
- While you are on a cellular call, the battery of your cellular phone is being consumed. We recommend charging your cellular phone during the call.

### Registering a cellular phone

#### Important:

- For more details and the list of compatible cellular phones, please visit at:  
[www.panasonic.com/CompatibleCellPhones](http://www.panasonic.com/CompatibleCellPhones)
- Before registering a Bluetooth enabled cellular phone to the base unit:

- we recommend you change the PIN (page 17).
- make sure that no Bluetooth device such as a Bluetooth headset is connected to your cellular phone.

#### 1 Base unit:

Press and hold the desired cellular select button (**[1]**, **[2]**) until the LINK TO CELL indicator flashes green.

- After the LINK TO CELL indicator starts flashing, the rest of the procedure must be completed within 5 minutes.

#### 2 Your cellular phone:

While the LINK TO CELL indicator is flashing green, follow the instructions of your cellular phone to enter the registration mode.

- Depending on your cellular phone, it may ask you to enter the base unit PIN (default: "0000").

#### 3 Base unit:

Wait until the LINK TO CELL indicator stops flashing and lights green to complete registration.

- It may take more than 10 seconds to complete registration.

#### Note:

- To cancel a cellular phone from the base unit, see "Deregistering a cellular phone", page 19.
- Only one cellular phone can be registered to a cellular select button. Deregister the unnecessary cellular phone before registering a new one (page 19).

### Changing the PIN (Personal Identification Number)

For security, the PIN must be entered when registering a cellular phone.

#### Important:

- If you change the PIN, please make note of your new PIN. The unit does

## Link to Cell

not reveal the PIN to you. If you forget your PIN, see page 55.

- 1 [MENU] → [#][1][3][2]
- 2 Enter the current 4-digit PIN (default: "0000").
- 3 Enter the new 4-digit PIN.
- 4 [Save] → [OFF]

## Link to cell settings

### Auto connection to the cellular phone

After your cellular phone is connected to the base unit, and if you carry your cellular phone far from the base unit (example: if you leave the house with your cellular phone), the connection is lost. After returning closer to the base unit's range, this feature allows the base unit to try to reconnect to the cellular phone at regular intervals. You can set how often the base unit tries to resume the connection. The default setting is "1min".

#### Important:

- Some cellular phones lose connection after usage, please check the specification of your cellular phone for more details.

- 1 [MENU] → [#][6][3][2]
- 2 [v]/[▲]: Select the desired setting.
- 3 [Save] → [OFF]

#### Note:

- Depending on your cellular phone, it may ask you if you accept the connection requirement from the base unit. Refer to the operating instructions of your cellular phone for further operations.
- If necessary, you can turn this feature off. When turned off, connect the

cellular phone to the base unit manually (page 18).

### Disconnecting/connecting the cellular phone manually

When you make or answer calls with your cellular phone, we recommend you disconnect it from the base unit, otherwise received audio may not be heard on your cellular phone.

You can also manually reconnect the cellular phone to the base unit without waiting for the auto connection feature to resume the connection.

#### Base unit:

Press the cellular select button ([1], [2]) to disconnect/connect.

### Storing your area code (for users dialing only a 7-digit phone number to make a local call)

You need to add your area code when making cellular calls to a phone number in your area. Once you store your area code, the area code is automatically added to the beginning of the 7-digit phone number when making cellular calls.

- 1 [MENU] → [#][6][3][3]
- 2 Enter the 3-digit area code.
  - To correct a digit, press [Clear].
- 3 [Save] → [OFF]

## *Link to Cell*

### Selecting which handset to ring for cellular calls

You can select which handset rings when you receive a call to a registered cellular phone. The default setting is "0 (A11)".

- 1 **[MENU]** → **[#][6][2][7]**
- 2 **[▼]/[▲]**: Select the desired cellular phone.
  - When only 1 cellular phone is registered, go to step 3.
- 3 **[Select]**
- 4 **[▼]/[▲]**: Select the desired handset(s). → **[▶]**
  - The selected handsets are indicated by ✓.
  - To cancel a selected handset, press **[▶]** again.
- 5 **[Save]** → **[OFF]**

### Turning on the discoverable mode

When the discoverable mode is turned on, the base unit may be seen by other Bluetooth devices. The default setting is "Off".

- 1 **[MENU]** → **[#][6][2][0]**
- 2 **[▼]/[▲]**: Select the desired setting.
- 3 **[Save]** → **[OFF]**

### Deregistering a cellular phone

A handset can cancel a registered cellular phone from the base unit.

- 1 **[MENU]** → **[#][\*][1][3][4]**
- 2 **[3][3][5]** → **[OK]**
  - When only 1 cellular phone is registered, go to step 4.
- 3 **[▼]/[▲]**: Select the desired cellular phone.
- 4 **[Select]**

- After the cellular phone is deregistered, the handset beeps and the LINK TO CELL indicator is turned off.

## Making/Answering Calls

### Making calls using a cellular line

#### Important:

- Only 1 cellular line can be used at a time.
- Before making or answering calls, confirm that the LINK TO CELL indicator lights green (page 11).

#### KX-TH1201

- 1 Lift the handset and dial the phone number.
  - To correct a digit, press **[Clear]**.
- 2 Press **[Cell]** or **[↶]**.
  - When only 1 cellular phone is registered, the unit starts dialing. Go to step 4.
- 3 **[▼]/[▲]**: Select the desired cellular phone. → **[Select]**
- 4 When you finish talking, press **[OFF]** or place the handset on the charger.

#### Using the speakerphone

- 1 Dial the phone number, and press **[☎]**.
  - When only 1 cellular phone is registered, the unit starts dialing. Go to step 3.
- 2 **[▼]/[▲]**: Select the desired cellular phone. → **[Select]**
  - Speak alternately with the other party.
- 3 When you finish talking, press **[OFF]**.

#### Note:

- For best performance, use the speakerphone in a quiet environment.
- To switch back to the receiver, press **[↶]**.

#### Adjusting the receiver or speaker volume

Press **[▲]** or **[▼]** repeatedly while talking.

#### KX-TH1211/KX-TH1212

#### Important:

- A cellular line cannot be used while using the landline.

- 1 Lift the handset and dial the phone number.
  - To correct a digit, press **[Clear]**.
- 2 **[Cell]**
  - When only 1 cellular phone is registered, the unit starts dialing. Go to step 4.
- 3 **[▼]/[▲]**: Select the desired cellular phone. → **[Select]**
- 4 When you finish talking, press **[OFF]** or place the handset on the charger.

#### Note:

- To switch to the speaker, press **[☎]**. To switch back to the receiver, press **[↶]**.

#### Adjusting the receiver or speaker volume

Press **[▲]** or **[▼]** repeatedly while talking.

### Making a call using the redial list

The last 5 phone numbers dialed are stored in the redial list (each 48 digits max.).

- 1 **[REDIAL]**
- 2 **[▼]/[▲]**: Select the desired phone number.
- 3 **KX-TH1201: [↶]/[Cell]**  
**KX-TH1211/KX-TH1212: [Cell]**

## Making/Answering Calls

- When only 1 cellular phone is registered, the unit starts dialing.
- 4** When 2 cellular phones are registered:  
[▼]/[▲]: Select the desired cellular phone. → [Select]

### Erasing a number in the redial list

- 1** [REDIAL]
- 2** [▼]/[▲]: Select the desired phone number.
- 3** [Erase] → [Yes] → [OFF]

## Making calls using the landline

**Available for:**  
KX-TH1211/KX-TH1212

### Important:

- The landline cannot be used while using a cellular line.
- 1** Lift the handset and dial the phone number.
    - To correct a digit, press [Clear].
  - 2** [↶]
  - 3** When you finish talking, press [OFF] or place the handset on the charger.

### Using the speakerphone

- 1** Dial the phone number, and press [☎].
  - Speak alternately with the other party.
- 2** When you finish talking, press [OFF].

### Note:

- For best performance, use the speakerphone in a quiet environment.

- To switch back to the receiver, press [↶].

### Adjusting the receiver or speaker volume

Press [▲] or [▼] repeatedly while talking.

## Making a call using the redial list

The last 5 phone numbers dialed are stored in the redial list (each 48 digits max.).

- 1** [REDIAL]
- 2** [▼]/[▲]: Select the desired phone number.
- 3** [↶]

### Note:

- To erase a number, see "Erasing a number in the redial list", page 21.

## Pause (for PBX/long distance service users)

A pause is sometimes required when making calls using a PBX or long distance service. When storing a calling card access number and/or PIN in the phonebook, a pause is also needed (page 25).

**Example:** If you need to dial the line access number "9" when making outside calls with a PBX:

- 1** [9] → [PAUSE]
- 2** Dial the phone number. → [↶]

### Note:

- A 3.5 second pause is inserted each time [PAUSE] is pressed. Repeat as needed to create longer pauses.

## Making/Answering Calls

### Answering calls

When a call is being received, the ringer indicator flashes rapidly.

- 1 Lift the handset and press [**ANS**] or [**END**] when the handset rings.
  - You can also answer the call by pressing any dial key from [**0**] to [**9**], [**\***], or [**#**]. (**Any key answer feature**)
- 2 When you finish talking, press [**OFF**] or place the handset on the charger.

#### Auto talk

You can answer calls simply by lifting the handset off the charger. You do not need to press [**ANS**]. To turn this feature on, see page 29.

#### Adjusting the handset ringer volume

Press [**▲**] or [**▼**] repeatedly to select the desired volume while the handset is ringing for an incoming call.

#### Note:

- You can also program the handset ringer volume beforehand (page 30, 31).

#### Temporary handset ringer off

While the handset is ringing for a call, you can turn the ringer off temporarily by pressing [**OFF**].

### Useful features during a call

#### Hold

This feature allows you to put an outside call on hold.

- 1 Press [**HOLD**] 2 times during an outside call.
- 2 To release hold, press [**ANS**].
  - KX-TH1211/KX-TH1212: Another handset user can take the landline call by pressing [**ANS**].

#### Note:

- If a call is kept on hold for more than 9 minutes, an alarm tone starts to sound and the ringer indicator flashes rapidly. After 1 additional minute on hold, the call is disconnected.
- KX-TH1211/KX-TH1212: If another phone is connected to the same line (page 13), you can also take the landline call by lifting its handset.

#### Mute

While mute is turned on, you can hear the other party, but the other party cannot hear you.

- 1 Press [**Mute**] during an outside call.
  - [**Mute**] flashes.
- 2 To return to the conversation, press [**Mute**] again.

#### Note:

- [**Mute**] is a soft key visible on the handset display during a call.

#### Flash for landline calls

Available for:  
KX-TH1211/KX-TH1212

## Making/Answering Calls

**[FLASH]** allows you to use the special features of your host PBX such as transferring an extension call, or accessing optional telephone services.

**Note:**

- To change the flash time, see page 31.

### For call waiting or Call Waiting Caller ID service users

To use call waiting, you must first subscribe to the call waiting service of your service provider/telephone company.

This feature allows you to receive calls while you are already talking on the phone. If you receive a call while on the phone, you will hear a call waiting tone. **If you subscribe to both Caller ID and Call Waiting with Caller ID services**, the 2nd caller's information is displayed after you hear the call waiting tone on the handset.

- 1 Press **[CALL WAIT]** to answer the 2nd call.
- 2 To switch between calls, press **[CALL WAIT]**.

**Note:**

- Please contact your service provider/telephone company for details and availability of this service in your area.

### Temporary tone dialing for landline calls (for rotary/pulse service users)

**Available for:**  
KX-TH1211/KX-TH1212

You can temporarily switch the dialing mode to tone when you need to access touch-tone services (for example,

answering services, telephone banking services, etc.).

Press **[\*]** (TONE) before entering access numbers which require tone dialing.

### Handset clarity booster

This feature can improve sound clarity when the handset is used in an area where there may be interference. During an outside call, this feature is turned on automatically when necessary.

- While this feature is turned on the battery operating time is shortened (page 15).

### Call share for landline calls

**Available for:**  
KX-TH1211/KX-TH1212

This feature allows you to join an existing outside call.

To join the conversation, press **[↶]** when the other handset is on an outside call.

**Note:**

- A maximum of 4 parties (including 1 outside party) can join a conversation using 3 extensions.

## Shared Phonebook

### Shared phonebook

The shared phonebook allows you to make calls without having to dial manually. Any handset registered to the base unit can use the shared phonebook. You can add 50 names and phone numbers to the shared phonebook.

#### Important:

- Only 1 person can access the shared phonebook at a time.

### Adding entries

- 1 **[Phonebook]**
- 2 **[Add]**
- 3 Enter the party's name (16 characters max.). → **[Next]**
- 4 Enter the party's phone number (32 digits max.). → **[Next]** → **[Save]**
  - To add other entries, repeat from step 2.
- 5 **[OFF]**

#### Note:

- Caller ID subscribers can use ringer ID feature (page 38).

### Character table for entering names

Key	Character
[1]	& ' ( ) , - . / 1
[2]	a b c A B C 2
[3]	d e f D E F 3
[4]	g h i G H I 4
[5]	j k l J K L 5
[6]	m n o M N O 6
[7]	p q r s P Q R S 7
[8]	t u v T U V 8
[9]	w x y z W X Y Z 9
[0]	0 Space

Key	Character
[*]	*
[#]	#

- To enter another character that is located on the same dial key, first press **[▶]** to move the cursor to the next space.

### Correcting a mistake

Press **[◀]** or **[▶]** to move the cursor to the character or number you want to erase, then press **[Clear]**. Enter the appropriate character or number.

- Press and hold **[Clear]** to erase all characters or numbers.

### Finding and calling a phonebook entry

#### Scrolling through all entries

##### ■ Using a cellular line

- 1 **[Phonebook]** → **[Search]**
- 2 **[▼]/[▲]**: Select the desired entry.
- 3 **KX-TH1201: [↩]/[Cell]**  
**KX-TH1211/KX-TH1212: [Cell]**
  - When only 1 cellular phone is registered, the unit starts dialing.
- 4 When 2 cellular phones are registered:  
**[▼]/[▲]**: Select the desired cellular phone. → **[Select]**

##### ■ Using the landline (KX-TH1211/KX-TH1212)

- 1 **[Phonebook]** → **[Search]**
- 2 **[▼]/[▲]**: Select the desired entry.
- 3 **[↩]**



## Shared Phonebook

### Searching by first character (alphabetically)

- 1 **[Phonebook]** → **[Search]**
- 2 Press the dial key (**[0]** – **[9]**, **[\*]**, or **[#]**) which contains the character you are searching for (page 24).
  - Press the same dial key repeatedly to display the first entry corresponding to each character located on that dial key.
  - If there is no entry corresponding to the character you selected, the next entry is displayed.
- 3 **[▼]/[▲]**: Scroll through the phonebook if necessary.
- 4 ■ **Using a cellular line:**  
To dial the phone number, follow steps 3 and 4, "Scrolling through all entries", page 24.  
■ **Using the landline (KX-TH1211/KX-TH1212):**  
To dial the phone number, press **[↶]**.

### Editing entries

- 1 Find the desired entry (page 24).  
→ **[Option]**
- 2 **[▼]/[▲]**: "**Edit**" → **[Select]**
- 3 Edit the name if necessary (16 digits max.; page 24). → **[Next]**
- 4 Edit the phone number if necessary (32 characters max.). → **[Next]**  
→ **[Save]** → **[OFF]**

### Erasing entries

- 1 Find the desired entry (page 24).  
→ **[Option]**
- 2 **[▼]/[▲]**: "**Erase**" → **[Select]**
- 3 **[Yes]** → **[OFF]**

### Chain dial

This feature allows you to dial phone numbers in the phonebook while you are on a call. This feature can be used, for example, to dial a calling card access number or bank account PIN that you have stored in the phonebook, without having to dial manually.

- 1 During an outside call, press **[MENU]**.
  - Instead of pressing **[MENU]**, you can also press **[Ph.book]** if it is shown on the display.
- 2 **[▼]/[▲]**: Select the desired entry.
- 3 Press **[Call]** to dial the number.

#### Note:

- KX-TH1211/KX-TH1212: When storing a calling card access number and your PIN in the phonebook as 1 phonebook entry, press **[PAUSE]** to add pauses after the number and PIN as necessary (page 21).
- KX-TH1211/KX-TH1212: If you have rotary/pulse service, you need to press **[\*]** before pressing **[MENU]** in step 1 to change the dialing mode temporarily to tone.

## Programming

### Programmable settings

You can customize the unit by programming the following features using the handset.

To access the features, there are 2 methods:

- scrolling through the display menus (page 26)
- using the direct commands (page 29)
- Mainly the direct command method is used in these operating instructions.

#### Programming by scrolling through the display menus

- 1 **[MENU]**
- 2 Press **[▼]** or **[▲]** to select the desired main menu. → **[Select]**
- 3 Press **[▼]** or **[▲]** to select the desired item in sub-menu 1. → **[Select]**
  - In some cases, you may need to select from sub-menu 2. → **[Select]**
- 4 Press **[▼]** or **[▲]** to select the desired setting. → **[Save]**
  - This step may vary depending on the feature being programmed.
  - To exit the operation, press **[OFF]**.

#### Note:

- See page 29 to page 31 for the default setting.

#### KX-TH1201

Main menu	Sub-menu 1	Sub-menu 2	Page
Block calls <sup>*1</sup>	–	–	33
Night mode	On/Off	–	34
	Start/End	–	34
Ringer for cell	Ringer volume	–	–
	Ringer tone	–	–
Set date & time	Date and time <sup>*1</sup>	–	16
	Alarm	–	34
Talking CallerID	–	–	37
Customer support	–	–	35

## Programming

Main menu	Sub-menu 1	Sub-menu 2	Page	
Link to cell	Select HS (ring) <sup>*1</sup>	–	19	
	Auto connection <sup>*1</sup>	–	18	
	Area code (cell) <sup>*1</sup>	–	18	
	Discoverable <sup>*1</sup>	–	19	
	Change PIN <sup>*1</sup>	–	17	
	Deregistration	–	19	
Initial setting	LCD contrast	–	–	
	Key tone	–	–	
	Auto talk	–	22	
	Registration	HS registration		35
		Deregistration		36
	Change language	Display		16
Voice prompt <sup>*1</sup>			16	

<sup>\*1</sup> If you program these settings using one of the handsets, you do not need to program the same item using another handset.

### KX-TH1211/KX-TH1212

Main menu	Sub-menu 1	Sub-menu 2	Page
V.M. access <sup>*1</sup>	–	–	42
Block calls <sup>*1</sup>	–	–	33
Night mode	On/Off	–	34
	Start/End	–	34
Ringer setting	Ringer volume	–	–
	Ringer tone	–	–
Ringer for cell	Ringer volume	–	–
	Ringer tone	–	–
Set date & time	Date and time <sup>*1</sup>	–	16
	Alarm	–	34
	Time adjustment <sup>*1</sup>	–	–
Talking CallerID	–	–	37
Customer support	–	–	35

## Programming

Main menu	Sub-menu 1	Sub-menu 2	Page	
Link to cell	Select HS (ring) *1	-	19	
	Auto connection *1	-	18	
	Area code (cell) *1	-	18	
	Discoverable *1	-	19	
	Change PIN *1	-	17	
	Deregistration	-	19	
Initial setting	Voice Mail	Store VM access# *1	41	
		VM tone detect *1	41	
	Message alert	-	42	
	LCD contrast	-	-	
	Key tone	-	-	
	Auto talk	-	22	
	Caller ID edit *1	-	39	
	Set tel line	Set dial mode *1		16
		Set flash time *1		22
		Set line mode *1		-
	Registration	HS registration		35
Deregistration			36	
Change language	Display		16	
	Voice prompt *1		16	

\*1 If you program these settings using one of the handsets, you do not need to program the same item using another handset.

## Programming

### Programming using the direct commands

- 1 **[MENU]** → **[#]**
- 2 Enter the desired feature code.
- 3 Enter the desired setting code. → **[Save]**
  - This step may vary depending on the feature being programmed.
  - To exit the operation, press **[OFF]**.

**Note:**

- In the following table, < > indicates the default settings.

Feature	Feature code	Setting code	System setting <sup>*1</sup>	Page
Alarm	[7][2][0]	[1]: Once [2]: Daily [0]: <Off>	–	34
Auto talk <sup>*2</sup>	[2][0][0]	[1]: On [0]: <Off>	–	22
Block calls	[2][1][7]	–	●	33
Customer support	[6][8][0]	–	–	35
Date and time	[1][0][1]	–	●	16
Deregistration	[1][3][1]	–	–	36
Display (Change language)	[1][1][0]	[1]: <English> [2]: Español	–	16
Night mode (On/Off)	[2][3][8]	[1]: On [0]: <Off>	–	34
Night mode (Start/End)	[2][3][7]	<11:00 PM/6:00 AM>	–	34
HS registration (Handset registration)	[1][3][0]	–	–	35
Key tone <sup>*3</sup>	[1][6][5]	[1]: <On> [0]: Off	–	–
LCD contrast (Display contrast)	[1][4][5]	[1]–[6]: Level 1–6 <3>	–	–
Talking CallerID	[1][6][2]	[1]: <On> [0]: Off	–	37
Voice prompt (Change language)	[1][1][2]	[1]: <English> [2]: Español	●	16

\*1 If “System setting” column is checked, you do not need to program the same item using another handset.

\*2 If you subscribe to Caller ID service and want to view the caller's information after lifting up the handset to answer a call, turn off this feature.

## Programming

\*3 Turn this feature off if you prefer not to hear key tones while you are dialing or pressing any keys, including confirmation tones and error tones.

### For cellular lines

Feature	Feature code	Setting code	System setting <sup>*1</sup>	Page
Area code (cell)	[6][3][3]	–	●	18
Auto connection	[6][3][2]	[1]: <1min> [2]: 3min [3]: 5min [4]: 10min [0]: Off	●	18
Cellular line mode	[1][5][7]	–	●	35
Change PIN	[1][3][2]	–	●	17
Deregistration	[*][1][3][4]	–	–	19
Discoverable	[6][2][0]	[1]: On [0]: <Off>	●	19
Ringer tone <sup>*2</sup> (Cellular line 1)	[6][2][9]→ [1]	[1]–[3]: Tone 1–<3>	–	–
Ringer tone <sup>*2</sup> (Cellular line 2)	[6][2][9]→ [2]	[4]–[7]: Melody 1–4	–	–
Ringer volume <sup>*3</sup> (Cellular line 1)	[6][2][8]→ [1]	[1]: Low [2]: Medium [3]: <High> [0]: Off	–	–
Ringer volume <sup>*3</sup> (Cellular line 2)	[6][2][8]→ [2]		–	–
Select HS (ring)	[6][2][7]	–	●	19

\*1 If “System setting” column is checked, you do not need to program the same item using another handset.

\*2 If you select one of the melody ringer tones, the ringer tone will continue to play for several seconds even if the caller has already hung up. You may either hear a dial tone or no one on the line when you answer the call.

\*3 When the ringer volume is set to off for a cellular line, “**Ringer off**” is not displayed in standby mode.

## Programming

### For landline (KX-TH1211/KX-TH1212)

Feature	Feature code	Setting code	System setting <sup>*1</sup>	Page
Caller ID edit (Caller ID number auto edit)	[2][1][4]	[1]: <On> [0]: Off	●	39
Message alert	[3][4][0]	[1]: <On> [0]: Off	–	42
Ringer tone <sup>*2, *3</sup>	[1][6][1]	[1]–[3]: Tone <1>–3 [4]–[7]: Melody 1–4	–	–
Ringer volume	[1][6][0]	[1]: Low [2]: Medium [3]: <High> [0]: Off	–	–
Set dial mode	[1][2][0]	[1]: Pulse [2]: <Tone>	●	16
Set flash time <sup>*4</sup>	[1][2][1]	[1]: <700ms> [2]: 600ms [3]: 400ms [4]: 300ms [5]: 250ms [6]: 110ms [7]: 100ms [8]: 90ms	●	22
Set line mode <sup>*5</sup>	[1][2][2]	[1]: A [2]: <B>	●	–
Store VM access#	[3][3][1]	–	●	41
Time adjustment <sup>*6</sup> (Caller ID subscribers only)	[2][2][6]	[1]: <Caller ID [auto]> [0]: Manual	●	–
V.M. access	[3][3][0]	–	–	42
VM tone detect	[3][3][2]	[1]: <On> [0]: Off	●	41

\*1 If “System setting” column is checked, you do not need to program the same item using another handset.

\*2 If you subscribe to a distinctive ring service (such as IDENT-A-RING), select a tone (tone 1 to 3). If you select a melody, you cannot distinguish lines by their ringers.

\*3 If you select one of the melody ringer tones, the ringer tone will continue to play for several seconds even if the caller has already hung up. You may either hear a dial tone or no one on the line when you answer the call.

\*4 The flash time depends on your telephone exchange or host PBX. Contact your PBX supplier if necessary. The setting should stay at “700ms” unless pressing **[FLASH]** fails to pick up the waiting call.



## ***Programming***

\*5 Generally, the line mode setting should not be adjusted. If “Line in use” is not displayed when another phone connected to the same line is in use, you need to change the line mode to “A”.

\*6 This feature allows the unit to automatically adjust the date and time setting when caller information is received. To use this feature, set the date and time first.

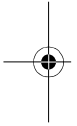



## Programming

### Special instructions for programmable settings

#### Block calls (Caller ID subscribers only)

This feature allows the unit to reject calls from specified phone numbers that you do not want to answer such as junk calls. You can store up to 20 phone numbers in the block call list by using the caller list or by entering the numbers directly. When a call is received, the unit rings for a short time while identifying the caller. If the phone number matches an entry in the block call list, the unit sends out a busy tone to the caller, then disconnects the call.

#### Important:

- You must store the phone number with an area code (10 digits) in the block call list.
- When the unit receives a call from a number that is stored in the block calls list:
  - while receiving the call, “**Caller blocked**” will be displayed and the number will not be displayed.
  - when the call is disconnected, the number is logged in the caller list (page 38) with .
- Depending on your cellular phone or cellular phone service, this feature may work differently. When a cellular call is received from a phone number in the block call list:
  - the call may be transferred to the voice mail service of your cellular phone.
  - the caller may not hear the busy tone before the call is disconnected.

#### Storing unwanted callers from the caller list

- 1 **[View CID]**
- 2 **[▼]/[▲]**: Select the item to be blocked. → **[Option]**
- 3 **[▼]/[▲]**: “**Edit & Save**” → **[Select]**
  - To edit the number, press **[Edit]** repeatedly until the phone number is shown in the 10-digit format.
- 4 **[Save]**
- 5 **[▼]/[▲]**: “**Block calls**” → **[Select]**
- 6 **[Yes]** → **[OFF]**

#### Storing unwanted callers by entering phone numbers

- 1 **[MENU]** → **[#][2][1][7]** → **[Add]**
- 2 Enter the phone number (32 digits max.).
  - To erase a digit, press **[Clear]**.
- 3 **[Save]** → **[OFF]**

#### Viewing/editing/erasing block call numbers

- 1 **[MENU]** → **[#][2][1][7]**
- 2 **[▼]/[▲]**: Select the desired item.
  - To exit, press **[OFF]**.
- 3 Proceed with the desired operation.
  - **Editing a number:**  
**[Edit]** → Edit the phone number. → **[Save]** → **[OFF]**
  - **Erasing a number:**  
**[Erase]** → **[Yes]** → **[OFF]**

#### Note:

- When editing, press the desired dial key to add a digit, **[Clear]** to erase.

## Programming

### Night mode

Night mode allows you to select a span of time during which the handset will not ring for outside calls. This feature is useful for instances when you do not want to be disturbed, for example, while sleeping. Night mode can be set for each handset.

#### Important:

- Set the date and time beforehand (page 16).
- If you have set the alarm, the alarm sounds even if the night mode is turned on.

#### Setting the start and end time

- 1 **[MENU]** → **[#][2][3][7]**
- 2 Enter the desired hour and minute you wish to start this feature.
- 3 **[AM/PM]**: Select **"AM"** or **"PM"**. → **[v]**
- 4 Enter the desired hour and minute you wish to end this feature.
- 5 **[AM/PM]**: Select **"AM"** or **"PM"**.
- 6 **[Save]** → **[OFF]**

#### Note:

- To correct a digit, press **[▲]**, **[v]**, **[◀]**, or **[▶]** to move the cursor to the digit, then make the correction.

#### Turning night mode on/off

- 1 **[MENU]** → **[#][2][3][8]**
- 2 **[v]/[▲]**: Select **"On"** or **"Off"**. → **[Save]** → **[OFF]**

#### Note:

- When the night mode is turned on, **"Night mode"** is displayed during the selected period.

### Alarm

You can set one of 2 different alarm options (once or daily) at a time for each handset. An alarm sounds at the set time for 1 minute. The following alarm sounds are available:

- **"Tone & Melody"**: You can choose an alarm sound from 3 tones and 4 melodies.
- **"Voice"**: You can choose one of the 7 pre-recorded announcements:
  - "Good morning"
  - "It's time for dinner"
  - "It's time for lunch"
  - "It's time for the game"
  - "It's time for your meeting"
  - "It's time to pick up the children"
  - "Happy birthday"

The handset makes the selected announcement at the set time (**talking alarm clock**).

#### Important:

- Set the date and time beforehand (page 16).

- 1 **[MENU]** → **[#][7][2][0]**
- 2 **[v]/[▲]**: Select the desired alarm option. → **[Select]**

<b>Off</b>	Turns alarm off. Go to step 6.
<b>Once</b>	An alarm sounds once at the set time. Enter the desired month, date, and year.
<b>Daily</b>	An alarm sounds daily at the set time.

- 3 Set the desired time. → **[OK]**
- 4 **[v]/[▲]**: Select **"Tone & Melody"** or **"Voice"**. → **[Select]**
- 5 **[v]/[▲]**: Select the desired item. → **[Save]**

## Programming

- If you set a tone or melody, we recommend selecting a different one for outside calls.

### 6 [OFF]

#### Note:

- To stop the alarm, press any dial key or place the handset on the charger.
- When the handset is in use, the alarm will not sound until the handset is in standby mode.
- If the talking alarm clock is set at the same time for two or more handsets, the first handset makes the announcement, while the other handsets only sound the tone.
- If the other unit is in use at the set time, the handsets sound the tone instead of the selected announcement.
- If you select "Once", the setting changes to "Off" after the alarm sounds.
- KX-TH1201: The ringer volume for the alarm follows the higher volume level of 2 lines (page 30). When the ringer volume is set to off for both lines, the alarm sound is heard at a low level.
- KX-TH1211/KX-TH1212: The ringer volume for the alarm follows the volume level of the landline. When the ringer volume for the landline is set to off (page 31), the alarm sound is heard at a low level.

### Customer support

The handset can display the Internet address where you can download the operating instructions or get further information for this product by using your computer.

- 1 [MENU] → [∓][6][8][0]
- 2 [OFF]

### Cellular line mode

If you do not use the landline and only use cellular lines, we recommend setting the unit to the cellular line mode.

Once you set this mode:

- other than the soft key [Cell], [↶] or [↷] can be used.
- programmable settings for the landline are not displayed and become inapplicable (page 27, 31, 31).

- 1 [MENU] → [∓][1][5][7]
- 2 [OFF]

### When you use the landline again

Before connecting the telephone line to the base unit, perform the above setting again.

## Registering a unit

### Operating additional handsets

#### Additional handsets

Up to 6 handsets can be registered to the base unit.

#### Important:

- See page 6 for information on the available models.

### Registering a handset to a base unit

The supplied handset and base unit are pre-registered. If for some reason the handset is not registered to the base unit, register the handset.

- 1 Handset:  
[MENU] → [∓][1][3][0]
- 2 Base unit:

## Programming

Press and hold **[LOCATOR]** for 4 seconds.

- If all registered handsets start ringing, press the same button to stop. Then repeat this step.
- The next step should be completed within 90 seconds.

### 3 Handset:

Press **[OK]**, then wait until a long beep sounds.

### 4 [OFF]

#### Note:

- While registering, “**Base registering**” is displayed on all registered handsets.
- When you purchase an additional handset, refer to the additional handset’s installation manual for registration.

## Deregistering a handset

A handset can cancel its own registration (or the registration of another handset) that is stored in the base unit. This allows the handset to end its wireless connection with the system.

- 1 **[MENU]** → **[#][1][3][1]**
- 2 **[3][3][5]** → **[OK]**
- 3 Select the handset you want to cancel by pressing the desired handset number.

## Caller ID Service

### Using Caller ID service

#### Important:

- This unit is Caller ID compatible. To use Caller ID features, you must subscribe to Caller ID service. Contact your service provider/telephone company for details.

#### Caller ID features

When an outside call is being received, the phone number is displayed.

- KX-TH1211/KX-TH1212: For landline calls, the caller's name is also displayed.

Caller information for the last 50 callers is logged in the caller list from the most recent call to the oldest.

- KX-TH1211/KX-TH1212: If the unit cannot receive caller information from landline calls, the following is displayed:
  - “**Out of area**”: The caller dialed from an area which does not provide Caller ID service.
  - “**Private caller**”: The caller requested not to send caller information.
  - “**Long distance**”: The caller made a long distance call.
- KX-TH1211/KX-TH1212: If the unit is connected to a PBX system, caller information may not be received properly. Contact your PBX supplier.

#### Missed calls

If a call is not answered, the unit treats the call as a missed call. The display shows “**Missed call**”. This lets you know if you should view the caller list to see who called while you were away.

#### Phonebook name display

When caller information is received and it matches a phone number stored in the phonebook, the stored name in the phonebook is displayed and logged in the caller list.

#### Talking Caller ID

This feature lets you know who is calling without looking at the display.

To use this feature, you must:

- subscribe to Caller ID service of your service provider/telephone company.
- turn this feature on (page 29).

When caller information is received, the handsets announce the caller's name or phone number received from your service provider/telephone company following every ring. The unit announces in English only.

- Name pronunciation may vary. This feature may not pronounce all names correctly.
- Caller ID service has a limit of how many characters can be displayed. If the caller's name is too long, the handset may not be able to display or announce the entire name.
- The announcement is heard at the same level as the ringer volume (page 30, 31).
- When you receive a call while on the phone, the 2nd caller's information is not announced even if you subscribe to both Caller ID and Call Waiting with Caller ID services.

#### Phonebook name announcement

When caller information is received and it matches a phone number stored in the phonebook, the stored name in the phonebook is announced.

## Caller ID Service

### Ringer ID

This feature can help you identify who is calling by using different ringers for different callers stored in the phonebook. You can assign a different ringer to each phonebook entry. When a call is received from a caller stored in the phonebook, the assigned ringer rings after the caller information is displayed. If you select "No Ringer ID" (default), the handset uses the ringer tone you selected on page 30 when a call is received from that caller.

- 1 Find the desired item (page 24). → **[Option]**
- 2 **[▼]/[▲]**: "Ringer ID" → **[Select]**
- 3 **[▼]/[▲]**: Select the desired setting.
- 4 **[Save]** → **[OFF]**

#### Note:

- When you assign the ringer ID to an entry in the shared phonebook using one handset, it is applied for all handsets.

### Caller list

#### Important:

- Only 1 person can access the caller list at a time.

#### Viewing the caller list and calling back

##### ■ Using a cellular line

- 1 **[View CID]**
- 2 Press **[▼]** to search from the most recent call, or **[▲]** to search from the oldest call.
- 3 To call back:  
**KX-TH1201**: **[↶]/[Cell]**  
**KX-TH1211/KX-TH1212**: **[Cell]**
  - When only 1 cellular phone is registered, the unit starts dialing.

OR

To exit, press **[OFF]**.

- 4 When 2 cellular phones are registered:  
**[▼]/[▲]**: Select the desired cellular phone. → **[Select]**

##### ■ Using the landline (KX-TH1211/KX-TH1212)

- 1 **[View CID]**
- 2 Press **[▼]** to search from the most recent call, or **[▲]** to search from the oldest call.
- 3 To call back, press **[↶]**.  
To exit, press **[OFF]**.

#### Note:

- If the item has already been viewed or answered, ✓ is displayed, even if it was viewed or answered using another handset.
- **[Cell]** indicates the caller information was received from the cellular line.

## Caller ID Service

### Editing a caller's phone number before calling back

You can edit a phone number in the caller list by removing its area code and/or the long distance code "1".

- 1 **[View CID]**
- 2 **[v]/[▲]**: Select the desired entry.  
→ **[Option]**
- 3 **[v]/[▲]**: "Edit & Call" → **[Select]**
- 4 Press **[Edit]** repeatedly until the phone number is shown in the desired format.

- ① Local phone number

**Example:**

321-5555

- ② Area code – Local phone number

**Example:**

555-321-5555

- ③ 1 – Area code – Local phone number

**Example:**

1-555-321-5555

#### 5 ■ Using a cellular line:

To dial the phone number, follow steps 3 and 4, "Viewing the caller list and calling back", page 38.

#### ■ Using the landline (KX-TH1211/KX-TH1212):

To dial the phone number, press **[↶]**.

### Caller ID number auto edit feature

#### Available for:

KX-TH1211/KX-TH1212

Once you call back an edited number, the unit remembers the Area Code and Format of the Edited Number. Next time when someone calls from the same Area Code, caller information is customized by the unit as follows:

- When the call is being received, the Caller ID number is displayed in the same Format as the Edited Number.
- After the call is ended, the phone number of the caller, when reviewed from the Caller list, is displayed in the same Format as the Edited Number.

For example, you can use this feature to set the unit to ignore the area code of callers in your area code, so that you can call these local numbers using caller information without dialing the area code.

To activate this feature, you must edit an item in the caller list, then call that number. After that, phone numbers from that caller's area code are edited automatically.

This feature can be turned on or off (page 31).

#### Note:

- Phone numbers from the 4 most recently edited area codes are automatically edited.
- If you move to another area, you can turn this feature off to erase previously edited area codes. To use this feature again, turn it on and reprogram the area codes you want to edit once again.

## Caller ID Service

### Erasing selected caller information

- 1 [View CID]
- 2 [▼]/[▲]: Select the desired entry.  
→ [Option]
- 3 [▼]/[▲]: "Erase" → [Select]
- 4 [Yes] → [OFF]

### Erasing all caller information

- 1 [View CID]
- 2 [All erase] → [Yes]

### Storing caller information into the phonebook

- 1 [View CID]
- 2 [▼]/[▲]: Select the desired entry.  
→ [Option]
- 3 [▼]/[▲]: "Edit & Save" → [Select]
  - To edit the number, press [Edit] repeatedly until the phone number is shown in the desired format.
- 4 [Save]
- 5 [▼]/[▲]: "Phonebook" → [Select]
  - If there is name information for the caller, go to step 7.
- 6 Enter the name (16 characters max.; page 24). → [Next] → [Save]
- 7 [OFF]



## Voice mail service for landline

**Available for:**  
KX-TH1211/KX-TH1212

Voice mail is an automatic answering service offered by your service provider/telephone company. After you subscribe to this service, your service provider/telephone company's voice mail system answers calls for you when you are unavailable to answer the phone or when your line is busy. Messages are recorded by your service provider/telephone company, not your telephone. Please contact your service provider/telephone company for details of this service.

### Storing the voice mail (VM) access number

In order to listen to your voice mail messages, you must dial your service provider/telephone company's voice mail access number. Once you have stored your voice mail access number, you can dial it automatically (page 42).

- 1 **[MENU]** → **[#][3][3][1]**
- 2 Enter your access number (32 digits max.). → **[Save]** → **[OFF]**

**Note:**

- When storing your voice mail access number and your mailbox password, press **[PAUSE]** to add pauses (page 21) between the access number and the password as necessary. Contact your service provider/telephone company for the required pause time.

### Voice Mail Service for Landline

**Example:**

1-222-333-4444	PPPP	8888
VM access number	Pauses	Password

### To erase the voice mail access number

- 1 **[MENU]** → **[#][3][3][1]**
- 2 Press and hold **[Clear]** until all digits are erased. → **[Save]** → **[OFF]**

### Voice mail (VM) tone detection

Your service provider/telephone company sends special signals (sometimes called "voice mail tones" or "stutter tones") to the unit to let you know you have new voice mail messages. If you hear a series of dial tones followed by a continuous dial tone after you press **[↶]**, you have new voice mail messages. Minutes after you hang up a call or after the phone stops ringing, your unit checks the phone line to see if new voice mail messages have been recorded.

Turn this feature off when:

- You do not subscribe to voice mail service.
- Your service provider/telephone company does not send voice mail tones.
- Your phone is connected to a PBX.

If you are not sure which setting is required, contact your service provider/telephone company.

### Turning VM tone detection on/off

The default setting is "On".

- 1 **[MENU]** → **[#][3][3][2]**
- 2 **[▼]/[▲]**: Select the desired setting. → **[Save]** → **[OFF]**

## Voice Mail Service for Landline

### Listening to voice mail messages

The unit lets you know that you have new voice mail messages in the following ways:

- “**New Voice Mail**” is displayed on the handset.
- The message indicator on the handset flashes slowly if message alert feature is turned on (“Message alert”; page 42).

- 1 Press [**⏏**], then press [**VM**] within 15 seconds.  
OR  
[**MENU**] → [**#**][**3**][**3**][**0**]
  - The speakerphone turns on.
- 2 Follow the pre-recorded instructions.
- 3 When finished, press [**OFF**].

#### Note:

- If [**VM**] is not displayed, the voice mail access number has not been stored. Store the number (page 41).
- If the handset still indicates there are new messages even after you have listened to all new messages, turn it off by pressing and holding [**OFF**] until the handset beeps.
- If your voice mail service uses voice mail tones and a message is over 3 minutes long, the handset may not indicate new messages.
- If your voice mail service uses voice mail tones, the tones are heard from any phone connected to the same line. If you want to use another phone to listen to voice mail messages, you have to dial your access number manually.

### Message alert

You can select whether or not the message indicator on the handset flashes slowly when there are new recorded messages in the voice mail system. The default setting is “On”.

- 1 [**MENU**] → [**#**][**3**][**4**][**0**]
- 2 [**▼**]/[**▲**]: Select the desired setting.  
→ [**Save**] → [**OFF**]

#### Note:

- While message alert is on, battery operating time is shortened (page 15).

## Intercom/Locator

### Intercom

Intercom calls can be made between handsets.

#### Note:

- If you receive an outside call while talking on the intercom, you hear 2 tones. To answer the call, press **[OFF]**, then press **[↶]**.
- When paging a unit for an intercom call, the paged unit beeps for 1 minute.

### Making an intercom call

- 1 **[INTERCOM]**
- 2 **[▼]/[▲]**: Select the desired unit. → **[Select]**
  - To stop paging, press **[OFF]**.
- 3 When you finish talking, press **[OFF]**.

### Answering an intercom call

- 1 Press **[↶]** to answer the page.
- 2 When you finish talking, press **[OFF]**.

#### Note:

- KX-TH1201: The ringer volume for intercom calls follows the higher volume level of 2 lines. When the ringer volume is set to off for both lines (page 30), the handset rings at a low level.
- KX-TH1211/KX-TH1212: The ringer volume for intercom calls follows the volume level of the landline. When the ringer volume for the landline is set to off (page 31), the handset rings at a low level.

### Transferring calls

Outside calls can be transferred between 2 handsets.

- 1 During an outside call, press **[INTERCOM]** to put the call on hold.
- 2 **[▼]/[▲]**: Select the desired unit. → **[Transfer]**
- 3 Wait for the paged party to answer.
  - If the paged party does not answer, press **[↶]** to return to the outside call.
- 4 **[OFF]**
  - The outside call is being routed to the handset.

### Answering transferred calls

Press **[↶]** to answer the page.

- After the paging party disconnects, you can talk to the outside caller.

### Conference calls on the landline

Available for:  
KX-TH1211/KX-TH1212

2 handsets can have a conference call with an outside party on the landline.

- 1 During an outside call, press **[INTERCOM]** to put the call on hold.
- 2 **[▼]/[▲]**: Select the desired unit. → **[Transfer]**
- 3 Wait for the paged party to answer.
  - If the paged party does not answer, press **[↶]** to return to the outside call.
- 4 **[Conf]**

## **Intercom/Locator**

- To leave the conference, press **[OFF]**. The other parties can continue the conversation.
- To put the outside call on hold, press **[HOLD]**. To resume the conference, press **[Conf]**.

### **Note:**

- Conference calls on a cellular line are not available.

---

## **Handset locator**

You can locate a misplaced handset by paging it.

- 1 Base unit:**  
**[LOCATOR]**
  - All registered handsets beep for 1 minute.
- 2 To stop paging:**  
**Base unit:**  
Press **[LOCATOR]**.  
**Handset:**  
Press **[OFF]**.

## Belt clip

You can hang the handset on your belt or pocket using the supplied belt clip.

### To attach the belt clip

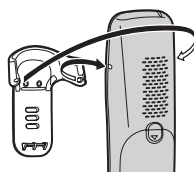

### To remove the belt clip



## Wall mounting

### Base unit

- KX-TH1201: The base unit does not have a telephone line jack.

- 1 Remove the base unit stand by pushing (1) and sliding down (2).

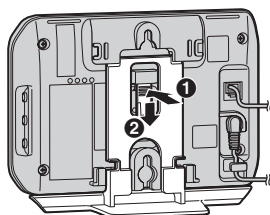

### Useful Information

- Model shown is KX-TH1211.
- 2 Tuck the telephone line cord and connect the cord. (KX-TH1211/ KX-TH1212)  
Mount the unit by inserting the mounting pins into the round openings on the unit (for pin B, use the round cut out at the bottom of the unit if you are using the 4 inch phone plate), then slide the unit down to secure it. Connect the AC adaptor to power outlet (page 12).
- There are 2 common types of wall phone plates. The distance between A and B may vary depending on the size of the wall phone plate installed.
  - Model shown is KX-TH1211.

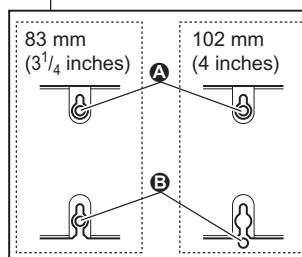
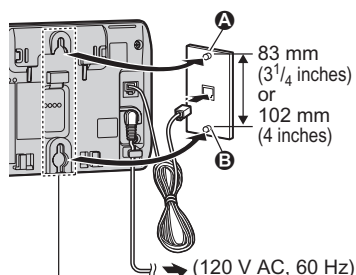

## Useful Information

- 3 KX-TH1211/KX-TH1212:**  
Put the telephone line cord into the gap between the wall and the base unit.

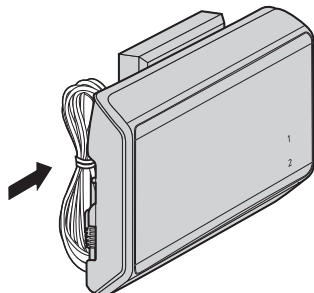

### To attach the base unit stand

Place the base unit stand by fitting the tab into the slot on the base unit. Then slide the stand until it clicks.

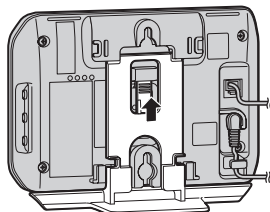

- Model shown is KX-TH1211.

## Charger

- 1** Drive the screws (not included) into the wall.

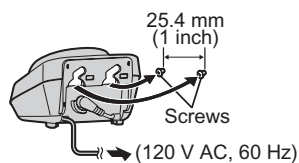

- 2** Mount the charger (1), then slide it down (2) and to the right (3) until it is secure.

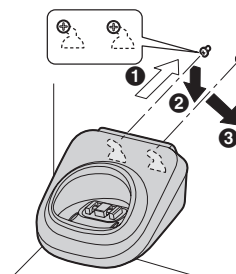

## Headset (optional)

Connecting a headset to the handset allows for hands-free conversations. We recommend using the Panasonic headset noted on page 6.

### Switching a call between the headset and handset speakerphone

To switch to the handset speakerphone, press [📞].

To return to the headset, press [🎧].

## Useful Information

### Error messages

If the unit detects a problem, one of the following messages is shown on the display.

Display message	Cause/solution
<b>Busy</b> or <b>System is busy. Please try again later.</b>	<ul style="list-style-type: none"> <li>• The called handset is in use.</li> <li>• Other units are in use and the system is busy. Try again later.</li> <li>• The handset you are using is too far from the base unit. Move closer and try again.</li> <li>• A line is being used by another handset. A cellular line and the landline cannot be used at a time.</li> <li>• You tried to join the outside call on the cellular line. Only an existing outside call on the landline can be joined.</li> <li>• The handset's registration may have been canceled. Re-register the handset (page 35).</li> </ul>
<b>Don't use this battery.</b>	<ul style="list-style-type: none"> <li>• A wrong type of batteries such as Alkaline or Manganese was inserted. Use only the rechargeable Ni-MH batteries noted on page 6, 13.</li> </ul>
<b>Error!!</b>	<ul style="list-style-type: none"> <li>• The handset's registration has failed. Move the handset and base unit away from all electrical appliances and try again.</li> </ul>
<b>Insert battery</b>	<ul style="list-style-type: none"> <li>• The handset was placed on the charger without batteries. Insert the batteries properly (page 13).</li> </ul>
<b>Invalid</b>	<ul style="list-style-type: none"> <li>• There is no handset registered to the base unit matching the handset number you entered.</li> <li>• The handset is not registered to the base unit. Register the handset (page 35).</li> <li>• No cellular phone is registered to the base unit. Register a cellular phone (page 17).</li> </ul>
<b>No link to base.</b> <b>Reconnect AC adaptor.</b>	<ul style="list-style-type: none"> <li>• The handset has lost communication with the base unit. Move closer to the base unit and try again.</li> <li>• Unplug the base unit's AC adaptor to reset the unit. Reconnect the adaptor and try again.</li> <li>• The handset's registration may have been canceled. Re-register the handset (page 35).</li> </ul>

## Useful Information

Display message	Cause/solution
Phonebook full	<ul style="list-style-type: none"><li>The phonebook memory is full. Erase unnecessary entries (page 25).</li></ul>
Store VM access# <sup>*1</sup>	<ul style="list-style-type: none"><li>You have not stored the voice mail access number. Store the number (page 41).</li></ul>

\*1 KX-TH1211/KX-TH1212



## Useful Information

### Troubleshooting

If you still have difficulties after following the instructions in this section, disconnect the base unit's AC adaptor, then reconnect the base unit's AC adaptor. Remove the batteries from the handset, and then insert the batteries into the handset again.

#### General use

Problem	Cause/solution
The unit does not work.	<ul style="list-style-type: none"><li>• Make sure the batteries are installed correctly (page 13).</li><li>• Fully charge the batteries (page 14).</li><li>• Check the connections (page 12).</li><li>• Unplug the base unit's AC adaptor to reset the unit. Reconnect the adaptor and try again.</li><li>• The handset has not been registered to the base unit. Register the handset (page 35).</li></ul>
I cannot register a cellular phone to the base unit.	<ul style="list-style-type: none"><li>• Depending on the compatibility of the cellular phone, you may not be able to register it to the base unit.</li><li>• Confirm that your cellular phone supports the hands-free profile (HFP) specification. If it does not, you cannot register it to the base unit.</li><li>• Confirm that the Bluetooth feature of your cellular phone is turned on. You may need to turn this feature on depending on your cellular phone.</li><li>• The Bluetooth technology on your cellular phone may not be functioning normally. Turn off and on your cellular phone.</li><li>• It may take more than 10 seconds to complete registration after you have performed all operations with the cellular phone. Wait until the LINK TO CELL indicator stops flashing and lights green.</li><li>• If your cellular phone is already connected to another Bluetooth device such as a Bluetooth headset, turn it off or disconnect it from your cellular phone.</li></ul>

## Useful Information

Problem	Cause/solution
I cannot connect a cellular phone to the base unit.	<ul style="list-style-type: none"><li>• Depending on the compatibility of your cellular phone, you may not be able to connect it to the base unit.</li><li>• Confirm that you have registered your cellular phone to the base unit using the cellular phone (page 35). Refer to the operating instructions of your cellular phone for registration.</li><li>• Confirm that your cellular phone is turned on.</li><li>• Confirm that the Bluetooth feature of your cellular phone is turned on. You may need to turn this feature on depending on your cellular phone.</li><li>• The Bluetooth technology on your cellular phone may not be functioning normally. Turn off and on your cellular phone.</li><li>• Confirm that your cellular phone is placed within the range of the base unit.</li><li>• Depending on the state of the wireless environment, such as the presence of any electrical interference, there may be a delay even if the auto connection feature is turned on. You can connect to the base unit manually (page 18).</li><li>• If your cellular phone is already connected to another Bluetooth device such as a Bluetooth headset, turn it off or disconnect it from your cellular phone.</li><li>• Depending on your cellular phone, you may be asked to accept the connection requirement from the base unit. Refer to the operating instructions of your cellular phone for further operations.</li></ul>

## Useful Information

Problem	Cause/solution
I cannot hear a dial tone.	<ul style="list-style-type: none"> <li>• Make sure the base unit's AC adaptor is connected properly (page 12).</li> <li>• Make sure that the LINK TO CELL indicator lights green and the cellular phone is connected to the base unit (page 18).</li> <li>• Make sure the telephone line cord is connected properly (page 12).<sup>*1</sup></li> <li>• If you are using a splitter to connect the unit, remove the splitter and connect the unit to the wall jack directly. If the unit operates properly, check the splitter.<sup>*1</sup></li> <li>• Disconnect the base unit from the telephone line and connect the line to a known working telephone. If the working telephone operates properly, contact our service personnel to have the unit repaired. If the working telephone does not operate properly, contact your service provider/telephone company.<sup>*1</sup></li> </ul>
The indicator on the handset flashes slowly.	<ul style="list-style-type: none"> <li>• New voice mail messages have been recorded. Listen to the new voice mail messages (page 42).<sup>*1</sup></li> </ul>

<sup>\*1</sup> KX-TH1211/KX-TH1212

## Programmable settings

Problem	Cause/solution
I have changed the display language to a language I cannot read.	<ul style="list-style-type: none"> <li>• Change the display language (page 16).</li> </ul>
While programming, the handset starts to ring.	<ul style="list-style-type: none"> <li>• A call is being received. Answer the call and start again after hanging up.</li> </ul>
I cannot register a handset to a base unit.	<ul style="list-style-type: none"> <li>• The maximum number of handsets (6) is already registered to the base unit. Cancel unused handset registrations from the base unit (page 36).</li> <li>• Place the handset and the base unit away from other electrical appliances.</li> </ul>

## Battery recharge

Problem	Cause/solution
The handset beeps and/or  flashes.	<ul style="list-style-type: none"> <li>• Battery charge is low. Fully charge the batteries (page 14).</li> </ul>

For assistance, please visit <http://www.panasonic.com/help>

## Useful Information

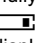
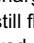
Problem	Cause/solution
I fully charged the batteries, but  still flashes or  is displayed.	<ul style="list-style-type: none"> <li>• Clean the charge contacts and charge again (page 14).</li> <li>• It is time to replace the batteries (page 13).</li> </ul>
I fully charged the batteries, but the operating time seems to be shorter.	<ul style="list-style-type: none"> <li>• Clean the battery ends (+, -) and the charge contacts with a dry cloth, and charge again.</li> </ul>

## Making/answering calls, intercom

Problem	Cause/solution
Noise is heard, sound cuts in and out.	<ul style="list-style-type: none"> <li>• You are using the handset or base unit in an area with high electrical interference. Place the base unit and use the handset away from sources of interference.</li> <li>• Move closer to the base unit.</li> <li>• If you use a DSL/ADSL service, we recommend connecting a DSL/ADSL filter between the base unit and the telephone line jack. Contact your DSL/ADSL provider for details.*1</li> </ul>
I cannot make local calls with the handset using a cellular line.	<ul style="list-style-type: none"> <li>• You need to add your area code when making cellular calls. Store your area code in order to automatically add it to the beginning of the 7-digit phone number when making cellular calls (page 18).</li> </ul>
I cannot make and answer cellular calls with the handset.	<ul style="list-style-type: none"> <li>• Depending on the cellular phone's compatibility, you may not be able to make or answer cellular calls even if the cellular phone is connected to the base unit.</li> <li>• Confirm that your cellular phone is turned on.</li> <li>• Confirm that your cellular phone is connected to the base unit (page 11).</li> <li>• Confirm that your cellular phone is placed within the range of the base unit.</li> <li>• If someone is talking on a cellular call or customizing the cellular settings, you cannot use the cellular feature. There can be only one active Bluetooth connection at a time.</li> <li>• The cellular phone is being used separately from your system.</li> </ul>

## Useful Information

Problem	Cause/solution
I can make or answer cellular calls but cannot hear a sound.	<ul style="list-style-type: none"><li>• The Bluetooth technology on your cellular phone may not be functioning normally. Turn off and on your cellular phone.</li><li>• Disconnect and connect the base unit AC adaptor and try again.</li></ul>
I cannot switch cellular calls from the handset to the cellular phone.	<ul style="list-style-type: none"><li>• Your cellular phone may not support this feature. Refer to the operating instructions of your cellular phone.</li></ul>
The handset does not ring.	<ul style="list-style-type: none"><li>• The ringer volume is turned off. Adjust the ringer volume (page 30, 31).</li><li>• Night mode is turned on. Turn it off (page 34).</li></ul>
I cannot make a call.	<ul style="list-style-type: none"><li>• The dialing mode may be set incorrectly. Change the setting (page 16).<sup>*1</sup></li><li>• The handset is too far from the base unit. Move closer and try again.</li><li>• The registered cellular phone has been disconnected from the base unit. Reconnect the cellular phone (page 18).</li><li>• A line is in use. Only 1 line can be used at a time.</li></ul>
I cannot make long distance calls. <sup>*1</sup>	<ul style="list-style-type: none"><li>• Make sure that you have long distance service.</li></ul>

\*1 KX-TH1211/KX-TH1212

## Useful Information

### Caller ID/Talking Caller ID

Problem	Cause/solution
Caller information is not displayed.	<ul style="list-style-type: none"> <li>You need to subscribe to Caller ID service. Contact your service provider/telephone company for details.</li> <li>If your unit is connected to any additional telephone equipment such as a Caller ID box or cordless telephone line jack, plug the unit directly into the wall jack.*1</li> <li>If you use a DSL/ADSL service, we recommend connecting a DSL/ADSL filter between the base unit and the telephone line jack. Contact your DSL/ADSL provider for details.*1</li> <li>The name display service for landline calls may not be available in some areas. Contact your service provider/telephone company for details.*1</li> <li>Other telephone equipment may be interfering with this unit. Disconnect the other equipment and try again.</li> </ul>
Caller information is displayed or announced late.	<ul style="list-style-type: none"> <li>Depending on your service provider/telephone company, the unit may display or announce the caller's information at 2nd ring or later.</li> <li>Move closer to the base unit.</li> </ul>
Caller information is not announced.	<ul style="list-style-type: none"> <li>The handset ringer volume is turned off. Adjust it (page 30, 31).</li> <li>The Talking Caller ID feature is turned off. Turn it on (page 29).</li> </ul>
The caller list/incoming phone numbers are not edited automatically.*1	<ul style="list-style-type: none"> <li>The Caller ID number auto edit feature is turned off. Turn it on and try again (page 31).</li> <li>You need to call back the edited number to activate Caller ID number auto edit.</li> </ul>
I cannot dial the phone number edited in the caller list.*1	<ul style="list-style-type: none"> <li>The phone number you dialed might have been edited incorrectly (for example, the long distance "1" or the area code is missing). Edit the phone number with another pattern (page 39).</li> </ul>
Time on the unit is shifted.*1	<ul style="list-style-type: none"> <li>Incorrect time information from incoming Caller ID changes the time. Set the time adjustment to off (page 31).</li> </ul>

## Useful Information

Problem	Cause/solution
The 2nd caller's information is not displayed during an outside call.	<ul style="list-style-type: none"><li>In order to use Caller ID, call waiting, or Call Waiting Caller ID (CWID), you must first contact your service provider/telephone company and subscribe to the desired service. After subscribing, you may need to contact your service provider/telephone company again to activate this specific service, even if you already subscribed to both Caller ID and Call Waiting with Caller ID services (CWID).</li></ul>

\*1 KX-TH1211/KX-TH1212

## Liquid damage

Problem	Cause/solution
Liquid or other form of moisture has entered the handset/base unit.	<ul style="list-style-type: none"><li>Disconnect the AC adaptor and telephone line cord from the base unit. Remove the batteries from the handset and leave to dry for at least 3 days. After the handset/base unit are completely dry, reconnect the AC adaptor and telephone line cord. Insert the batteries and charge fully before use.</li></ul>

### Caution:

- To avoid permanent damage, do not use a microwave oven to speed up the drying process.

## PIN for cellular phone registration

Problem	Cause/solution
I cannot remember the PIN.	<ul style="list-style-type: none"><li>Change the PIN using the following method. <b>1</b> [MENU] → [≡][1][3][2] <b>2</b> [*][7][0][0][0] <b>3</b> Enter the new 4-digit PIN. → [Save] → [OFF]</li></ul>

## Useful Information

### FCC and other information

This equipment is hearing aid compatible as defined by the FCC in 47 CFR Section 68.316.

When you hold the phone to your ear, noise might be heard in your Hearing Aid. Some Hearing Aids are not adequately shielded from external RF (radio frequency) energy. If noise occurs, use an optional headset accessory or the speakerphone option (if applicable) when using this phone. Consult with your audiologist or Hearing Aid manufacturer about the availability of Hearing Aids which provide adequate shielding to RF energy commonly emitted by digital devices.

This device complies with Part 15 of the FCC Rules. Operation is subject to the following two conditions:  
(1) This device may not cause harmful interference, and (2) this device must accept any interference received, including interference that may cause undesired operation.

Privacy of communications may not be ensured when using this phone.

#### **CAUTION:**

Any changes or modifications not expressly approved by the party responsible for compliance could void the user's authority to operate this device.

#### **NOTE:**

This equipment has been tested and found to comply with the limits for a Class B digital device, pursuant to Part 15 of the FCC Rules. These limits are designed to provide reasonable

protection against harmful interference in a residential installation. This equipment generates, uses, and can radiate radio frequency energy and, if not installed and used in accordance with the instructions, may cause harmful interference to radio communications. However, there is no guarantee that interference will not occur in a particular installation. If this equipment does cause harmful interference to radio or television reception, which can be determined by turning the equipment off and on, the user is encouraged to try to correct the interference by one or more of the following measures:

- Reorient or relocate the receiving antenna.
- Increase the separation between the equipment and receiver.
- Connect the equipment into an outlet on a circuit different from that to which the receiver is connected.
- Consult the dealer or an experienced radio/TV technician for help.

Some cordless telephones operate at frequencies that may cause interference to nearby TVs and VCRs. To minimize or prevent such interference, the base of the cordless telephone should not be placed near or on top of a TV or VCR. If interference is experienced, move the cordless telephone further away from the TV or VCR. This will often reduce, or eliminate, interference.



## Useful Information

### FCC RF Exposure Warning:

- This product complies with FCC radiation exposure limits set forth for an uncontrolled environment.
- To comply with FCC RF exposure requirements, the base unit must be installed and operated 20 cm (8 inches) or more between the product and all person's body (excluding extremities of hands, wrist and feet).
- This product may not be collocated or operated in conjunction with any other antenna or transmitter.
- The handset may be carried and operated with only the specific provided belt-clip. Other non-tested belt-clips or similar body-worn accessories may not comply and must be avoided.

### Notice

- FCC ID can be found inside the battery compartment or on the back of the units.

### KX-TH1211/KX-TH1212

This equipment complies with Part 68 of the FCC rules and the requirements adopted by the ACTA. On the bottom of this equipment is a label that contains, among other information, a product identifier in the format US:ACJ-----.

If requested, this number must be provided to the telephone company.

- Registration No.....(found on the back of the unit)
- Ringer Equivalence No. (REN)..... 0.1B

A plug and jack used to connect this equipment to the premises wiring and telephone network must comply with the applicable FCC Part 68 rules and requirements adopted by the ACTA. A compliant telephone cord and modular plug is provided with the product. It is designed to be connected to a compatible modular jack that is also compliant.

The REN is used to determine the number of devices that may be connected to a telephone line. Excessive RENs on a telephone line may result in the devices not ringing in response to an incoming call. In most but not all areas, the sum of RENs should not exceed five (5.0). To be certain of the number of devices that may be connected to a line, as determined by the total RENs, contact the local telephone company. For products approved after July 23, 2001, the REN for the product is part of the product identifier that has the format US:AAAEQ##TXXXX. The digits represented by ## are the REN without a decimal point (e.g., 03 is a REN of 0.3).

If this equipment causes harm to the telephone network, the telephone company will notify you in advance that temporary discontinuance of service may be required. But if advance notice isn't practical, the telephone company will notify the customer as soon as possible. Also, you will be advised of your right to file a complaint with the FCC if you believe it is necessary.

## Useful Information

The telephone company may make changes in its facilities, equipment, operations or procedures that could affect the operation of the equipment. If this happens the telephone company will provide advance notice in order for you to make necessary modifications to maintain uninterrupted service.

If trouble is experienced with this equipment, for repair or warranty information, please contact a Factory Service Center or other Authorized Servicer. If the equipment is causing harm to the telephone network, the telephone company may request that you disconnect the equipment until the problem is resolved.

Connection to party line service is subject to state tariffs. Contact the state public utility commission, public service commission or corporation commission for information.

If your home has specially wired alarm equipment connected to the telephone line, ensure the installation of this equipment does not disable your alarm equipment. If you have questions about what will disable alarm equipment, consult your telephone company or a qualified installer.

### WHEN PROGRAMMING EMERGENCY NUMBERS AND/OR MAKING TEST CALLS TO EMERGENCY NUMBERS:

- 1) Remain on the line and briefly explain to the dispatcher the reason for the call.
- 2) Perform such activities in the off-peak hours, such as early morning or late evenings.

## Notice

- This product is designed for use in the United States of America. Sale or use of this product in other countries may violate local laws.
- Cet appareil est conçu pour être utilisé aux États-Unis d'Amérique. La vente ou l'emploi de cet appareil dans certains autres pays peut constituer une infraction à la législation locale.
- Este producto está diseñado para usarse en los Estados Unidos de América. La venta o el empleo de este producto en ciertos países puede constituir violación de la legislación local.
- 本產品專為美國使用而設。若在其他國家銷售或使用，可能會違反當地法例。
- この製品は、日本国外での使用を目的として設計されており、日本国内での使用は法律違反となります。従って、当社では日本国内においては原則として修理などのサービスは致しかねます。

## ENERGY STAR

As an ENERGY STAR® Participant, Panasonic has determined that this product meets the ENERGY STAR guidelines for energy efficiency. ENERGY STAR is a U.S. registered mark.



## Specifications

- **Standard:**  
DECT 6.0 (Digital Enhanced Cordless Telecommunications 6.0)  
Bluetooth wireless technology 1.2
- **Number of channels:**  
60 Duplex Channels (DECT 6.0)  
79 Duplex Channels (Bluetooth)
- **Frequency range:**  
1.92 GHz to 1.93 GHz (DECT 6.0)  
2.402 GHz to 2.48 GHz (Bluetooth)
- **Duplex procedure:**  
TDMA (Time Division Multiple Access)
- **Channel spacing:**  
1.728 MHz (DECT 6.0)  
1.0 MHz (Bluetooth)
- **Bit rate:**  
1.152 Mbit/s (DECT 6.0)  
1.0 Mbit/s (Bluetooth)
- **Modulation:**  
GFSK (Gaussian Frequency Shift Keying)
- **RF transmission power:**  
100 mW (max.)
- **Voice coding:**  
ADPCM 32 kbit/s (DECT 6.0)  
CVSD/PCM 64 kbit/s (Bluetooth)
- **Power source:**  
120 V AC, 60 Hz
- **Power consumption:**  
**Base unit:**  
Standby: Approx. 3.3 W  
Maximum: Approx. 5.5 W  
**Charger:**  
Standby: Approx. 0.3 W  
Maximum: Approx. 2.9 W
- **Operating conditions:**  
5 °C – 40 °C (41 °F – 104 °F), 20 % – 80 % relative air humidity (dry)
- **Dimensions:**  
**Base unit**

## Useful Information

- Approx. 135 mm × 178 mm × 75 mm  
(xx inches × xx inches × xx inches)
- Handset:** Approx. 155 mm × 48 mm × 33 mm  
(6 <sup>3</sup>/<sub>32</sub> inches × 1 <sup>7</sup>/<sub>8</sub> inches × 1 <sup>5</sup>/<sub>16</sub> inches)
- Charger:** Approx. 51 mm × 75 mm × 88 mm  
(2 inches × 2 <sup>15</sup>/<sub>16</sub> inches × 3 <sup>15</sup>/<sub>32</sub> inches)
- **Mass (weight):**  
**Base unit**  
KX-TH1201: Approx. 283 g (xx lb.)  
KX-TH1211/KX-TH1212: Approx. 285 g (xx lb.)  
**Handset:** Approx. 130 g (0.29 lb.)  
**Charger:** Approx. 60 g (0.13 lb.)

### Note:

- Design and specifications are subject to change without notice.
- The illustrations in these instructions may vary slightly from the actual product.

### Trademarks

- The Bluetooth word mark and logos are owned by the Bluetooth SIG, Inc. and any use of such marks by Panasonic is under license. Other trademarks and trade names are those of their respective owners.

**Useful Information**

**Customer services**

**Customer Services Directory**

Obtain Product Information and Operating Assistance; locate your nearest Dealer or Service Center; purchase Parts and Accessories; or make Customer Service and Literature requests by visiting our Web Site at:

**<http://www.panasonic.com/help>**

or, contact us via the web at:

**<http://www.panasonic.com/contactinfo>**

You may also contact us directly at: 1-800-211-PANA (1-800-211-7262), Monday - Friday 9 am to 9 pm; Saturday - Sunday 10 am to 7 pm, EST.

TTY users (hearing or speech impaired users) can call 1-877-833-8855.

**Accessory Purchases**

Purchase Parts, Accessories and Instruction Books online for all Panasonic Products by visiting our Web Site at:

**<http://www.pstc.panasonic.com>**

or, send your request by E-mail to:

**[npcparts@us.panasonic.com](mailto:npcparts@us.panasonic.com)**

You may also contact us directly at:

1-800-332-5368 (Phone) 1-800-237-9080 (Fax Only)

(Monday - Friday 9 am to 9 pm, EST.)

Panasonic Service and Technology Company

20421 84th Avenue South, Kent, WA 98032

(We Accept Visa, MasterCard, Discover Card, American Express, and Personal Checks.)

TTY users (hearing or speech impaired users) can call 1-866-605-1277.

**Service in Puerto Rico**

Panasonic Puerto Rico, Inc.

San Gabriel Industrial Park, Ave. 65 de Infantería, Km. 9.5,

Carolina, Puerto Rico 00985

Phone (787)750-4300, Fax (787)768-2910

Useful Information

Warranty

PANASONIC CONSUMER ELECTRONICS COMPANY, DIVISION OF PANASONIC CORPORATION OF NORTH AMERICA One Panasonic Way, Secaucus, New Jersey 07094

PANASONIC PUERTO RICO, INC. San Gabriel Industrial Park, Ave. 65 de Infanteria, Km. 9.5, Carolina, Puerto Rico 00985

Panasonic Telephone Products Limited Warranty

Limited Warranty Coverage

If your product does not work properly because of a defect in materials or workmanship, Panasonic Consumer Electronics Company or Panasonic Puerto Rico, Inc. (collectively referred to as "the warrantor") will, for the length of the period indicated on the chart below, which starts with the date of original purchase ("Limited Warranty period"), at its option either (a) repair your product with new or refurbished parts, or (b) replace it with a new or a refurbished product. The decision to repair or replace will be made by the warrantor.

Table with 2 columns: Parts, Labor. Both have a duration of One (1) Year.

During the "Labor" Limited Warranty period there will be no charge for labor. During the "Parts" Limited Warranty period, there will be no charge for parts. You must mail-in your product prepaid during the Limited Warranty period. This Limited Warranty excludes both parts and labor for batteries, antennas, and cosmetic parts (cabinet). This Limited Warranty only applies to products purchased and serviced in the United States or Puerto Rico. This Limited Warranty is extended only to the original purchaser and only covers products purchased as new.

Ship-In Service

For assistance in the continental U.S.A. in obtaining repairs please ship the product prepaid to: PSTC (Panasonic) Exchange Center, 4900 George McVay Drive, Suite B Door #12, McAllen, TX 78503 panacare@us.panasonic.com

When shipping the unit carefully pack in a padded shipping carton, include all accessories, and send it prepaid. Include a letter detailing the complaint, a return address and provide a day time phone number where you can be reached. P.O. Boxes are not acceptable. Keep the tracking number for your records. A copy of valid registered receipt is required under the 1 year parts and labor Limited Warranty.

## **Useful Information**

**IF REPAIR IS NEEDED DURING THE LIMITED WARRANTY PERIOD THE PURCHASER WILL BE REQUIRED TO FURNISH A SALES RECEIPT/PROOF OF PURCHASE INDICATING DATE OF PURCHASE, AMOUNT PAID AND PLACE OF PURCHASE. CUSTOMER WILL BE CHARGED FOR THE REPAIR OF ANY UNIT RECEIVED WITHOUT SUCH PROOF OF PURCHASE.**

### **Limited Warranty Limits And Exclusions**

This Limited Warranty ONLY COVERS failures due to defects in materials or workmanship, and DOES NOT COVER normal wear and tear or cosmetic damage. The Limited Warranty ALSO DOES NOT COVER damages which occurred in shipment, or failures which are caused by products not supplied by the warrantor, or failures which result from accidents, misuse, abuse, neglect, bug infestation, mishandling, misapplication, alteration, faulty installation, set-up adjustments, misadjustment of consumer controls, improper maintenance, power line surge, lightning damage, modification, introduction of sand, humidity or liquids, commercial use such as hotel, office, restaurant, or other business or rental use of the product, or service by anyone other than a Factory Service Center or other Authorized Servicer, or damage that is attributable to acts of God.

**THERE ARE NO EXPRESS WARRANTIES EXCEPT AS LISTED UNDER "LIMITED WARRANTY COVERAGE". THE WARRANTOR IS NOT LIABLE FOR INCIDENTAL OR CONSEQUENTIAL DAMAGES RESULTING FROM THE USE OF THIS PRODUCT, OR ARISING OUT OF ANY BREACH OF THIS LIMITED WARRANTY.** (As examples, this excludes damages for lost time, lost calls or messages, cost of having someone remove or re-install an installed unit if applicable, travel to and from the servicer. The items listed are not exclusive, but are for illustration only.) **ALL EXPRESS AND IMPLIED WARRANTIES, INCLUDING THE WARRANTY OF MERCHANTABILITY, ARE LIMITED TO THE PERIOD OF THE LIMITED WARRANTY.**

Some states do not allow the exclusion or limitation of incidental or consequential damages, or limitations on how long an implied warranty lasts, so the exclusions may not apply to you.

This Limited Warranty gives you specific legal rights and you may also have other rights which vary from state to state. If a problem with this product develops during or after the Limited Warranty period, you may contact your dealer or Service Center. If the problem is not handled to your satisfaction, then write to the warrantor's Consumer Affairs Department at the addresses listed for the warrantor.

**PARTS AND SERVICE, WHICH ARE NOT COVERED BY THIS LIMITED WARRANTY, ARE YOUR RESPONSIBILITY.**

## Index

- A** Additional handset: 35  
Alarm: 34  
Answering calls: 22  
Area code: 18  
Auto talk: 22
- B** Battery: 13, 14  
Belt clip: 45  
Block calls: 33  
Bluetooth wireless technology: 17  
Booster (Clarity booster): 23
- C** Caller ID number auto edit: 39  
Caller ID service: 37  
Caller list: 38  
Caller list edit: 39  
Call share: 23  
Call waiting: 23  
Call Waiting Caller ID: 23  
Cellular phone
  - Deregistration: 19
  - Registration: 17Chain dial: 25  
CID (Caller ID): 38  
Conference calls: 43  
Connection (Link to cell): 18  
Customer support: 35
- D** Date and time: 16  
Dialing mode: 16  
Direct commands: 29  
Discoverable mode: 19  
Display
  - Contrast: 29
  - Language: 16
- E** Error messages: 47
- F** Flash: 22, 28
- H** Handset
  - Deregistration: 36
  - Locator: 44
  - Registration: 35Headset, optional: 46  
Hold: 22
- I** Intercom: 43
- K** Key tone: 29
- L** Line mode: 31  
Link to cell: 17
- M** Making calls: 20, 21  
Missed calls: 37  
Mute: 22
- N** Night mode: 34
- P** Pause: 21  
Phonebook: 24  
PIN: 17  
Power failure: 13
- R** Redialing: 20, 21  
Ringer tone: 30, 31  
Rotary/pulse service: 23
- S** SP-PHONE (Speakerphone): 20, 21
- T** Talking alarm clock: 34  
Talking battery alert: 15  
Talking Caller ID: 37  
Time adjustment: 31  
Transferring calls: 43  
Troubleshooting: 49  
TTY: 6, 60
- V** VM (Voice mail): 41  
Voice guidance language: 16  
Voice mail: 41  
Volume
  - Receiver: 11, 21
  - Ringer: 22, 30, 31
  - Speaker: 11, 21
- W** Wall mounting: 45

