

Panasonic®

Operating Instructions

2.4 GHz Expandable Cordless Phone System

Model No. **KX-TH102-A**

KX-TH102-M

2LINE

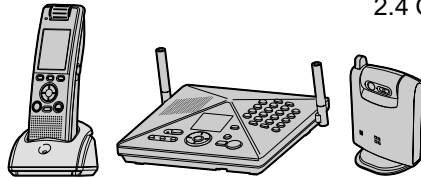

Model shown is KX-TH102-M.



This unit is compatible with Caller ID. To use this feature, you must subscribe to the appropriate service offered by your service provider.

Charge the battery for 6 hours before initial use.

Please read these Operating Instructions before using the unit and save for future reference.

For assistance, visit our website: <http://www.panasonic.com> for customers in the U.S.A. or Puerto Rico.

Introduction

Expanding your phone

You can expand the system by adding handsets (monochrome display handsets and color display handset), wireless camera unit, USB wireless adaptor, and repeater, sold separately. Using these accessories, you can have a video call, monitor on a room where the color display handset or wireless camera is located and taking pictures.

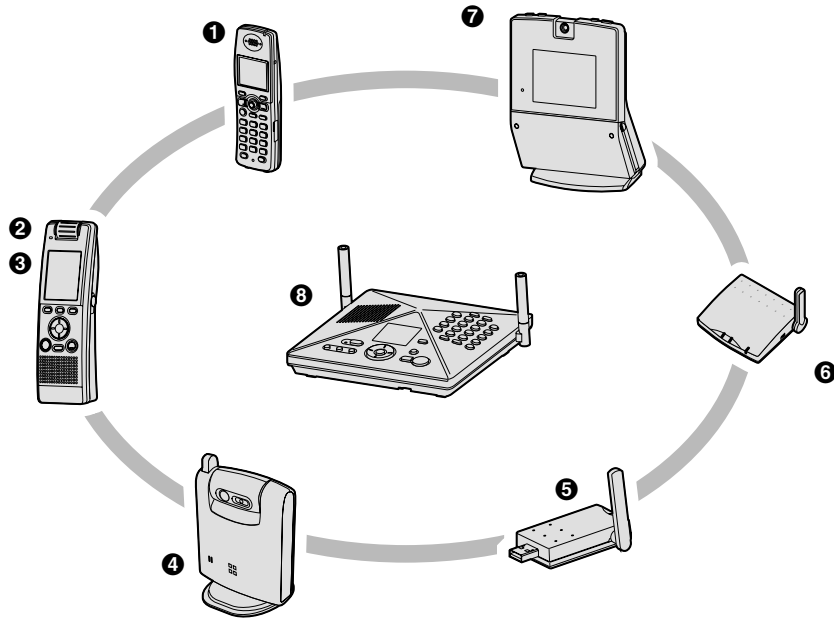

Note:

- Up to 8 handsets (KX-THA11/KX-THA12/KX-THA16) and up to 10 other Bluetooth featured units (KX-THA13/KX-THA14 and a maximum of 5 cellular phones) can be registered to a single base unit.

Available accessory handsets

3 accessory handset models are available. Operations and features of 3 different accessory handsets have certain differences as indicated in the table below.

Feature	KX-THA11	KX-THA12	KX-THA16	Page
Description	Available as accessory handset only	Same handset supplied with KX-TH102-A/ KX-TH102-M	Available as accessory handset only	–
Display type	Monochrome	Color	Color	–
Display size	1.6 inch	2 inch	3.6 inch	–
Control type	Joystick	Navigator key	Navigator key	
USB-support*1	●	●	●	*2
Picture ID	–	●	●	
Picture download feature	–	●	●	*2
Song record feature	●	●	●	
Song download feature	●	●	●	*2
Wallpaper	–	●	●	
Wallpaper download feature	–	●	●	*2
Memory status display	–	●	●	
Video call	–	●	●	
View monitor	–	●	●	
Camera	–	●	●	
Cellular feature	●	●	●	

*1 USB-support allows you to connect the handset to your PC and send pictures and songs from your PC to the handset, as well as create and edit phonebook entries using your PC.

*2 For information on using this feature, refer to the help section of the GIGARANGE USB Utility software. If you have not installed the GIGARANGE USB Utility software, refer to the included "Installation Guide for GIGARANGE USB Utility" for details.

Introduction

Important safety instructions

When using this unit, basic safety precautions should always be followed to reduce the risk of fire, electric shock, or personal injury.

1. Read and understand all instructions.
2. Follow all warnings and instructions marked on this unit.
3. Unplug this unit from power outlets before cleaning. Do not use liquid or aerosol cleaners. Use a damp cloth for cleaning.
4. Do not use this unit near water, for example near a bathtub, wash bowl, kitchen sink, etc.
5. Place the unit securely on a stable surface. Serious damage and/or injury may result if the unit falls.
6. Do not cover slots and openings on the unit. They are provided for ventilation and protection against overheating. Never place the unit near radiators, or in a place where proper ventilation is not provided.
7. Use only the power source marked on the unit. If you are not sure of the type of power supplied to your home, consult your dealer or local power company.
8. Do not place objects on the power cord. Install the unit where no one can step or trip on the cord.
9. Do not overload power outlets and extension cords. This can result in the risk of fire or electric shock.
10. Never push any objects through slots in this unit. This may result in the risk of fire or electric shock. Never spill any liquid on the unit.
11. To reduce the risk of electric shock, do not disassemble this unit. Take the unit to an authorized service center when service is required. Opening or removing covers may expose you to dangerous voltages or other risks.

Incorrect reassembly can cause electric shock when the unit is subsequently used.

12. Unplug this unit from power outlets and refer servicing to an authorized service center when the following conditions occur:
 - A. When the power cord is damaged or frayed.
 - B. If liquid has been spilled into the unit.
 - C. If the unit has been exposed to rain or water.
 - D. If the unit does not work normally by following the operating instructions. Adjust only controls covered by the operating instructions. Improper adjustment may require extensive work by an authorized service center.
 - E. If the unit has been dropped or physically damaged.
 - F. If the unit exhibits a distinct change in performance.
13. During thunderstorms, avoid using telephones except cordless types. There may be a remote risk of an electric shock from lightning.
14. Do not use this unit to report a gas leak, when in the vicinity of the leak.

SAVE THESE INSTRUCTIONS

CAUTION:

Installation

- Never install telephone wiring during a lightning storm.
- Never install telephone jacks in wet locations unless the jack is specifically designed for wet locations.
- Never touch uninsulated telephone wires or terminals unless the telephone line has been disconnected at the network interface.
- Use caution when installing or modifying telephone lines.

Introduction

- Do not touch the plug with wet hands.
- The AC adaptor is used as the main disconnect device. Ensure that the AC outlet is installed near the unit and is easily accessible.
- To prevent the electric shock, use only the included audio cable with the transformer when connecting the unit to an audio device.

Battery

To reduce the risk of fire or injury to persons, read and follow these instructions.

- Use only the battery(ies) specified.
- Do not dispose of the battery(ies) in a fire. They may explode. Check with local waste management codes for special disposal instructions.
- Do not open or mutilate the battery(ies). Released electrolyte is corrosive and may cause burns or injury to the eyes or skin. The electrolyte may be toxic if swallowed.
- Exercise care when handling the battery(ies). Do not allow conductive materials such as rings, bracelets or keys to touch the battery(ies), otherwise a short circuit may cause the battery(ies) and/or the conductive material to overheat and cause burns.
- Charge the battery(ies) provided with or identified for use with this product only in accordance with the instructions and limitations specified in this manual.

WARNING:

- To prevent the risk of fire or electrical shock, do not expose this product to rain or any type of moisture.
- Unplug this unit from power outlets if it emits smoke, an abnormal smell or makes an unusual noise. These conditions can cause fire or electric shock. Confirm that smoke has stopped and contact the Panasonic Call Center at 1-800-211-PANA (7262).

Medical

- Consult the manufacturer of any personal medical devices, such as pacemakers or hearing aids, to determine if they are adequately shielded from external RF (radio frequency) energy. (The unit operates in the frequency range of 2.4 GHz to 2.48 GHz, and the power output level can range from 0.04 to 0.25 watts.) Do not use the unit in health care facilities if any regulations posted in the area instruct you not to do so. Hospitals or health care facilities may be using equipment that could be sensitive to external RF (radio frequency) energy.

Introduction

For best performance

Base unit location/noise

The base unit and handset use radio waves to communicate with each other. For maximum distance and noise-free operation, we recommend the following:

- Placing the unit away from electrical appliances such as a TV, personal computer or another cordless phone.
- Placing the base unit in a HIGH and CENTRAL location with no obstructions such as walls.
- Raising the antennas vertically.
- If you use the handset near a microwave oven which is being used, noise may be heard. Move away from the microwave oven and closer to the base unit.
- If you use the handset near another cordless phone's base unit, noise may be heard. Move away from the other cordless phone's base unit and closer to your base unit.

Environment

- Keep the unit away from electrical noise generating devices, such as fluorescent lamps and motors.
- The unit should be kept free from excessive smoke, dust, high temperature and vibration.
- The unit should not be exposed to direct sunlight.
- Do not place heavy objects on top of the unit.
- When you leave the unit unused for a long period of time, unplug this unit from power outlet.
- The unit should be kept away from heat sources such as heaters, kitchen stoves, etc. It should not be placed in rooms where the temperature is less than 5 °C (41 °F) or greater than 40 °C (104 °F). Damp basements should also be avoided.

- The maximum calling distance may be shortened when the unit is used in the following places: Near obstacles such as hills, tunnels, undergrounds, near metal objects such as wire fences, etc.
- Operating near 2.4 GHz electrical appliances may cause interference. Move away from the electrical appliances.

Routine care

- Wipe the outer surface of the unit with a soft cloth. Do not use benzine, thinner or any abrasive powder.

Preparation

Connections

Connecting the AC adaptor

Base unit

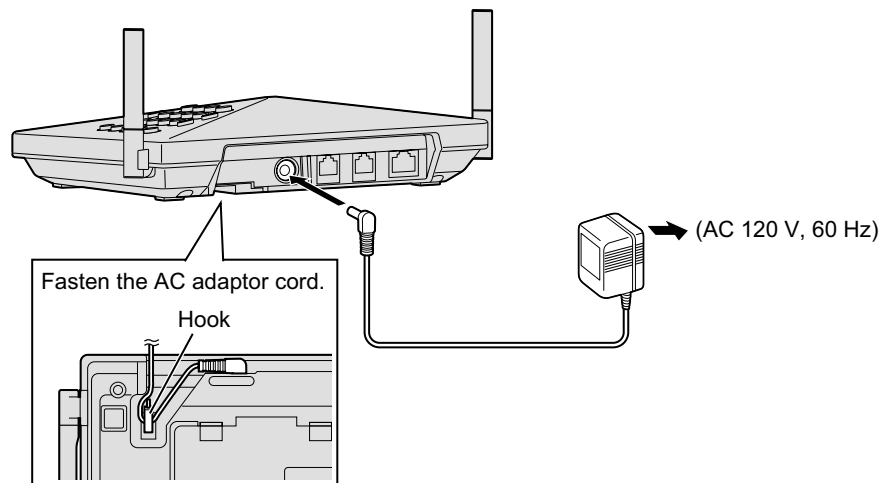

Note:

- Use only the included Panasonic AC adaptor PQLV1.
- The AC adaptor must remain connected at all times. (It is normal for the adaptor to feel warm during use.)
- The AC adaptor should be connected to a vertically oriented or floor-mounted AC outlet. Do not connect the AC adaptor to a ceiling-mounted AC outlet, as the weight of the adaptor may cause it to become disconnected.
- The unit will not work during a power failure. We recommend connecting a standard telephone to the same telephone line or to the same telephone jack using the Panasonic KX-J66 T-adaptor. Emergency power can be supplied to the unit by connecting a Panasonic battery back-up power supply noted on page 7.

Preparation

Connecting the telephone line cord

To connect to a 2-line telephone jack

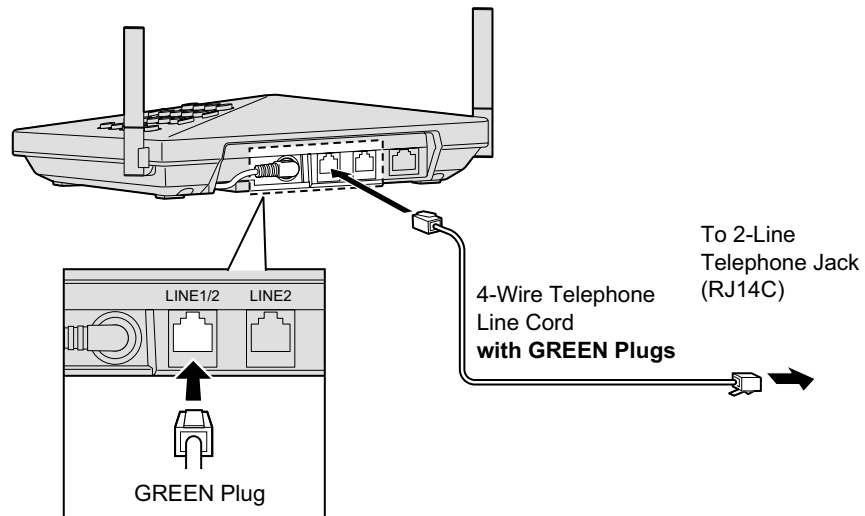

To connect to 2 single-line telephone jacks

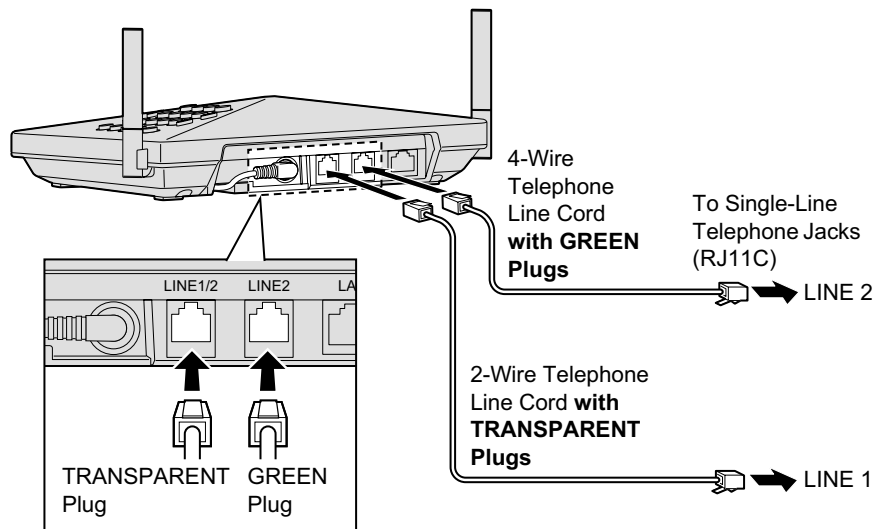

Preparation

If you use the unit as a single-line telephone only

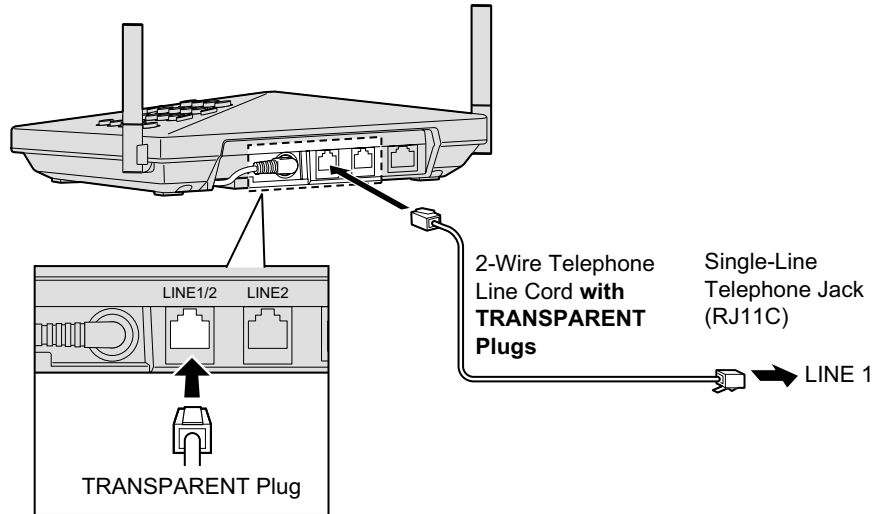

Preparation

If you subscribe to a DSL service

- Please attach a noise filter (contact your DSL provider) to the telephone line between the base unit and the telephone line jack in the event of the following:
 - Noise is heard during conversations.
 - Caller ID features (page 38) do not function properly.

Connecting a 2 line telephone jack

For this connection, please purchase the Panasonic T-adaptor KX-J24. See page 5 for ordering information.

Example: DSL line is LINE 2

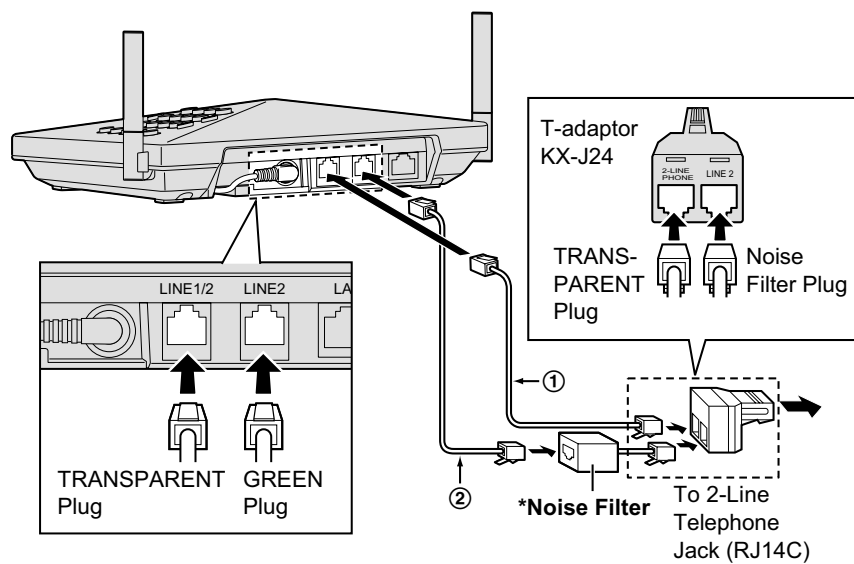

① 2-wire telephone line cord with TRANSPARENT plugs

② 4-wire telephone line cord with GREEN plugs

Preparation

Connecting 2 single-line telephone jacks
Example: DSL line is LINE 2

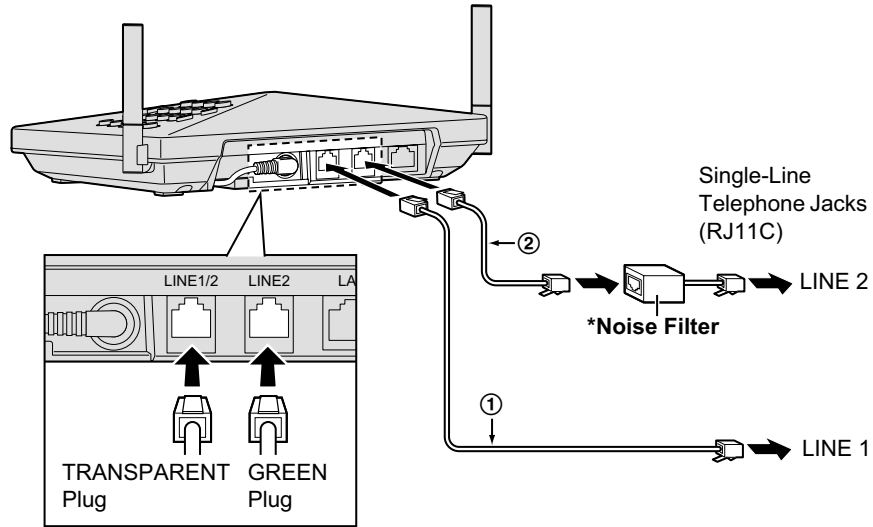

- ① 2-wire telephone line cord **with TRANSPARENT plugs**
- ② 4-wire telephone line cord **with GREEN plugs**

Preparation

Battery installation

Insert the battery (①), and press it down until it snaps into the compartment (②). Close the handset cover.





Battery charge

Place the handset on the charger for **6 hours** before initial use.

Note:

- If you want to use the unit immediately, charge the batteries for at least 15 minutes.
- To ensure the battery charges properly, clean the charge contacts of the handset and charger with a soft, dry cloth once a month. Clean more often if the unit is subject to grease, dust, or high humidity.

Battery strength

Battery icon	Battery strength
	Fully charged
	Medium
	Low When flashing: needs to be recharged.
	Discharged

Note:

- When the battery needs to be charged, the handset beeps intermittently while it is in use.

Preparation

Panasonic battery performance

Operation	Operating time
While in use (talking)	Up to 5 hours
While not in use (standby)	Up to 11 days
While using the clarity booster feature (page 31)	Up to 3 hours

Note:

- Battery power is consumed whenever the handset is off the charger, even when the handset is not in use. The longer you leave the handset off the charger, the shorter you can actually talk on the handset.
- Once the battery is fully charged, you do not have to charge it again until "Recharge battery" is displayed or  flashes. This will maximize the battery life.

Battery replacement

If battery performance diminishes, make sure you have cleaned the charge contacts and fully charged the battery. The battery needs to be replaced if any of the following are displayed after a few phone calls even when you have fully charged the battery.

- Use only the rechargeable Panasonic battery noted on page 7.
- 1 Press the notch on the cover firmly and slide it as indicated by the arrow.

- 2 Replace the old battery with a new one, and close the cover (see page 18 for battery installation).

Attention:



A nickel metal hydride battery that is recyclable powers the product you have purchased. Please call 1-800-8-BATTERY for information on how to recycle this battery.

Controls

Base unit

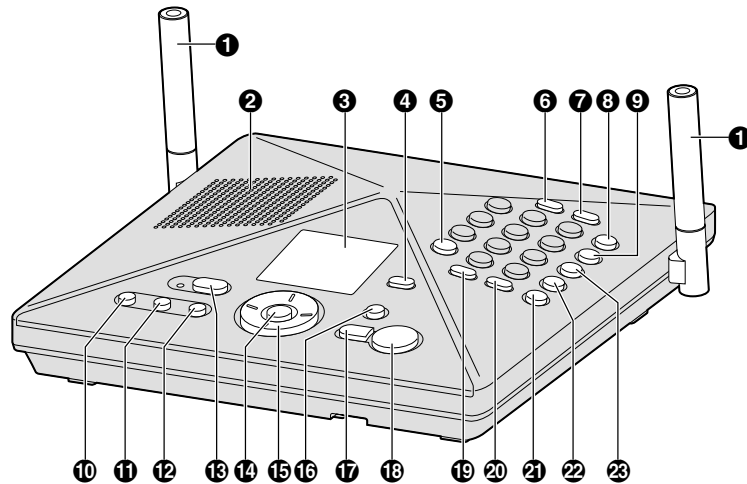

- | | |
|-----------------------|-----------------------------|
| ① Antenna | ⑭ [MENU] [SET] |
| ② Speaker | ⑮ Navigator key |
| ③ Display | ⑯ [LINE SELECT] |
| ④ [CELLULAR] | ⑰ [STOP] |
| ⑤ [*] (TONE) | ⑱ [MESSAGE] |
| ⑥ [REDIAL] [PAUSE] | ⑲ [TRANSFER] [INTERCOM] |
| ⑦ [CALL WAIT] [FLASH] | ⑳ [MUTE] |
| ⑧ [LINE 1] | ㉑ [SP-PHONE] (Speakerphone) |
| ⑨ [LINE 2] | ㉒ [HOLD] |
| ⑩ [ERASE] | ㉓ [CONF] (Conference) |
| ⑪ [EDIT] | |
| ⑫ [MEMO] | |
| ⑬ [ANSWER ON] | |

Preparation

Handset

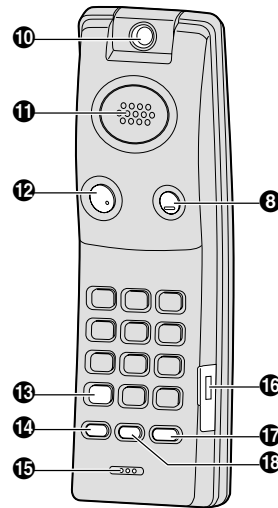
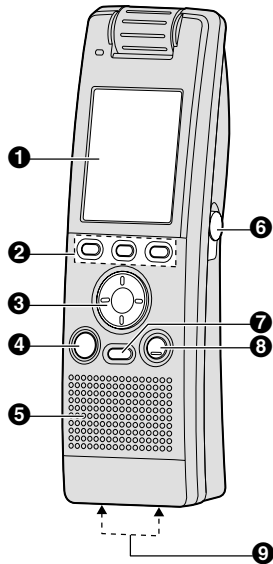

- 1 Display
- 2 Soft keys
- 3 Navigator key
- 4 [SP-PHONE]
- 5 Speaker
- 6 Headset jack/Audio jack
- 7 [CLEAR] [MUTE]
- 8 [OFF]
- 9 Charge contacts
- 10 Camera

- 11 Receiver
- 12 [TALK]
- 13 [*] (TONE)
- 14 [REDIAL] [PAUSE]
- 15 Microphone
- 16 USB port
- 17 [HOLD] [INTERCOM]
- 18 [CALL WAIT] [FLASH]

Preparation

Charger

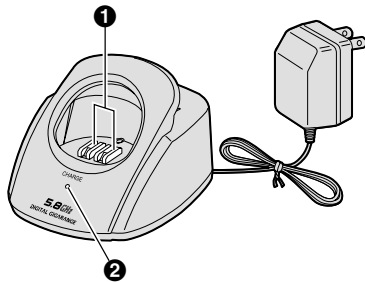

- 1** Charge contacts
- 2** CHARGE indicator

Wireless camera unit

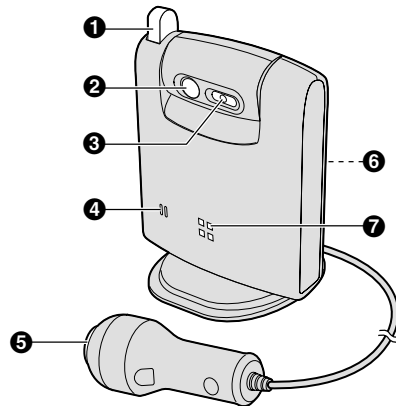

- 1** Antenna
- 2** Photoflash
- 3** Camera
- 4** Microphone
- 5** [Call]
- 6** Speaker

Making/Answering Calls



Making calls using the handset

- 1 Lift the handset and dial the phone number.
 - To correct a digit, press **[CLEAR]**.
 - To cancel, press **[OFF]**.
- 2 
- 3 When finished talking, press **[OFF]** or place the handset on the charger.

Note:

- If you change the line selection (page xx), press the desired line button to call.

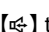
Using the speakerphone

- 1 During a conversation, press  to turn on the speakerphone.
 - Speak alternately with the caller.
 - 2 When finished talking, press **[OFF]**.
- Note:**
- For best performance, please note the following:
 - Use the speakerphone in a quiet environment.
 - If you or the other party have difficulty hearing each other, press the navigator key up or down to adjust the speaker volume as necessary.
 - To switch back to the receiver, press .

Adjusting the receiver/speaker volume

Press the navigator key up or down while talking.

Making a call using the redial list

The last 10 phone numbers dialed are stored in the redial list.

- 1 **[REDIAL]**
- 2 Select the desired number.
 - To delete the displayed number, press **[CLEAR]**.
- 3 

Making/Answering Calls

Making calls using the base unit

- 1 Dial the phone number.
 - To correct a digit, press **[ERASE]**.
 - To cancel, press **[STOP]**.
- 2 **[SP-PHONE]**
- 3 When the other party answers, speak into the MIC.
- 4 When finished talking, press **[SP-PHONE]**.

Note:

- If you change the line selection (page xx), press the desired line button to call.
- For best performance, please note the following:
 - Use the speakerphone in a quiet environment.
 - If you or the other party have difficulty hearing each other, push the joystick up or down to adjust the speaker volume as necessary.
- While on a call, you can switch from the speaker phone to the handset:
 - If the handset is off the charger, press **[📞]** or **[📞]** on the handset, then press **[SP-PHONE]** on the charger.
 - If the handset is on the charger, simply lift the handset.

Adjusting the speaker volume

Press the navigator key up or down while talking.



Making a call using the redial list

The last 10 phone numbers dialed are stored in the redial list.

- 1 **[REDIAL]**
- 2 Select the desired number.
 - To delete the displayed number, press **[ERASE]**.
- 3 **[SP-PHONE]**

Making/Answering Calls

Answering calls using the handset

1 Lift the handset and press [] or [].

- You can also answer a call by pressing any button except the navigator key or [OFF]. (**Any key talk feature**)

2 When finished talking, press [OFF].

Note:

- If you change the line selection (page xx), press the flashing line button to answer.

Auto talk

This feature allows you to answer a call by simply lifting the handset off the charger. You do not need to press []. To activate this feature, see page 58.

Temporary ringer off

While the handset is ringing for an outside call, you can turn the ringer off temporarily by pressing [OFF].

Answering calls using the base unit

1 [SP-PHONE]

2 Speak into the MIC.

3 When finished talking, press [SP-PHONE].

Note:

- If you change the line selection (page xx), press the flashing line button to answer.

Caller ID Service

Using Caller ID service

This unit is Caller ID compatible. To use Caller ID features, you must subscribe to your telephone company's Caller ID service.

Caller ID features

When an outside call is being received, the calling party's name and telephone number will be displayed.

Caller information for the last 50 different callers will be logged in the caller list, allowing you to return missed calls. Caller information is stored by the most recent call to the oldest.

- While listening to a message recorded by the answering system, using the handset, you can call back the caller without having to dial the phone number (page 65).
- If the unit cannot receive caller information, the following will be displayed:
 - "**Out of area**": The caller dialed from an area which does not provide Caller ID service.
 - "**Private caller**": The caller requested not to send caller information.
 - "**Long distance**": The caller called you long distance.
- If the unit is connected to a PBX system, caller information may not be received properly. Consult your PBX supplier.

Call Waiting Caller ID display

If you subscribe to both Caller ID and Call Waiting with Caller ID services, the 2nd caller's information will be displayed after you hear a Call Waiting tone (page 30).

Note:

- Please contact your telephone company for details and availability of this service in your area.

Talking Caller ID

This feature allows you to know who is calling without looking at the display. When a call comes in, the handset and base unit will announce the caller's name displayed on the handset following every ring.

To use this feature, you must subscribe to your telephone company's Caller ID service.

- Name pronunciation may vary. This feature may not pronounce all names correctly.
- Caller ID supports names of up to 15 letters. If the caller's name has more than 15 letters, the name will not be displayed or announced correctly.
- Usually the unit will announce the caller's name after the 2nd ring. If you turn on the answering system, and set the ring count to "2" (page 68), the unit will not announce the caller's name. If "**To11 saver**" is selected, and there is a new message, the unit will not announce the caller's name.

Caller ID Service

Caller list

Caller information for the last 50 different callers will be logged in the caller list. You can use this list to return missed calls.

Missed calls

If a call is not answered, the unit treats the call as a missed call. The number of missed calls is shown on the handset display. This lets you know if you should view the caller list to see who called while you were out.

Viewing the caller list and calling back

1 [MENU] → [≡][2][1][3]

2 Press the navigator key down to search from the most recent call, or up to search from the oldest call.

3 For handset: [↶]/[↷]

For base unit: [SP-PHONE]

- If the line selection is "Auto" (page XX) and you press [↶] or [↷], the indicated line will be selected. If the indicated line is already being used or you want to select the other line, press [MENU], [CALL], and select the other line by pressing [LINE 1] or [LINE 2].

Note:

- In some cases, you may have to edit the number before dialing. (For example, you may have to delete "1" and the area code.)

Displayed symbols

- **1** and **2** indicate which line the caller information was received from.
- If the same caller calls more than once, it will be displayed with the number ("x2" to "x9"). Only the date and time of the most recent call will be stored.

- A ✓ is displayed next to items which have already been viewed or answered on this handset.

Answering System Features

Answering system

Important:

- Only 1 person can access the answering system (listen to messages, record a greeting message, etc.) at a time.
- When callers leave messages, the unit records the day and time of each message. Make sure the date and time have been set (page 26).

Recording your greeting message

You can record your own greeting message (max. 2 minutes) that will be played when the answering system answers a call. If you do not record a greeting message, a pre-recorded greeting message will be used.

- 1** [MENU] → [Ⓜ][3][0][2]
- 2** Press [LINE SELECT] to select the desired line. → [SET]
- 3** After the unit beeps, speak clearly about 20 cm (8 inches) away from the MIC.
- 4** To stop recording, press [STOP].

Playing back the greeting message

- 1** [MENU] → [Ⓜ][3][0][3]
- 2** Select the desired line.

Erasing your greeting message

- 1** [MENU] → [Ⓜ][3][0][3]
- 2** Select the desired line.
- 3** Press [ERASE] while your greeting message is playing.

Pre-recorded greeting message

If you erase or do not record your own greeting message, the unit can play a prerecorded greeting message for callers and ask them to leave messages. If the message recording time (page 69) is set to "Greeting only", caller messages will not be recorded and the unit will play a different prerecorded greeting message asking callers to call again.

Answering System Features

Turning the answering system on/off

Press **[LINE SELECT]** to select the desired line(s). → **[ANSWER ON]**

- When the answering system is turned on, the ANSWER ON indicator lights.

Listening to messages

When new messages have been recorded:

- The MESSAGE indicator on the base unit will flash.

The base unit display will show the number of messages (old and new) recorded by the answering system.

Listening to messages using the base unit

Press **[MESSAGE]**.

- When you have no new messages, the unit will play back all messages.
- The unit will play all new messages including memo messages.
- To play back messages for the desired line(s), press **[LINE SELECT]** to select the desired line(s) before pressing **[MESSAGE]**. When a line is selected, memo messages (page 65) will not be played.

Adjusting the speaker volume

Press the navigator key up or down while using the answering system.

- To adjust the speaker volume for the desired line, press **[LINE SELECT]** before pressing the navigator key.

Repeating a message

Press the navigator key left while listening to the message.

- If pressed within the first 5 seconds of a message, the previous message will be played.

Skipping a message

Press the navigator key right to play the next message.

Pausing message playback

Press **[STOP]**.

Useful Information

FCC and other information

This equipment complies with Part 68 of the FCC rules and the requirements adopted by the ACTA. On the bottom of this equipment is a label that contains, among other information, a product identifier in the format US:ACJ-----.

- If requested, this number must be provided to the telephone company.
- Registration No
.....(found on the bottom of the unit)
- Ringer Equivalence No.
(REN).....0.1B

A plug and jack used to connect this equipment to the premises wiring and telephone network must comply with the applicable FCC Part 68 rules and requirements adopted by the ACTA. A compliant telephone cord and modular plug is provided with this product. It is designed to be connected to a compatible modular jack that is also compliant.

The REN is used to determine the number of devices that may be connected to a telephone line. Excessive RENs on a telephone line may result in the devices not ringing in response to an incoming call. In most but not all areas, the sum of RENs should not exceed five (5.0). To be certain of the number of devices that may be connected to a line, as determined by the total RENs, contact the local telephone company. For products approved after July 23, 2001, the REN for this product is part of the product identifier that has the format US:AAEQ##TXXXX. The digits represented by ## are the REN without a decimal point (e.g., 03 is a REN of 0.3).

If this equipment causes harm to the telephone network, the telephone company will notify you in advance that temporary discontinuance of service may be required. But if advance notice isn't practical, the telephone company will

notify the customer as soon as possible. Also, you will be advised of your right to file a complaint with the FCC if you believe it is necessary.

The telephone company may make changes in its facilities, equipment, operations or procedures that could affect the operation of the equipment. If this happens the telephone company will provide advance notice in order for you to make necessary modifications to maintain uninterrupted service.

If trouble is experienced with this equipment, for repair or warranty information, please contact a Factory Servicenter or other Authorized Servicer. If the equipment is causing harm to the telephone network, the telephone company may request that you disconnect the equipment until the problem is resolved.

Connection to party line service is subject to state tariffs. Contact the state public utility commission, public service commission or corporation commission for information.

If your home has specially wired alarm equipment connected to the telephone line, ensure the installation of this equipment does not disable your alarm equipment. If you have questions about what will disable alarm equipment, consult your telephone company or a qualified installer.

This equipment is hearing aid compatible as defined by the FCC in 47 CFR Section 68.316.

Useful Information

When you hold the phone to your ear, noise might be heard in your Hearing Aid. Some Hearing Aids are not adequately shielded from external RF (radio frequency) energy. If noise occurs, use an optional headset accessory or the speakerphone option (if applicable) when using this phone. Consult with your audiologist or Hearing Aid manufacturer about the availability of Hearing Aids which provide adequate shielding to RF energy commonly emitted by digital devices.

WHEN PROGRAMMING EMERGENCY NUMBERS AND/OR MAKING TEST CALLS TO EMERGENCY NUMBERS:

- 1) Remain on the line and briefly explain to the dispatcher the reason for the call.
- 2) Perform such activities in the off-peak hours, such as early morning or late evenings.

The software contained in this equipment to allow user access to the network must be upgraded to recognize newly established network area codes and exchange codes as they are placed into service.

Failure to upgrade the premises systems or peripheral equipment to recognize the new codes as they are established will restrict the customer and the customer's employees from gaining access to the network and to these codes.

This device complies with Part 15 of the FCC Rules. Operation is subject to the following two conditions:

- (1) This device may not cause harmful interference, and
- (2) this device must accept any interference received, including interference that may cause undesired operation.

Privacy of communications may not be ensured when using this phone.

CAUTION:

Any changes or modifications not expressly approved by the party responsible for compliance could void the user's authority to operate this device.

NOTE:

This equipment has been tested and found to comply with the limits for a Class B digital device, pursuant to Part 15 of the FCC Rules. These limits are designed to provide reasonable protection against harmful interference in a residential installation. This equipment generates, uses, and can radiate radio frequency energy and, if not installed and used in accordance with the instructions, may cause harmful interference to radio communications. However, there is no guarantee that interference will not occur in a particular installation. If this equipment does cause harmful interference to radio or television reception, which can be determined by turning the equipment off and on, the user is encouraged to try to correct the interference by one or more of the following measures:

- Reorient or relocate the receiving antenna.
- Increase the separation between the equipment and receiver.
- Connect the equipment into an outlet on a circuit different from that to which the receiver is connected.
- Consult the dealer or an experienced radio/TV technician for help.

Some cordless telephones operate at frequencies that may cause interference to nearby TVs and VCRs. To minimize or prevent such interference, the base of the cordless telephone should not be placed near or on top of a TV or VCR. If interference is experienced, move the cordless telephone further away from the TV or VCR. This will often reduce, or eliminate, interference.

Useful Information

FCC RF Exposure Warning:

This product complies with FCC radiation exposure limits set forth for an uncontrolled environment. To comply with FCC RF exposure requirements the base unit must be installed and operated with its antenna located 20 cm or more between antenna and all person's body (excluding extremities of hands, wrist and feet). The handset unit may be carried and operated with only the specific provided belt-clip. Other non-tested belt-clips or similar body-worn accessories may not comply and must be avoided. The base and handset units must not be co-located or operated in conjunction with any other antenna or transmitter.

Responsible party:

Panasonic Corporation of North America
One Panasonic Way,
Secaucus, New Jersey 07094
Phone number: 1-800-211-PANA (7262)

FCC Warning:

To ensure compliance with FCC emissions limits, use only the included USB cable with the ferrite core when connecting the unit to a computer.

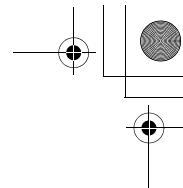
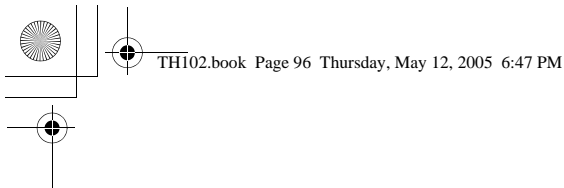

If you need assistance with setup or operation;

- 1** Visit our website: <http://www.panasonic.com/consumersupport>
- 2** Contact us via the web at: <http://www.panasonic.com/contactinfo>
- 3** Call us at: 1-800-211-PANA (7262)
TTY users (hearing or speech impaired users) can call 1-877-833-8855.

When you ship the product;

- Carefully pack your unit, preferably in the original carton.
- Attach a letter, detailing the symptom, to the outside of the carton.
- Send the unit to Panasonic Services Company Customer Servicenter, prepaid and adequately insured.
- Do not send your unit to Panasonic Consumer Electronics Company listed below or to executive or regional sales offices. These locations do not repair consumer products.



• This cordless telephone is designed for use in the United States of America. Sale or use of this product in other countries may violate local laws.
• Ce téléphone sans fil est conçu pour être utilisé aux États-Unis d'Amérique. La vente ou l'emploi de cet appareil dans certains autres pays peut constituer une infraction à la législation locale.
• Este teléfono inalámbrico fue elaborado para uso en los Estados Unidos de América. La venta o el empleo de este producto en ciertos países puede constituir violación de la legislación local.
• このコードレス電話機は、日本国外での使用を目的として設計されており、日本国内での使用は法律違反となります。従って、当社では日本国内においては原則として修理などのサービスは致しかねます。

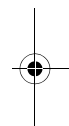

Copyright:

This material is copyrighted by Panasonic Communications Co., Ltd., and may be reproduced for internal use only. All other reproduction, in whole or in part, is prohibited without the written consent of Panasonic Communications Co., Ltd.
© 2005 Panasonic Communications Co., Ltd. All Rights Reserved.

**Panasonic Consumer Electronics Company,
Division of Panasonic Corporation of North America**
One Panasonic Way, Secaucus, New Jersey 07094

Panasonic Puerto Rico, Inc.
San Gabriel Industrial Park, Ave. 65 de Infantería, Km. 9.5,
Carolina, Puerto Rico 00985

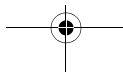
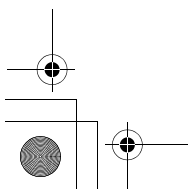

PQQX14673ZA DM0605MK0

