

Operating Instructions PRINTER

Model No. JT-H300PR-U1

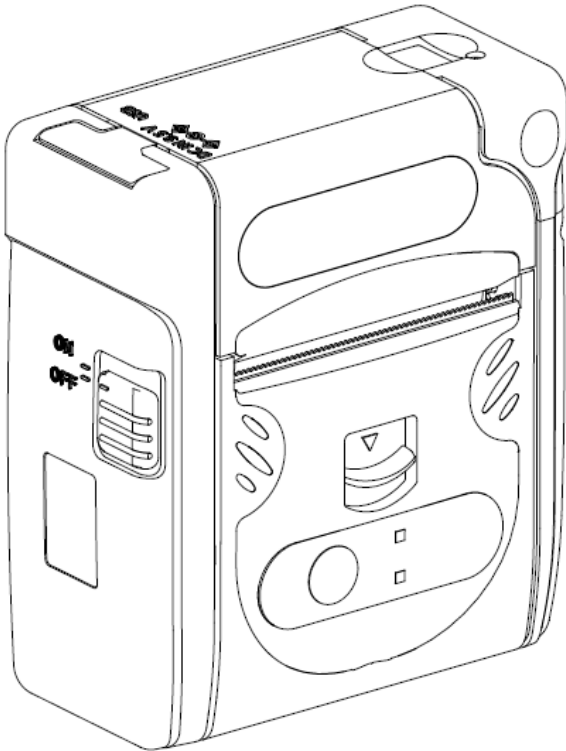

Contents

| | |
|--------------------------------------|----|
| Read Me First | 2 |
| 1. Getting Started | 3 |
| Precautions | 3 |
| Name of each part & function | 6 |
| 2. Operation | 7 |
| Battery Installation | 7 |
| Paper Installation | 7 |
| AC cable Set Up | 8 |
| Charging Battery | 9 |
| 3. Appendix | 10 |
| Troubleshooting | 10 |
| How to care | 11 |
| How to attach the Option parts | 11 |
| Specifications | 12 |
| Warranty Policy | 13 |
| Compliance Notice | 13 |

Before operating this product, please read these instructions carefully and save this document for future use.

Read Me First

Introduction

Thank you for purchasing the JT-H300PR series Panasonic Printer.

This manual describes the instructions for the printer.

Please read this manual carefully before using this product.

What's in the Box?

Printer (Battery is not included.)

Safety Precautions

Options

1. AC Adaptor : JT-H300AD-P1
2. Belt Hook : JT-H300BH-P1
3. Wearable Case : JT-H300CA-P1
4. USB Cable : JT-H300CC-P1

Other Equipment

1. Thermal Paper (Please ask our sales rep about the recommended Paper.)

1. Getting Started

Precautions



[Printer: JT-H300PR-U1]

1. Avoid Radio Frequency Interference

Do not place the printer near a television or radio receiver.

2. Avoid Stacking

Do not place heavy objects on the printer.

3. Keep Small Objects Away

Do not insert paper clips or other small objects into the printer.

Failure to observe this may cause fire or electric shock.

4. Keep Dry

Failure to observe this may cause fire or electric shock.

5. Do Not Disassemble the Printer

Do not attempt to disassemble the printer. Failure to observe this may cause fire or electric shock.

6. Do Not Touch

Keep your hands away from the paper cutter and the thermal head.

Failure to observe this may cause injury.

7. Do Not Use With Any Other Battery

The printer is designed for the specified JT-H100DP-50 battery.

Using unspecified battery may cause smoke or fire.

| |
|---|
| <p>CAUTION Risk of explosion if battery is replaced by an incorrect type. Dispose of used batteries according to the instructions and/or local requirements.</p> |
|---|

8. Use only the specified AC adaptor and AC cord

Using unspecified AC adaptor or AC cord may cause smoke or fire.

9. Do Not Use In Aircrafts or Hospitals

This printer includes "Bluetooth" wireless communication.

Turn off the power switch in aircrafts or hospitals. Abnormal use may occur if used in close proximity to electric instruments or electro-medical apparatus.

10. Do Not hold this product for too long when the power on

Failure to observe this may cause a serious low-temperature burn.

<NOTE>

Do not open the cover while the printer is operating.

Keep the thermal paper away from the direct exposure to light, high temperature, dust and humidity.

Precautions



[Battery Pack: JT-H100DP-50] [For Sales rep or service bench]

1. Avoid Heat

Do not throw the battery pack into a fire or expose it to excessive heat.

Failure to observe this may cause fire or explosion.

2. Keep Articles Away

Do not place the battery pack together with articles such as necklaces or hairpins when carrying or storing. Failure to observe this may cause heat, fire or explosion.

3. Keep Dry

Failure to observe this may cause heat, fire or explosion.

4. Do Not Disassemble

Do not insert sharp object into the battery pack. Do not deform, disassemble, or modify the printer. Failure to observe this may cause heat, fire or explosion.

5. Do Not Short

Do not short the positive (+) and negative (-) contact. Failure to observe this may cause heat, fire or explosion.

6. Avoid Extreme Heat, Cold, and Direct Sunlight

Do not charge, use or leave the battery pack for extended periods where it will be exposed to direct sunlight or in a hot, or cold environment.

7. Do Not Put Into a Microwave Oven

Do not put the battery pack into a microwave oven or pressurized chamber.

Failure to observe this may cause explosion.

8. Do Not Use With Any Other Device

The battery pack is designed for the specified JT-H300PR-E1 printer and JT-H100CG-55 charger. Do not use the battery with any other device.

CAUTION Risk of explosion if battery is replaced by an incorrect type.
Dispose of used batteries according to the instructions and/or local requirements.

9. Stop Using

Should the battery emit an abnormal odor, become hot to the touch, become discolored, change shape, or become in any way different, remove it from the printer and stop using it.

<NOTE>

Please charge the battery pack for at least 100minutes before first use.

Please ask our sales rep about the dispose method of the battery.

If the battery pack is not going to be used for a long period, please charge or discharge it until the remaining battery capacity becomes 30% to 40% and store it in a cool, dry place.

Precautions



[AC Adaptor: JT-H300AD-P1]

1. Do Not Disassemble

Do not attempt to disassemble the charger.
Failure to observe this may cause electric shock or fire.

2. Keep Dry

Failure to observe this may cause heat or fire.

3. Do Not Use With Any Other Device

The AC Adaptor is designed for the specified JT-H300PR printer. Do not use the AC adaptor with any other device.

4. Do Not Exceed the Ratings of AC Outlet and Wirings, and Connect the AC Adaptor Only within 100-240 V AC.

Exceeding the ratings may result in overheating or fire.

5. Do Not Touch the Plug with Wet Hands

Failure to observe this may cause electric shock.

6. Be Certain to Plug Fully Into the Outlet

Failure to observe this may cause electric shock or fire.

7. When Unplugging, Make Sure to Hold the Body of the Plug

Using damaged power strip may cause electric shock, short circuit or fire.

8. Do Not Use a Damaged Power-code or Plug

Failure to observe this may cause electric shock or fire.

9. Clean the Dust off the Plug, Periodically

Failure to observe this may cause electric shock or fire.

10. Do Not hold this product for too long when the power on

Failure to observe this may cause a serious low-temperature burn.

11. Do not use this product outdoors.

Failure to observe this may cause electric shock or fire.

Name of each part & function

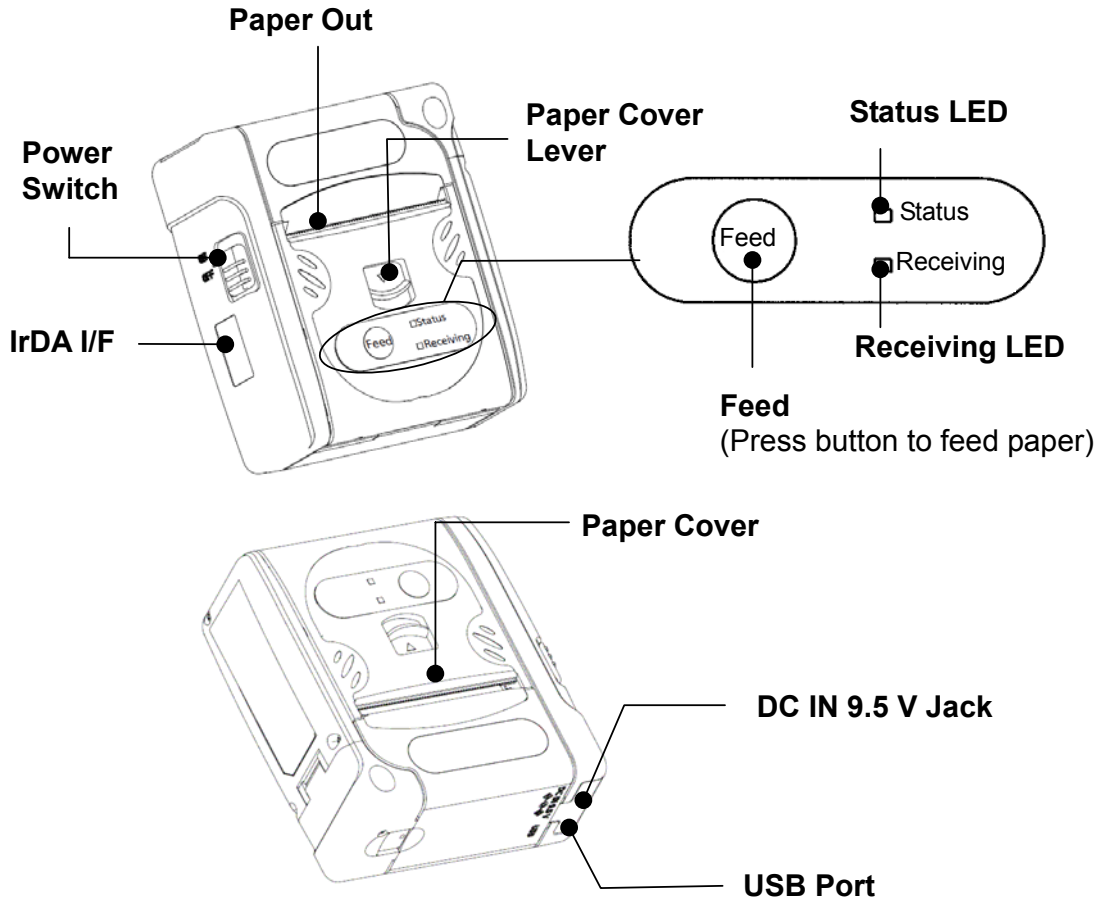

| LED | Indicate | Status |
|---------------|--------------|---|
| Status LED | Off | Normal status. |
| | Green Light | 1. Power-on (5 seconds lightning), 2. Power-off (0.5 second lightning) 3. Battery Full Charge(at AC Adaptor connection) |
| | Orange Light | Detect battery capacity low; printable. |
| | Orenge Blink | The paper is empty |
| | Red Light | 1. Detect Low voltage; not printable. 2. Battry Charging(at AC Adaptor connection) |
| Receiving LED | Red Blink | 1. The cover of paper is open. 2. Others, the printer is out of order. 3. Battry Charging Error or Preliminary charging (1.3 second lightning/at AC Adaptor connection) |
| | Green Light | 1. Printing 2. Power-off(0.5 sevend lightning) |
| | Green Blink | In communications. |

2. Operation

Paper Installation

- 1) Slide the Paper Cover Lever
- 2) Open the Paper Cover

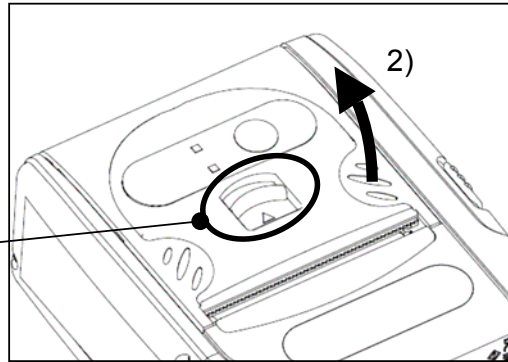
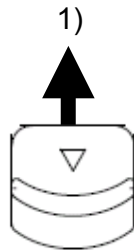

- 3) Install Paper (Paper must be tightly rolled and be confirmed that dust/sand is not on.)
- 4) Close the Paper Cover (Make sure that the Cover is closed completely.)

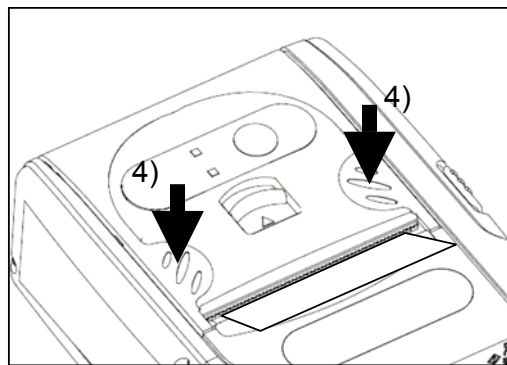
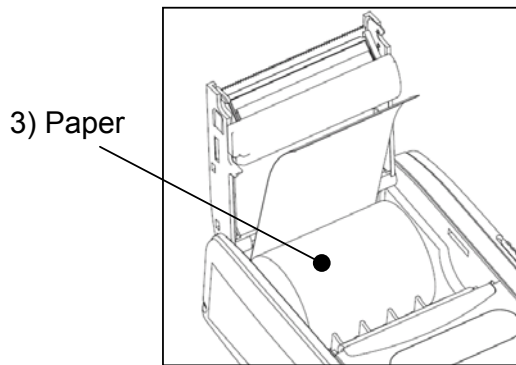

AC cable Set Up

Please attach the core to the AC cable, before using the AC adaptor.

The core is included in the AC adaptor (JT-H300AD-P1).

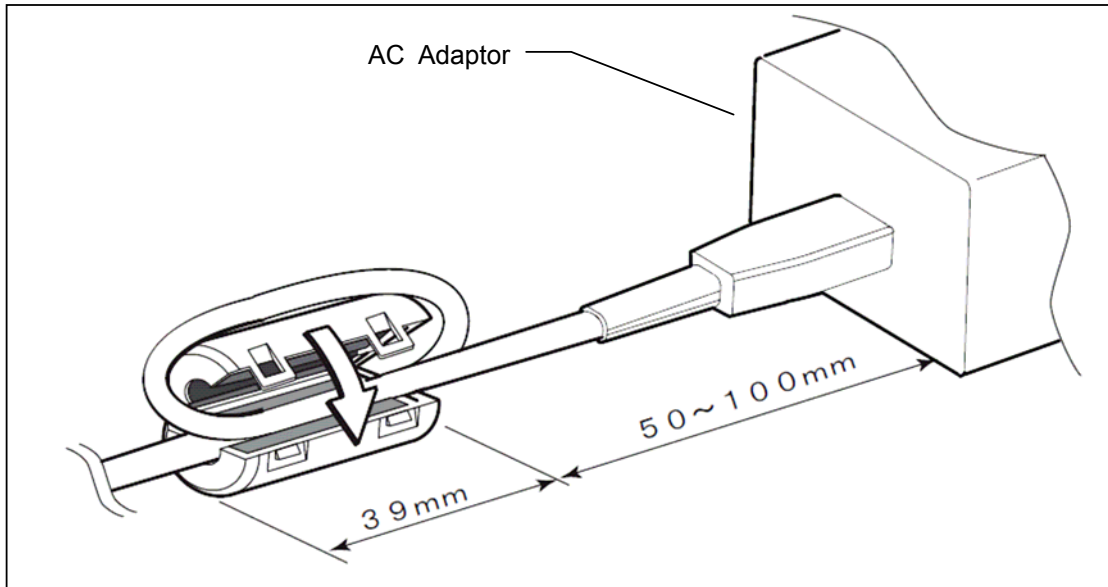

How to connect USB cable

- 1) Pull the Connector Cover.
- 2) Connect the plug of USB cable (JT-H300CC-P1), to the USB connector of the printer.

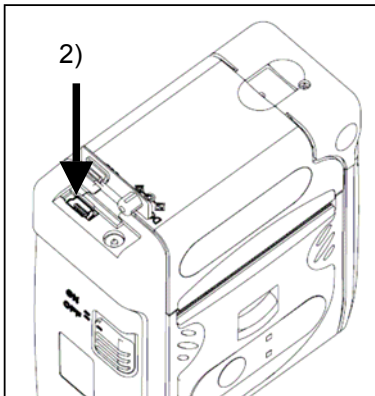
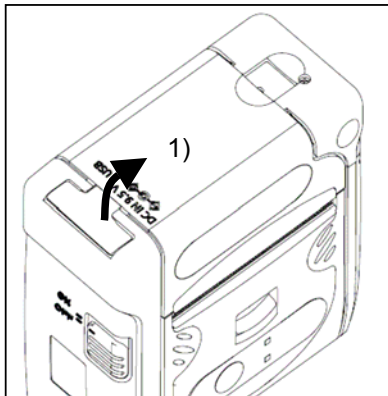

<Note>

The USB cable must use the special one (JT-H300CC-P1).

Charging Battery

[By AC Adaptor]

- 1) Pull the Connector Cover.
- 2) Connect the plug of AC adaptor, to the DC jack of the printer.

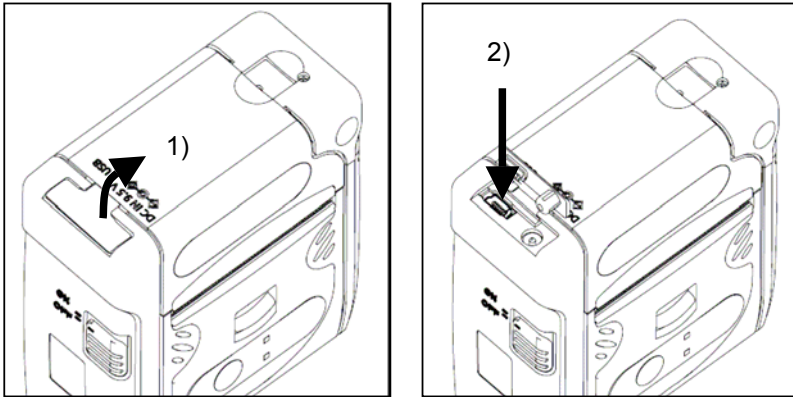

<Note>

Don't open the battery cover.

3. Appendix

Troubleshooting

| Symptom | Possible Cause | Solution |
|--|--|--|
| No Power in Printer | <ol style="list-style-type: none"> 1. Has the battery fully inserted? 2. Is the Power Switch on? | <ol style="list-style-type: none"> 1. Charge the battery pack. 2. Move the Power Switch on. |
| Nothing is printed | <ol style="list-style-type: none"> 1. Is the power turned on? 2. Is the paper set correctly? 3. Are the LED signals lighting red? 4. Is the LED blinking red? 5. Are you using Bluetooth? 6. Are you using IrDA? | <ol style="list-style-type: none"> 1. Turn on power. 2. Check the print paper setting. 3. Charge the battery. 4. Make sure that the paper is setting properly, or close the paper cover completely. 5. Reduce the distance of the device and the printer. 6. Adjust the angle of IrDA, or clean up the window, or avoid direct sunlight. |
| The print is faint | <ol style="list-style-type: none"> 1. Isn't the thermal head dirty? 2. Are you using the recommended paper? | <ol style="list-style-type: none"> 1. Clean it up. 2. Check the paper. |
| The orange or red LED is lighting even after charging battery. | The life cycle of the battery pack may have expired. | Replace the battery pack with a new one. |

How to care

<How to clean up the thermal head and the rubber roller. >

Push the paper cover lever to open the paper cover.

Wipe off any dust/dirt using the cotton swab with a small amount of alcohol (ethanol).

(Do not use thinner, benzene series or kerosene series.)

Close the cover after alcohol volatilizes.

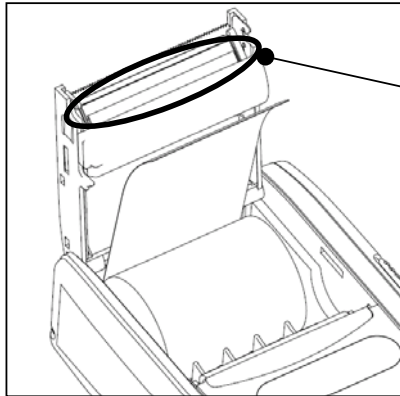

Thermal head

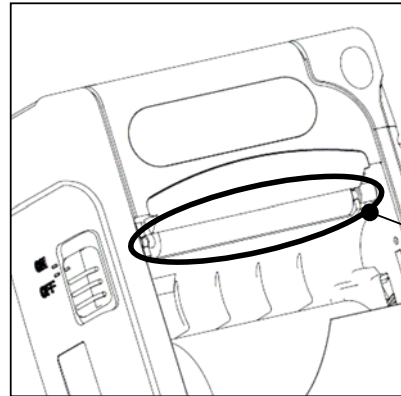

Rubber roller

How to attach the Option parts

<How to attach the Belt hook. >

- 1) Please put the belt hook on the back of the printer confirming the attaching direction.
- 2) Please attach the belt hook to the printer with two screws of the attachment so as not to loosen.

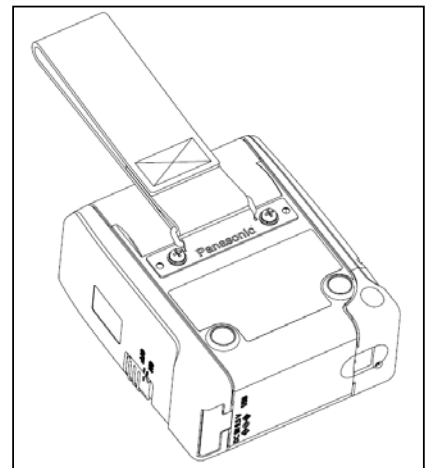
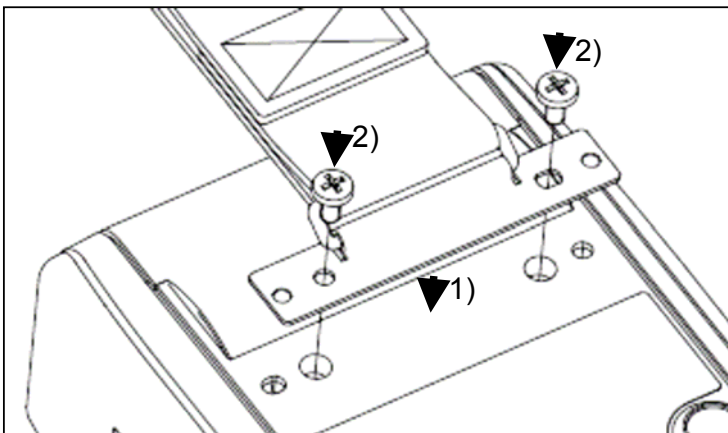

<NOTE>

Do not pull the belt hook strongly.

Failure to observe this may cause breaking and dropping the printer.

Do not use any other screws except the specified screws of the attachment.

Specifications

[Printer:JT-H300PR-U1]

| Items | Description | Specifications |
|---------------------|-----------------------|--|
| Mechanical | Printing | Line Thermal |
| | Printing Speed | Max. 106 mm/Sec (Panasonic Test Standard) |
| Head | Printing Width | 48 mm (384 dots/ line) |
| | Character font | 12 x 24 dots (standard) |
| Printing Function | Font Type | Alpha-numeric, Barcode, 2D code |
| Life Time | Head | 1 X 10 ⁸ pulse or more |
| | | 25 Km or more (Recommended paper) |
| Paper | Paper width | 58 mm ^{+0-1mm} |
| | Roll direction | Outside (outside surface; thermal) |
| Communication *1 | Bluetooth | Bluetooth V2.0+EDR (Class 2) 2.4 GHz ^{*2} |
| | IrDA | IrDA V1.2 (Proprietary) |
| | USB | USB V2.0(Proprietary) Full Speed 12Mbps |
| Power supply | Battery | Battery Pack:JT-H100DP-50 |
| Size & Mass | Size | Approx.W 88 mm x L 102 mm x D 43 mm |
| | Mass | Approx. 280 g (without paper) |
| Environment | Operation temperature | 0 to 40 degree centigrade (without paper) |

*1 : Connectivity of this printer with some equipment (PC, Handheld Computer) made by Panasonic has confirmed.

This printer may not connect the other equipments.

Some PC or Handheld computer are confirmed the communication with this printer via I/F(Bluetooth, IrDA,USB) works correctly.

*2 : Bluetooth is a registered trademark if the Bluetooth SIG,Inc.

[AC Adaptor: JT-H300AD-P1 *3]

| Items | Description | Specifications |
|-------|-------------|---------------------------|
| Power | Input | 100 V – 240 V AC 50/60 Hz |
| | Output | 9.5 V DC 1 A |

*3 : AC cable is not attached.

Warranty Policy

The warranty period and what is covered are according to the application, contract or distributor.

Please ask our sales rep.

<NOTE>

The out of term warranty is as follows:

- Any secondary damages as for the loose of Printing paper, data or business chances.
- Any damages by user including dropping, water contact or any other wrong use, other than the purpose designed for.

For USA

Federal Communications Commission Notices

This product complies with Part 15 of the FCC Rules. Operation is subject to the following two conditions:

- (1) this device may not cause harmful interference, and
- (2) this device must accept any interference received, including interference that may cause undesired operation.

Harmful Interference Notice

This product has been tested and complies with the specifications for a Class B digital device, pursuant to Part 15 of the FCC Rules. These limits are designed to provide reasonable protection against harmful interference in a residential installation. This equipment generates, uses, and can radiate radio frequency energy and, if not installed and used according to the instructions, may cause harmful interference to radio communications. However, there is no guarantee that interference will not occur in a particular installation. If this equipment does cause harmful interference to radio or television reception, which is found by turning the equipment off and on, the user is encouraged to try to correct the interference by one or more of the following measures:

- Reorient or relocate the receiving antenna
- Increase the separation between the equipment or devices
- Connect the equipment to an outlet other than the receiver's
- Consult a dealer or an experienced radio/TV technician for assistance

Changes or modifications to this equipment that have not been approved by Ruckus Wireless may void the user's authority to operate this equipment.

This equipment complies with FCC RF radiation exposure limits set forth for an uncontrolled environment.

To order the AC Adaptor and/or other options please ask our sales



A lithium ion/polymer battery that is recyclable powers the product you have purchased.

Please call 1-800-8-BATTERY for information on how to recycle this battery.

FCC WARNING

Changes or modifications not expressly approved by the party responsible for compliance could void the user's authority to operate the equipment.

This transmitter must not be co-located or operated in conjunction with any other antenna or transmitter.

For CANADA

Industry Canada Statement

This device complies with Industry Canada ICES-003 and RSS210 rules. Operation is subject to the following two conditions:

1. This device may not cause interference and
2. This device must accept any interference, including interference that may cause undesired operation of the device.

This equipment complies with IC radiation exposure limits set forth for an uncontrolled environment and meets RSS-102 of the IC radio frequency (RF) Exposure rules. This equipment has very low levels of RF energy that are deemed to comply without testing of specific absorption ratio (SAR).

Règlement d'Industrie Canada

Cet appareil est conforme aux normes NMB003 et RSS210 d'Industrie Canada.

Le fonctionnement est soumis aux conditions suivantes :

1. Ce périphérique ne doit pas causer d'interférences;
2. Ce périphérique doit accepter toutes les interférences reçues, y compris celles qui risquent d'entraîner un fonctionnement indésirable.

Cet équipement est conforme aux limitations concernant l'exposition aux radiations dans un environnement non contrôlé ainsi qu'aux directives de la norme CNR-102 sur l'exposition aux radiofréquences (RF) établies par IC.

Cet équipement a de très faibles niveaux d'énergie RF lesquels sont considérés comme conformes sans test du taux d'absorption spécifique (DAS).



A lithium ion/polymer battery that is recyclable powers the product you have purchased. Please call 1-800-8-BATTERY for information on how to recycle this battery.

L'appareil que vous vous êtes procuré est alimenté par une batterie au lithium-ion/lithium-polymère. Pour des renseignements sur le recyclage de la batterie, veuillez composer le 1-800-8-BATTERY.

Panasonic Solutions Company
Unit of Panasonic Corporation of North America
One Panasonic Way
Secaucus, NJ 07094

The operation instructions can be downloaded from following URL.

<http://www.panasonic.net/pss/ht/jt-h300pr.html>

Specifications and manuals are subject to change without notice.

Panasonic System Networks Co., Ltd.

Web Site: <http://panasonic.net/>