

Panasonic®

Operating Instructions Digital Wireless Earphones

Model No. **RP-BT10**

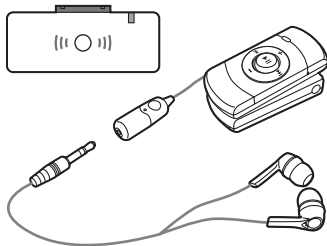

Dear Customer

Thank you for purchasing this product. Before connecting, operating or adjusting this product, please read the instructions completely. Please keep this manual for future reference.

P



RQT8993-P

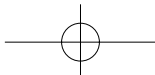

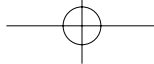

IMPORTANT SAFETY INSTRUCTIONS

- 1) Read these instructions.
- 2) Keep these instructions.
- 3) Heed all warnings.
- 4) Follow all instructions.
- 5) Do not use this apparatus near water.
- 6) Clean only with dry cloth.
- 7) Do not block any ventilation openings. Install in accordance with the manufacturer's instructions.
- 8) Do not install near any heat sources such as radiators, heat registers, stoves, or other apparatus (including amplifiers) that produce heat.
- 9) Do not defeat the safety purpose of polarized or grounding-type plug. A polarized plug has two blades with one wider than the other. A grounding-type plug has two blades and a third grounding prong. The wide blade or the third prong are provided for your safety. If the provided plug does not fit into your outlet, consult an electrician for replacement of the obsolete outlet.
- 10) Protect the power cord from being walked on or pinched particularly at plugs, convenience receptacles, and the point where they exit from the apparatus.
- 11) Only use attachments/accessories specified by the manufacturer.
- 12) Unplug this apparatus during lightning storms or when unused for long periods of time.
- 13) Refer all servicing to qualified service personnel. Servicing is required when the apparatus has been damaged in any way, such as power-supply cord or plug is damaged, liquid has been spilled or objects have fallen into the apparatus, the apparatus has been exposed to rain or moisture, does not operate normally, or has been dropped.
- 14) Do not operate the appliance which has a damaged output cord or enclosure or plug.
- 15) Always unplug the appliance when not in use.
- 16) The appliance is designed to supply Audio/Video equipment, for indoor use only.
- 17) Do not cover the equipment when in use.
- 18) The main plug used as disconnect device from the mains so the disconnect device shall remain readily operable.
- 19) Do not expose to dripping or splashing and do not place objects filled with liquids on the apparatus.
- 20) Do not exceed the manufacturer's specification when in use.

WARNING:

TO REDUCE THE RISK OF FIRE OR ELECTRIC SHOCK,

- DO NOT EXPOSE THIS APPARATUS TO RAIN OR MOISTURE. APPARATUS SHALL NOT BE EXPOSED TO DRIPPING OR SPLASHING AND NO OBJECTS FILLED WITH LIQUIDS, SUCH AS VASES, SHALL BE PLACED ON THE APPARATUS.
- USE ONLY THE RECOMMENDED ACCESSORIES.
- DO NOT REMOVE THE COVER (OR BACK); THERE ARE NO USER SERVICEABLE PARTS INSIDE. REFER SERVICING TO QUALIFIED SERVICE PERSONNEL.

CAUTION!

DO NOT INSTALL OR PLACE THIS UNIT IN A BOOKCASE, BUILT-IN CABINET OR IN ANOTHER CONFINED SPACE. ENSURE THE UNIT IS WELL VENTILATED. TO PREVENT RISK OF ELECTRIC SHOCK OR FIRE HAZARD DUE TO OVERHEATING, ENSURE THAT CURTAINS AND ANY OTHER MATERIALS DO NOT OBSTRUCT THE VENTILATION VENTS.

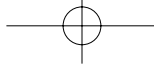

FCC Note:

This equipment has been tested and found to comply with the limits for a Class B digital device, pursuant to Part 15 of the FCC Rules. These limits are designed to provide reasonable protection against harmful interference in a residential installation. This equipment generates, uses and can radiate radio frequency energy and, if not installed and used in accordance with the instructions, may cause harmful interference to radio communications.

However, there is no guarantee that interference will not occur in a particular installation. If this equipment does cause harmful interference to radio or television reception, which can be determined by turning the equipment off and on, the user is encouraged to try to correct the interference by one or more of the following measures:

- Reorient or relocate the receiving antenna.
- Increase the separation between the equipment and receiver.
- Connect the equipment into an outlet on a circuit different from that to which the receiver is connected.
- Consult the dealer or an experienced radio/TV technician for help.

FCC caution: To maintain compliance with FCC regulations, shielded interface cables must be used with this equipment. Operation with non-approved equipment or unshielded cables may result in interference to radio and TV reception. Any changes or modifications not approved by the party responsible for compliance could void the user's authority to operate this equipment.

This device complies with Part 15 of the FCC Rules. Operation is subject to the following two conditions:
(1) This device may not cause harmful interference, and
(2) this device must accept any interference received, including interference that may cause undesired operation.

Declaration of Conformity

Trade Name: Panasonic

Model no.: RP-BT10

Responsible Party: Panasonic Corporation of North America
One Panasonic Way
Secaucus, NJ 07094

Support Contact: Panasonic Consumer Electronics Company
Telephone No.: 1-800-211-7262

RQT8993

4

The socket outlet shall be installed near the equipment and easily accessible. The mains plug of the power supply cord shall remain readily operable. To completely disconnect this apparatus from the AC Mains, disconnect the power supply cord plug from AC receptacle.

CAUTION

Danger of explosion if battery is incorrectly replaced. Replace only with the same or equivalent type recommended by the manufacturer.

Dispose of used batteries according to the manufacturer's instructions.

A nickel metal hydride battery that is recyclable powers the product you have purchased. Please call 1-800-8-BATTERY for information on how to recycle this battery



The receiver (handsfree unit) is certified under FCC ID: ACJRPBT10R. The FCC ID is also located on the battery cover and inside the battery compartment.

-If you see this symbol-

Information on Disposal in other Countries outside the European Union



This symbol is only valid in the European Union. If you wish to discard this product, please contact your local authorities or dealer and ask for the correct method of disposal.

RQT8993

5

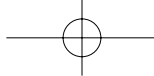

Supplied Accessories



Please check and identify the supplied accessories.

Use numbers indicated in parentheses when asking for replacement parts. "As of June 2007" **To order accessories, refer to the "Panasonic / Technics Accessory Limited Warranty" on page 29.**

- AC adaptor 1
(RFX8772)
- USB power cable..... 1
(RFX5956)
- Earphones with ear pads..... 1
White: (RFX5891), Black: (RFX5891-K)
• M size ear pads put on earphones

The model number and serial number of this product can be found on either the back or the bottom of the unit.

Please note them in the space provided below and keep for future reference.

MODEL NUMBER RP-BT10
SERIAL NUMBER _____

User memo:

DATE OF PURCHASE _____
DEALER NAME _____
DEALER ADDRESS _____
TELEPHONE NUMBER _____

Product service

Do not attempt to remove the cover(s) or repair the unit yourself. Refer servicing to qualified personnel only.

Product information

For product service, product information or assistance with product operation, refer to the servicenter directory.

Table of contents

IMPORTANT SAFETY INSTRUCTIONS	2
Supplied Accessories	6
Features	8
Precautions	9
Basic flow of operations	11
Parts and their functions.....	12
Preparations (prior to use).....	13
Listening to music on your iPod®	15
Talking on your cellphone	18
Listening to music on your cellphone	21
List of lamp displays	23
How to dispose of the unit	24
Maintenance	24
Troubleshooting.....	25
Specifications	28

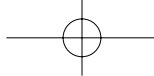

Features

- Digital wireless earphones for iPod®*1
- Compatible with some cellphones which incorporate **Bluetooth** wireless technology (answer call) and also compatible with some music cellphones which incorporate **Bluetooth** wireless technology*2
- High quality and Low noise sound
- 2-way battery charge (USB/AC adaptor)
- Custom fit with 3 sizes of ear pads (S/M/L)



*1 Made for

iPod nano 2nd G

iPod 5th G (Video)

iPod nano 1st G

iPod 4th G (color Display)

iPod 4th G

iPod mini

*G means generation

Note: The latest iPod® software versions are required.

*2 Do not work with all the cellphones which incorporate **Bluetooth** wireless technology.

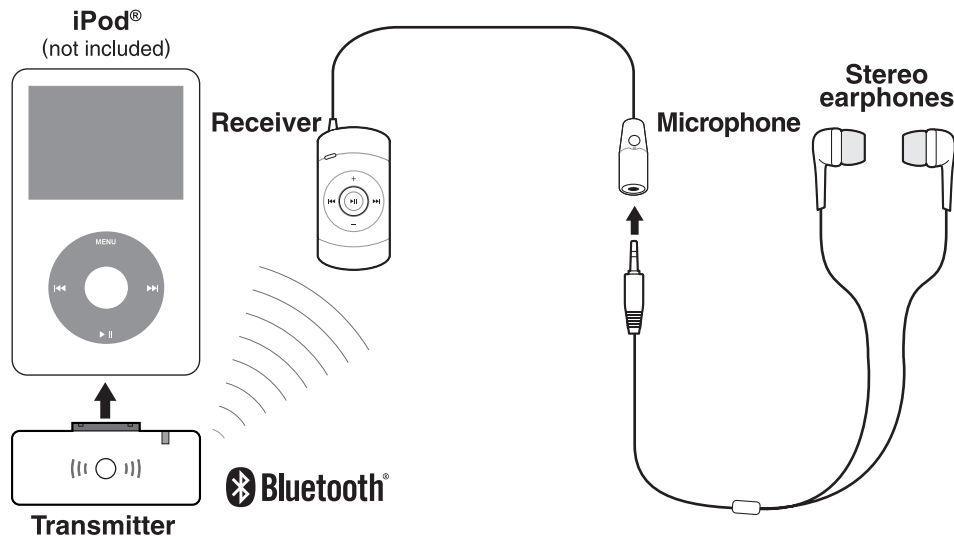

Precautions

AC adaptor

Handle the AC adaptor carefully. Improper handling is dangerous.

- Do not touch it with wet hands.
 - Do not place heavy objects on top of it.
- Be sure to use the supplied AC adaptor.

Battery

- The rechargeable battery can be recharged about 300 times. If its operating time becomes extremely short, you should consult the dealer about exchange of the rechargeable battery. (RP-BP65HP-1)
- Do not heat or expose to flame.
- Carry and store the rechargeable battery in the battery carrying case to prevent contact with metal objects.
- Do not peel off the covering on battery and do not use if the covering has been peeled off. Mishandling of battery can cause electrolyte leakage which can damage items the fluid contacts and may cause a fire.
- Keep the battery, out of the reach of children to prevent them from being swallowed.

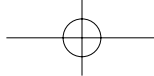

Precautions

The unit

This unit uses the 2.4 GHz radio frequency band (**Bluetooth**). However other wireless equipment may use the same frequency. Be sure to take note of the following to prevent radio wave interference from other equipment.

■ Restriction of use

For use only in your country.

■ Range of use

The range of use is up to approximately 10 m (30 ft.). The range may be less depending on the structure of the building, the environment and any obstacles between the receiver and the transmitter. Such obstacles as reinforced concrete walls and metal doors, in particular, obstruct the transmitter's signals.

■ Interference from other equipment

Due to radio interference, malfunctions such as sound distortion may occur if the unit is placed too close to other equipment. We recommend keeping the unit as far away as possible from the following devices:

Bluetooth devices other than this unit, wireless LAN, microwaves, office automation devices, digital cordless telephones and other electronic devices

The unit is designed to automatically avoid radio interference from these household devices. However the sound will be broken when radio interference occurs.

■ Using the unit

- Do not drop, hit or otherwise subject the transmitter or receiver to strong shocks of any kind. This may cause damage.
- Do not expose the unit to water or other liquids as it may cause damage.
- Do not use near microwave ovens, pacemakers or other industrial, chemical or medical equipment.
- Do not use inside an aircraft, as this may compromise the safety of the aircraft.
- Keep the ear pads, out of the reach of children to prevent them from being swallowed.

Basic flow of operations

Listening to music

① Connect the transmitter to the iPod®.

Connect it to the iPod®'s dock connector. (Refer to page 15.)



- Prior to shipment from the manufacturing plant, the transmitter and receiver pair is registered.

② Setting the pair

Use a **Bluetooth** connection for the receiver and transmitter that has been connected to the iPod®.

The pair setting is performed automatically.

(Refer to page 15.)



③ Listening to music

- You can listen to the music played by the iPod® with the receiver.
- You can play, pause and control the music in other ways with the receiver. (Refer to page 16.)

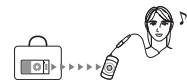

Talking on the phone

① Registering the device pair

The receiver and **Bluetooth** cellphone must be registered for the parties to be connected. Once they have been registered, they need not be registered again. (Refer to page 18.)



② Setting the pair

Use a **Bluetooth** connection for the receiver and **Bluetooth** cellphone.

(Refer to page 19.)



③ Talking on the phone

You can now operate the receiver and receive incoming calls. (Refer to page 20.)

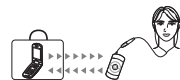

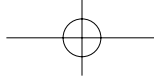

Parts and their functions

Transmitter

- ① Connector: Connect this to the iPod®'s dock connector.
- ② Lamp: This indicates the status of the device.
(Refer to page 23.)
- ③ Transmitter button: This is operated when setting the pair.

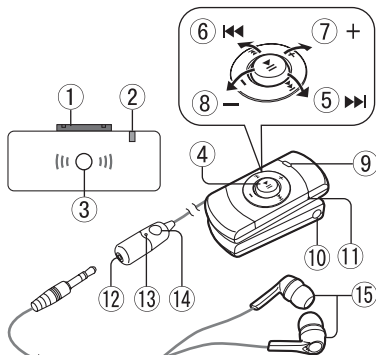

RQT8993

12

Receiver, microphone and earphones

- ④ **▶||** : PLAY/PAUSE
- ⑤ **▶▶** : Forward
- ⑥ **◀◀** : Backward
- ⑦ **+** : Use this to increase the volume level.
- ⑧ **-** : Use this to reduce the volume level. Also use it to register the pair.
- ⑨ Lamp: This indicates the status of the device.
(Refer to page 23.)
- ⑩ DC IN socket: Connect the accessory AC adapter or USB cable here.
(Be sure to use the AC adapter or USB cables that have been provided as an accessory. Trouble or malfunctioning may result if a product such as one with different plug polarities is used instead.)
- ⑪ Reset switch: (Refer to page 25.)
- ⑫ AUDIO OUT (line out) connector:
Connect the headphones with the 3.5 mm plug to this connector.
- ⑬ Microphone: The microphone used when talking on the phone is built-in.
- ⑭ MIC button: Use this to turn the power on or off, start talking when receiving an incoming call or end talking to terminate the call, set the pairing, etc.
- ⑮ Stereo earphones (L / R)

Preparations (prior to use)

Charging (only the receiver)

The unit (receiver) contains a rechargeable nickel-hydrogen battery. Recharge this battery prior to use.

■ When using the AC adapter to recharge the battery

- ① Connect the AC adapter to the receiver.
The receiver's lamp (purple) lights up.
When charging is completed, the lamp goes off.
- Caution:**
 - Be sure to use the AC adapter that is supplied as an accessory.
 - Use the AC plug of the AC adapter at a ^(a) 90- or ^(b) 180-degree angle. Do not use the AC plug bent at other angles, as this will result in faulty contact.

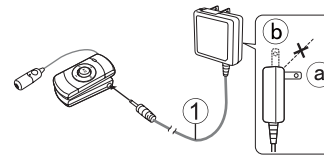

■ When connecting the USB cable to a PC to recharge the battery

- ① Connect one end of the USB cable to the receiver and the other end to the PC.
The receiver's lamp (purple) lights up.
When charging is completed, the lamp goes off.
- Caution:** Be sure to use the USB power cable that is supplied as an accessory.
- Notes:**
 - During charging, the rechargeable battery will heat up: this is normal and not indicative of trouble.
 - Charge the battery in an ambient temperature from 0 to 40°C. Otherwise, the battery may not fully charge.
 - The transmitter receives its power from the iPod® so there is no need to recharge it.
 - During charging, the receiver's reception functions do not work.
 - **To prevent overcharging, repeated charging is not possible.**

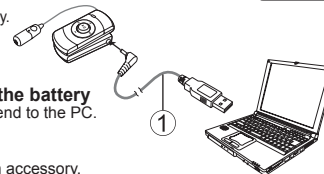

Before charging again after fully charging, use the unit for at least 20 to 30 minutes. (If charging is restarted immediately after fully charging, charging will automatically stop after about 1 minute.)

■ Approximate charging times and charge retention times

Charging time	Audio playback time	Continuous standby time
Approx. 3 hours	Approx. 4.5 hours	Approx. 25 hours

- The continuous operating time of the transmitter depends on the charging capacity of the iPod®.

RQT8993

13

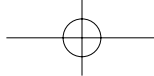

Preparations (prior to use)

Concerning the connection of the stereo earphones (L, R)

Insert the input plug of the stereo earphones into the AUDIO OUT connector for use.

■ How to fit the stereo earphones into your ears properly

If the earpieces are not fitted snugly into your ears, you may not obtain a good seal or hear bass sounds. Fit them into your ears snugly for a better sound quality listening experience.

- ① Lift the upper part of your left ear lobe using your right hand (and vice versa).
- ② Twist slightly and gently push the earphones in.

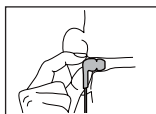
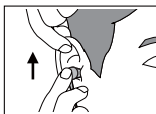

Note:

- Discontinue use if you experience discomfort. Continued use may cause rashes or other allergic reactions.

■ Concerning the ear pads

Your earphones are fitted with M size ear pads at the time of their purchase.

If you feel that they are too small or too large for your ears, replace them with the S or L size pads.

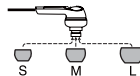

14

RQT8993

Listening to music on your iPod®

Setting the pair

As soon as the receiver and transmitter power are turned on, the pair setting is performed automatically.

- ① Connect the transmitter to the dock connector on the bottom of the iPod®.

• The iPod®'s power is now automatically turned on.

- ② Press and hold the MIC button on the receiver for 2 seconds.

• The receiver's power is now turned on, and the lamp (red) blinks slowly.

- ③ Press and hold the Transmitter button on the transmitter for 2 seconds.

• The transmitter's lamp (red) starts blinking rapidly, and when the pair setting is completed, the lamps (blue) on the transmitter and receiver start blinking slowly to indicate that the pair setting has been completed.

Note: • To establish pairing again after pairing has been released or the transmitter's power was turned off, press and hold the Transmitter button on the transmitter for 2 seconds. The pair setting is restored.

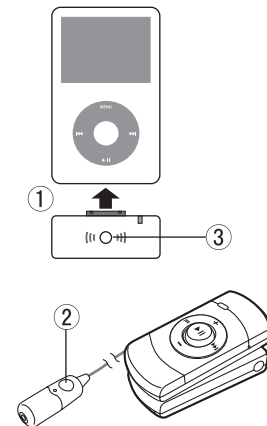

15

RQT8993

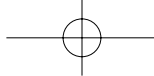

Listening to music on your iPod®

Operating the receiver

As soon as the pairing has been set, the iPod® can be operated by remote control.

- ① **▶||** Play/pause : Each time this is pressed, the mode is switched.
- ② **▶▶** Next/Fast-forward : Press this once to skip to the next track; Press and hold it down to fast-forward.
- ③ **◀◀** Previous/Rewind : Press this once to return to the beginning of the previous track; Press and hold it down to rewind.
- ④ **+** Volume (up) : Use this to adjust the volume level in 16 steps.
- ⑤ **-** Volume (down) : Use this to adjust the volume level in 16 steps.

- Some operations may not be supported depending on the player you are using.
- When you pause operation using the receiver, the iPod® screen flashes approximately every 20 seconds. This is to prevent the power from automatically turning off, and it is not a malfunction.
- The earphone volume depends on the receiver side, so changing the iPod® volume does not change the earphone volume.
- Even if you change the volume with the receiver, the iPod® volume display does not change.

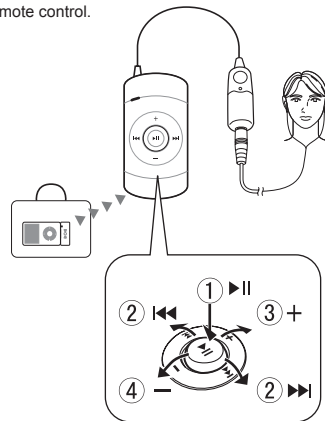

Winding up an operation session

- ① **Press and hold the MIC button on the receiver for 6 seconds.**
The receiver's power is turned off, the pairing setting is released, and the lamp goes off.
 - The iPod®'s power turns off automatically.

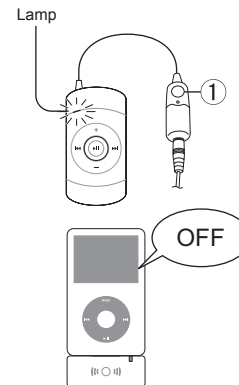

If you also establish pairing with a **Bluetooth** cellphone, you can receive calls to your **Bluetooth** cellphone while listening to music on your iPod®.

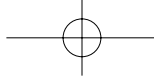

Talking on your cellphone

Registering the device pair

In order to establish the wireless connection between the receiver and **Bluetooth** cellphone, the receiver and cellphone pair must be registered.

• Operations involving the receiver

① **Press and hold the MIC button on the receiver for 2 seconds.**

The receiver's power is turned on, and its lamp (red) starts blinking slowly.

② **Press and hold the [-] button on the receiver for 6 seconds.**

The lamp (red) starts blinking rapidly.

Caution: While the lamp (red) blinks rapidly (for about 60 seconds), register the pairing of the receiver and **Bluetooth** cellphone. Repeat step ② if the lamp (red) starts blinking slowly.

• Operations involving the Bluetooth cellphone

③ **Using your cellphone, conduct a Bluetooth device search.**

Caution: A list of detected devices is displayed on the cellphone screen, and "RP-BT10R Panasonic" is displayed for the receiver.

If "RP-BT10R Panasonic" is not displayed, repeat the procedure from step ②.

If you are requested to input the pass key, input "0000."

Notes: For further details on conducting the **Bluetooth** device search, refer to the operating instructions of your cellphone.

Once the pairing has been registered, it need not be registered again.

It may not be possible to register the pairing with some cellphones because they use a different data transfer format.

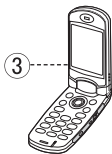
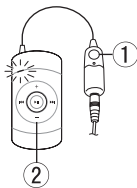

Setting the pair

In order to establish the wireless connection between the receiver and **Bluetooth** cellphone, the receiver and cellphone pair must first be registered.

Before operating the units, check the following points.

• Has the pairing of the receiver and cellphone you are about to use been registered? (Refer to page 18.)

① **Press and hold the MIC button on the receiver for 2 seconds.**

The receiver's power is turned on, and its lamp (red) starts blinking slowly.

② **Establish a "hands-free" connection by performing the Bluetooth connection operation on your cellphone.**

When the pair setting is completed, the receiver's lamp (blue) starts blinking slowly.

To establish pairing again after pairing has been released or the receiver's power was turned off, press the MIC button on the receiver once, then check the connection with the cellphone.

Note:

For further details on the **Bluetooth** connection operation, refer to the operating instructions of your cellphone.

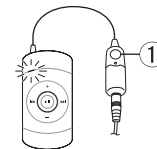

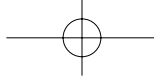

Talking on your cellphone

Talking on the phone

■ Receiving incoming calls

You will hear the incoming call tone when someone calls the number of your cellphone.

- ①-a To talk to the other party, **Press the MIC button on the receiver.**
- ①-b To switch the call to your cellphone, **Press and hold the MIC button on the receiver for 2 seconds after the call has been connected.**
- ①-c To refuse the call, **Press and hold the MIC button on the receiver for 2 seconds during the call tone.**

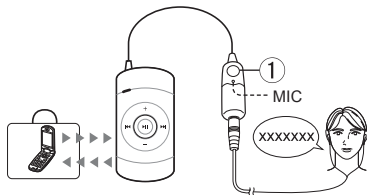

■ Hanging up

- ① **Press the MIC button on the receiver.** The call is now terminated.

Notes:

- If you receive a call while music is playing on the iPod®, the iPod® music will be temporarily suspended, and you will hear the incoming call tone.
- When the call is terminated, the iPod® music will resume.

Adjusting the call volume

The call volume can be adjusted by pressing the [+] and [-] buttons.

Notes:

- The call volume cannot be adjusted during call standby.
- You can select separate settings for the call volume level and music play level.

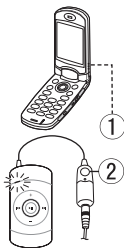

Winding up an operation session

- ① **Disconnect the Bluetooth connection using your cellphone.**

Note:

- For further details on disconnecting the Bluetooth connection, refer to the operating instructions of your cellphone.

- ② **Press and hold the MIC button on the receiver for 6 seconds.**

The receiver's power is turned off, and its lamp (red) goes off.

Listening to music on your cellphone

Setting the pair

In order to establish the wireless connection between the receiver and Bluetooth cellphone, the receiver and cellphone pair must first be registered.

Before operating the units, check the following points.

- Has the pairing of the receiver and cellphone you are about to use been registered? (Refer to page 18.)

- ① **Press and hold the MIC button on the receiver for 2 seconds.**

The receiver's power is turned on, and its lamp (red) starts blinking slowly.

- ② **Establish the "audio" connection by performing the Bluetooth connection operation on your cellphone.**

- ③ **Perform the audio playback operation using the above cellphone.**

When the pair setting is completed, the receiver's lamp (blue) starts blinking slowly.

- Perform the operation for transmitting to the Bluetooth device.
- The receiver starts receiving, and the playback sound can be heard through the earphones.

Note:

- For further details on the Bluetooth connection, refer to the operating instructions of your cellphone.

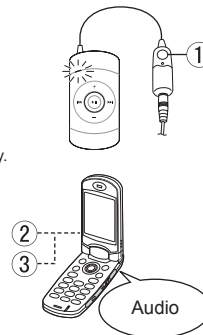

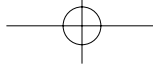

Listening to music on your cellphone

Operating the receiver

Once the pairing is set, the music play functions of your cellphone can be operated by remote control (a).
(Same as for iPod®: page 16)

- Notes:**
- Some cellphones may cancel the pairing when playback is stopped on the cellphone side while listening to music.
 - For further details on the operations after receiving a call while listening to music, refer to the operating instructions of your cellphone.

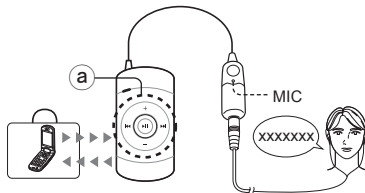

Winding up an operation session

- 1 Disconnect the Bluetooth connection using your cellphone.

Note: • For further details on disconnecting the Bluetooth connection, refer to the operating instructions of your cellphone.

- 2 Press and hold the MIC button of the receiver for 6 seconds.

The receiver's power is turned off, and its lamp (red) goes off.



List of lamp displays

Receiver

Lamp	Device status	Remarks
Lights (purple)	Now charging	
Off	Charging completed	
Lights alternately blue and red.	Low battery charge	Under operation
Off	While power is off	
Blinks slowly (red)	While power is on (no pairing)	Power turns off after 3 minutes.
Blinks rapidly (red)	When pairing is being set (*1)	
Blinks slowly (blue)	When pairing is set successfully	
Blinks slowly (blue)	When an incoming call is received	
Blinks slowly (blue)	While talking	

*1If the device that is trying to be connected cannot be found, the lamp blinks rapidly for a maximum of 60 seconds or so, after which it blinks slowly again.

Transmitter

Lamp	Device status	Remarks
Off	While power is off	
Blinks slowly (red)	While power is on (no pairing)	Power turns off after 3 minutes.
Blinks rapidly (red)	When pairing is being set (*1)	
Blinks slowly (blue)	When pairing is set successfully	

*1If the device that is trying to be connected cannot be found, the lamp blinks rapidly for a maximum of 60 seconds or so, after which it blinks slowly again.

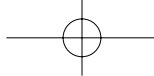

How to dispose of the unit

The unit (receiver) uses a rechargeable nickel-hydrogen battery. (RP-BP65HP-1)
To protect the environment and conserve valuable resources, when disposing of the unit, remove its rechargeable nickel-hydrogen battery and take it to a recycling center.

■ How to remove the battery

• When the rechargeable battery is to be replaced, consult with your dealer.

① Use a  screwdriver to undo the screw on the back panel of the unit (receiver), and remove the battery lid.

② Remove the rechargeable battery.

Caution: • Unless the unit is to be disposed of, do not remove the battery lid.
• Check that the rechargeable battery has completely discharged before removing it.

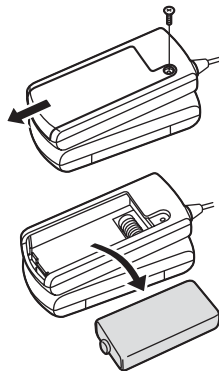

Maintenance

To clean this unit, wipe with a soft, dry cloth.

- Never use alcohol, paint thinner, or benzene to clean this unit.
- Before using chemically treated cloth, read the instructions that came with the cloth carefully.

Troubleshooting

Before requesting service, make the below checks. If you are in doubt about some of the check points, or if the remedies indicated in the chart do not solve the problem: refer to the "Panasonic / Technics Accessory Limited Warranty" on page 29. Take the unit when you visit your dealer.

Problem	Possible cause and suggested remedy
I can't hear any sound. The sound is barely audible. I hear a lot of noise. The sound keeps breaking up.	<ul style="list-style-type: none"> •Something is wrong with the wireless communication. •Is power being supplied to the unit and device connected to it? (Is the unit's lamp blinking in blue?) •Have you temporarily suspended play using the receiver or iPod®? •Has the transmitter been inserted all the way into the docking connector of the iPod®? •Is the transmitter's connector dirty? •Has the input plug of the stereo earphones been inserted all the way (into the AUDIO OUT connector)? •Is the plug dirty? •Noise may be heard due to the effect of the cellphone. •Depending on the specifications and settings of your cellphone, the sound may break up or data communication may not be possible when you operate your cellphone. •Is a Bluetooth-enabled device other than this unit being used? Do not use the two devices at the same time.
The unit doesn't work.	<ul style="list-style-type: none"> •Has the battery in the receiver or the device connected discharged? If it is, recharge it. •No power is supplied while the unit is being charged. •Connect the transmitter firmly to your iPod®, and reset the receiver. (The pairing information is not erased by this operation.) Then perform the pair setting again. * Reset operation: Insert a paper clip or other thin rod-type object into the hole on the receiver and press until there is the feeling of a button being pressed.
I can't register the (pairing of the) device.	<ul style="list-style-type: none"> •Did you allow more than one minute to elapse after setting the unit to the device registration mode? The pair setting is automatically released if you allow more than one minute to elapse. •Set the pairing with the unit and connected device placed as close to each other as possible.
I can't use my cellphone to communicate.	<ul style="list-style-type: none"> •Is your cellphone set to auto response or answering machine mode? •Have you set the volume level for the incoming tone and for receiving calls too low?

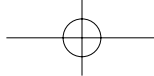

Troubleshooting

Problem	Possible cause and suggested remedy
The rechargeable battery is hot while it is being charged.	The battery will become somewhat hot: this is normal and not indicative of trouble.
I can't connect a device even though I have already registered it.	<p><iPod®> •Re-register the transmitter and receiver pairing.</p> <ol style="list-style-type: none"> 1. Connect the transmitter to the iPod®. 2. Press and hold the transmitter button for 2 seconds. The transmitter's lamp (red) starts blinking rapidly. 3. Press and hold the MIC button on the receiver for 2 seconds. The receiver's power is now turned on, and the lamp (red) blinks slowly. 4. Press and hold the [-] button on the receiver for 6 seconds. The receiver and transmitter lamps (red) start blinking rapidly. <ul style="list-style-type: none"> • When re-registering the pairing: Wait for about 7 seconds. Step 5 is not necessary. • When registering the pairing for the first time (when replacing the unit with a new one): Go to step 5. 5. Press the transmitter button twice quickly. When the pair setting has been re-registered, the transmitter lamp (blue) and receiver lamp (blue) will blink slowly. If failed, power off both devices and try again. <p><Cellphone> Re-register the cellphone and receiver pairing. Refer to "Registering the device pair" on page 18.</p>
Charging is not terminated even though the time for a complete charging has elapsed.	This process may take approximately 3 hours or so depending on the level of the battery's remaining charge.
Charging stops immediately.	To prevent overcharging, repeated charging is not possible. Before charging again after fully charging, use the unit for at least 20 to 30 minutes. (If charging is restarted immediately after fully charging, charging will automatically stop after about 1 minute.)

RQT8993

26

Problem	Possible cause and suggested remedy
I can use the unit only for a short time even after charging.	<ul style="list-style-type: none"> •The unit may be usable just for a short time when its battery is first charged or when it is charged after the unit has not been used for a prolonged period. The battery's charging capability will be restored after a few charges. •The battery will discharge if the power switch is kept at the "on" setting. •If the play time available is extremely short even after the battery has been charged, it means that the rechargeable battery has reached the end of its service life (after about 300 charges). For more information on replacing the rechargeable nickel-hydrogen battery, consult with your dealer.
The sound cut out while music was playing.	•Did you receive mail or a message (R/F)? Check your cellphone.
Sound copyright-protected by SCMS-T (a copy protection technology) cannot be played.	•This is not supported by the unit.

• iPod®: The latest iPod® software versions are required.

■ **If wireless communication is not possible or is disconnected, check the following.**

- a) Has the battery in the unit or connected device discharged?
- b) Is power being supplied to the unit and device connected to it?
- c) If there is an obstacle between the receiver and the transmitter or connected device, avoid or remove it.
- d) Is a wireless device, microwave oven, etc. that operates on a frequency in the 2.4 GHz band being used near the receiver, transmitter or connected device?
- e) Place the receiver, transmitter and connected device as close to one another as possible.
- f) Change the position or direction of the receiver, transmitter or connected device.
- g) Have you registered the device with the cellphone and transmitter?
- h) Are the registered cellphone, transmitter and unit set to the wireless communication standby status?

RQT8993

27



Specifications

- **Bluetooth** specification : version 2.0
- Output : Power Class 2
- Carrier frequency : 2.4 - 2.483 GHz
- Operation distance : up to 10 m (33 ft.)
- Compatible **Bluetooth** Profiles : A2DP (Advanced Audio Distribution Profile), AVRCP (Audio Video Remote Control Profile), HSP (Head Set Profile), HFP (Hands Free Profile)
- Audio Codec : SBC
- Battery : Ni-MH (1.2 V, min 620 mAh)
- Playback time : 4.5 hours
- Charge time : 3 hours
- Total cord length : 0.6 m (2.1 ft.)
- Plug (Earphones) : 3.5 mm (1/8 in.)
- Dimensions (W × H × D) :
 - Receiver 24.0 mm × 54.0 mm × 24.1 mm (15/16 in. × 2-1/8 in. × 15/16 in.)
 - Transmitter 62.3 mm × 31.0 mm × 11.0 mm (2-7/16 in. × 1-1/4 in. × 7/16 in.)
- Mass (Weight) :
 - Receiver Approx. 30.4 g (1.1 oz.)
 - Transmitter Approx. 11.4 g (0.4 oz.)
- AC Adaptor :
 - Input AC 120 V, 60 Hz
 - Output DC 4.8 V, 720 mA
 - Power consumption 6 W

* Specifications are subject to changes without notices.

Listening caution



Do not play your earphones at a high volume. Hearing experts advise against continuous extended play. If you experience a ringing in your ears, reduce volume or discontinue use.

Pay attention to the surrounding environment (traffic) when using the earphones while walking. Do not use while operating a motorized vehicle. It may create a traffic hazard and is illegal in many areas.

You should use extreme caution or temporarily discontinue use in potentially hazardous situations. Sound can be deceiving. Over time your hearing "comfort level" adapts to higher volumes of sound. So what sounds "normal" can actually be loud and harmful to your hearing. Guard against this by setting your equipment at a safe level BEFORE your hearing adapts.

- To establish a safe level:
- Start your volume control at a low setting.
 - Slowly increase the sound until you can hear it comfortably and clearly, and without distortion.
- Once you have established a comfortable sound level:
- Leave it there.

Panasonic Consumer Electronics Company, Division of
Panasonic Corporation of North America
One Panasonic Way Secaucus, New Jersey 07094

FOR U.S.A.

Panasonic Puerto Rico, Inc.
Ave. 65 de Infantería, Km. 9.5, San Gabriel Industrial Park,
Carolina, Puerto Rico 00985

Panasonic / Technics Accessory Limited Warranty

Limited Warranty Coverage

If your product does not work properly because of a defect in materials or workmanship, Panasonic Consumer Electronics Company or Panasonic Puerto Rico, Inc. (collectively referred to as "the warrantor") will, for the length of the period as follows, which starts with the date of original purchase ("warranty period"), replace it with a new or a refurbished product.

Product	Parts	Service
Headphones, Earphones, Headset, Microphone, Speaker System, Cable, Rechargeable Battery	Ninety (90) days	Carry-in or Mail-in

During the "Parts" warranty period, there will be no charge for parts. You must carry-in or mail-in your product, during the warranty period. If non-rechargeable batteries are included, they are not warranted. This warranty only applies to products purchased and serviced in U.S.A. or Puerto Rico. This warranty is extended only to the original purchaser of a new product which was not sold "as is". A purchase receipt or other proof of the original purchase date is required for warranty service.

For assistance in U.S.A., please visit our Web Site at : <http://www.pstc.panasonic.com> or, send your request by E-mail to : npcparts@us.panasonic.com You may also contact us directly at : 1-800-332-5368 (Phone) or 1-800-237-9080 (Fax) (Monday - Friday 9 am - 8 pm, EST.) **Panasonic Service and Technology Company** : 20421 84th Avenue South, Kent, WA 98032 (For hearing or speech impaired TTY users, TTY : 1-866-605-1277)

For assistance in Puerto Rico, please contact at : (787) 750-4300 (Phone) or (787) 768-2910 (Fax) **Panasonic Puerto Rico, Inc.**

Limited Warranty limits And Exclusions

The warranty ONLY COVERS failures due to defects in materials or workmanship, and DOES NOT COVER normal wear and tear or cosmetic damage. The warranty ALSO DOES NOT COVER damages which occurred in shipment, or failures which are caused by products

not supplied by the warrantor, or failures which result from accidents, misuse, abuse, neglect, mishandling, misapplication, alteration, faulty installation, set-up adjustments, misadjustment of consumer controls, improper maintenance, power line surge, lightning damage, modification, rental use of the product, serviced by anyone other than a Factory ServiCenter or other Authorized Sevice, or damage that is attributable to acts of Gods.

THERE ARE NO EXPRESS WARRANTIES EXCEPT AS LISTED UNDER "LIMITED WARRANTY COVERAGE". THE WARRANTOR IS NOT LIABLE FOR INCIDENTAL OR CONSEQUENTIAL DAMAGES RESULTING FROM THE USE OF THIS PRODUCT, OR ARISING OUT OF ANY BREACH OF THIS WARRANTY, INCLUDING WITHOUT LIMITATION, LOSS OF GOODWILL, PROFITS OR REVENUE, LOSS OF USE OF THIS PRODUCT OR ANY ASSOCIATED EQUIPMENT, COST OF SUBSTITUTE EQUIPMENT, DOWNTIME COSTS, OR CLAIMS OF ANY PARTY DEALING WITH BUYER FOR SUCH DAMAGES. (As examples, this excludes damages for lost time, cost of having someone remove or re-install an installed unit if applicable, travel to and from the servicer. The items listed are not exclusive, but are for illustration only.) **ALL EXPRESS AND IMPLIED WARRANTIES, INCLUDING THE WARRANTIES OF MERCHANTABILITY, ARE LIMITED TO THE PERIOD OF THE LIMITED WARRANTY.**

Some states do not allow the exclusions or limitations of incidental or consequential damages, or limitations on how long an implied warranty lasts, so the exclusions may not apply to you.

This warranty gives you specific legal rights and you may also have others rights which vary from state to state. If a problem with this product develops during or after the warranty period, you may contact your dealer or ServiCenter. If the problem is not handled to your satisfaction, then write to the warrantor's Consumer Affairs Department at the address listed for the warrantor.

PARTS AND SERVICE WHICH ARE NOT COVERED BY THIS LIMITED WARRANTY ARE YOUR RESPONSIBILITY.

AVC200704

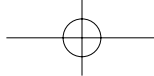

Memo

Memo

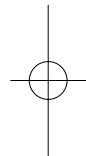
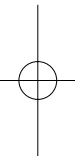

RQT8993

30

RQT8993

31

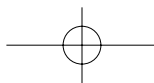

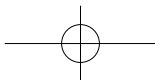

- The **Bluetooth** word mark and logos are owned by the **Bluetooth** SIG, Inc. and any use of such marks by Matsushita Electric Industrial Co.,Ltd. is under license. Other trademarks and trade names are those of their respective owners.
- iPod® is a trademark of Apple Inc.,registered in the U.S. and other countries.

**Panasonic Consumer Electronics
Company, Division of Panasonic
Corporation of North America**
One Panasonic Way Secaucus,
New Jersey 07094
<http://www.panasonic.com>

© 2007 Matsushita Electric Industrial Co., Ltd.
Printed in China

Panasonic Puerto Rico, Inc.
Ave. 65 de Infantería, Km. 9.5
San Gabriel Industrial Park, Carolina,
Puerto Rico 00985

En

RQT8993-P
M0607TK0